

CLOPAY MODEL 902  
IDEAL MODEL C2AL

UP TO 24'-2" WIDE X 18'-0" HIGH

REVISIONS

REV. NO.	ZONE:	DATE:	ECN NO.	APPVD:	DESCRIPTION
07	-	02/2022	-	-	REVISED FOR TDI.

DOOR HEIGHT 'A'	NUMBER OF SECTIONS
UP TO 8'-0"	4
8'-3" THRU 10'-0"	5
10'-3" THRU 12'-0"	6
12'-3" THRU 14'-0"	7
14'-3" THRU 16'-0"	8
16'-3" THRU 18'-0"	9

MAX. SECTION HEIGHT: 24"

DOOR HEIGHT	"L"
8'-0"	88"
9'-0"	100"
10'-0"	112"
12'-0"	136"
14'-0"	160"
15'-0"	172"
16'-0"	184"
17'-0"	196"
18'-0"	208"

THE OPTIONAL GLAZING SHOWN ON THIS DRAWING MEETS THE WIND LOAD REQUIREMENTS OF THE FLORIDA BUILDING CODE OR INTERNATIONAL BUILDING CODE BUT DOES NOT MEET THE IMPACT RESISTANT REQUIREMENT FOR WINDBORNE DEBRIS REGIONS (FBC / IBC CHAPTER 16).

DOOR IS MADE OF 6063-T5 ALUMINUM EXTRUSIONS.  
WALL THICKNESS:  
TOP & BOTTOM RAILS .075  
INTER. TOP & BOTTOM RAILS .075  
TOP HAS .1 x 1.875" FIN  
INTER. TOP RAIL CAP .040  
SINGLE & DOUBLE END STILES .075  
CENTER STILES .062

THIS PRODUCT COMPLIES WITH THE 2018 IBC/IRC.

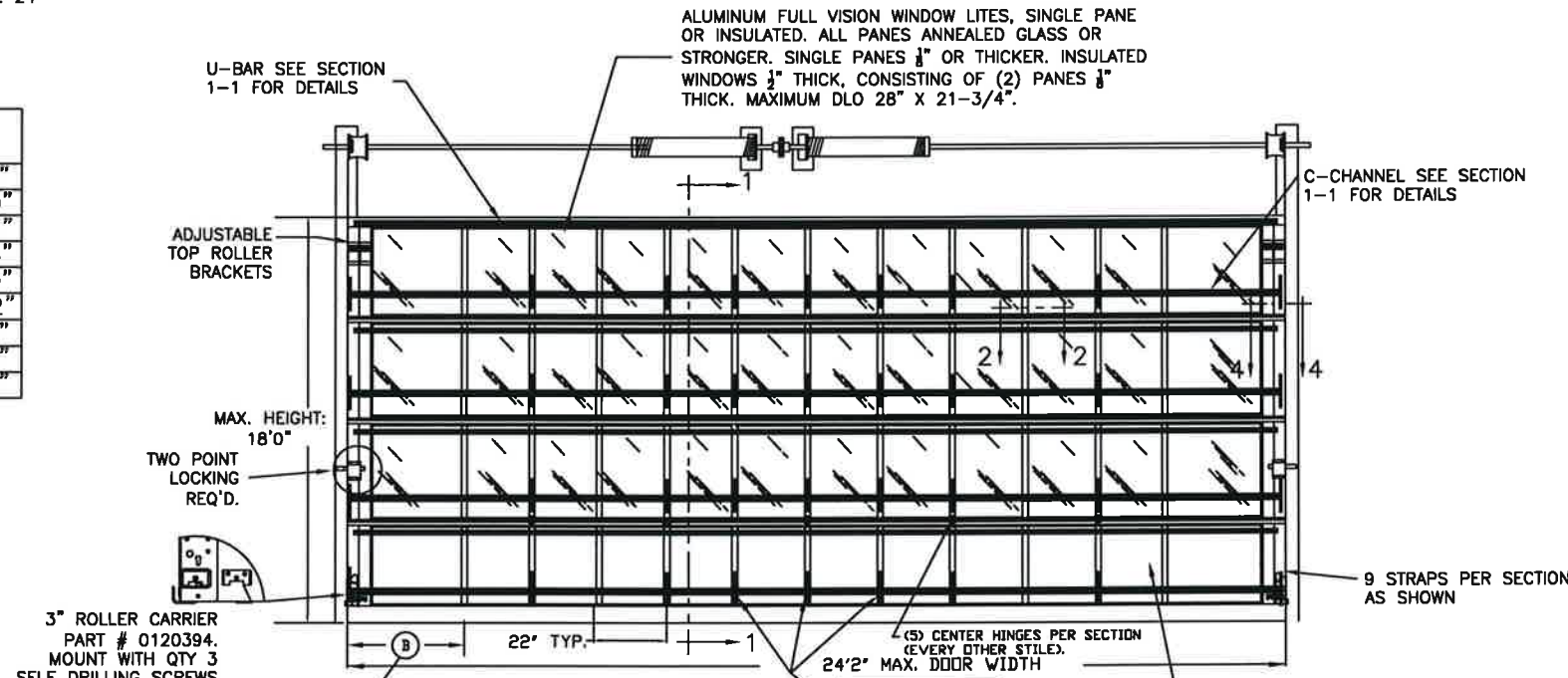

NOTE:  
CENTER STILES ALWAYS 22" FROM CENTER TO CENTER. FOR ANY GIVEN DOOR WIDTH, DIMENSION 'B' IS THE LEFTOVER DIMENSION ON BOTH SIDES OF THE DOOR. THE MAXIMUM TESTED FULL VISION PANEL SIZE IS 23" X 24".

AT THE CENTER OF EACH C-CHANNEL ATTACH THREE 6"x2-1/4"x12 GA. STEEL PLATE TO THE UNDERSIDE OF THE THE C-CHANNEL WITH (4) 1/4"x3/4" SELF TAPPING SCREWS.

CENTER STILES FASTENED TO RAILS WITH FULL LENGTH 5/16" STEEL RODS AND FLANGE NUTS

COR-LOVLY CENTER HINGES ON EVERY OTHER STILE STARTING WITH CENTER OF DOOR.

COR-LOVLY CENTER HINGE OF 16 GA. GALV. STEEL, ATTACHED TO INTER. BOTTOM RAIL WITH (2) #14 x 5/8" SHT MTL SCREWS AND TWO INTER. TOP RAIL WITH (2) 1/4" - 20 x 1/2" HEX HEAD MACHINE SCREWS & NUTS

SECTION 2 - 2

END STILES FASTENED TO RAILS WITH FULL LENGTH 5/16" STEEL RODS AND FLANGE NUTS

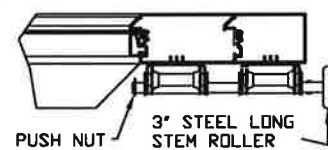

SECTION 4 - 4

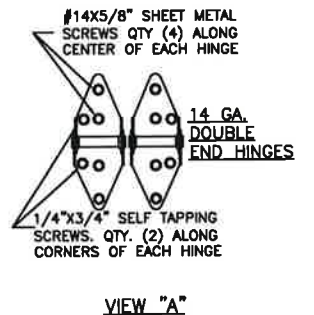
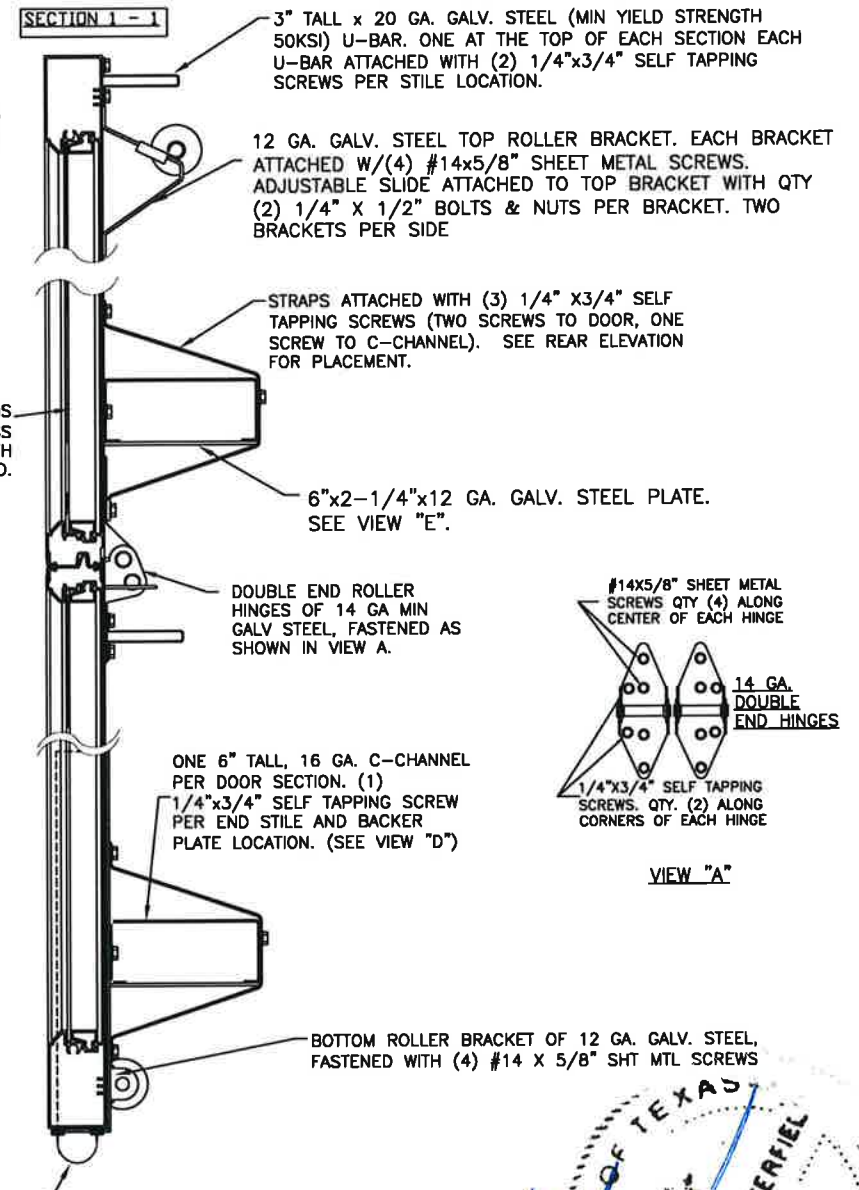
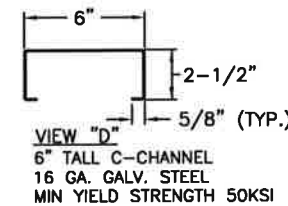

DESIGN ENGINEER: MARK WESTERFIELD, P.E.  
FLORIDA P.E. #48495, NC P.E. #23832, TEXAS P.E. #91513  
DESIGN LOADS: +25 & -25 P.S.F.  
TEST LOADS +37.5 & -37.5 P.S.F.

MANUFACTURING PRODUCT CODE:  
MPC: C-AL-1F499

Unless Stated Otherwise TOLERANCES are  
.0 = ±.031  
.00 = ±.015  
.000 = ±.005  
.0000 = ±.001  
Degrees = ±1/2°

**Clopay** CORPORATION  
8585 Duke Boulevard  
Mason, OH 45040 USA  
Tel. No. 513-770-4800  
Fax No. 513-770-4853

CLOPAY WINDLOAD RATING  
W4

DESCRIPTION: M/N 902, C2AL, 24'2" WIDE DES. +25/-25 PSF

DRAWN BY: BFA DATE: 11/30/04 SCALE: NONE DWG. B  
CHECKED BY: - DATE: - SHEET 1 OF 1 SIZE B

DWG. NO.: 103332 VER: TDI

CLOPAY CORP.  
ALL RIGHTS RESERVED.



Unless Stated Otherwise DIMENSIONS ARE IN INCHES.

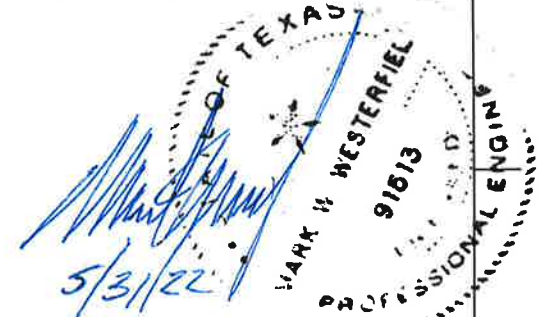

CLOPAY MODEL 902  
IDEAL MODEL C2AL

UP TO 24'-2" WIDE X 18'-0" HIGH

REVISIONS					
REV. NO.	ZONE:	DATE:	ECN NO.	APPVD:	DESCRIPTION
07	-	02/2022	-	-	SEE SHEET 1 FOR REVISION DETAILS.

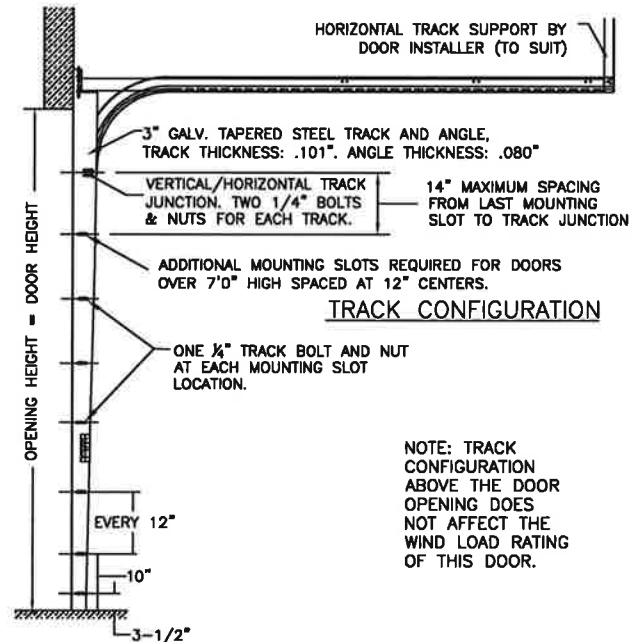

NOTE: TRACK CONFIGURATION ABOVE THE DOOR OPENING DOES NOT AFFECT THE WIND LOAD RATING OF THIS DOOR.

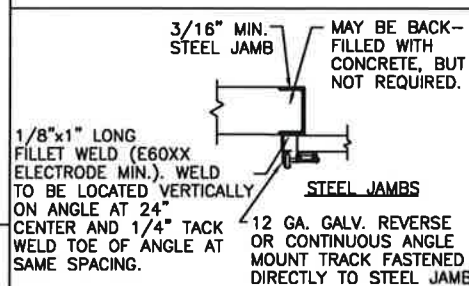

CENTER STILES FASTENED TO RAILS WITH FULL LENGTH 5/16\"/>

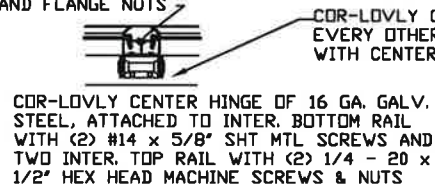

SECTION 2 - 2

END STILES FASTENED TO RAILS WITH FULL LENGTH 5/16\"/>

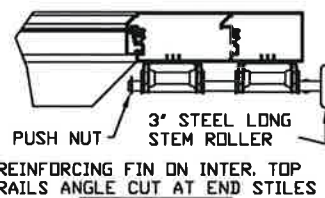

SECTION 4 - 4

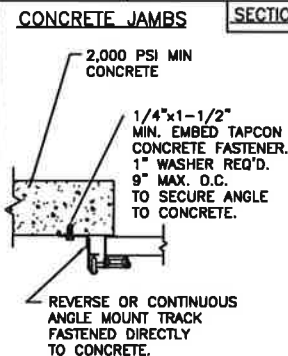
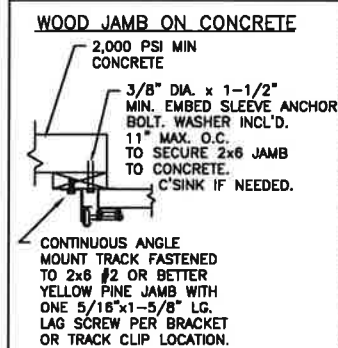

SECTION 5 - 5

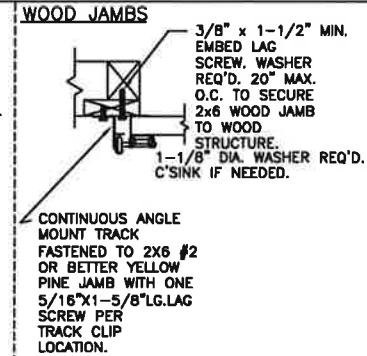
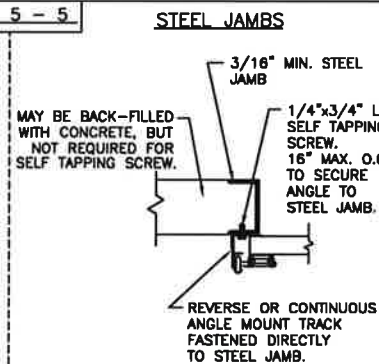

THE DESIGN OF THE SUPPORTING STRUCTURAL ELEMENTS IS THE RESPONSIBILITY OF THE BUILDING ENGINEER OR ARCHITECT OF RECORD.

DESIGN ENGINEER: MARK WESTERFIELD, P.E.  
FLORIDA P.E. #48495, NC P.E. #23832, TEXAS P.E. #91513  
DESIGN LOADS: +25 & -25 P.S.F.  
TEST LOADS +37.5 & -37.5 P.S.F.

MANUFACTURING PRODUCT CODE:  
MPC: C2AL1499

Unless Stated Otherwise TOLERANCES are  
.0 = ±.031  
.00 = ±.015  
.000 = ±.005  
.0000 = ±.001  
Degrees = ±1/2°

**Clopay** CORPORATION  
8585 Duke Boulevard  
Mason, OH 45040 USA  
Tel. No. 513-770-4800  
Fax No. 513-770-4853

CLOPAY WINDLOAD RATING  
W4

DESCRIPTION: M/N 902, C2AL, 24'2" WIDE DES. +25/-25 PSF

DRAWN BY: BFA DATE: 11/30/04 SCALE: NONE DWG. SIZE B

CHECKED BY: - DATE: - SHEET 1 OF 1

DWG. NO.: 103332 VER: TDI

