

UP TO 22'-2" WIDE X 18'-0" HIGH

MODELS AVAILABLE (CLOPAY/ HOLMES/ IDEAL)
 MODELS 524, 520/ 224/ C4ST, COST
 INSULATED MODELS 524S, 520S, 524V/ 224S/ C4SS, COSS, C4SV

REVISIONS					
REV. NO.	ZONE	DATE	ECN NO.	APPVD.	DESCRIPTION
04	-	08/2012	-	-	REVISED FOR TDI.
05	-	06/2013	-	-	REMOVED ACRYLIC GLAZING OPTION.
06	-	08/2016	-	-	REMOVED WIND SPEED TABLE.
07	-	02/2022	-	-	REVISED FOR TDI.

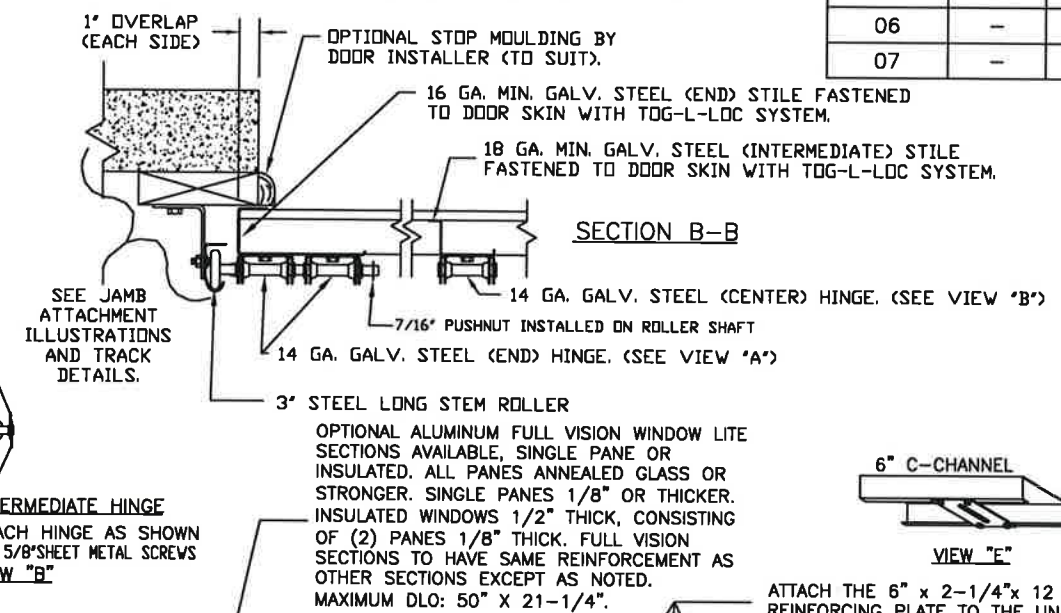
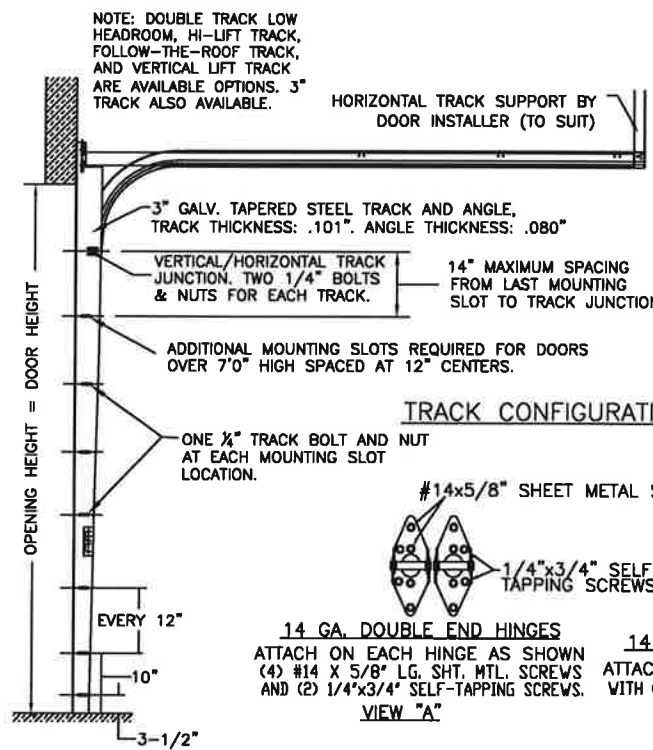

THIS PRODUCT COMPLIES WITH THE 2018 IBC/IRC.

SECTIONS ARE 1-7/8" THK PANELS ROLL FORMED OF .022" MIN. HOT DIPPED G-40 GALVANIZING, ROLL FORMED STEEL.

3" TALL X 20 GA. GALV. STEEL (MIN. YIELD STRENGTH 50KSI) U-BAR. ATTACHED ONE AT THE TOP OF EACH SECTION EACH U-BAR ATTACHED WITH (2) 1/4"x3/4" SELF TAPPING SCREWS PER STILE LOCATION.

ADJUSTABLE TOP ROLLER BRACKET OF 12 GA. GALV. STEEL, INSTALLED ON DOOR WITH (4) #14 X 5/8" LG SHEET METAL SCREWS. (2 BRACKETS PER SIDE)

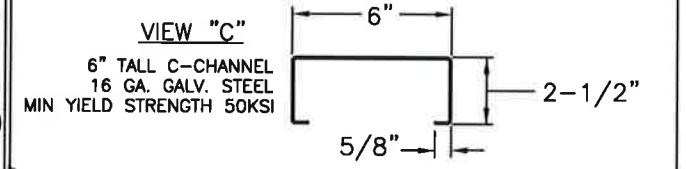

(1) 6"x16 GA. C-CHANNEL PER DOOR SECTION. (1) 1/4"x3/4" SELF TAPPING SCREW PER STILE LOCATION. (SEE VIEW "C")

END HINGES OF MIN. 14 GA. GALV. STEEL, FASTENED WITH (4) #14 X 5/8" LG. SHT. MTL. SCREWS AND (2) 1/4"x3/4" SELF-TAPPING SCREWS. QTY-2 HINGES PER SIDE

1-1/4"WIDE X 16 GA. GALV. STRAP. EACH STRAP ATTACHED WITH (3) 1/4" X 3/4" SELF TAPPING SCREWS. TWO SCREWS TO DOOR, ONE SCREW TO C-CHANNEL.

BOTTOM ROLLER BRACKET OF 12 GA. MIN. GALV. STEEL, FASTENED WITH (4) #14 X 5/8" LG SHT. MTL. SCREWS

BOTTOM SECTION REINFORCED WITH TEMPERED ALUMINUM EXTRUSION WITH INTEGRAL RETAINER FOR FLEXIBLE VINYL ASTRAGAL

SECTION A-A (SIDE VIEW)

DESIGN LOADS: +30 & -30 P.S.F.
 TEST LOADS: +45 & -45 P.S.F.

MANUFACTURING PRODUCT CODE: MPC: C-PAN-1E448

DOOR HEIGHT 'A'	NUMBER OF SECTIONS
8'-0"	4
8'-3" THRU 10'-0"	5
10'-3" THRU 12'-0"	6
12'-3" THRU 14'-0"	7
14'-3" THRU 16'-0"	8
16'-3" THRU 18'-0"	9

MAX. SECTION HEIGHT: 24"

DOOR HEIGHT	"L"
8'-0"	88"
9'-0"	100"
10'-0"	112"
12'-0"	136"
14'-0"	160"
15'-0"	172"
16'-0"	184"
17'-0"	196"
18'-0"	208"

THE OPTIONAL GLAZING SHOWN ON THIS DRAWING MEETS THE WIND LOAD REQUIREMENTS OF THE FLORIDA BUILDING CODE OR INTERNATIONAL BUILDING CODE BUT DOES NOT MEET THE IMPACT RESISTANT REQUIREMENT FOR WINDBORNE DEBRIS REGIONS (FBC / IBC CHAPTER 16).

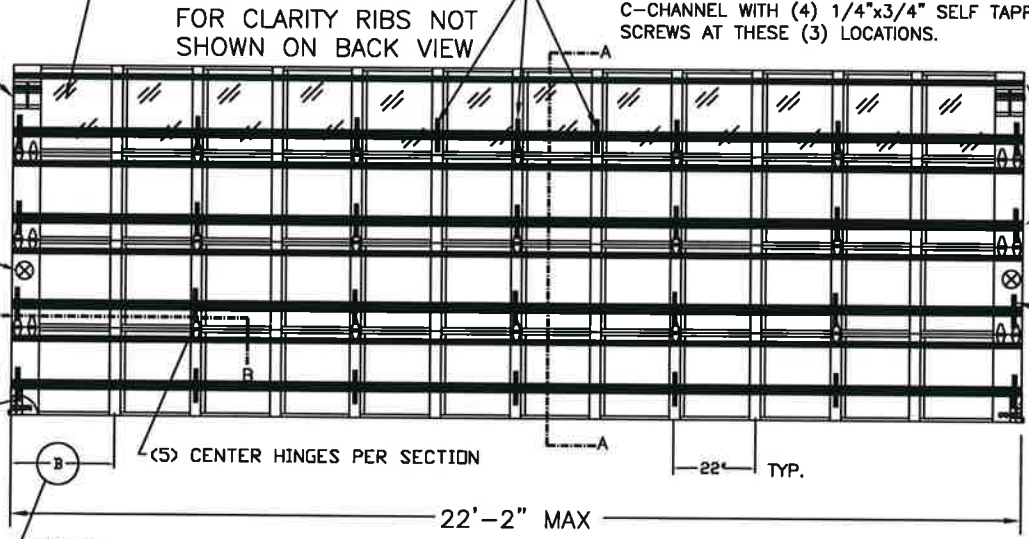
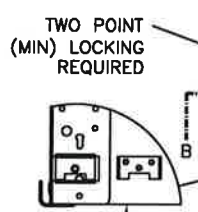
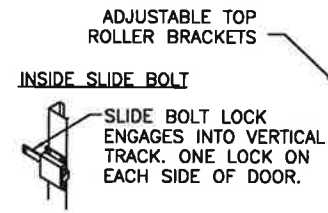

NOTE: CENTER STILES ALWAYS 22" FROM CENTER TO CENTER. FOR ANY GIVEN DOOR WIDTH, DIMENSION 'B' THIS DIMENSION WILL NOT BE GREATER THAN 23" OR LESS THAN 18"

ANCHOR NOTE: FIRST (BOTTOM) ANCHOR STARTING AT NO MORE THAN HALF OF THE MAXIMUM ON-CENTER DISTANCE. HIGHEST ANCHOR INSTALLED AT LEAST AS HIGH AS THE DOOR OPENING.

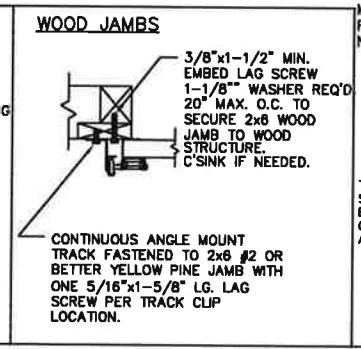
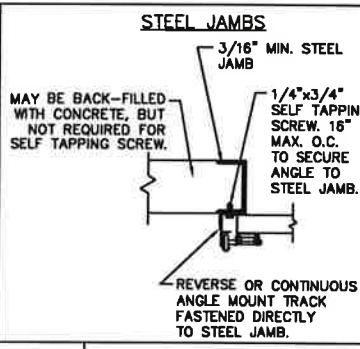
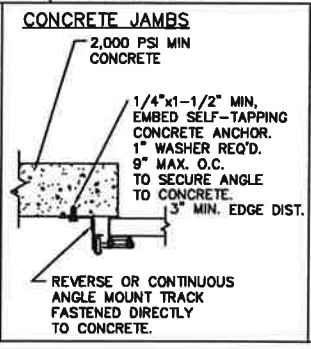
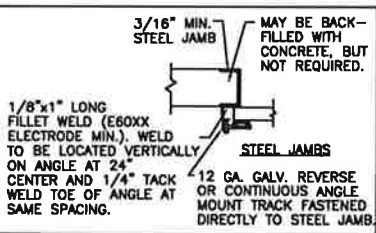

MARK WESTERFIELD, P.E. FLORIDA P.E. No. 48495, NC P.E. #23832, TEXAS P.E. #91513

THE DESIGN OF THE SUPPORTING STRUCTURAL ELEMENTS IS THE RESPONSIBILITY OF THE BUILDING ENGINEER OR ARCHITECT OF RECORD.

MARK WESTERFIELD
 5/31/22

CLOPAY CORP. ALL RIGHTS RESERVED.

Third Angle Projection

Unless Stated Otherwise DIMENSIONS ARE IN INCHES.

.0	= ±.031
.000	= ±.015
.0000	= ±.005
.00000	= ±.001
Degrees	= ±1/2

WATERFRONT

Clopay CORPORATION

8585 Duke Boulevard
 Mason, OH 45040 USA
 Tel. No. 513-770-4800
 Fax No. 513-770-4853

CLOPAY WINDLOAD RATING
W5

DESCRIPTION: COMMERCIAL RIBBED DOOR, +30/-30 PSF DESIGN LOAD

DRAWN BY: RJK	DATE: 11/02/04	SCALE: NONE	DWG. SIZE: B
CHECKED BY: MWW	DATE: -	SHEET 1 OF 1	VER: TDI

DWG. NO.: 103319