

CLOPAY MODEL 902  
IDEAL MODEL C2AL

REVISIONS

REV. NO.	ZONE:	DATE:	ECN NO.	APPVD:	DESCRIPTION
05	-	08/2012	-	SH	REVISED FOR TDI.
06	-	06/2013	-	SH	REMOVED ACRYLIC GLAZING. SPECIFIED MAX GLAZING DIMENSION.
07	-	08/2016	-	SH	REMOVED WIND SPEED TABLE.
08	-	02/2022	-	SH	REVISED FOR TDI.

DOOR HEIGHT 'A'	NUMBER OF SECTIONS
UP TO 8'-0"	4
8'-3" THRU 10'-0"	5
10'-3" THRU 12'-0"	6
12'-3" THRU 14'-0"	7
14'-3" THRU 16'-0"	8
16'-3" THRU 18'-0"	9

MAX. SECTION HEIGHT: 24"

ALUMINUM FULL VISION WINDOW LITES, SINGLE PANE OR INSULATED. ALL PANES ANNEALED GLASS OR STRONGER. SINGLE PANES 1/2" OR THICKER. INSULATED WINDOWS 1/2" THICK, CONSISTING OF (2) PANES 1/2" THICK. MAXIMUM DLO 33" X 21-3/4".

THIS PRODUCT COMPLIES WITH THE 2018 IBC/IRC.

SECTION 1 - 1

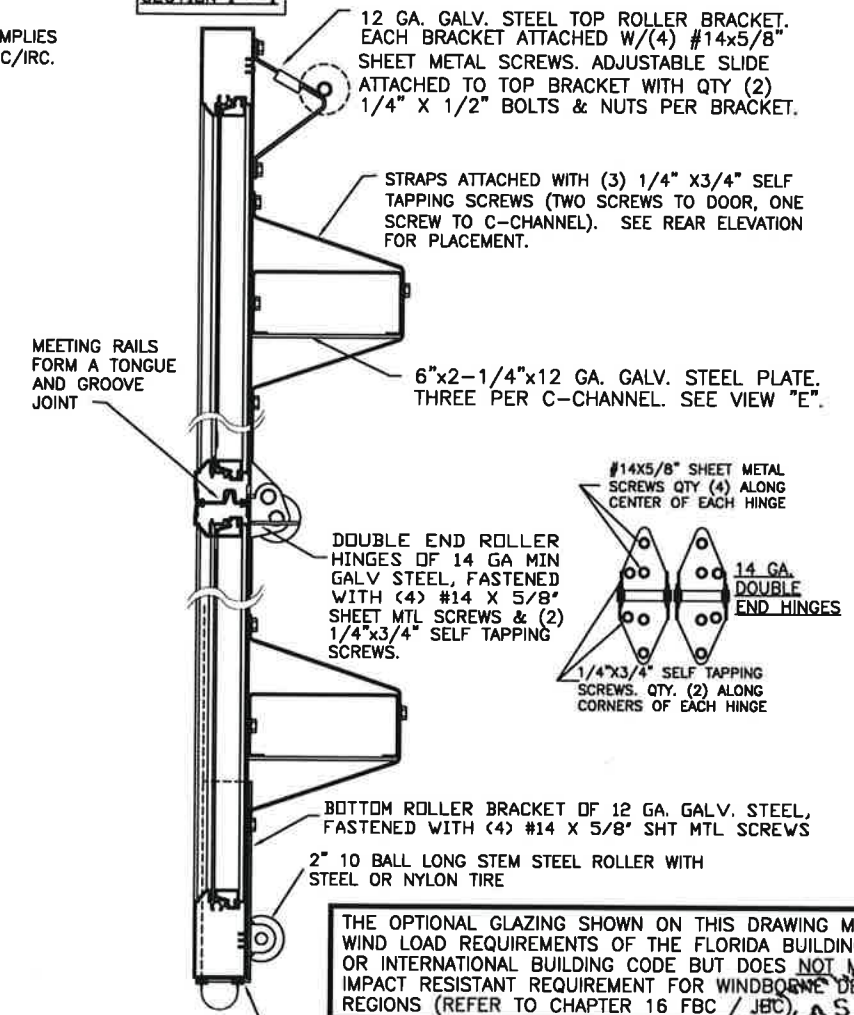

BOTTOM SECTION REINFORCED WITH A TEMPERED ALUMINUM EXTRUSION WITH INTEGRAL RETAINER FOR FLEXIBLE VINYL ASTRAGAL

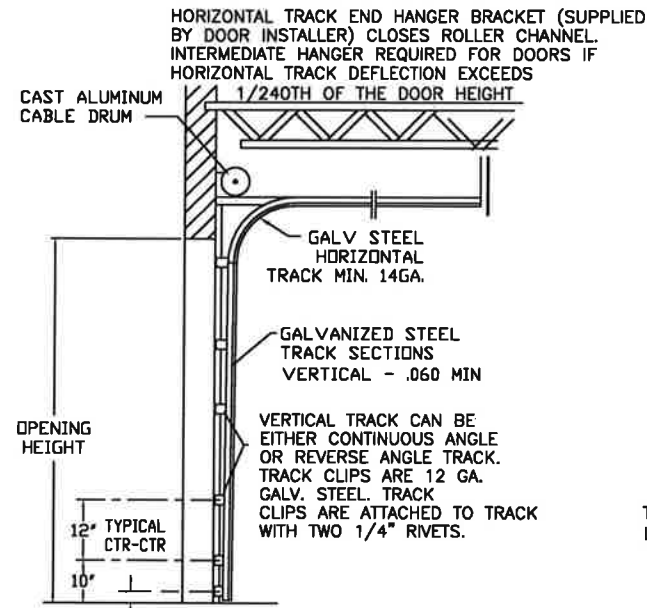

\*\* SIDE ELEVATION STANDARD-LIFT TRACK DETAILS \*\*

DOOR IS MADE OF 6063-T5 ALUMINUM EXTRUSIONS. WALL THICKNESS:  
TOP & BOTTOM RAILS .075  
INTER. TOP & BOTTOM RAILS .075  
TOP HAS .1 X 1.875" FIN  
INTER. TOP RAIL CAP .040  
SINGLE & DOUBLE END STILES .075  
CENTER STILES .062

\*\* NOTE: DOUBLE TRACK LOW HEADROOM, HI-LIFT TRACK, FOLLOW-THE-ROOF TRACK, AND VERTICAL LIFT TRACK ARE AVAILABLE OPTIONS. 3" TRACK ALSO AVAILABLE.

CENTER STILES FASTENED TO RAILS WITH FULL LENGTH 5/16" ALUMINUM RODS AND FLANGE NUTS

COR-LDONLY CENTER HINGE OF 16 GA. GALV. STEEL, ATTACHED TO INTER. BOTTOM RAIL WITH (2) #14 X 5/8" SHT MTL SCREWS AND TO INTER. TOP RAIL WITH (2) 1/4 - 20 X 1/2" HEX HEAD MACHINE SCREWS & NUTS

SECTION 2 - 2

AT THE CENTER OF EACH C-CHANNEL ATTACH THREE 6"x2-1/4"x12 GA. STEEL PLATE TO THE UNDERSIDE OF THE C-CHANNEL WITH (4) 1/4"x3/4" SELF TAPPING SCREWS.

VIEW "E" 6" C-CHANNEL

END STILES FASTENED TO RAILS WITH FULL LENGTH 5/16" ALUMINUM RODS AND FLANGE NUTS

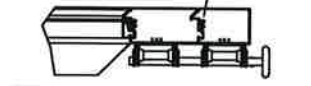

REINFORCING FIN ON INTER. TOP RAILS ANGLE CUT AT END STILES

SECTION 4 - 4

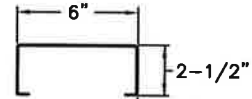

6" TALL C-CHANNEL 16 GA. GALV. STEEL

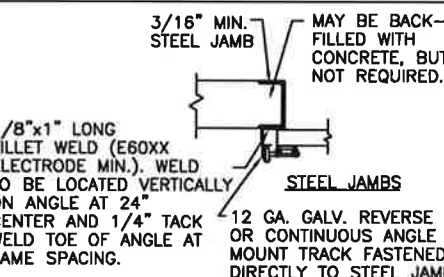

WOOD JAMB ON CONCRETE

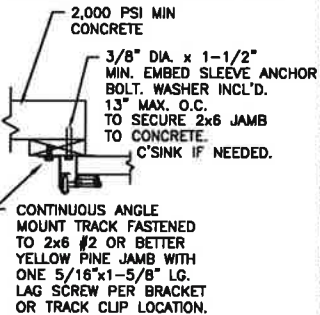

CONCRETE JAMBS

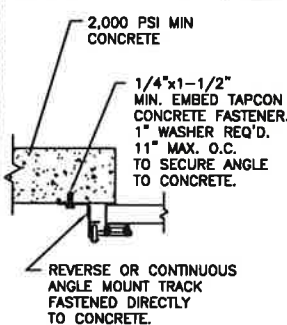

SECTION 5 - 5

STEEL JAMBS

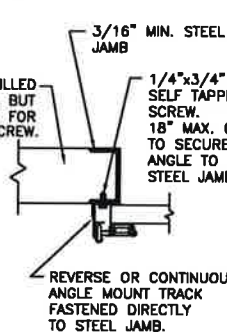

WOOD JAMBS

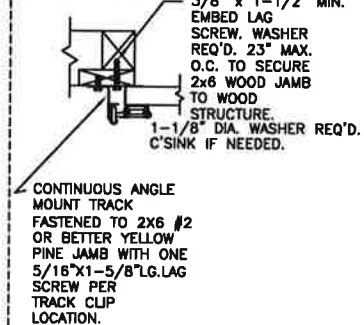

THE DESIGN OF THE SUPPORTING STRUCTURAL ELEMENTS IS THE RESPONSIBILITY OF THE BUILDING ENGINEER OR ARCHITECT OF RECORD.

CLOPAY CORP. ALL RIGHTS RESERVED.

Unless Stated Otherwise TOLERANCES are  
.0 = ±.031  
.00 = ±.015  
.000 = ±.005  
.0000 = ±.001  
Degrees = ±1/2"

Third Angle Projection

Unless Stated Otherwise DIMENSIONS ARE IN INCHES.

DESIGN ENGINEER: MARK WESTERFIELD, P.E.  
FLORIDA P.E. #48495, NC P.E. #23832, TEXAS P.E. #91513  
DESIGN LOADS: +30 & -30 P.S.F.  
TEST LOADS +45 & -45 P.S.F.

**Clopay** Building Products Company  
8585 Duke Boulevard  
Mason, OH 45040 USA  
Tel. No. 513-770-4800  
Fax No. 513-770-4853

MANUFACTURING PRODUCT CODE:  
MPC: C-AL-11-499

CLOPAY WINDLOAD RATING  
W5

DESCRIPTION: M/N 902, C2AL 20'2" WIDE DES. +30/-30 PSF

DRAWN BY: RJK DATE: 3/24/04 SCALE: NONE DWG. SIZE B

CHECKED BY: MWW DATE: 4/1/04 SHEET 1 OF 1

DWG. NO.: 103296 VER: TDI

