

BRAND	MODEL
CLOPAY	904, 904U, AX, AXU
IDEAL	C4AL, C4ALU

MADE FROM 6063-T5 ALUMINUM.

THIS PRODUCT COMPLIES WITH THE 2018 IBC/IRC.

DSB LITES OR BETTER, ANNEALED OR TEMPERED. INSULATED GLAZING SHALL CONSIST OF 2 ANNEALED OR TEMPERED DSB LITES. MAX DLO 48" X 25.825".

REVISIONS					
REV. NO.	ZONE:	DATE:	ECN NO.	APPVD:	DESCRIPTION
00	-	4/7/22	-	JDW	RELEASED FOR PRODUCTION

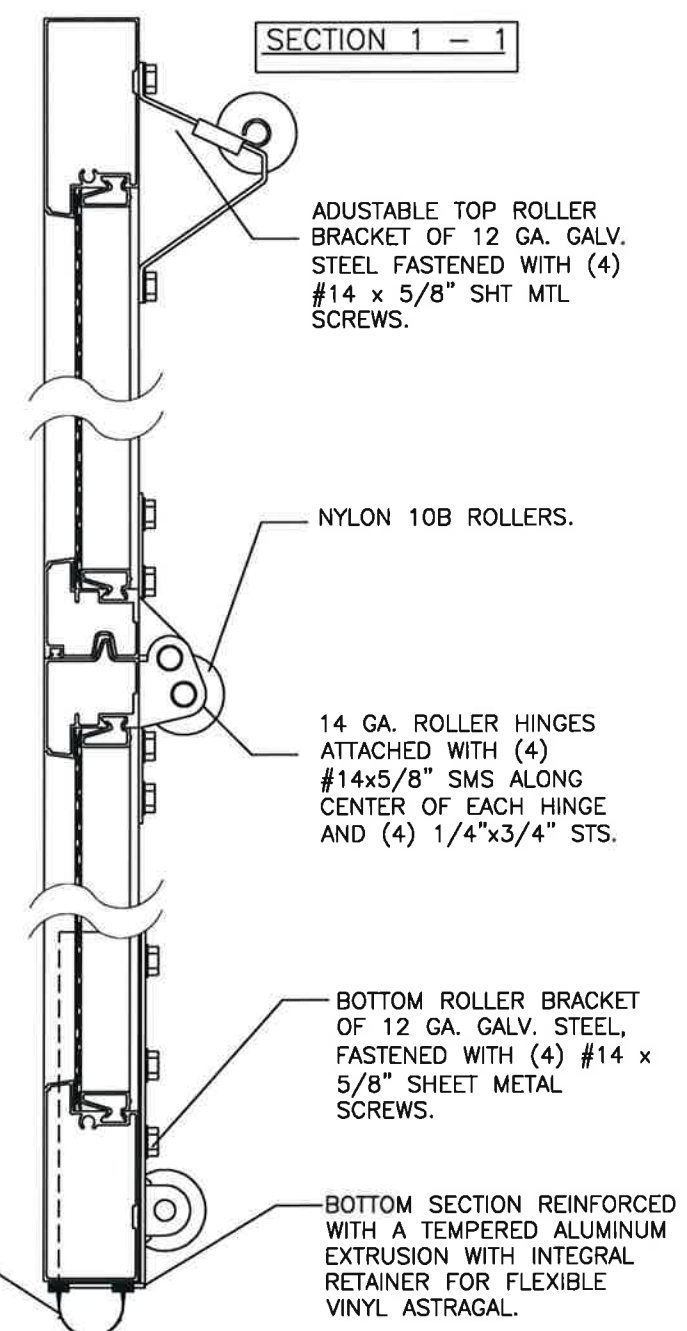
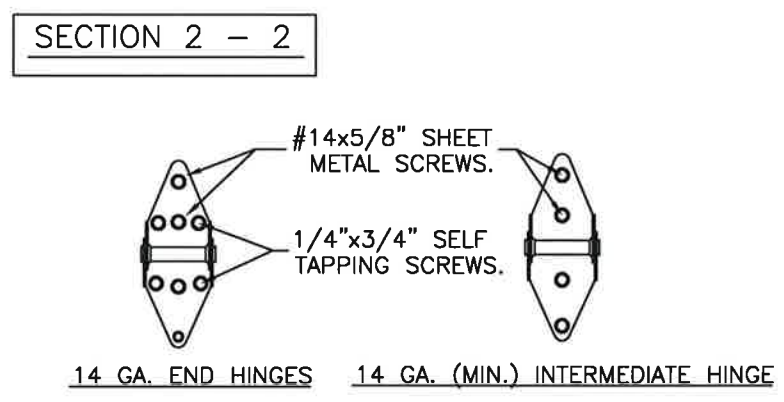
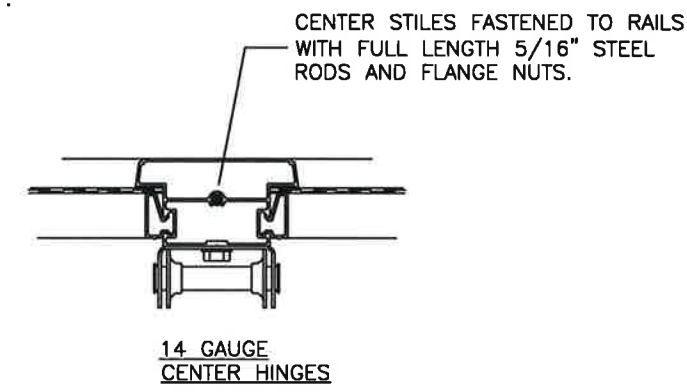
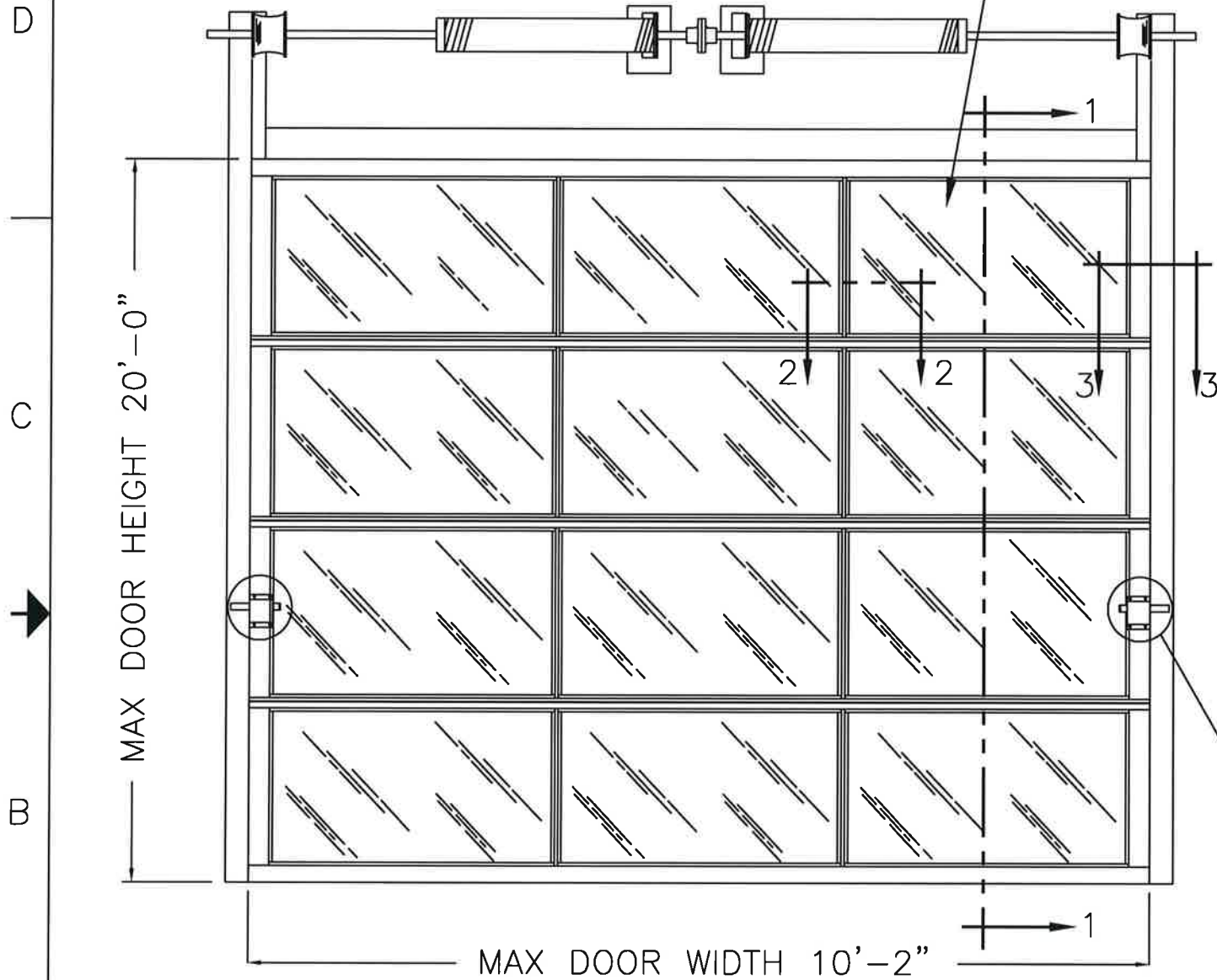

TWO POINT LOCKING

SEE PAGE 2 FOR DIFFERENT JAMB CONFIGURATIONS

END STILES FASTENED TO RAILS WITH FULL LENGTH 5/16" STEEL RODS AND FLANGE NUTS.

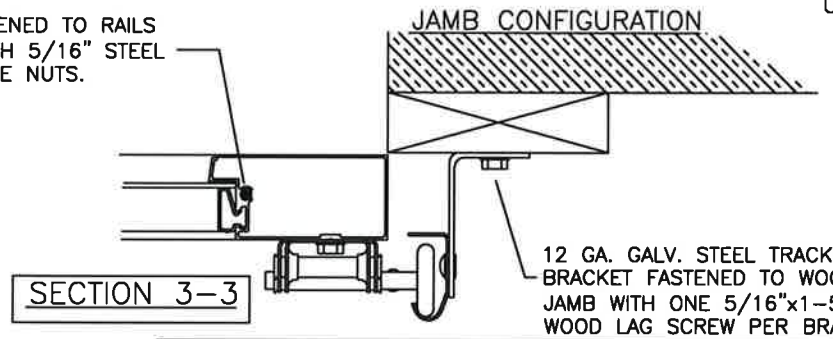

DESIGN PRESSURE: +30.0, -30.0 PSF  
TEST PRESSURE: +45.0, -45.0 PSF

*Mark Westerfield*  
4/21/22

STATE OF TEXAS  
MARK W. WESTERFIELD  
91513  
PROFESSIONAL ENGINEER

DESIGN ENGINEER:  
MARK WESTERFIELD, P.E.  
FLORIDA P.E. #48495  
NC P.E. #23832, TEXAS P.E. #91513

MANUFACTURING PRODUCT CODE  
C-AL2-1F499

NOTICE: Confidential/Proprietary information of CLOPAY CORPORATION is contained herein and may not be disclosed, used, duplicated, made available, or distributed without its prior consent. Failure to observe this notice may result in liability for any damages and losses resulting therefrom.	Unless Stated Otherwise TOLERANCES are
	.0 = ±.031
	.00 = ±.015
	.000 = ±.005
Third Angle Projection	.0000 = ±.001
	Degrees = ±1/2'
Unless Stated Otherwise DIMENSIONS ARE IN INCHES.	

**Clopay** CORPORATION  
8585 Duke Boulevard  
Mason, OH 45040 USA  
Tel. No. 513-770-4800  
Fax No. 513-770-4853

PART NO.: -		CLOPAY WINDLOAD RATING	
		W5	
DESCRIPTION: M/N 904 10' WIDE DES. +30/-30 PSF			
DRAWN BY: J. WHEELER	DATE: 4/7/22	SCALE: NTS	DWG. B
CHECKED BY: SH	DATE: CHKD_DT	SHEET 1 OF 2	SIZE B
DWG. NO.: 105621		REV. NO. 00	

4

3

2

1

REVISIONS

REV. NO.	ZONE:	DATE:	ECN NO.	APPVD:	DESCRIPTION
00	-	4/7/22	-	JDW	SEE REVISION HISTORY ON SHEET 1

2" TRACK CONFIGURATION.

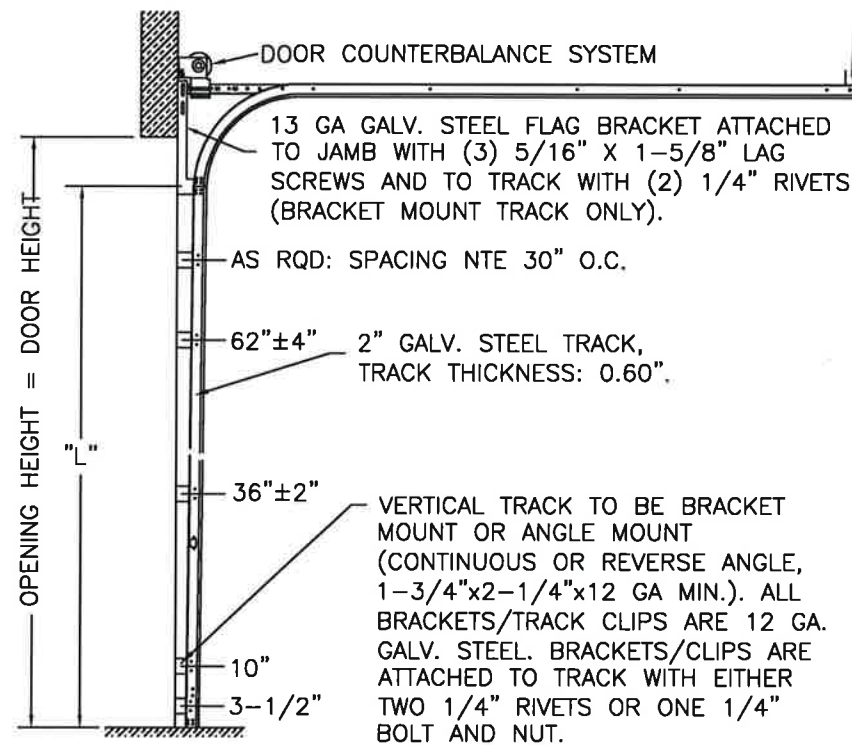

HORIZONTAL TRACK SUPPORT BY DOOR INSTALLER (TO SUIT).

WOOD JAMBS

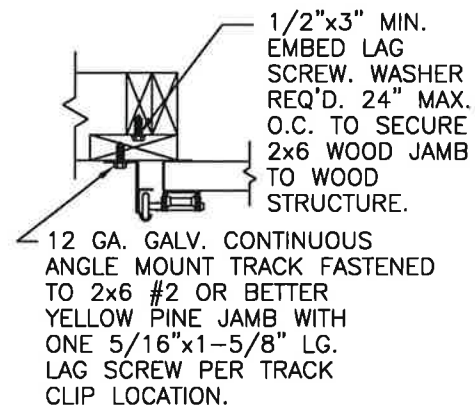

SECTION 3-3

CONCRETE JAMBS

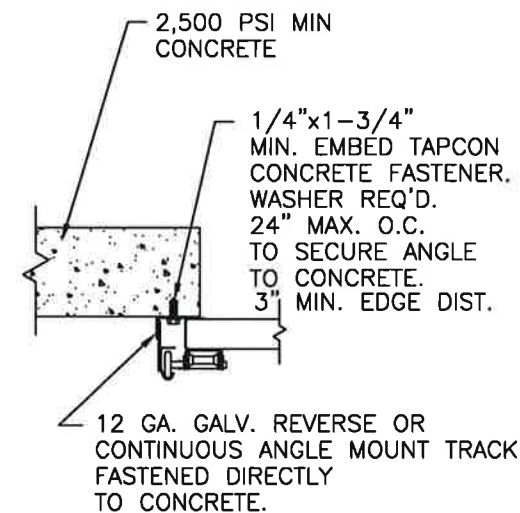

SECTION 3-3

STEEL JAMBS

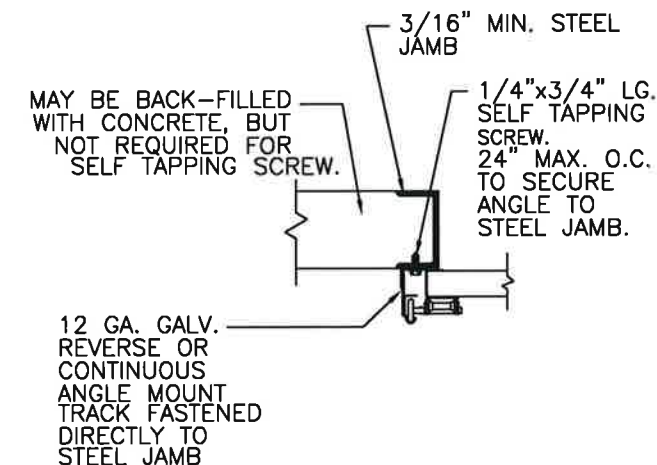

SECTION 3-3

DOOR HEIGHT "L"	"L"
6'-6"	70"
7'-0"	76"
7'-6"	82"
8'-0"	88"
8'-6"	94"
9'-0"	100"
9'-6"	106"
10'-0"	112"
10'-6"	118"
11'-0"	124"
11'-6"	130"
12'-0"	136"
12'-6"	142"
13'-0"	148"
13'-6"	154"
14'-0"	160"
14'-6"	166"
15'-0"	172"
15'-6"	178"
16'-0"	184"
16'-6"	190"
17'-0"	196"
17'-6"	202"
18'-0"	208"
18'-6"	214"
19'-0"	220"
19'-6"	226"
20'-0"	232"

NOTE DOUBLE TRACK HEADROOM, HI-LIFT TRACK, FOLLOW-THE- ROOF TRACK, AND VERTICAL LIFT TRACK ARE AVAILABLE OPTIONS. TRACK CONFIGURATION ABOVE THE DOOR OPENING DOES NOT AFFECT THE WIND LOAD RATING.

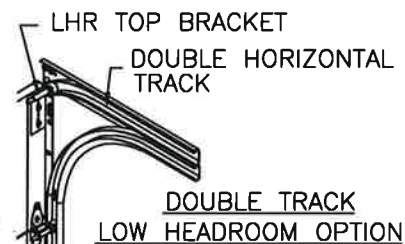

WOOD JAMB ON CONCRETE

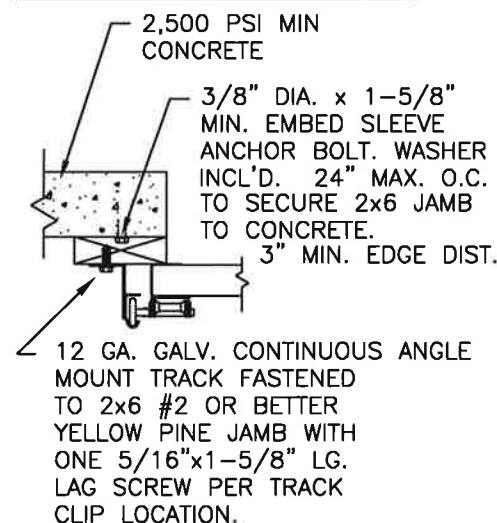

SECTION 3-3

STEEL JAMBS

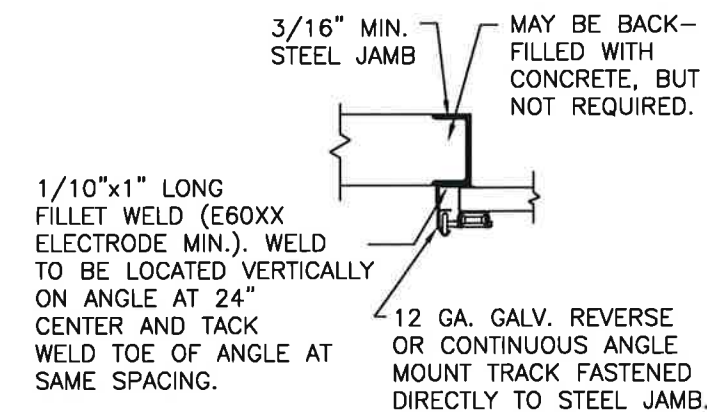

SECTION 3-3

DESIGN ENGINEER: MARK WESTERFIELD, P.E. FLORIDA P.E. #48495 NC P.E. #23832, TEXAS P.E. #91513



NOTICE: Confidential/Proprietary information of CLOPAY CORPORATION is contained herein and may not be disclosed, used, duplicated, made available, or distributed without its prior consent. Failure to observe this notice may result in liability for any damages and losses resulting therefrom.

Unless Stated Otherwise TOLERANCES are .0 = ±.031 .00 = ±.015 .000 = ±.005 .0000 = ±.001 Degrees = ±1/2'

Clopay CORPORATION 8585 Duke Boulevard Mason, OH 45040 USA Tel. No. 513-770-4800 Fax No. 513-770-4853

DESCRIPTION: M/N 904 10' WIDE DES. +30/-30 PSF

DRAWN BY: J. WHEELER DATE: 4/7/22 SCALE: NTS DWG. B

CHECKED BY: SH DATE: CHKD\_DT SHEET 2 OF 2 SIZE B

DWG. NO.: 105621 REV. NO. 00

PART NO.: -

CLOPAY WINDLOAD RATING W5

4

3

2

1