



A SENNECA COMPANY

HURRICANE SERIES FIBERGLASS DOUBLE DOOR OUTSWING "NON-IMPACT"

EVALUATED FOR USE IN THE STATE OF TEXAS

DR-980

The Fiberglass Door system described herein complies with the 2018 International Residential Code (IRC), Sections R301 & R609 and the 2018 International Building Code (IBC), Sections 1404.13, 1609, 1709.5, 2403 and 2404 subject to the following conditions:

1. Anchors shall be as listed and spaced as shown in the details. Anchor embedment to base material shall be beyond wall dressing or stucco.
2. When used in areas requiring wind-borne debris protection this product is required to be protected with an impact resistant covering that complies with Section R301.2.1.2 of the IRC and Section 1609.1.2 of the IBC.
3. Allowable design pressure requirements must be equal to or less than the design pressure rating shown in the design pressure chart, sheet 1 of this drawing.
4. Conditions not covered by this drawing are subject to further engineering analysis.

TABLE OF CONTENTS	
SHEET #	DESCRIPTION
1	Typical elevations, design pressures & general notes
2	Door panel details
3	Horizontal cross sections
4	Vertical cross sections
5	Frame anchoring & hardware details
6	Bill of materials & components

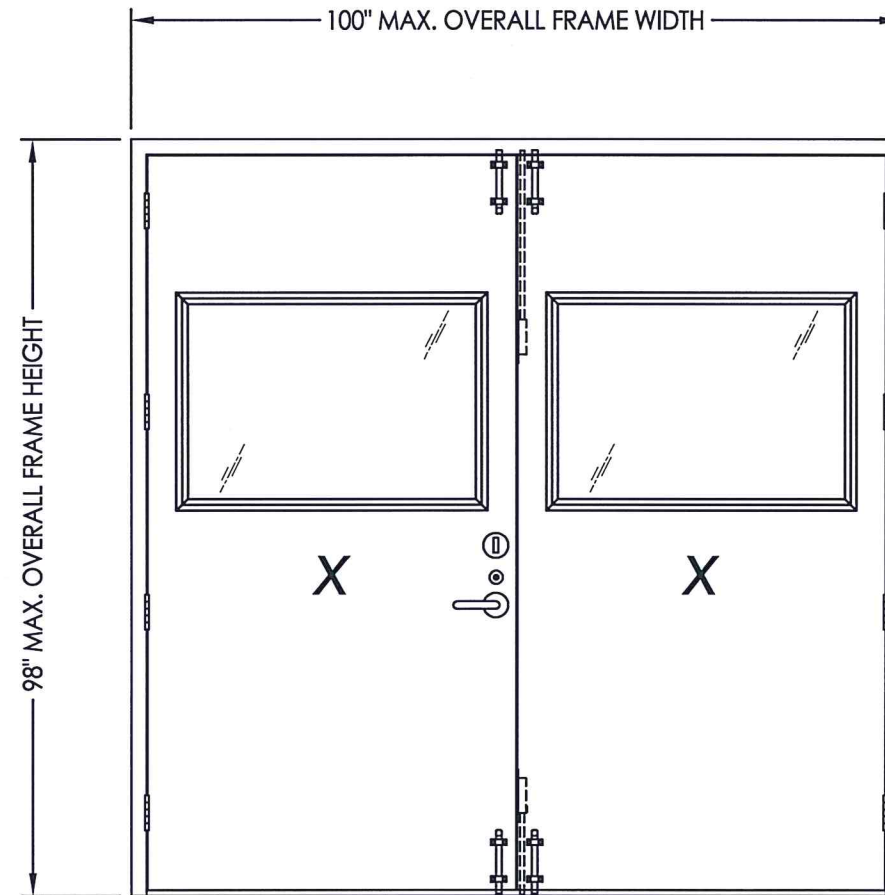

GLAZED PANELS SHOWN
(OPAQUE SIMILAR)

MAX FRAME DIMENSION	DOOR TYPE	DESIGN PRESSURE (PSF) OUTSWING	
		POSITIVE	NEGATIVE
100" x 98"	OPAQUE	+90.0	-90.0
100" x 98"	GLAZED	+90.0	-90.0

SURFACE BOLTS REQUIRED @ TOP & BOTTOM OF EACH DOOR



Documents Prepared By: Lyndon F. Schmidt, P.E.
TEXAS P.E. #104123

R.W. BUILDING CONSULTANTS, INC.
P.O. Box 230 Valrico FL 33595
Phone No.: 813.669.9197

CERTIFICATE OF REGISTRATION # F-11852

PRODUCT:	FIBERGLASS DOOR
PART OR ASSEMBLY:	TYPICAL ELEVATION, DESIGN PRESSURES & GENERAL NOTES
DATE:	5/14/18
SCALE:	N.T.S.
DWG. BY:	JK
CHK. BY:	LFS
DRAWING NO.:	TX-4836
SHEET	1 OF 6

Z:\Clients\Senneca\B - Texas Dept of Ins\Chem-Pruf\DR 980 Chem-Pruf Fiberglass Door - Non-Impact\Drawings\TX-4834.35.36 REV.dwg

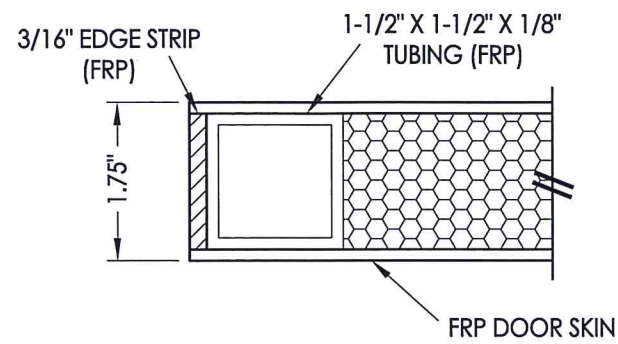

1
2 HORIZONTAL CROSS SECTION

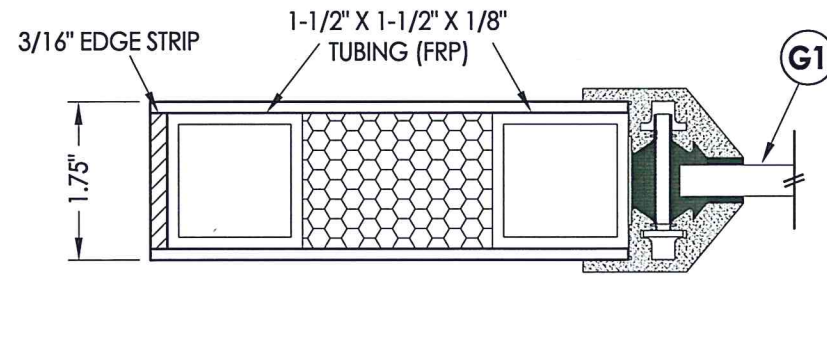

2
2 HORIZONTAL CROSS SECTION

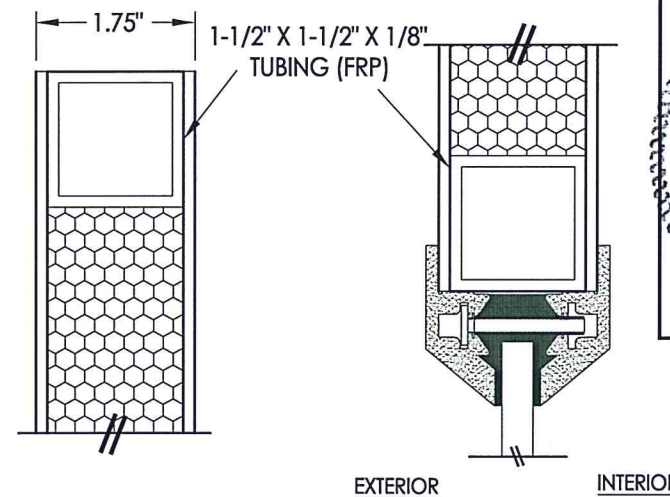

3
2 VERTICAL CROSS SECTION

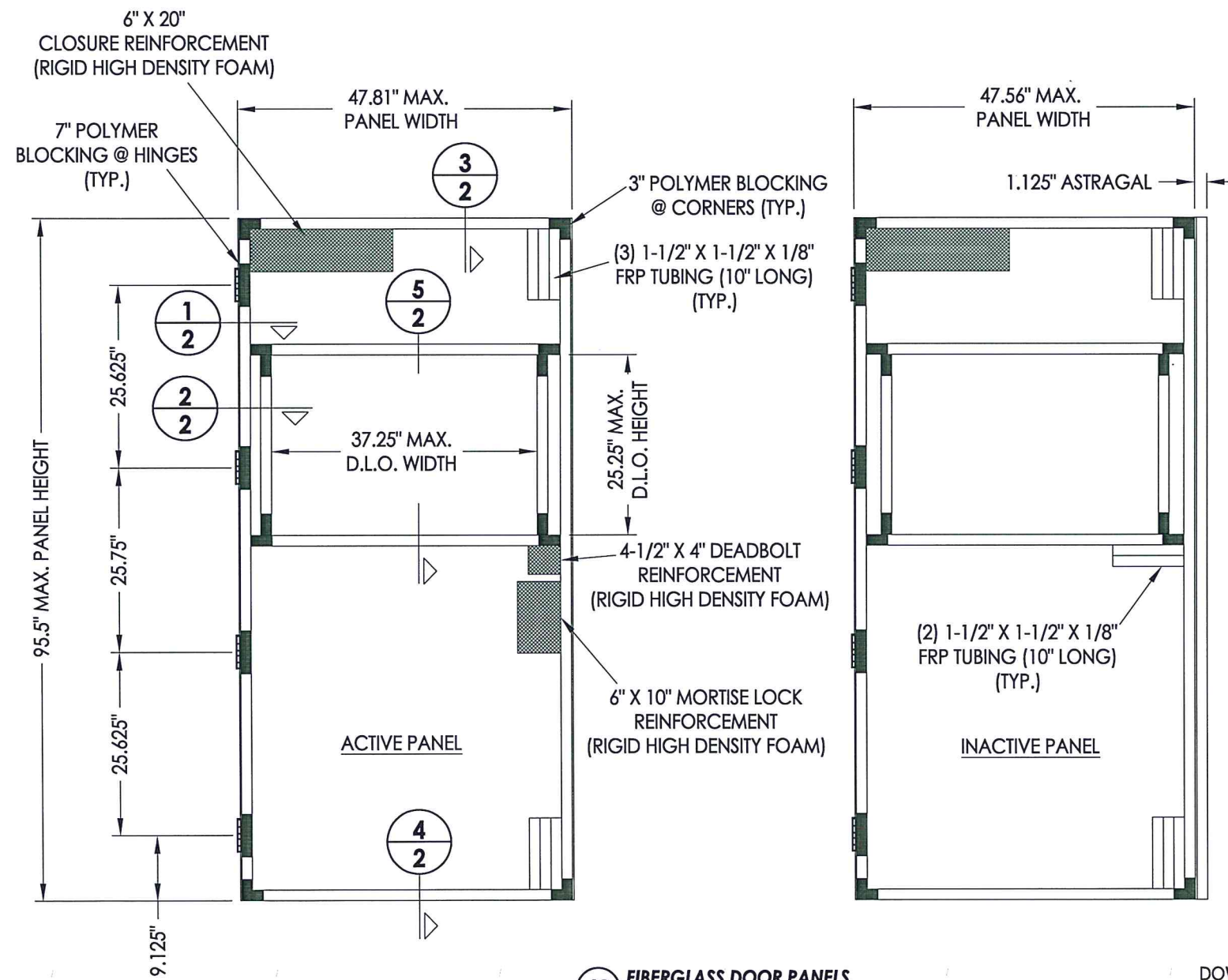

40 FIBERGLASS DOOR PANELS
CHEM-PRUF DOOR

DOOR SKIN: 0.125" MIN. THICKNESS
DOOR CORE: POLYPROPYLENE HONEYCOMB

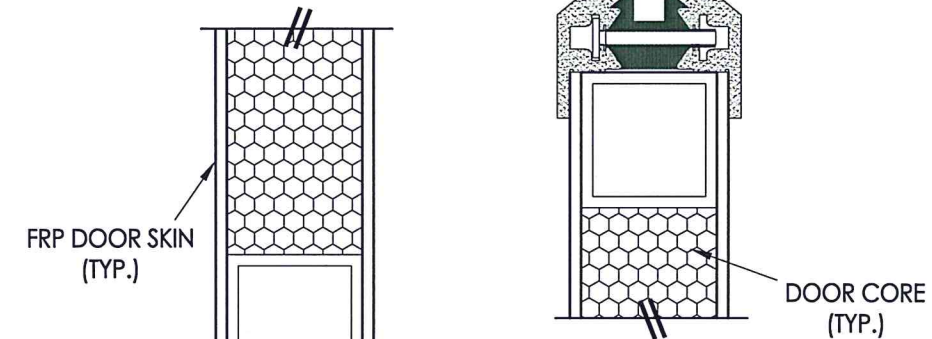

4
2 VERTICAL CROSS SECTION

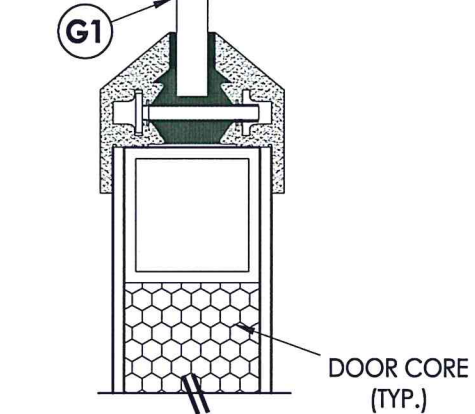

5
2 VERTICAL CROSS SECTION

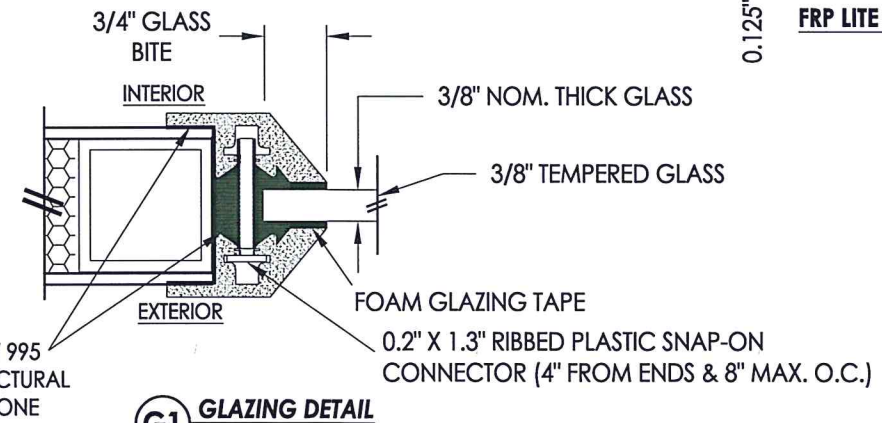
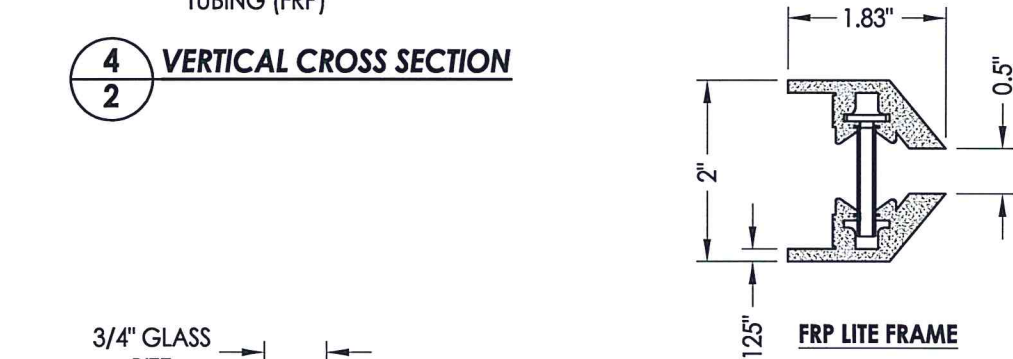

G1 GLAZING DETAIL



Documents Prepared By: Lyndon F. Schmidt, P.E.
TEXAS P.E. #104123

RW BUILDING CONSULTANTS, INC.
P.O. Box 230 Valrico FL 33595
Phone No.: 813.659.9197

CERTIFICATE OF REGISTRATION # F-11852

PRODUCT:	FIBERGLASS DOOR	
PART OR ASSEMBLY:	DOOR PANEL DETAILS	
NO.	DATE	BY
1	1/19/22	LFS
UPDATE TO 2018 IBC/IRC		
REVISIONS		
DATE:	5/14/18	
SCALE:	N.T.S.	
DWG. BY:	JK	
CHK. BY:	LFS	
DRAWING NO.:	TX-4836	
SHEET	2	OF 6

© 2018 R.W. BUILDING CONSULTANTS INC.

Z:\Clients\Senneca\B - Texas Dept of Ins\Chem-Pruf\DR 980 Chem-Pruf Fiberglass Door - Non-Impact\Drawings\TX-4834.35.36 REV.dwg

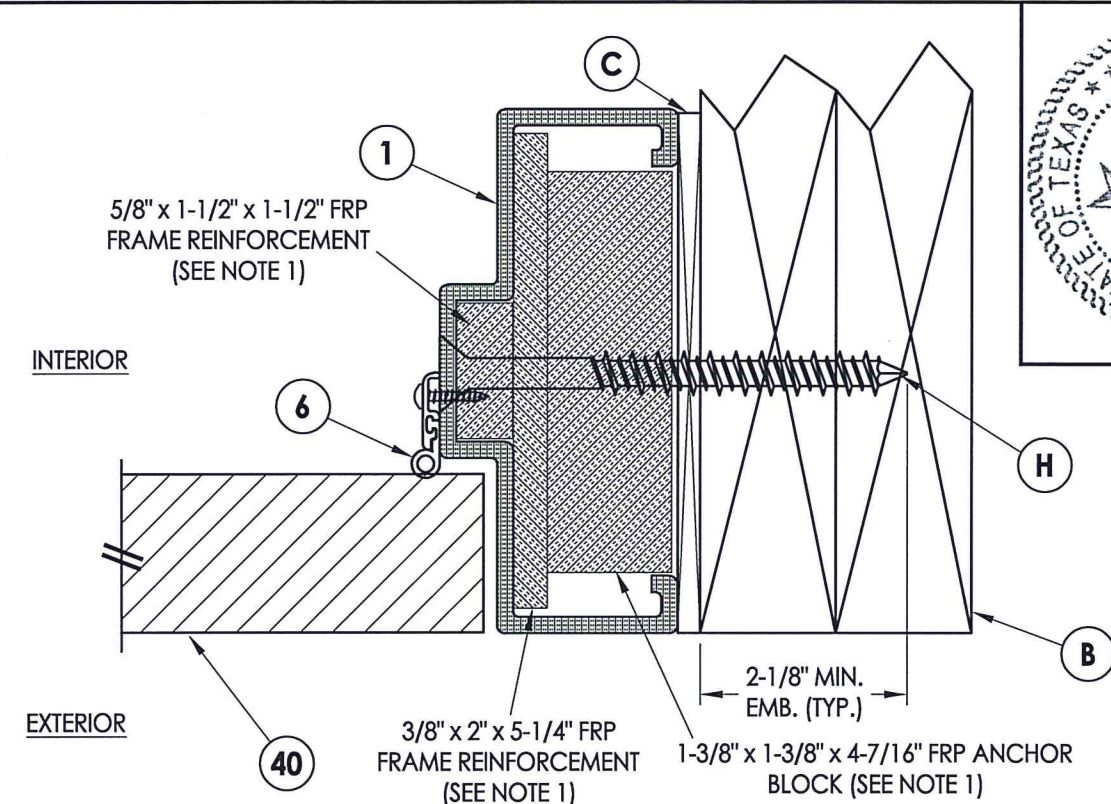
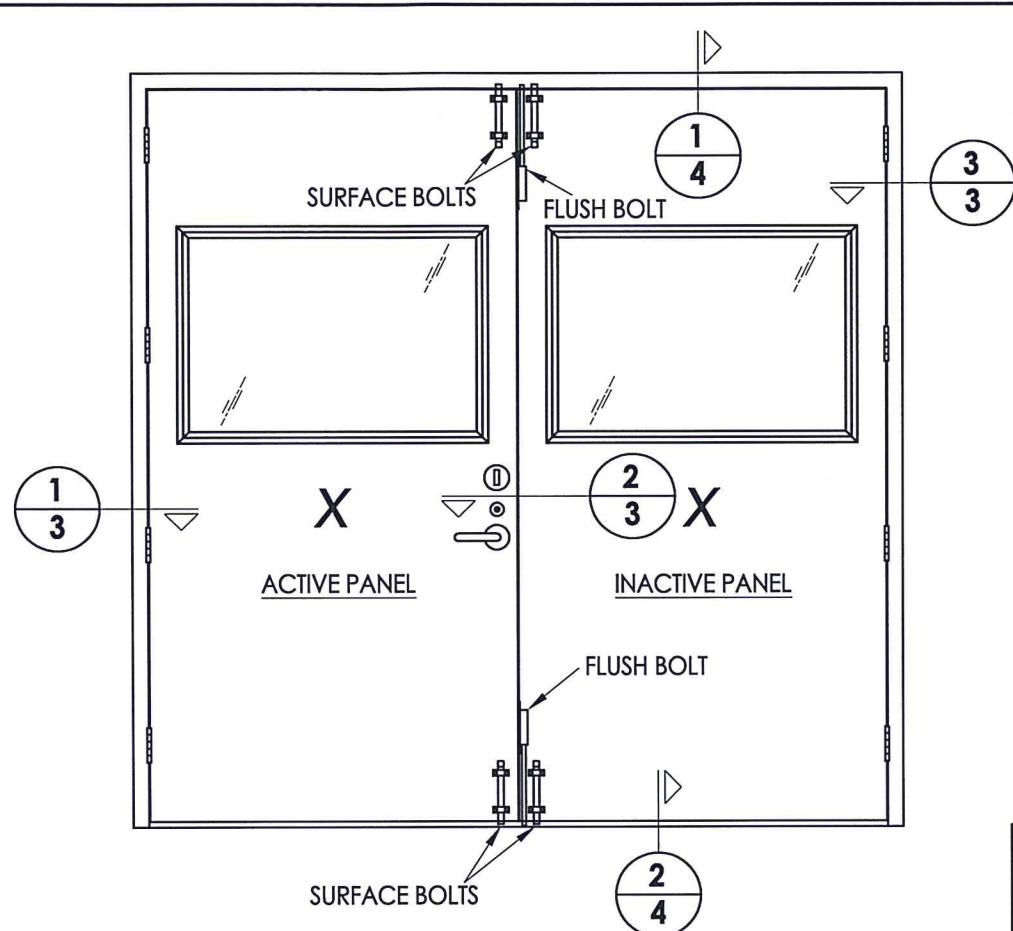

HARDWARE CHART	
MANUFACTURER	MODEL
SCHLAGE	MORTISE LOCK: L 9000 SERIES
SARGENT	DEADBOLT: 480 SERIES
ROCKWOOD	SURFACE BOLTS: 580-8
ROCKWOOD	FLUSH BOLTS: 556WS

3/3 HORIZONTAL CROSS SECTION
Outswing configuration

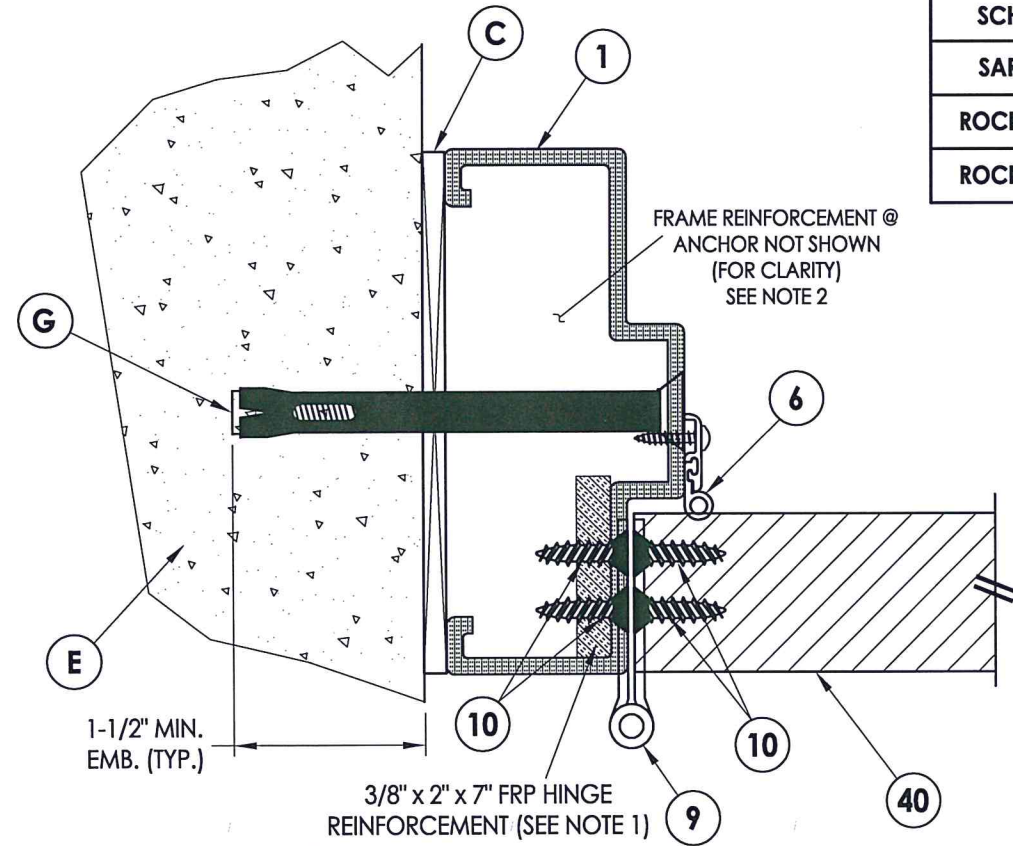

1/3 HORIZONTAL CROSS SECTION
Outswing configuration

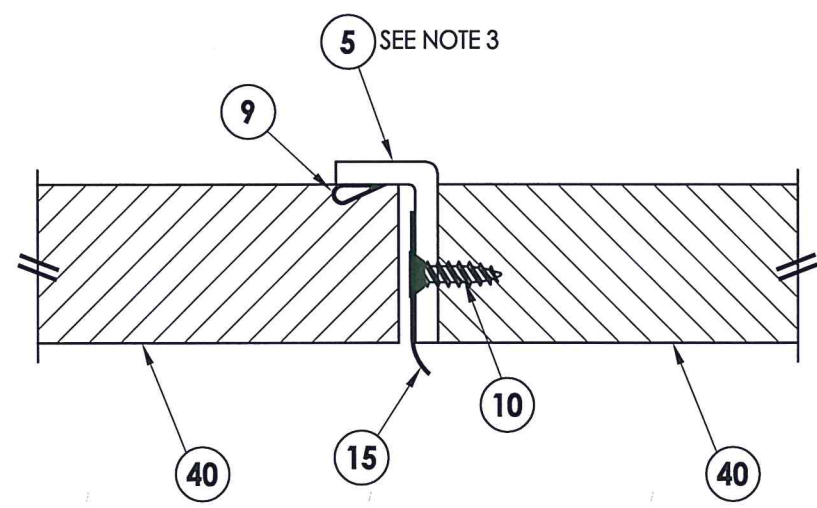

2/3 HORIZONTAL CROSS SECTION
Outswing configuration

- NOTES:
1. ALL FRP REINFORCEMENTS/ANCHOR BLOCKS ARE SECURED TO THE FRAME WITH LORD 7542A/B URETHANE ADHESIVE.
 2. FRAME REINFORCEMENTS SHOWN IN SECTION 3/3 ARE REQUIRED AT EACH ANCHOR LOCATION.
 3. FRP ASTRAGAL IS SECURED TO THE INACTIVE DOOR WITH LORD 7542/7545 URETHANE ADHESIVE.

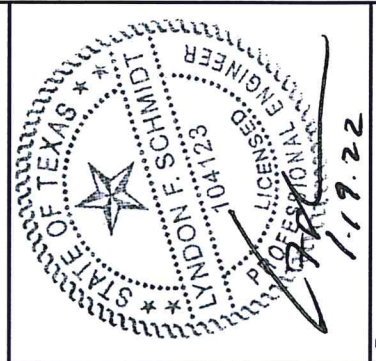

Documents Prepared By: Lyndon F. Schmidt, P.E.
TEXAS P.E. #104123

RW BUILDING CONSULTANTS, INC.
P.O. Box 230 Valrico FL 33595
Phone No.: 813.659.9197

CERTIFICATE OF REGISTRATION # F-11852

PRODUCT: FIBERGLASS DOOR
PART OR ASSEMBLY: HORIZONTAL CROSS SECTIONS

NO.	DATE	DESCRIPTION	BY
1	1/19/22	UPDATE TO 2018 IBC/IRC	LFS

DATE: 5/14/18
SCALE: N.T.S.
DWG. BY: JK
CHK. BY: LFS
DRAWING NO.: TX-4836
SHEET 3 OF 6

NOTES:
 1. ALL FRP REINFORCEMENTS/ANCHOR BLOCKS ARE SECURED TO THE FRAME WITH LORD 7542A/B URETHANE ADHESIVE.



Documents Prepared By: Lyndon F. Schmidt, P.E.
 TEXAS P.E. #104123

RW BUILDING CONSULTANTS, INC.
 P.O. Box 230 Valrico FL 33595
 Phone No.: 813.659.9197

CERTIFICATE OF REGISTRATION # F-11852

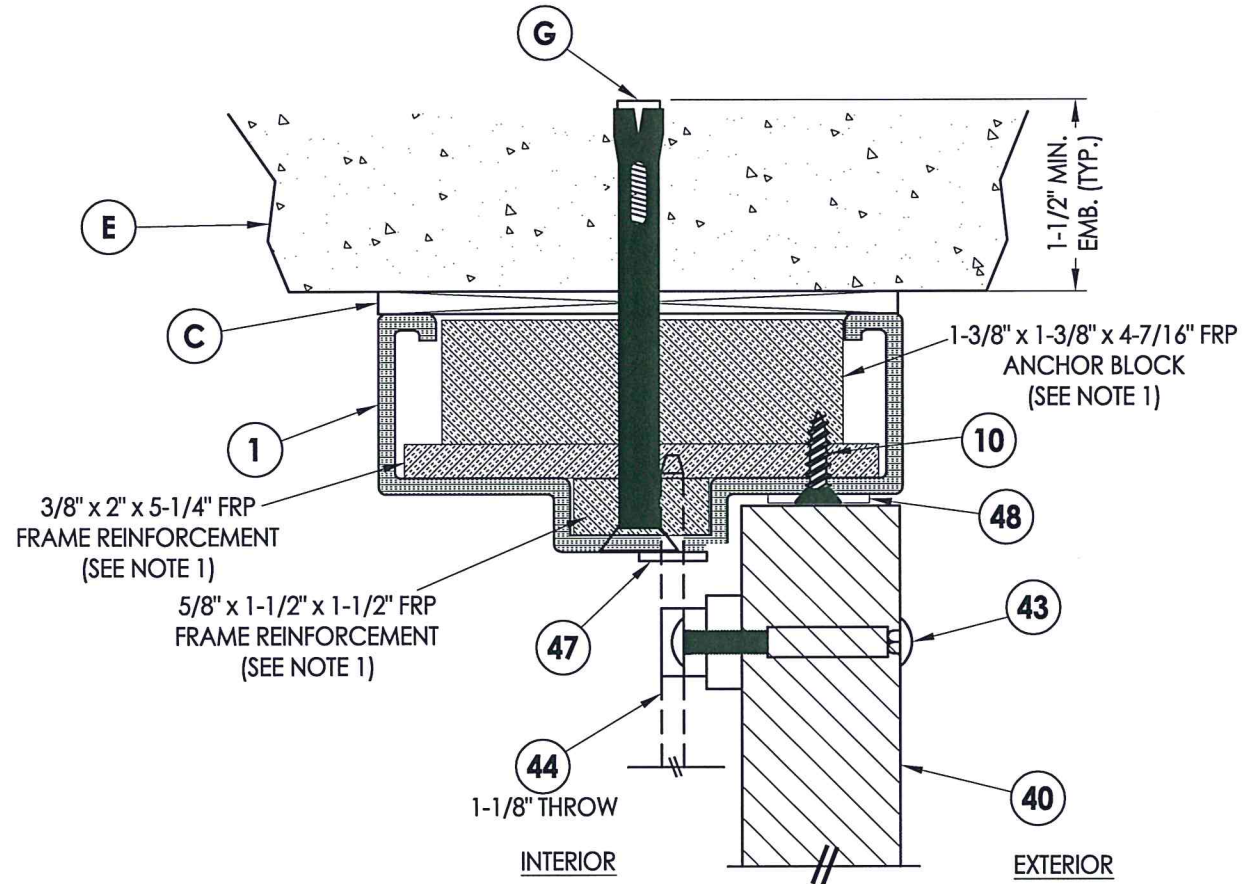

1 VERTICAL CROSS SECTION
4 Outswing configuration

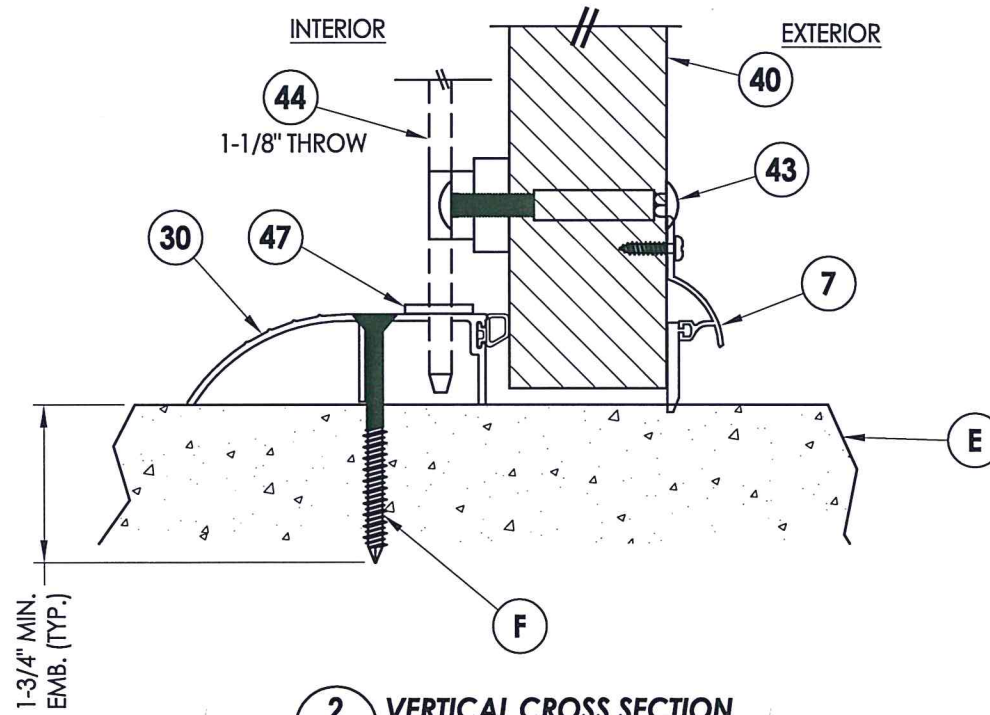

2 VERTICAL CROSS SECTION
4 Outswing Sill

PRODUCT:		FIBERGLASS DOOR	
PART OR ASSEMBLY:		HORIZONTAL CROSS SECTIONS	
NO.	DATE	BY	REVISIONS
1	1/19/22	LFS	UPDATE TO 2018 IBC/IRC
DATE: 5/14/18			
SCALE: N.T.S.			
DWG. BY: JK			
CHK. BY: LFS			
DRAWING NO.: TX-4836			
SHEET 4 OF 6			

Z:\Clients\Senneca\B - Texas Dept of Ins\Chem-Pruf\DR 980 Chem-Pruf Fiberglass Door - Non-Impact\Drawings\TX-4834.35.36 REV.dwg

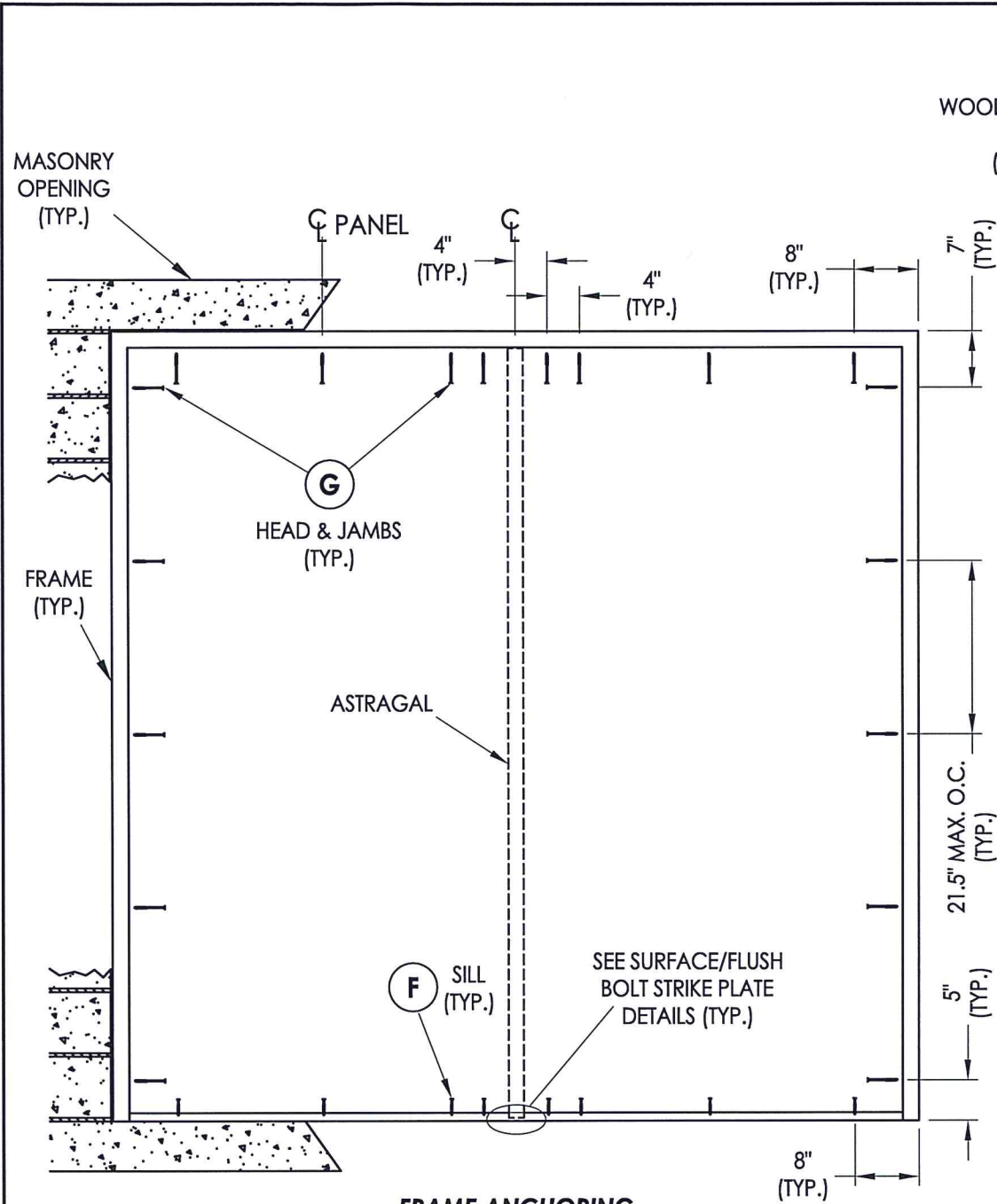

FRAME ANCHORING
Masonry Construction

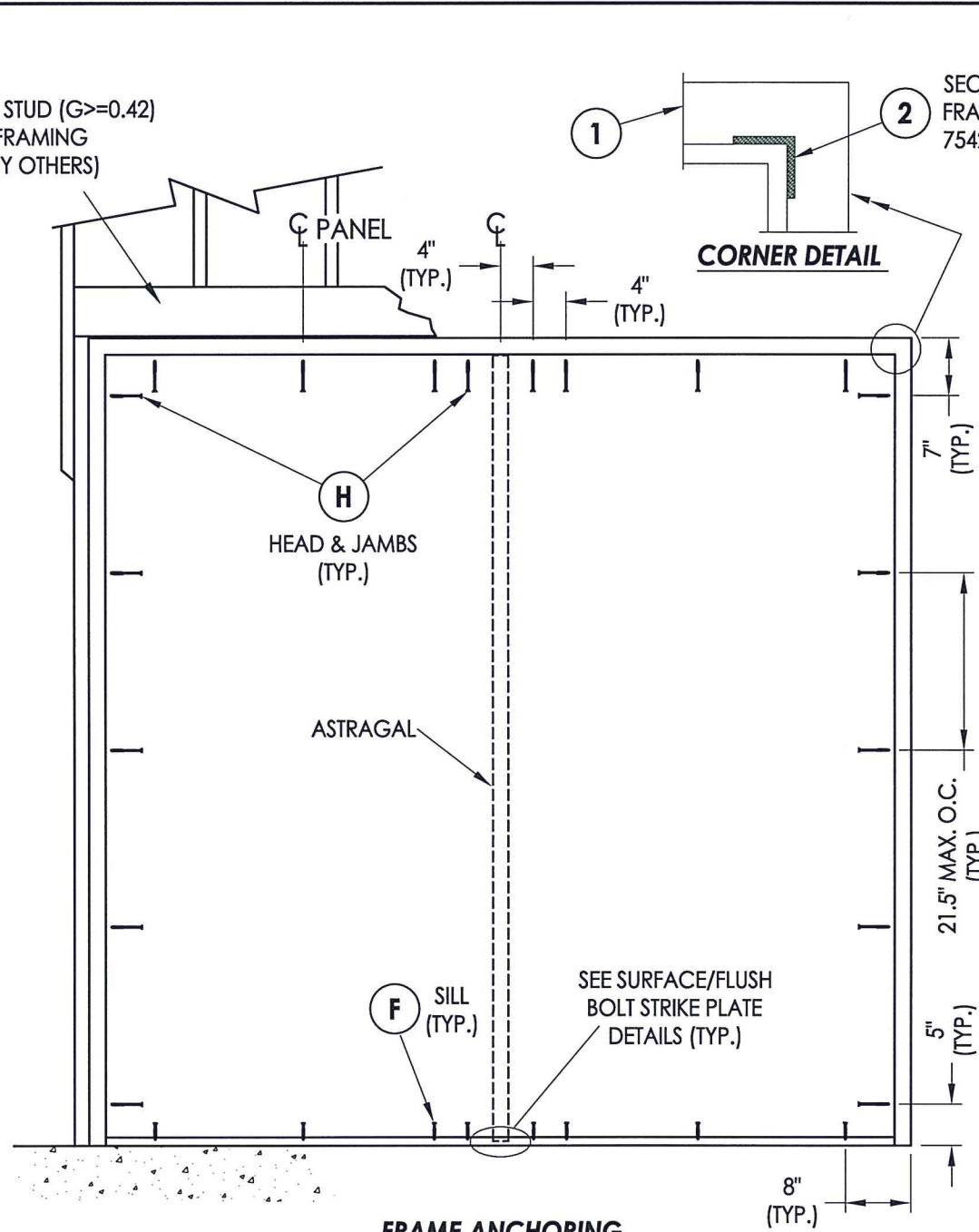

FRAME ANCHORING
Wood Stud

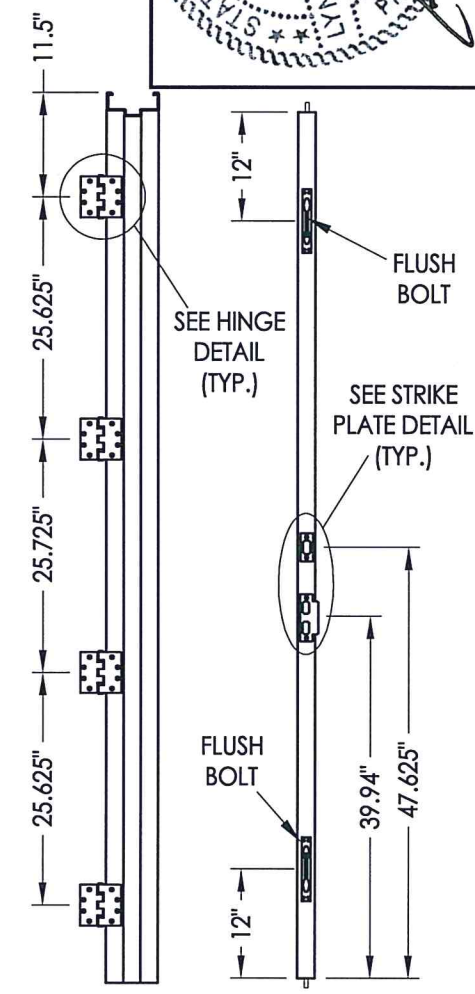
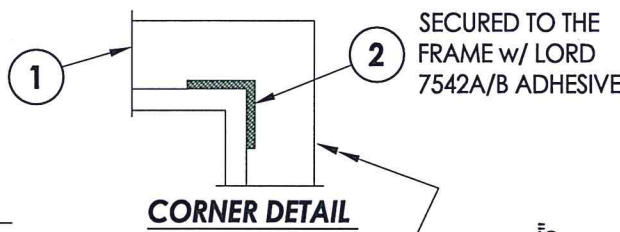

HINGE JAMB ASTRAGAL STRIKE

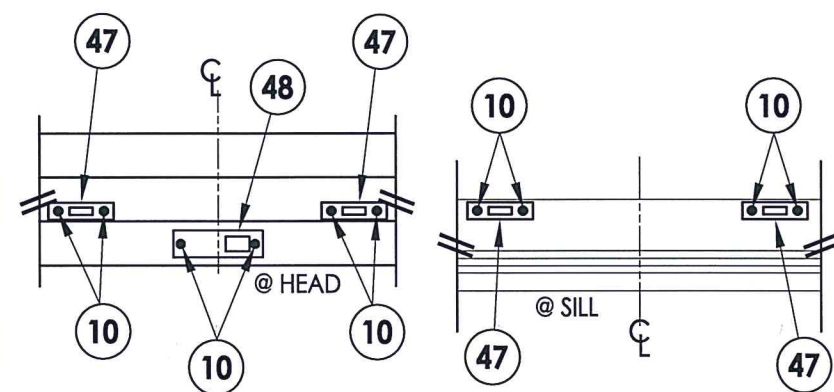

SURFACE/FLUSH BOLT STRIKE PLATE DETAILS

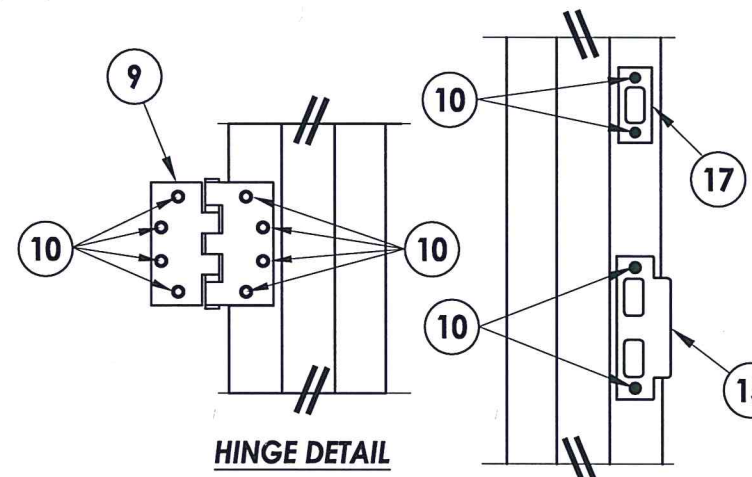

HINGE DETAIL

STRIKE PLATE DETAIL

CONCRETE ANCHOR NOTES:

- Concrete screw locations at the corners may be adjusted to maintain a minimum 1" edge distance to mortar joints. If concrete screw locations noted as "MAX. O.C." must be adjusted to maintain the minimum edge distance to mortar joints, additional concrete screws may be required to ensure the maximum on center dimension is not exceeded.
- Concrete anchor table:

ANCHOR TYPE	ANCHOR LOCATION	ANCHOR SIZE	MANUFACTURER	MIN. EDGE DISTANCE	MIN. EMBEDMENT
CONCRETE ANCHOR SCREW	SILL	1/4"	TAPCON® (ITW BUILDEX) ULTRACON+® (DeWALT)	2-1/2"	1-3/4"
CONCRETE SLEEVE ANCHOR	HEAD/JAMBS	3/8"	DYNABOLT SLEEVE ANCHOR® (ITW REDHEAD)	2-1/4"	1-1/2"



Documents Prepared By: Lyndon F. Schmidt, P.E.
TEXAS P.E. #104123

RW BUILDING CONSULTANTS, INC.
P.O. Box 230 Valrico FL 33595
Phone No.: 813.659.9197

CERTIFICATE OF REGISTRATION # F-11852

PRODUCT:	FIBERGLASS DOOR	
PART OR ASSEMBLY:	FRAME ANCHORING & HARDWARE DETAILS	
NO.	DATE	BY
1	1/19/22	LFS
UPDATE TO 2018 IBC/IRC		
DATE:	5/14/18	
SCALE:	N.T.S.	
DWG. BY:	JK	
CHK. BY:	LFS	
DRAWING NO.:	TX-4836	
SHEET	5	OF 6

Z:\Clients\Senneca\B - Texas Dept of Ins\Chem-Pruf\DR 980 Chem-Pruf Fiberglass Door - Non-Impact\Drawings\TX-4834.35.36 REV.dwg

BILL OF MATERIALS		
ITEM #	DESCRIPTION	MATERIAL
C	1/4" MAX. SHIM SPACE	-
E	MASONRY - 3,000 PSI MIN. CONCRETE CONFORMING TO ACI 301 OR HOLLOW BLOCK (GROUT FILLED) CONFORMING TO ASTM C90	CONCRETE
F	1/4" x 2-3/4" PFH DeWALT OR ITW CONCRETE SCREW	STEEL
G	3/8"Ø DYNABOLT SLEEVE ANCHOR	STEEL
H	3/8"Ø x 5" LAG SCREW	STEEL
1	DOOR FRAME (FRP)	FIBERGLASS
2	FRAME CORNER REINFORCEMENT (FRP)	FIBERGLASS
3	REMOVABLE MULLION (FRP)	FIBERGLASS
5	ASTRAGAL	FIBERGLASS
6	WEATHERSTRIP	NEOPRENE
7	DOOR SWEEP	VINYL
8	WEATHERSTRIP (NGP 5050 GASKET)	NEOPRENE
9	4-1/2" X 4-1/2" BUTT HINGE	SS
10	#12 X 1" PFH SMS	SS
15	MORTISE LATCH & DEADBOLT STRIKE PLATE	SS
16	LATCH STRIKE PLATE	SS
17	DEADBOLT STRIKE PLATE	STEEL
30	OUTSWING THRESHOLD	ALUM
40	DOOR PANEL - SEE DOOR PANEL DETAIL SHEET FOR CONSTRUCTION DETAILS	-
43	8-32 X 1" MACHINE SCREW w/ 1-3/4" SEX BOLT	STEEL
44	SURFACE BOLT - ROCKWOOD 580-8	SS
47	SURFACE BOLT STRIKE PLATE	SS
48	FLUSH BOLT STRIKE PLATE	SS

FIBER REINFORCED PLASTIC (FRP)

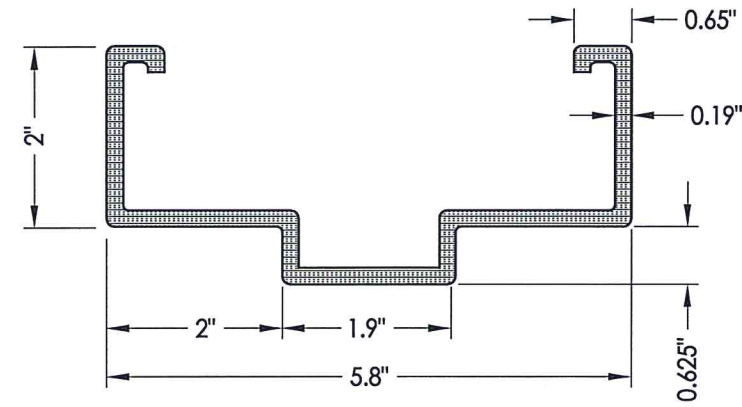

1 DOOR FRAME (FRP)

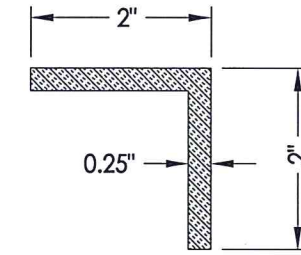

2 FRAME CORNER REINFORCEMENT
5" LONG

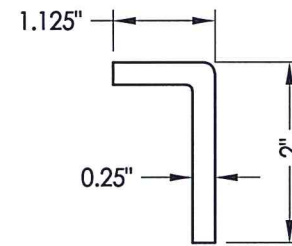

3 ASTRAGAL (FRP)

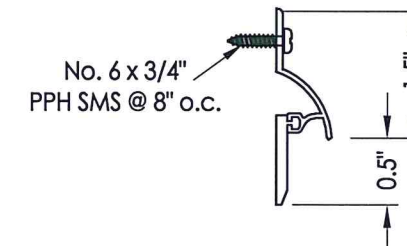

7 DOOR SWEEP
NGP 101 VA

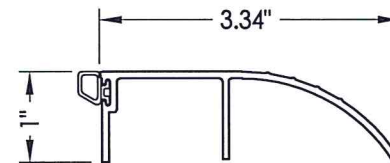

30 OUTSWING THRESHOLD
Pemko 2051-T

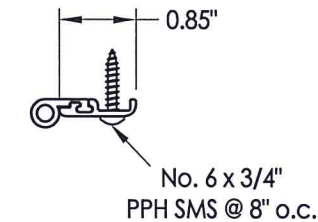

6 WEATHERSTRIP
NGP 137N

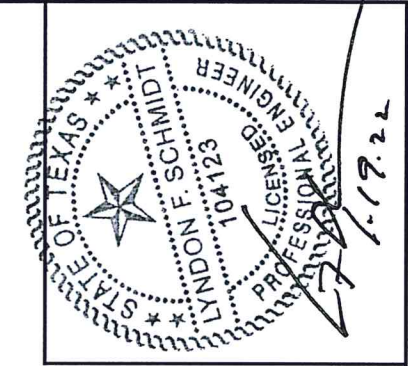

Documents Prepared By: Lyndon F. Schmidt, P.E.
TEXAS P.E. #104123

RW BUILDING CONSULTANTS, INC.
P.O. Box 230 Vairico FL 33595
Phone No.: 813.659.9197

CERTIFICATE OF REGISTRATION # F-11852

PRODUCT:	FIBERGLASS DOOR	
PART OR ASSEMBLY:	BILL OF MATERIALS & COMPONENTS	
NO.	DATE	REVISIONS
1	1/19/22	UPDATE TO 2018 IBC/IRC
LFS	BY	
DATE: 05/14/18		
SCALE: N.T.S.		
DWG. BY: JK		
CHK. BY: LFS		
DRAWING NO.: TX-4836		
SHEET 6 OF 6		