



# Glazed Fiberglass Single Door w/ Sidelites

CONTINUOUS HEAD & SILL FRAME SYSTEM  
INSWING / OUTSWING  
"NON-IMPACT"

### EVALUATED FOR USE IN THE STATE OF TEXAS

The Glazed Fiberglass Door system described herein complies with the 2018 International Residential Code (IRC), Sections R301 & R609 and the 2018 International Building Code (IBC), Sections 1404.13, 1609, 1709.5, 2403 and 2404 subject to the following conditions:

1. Anchors shall be as listed and spaced as shown in the details. Anchor embedment to base material shall be beyond wall dressing or stucco.
2. When used in areas requiring wind-borne debris protection this product is required to be protected with an impact resistant covering that complies with Section R301.2.1.2 of the IRC and Section 1609.2 of the IBC.
3. Allowable design pressure requirements must be equal to or less than the design pressure rating shown in the design pressure chart, sheet 1 of this drawing.
4. Conditions not covered by this drawing are subject to further engineering analysis.

TABLE OF CONTENTS	
SHEET #	DESCRIPTION
1	Typical elevations, design pressures & general notes
2	Door panel details
3	Slidelite panel details
4	Horizontal cross sections
5	Vertical cross sections
6	Vertical cross sections
7	Frame anchoring

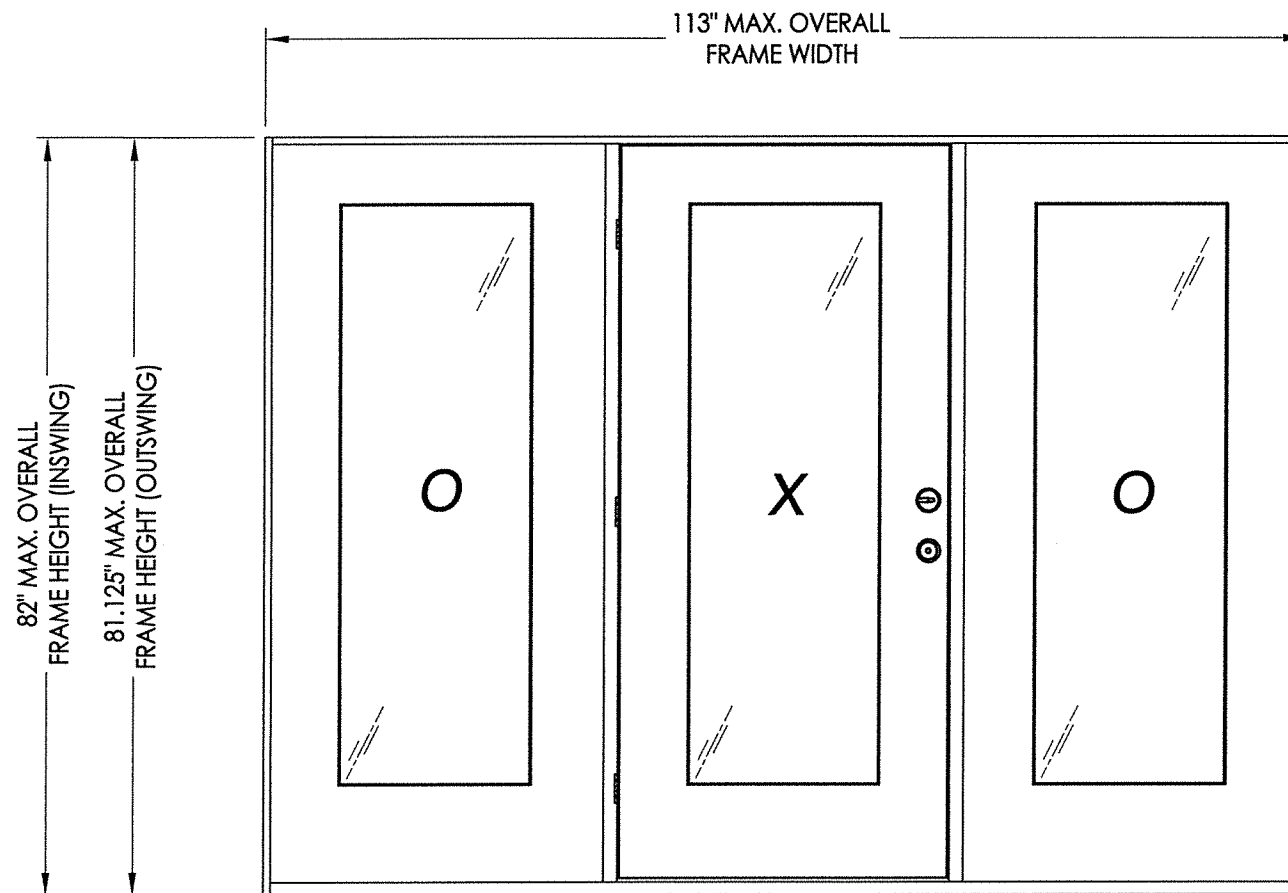

MODEL	DESIGN PRESSURE (PSF) w/ PINE FRAME & FATBOY PINE MULLIONS		DESIGN PRESSURE (PSF) w/ "FusionFrame" FRAME & MULLIONS	
	POSITIVE	NEGATIVE	POSITIVE	NEGATIVE
<b>INSWING</b>	<b>+50.0</b>	<b>-55.0</b>	<b>+50.0</b>	<b>-50.0</b>
<b>OUTSWING</b>	<b>+60.0</b>	<b>-60.0</b>	<b>+50.0</b>	<b>-50.0</b>

SEE SHEET 6 FOR THRESHOLD DESIGN PRESSURE LIMITATIONS

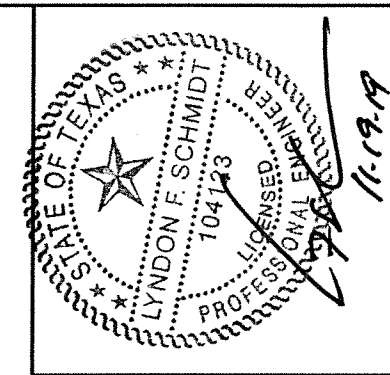

Documents Prepared By: Lyndon F. Schmidt, P.E.  
TEXAS P.E. #104123

**RW** BUILDING CONSULTANTS, INC.  
P.O. Box 230 Vairico FL 33595  
Phone No.: 813.659.9197  
TEXAS BOARD OF PROFESSIONAL ENGINEERS  
CERTIFICATE OF REGISTRATION # F-11852

PRODUCT: ENDURA  
PART OR ASSEMBLY: TYPICAL ELEVATION, DESIGN PRESSURES & GENERAL NOTES

NO.	DATE	REVISIONS
1	11/19/19	ADD "FusionFrame" OPTION & UPDATE TO 2018 IBC/IRC CODE

DATE: 12/07/17

SCALE: N.T.S.

DWG. BY: JK

CHK. BY: LFS

DRAWING NO.:

TX-4759

SHEET 1 OF 7

R:\Clients\Endura PERMANENT\B - Texas Dept of Ins\TDI - DR-954 Glazed Thermo-Tru FG door OXO (LK, DB) 36 in SL(4759-4760)\C - Drawings\TX-4759.4760.dwg, 2.3

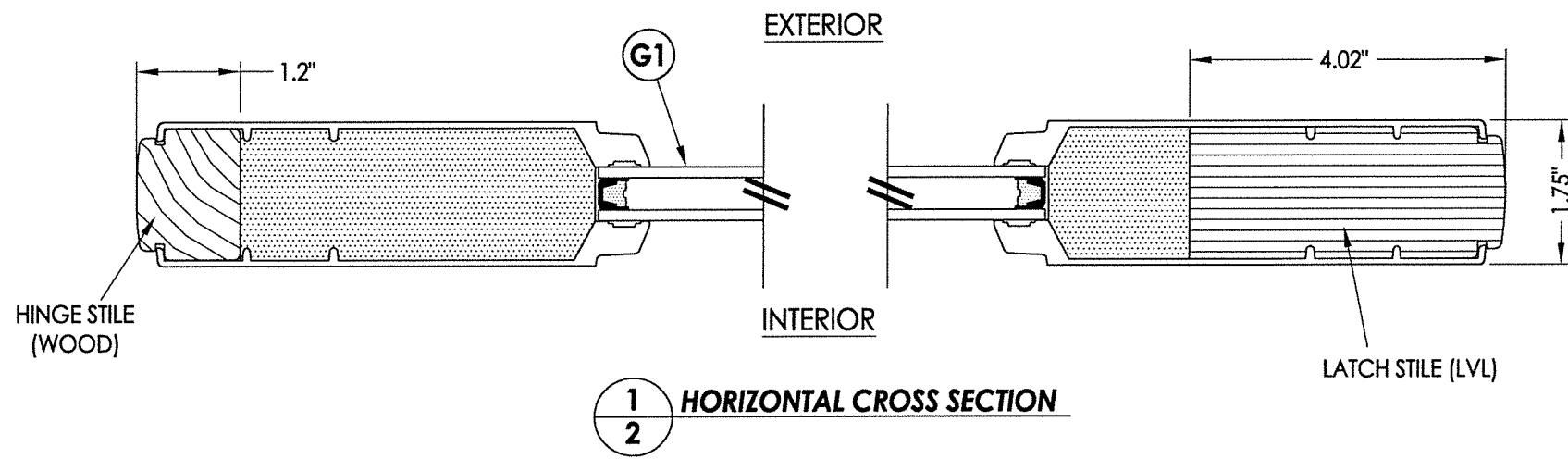

**1**  
**2** HORIZONTAL CROSS SECTION

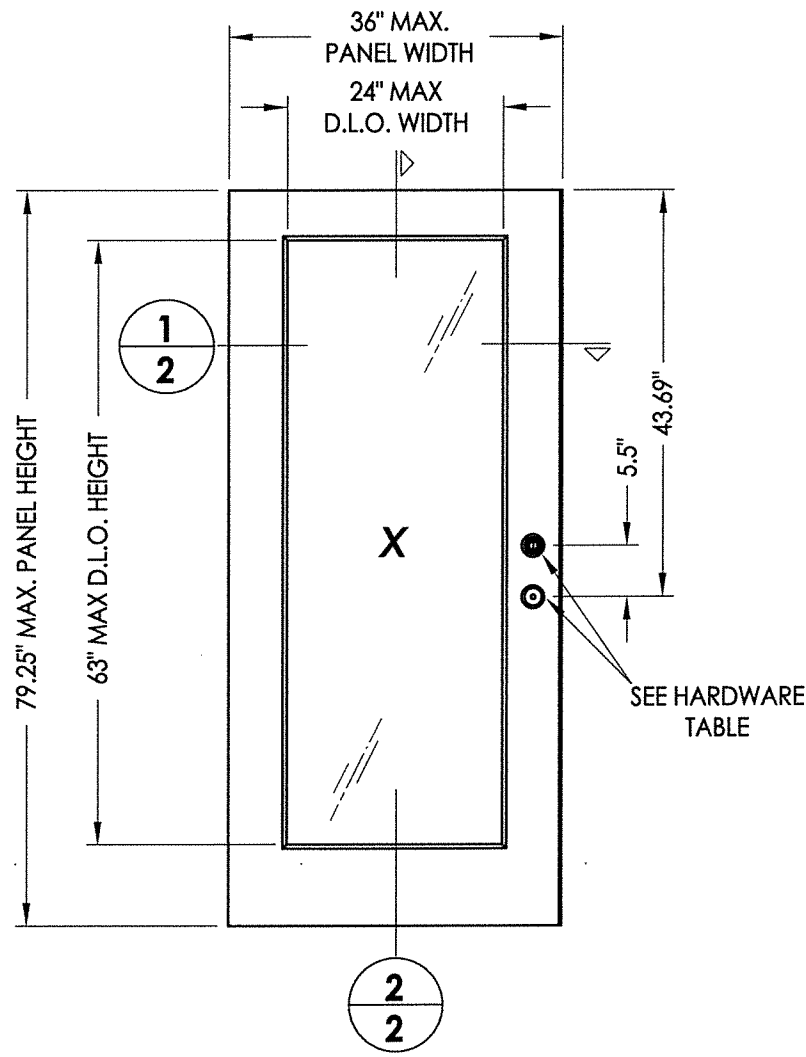

THERMA TRU - Flush Glazed  
Door Panel  
(fiberglass)

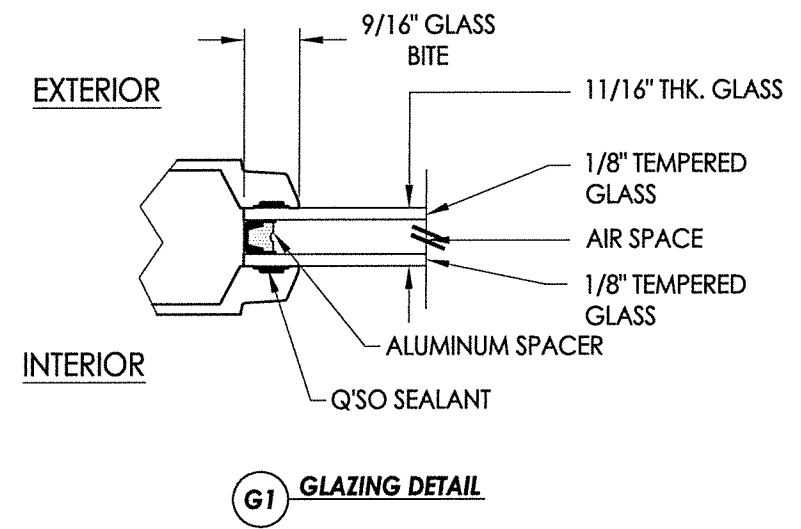

**G1** GLAZING DETAIL

DOOR LOCK HARDWARE TABLE	
MANUFACTURER	MODEL
KWIKSET	KNOB: SIGNATURE SERIES DEADBOLT: SIGNATURE SERIES (980)

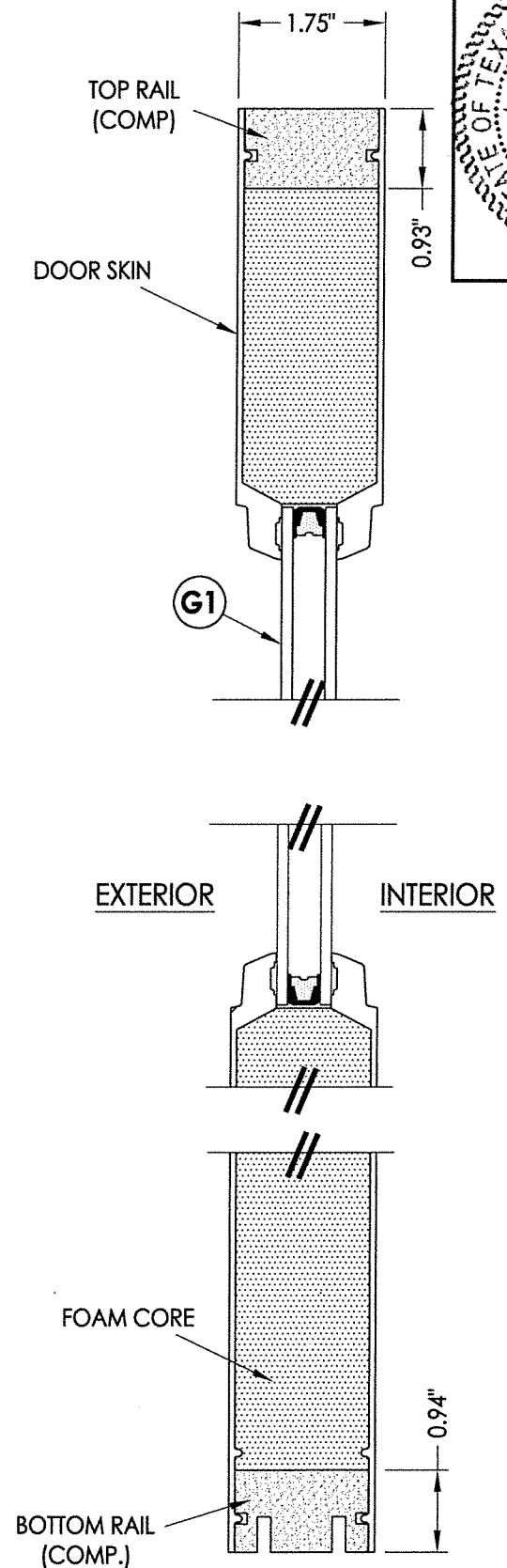

**2**  
**2** VERTICAL CROSS SECTION

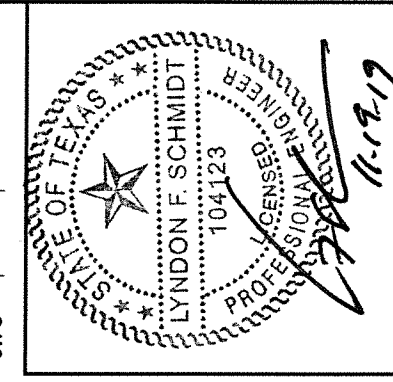

Documents Prepared By: Lyndon F. Schmidt, P.E.  
TEXAS P.E. #104123

**RW** BUILDING CONSULTANTS, INC.  
P.O. Box 230 Valrico FL, 33595  
Phone No.: 813.659.9197

TEXAS BOARD OF PROFESSIONAL ENGINEERS  
CERTIFICATE OF REGISTRATION # F-11852

PRODUCT: ENDURA  
PART OR ASSEMBLY: DOOR PANEL DETAILS & GLAZING DETAIL

NO.	DATE	BY	REVISIONS
1	11/19/19	LFS	ADD "FusionFrame" OPTION & UPDATE TO 2018 IBC/IRC CODE

DATE: 12/07/17  
SCALE: N.T.S.  
DWG. BY: JK  
CHK. BY: LFS  
DRAWING NO.: TX-4759  
SHEET 2 OF 7

R:\Clients\Endura PERMANENT\B - Texas Dept of Ins\TDI - DR-954 Glazed Thermo-Tru FG door OXO (LK, DB) 36 in SL(4759-4760)\C - Drawings\TX-4759-4760.dwg, 3.3

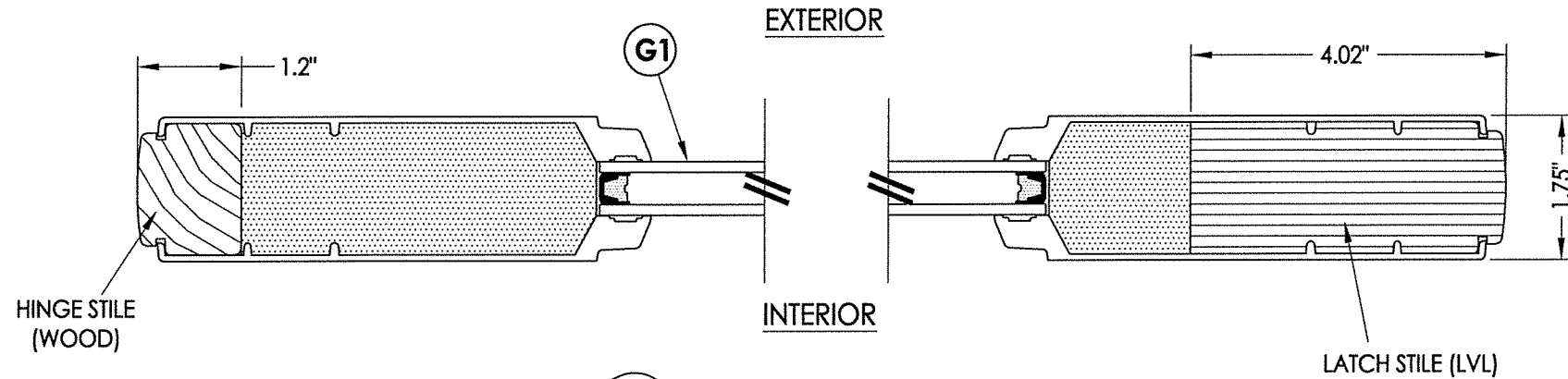

**1**  
**3** **HORIZONTAL CROSS SECTION**

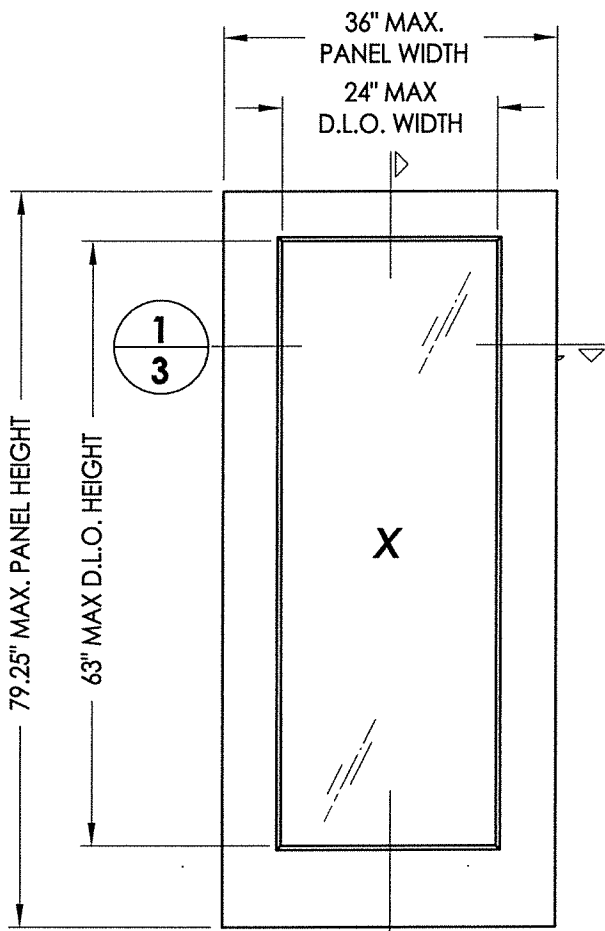

**2**  
**3** **THERMA TRU - Flush Glazed Sidelite Panel (fiberglass)**

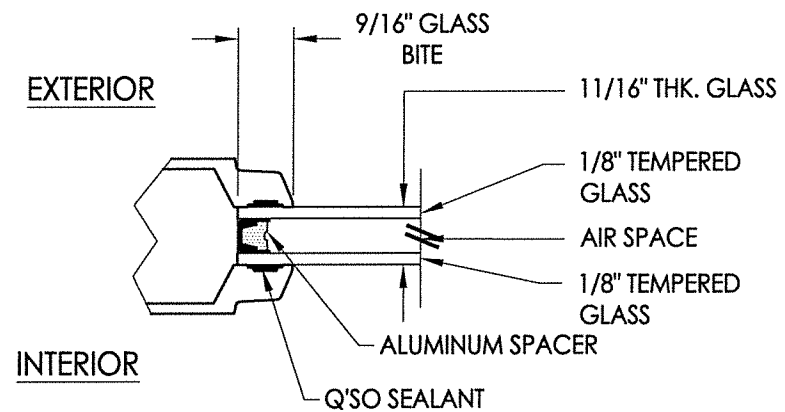

**G1** **GLAZING DETAIL**

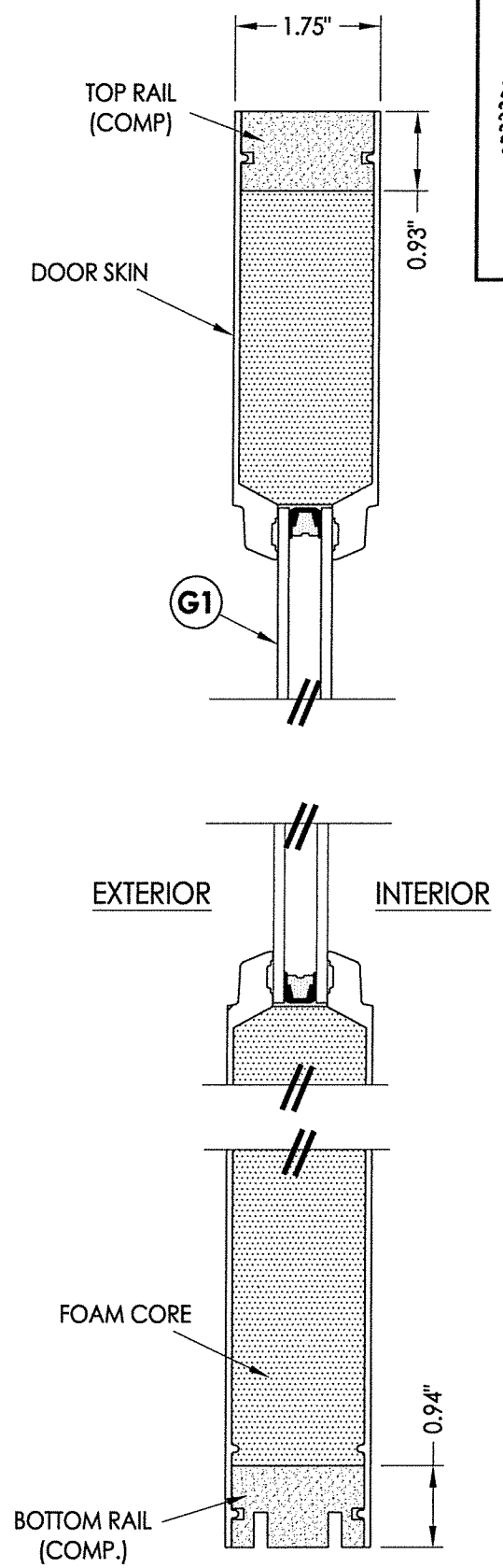

**2**  
**3** **VERTICAL CROSS SECTION**

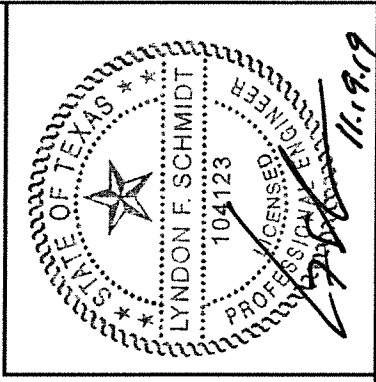

Documents Prepared By: Lyndon F. Schmidt, P.E.  
TEXAS P.E. #104123

**RW** BUILDING CONSULTANTS, INC.  
P.O. Box 230 Valrico FL, 33595  
Phone No.: 813.659.9197  
TEXAS BOARD OF PROFESSIONAL ENGINEERS  
CERTIFICATE OF REGISTRATION # F-11852

PRODUCT:	ENDURA
PART OR ASSEMBLY:	SIDELITE PANEL DETAILS (LIP LITE INSERT GLAZING)

NO.	DATE	BY	REVISIONS
1	11/19/19	LFS	ADD "FusionFrame" OPTION & UPDATE TO 2018 IBC/IRC CODE

DATE:	12/07/17
SCALE:	N.T.S.
DWG. BY:	JK
CHK. BY:	LFS
DRAWING NO.:	TX-4759
SHEET	3 OF 7

SIDELITE SKIN: FIBERGLASS (0.075" MIN. THICKNESS)  
CORE MATERIAL: POLYURETHANE FOAM (1.9 PCF MIN.)

R:\Clients\Endura PERMANENT\B - Texas Dept of Ins\TDI - DR-954 Glazed Thermo-Tru FG door OXO (L, DB) 36 in SL(4759-4760)\C - Drawings\TX-4759.4760.dwg, 4.3

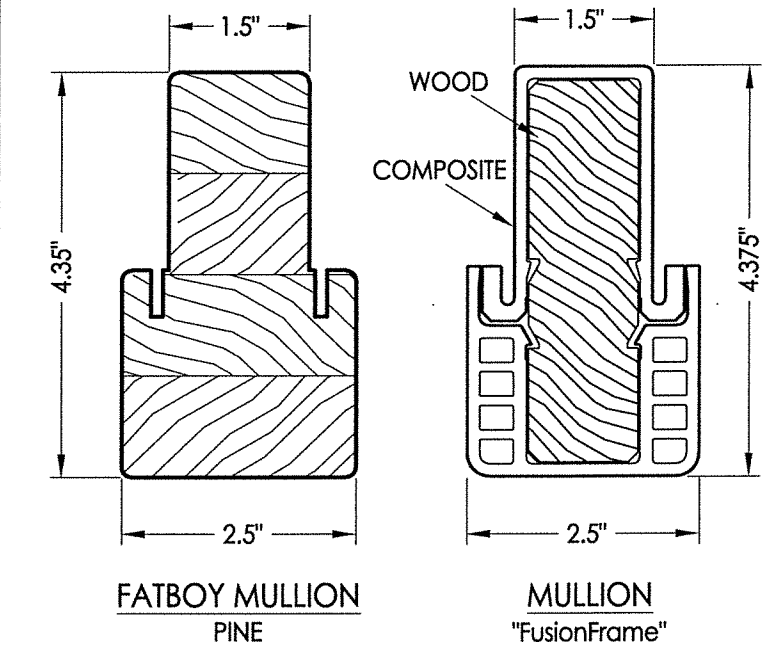
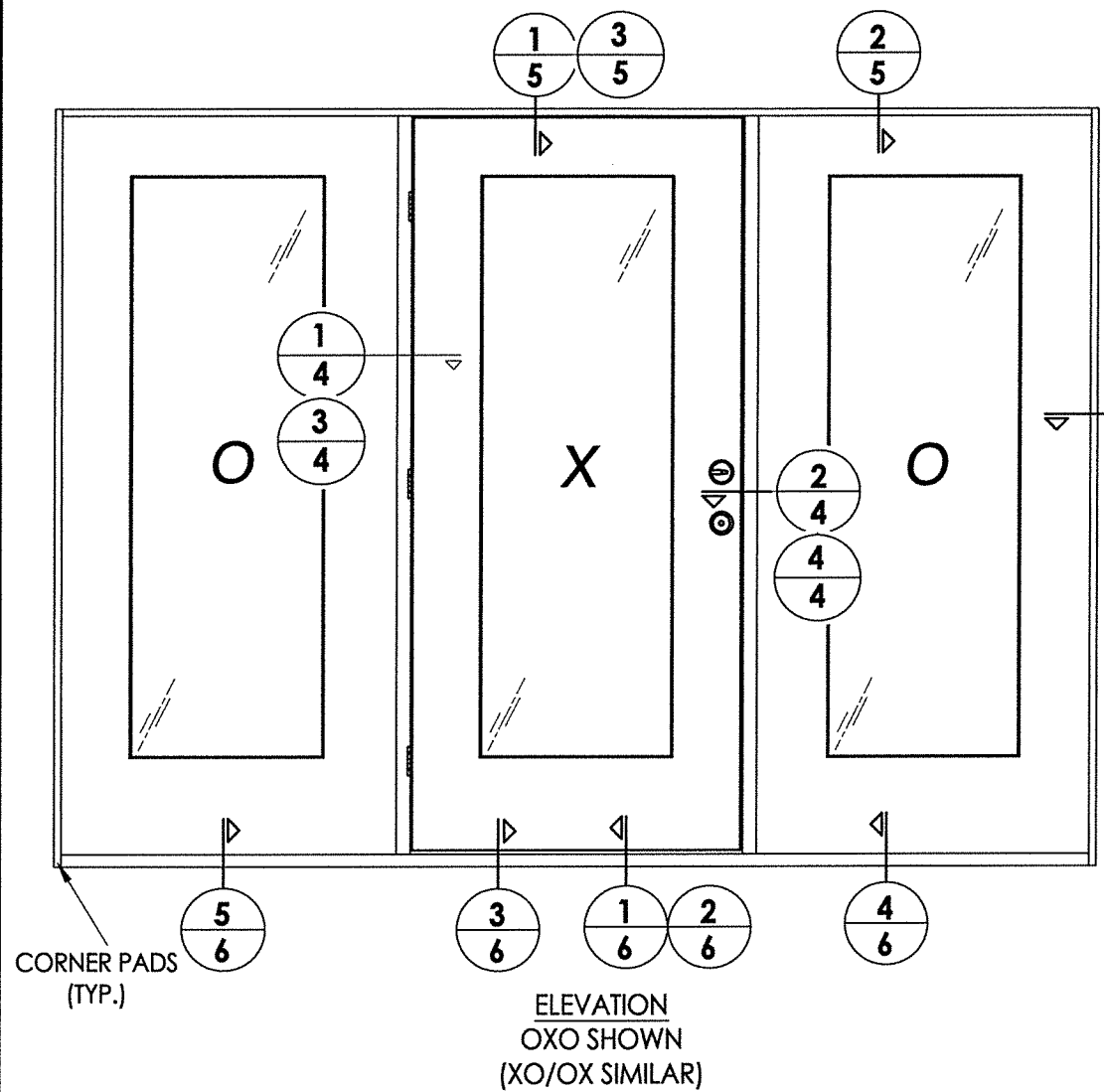

**NOTES:**  
 1. Spacing for sidelite screws: 6.5", 38.5" and 69" from head to sill (3 total).  
 2. Spacing for mullion screws: 6" from each end plus 3 more equally spaced (5 total).

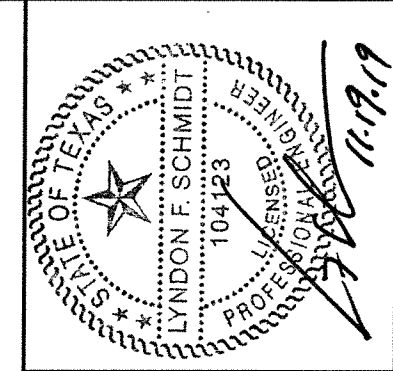
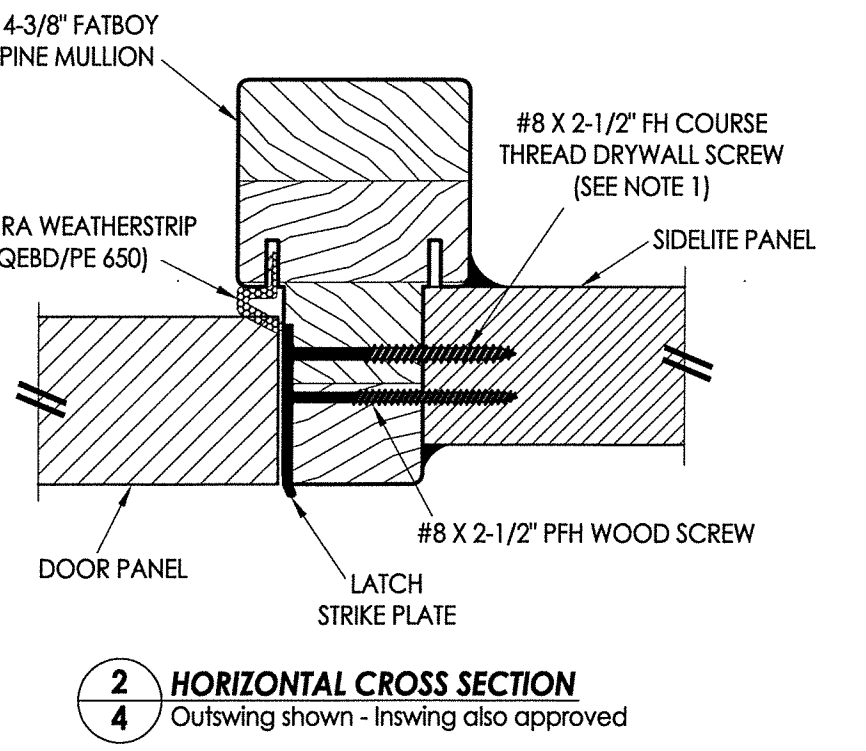
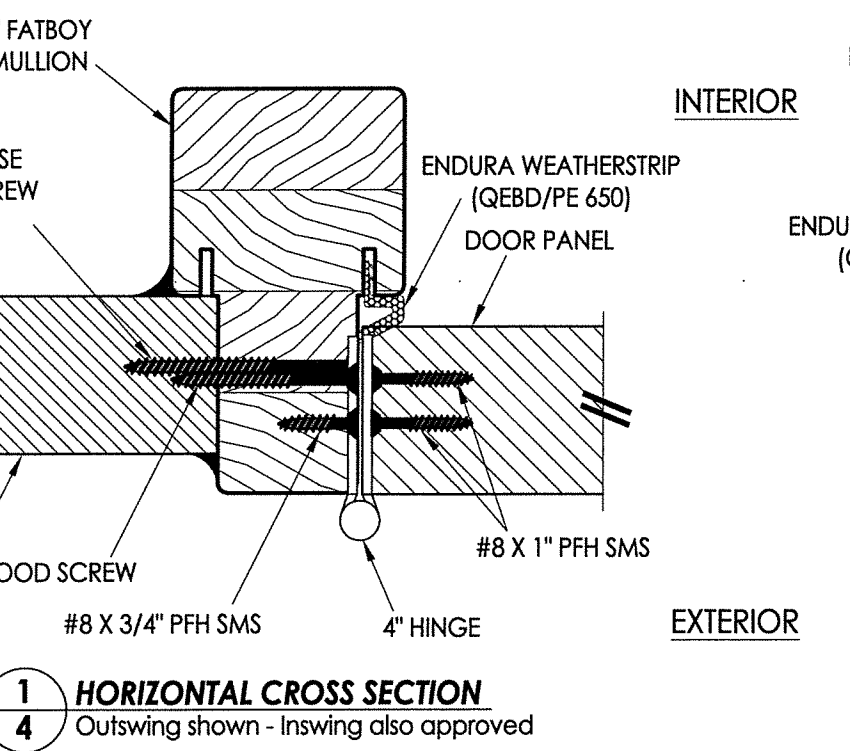
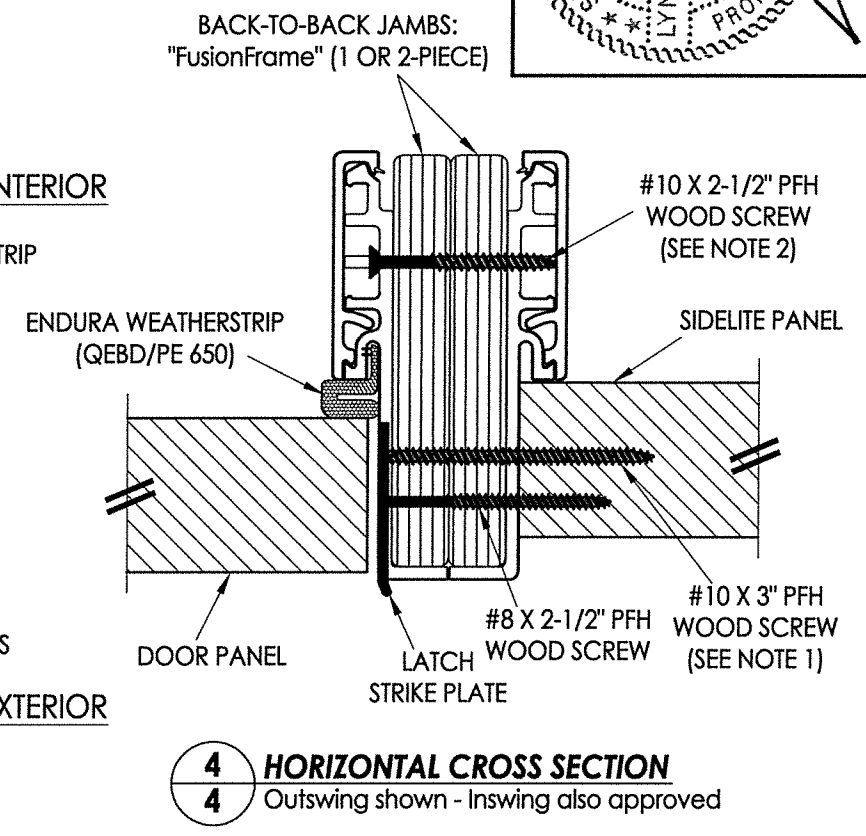
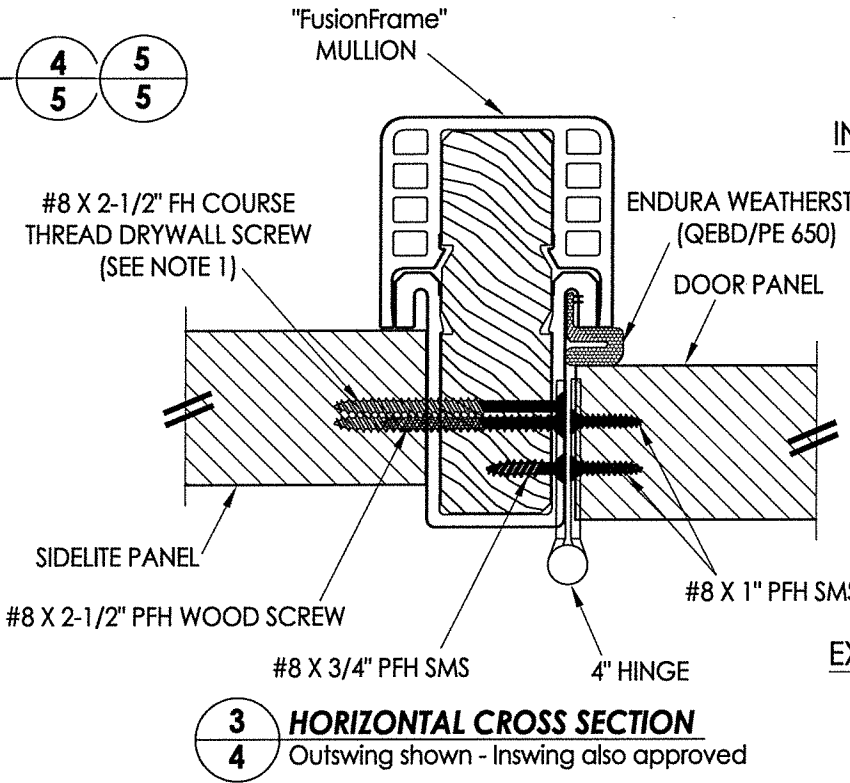

Documents Prepared By: Lyndon F. Schmidt, P.E.  
 TEXAS P.E. #104123

**RW** BUILDING CONSULTANTS, INC.  
 P.O. Box 230 Valrico FL, 33595  
 Phone No.: 813.659.9197

TEXAS BOARD OF PROFESSIONAL ENGINEERS  
 CERTIFICATE OF REGISTRATION # F-11852

PRODUCT:	ENDURA
PART OR ASSEMBLY:	FIBERGLASS DOOR
BY:	LFS
DATE:	11/19/19
REVISIONS:	UPDATE TO 2018 IBC/IRC CODE

NO.	DATE	BY
1	11/19/19	LFS

DATE:	12/07/17
SCALE:	N.T.S.
DWG. BY:	JK
CHK. BY:	LFS
DRAWING NO.:	TX-4759
SHEET	4 OF 7

© 2017 R.W. BUILDING CONSULTANTS INC.

R:\Clients\Endura PERMANENT\B - Texas Dept of Ins\TDI - DR-954 Glazed Thermo-Tru FG door OXO (LK, DB) 36 in SL(4759-4760)\C - Drawings\TX-4759.4760.dwg, 5.3

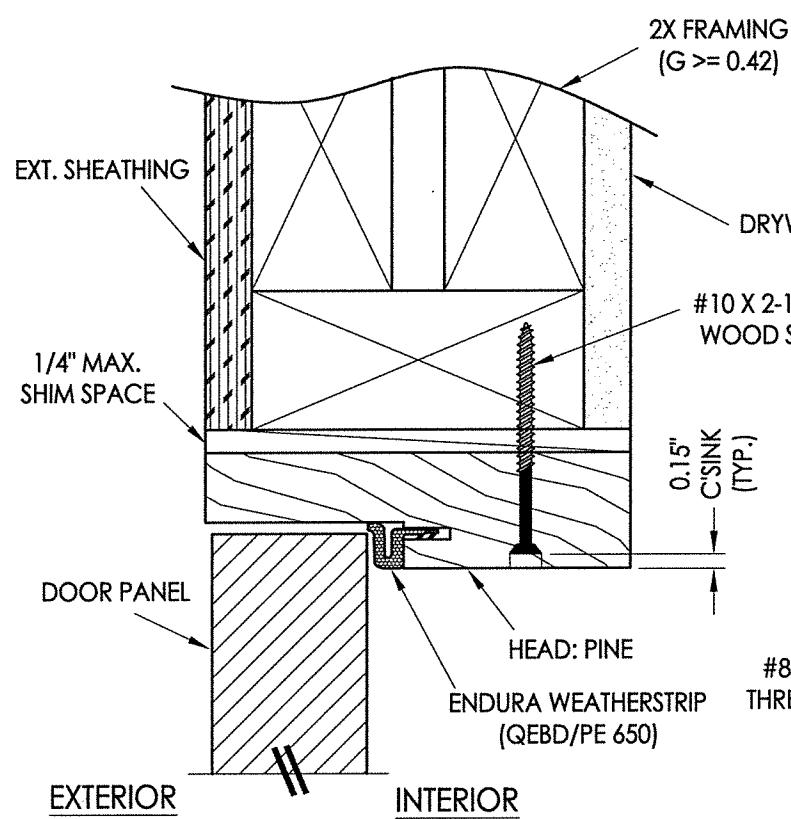

**1 VERTICAL CROSS SECTION**  
**5** Outswing shown - inswing also approved

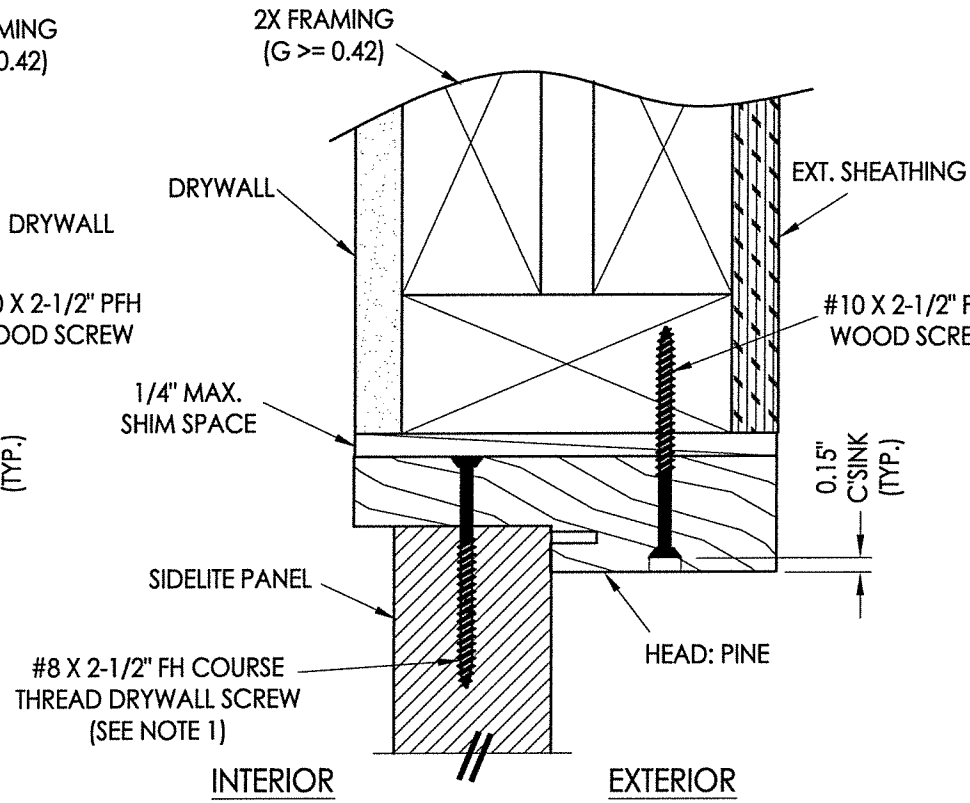

**2 VERTICAL CROSS SECTION**  
**5** Inswing shown - Outswing also approved

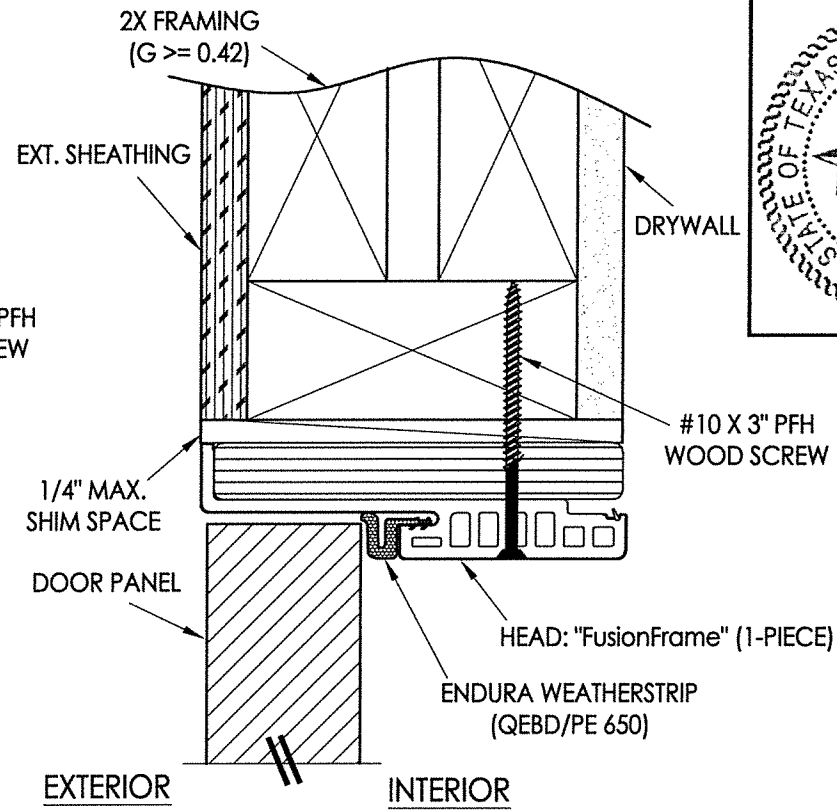

**3 VERTICAL CROSS SECTION**  
**5** Outswing shown - inswing also approved

**NOTE:**  
 1. Spacing for sidelite screws: 6" from each end (2 total).

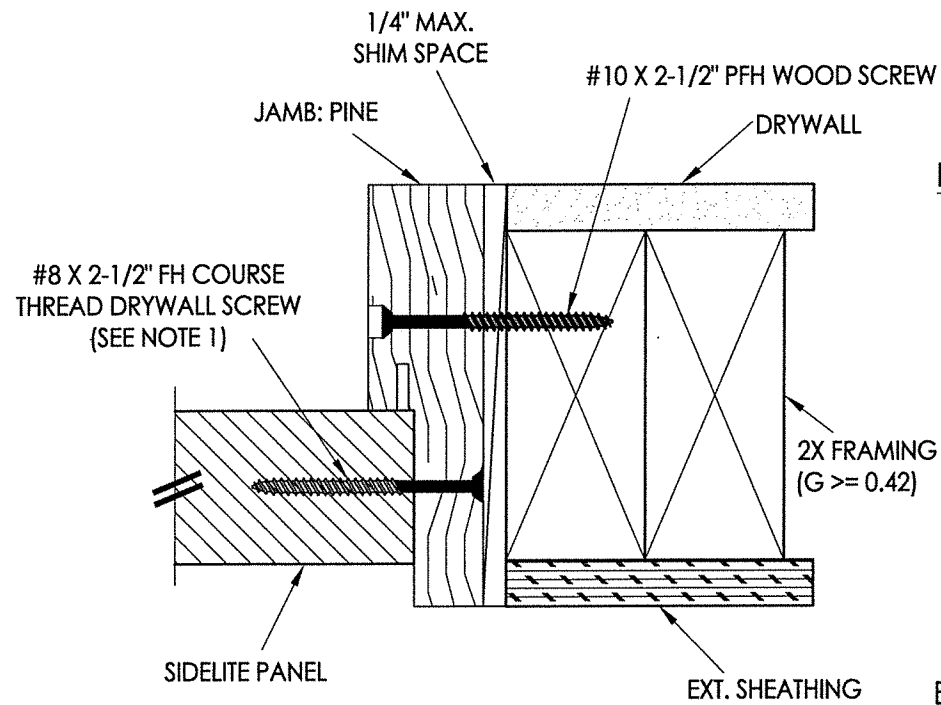
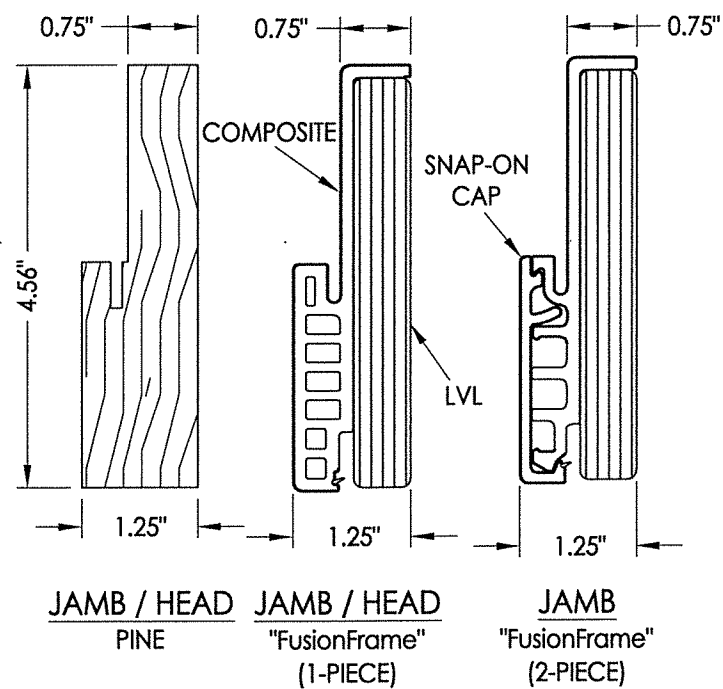

**4 HORIZONTAL CROSS SECTION**  
**5** Outswing shown - Inswing also approved

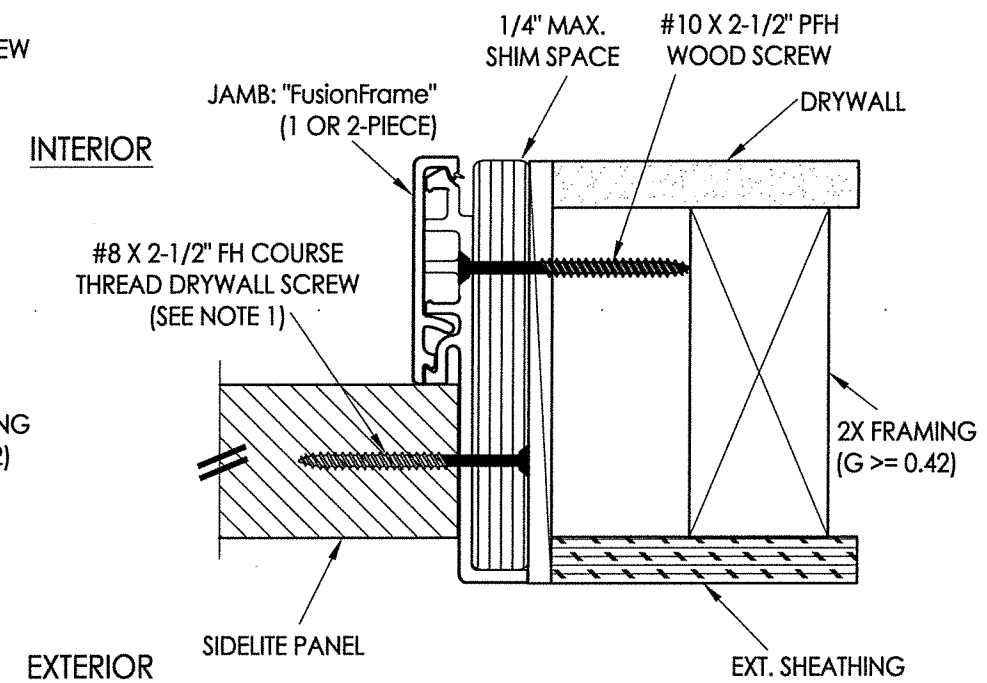

**5 HORIZONTAL CROSS SECTION**  
**5** Outswing shown - Inswing also approved

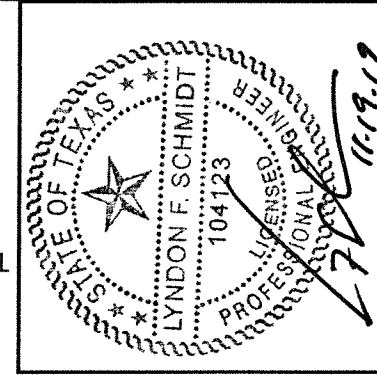

Documents Prepared By: Lyndon F. Schmidt, P.E.  
 TEXAS P.E. #104123

**RW** BUILDING CONSULTANTS, INC.  
 P.O. Box 230 Valrico FL, 33595  
 Phone No.: 813.659.9197  
 TEXAS BOARD OF PROFESSIONAL ENGINEERS  
 CERTIFICATE OF REGISTRATION # F-11852

PRODUCT:	ENDURA	
PART OR ASSEMBLY:	VERTICAL CROSS SECTIONS	
NO.	DATE	BY
1	11/19/19	LFS
ADD "FusionFrame" OPTION & UPDATE TO 2018 IBC/IRC CODE		
REVISIONS		
DATE:	12/07/17	
SCALE:	N.T.S.	
DWG. BY:	JK	
CHK. BY:	LFS	
DRAWING NO.:	TX-4759	
SHEET	5	OF 7

R:\Clients\Endura PERMANENT\B - Texas Dept of Ins\TDI - DR-954 Glazed Thermo-Tru FG door OXO (LK, DB) 36 in SL(4759-4760)\C - Drawings\TX-4759.4760.dwg, 6.3

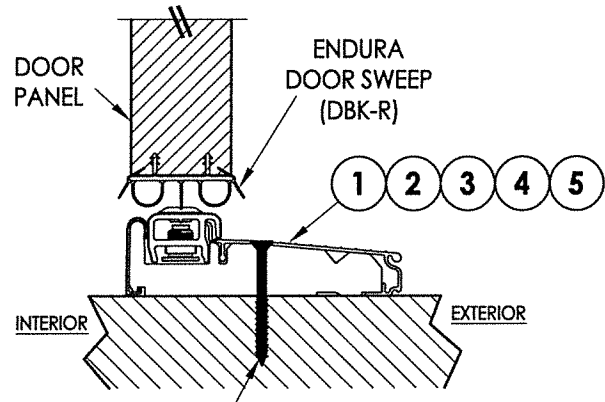

#10 X 2.5" PFH WOOD SCREW OR  
1/4" X 2-3/4" ELCO OR ITW CONCRETE SCREW

**1** VERTICAL CROSS SECTION  
**6** Inswing Adjustable Threshold

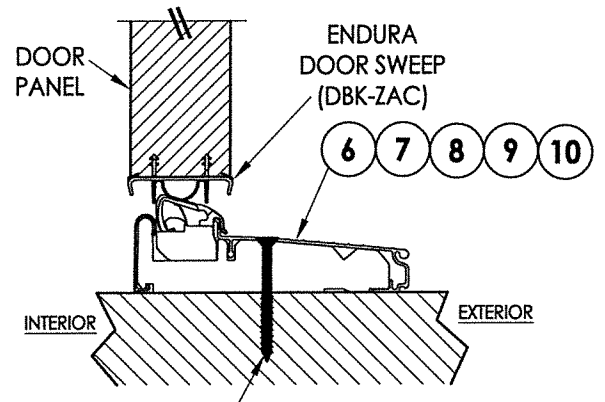

#10 X 2.5" PFH WOOD SCREW OR  
1/4" X 2-3/4" ELCO OR ITW CONCRETE SCREW

**2** VERTICAL CROSS SECTION  
**6** Inswing Articulating Threshold

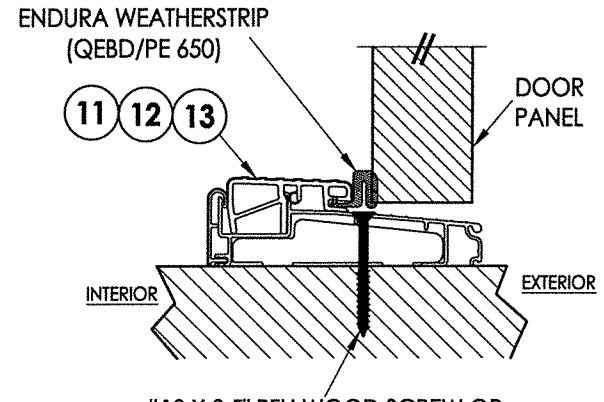

#10 X 2.5" PFH WOOD SCREW OR  
1/4" X 2-3/4" ELCO OR ITW CONCRETE SCREW

**3** VERTICAL CROSS SECTION  
**6** Outswing Bump Threshold

NOTE:  
1. Spacing for sidelite screws:  
6" from each end (2 total).

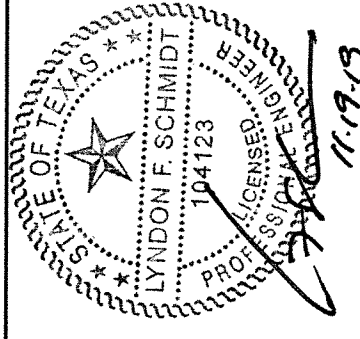

Documents Prepared By: Lyndon F. Schmidt, P.E.  
TEXAS P.E. #104123

RW BUILDING CONSULTANTS, INC.  
P.O. Box 230 Vairico FL 33595  
Phone No.: 813.659.9197

TEXAS BOARD OF PROFESSIONAL ENGINEERS  
CERTIFICATE OF REGISTRATION # F-11852

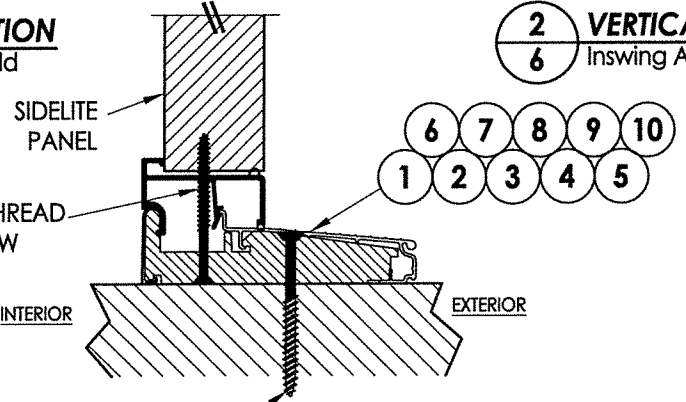

**4** VERTICAL CROSS SECTION  
**6** Inswing configuration

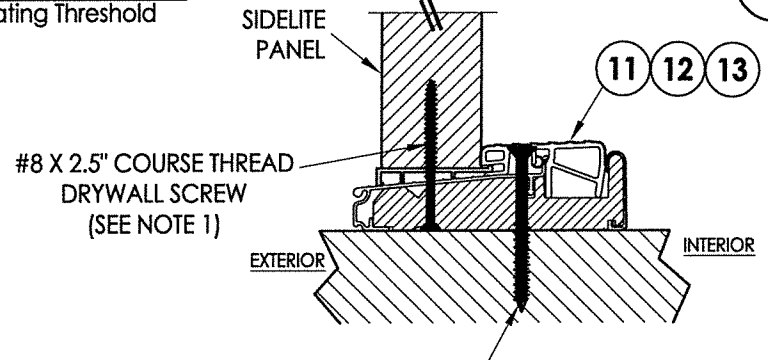

**5** VERTICAL CROSS SECTION  
**6** Outswing configuration

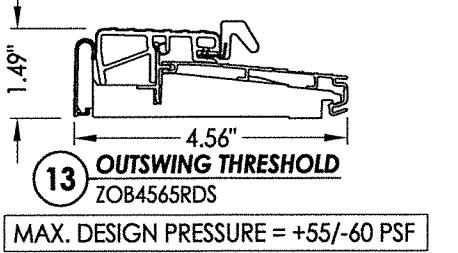
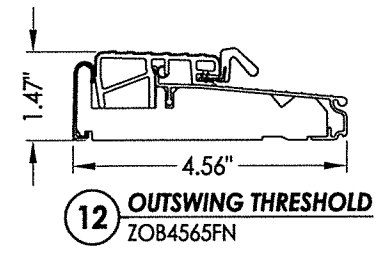
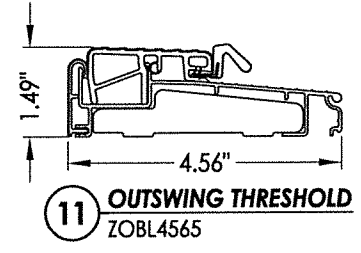
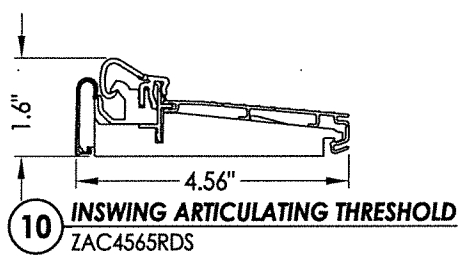
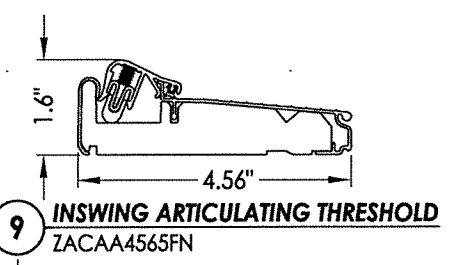
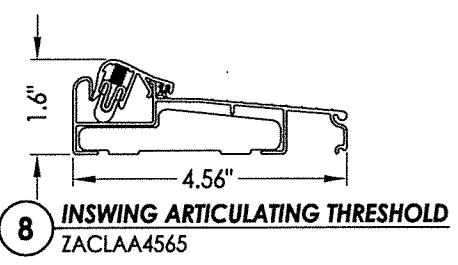
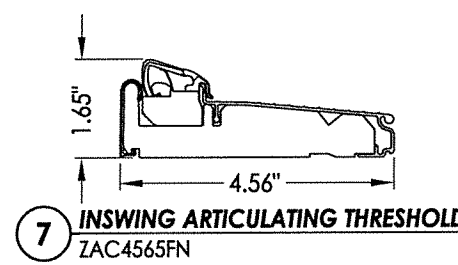
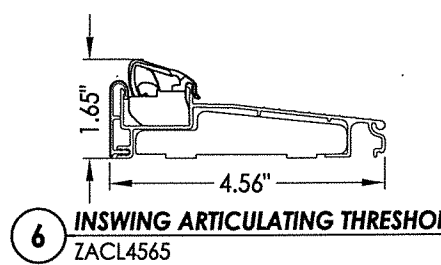
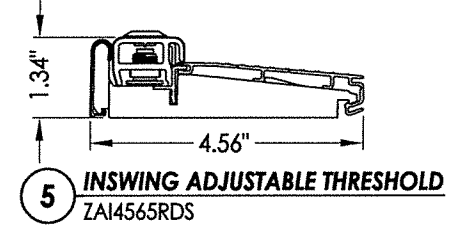
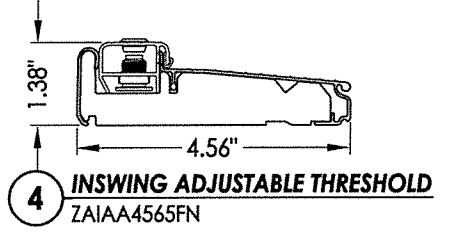
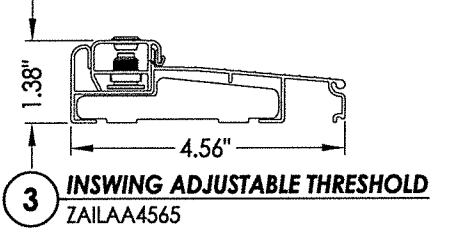
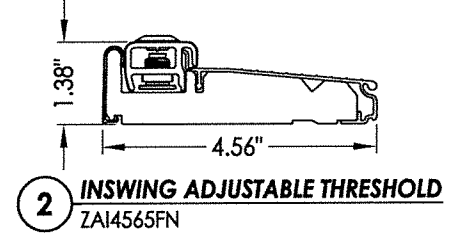
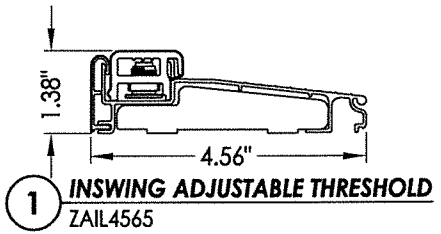

MAX. DESIGN PRESSURE = +55/-60 PSF

PRODUCT: ENDURA  
FIBERGLASS DOOR  
PART OR ASSEMBLY: LFS  
VERTICAL CROSS SECTIONS

NO.	DATE	BY	REVISIONS
1	11/19/19	LFS	ADD "FusionFrame" OPTION & UPDATE TO 2018 IBC/IRC CODE

DATE: 12/07/17  
SCALE: N.T.S.  
DWG. BY: JK  
CHK. BY: LFS  
DRAWING NO.: TX-4759  
SHEET 6 OF 7

© 2017 R.W. BUILDING CONSULTANTS INC.



