



By **R3Composites**  
 14123 Roth Road  
 Grabill, IN 46741

## Nicolette Glazed Fiberglass Door INSWING / OUTSWING "NON-IMPACT"

**EVALUATED FOR USE IN THE STATE OF TEXAS**

The Fiberglass Door described herein complies with the 2006 International Residential Code (IRC), Sections R301 & R613 and the 2006 International Building Code (IBC), Sections 1405.12, 1609, 1714.5, 2403 and 2404 (including Texas revisions) subject to the following conditions:

1. Anchors shall be as listed and spaced as shown in the details. Anchor embedment to base material shall be beyond wall dressing or stucco.
2. When used in areas requiring wind-borne debris protection this product is required to be protected with an impact resistant covering that complies with Section R301.2.1.2 of the IRC and Section 1609.1.2 of the IBC.
3. Allowable design pressure requirements must be equal to or less than the design pressure rating shown in the design pressure chart, sheet 1 of this drawing.
4. Conditions not covered by this drawing are subject to further engineering analysis.

| TABLE OF CONTENTS |  |
|-------------------|--|
| SHEET#            | DESCRIPTION  |
| 1                 | Typical elevations, design pressures & general notes |
| 2                 | Door panel details                                   |
| 3                 | Sidelite panel details and glazing detail            |
| 4                 | Sidelite panel details and glazing detail            |
| 5                 | Elevations   |
| 6                 | Horizontal cross sections                            |
| 7                 | Vertical cross sections                              |
| 8                 | Vertical cross sections                              |
| 9                 | Frame anchoring                                      |
| 10                | Bill of materials and components                     |

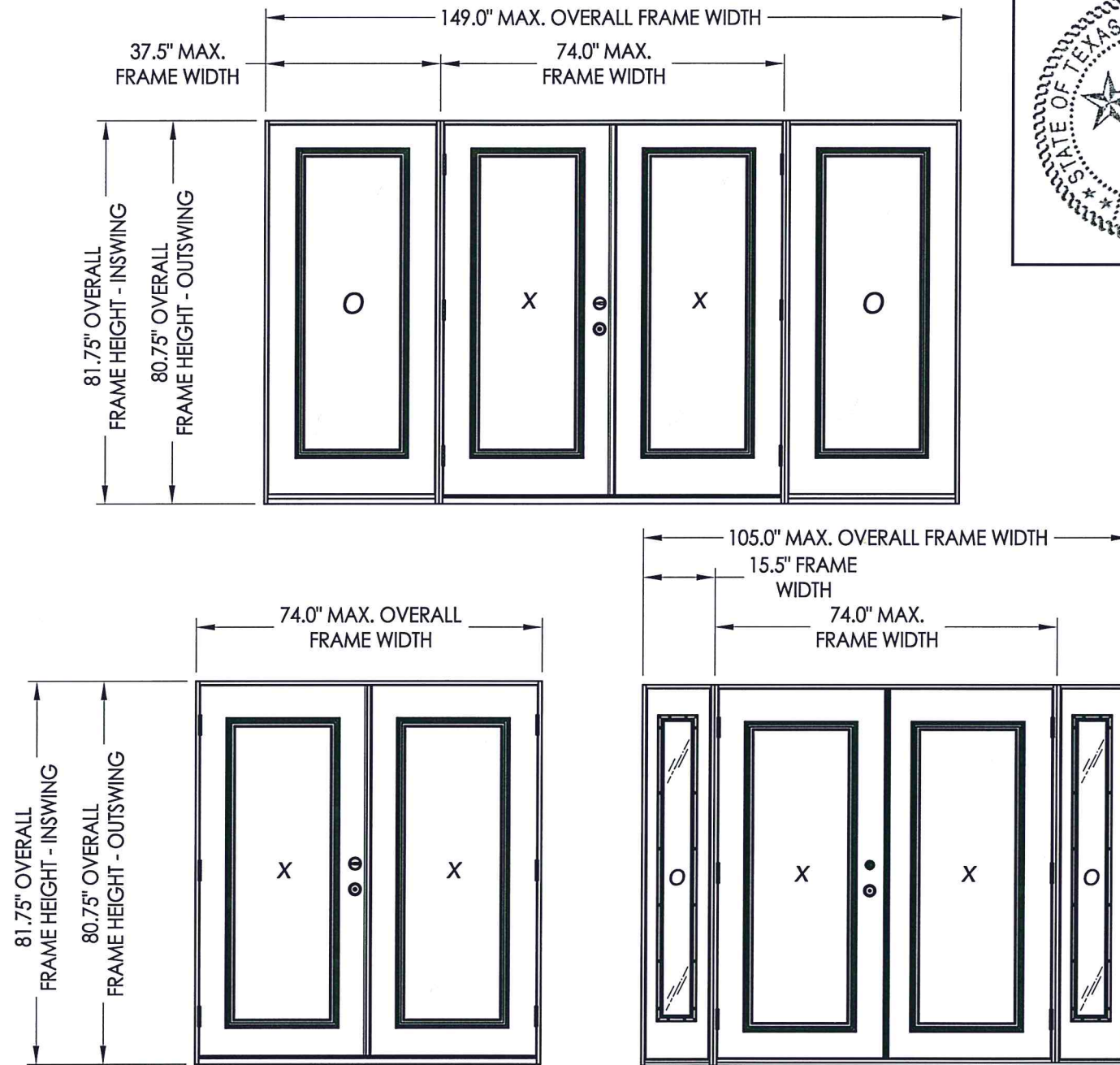

| CONFIGURATION | MAX. FRAME DIMENSION | MAX. SIDELITE D.L.O. DIMENSION | DESIGN PRESSURE (PSF) INSWING |          | DESIGN PRESSURE (PSF) OUTSWING |          |
|---------------|----------------------|--------------------------------|-------------------------------|----------|--------------------------------|----------|
|               |                      |                                | POSITIVE                      | NEGATIVE | POSITIVE                       | NEGATIVE |
| XX            | 74.0" x 81.75"       | 20.88" X 62.88"                | +40.0                         | -50.0    | +40.0                          | -40.0    |
| OXXO          | 105.0" x 81.75"      | 7.06" X 63.06"                 | +40.0                         | -50.0    | N/A                            | N/A      |
| OXXO          | 149.0" x 81.75"      | 20.88" X 62.88"                | +40.0                         | -50.0    | N/A                            | N/A      |

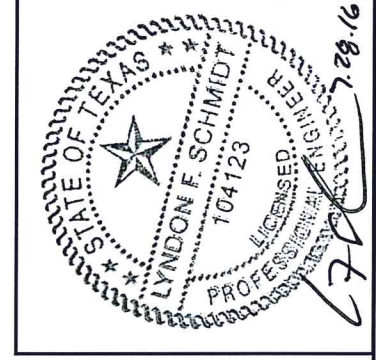

Documents Prepared By:  
 Lyndon F. Schmidt, P.E.  
 TEXAS P.E. #104123

**RW** BUILDING CONSULTANTS, INC.  
 P.O. Box 230 Valrico FL, 33595  
 Phone No.: 813.659.9197

TEXAS BOARD OF PROFESSIONAL ENGINEERS  
 CERTIFICATE OF REGISTRATION # F-11852

PRODUCT: R3 COMPOSITES

PART OR ASSEMBLY: TYPICAL ELEVATION, DESIGN PRESSURES & GENERAL NOTES

| NO. | DATE | BY | REVISIONS |
|-----|------|----|-----------|
|     |      |    |           |
|     |      |    |           |
|     |      |    |           |

DATE: 7/20/15  
 SCALE: N.T.S.  
 DWG. BY: JK  
 CHK. BY: LFS  
 DRAWING NO.: TX-4555  
 SHEET 1 OF 10

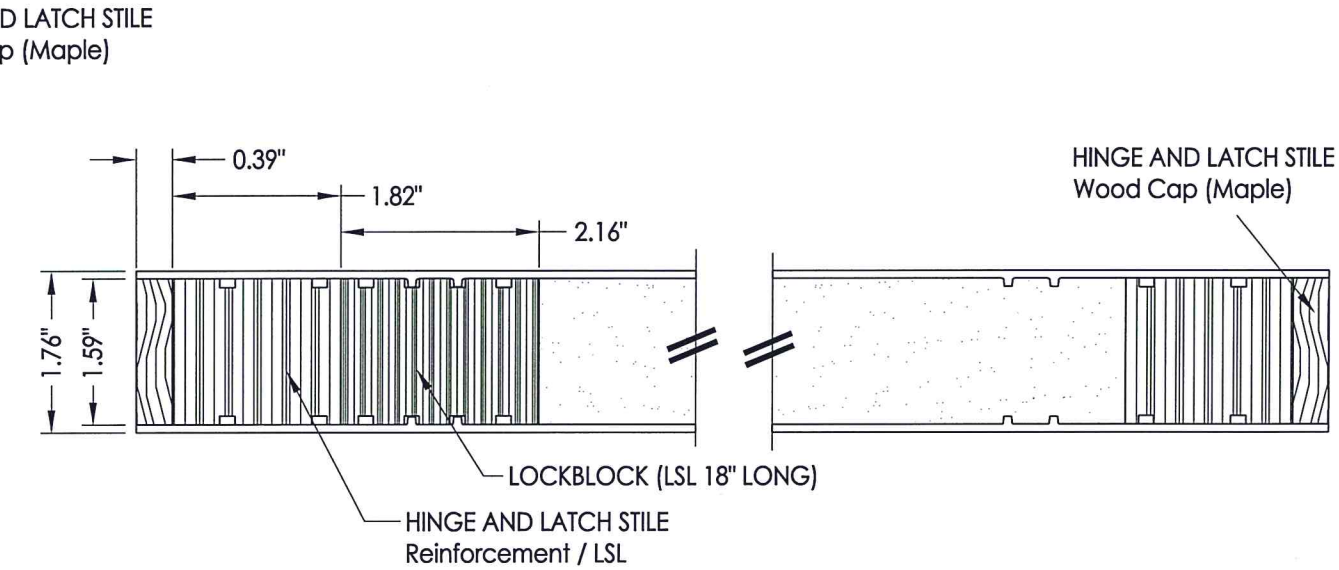
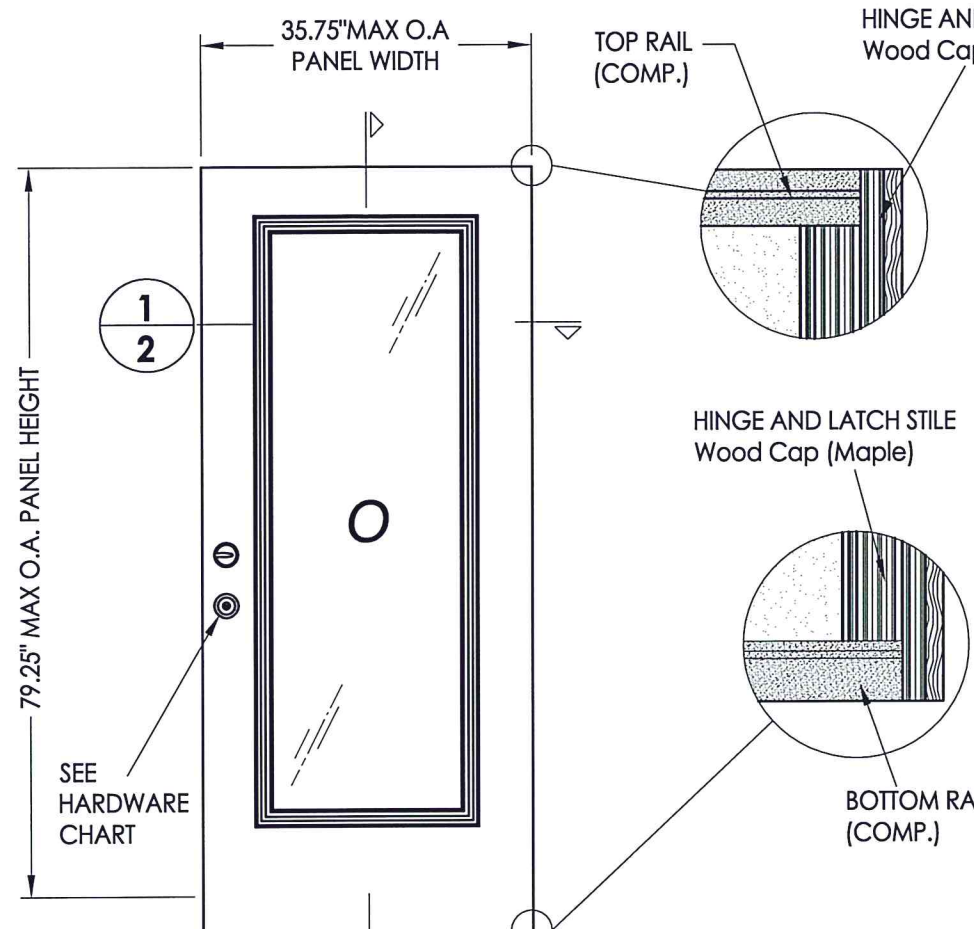

**1**  
**2** HORIZONTAL CROSS SECTION

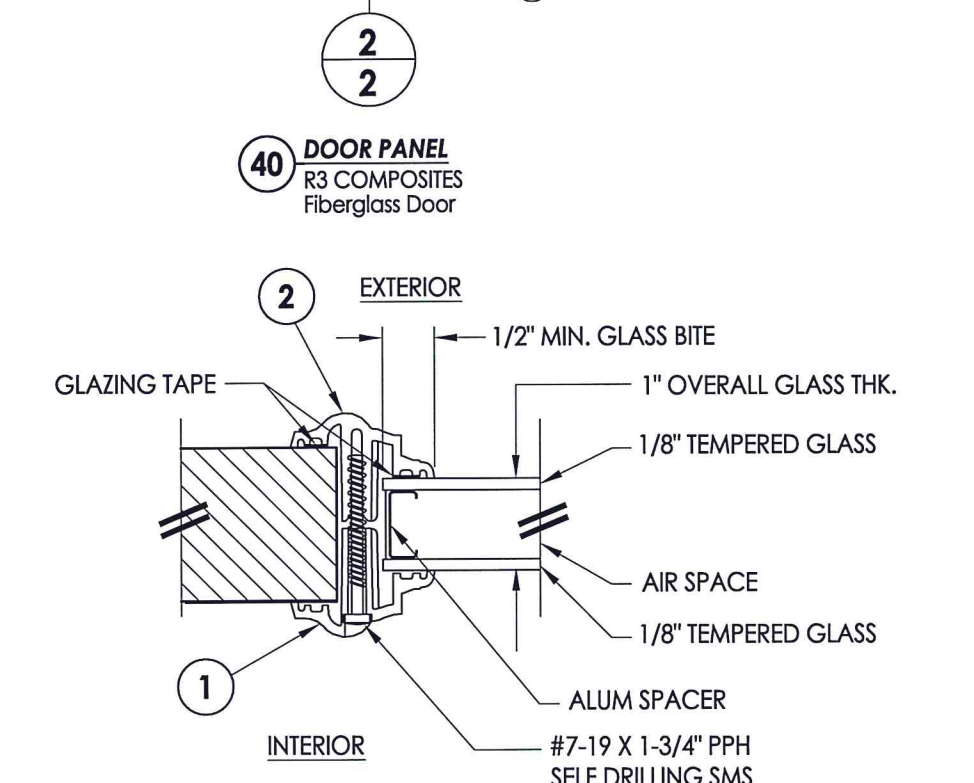

**G1** GLAZING DETAIL  
EVOLVE FRAME (1\"/>

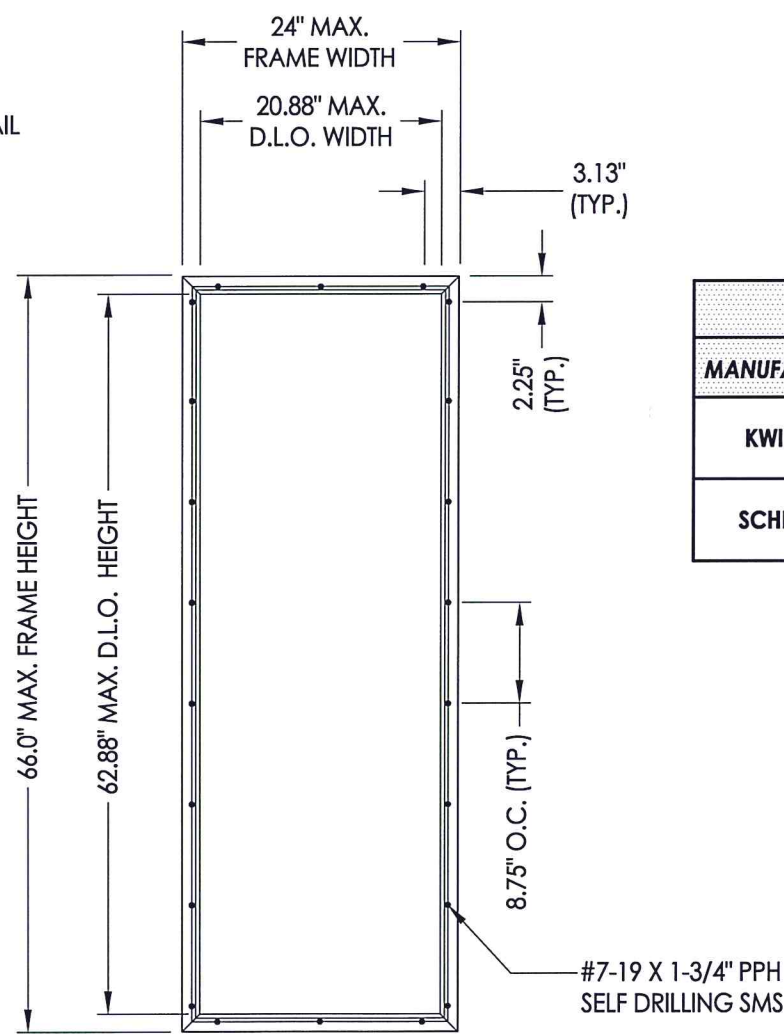

EVOLVE FRAME SYSTEM  
HP Polypropylene

| HARDWARE TABLE |                        |
|----------------|------------------------|
| MANUFACTURER   | MODEL                  |
| KWIKSET        | KNOB: SERIES (400)     |
|                | DEADBOLT: SERIES (660) |
| SCHLAGE        | KNOB: F51              |
|                | DEADBOLT: B60N         |

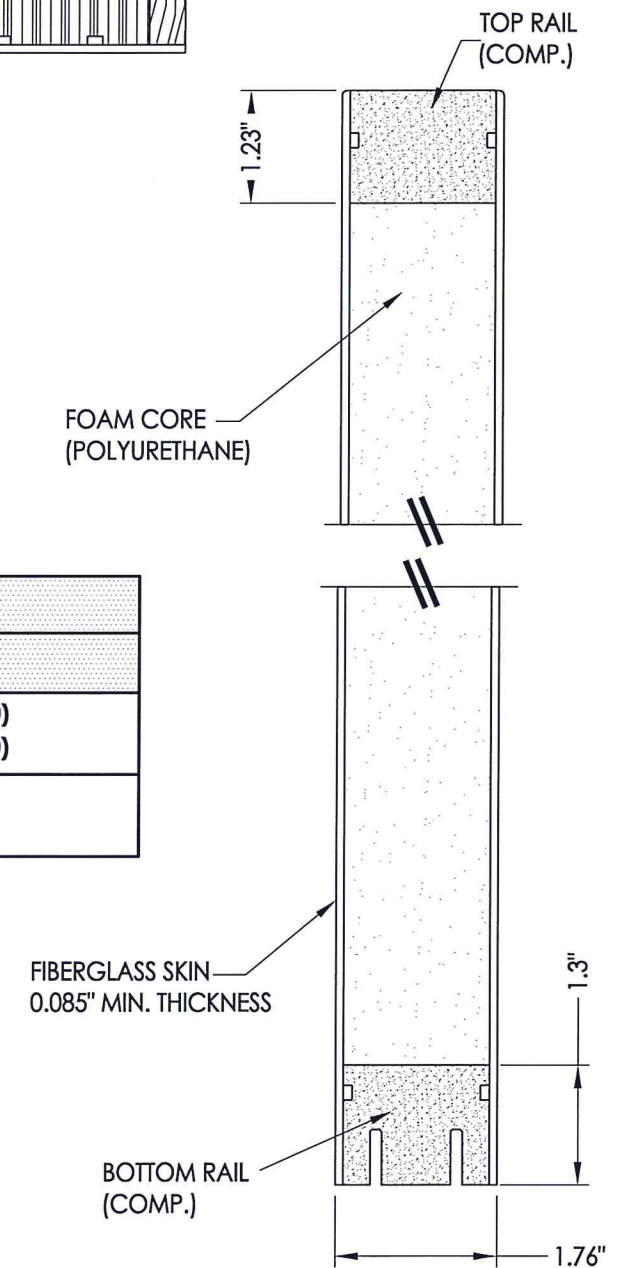

**2**  
**2** VERTICAL CROSS SECTION

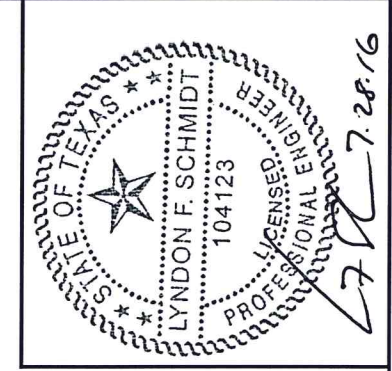

Documents Prepared By:  
Lyndon F. Schmidt, P.E.  
TEXAS P.E. #104123

**RW** BUILDING CONSULTANTS, INC.  
P.O. Box 230 Valrico FL. 33595  
Phone No.: 813.659.9197

TEXAS BOARD OF PROFESSIONAL ENGINEERS  
CERTIFICATE OF REGISTRATION # F-11852

PRODUCT: R3 COMPOSITES  
PART OR ASSEMBLY: DOOR PANEL DETAILS AND GLAZING DETAIL

| NO. | DATE | BY | REVISIONS |
|-----|------|----|-----------|
|     |      |    |           |
|     |      |    |           |
|     |      |    |           |

DATE: 7/20/15  
SCALE: N.T.S.  
DWG. BY: JK  
CHK. BY: LFS  
DRAWING NO.: TX-4555  
SHEET 2 OF 10

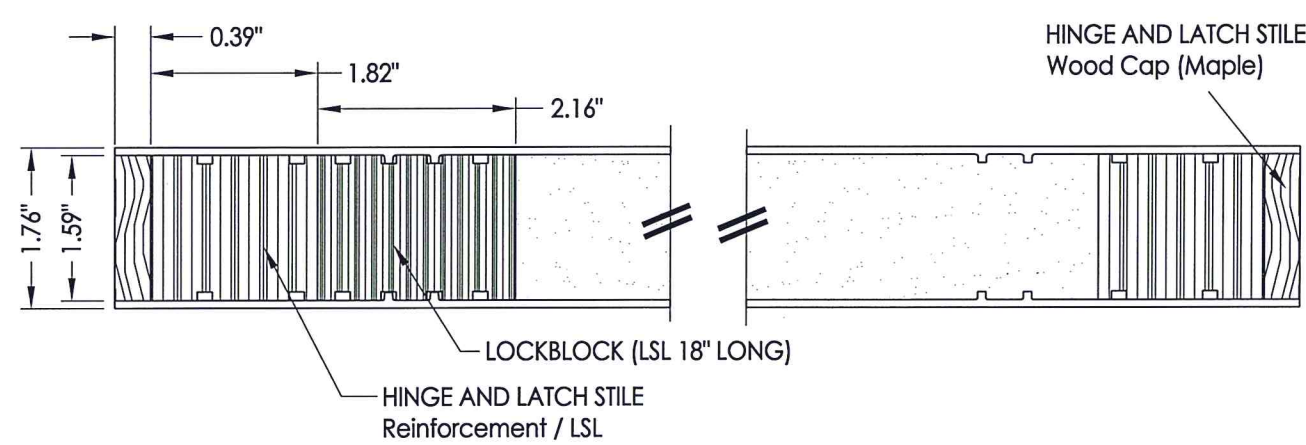
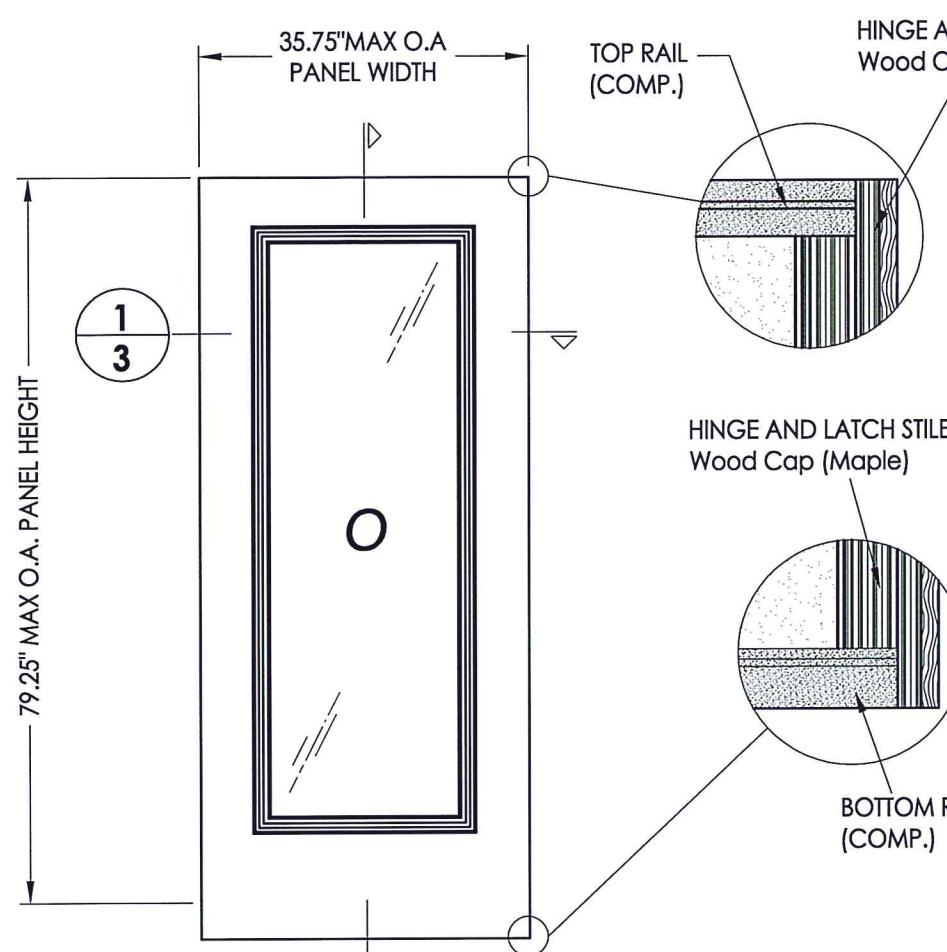

1  
3 **HORIZONTAL CROSS SECTION**

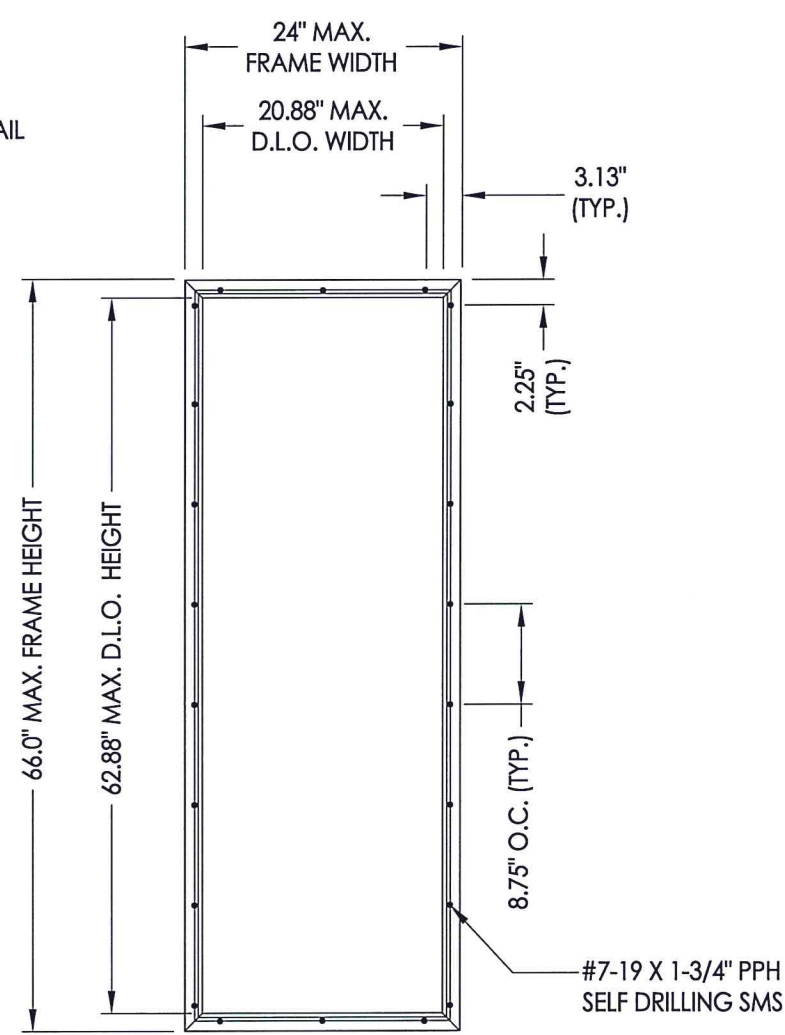

**EVOLVE FRAME SYSTEM**  
HP Polypropylene

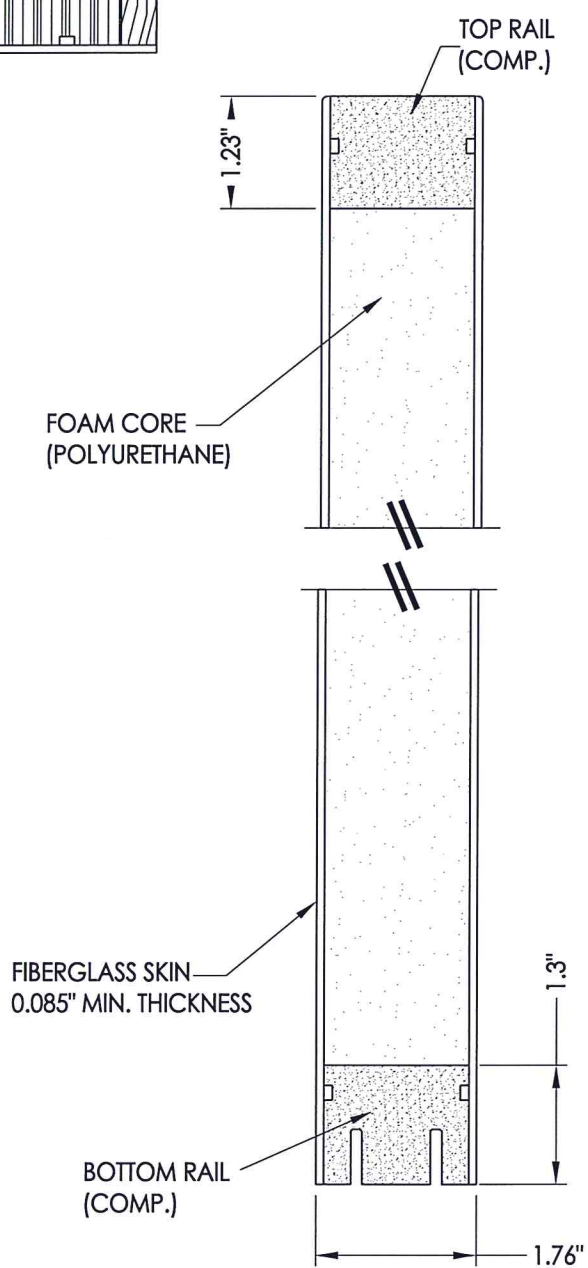

2  
3 **VERTICAL CROSS SECTION**

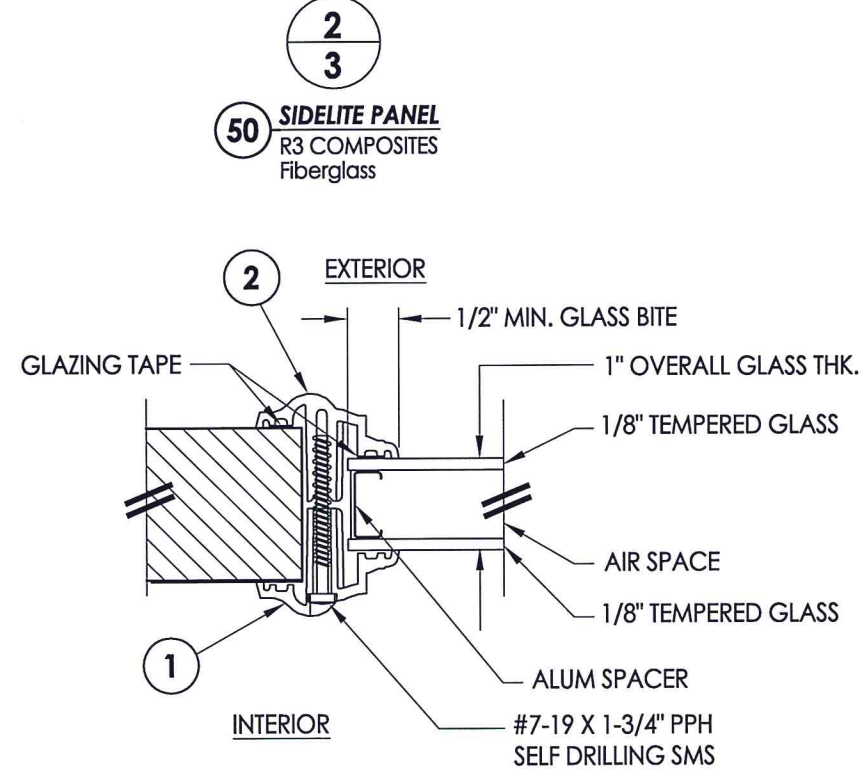

G1 **GLAZING DETAIL**  
EVOLVE FRAME (1" Insulated Glass)

50 **SIDELITE PANEL**  
R3 COMPOSITES  
Fiberglass

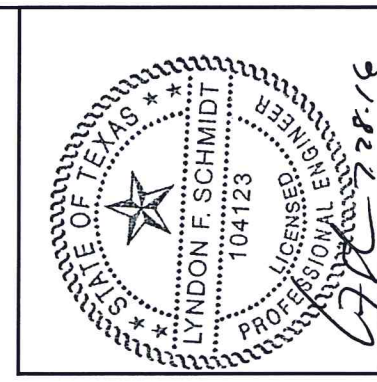

Lyndon F. Schmidt, P.E.  
TEXAS P.E. #104123

**RW** BUILDING CONSULTANTS, INC.  
P.O. Box 230 Valrico FL, 33595  
Phone No.: 813.659.9197

TEXAS BOARD OF PROFESSIONAL ENGINEERS  
CERTIFICATE OF REGISTRATION # F-11852

Documents Prepared By:

|                   |   |
|-------------------|---|
| PRODUCT:          | R3 COMPOSITES                             |
| PART OR ASSEMBLY: | SIDELITE PANEL DETAILS AND GLAZING DETAIL |

| NO. | DATE | BY | REVISIONS |
|-----|------|----|-----------|
|     |      |    |           |
|     |      |    |           |
|     |      |    |           |
|     |      |    |           |

DATE: 7/20/15

SCALE: N.T.S.

DWG. BY: JK

CHK. BY: LFS

DRAWING NO.: TX-4555

SHEET 3 OF 10

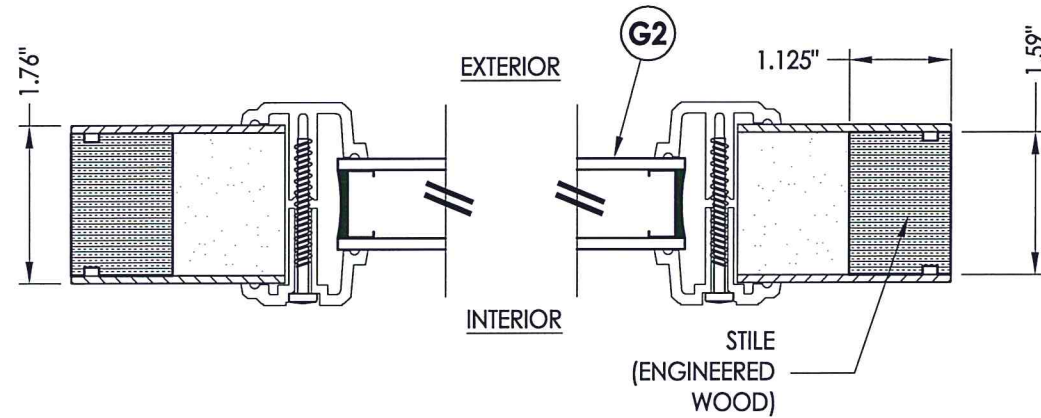

**1**  
**4** **HORIZONTAL CROSS SECTION**

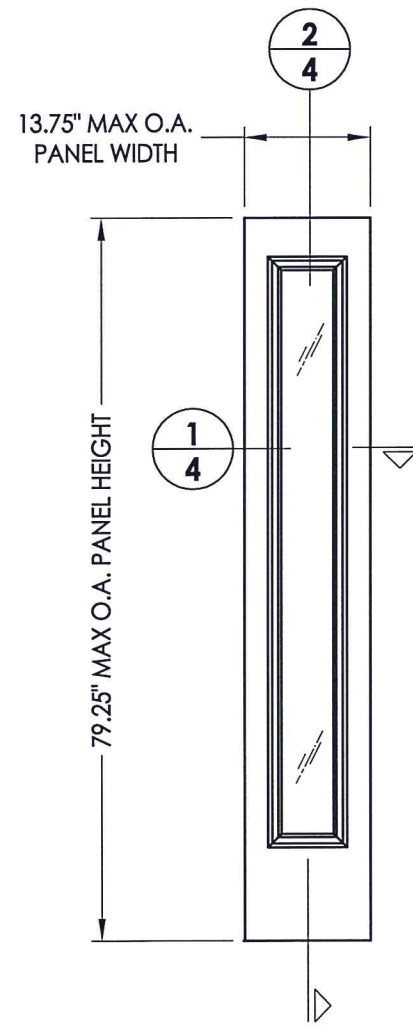

**60** **SIDELITE PANEL**

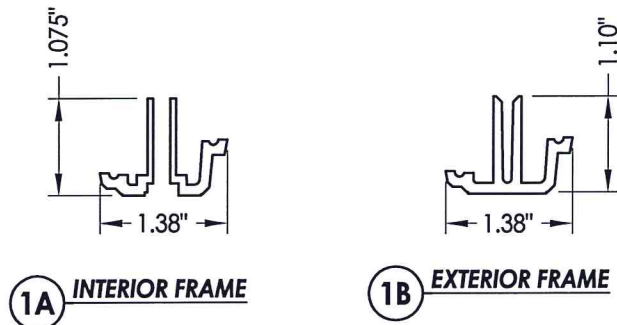

**1A** **INTERIOR FRAME**      **1B** **EXTERIOR FRAME**

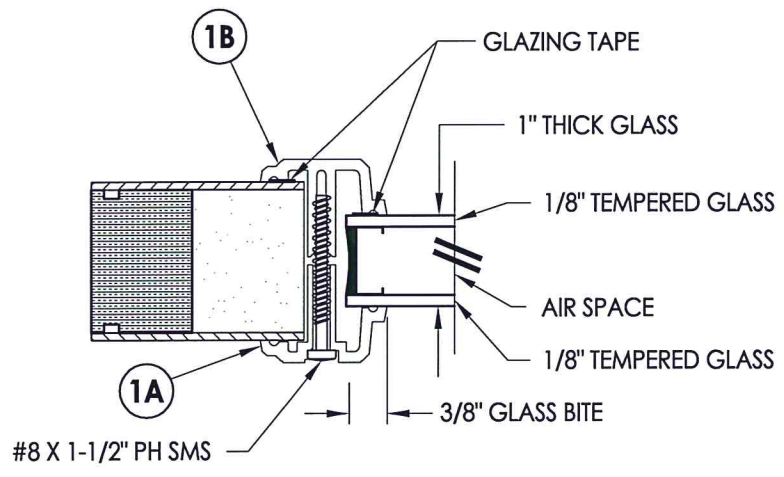

**G2** **GLAZING DETAIL**

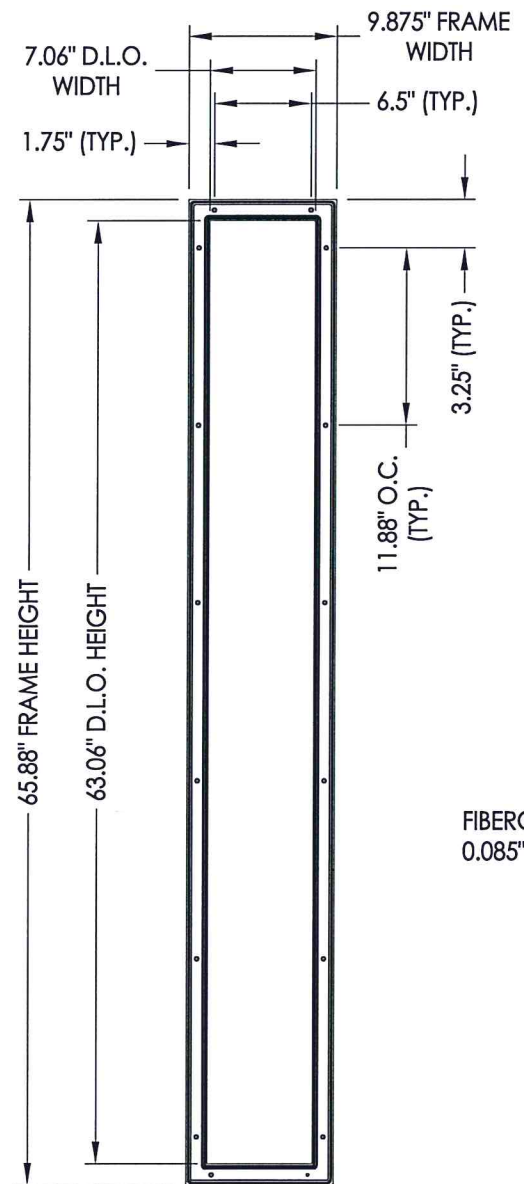

**CRAFTSMAN FRAME SYSTEM**  
**HP Polypropylene**

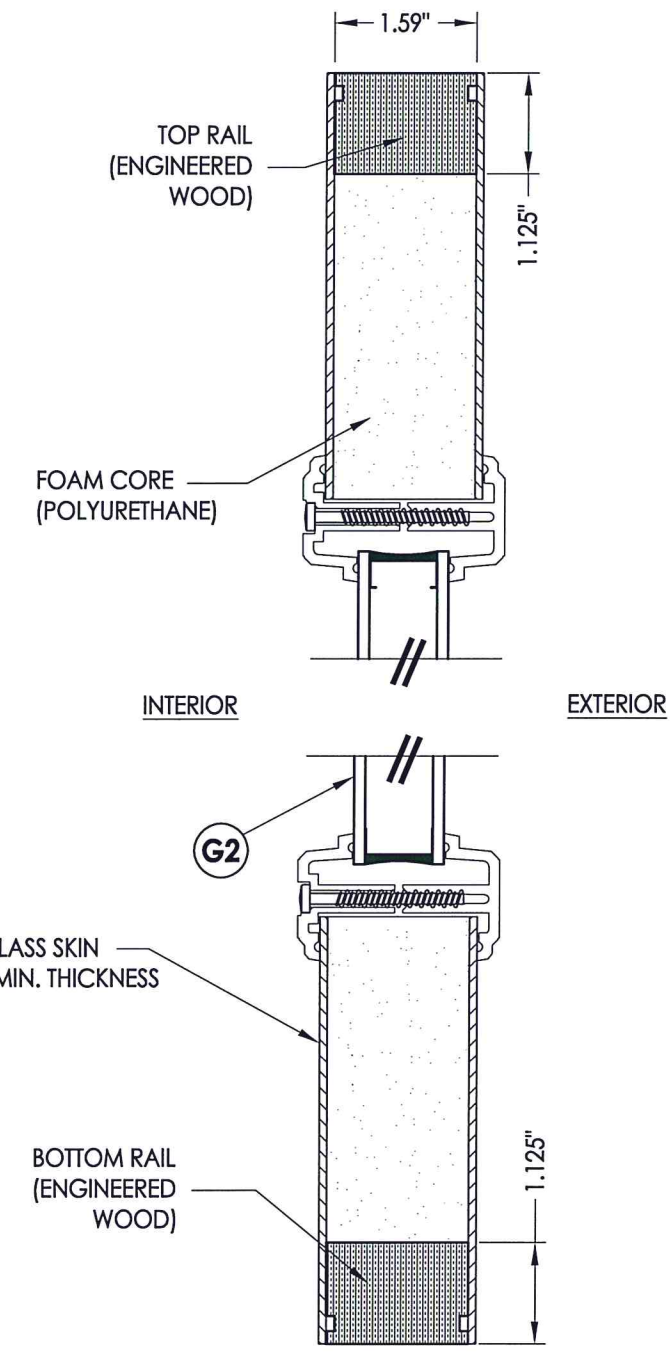

**2**  
**4** **VERTICAL CROSS SECTION**

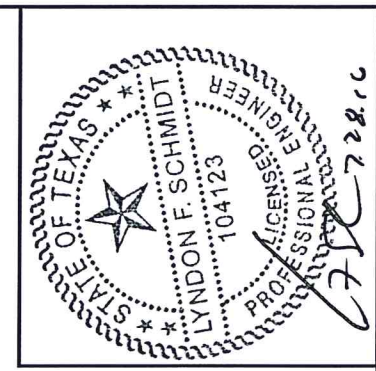

Documents Prepared By:  
Lyndon F. Schmidt, P.E.  
TEXAS P.E. #104123

**RW** BUILDING CONSULTANTS, INC.  
P.O. Box 230 Valrico FL. 33595  
Phone No.: 813.659.9197

TEXAS BOARD OF PROFESSIONAL ENGINEERS  
CERTIFICATE OF REGISTRATION # F-11852

PRODUCT: R3 COMPOSITES

PART OR ASSEMBLY: SIDELITE PANEL DETAILS AND GLAZING DETAIL

| NO. | DATE | BY |
|-----|------|----|
|     |      |    |
|     |      |    |
|     |      |    |
|     |      |    |

DATE: 7/20/15

SCALE: N.T.S.

DWG. BY: JK

CHK. BY: LFS

DRAWING NO.: TX-4555

SHEET 4 OF 10

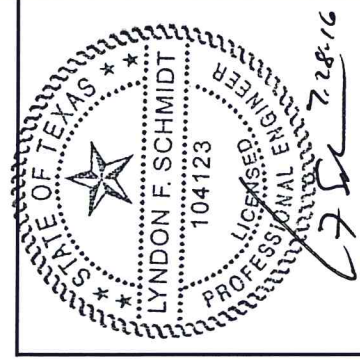
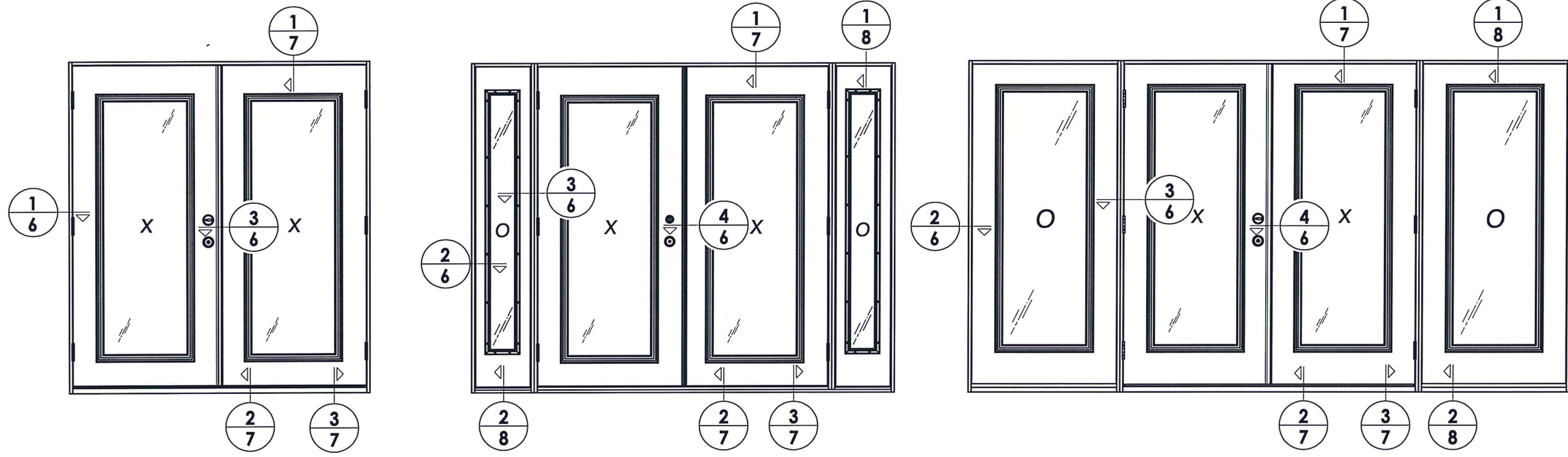

Documents Prepared By:  
 Lyndon F. Schmidt, P.E.  
 TEXAS P.E. #104123

**RW** BUILDING CONSULTANTS, INC.  
 P.O. Box 230 Valrico FL, 33595  
 Phone No.: 813.659.9197

TEXAS BOARD OF PROFESSIONAL ENGINEERS  
 CERTIFICATE OF REGISTRATION # P-11852

PRODUCT: R3 COMPOSITES  
 PART OR ASSEMBLY: ELEVATIONS

| NO. | DATE | BY | REVISIONS |
|-----|------|----|-----------|
|     |      |    |           |
|     |      |    |           |
|     |      |    |           |
|     |      |    |           |

DATE: 7/20/15  
 SCALE: N.T.S.  
 DWG. BY: JK  
 CHK. BY: LFS  
 DRAWING NO.: TX-4555  
 SHEET 5 OF 10

R:\Clients\18.3 Composites PERMANENT\18 - Texas Dept of Ins\18 Glazed Fiberglass Door\C - Drawings\TX-4554-55.dwg.6

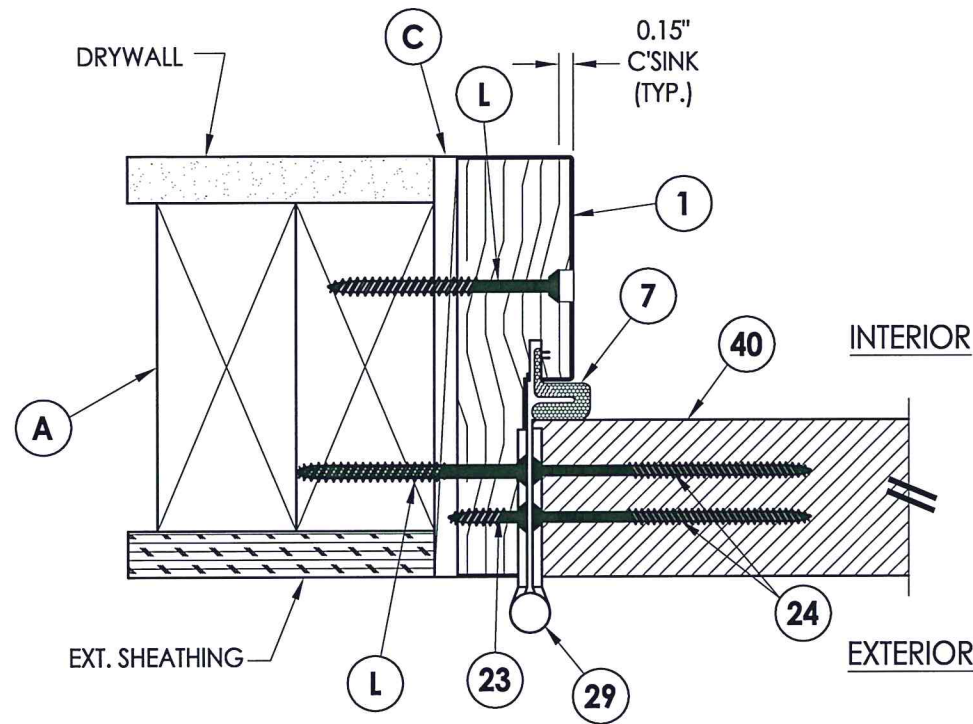

**1**  
**6** **HORIZONTAL CROSS SECTION**  
Outswing shown - Inswing also approved

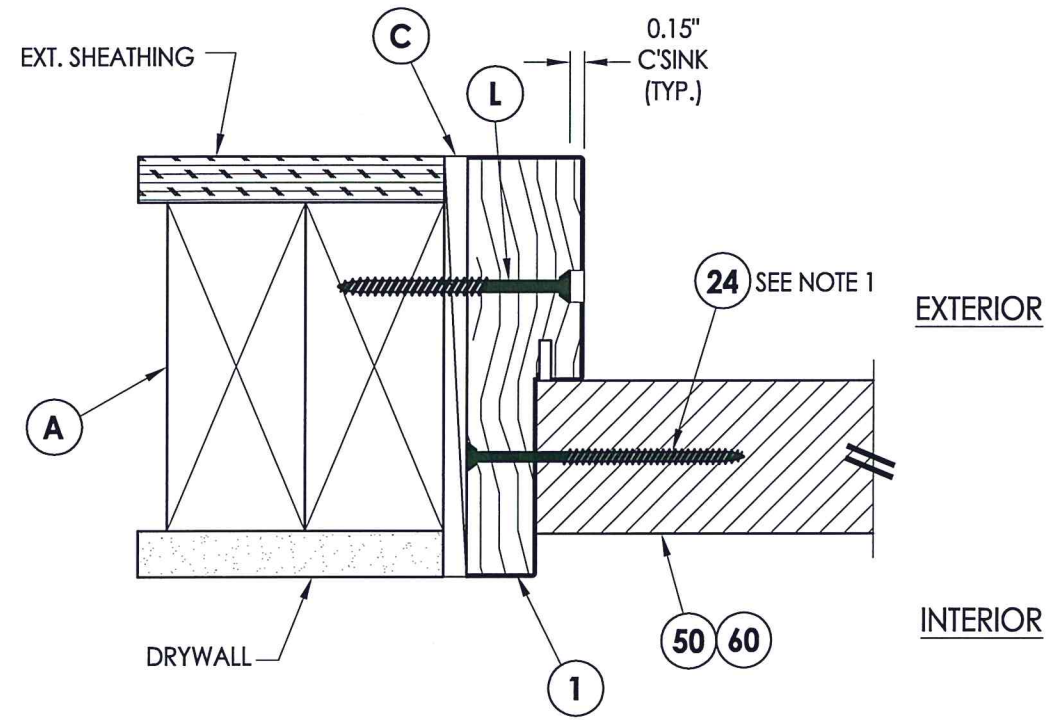

**2**  
**6** **HORIZONTAL CROSS SECTION**  
Inswing shown

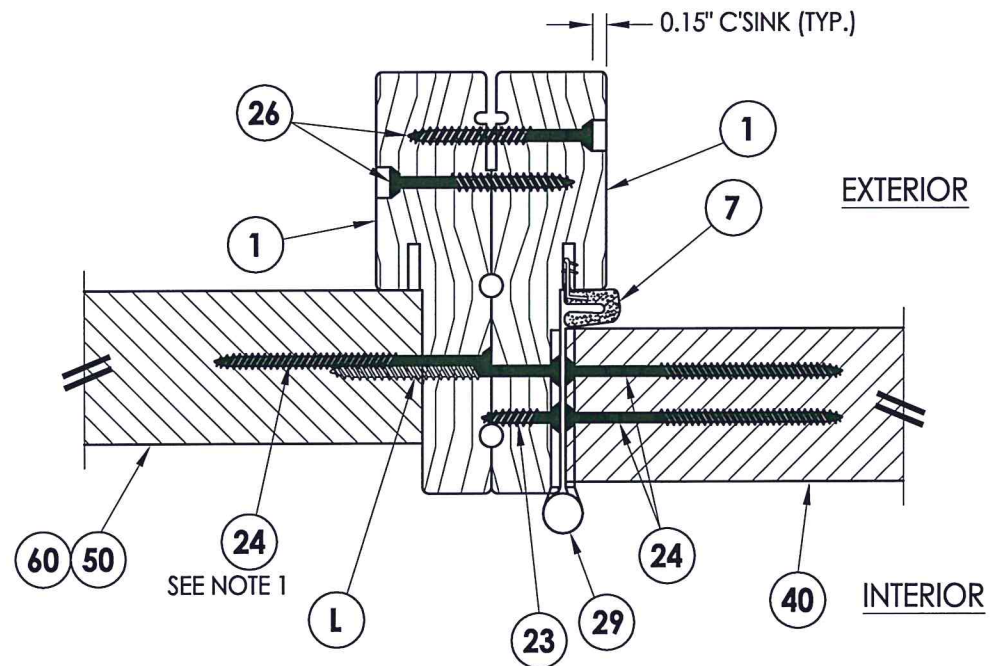

**3**  
**6** **HORIZONTAL CROSS SECTION**  
Inswing shown

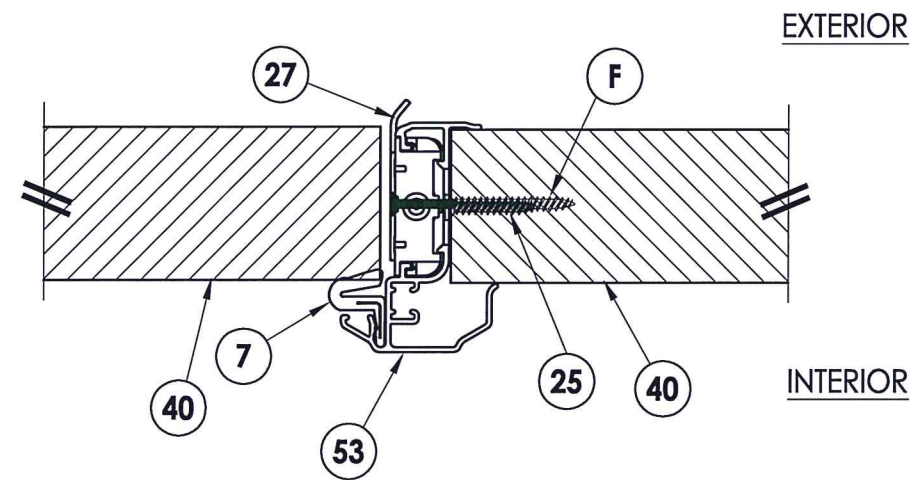

**4**  
**6** **HORIZONTAL CROSS SECTION**  
Outswing shown - Inswing also approved

NOTE:  
1. Location for item #24 is 1 at the center jamb (1) total.

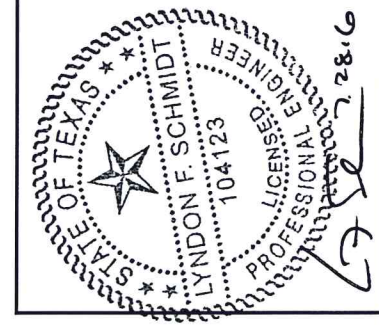

Lyndon F. Schmidt, P.E.  
TEXAS P.E. #104123

**RW** BUILDING CONSULTANTS, INC.  
P.O. Box 230 Valrico FL, 33595  
Phone No.: 813.659.9197

TEXAS BOARD OF PROFESSIONAL ENGINEERS  
CERTIFICATE OF REGISTRATION # F-11852

Documents Prepared By:

PRODUCT: R3 COMPOSITES

PART OR ASSEMBLY: HORIZONTAL CROSS SECTIONS

| NO. | DATE | BY | REVISIONS |
|-----|------|----|-----------|
|     |      |    |           |
|     |      |    |           |
|     |      |    |           |
|     |      |    |           |

DATE: 7/20/15

SCALE: N.T.S.

DWG. BY: JK

CHK. BY: LFS

DRAWING NO.:

TX-4555

SHEET 6 OF 10

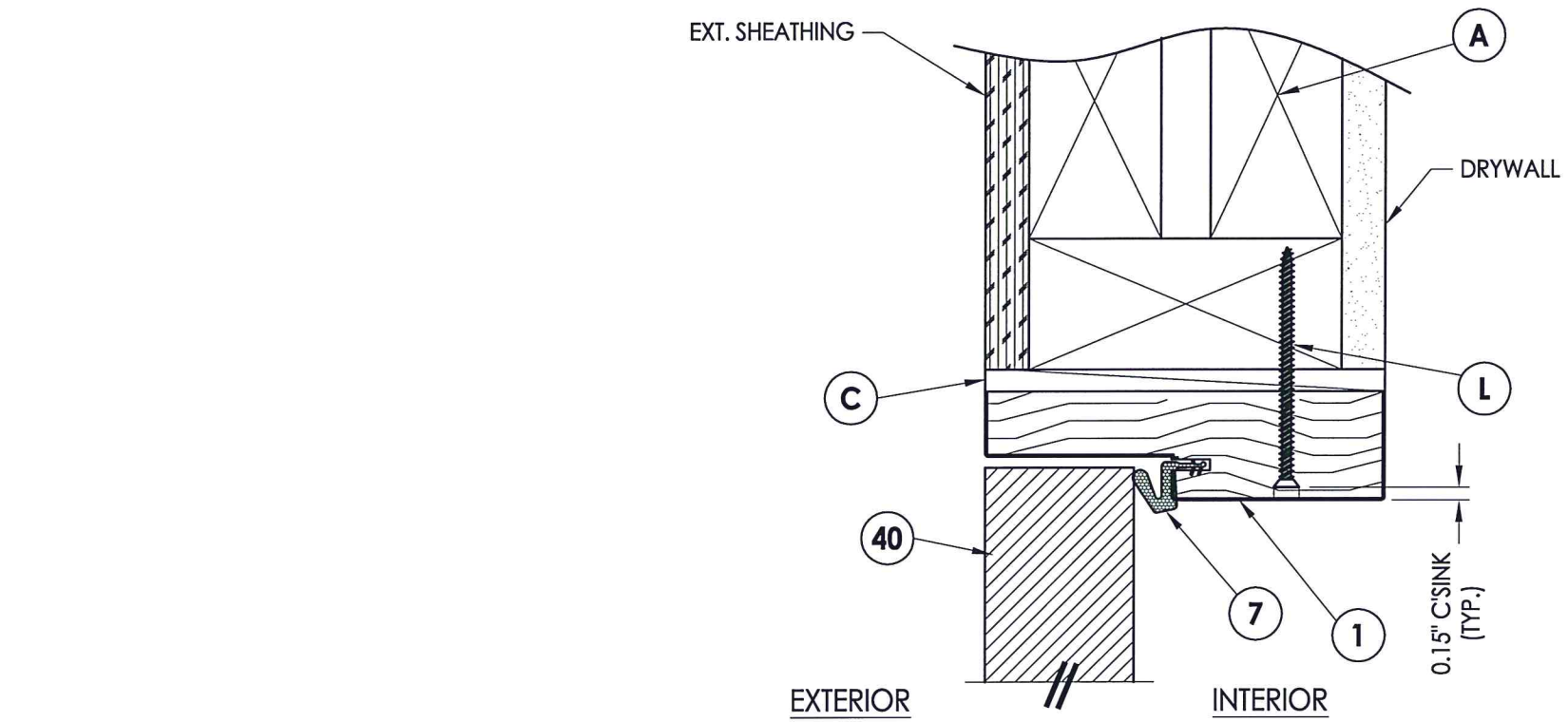

**1 VERTICAL CROSS SECTION**  
 7 Outswing shown - inswing also approved

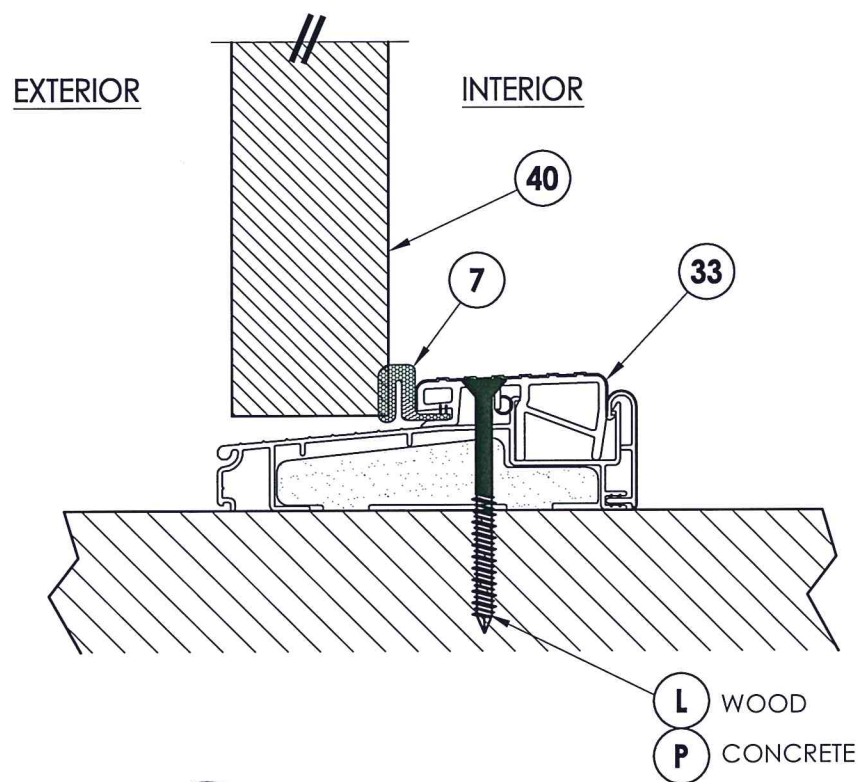

**2 VERTICAL CROSS SECTION**  
 7 Outswing configuration

NOTE:  
 1. Item #9 location, 2" from each end and 2 more equally space (4) total.

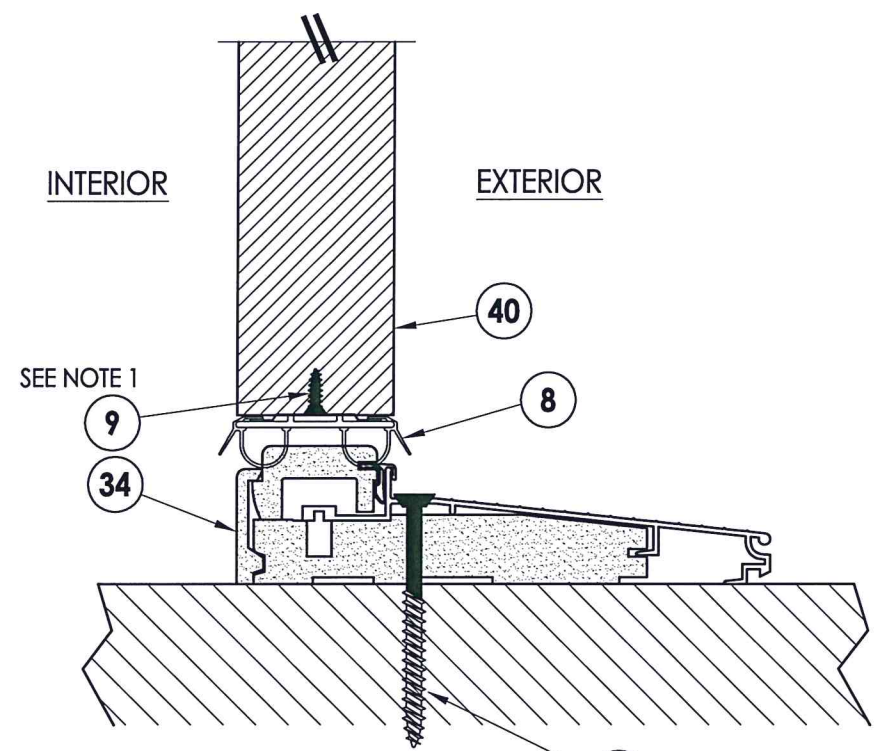

**3 VERTICAL CROSS SECTION**  
 7 Inswing configuration

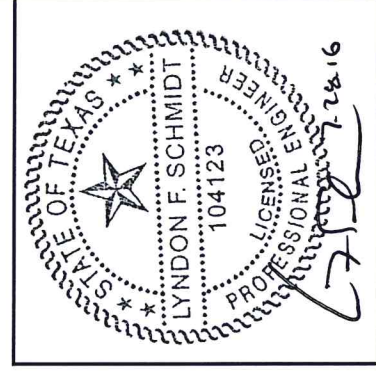

Documents Prepared By:  
 Lyndon F. Schmidt, P.E.  
 TEXAS P.E. #104123

**RW** BUILDING CONSULTANTS, INC.  
 P.O. Box 230 Valrico FL. 33595  
 Phone No.: 813.659.9197

TEXAS BOARD OF PROFESSIONAL ENGINEERS  
 CERTIFICATE OF REGISTRATION # F-11852

PRODUCT: R3 COMPOSITES  
 PART OR ASSEMBLY: VERTICAL CROSS SECTIONS

| NO. | DATE | BY | REVISIONS |
|-----|------|----|-----------|
|     |      |    |           |
|     |      |    |           |
|     |      |    |           |
|     |      |    |           |

DATE: 7/20/15  
 SCALE: N.T.S.  
 DWG. BY: JK  
 CHK. BY: LFS  
 DRAWING NO.: TX-4555  
 SHEET 7 OF 10

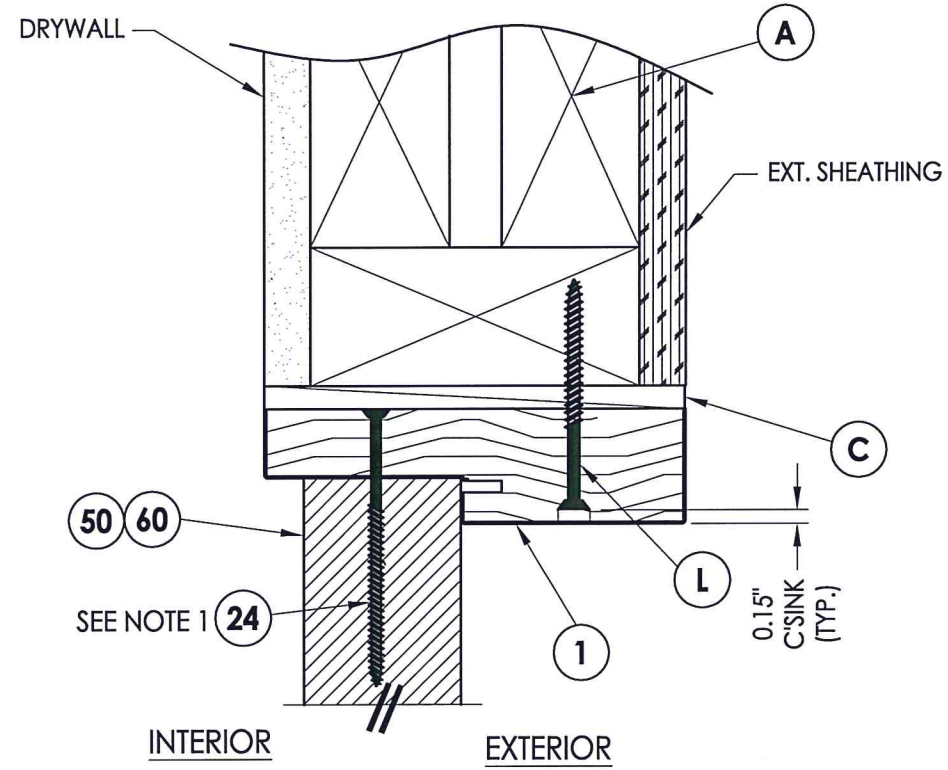

**1** VERTICAL CROSS SECTION  
**8** Inswing shown

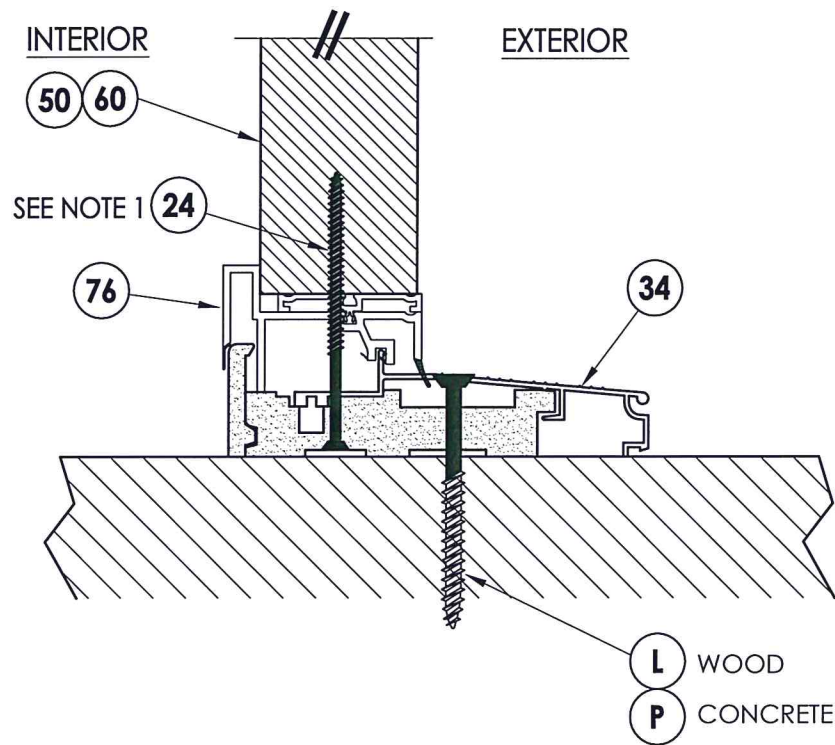

**2** VERTICAL CROSS SECTION  
**8** Inswing shown

NOTE:  
 1. Item #24 location, 2" from each end (2) total.

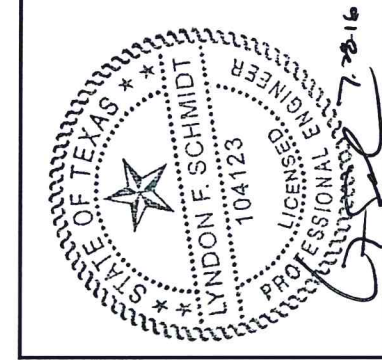

Documents Prepared By:  
 Lyndon F. Schmidt, P.E.  
 TEXAS P.E. #104123

**RW** BUILDING CONSULTANTS, INC.  
 P.O. Box 230 Valrico FL, 33595  
 Phone No.: 813.659.9197

TEXAS BOARD OF PROFESSIONAL ENGINEERS  
 CERTIFICATE OF REGISTRATION # F-11852

|                   |                         |
|-------------------|-------------------------|
| PRODUCT:          | R3 COMPOSITES           |
| PART OR ASSEMBLY: | VERTICAL CROSS SECTIONS |

| NO. | DATE | BY | REVISIONS |
|-----|------|----|-----------|
|     |      |    |           |
|     |      |    |           |
|     |      |    |           |
|     |      |    |           |

|              |         |
|--------------|---------|
| DATE:        | 7/20/15 |
| SCALE:       | N.T.S.  |
| DWG. BY:     | JK      |
| CHK. BY:     | LFS     |
| DRAWING NO.: | TX-4555 |
| SHEET        | 8 of 10 |



R:\Clients\R 3 Composites PERMANENT\B - Texas Dept of Ins\6'8 Glazed Fiberglass Door\C - Drawings\TX-4554-55.dwg, 9

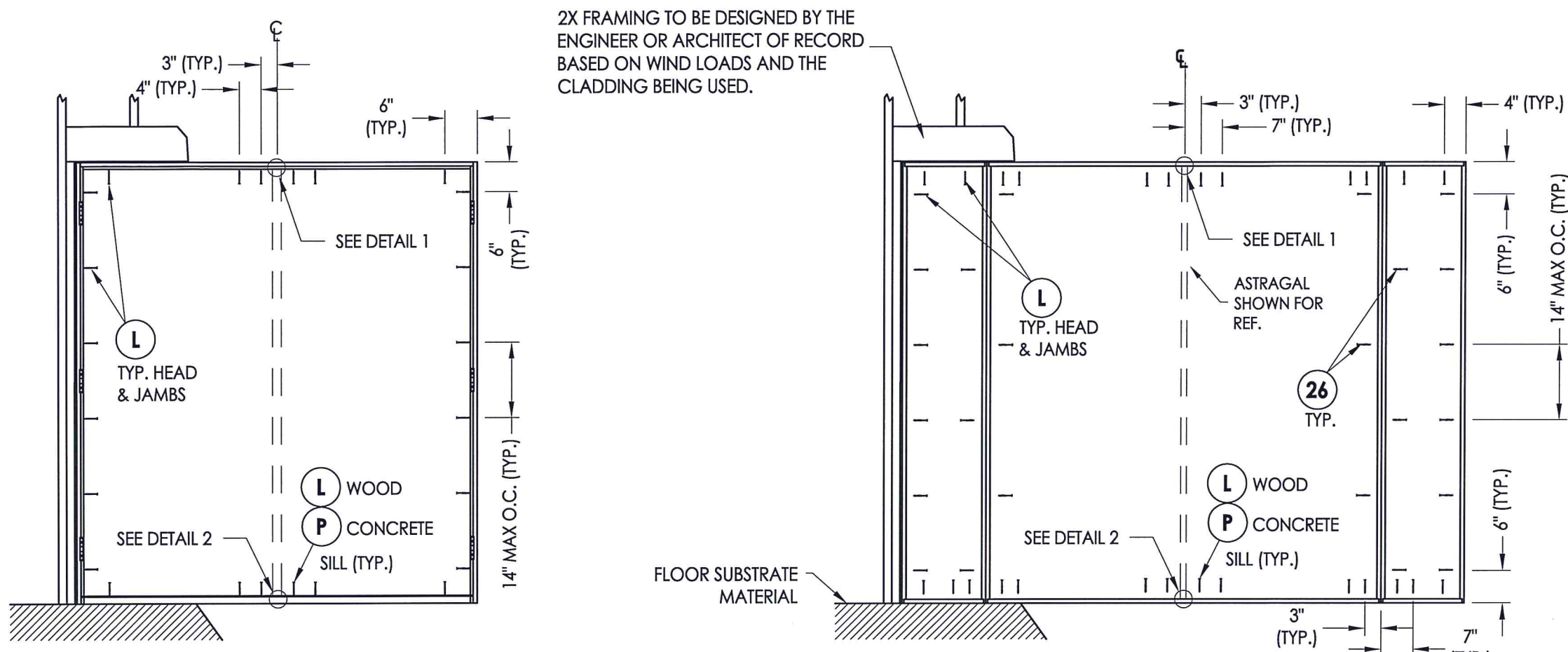

**FRAME ANCHORING**  
XX

**FRAME ANCHORING**  
OXXO

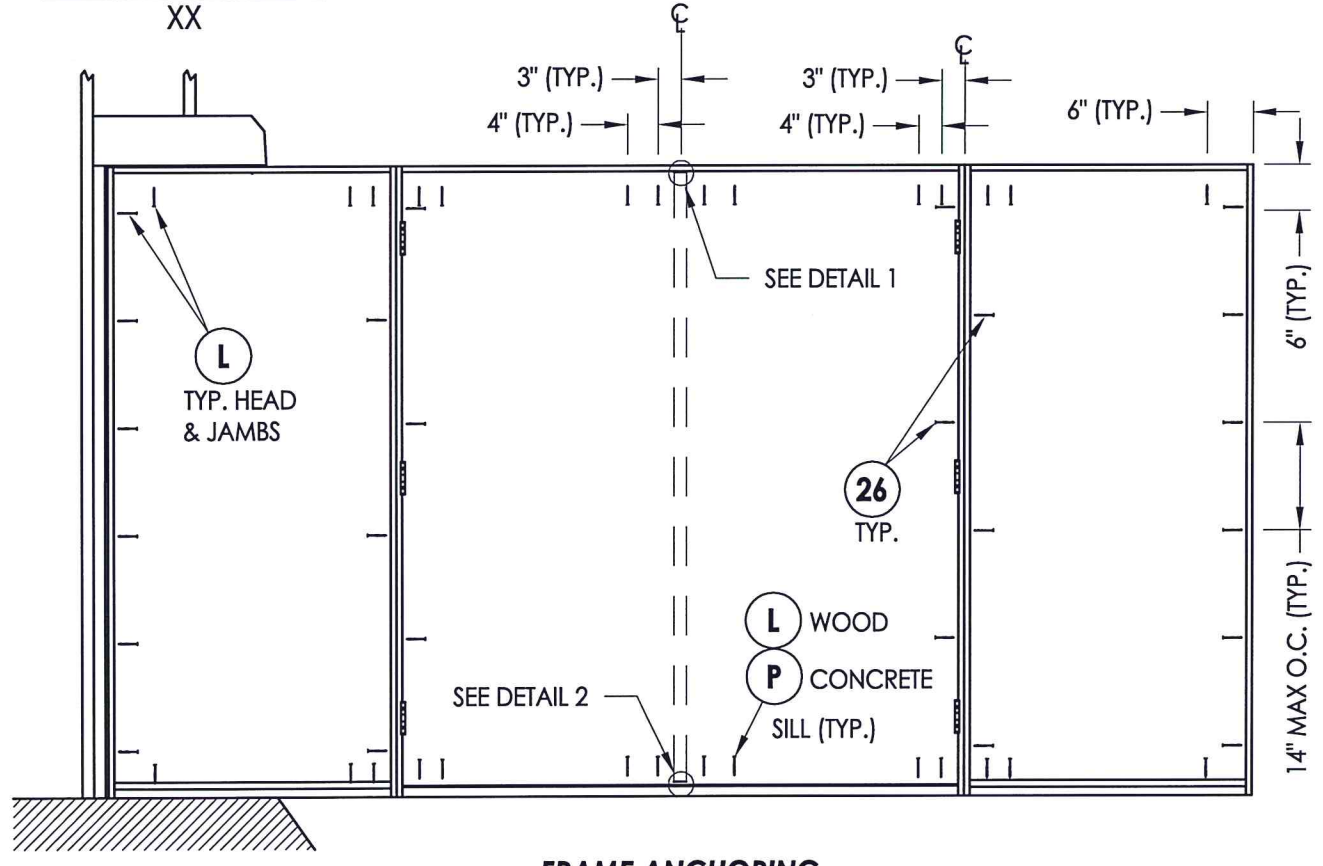

**FRAME ANCHORING**  
OXXO

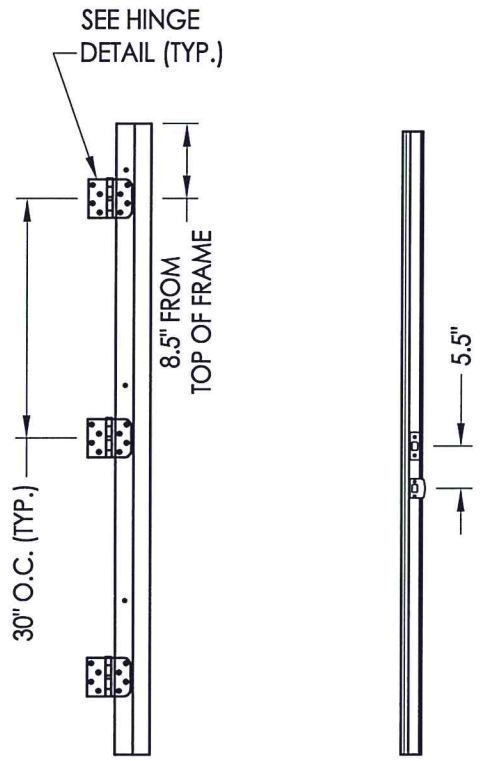

**HINGE JAMB**      **ASTRAGAL STRIKE**

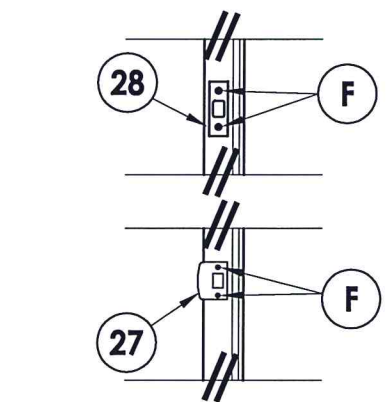

**LATCH & DEADBOLT DETAIL**

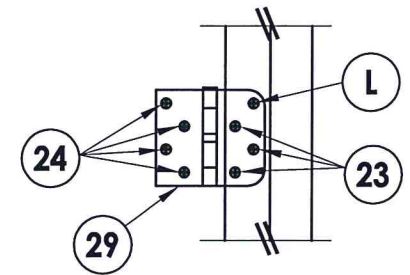

**HINGE DETAIL**

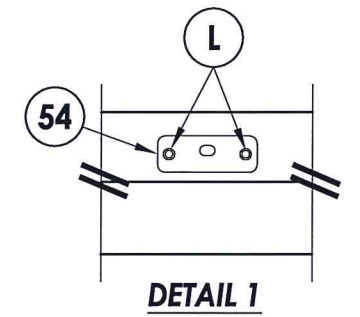

**DETAIL 1**

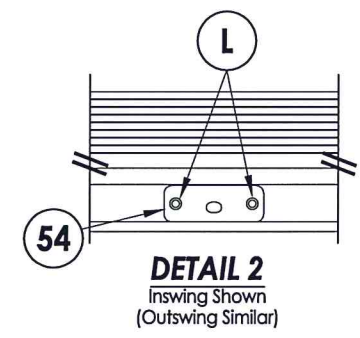

**DETAIL 2**  
Inswing Shown  
(Outswing Similar)

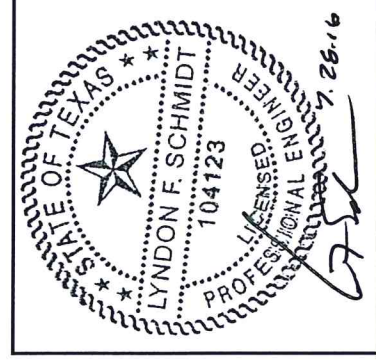

Lyndon F. Schmidt, P.E.  
TEXAS P.E. #104123

Documents Prepared By:  
**RW** BUILDING CONSULTANTS, INC.  
P.O. Box 230 Valrico FL, 33595  
Phone No.: 813.659.9197

TEXAS BOARD OF PROFESSIONAL ENGINEERS  
CERTIFICATE OF REGISTRATION # F-11852

PRODUCT: R3 COMPOSITES

PART OR ASSEMBLY: FRAME ANCHORING

| NO. | DATE | BY | REVISIONS |
|-----|------|----|-----------|
|     |      |    |           |
|     |      |    |           |
|     |      |    |           |

DATE: 7/20/15  
SCALE: N.T.S.  
DWG. BY: JK  
CHK. BY: LFS  
DRAWING NO.: TX-4555  
SHEET 9 OF 10

R:\Clients\13 Composites PERMANENT\B - Texas Dept of Ins\6.8 Glazed Fiberglass Door\C - Drawings\TX-4554-55.dwg\_10

**BILL OF MATERIALS**

| ITEM # | DESCRIPTION   | MATERIAL     |
|--------|---|--------------|
| A      | 2X FRAMING (SG >= 0.42)   | WOOD         |
| C      | 1/4" MAX. SHIM SPACE  | -            |
| F      | #8 X 2-1/2" PFH WOOD SCREW  | STEEL        |
| L      | #10 X 2-1/2" PFH WOOD SCREW (1.15" MIN. EMBEDMENT)                        | STEEL        |
| P      | 1/4" PFH CONCRETE SCREW (1-3/4" MIN. EMBEDMENT)                           | STEEL        |
| 1      | JAMB - FINGER JOINTED PINE  | WOOD         |
| 7      | WEATHERSTRIP  | FOAM         |
| 8      | DOOR BOTTOM SWEEP WITH STEEL RETAINER                                     | VINYL        |
| 9      | #8 X 1/2" PFH WOOD SCREW  | STEEL        |
| 23     | #10 X 3/4" PFH WOOD SCREW   | STEEL        |
| 24     | #9 X 3" PFH WOOD SCREW  | STEEL        |
| 25     | #8 x 1" PFH   | STEEL        |
| 26     | #10 X 2" PFH WOOD SCREW   | STEEL        |
| 27     | LATCH STRIKE PLATE  | STEEL        |
| 28     | DEADBOLT STRIKE PLATE   | STEEL        |
| 29     | 4" X 4" HINGE   | STEEL        |
| 33     | OUTSWING THRESHOLD  | ALUM. / WOOD |
| 34     | INSWING ADJUSTABLE THRESHOLD  | ALUM. / WOOD |
| 40     | DOOR PANEL - SEE DOOR PANEL DETAIL SHEET FOR CONSTRUCTION DETAILS         | -            |
| 50     | SIDELITE PANEL - SEE SIDELITE PANEL DETAIL SHEET FOR CONSTRUCTION DETAILS | -            |
| 53     | ENDURA ULTIMATE HURRICANE ASTRAGAL  | ALUM         |
| 54     | ASTRAGAL STRIKE PLATE   | STEEL        |
| 60     | SIDELITE PANEL - SEE SIDELITE PANEL DETAIL SHEET FOR CONSTRUCTION DETAILS | -            |
| 76     | INSWING SIDELITE ADAPTOR  | PVC          |

**CONCRETE ANCHOR NOTES:**

- Concrete anchor locations at the corners may be adjusted to maintain the min. edge distance to mortar joints.
- Concrete anchor locations noted as "MAX. ON CENTER" must be adjusted to maintain the min. edge distance to mortar joints, additional concrete anchors may be required to ensure the "MAX. ON CENTER" dimension are not exceeded.
- Concrete anchor table:

| ANCHOR TYPE    | ANCHOR SIZE | MIN. EMBEDMENT | MIN. CLEARANCE TO MASONRY EDGE | MIN. CLEARANCE TO ADJACENT ANCHOR |
|----------------|-------------|----------------|--------------------------------|-----------------------------------|
| ITW TAPCON®    | 1/4"        | 1-1/4"         | 2"                             | 4"                                |
| ELCO ULTRACON® | 1/4"        | 1-1/4"         | 1"                             | 4"                                |

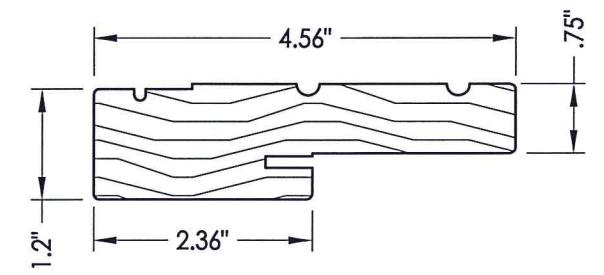

**1 WOOD JAMB**

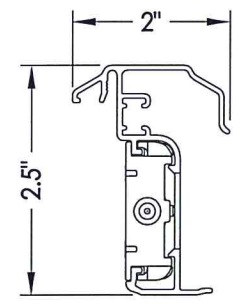

**53 ASTRAGAL**

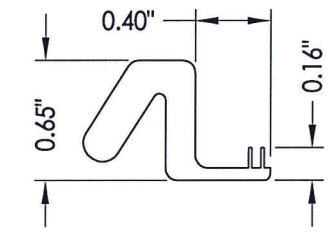

**7 WEATHERSTRIP**  
Endura Force 5

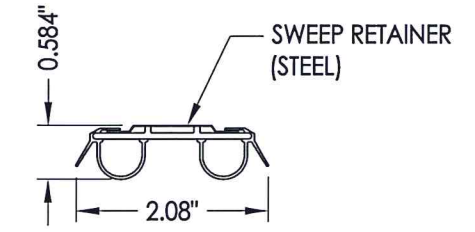

**8 DOOR BOTTOM SWEEP**

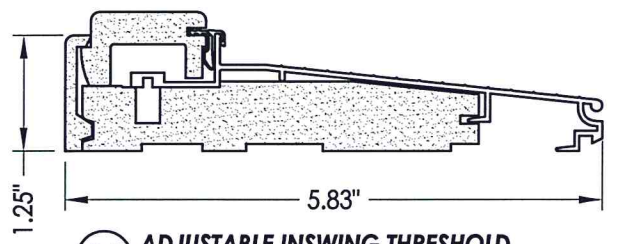

**34 ADJUSTABLE INSWING THRESHOLD**  
By Endura

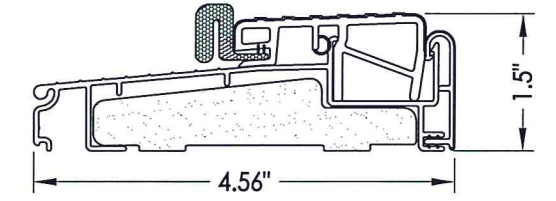

**33 OUTSWING THRESHOLD**  
By Endura

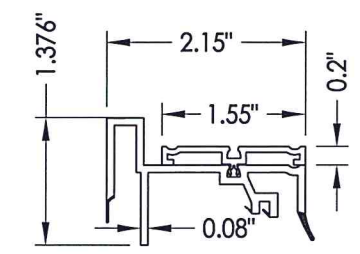

**76 INSWING SIDELITE ADAPTOR**



Lyndon F. Schmidt, P.E.  
TEXAS P.E. #104123

**RW BUILDING CONSULTANTS, INC.**  
P.O. Box 230 Valrico FL. 33595  
Phone No.: 813.659.9197

TEXAS BOARD OF PROFESSIONAL ENGINEERS  
CERTIFICATE OF REGISTRATION # F-11852

Documents Prepared By:

|                   |                                  |
|-------------------|----------------------------------|
| PRODUCT:          | R3 COMPOSITES                    |
| PART OR ASSEMBLY: | BILL OF MATERIALS AND COMPONENTS |

| NO. | DATE | BY |
|-----|------|----|
|     |      |    |
|     |      |    |
|     |      |    |
|     |      |    |
|     |      |    |
|     |      |    |
|     |      |    |
|     |      |    |
|     |      |    |

|              |          |
|--------------|----------|
| DATE:        | 7/20/15  |
| SCALE:       | N.T.S.   |
| DWG. BY:     | JK       |
| CHK. BY:     | LFS      |
| DRAWING NO.: | TX-4555  |
| SHEET        | 10 OF 10 |