

REVISIONS			
REV	DESCRIPTION	DATE	APPROVED
A	ADDED STRIKE AND GLASS DETAILS	01/06/16	R.L.

NOTES:

1. THE PRODUCT SHOWN HEREIN IS DESIGNED AND MANUFACTURED TO COMPLY WITH REQUIREMENTS OF THE 2006 IBC AND 2006 IRC WITH STATE OF TEXAS MODIFICATIONS.
2. WOOD FRAMING, METAL STRUCTURE AND MASONRY OPENING TO BE DESIGNED AND ANCHORED TO PROPERLY TRANSFER ALL LOADS TO STRUCTURE. FRAMING AND MASONRY OPENING IS THE RESPONSIBILITY OF THE ARCHITECT OR ENGINEER OF RECORD.
3. 1X BUCK OVER MASONRY/CONCRETE IS OPTIONAL. WHERE 1X BUCK IS NOT USED DISSIMILAR MATERIALS MUST BE SEPARATED WITH APPROVED COATING OR MEMBRANE. SELECTION OF COATING OR MEMBRANE IS THE RESPONSIBILITY OF THE ARCHITECT OR ENGINEER OF RECORD.
4. ALLOWABLE STRESS INCREASE OF 1/3 WAS NOT USED IN THE DESIGN OF THE PRODUCT SHOWN HEREIN. WIND LOAD DURATION FACTOR Cd=1.6 WAS USED FOR WOOD ANCHOR CALCULATIONS.
5. FRAME MATERIAL: COMPOSITE OR WOOD.  
DOOR SKIN MATERIAL: STEEL .033" THICK (MINIMUM), FIBERGLASS .085" THICK (MINIMUM)
6. UNITS MUST BE GLAZED PER ASTM E1300-04, SEE SHEET 7 FOR GLASS DETAILS.
7. APPROVED IMPACT PROTECTIVE SYSTEM IS REQUIRED FOR THIS PRODUCT IN WIND BORNE DEBRIS REGIONS.
8. SHIM AS REQUIRED AT EACH INSTALLATION ANCHOR WITH LOAD BEARING SHIM. SHIM WHERE SPACE OF 1/16" OR GREATER OCCURS. MAXIMUM ALLOWABLE SHIM STACK TO BE 1/4".
9. FOR ANCHORING INTO WOOD FRAMING OR 2X BUCK USE #8 WOOD SCREWS WITH SUFFICIENT LENGTH TO ACHIEVE A 1 1/4" MINIMUM EMBEDMENT INTO SUBSTRATE. LOCATE ANCHORS AS SHOWN IN ELEVATIONS AND INSTALLATION DETAILS.
10. FOR ANCHORING INTO MASONRY/CONCRETE USE 3/16" TAPCONS WITH SUFFICIENT LENGTH TO ACHIEVE A 1 1/4" MINIMUM EMBEDMENT INTO SUBSTRATE WITH 2 1/2" MINIMUM EDGE DISTANCE. LOCATE ANCHORS AS SHOWN IN ELEVATIONS AND INSTALLATION DETAILS.
11. FOR ANCHORING INTO METAL STRUCTURE USE #8 SMS OR SELF DRILLING SCREWS WITH SUFFICIENT LENGTH TO ACHIEVE 3 THREADS MINIMUM BEYOND STRUCTURE INTERIOR WALL. LOCATE ANCHORS AS SHOWN IN ELEVATIONS AND INSTALLATION DETAILS.
12. ALL FASTENERS TO BE CORROSION RESISTANT.
13. INSTALLATION ANCHORS SHALL BE INSTALLED IN ACCORDANCE WITH ANCHOR MANUFACTURER'S INSTALLATION INSTRUCTIONS AND ANCHORS SHALL NOT BE USED IN SUBSTRATES WITH STRENGTHS LESS THAN THE MINIMUM STRENGTH SPECIFIED BELOW:
  - A. WOOD – MINIMUM SPECIFIC GRAVITY OF G=0.42
  - B. CONCRETE – MINIMUM COMPRESSIVE STRENGTH OF 3,192 PSI.
  - C. MASONRY – STRENGTH CONFORMANCE TO ASTM C-90, GRADE N, TYPE 1 (OR GREATER).
  - D. METAL STRUCTURE: STEEL 18GA, 33KSI OR ALUMINUM 6063-T5 1/8" THICK MINIMUM

SIGNED: 01/07/2016

TABLE OF CONTENTS	
SHEET NO.	DESCRIPTION
1	NOTES
2	ELEVATIONS
3 - 7	INSTALLATION DETAILS

PROVIA DOOR, INC. 2150 STATE ROUTE 39 SUGARCREEK, OH 44681		
STEEL/FIBERGLASS INSWING GLAZED DOOR SINGLE & DOUBLE NI COMPOSITE/WOOD FRAME NOTES		
DRAWN: V.L.	DWG NO. 08-02396	REV A
SCALE NTS	DATE 07/21/14	SHEET 1 OF 7

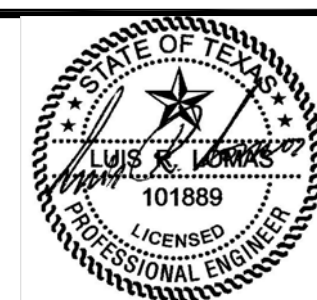

Luis R. Lomas P.E.  
TX No.: 101889

REVISIONS			
REV	DESCRIPTION	DATE	APPROVED
A	ADDED STRIKE AND GLASS DETAILS	01/06/16	R.L.

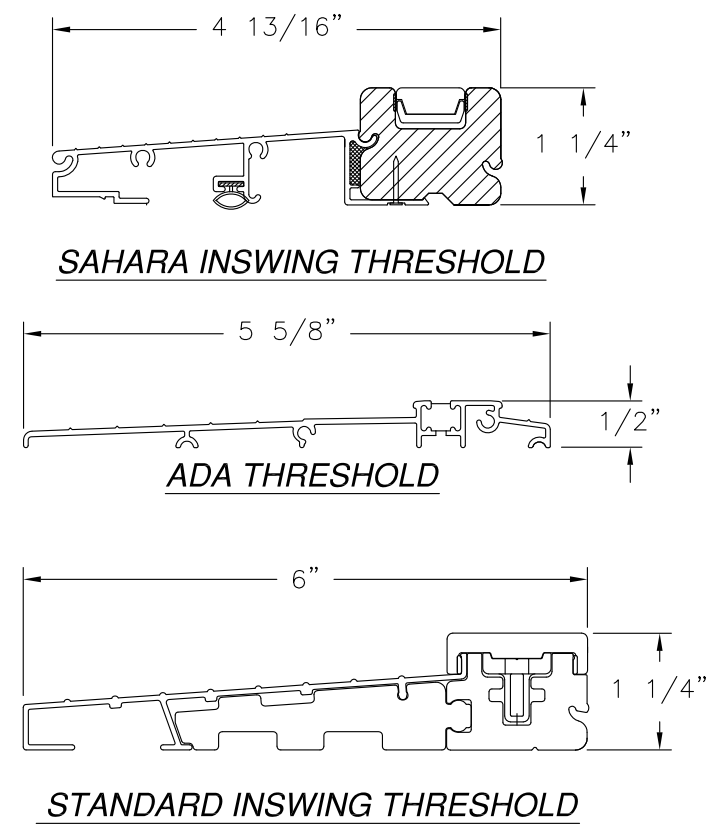
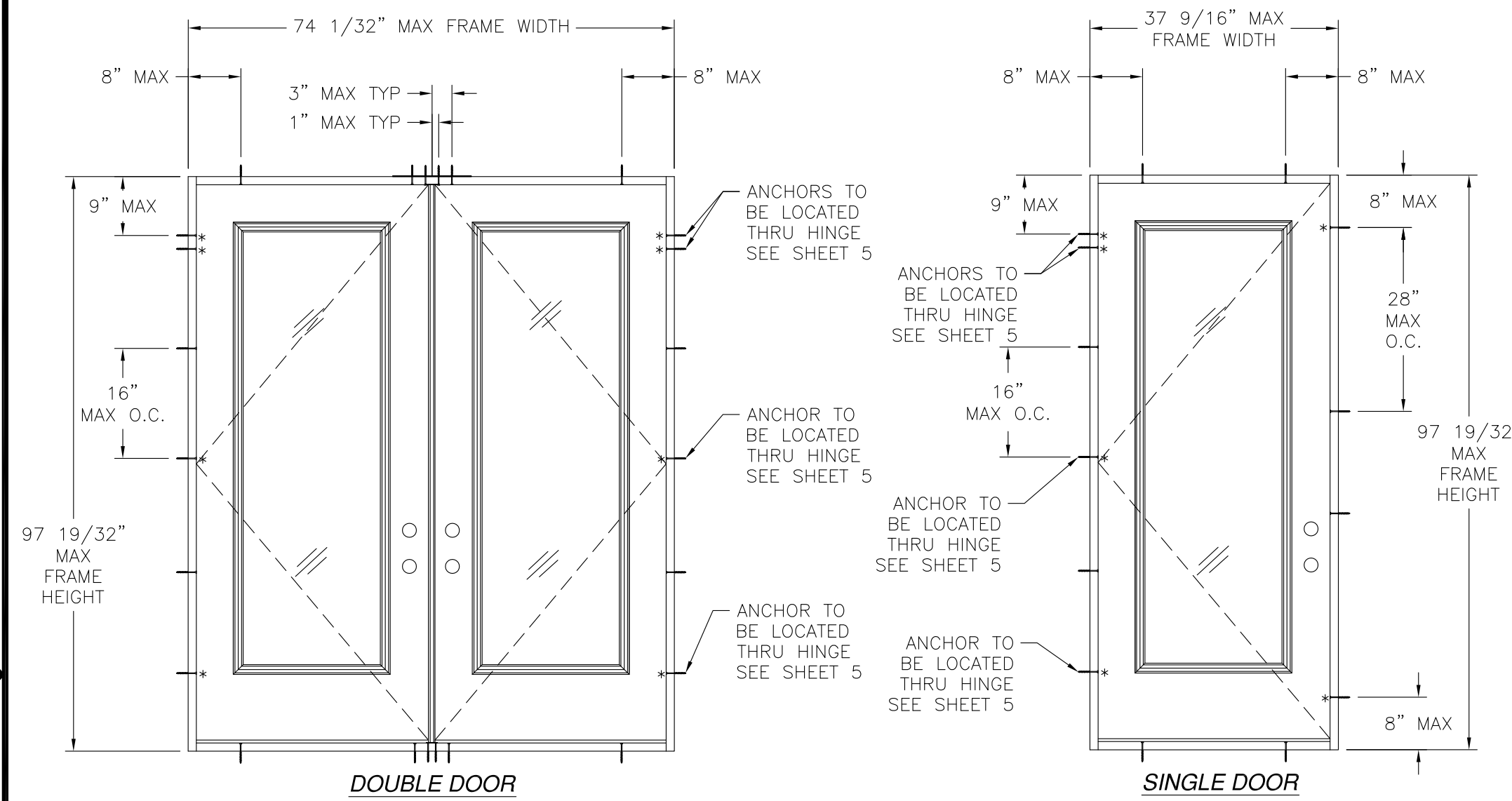

DESIGN PRESSURE RATING	IMPACT RATING
±55.0PSF	NONE
DESIGN PRESSURE RATING	IMPACT RATING
+48.0/-52.0PSF	NONE

WITH FIBERGLASS SLAB

HARDWARE SCHEDULE
A. F-SERIES ASSEMBLY DOOR KNOB BY SCHLAGE.
B. B-SERIES DEADBOLT ASSEMBLY BY SCHLAGE
C. F-SERIES DEADBOLT ASSEMBLY BY SCHLAGE
D. EMTEK RESIDENTIAL GRADE DOOR HANDLE ASSEMBLY (ALTERNATE)
E. TRILLENIUM MULTI-POINT LOCK HANDLE ASSEMBLY (ALTERNATE)
F. INSWING HURRICANE ASTRAGAL BY ENDURA
G. (3) 4" X 4" BALL BEARING HINGES BY PENROD
H. (3) 4" X 4" SPRING BOMMER HINGES BY PENROD (ALTERNATE)

- NOTES;
- HINGES ARE LOCATED AT 10", 50" AND 89" FROM TOP CORNER.
  - APPROVED CONFIGURATIONS MAY BE RIGHT OR LEFT HAND.
  - MAXIMUM PANEL SIZE 35 3/4" X 95".
  - MAXIMUM D.L.O. 20 3/8" X 78 1/2".
  - JAMBS ARE ASSEMBLED TO HEAD FRAME WITH (3) #8X3" WOOD SCREWS AT EACH JAMB.
  - JAMBS ARE ASSEMBLED TO THRESHOLD WITH (3) #6X1-1/2" WOOD SCREWS AT EACH JAMB.

PROVIA DOOR, INC.  
 2150 STATE ROUTE 39  
 SUGARCREEK, OH 44681

STEEL/FIBERGLASS INSWING GLAZED DOOR  
 SINGLE & DOUBLE NI COMPOSITE/WOOD FRAME  
 ELEVATIONS

DRAWN: V.L.      DWG NO. 08-02396      REV A

SCALE NTS      DATE 07/21/14      SHEET 2 OF 7

SIGNED: 01/07/2016

Luis R. Lomas P.E.  
 TX No.: 101889

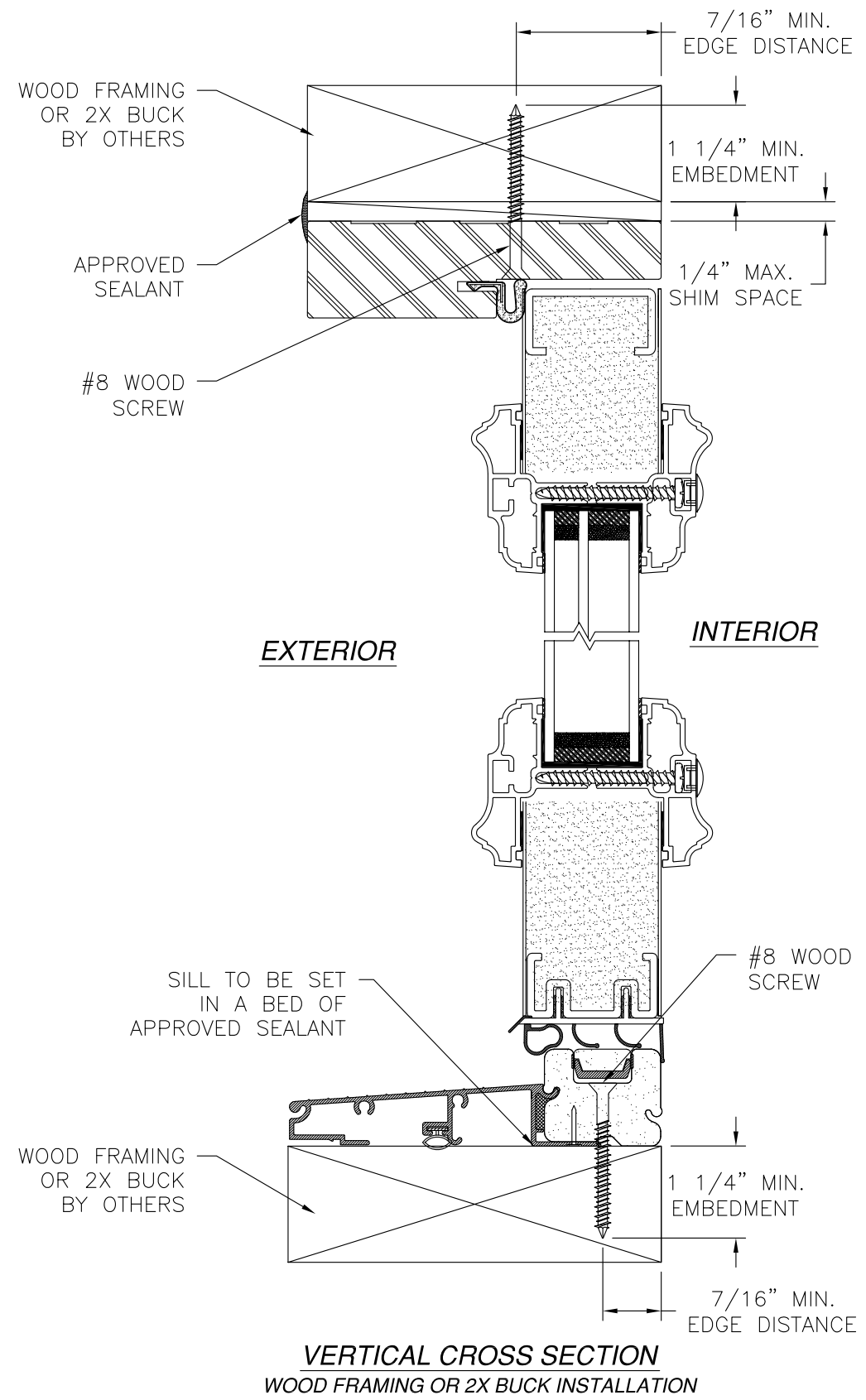

**VERTICAL CROSS SECTION**  
WOOD FRAMING OR 2X BUCK INSTALLATION

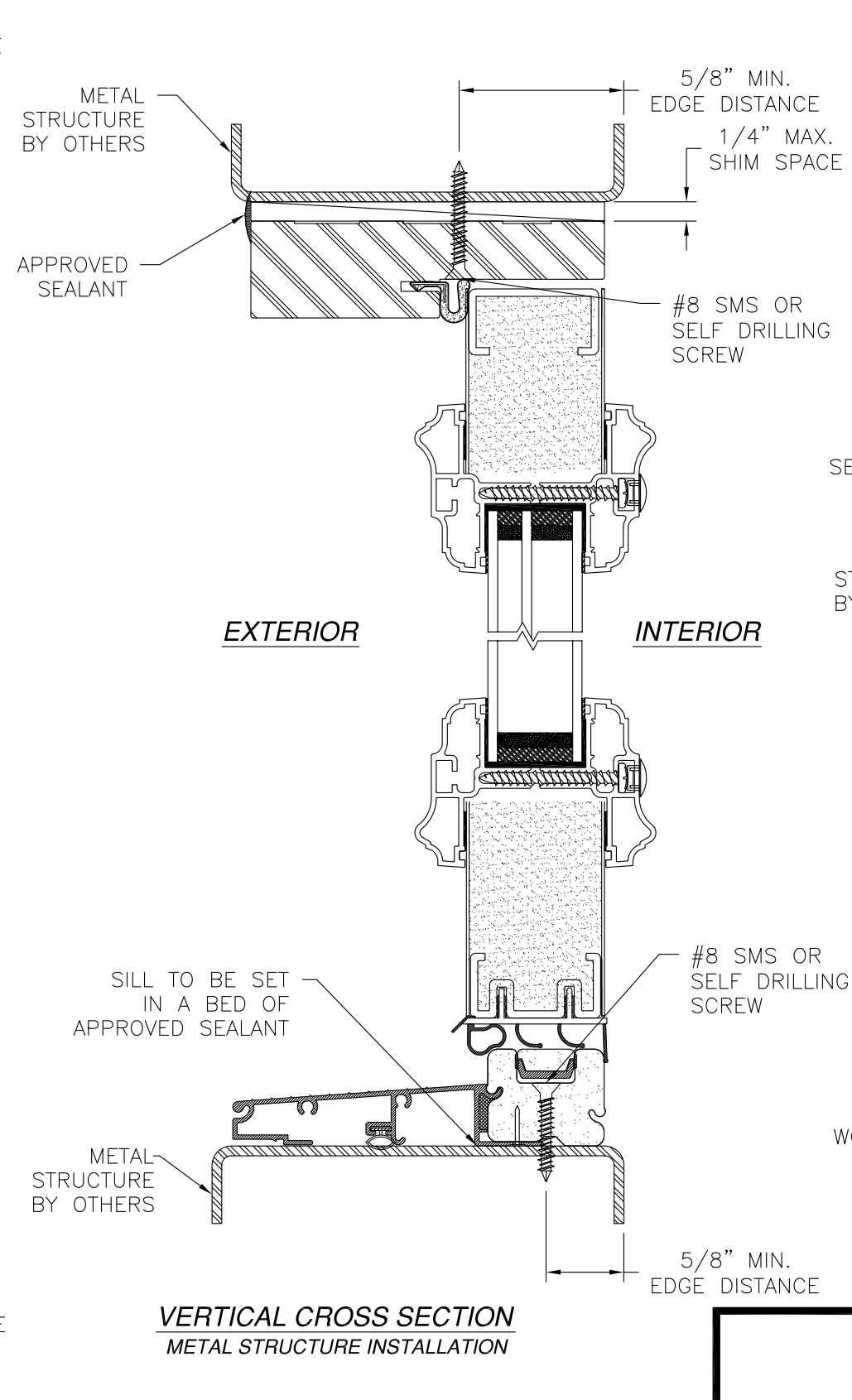

**VERTICAL CROSS SECTION**  
METAL STRUCTURE INSTALLATION

REVISIONS			
REV	DESCRIPTION	DATE	APPROVED
A	ADDED STRIKE AND GLASS DETAILS	01/06/16	R.L.

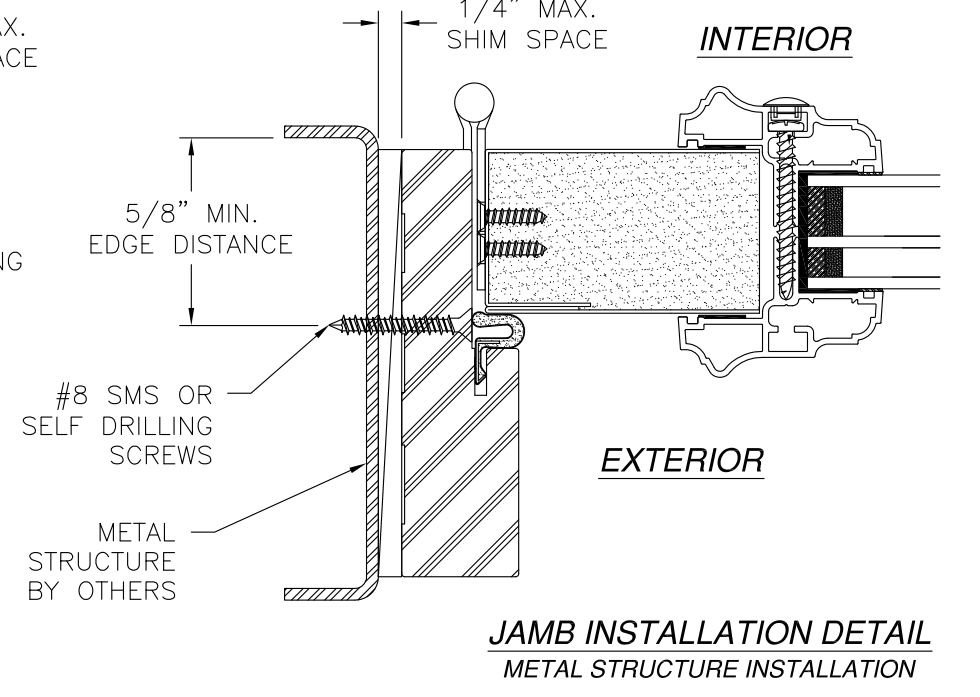

**JAMB INSTALLATION DETAIL**  
METAL STRUCTURE INSTALLATION

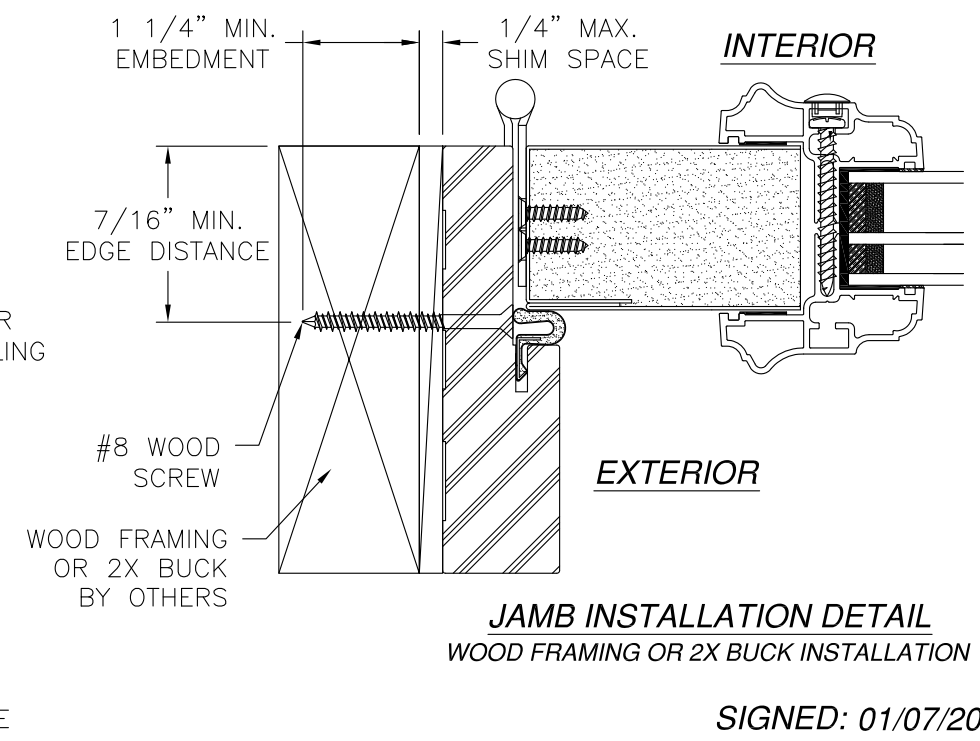

**JAMB INSTALLATION DETAIL**  
WOOD FRAMING OR 2X BUCK INSTALLATION

SIGNED: 01/07/2016

- NOTES:**
1. INTERIOR AND EXTERIOR FINISHES, BY OTHERS, NOT SHOWN FOR CLARITY.
  2. PERIMETER AND JOINT SEALANT BY OTHERS TO BE DESIGNED IN ACCORDANCE WITH ASTM E2112

**PROVIA DOOR, INC.**  
2150 STATE ROUTE 39  
SUGARCREEK, OH 44681

STEEL/FIBERGLASS INSWING GLAZED DOOR  
SINGLE & DOUBLE NI COMPOSITE/WOOD FRAME  
INSTALLATION DETAILS

DRAWN: V.L.	DWG NO. 08-02396	REV A
SCALE NTS	DATE 07/21/14	SHEET 3 OF 7

Luis R. Lomas P.E.  
TX No.: 101889

REVISIONS			
REV	DESCRIPTION	DATE	APPROVED
A	ADDED STRIKE AND GLASS DETAILS	01/06/16	R.L.

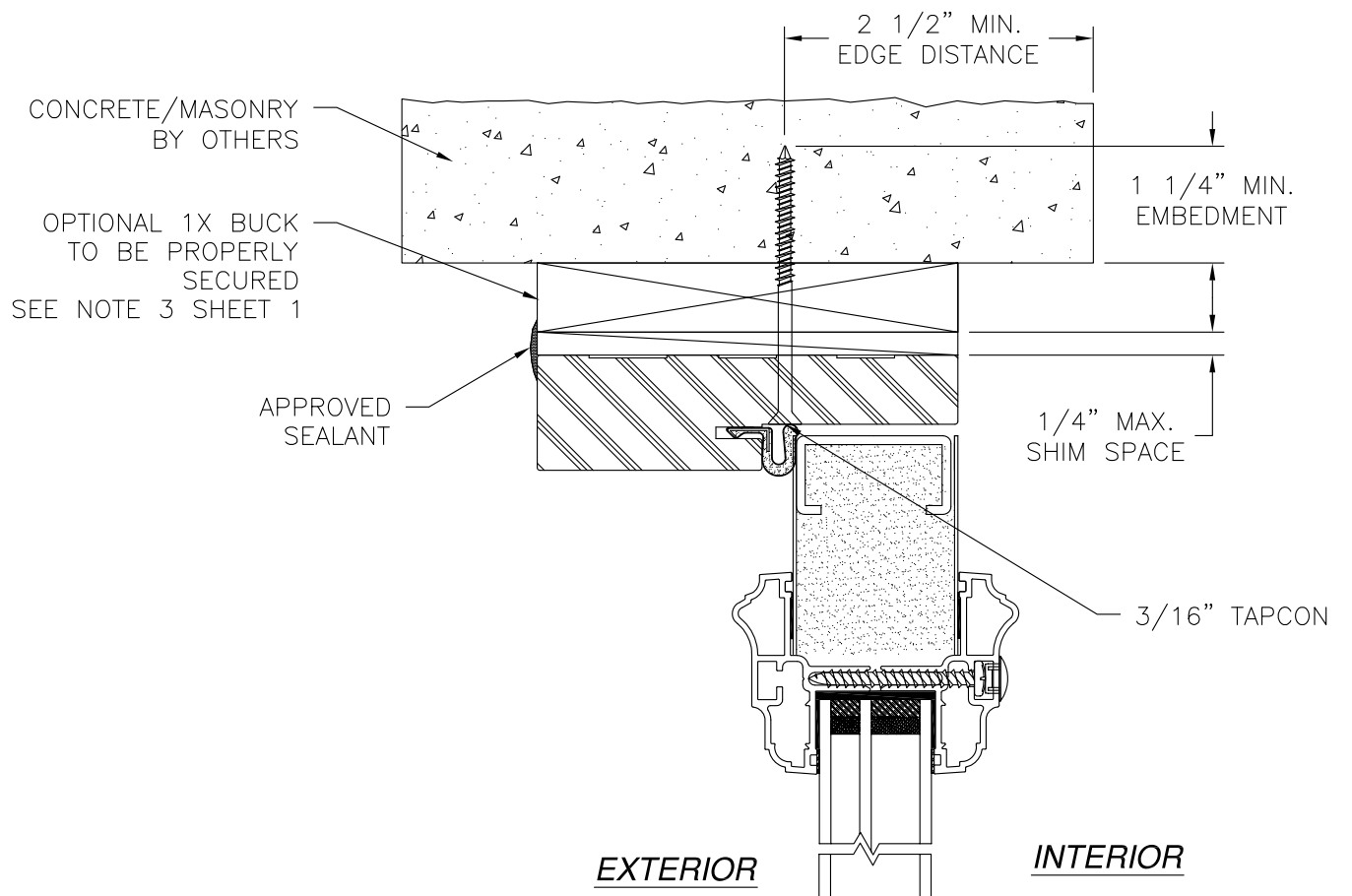

**EXTERIOR** **INTERIOR**

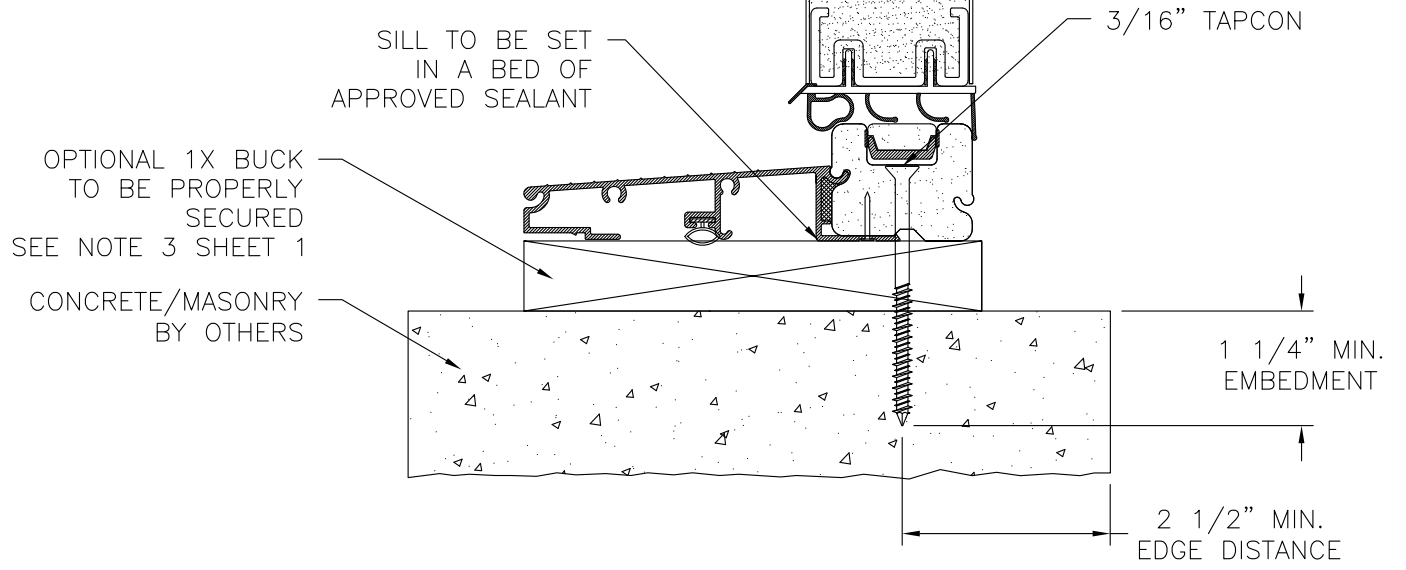

**VERTICAL CROSS SECTION**  
CONCRETE/MASONRY INSTALLATION

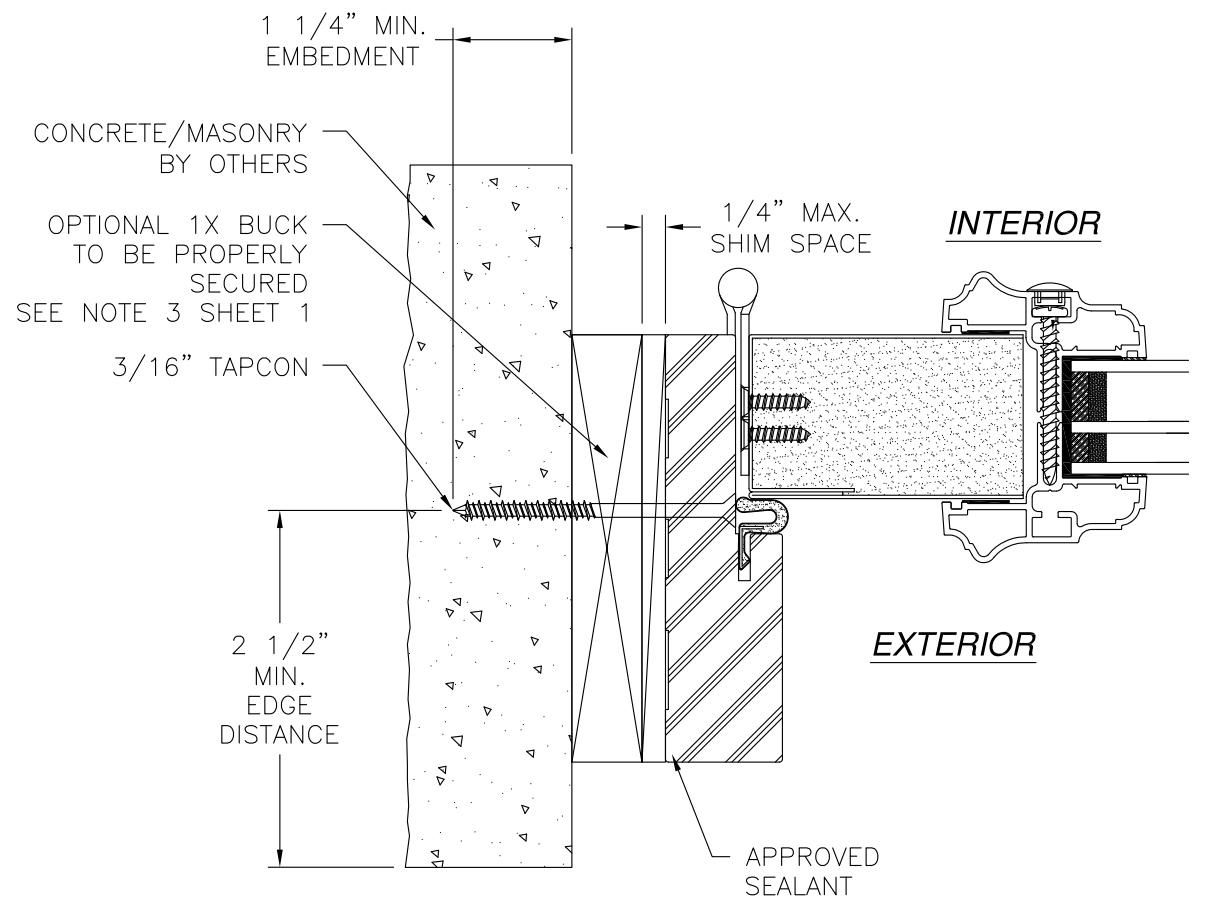

**JAMB INSTALLATION DETAIL**  
CONCRETE/MASONRY INSTALLATION

- NOTES:**
1. INTERIOR AND EXTERIOR FINISHES, BY OTHERS, NOT SHOWN FOR CLARITY.
  2. PERIMETER AND JOINT SEALANT BY OTHERS TO BE DESIGNED IN ACCORDANCE WITH ASTM E2112

SIGNED: 01/07/2016

**PROVIA DOOR, INC.**  
2150 STATE ROUTE 39  
SUGARCREEK, OH 44681

STEEL/FIBERGLASS INSWING GLAZED DOOR  
SINGLE & DOUBLE NI COMPOSITE/WOOD FRAME  
INSTALLATION DETAILS

DRAWN: V.L.	DWG NO. 08-02396	REV A
SCALE NTS	DATE 07/21/14	SHEET 4 OF 7

Luis R. Lomas P.E.  
TX No.: 101889

REVISIONS			
REV	DESCRIPTION	DATE	APPROVED
A	ADDED STRIKE AND GLASS DETAILS	01/06/16	R.L.

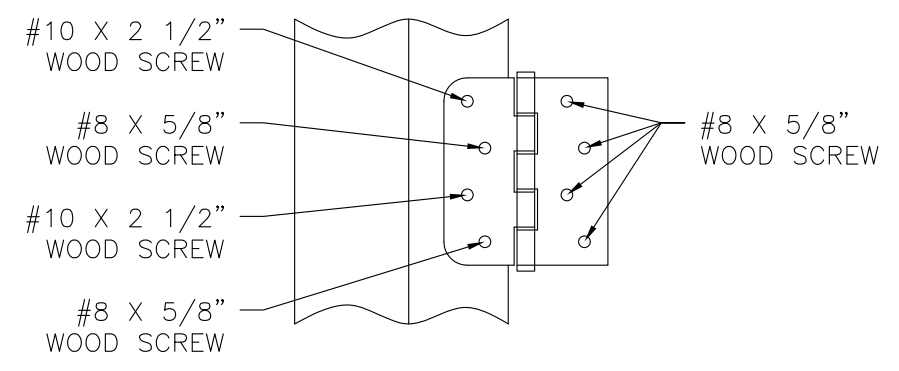

**HINGE INSTALLATION DETAIL**  
2X BUCK/WOOD FRAMING

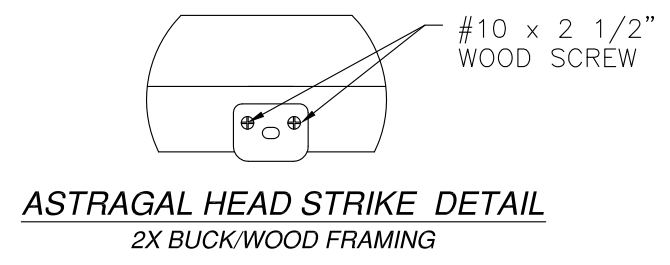

**ASTRAGAL HEAD STRIKE DETAIL**  
2X BUCK/WOOD FRAMING

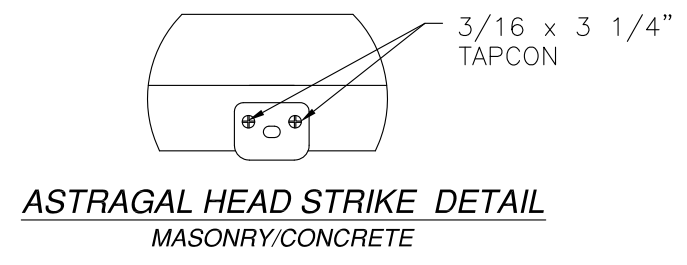

**ASTRAGAL HEAD STRIKE DETAIL**  
MASONRY/CONCRETE

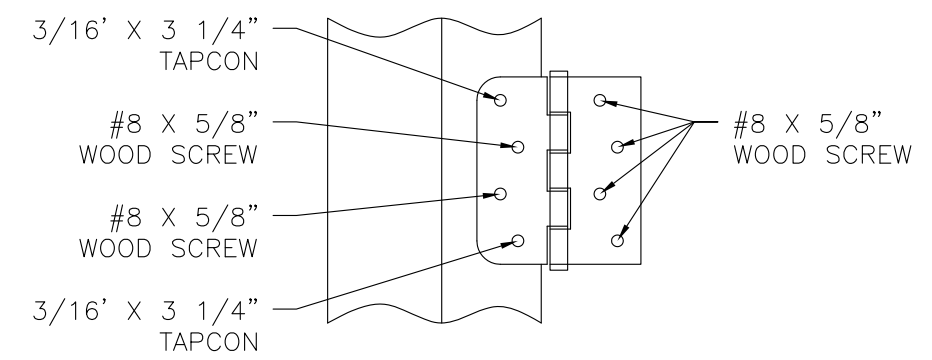

**HINGE INSTALLATION DETAIL**  
MASONRY/CONCRETE

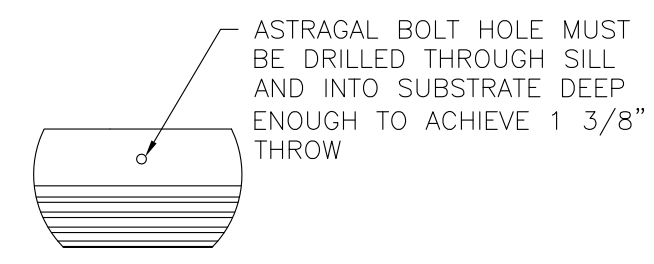

**ASTRAGAL SILL DETAIL**

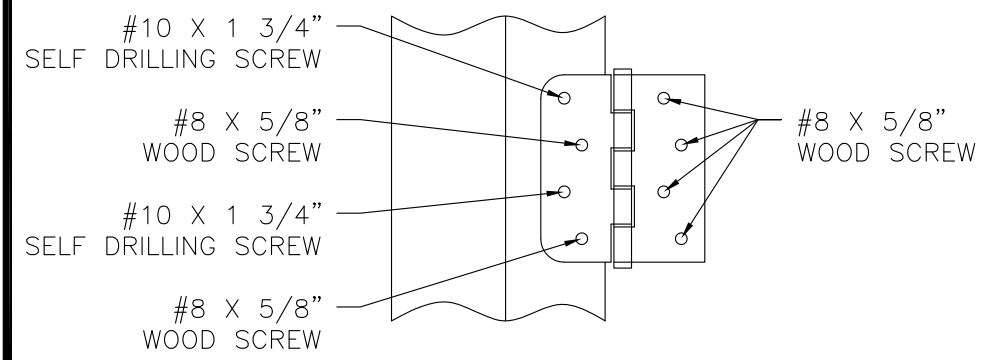

**HINGE INSTALLATION DETAIL**  
METAL STRUCTURE

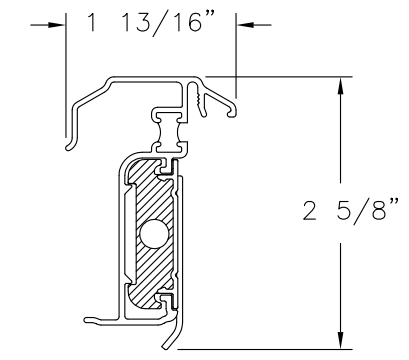

**HURRICANE ASTRAGAL DETAIL**

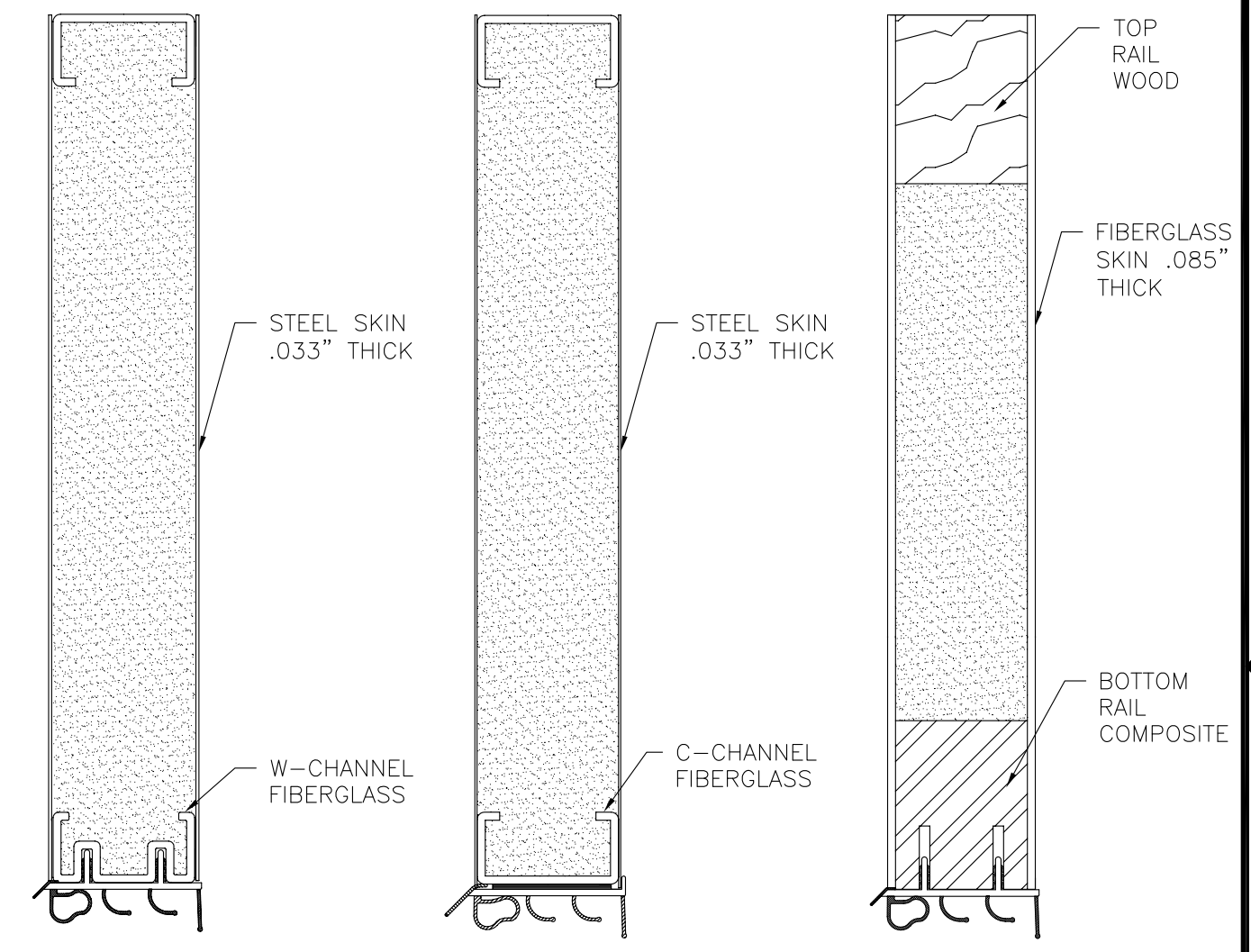

**20GA STEEL**      **20GA STEEL**      **FIBERGLASS**  
**APPROVED SLABS**

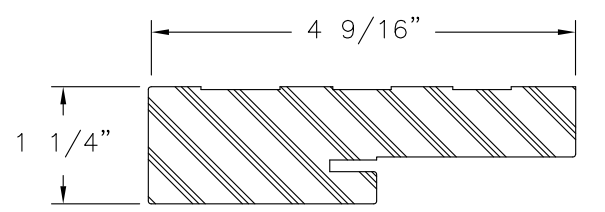

**COMPOSITE FRAME PROFILE**

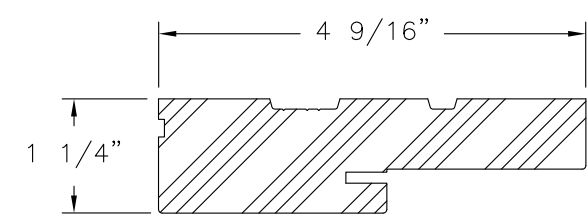

**WOOD FRAME PROFILE**

PROVIA DOOR, INC.  
2150 STATE ROUTE 39  
SUGARCREEK, OH 44681

STEEL/FIBERGLASS INSWING GLAZED DOOR  
SINGLE & DOUBLE NI COMPOSITE/WOOD FRAME  
INSTALLATION DETAILS

DRAWN: V.L.	DWG NO. 08-02396	REV A
SCALE NTS	DATE 07/21/14	SHEET 5 OF 7

SIGNED: 01/07/2016

Luis R. Lomas P.E.  
TX No.: 101889

REVISIONS			
REV	DESCRIPTION	DATE	APPROVED
A	ADDED STRIKE AND GLASS DETAILS	01/06/16	R.L.

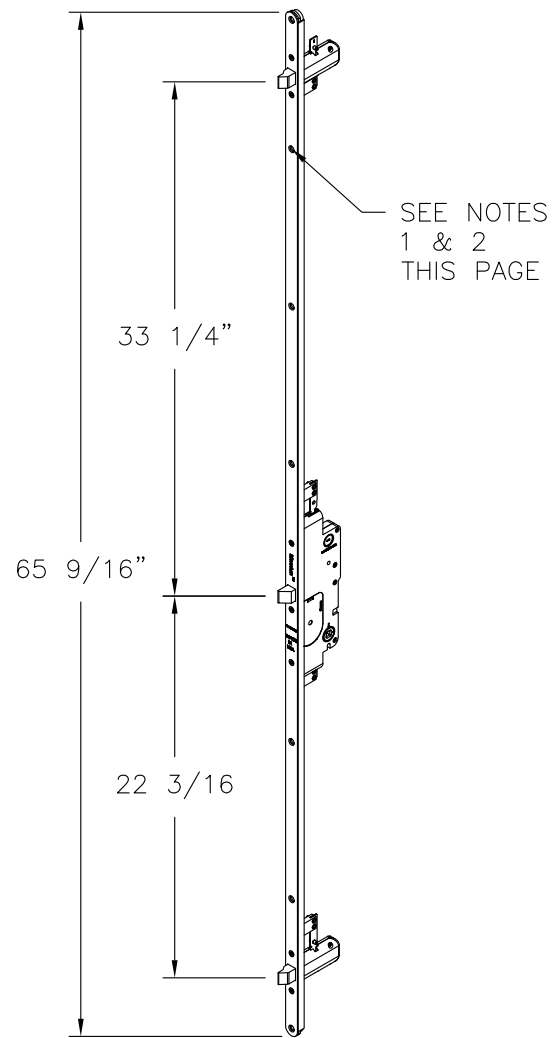

TRILENNIUM 3000

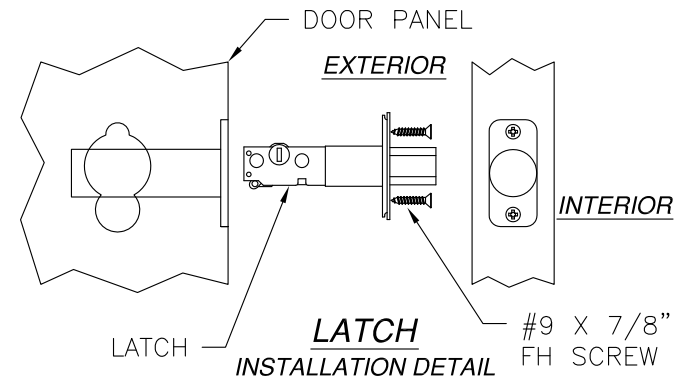
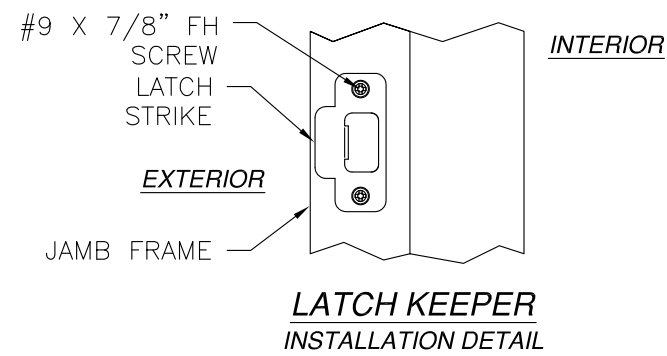
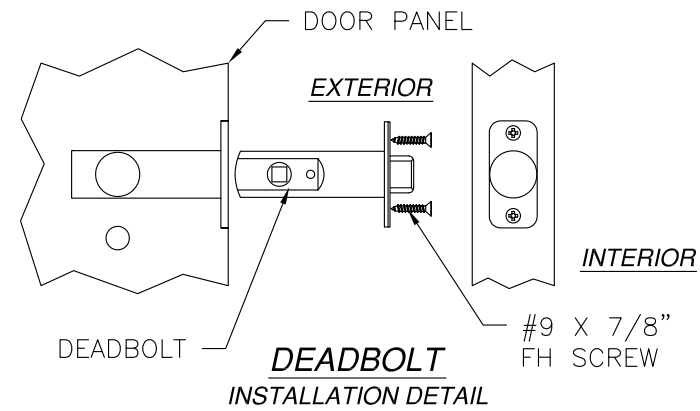
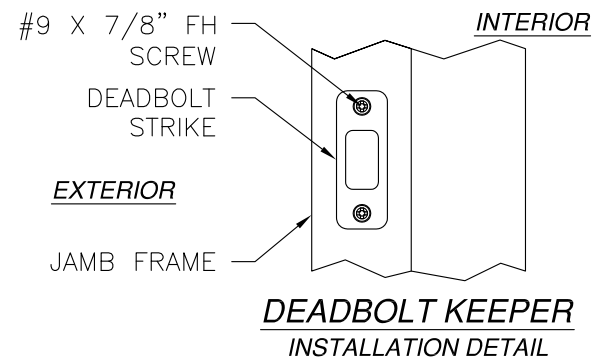

- NOTES:
- MULTIPOINT LOCK TO BE ATTACHED TO DOOR STILE USING (7) #10 X 1" FH WOOD SCREWS LOCATED IN PRE-DRILLED HOLES.
  - MULTIPOINT LOCK STRIKE PLATES TO BE ATTACHED TO JAMBS OR DOOR PANELS USING (2) #10 X 1" FH WOOD SCREWS & (1) #10 X 2 1/2" FH WOOD SCREW AT EACH LOCK LOCATION.

PROVIA DOOR, INC.  
2150 STATE ROUTE 39  
SUGARCREEK, OH 44681

STEEL/FIBERGLASS INSWING GLAZED DOOR  
SINGLE & DOUBLE NI COMPOSITE/WOOD FRAME  
INSTALLATION DETAILS

DRAWN: V.L.	DWG NO. 08-02396	REV A
SCALE NTS	DATE 07/21/14	SHEET 6 OF 7

SIGNED: 01/07/2016



Luis R. Lomas P.E.  
TX No.: 101889

REVISIONS			
REV	DESCRIPTION	DATE	APPROVED
A	ADDED STRIKE AND GLASS DETAILS	01/06/16	R.L.

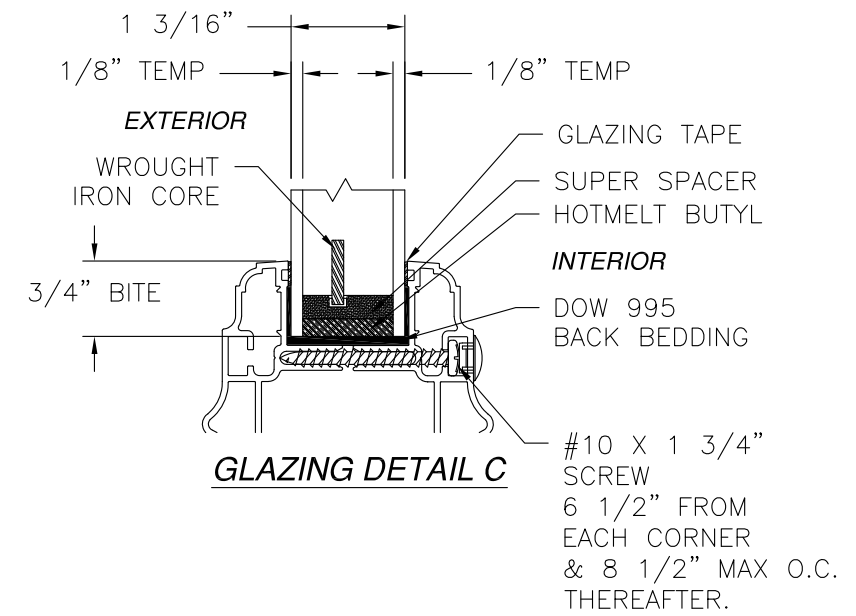
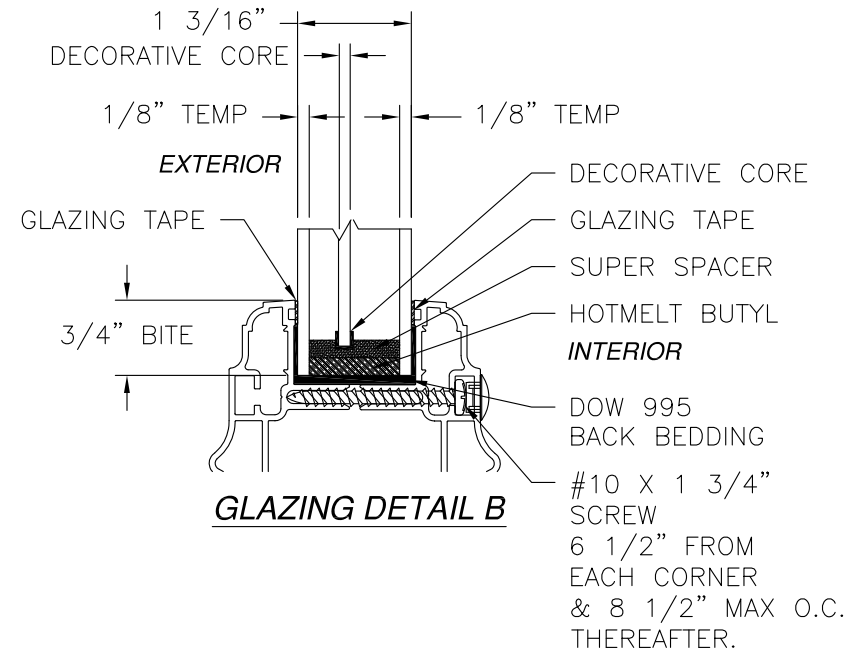
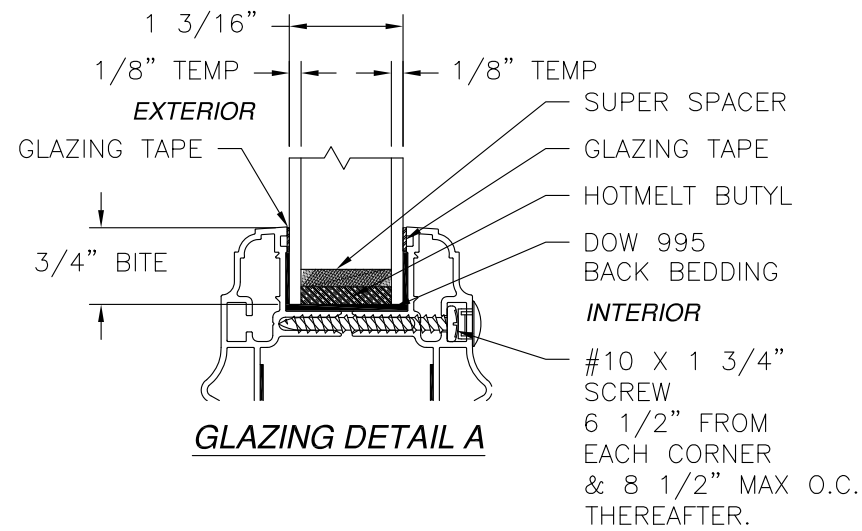

SIGNED: 01/07/2016

PROVIA DOOR, INC.  
2150 STATE ROUTE 39  
SUGARCREEK, OH 44681

STEEL/FIBERGLASS INSWING GLAZED DOOR  
SINGLE & DOUBLE NI COMPOSITE/WOOD FRAME  
INSTALLATION DETAILS

DRAWN: V.L.	DWG NO. 08-02396	REV A
SCALE NTS	DATE 07/21/14	SHEET 7 OF 7



Luis R. Lomas P.E.  
TX No.: 101889