

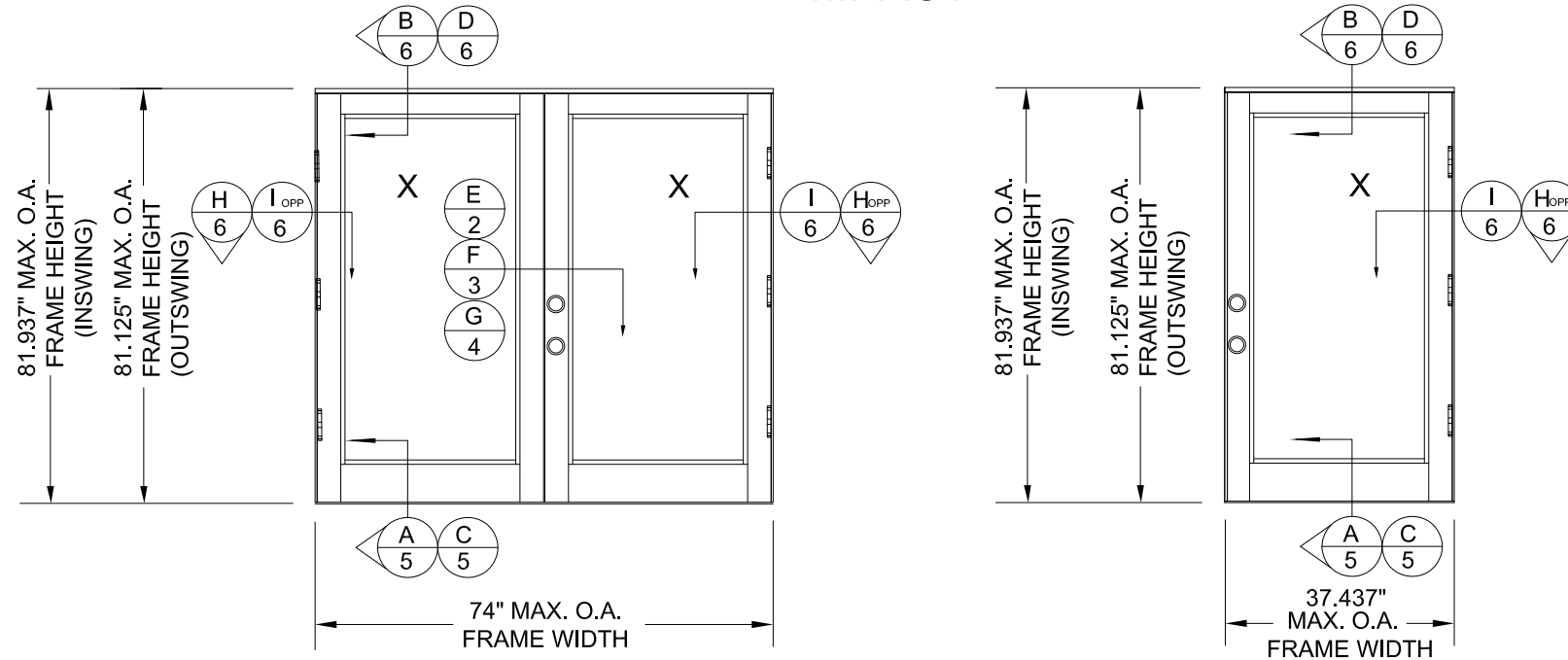

## MASONITE GLAZED 6'-8" FIBERGLASS DOOR XX AND X, INSWING / OUTSWING IMPACT



DOUBLE DOOR ELEVATION

SINGLE DOOR ELEVATION

Configuration	Frame size (in)	Design pressure rating (psf)	Impact rating
In-swing XX	74" x 81.937"	+50.0 -50.0	Large and Small
Out-swing XX	74" x 81.125"	+50.0 -50.0	
In-swing X	37.437" x 81.937"	+50.0 -50.0	Missile
Out-swing X	37.437" x 81.125"	+50.0 -50.0	

Masonite fiberglass insert glazed panels SMC 0.075" skin  
Refer to sheets 2, 3 & 4 for all hardware options  
Refer to sheet 5 for impact glazing insert options

TABLE OF CONTENTS	
SHEET	SHEET DESCRIPTION
1	ELEVATION AND GENERAL NOTES
2 - 4	ASTRAGAL & LOCK DETAILS
5	SILL AND GLAZING DETAILS
6	VERTICAL & HORIZONTAL CROSS SECTIONS
7 - 8	ANCHOR ELEVATIONS AND NOTES
9	COMPONENTS AND BILL OF MATERIALS

REVISIONS			
REV	DESCRIPTION	DATE	APPROVED
C	REVISED PER NEW CODE	11/10/2021	R.L.

GENERAL NOTES:

- THIS PRODUCT HAS BEEN EVALUATED AND IS IN COMPLIANCE WITH REQUIREMENTS OF THE 2018 IBC AND 2018 IRC.
- PRODUCT ANCHORS SHALL BE AS LISTED AND SPACED AS SHOWN ON DETAILS. ANCHOR EMBEDMENT TO BASE MATERIAL SHALL BE BEYOND WALL DRESSING.
- INSTALLATION DETAILS DESCRIBED HEREIN ARE GENERIC AND MAY NOT REFLECT ACTUAL CONDITIONS FOR A SPECIFIC SITE. IF INSTALLATION METHODS DEVIATE FROM THESE APPROVED DETAILS WOULD REQUIRE FURTHER INVESTIGATION BY A LICENSED REGISTERED DESIGN PROFESSIONAL IS REQUIRED.
- ADEQUACY OF EXISTING STRUCTURAL CONCRETE / MASONRY AND 2X FRAMING PER INSTALLATION AS A MAIN WIND FORCE RESISTING SYSTEM CAPABLE OF WITHSTANDING AND TRANSFERRING APPLIED PRODUCT LOADS TO FOUNDATION IS THE RESPONSIBILITY OF ENGINEER OR ARCHITECT OF RECORD.
- THIS PRODUCT IS IMPACT RATED AND DOES NOT REQUIRE IMPACT PROTECTION IN WIND BORNE DEBRIS REGIONS.
- 1X BUCK OVER MASONRY/CONCRETE IS OPTIONAL. WHERE 1X BUCK IS NOT USED DISSIMILAR MATERIALS MUST BE SEPARATED WITH APPROVED COATING OR MEMBRANE. SELECTION OF COATING OR MEMBRANE IS THE RESPONSIBILITY OF THE ARCHITECT OR ENGINEER OF RECORD.
- APPROVED CONFIGURATIONS: X, XX.

ENDURA PRODUCTS, INC.

8817 WEST MARKET STREET  
COLFAX, NC 27235

MASONITE GLAZED  
FIBERGLASS DOORS  
ELEVATIONS AND GENERAL NOTES

DRAWN: RM	DWG NO. NL-0017	REV C
SCALE NTS	DATE 09/04/13	SHEET 1 OF 9

L. ROBERTO LOMAS P.E.  
1432 WOODFORD RD LEWISVILLE, NC 27023  
434-688-0609 rllomas@rlomaspe.com

SIGNED: 11/10/2021



Luis R. Lomas P.E.  
TX No.: 101889

REVISIONS			
REV	DESCRIPTION	DATE	APPROVED
C	REVISED PER NEW CODE	11/10/2021	R.L.

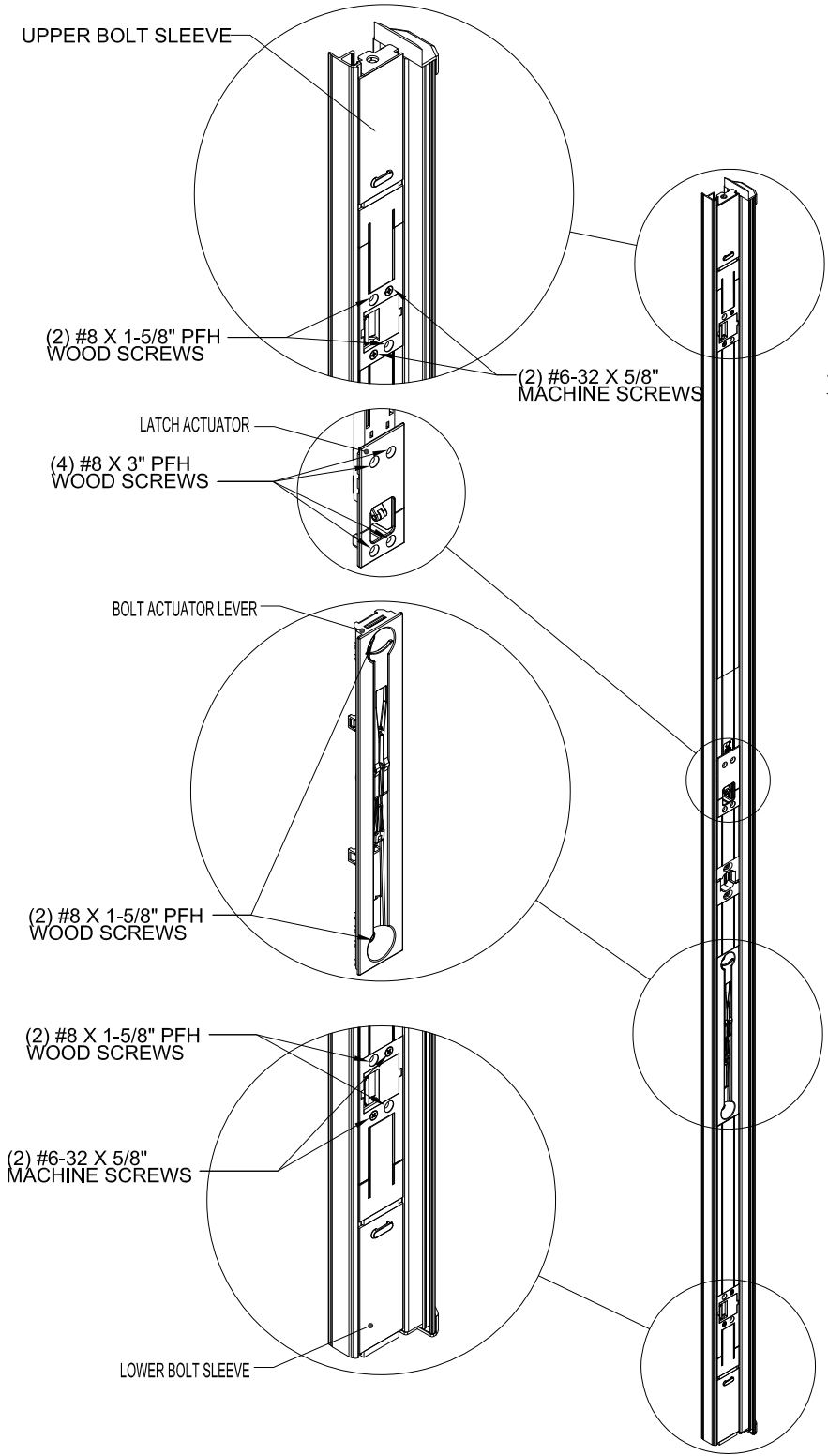

ULTIMATE MULTIPOINT ASTRAGAL

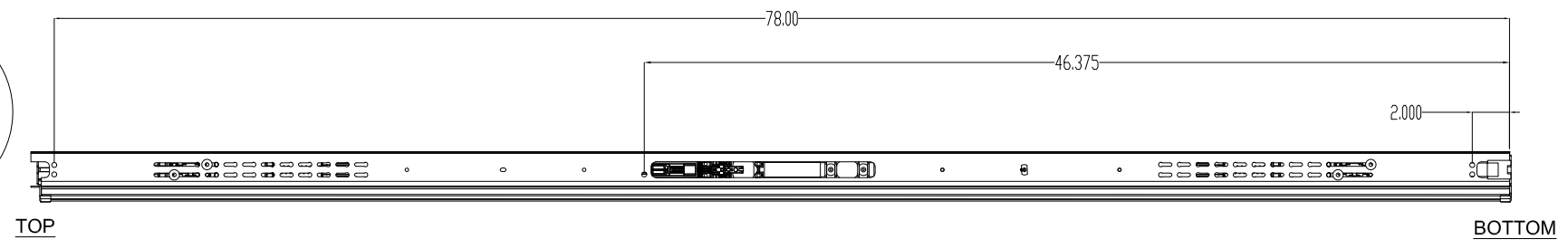

ANCHOR SCREW LOCATIONS

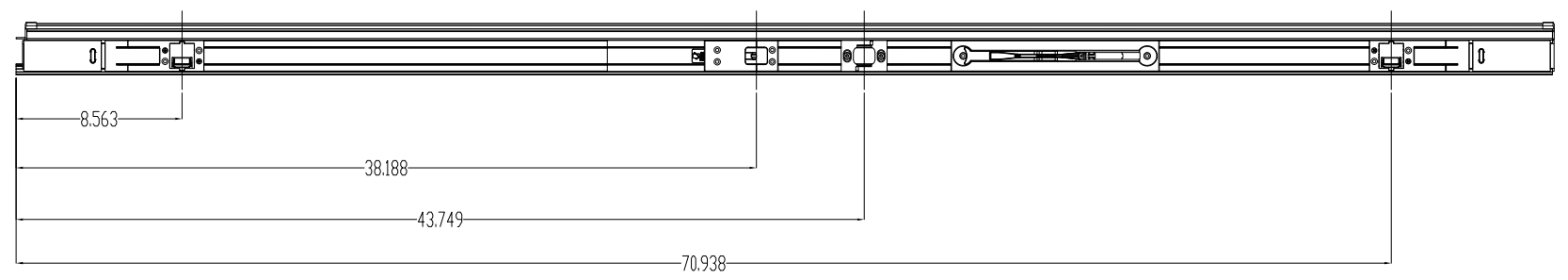

HARDWARE LOCATIONS

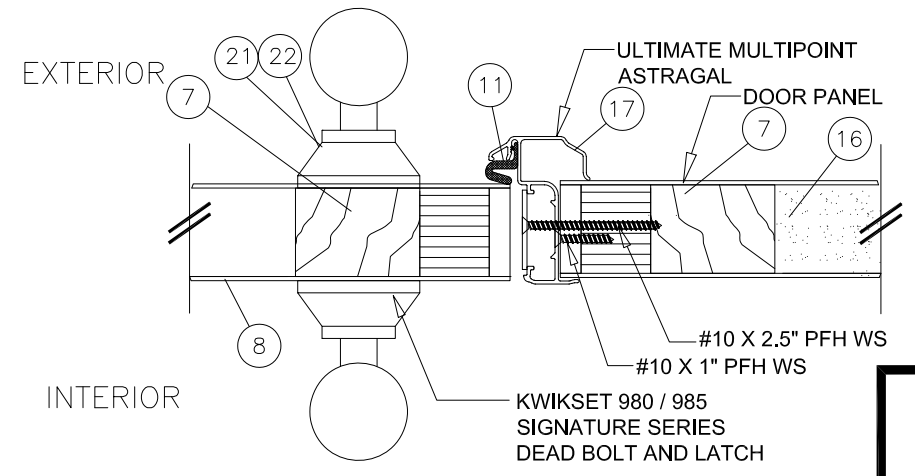

- (E) ASTRAGAL SECTION
- (2) INSWING SHOWN-OUTSWING SIMILAR

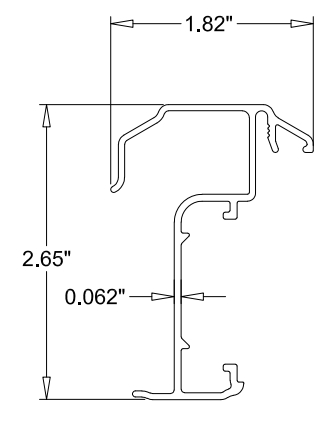

ASTRAGAL SECTION

SIGNED: 11/10/2021

**ENDURA PRODUCTS, INC.**  
 8817 WEST MARKET STREET  
 COLFAX, NC 27235

MASONITE GLAZED  
 FIBERGLASS DOORS  
 ASTRAGAL AND LOCK SET DETAILS

DRAWN: RM	DWG NO. NL-0017	REV C
SCALE NTS	DATE 09/04/13	SHEET 2 OF 9

L. ROBERTO LOMAS P.E.  
 1432 WOODFORD RD LEWISVILLE, NC 27023  
 434-688-0609 rllomas@rlomaspe.com



Luis R. Lomas P.E.  
 TX No.: 101889

REVISIONS			
REV	DESCRIPTION	DATE	APPROVED
C	REVISED PER NEW CODE	11/10/2021	R.L.

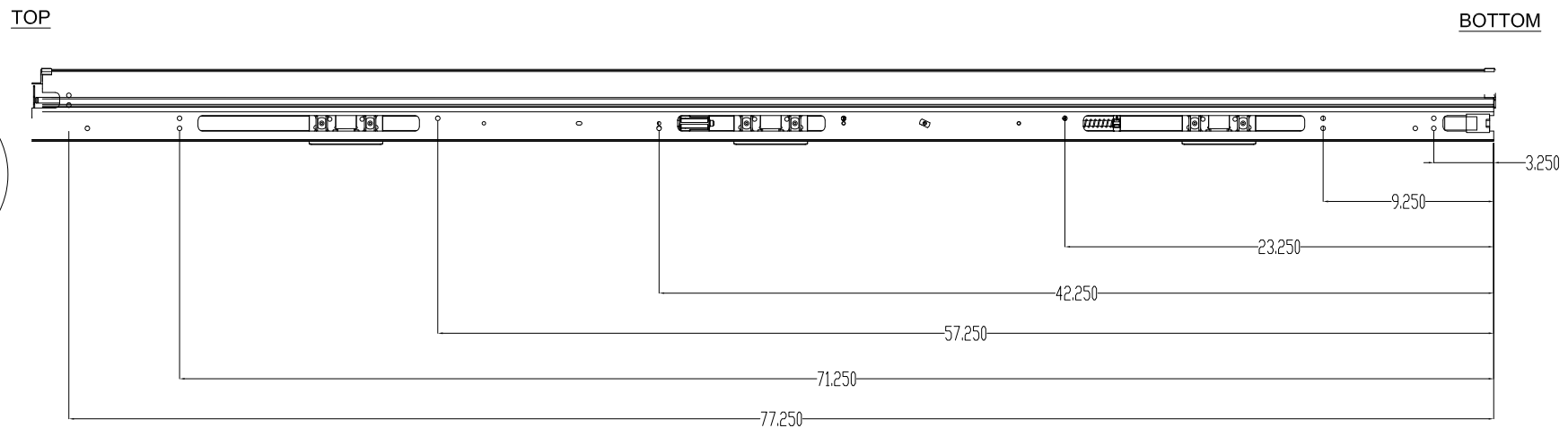

ANCHOR SCREW LOCATIONS

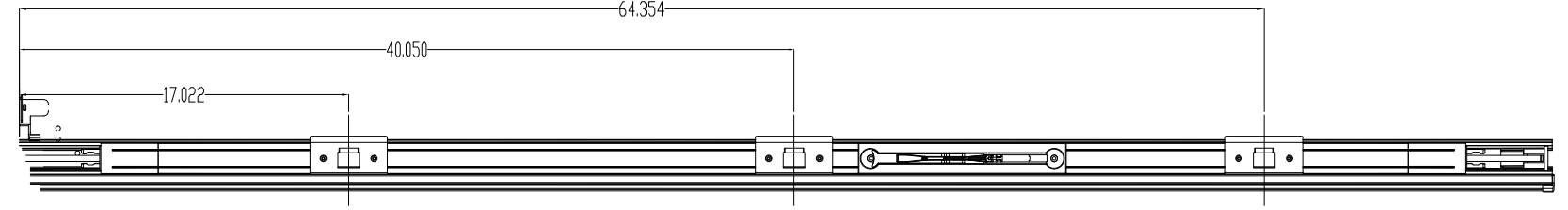

HARDWARE LOCATIONS

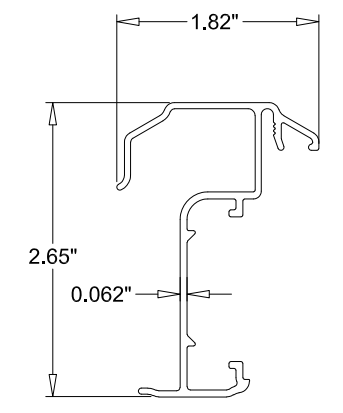
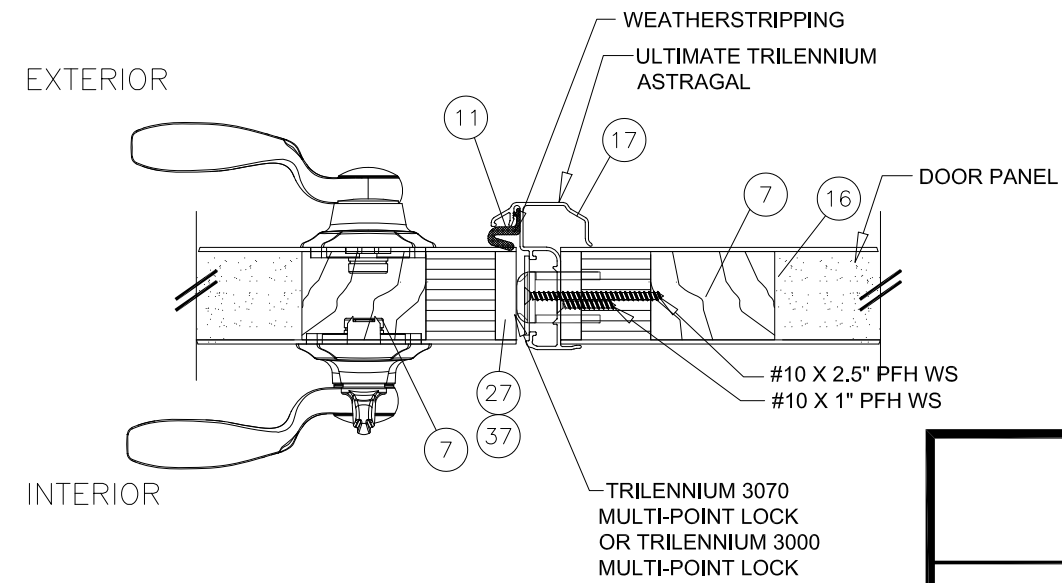

ASTRAGAL SECTION

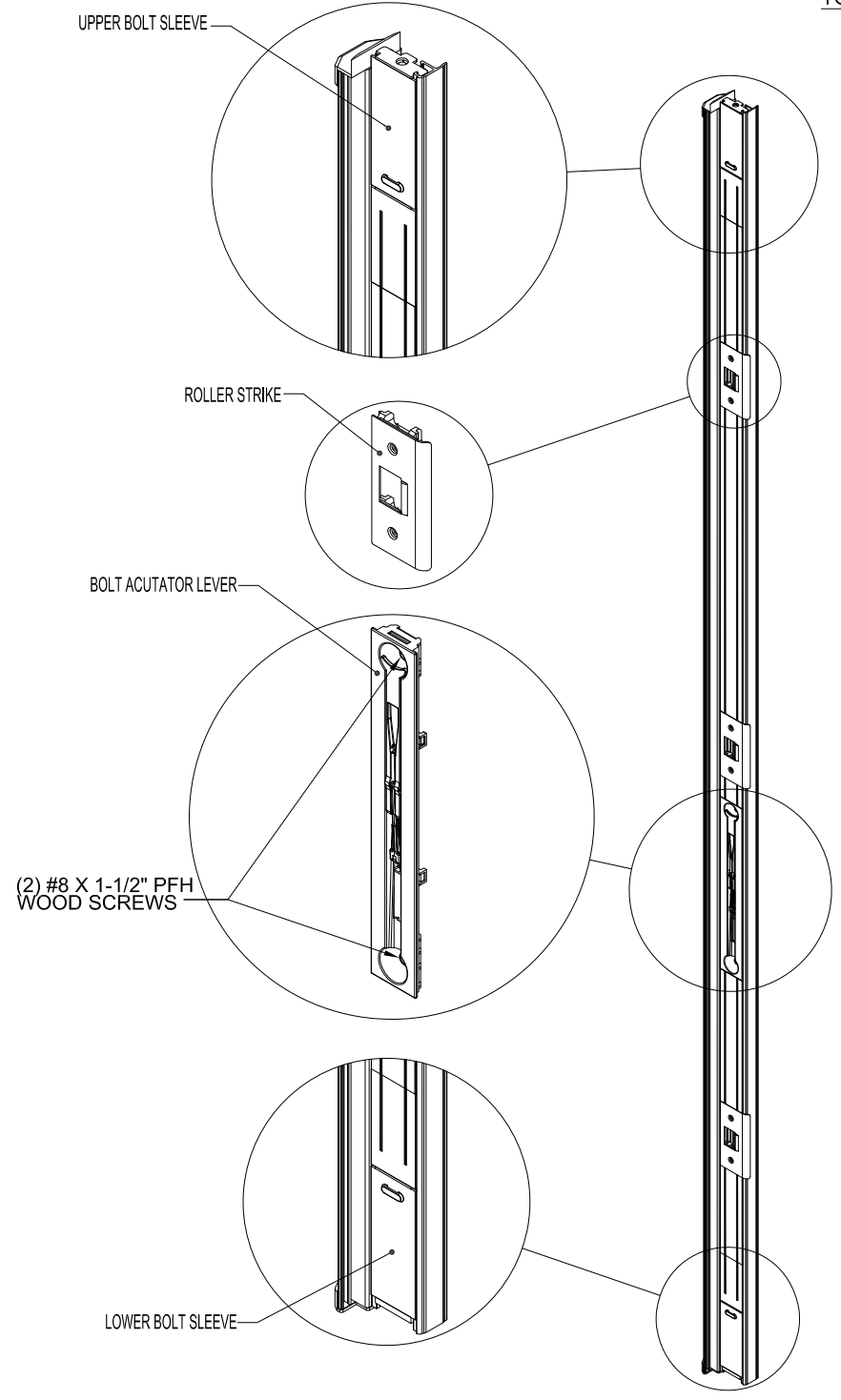

ULTIMATE TRIENNium ASTRAGAL

F  
3 ASTRAGAL SECTION  
INSWING SHOWN-OUTSWING SIMILAR

SIGNED: 11/10/2021

ENDURA PRODUCTS, INC.  
8817 WEST MARKET STREET  
COLFAX, NC 27235

MASONITE GLAZED  
FIBERGLASS DOORS  
ASTRAGAL AND LOCK SET DETAILS

DRAWN: RM	DWG NO. NL-0017	REV C
SCALE NTS	DATE 09/04/13	SHEET 3 OF 9

L. ROBERTO LOMAS P.E.  
1432 WOODFORD RD LEWISVILLE, NC 27023  
434-688-0609 rllomas@rlomaspe.com



Luis R. Lomas P.E.  
TX No.: 101889

REVISIONS			
REV	DESCRIPTION	DATE	APPROVED
C	REVISED PER NEW CODE	11/10/2021	R.L.

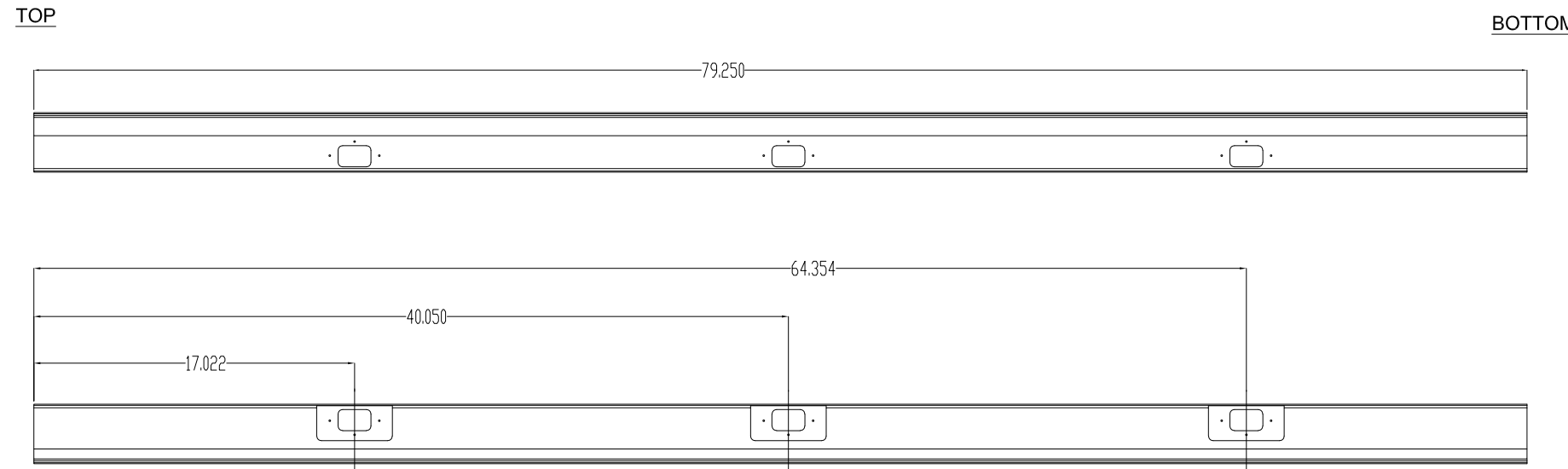

HARDWARE LOCATIONS

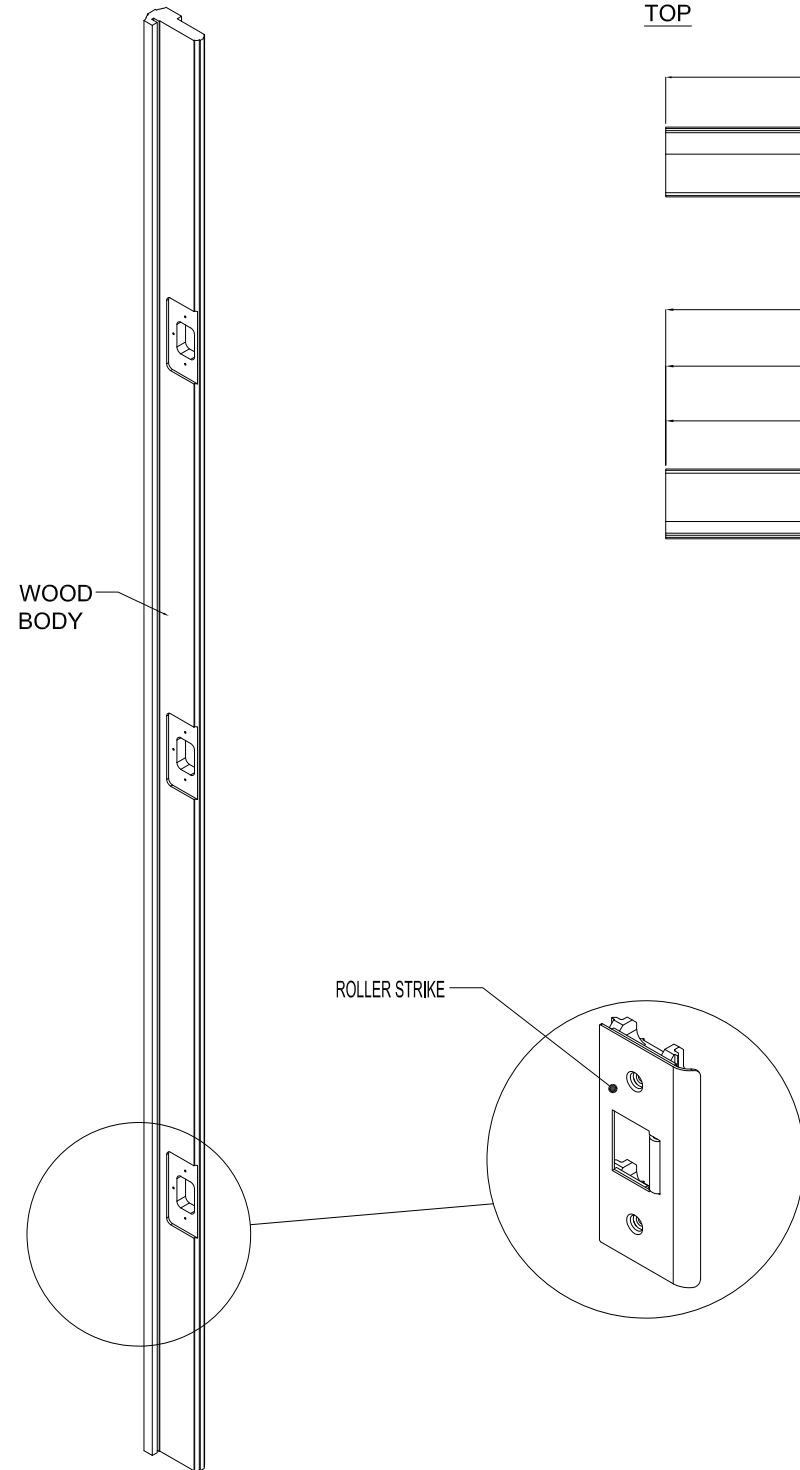

WOOD ASTRAGAL

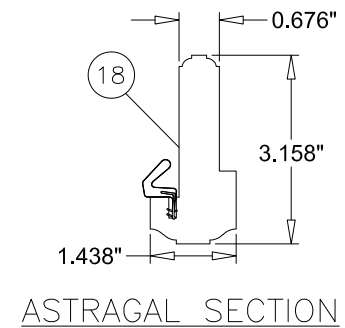
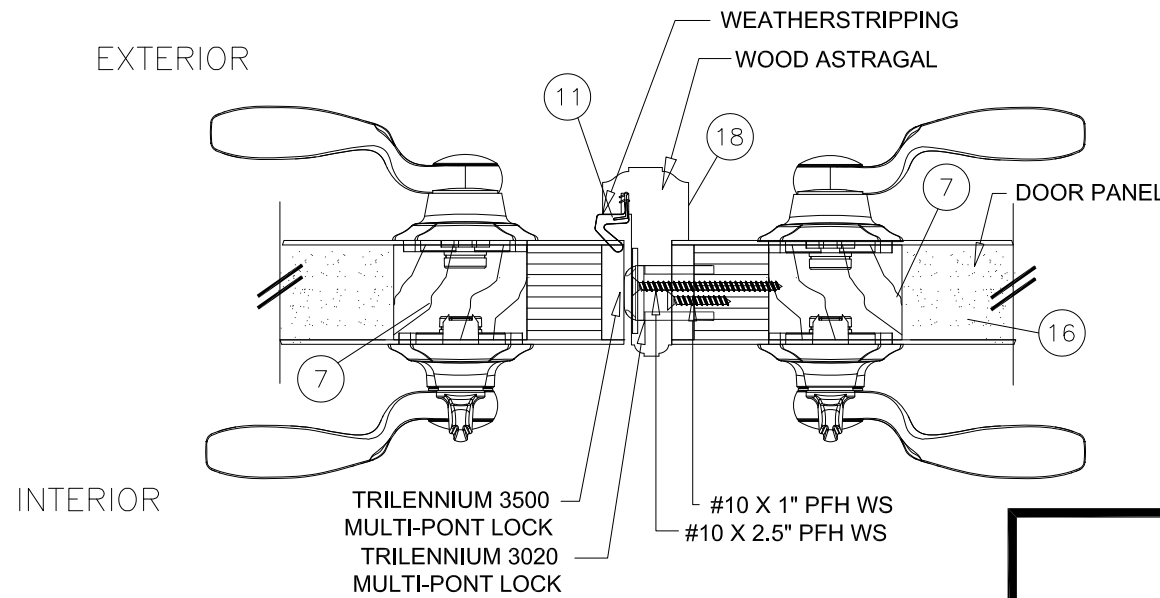

(G)  
4 ASTRAGAL SECTION  
INSWING SHOWN-OUTSWING SIMILAR

SIGNED: 11/10/2021

ENDURA PRODUCTS, INC.  
8817 WEST MARKET STREET  
COLFAX, NC 27235

MASONITE GLAZED  
FIBERGLASS DOORS  
ASTRAGAL AND LOCK SET DETAILS

DRAWN: RM	DWG NO. NL-0017	REV C
SCALE NTS	DATE 09/04/13	SHEET 4 OF 9

L. ROBERTO LOMAS P.E.  
1432 WOODFORD RD LEWISVILLE, NC 27023  
434-688-0609 rllomas@rlomaspe.com



Luis R. Lomas P.E.  
TX No.: 101889

REVISIONS			
REV	DESCRIPTION	DATE	APPROVED
C	REVISED PER NEW CODE	11/10/2021	R.L.

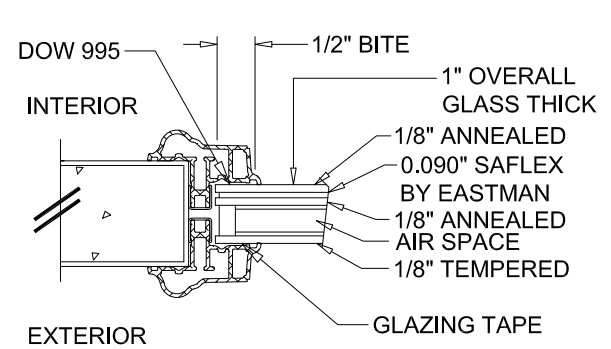

**J**  
**5** HORIZONTAL CROSS SECTION  
OD L SEVERE WEATHER  
GLAZING INSERT OPTION

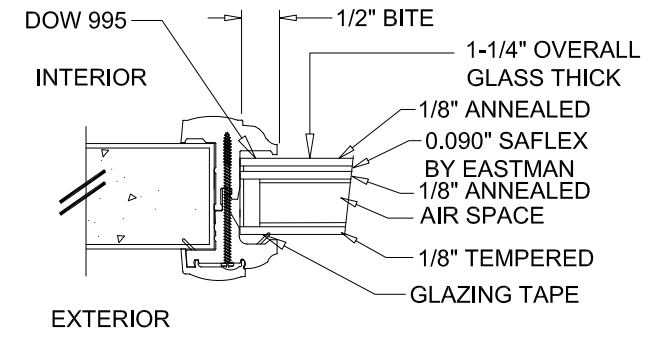

**K**  
**5** HORIZONTAL CROSS SECTION  
RSL HURRICANE IMPACT  
GLAZING INSERT OPTION

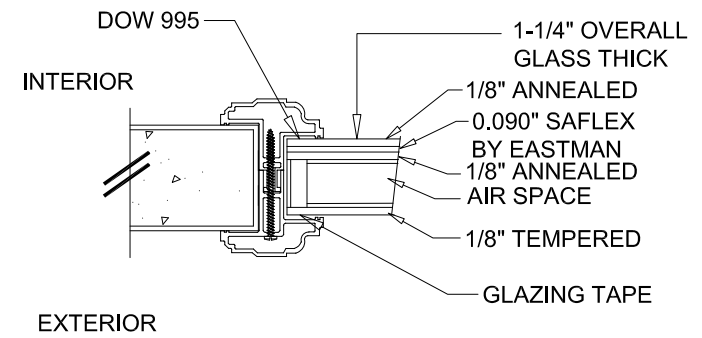

**L**  
**5** HORIZONTAL CROSS SECTION  
SPECIALTY IMPACT  
GLAZING INSERT OPTION

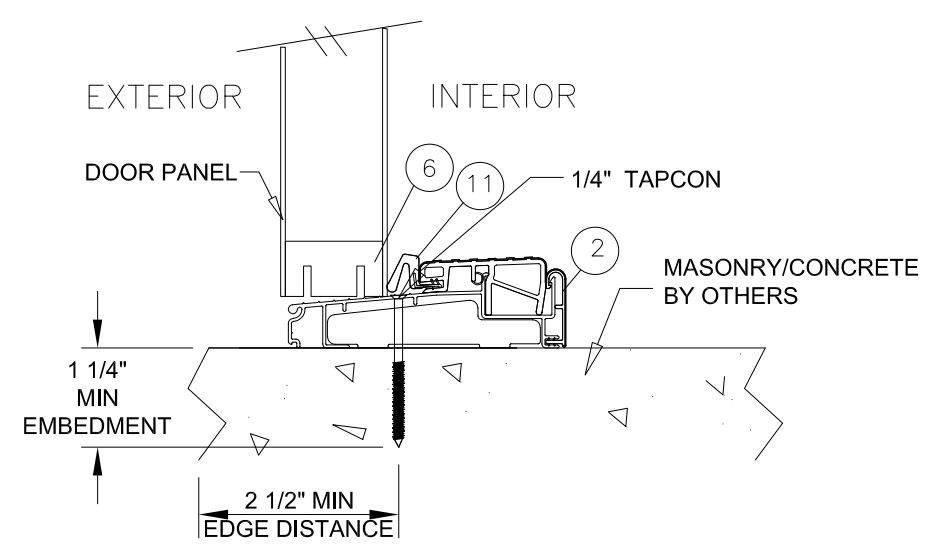
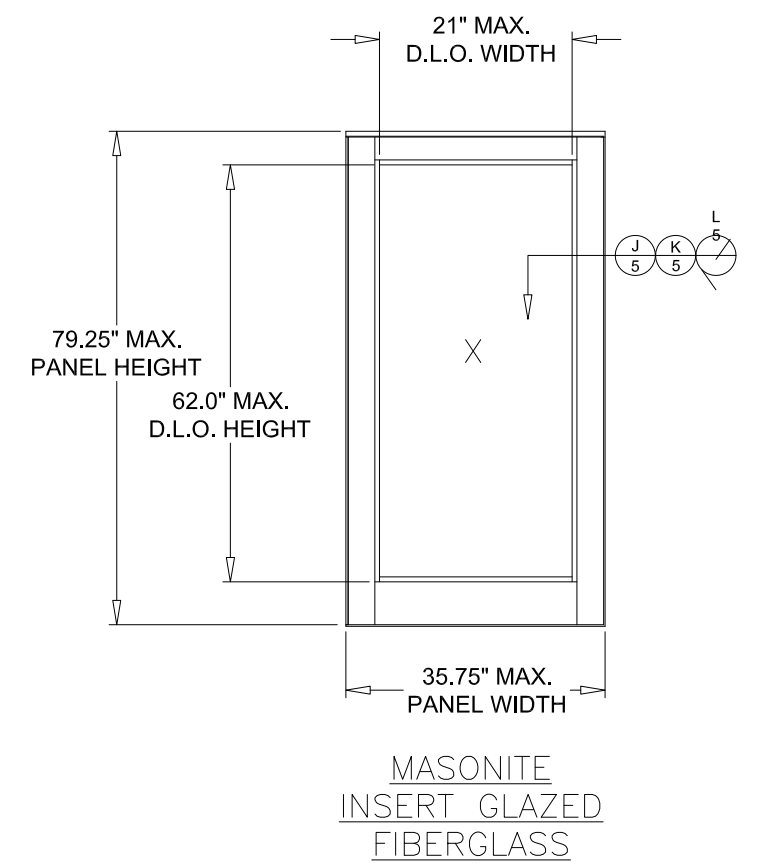

**A**  
**5** VERTICAL CROSS SECTION  
OUTSWING MASONRY/CONCRETE INSTALLATION

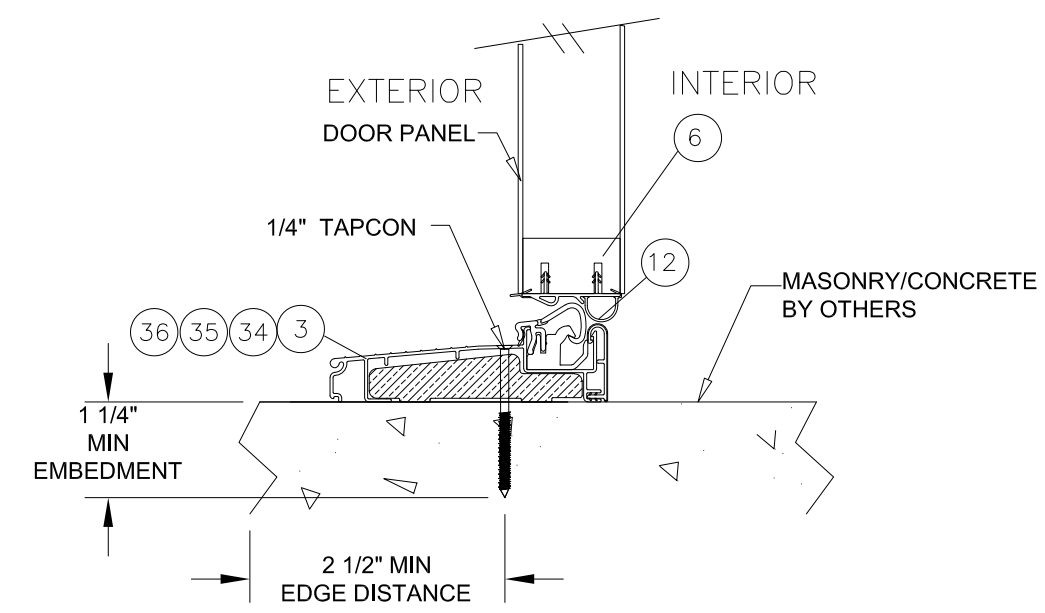

**C**  
**5** VERTICAL CROSS SECTION  
IN-SWING MASONRY/CONCRETE INSTALLATION

- NOTES:**
- INTERIOR AND EXTERIOR FINISHES, BY OTHERS, NOT SHOWN FOR CLARITY.
  - PERIMETER AND JOINT SEALANT BY OTHERS TO BE DESIGNED IN ACCORDANCE WITH ASTM E2112

ENDURA PRODUCTS, INC.  
8817 WEST MARKET STREET  
COLFAX, NC 27235

MASONITE GLAZED  
FIBERGLASS DOORS  
GLAZING INSERT AND SILL DETAILS

DRAWN: RM	DWG NO. NL-0017	REV C
SCALE NTS	DATE 09/04/13	SHEET 5 OF 9

L. ROBERTO LOMAS P.E.  
1432 WOODFORD RD LEWISVILLE, NC 27023  
434-688-0609 rllomas@rlomaspe.com

SIGNED: 11/10/2021



Luis R. Lomas P.E.  
TX No.: 101889

REVISIONS			
REV	DESCRIPTION	DATE	APPROVED
C	REVISED PER NEW CODE	11/10/2021	R.L.

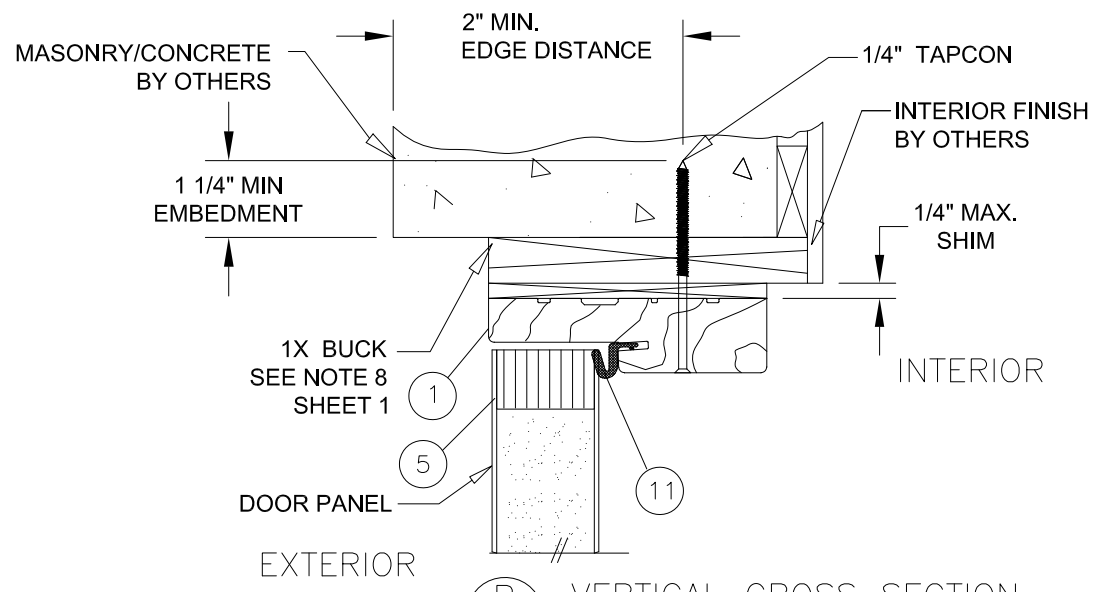

**B** VERTICAL CROSS SECTION  
**6** OUTSWING SHOWN-INSWING SIMILAR  
MASONRY/CONCRETE INSTALLATION

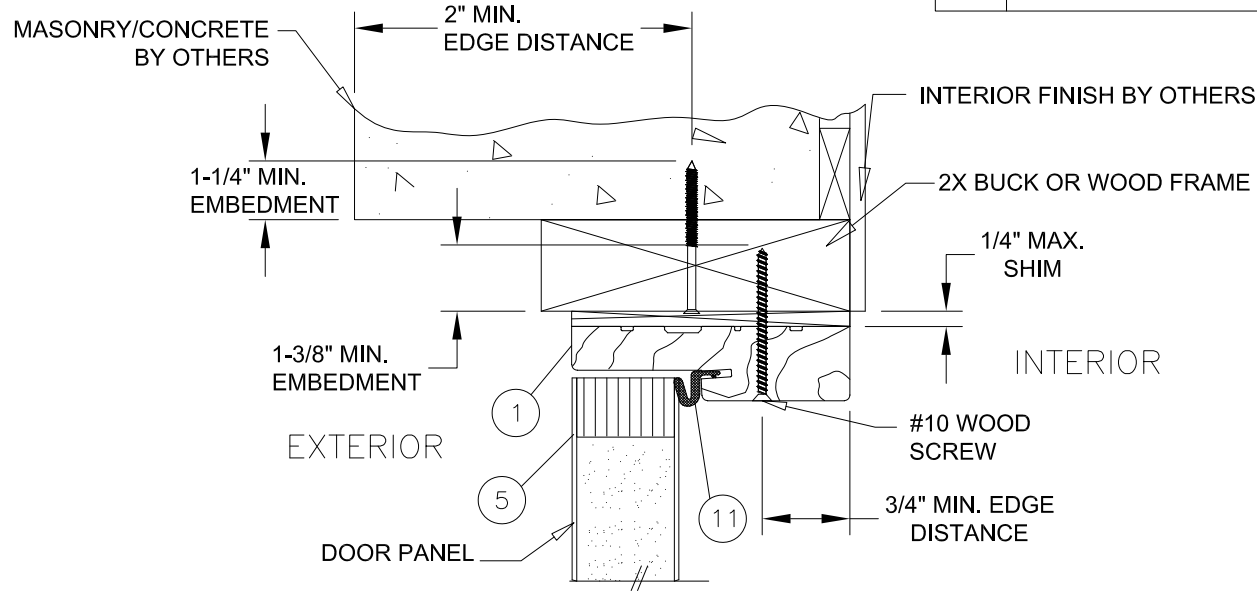

**D** VERTICAL CROSS SECTION  
**6** OUTSWING SHOWN-INSWING SIMILAR  
2X BUCK OR WOOD FRAME INSTALLATION

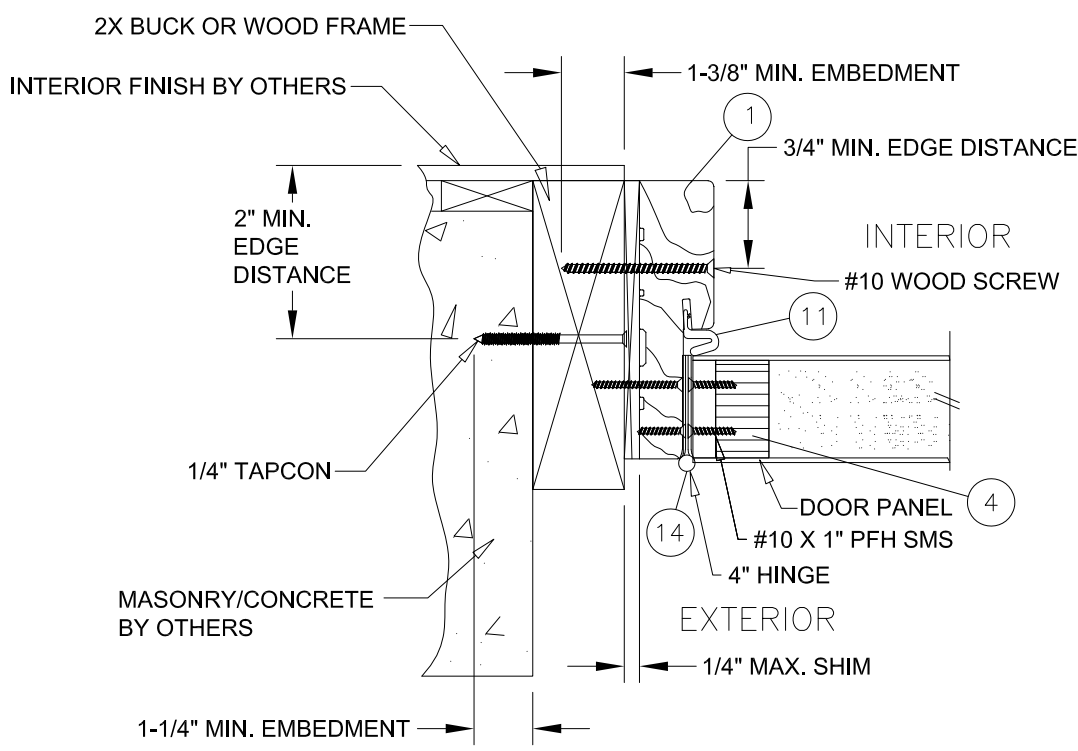

**H** HORIZONTAL CROSS SECTION  
**6** OUTSWING SHOWN-INSWING SIMILAR  
2X BUCK OR WOOD FRAME INSTALLATION

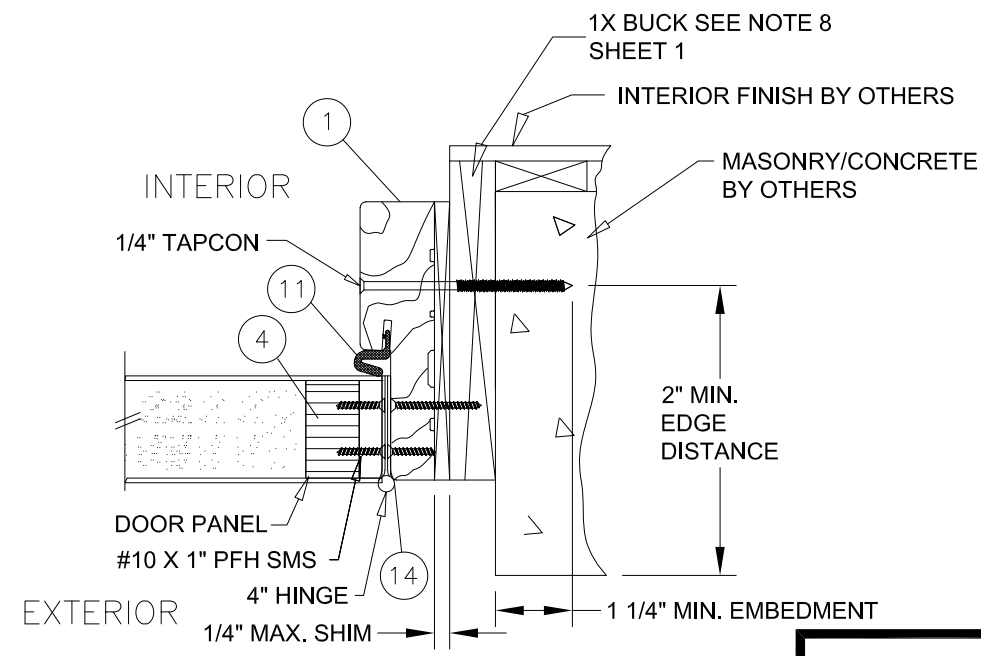

**I** HORIZONTAL CROSS SECTION  
**6** OUTSWING SHOWN-INSWING SIMILAR

- NOTES:**
1. INTERIOR AND EXTERIOR FINISHES, BY OTHERS, NOT SHOWN FOR CLARITY.
  2. PERIMETER AND JOINT SEALANT BY OTHERS TO BE DESIGNED IN ACCORDANCE WITH ASTM E2112

**ENDURA PRODUCTS, INC.**  
8817 WEST MARKET STREET  
COLFAX, NC 27235

MASONITE GLAZED  
FIBERGLASS DOORS  
DOOR CROSS SECTIONS

DRAWN: RM	DWG NO. NL-0017	REV C
SCALE NTS	DATE 09/04/13	SHEET 6 OF 9

L. ROBERTO LOMAS P.E.  
1432 WOODFORD RD LEWISVILLE, NC 27023  
434-688-0609 rllomas@rlomaspe.com

SIGNED: 11/10/2021



Luis R. Lomas P.E.  
TX No.: 101889

REVISIONS			
REV	DESCRIPTION	DATE	APPROVED
C	REVISED PER NEW CODE	11/10/2021	R.L.

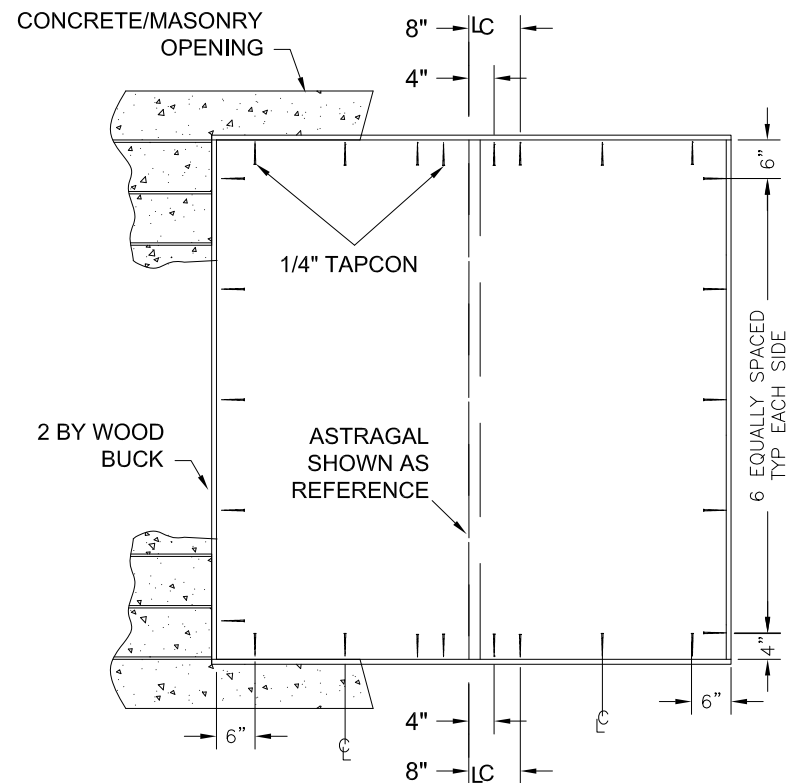

**WOOD BUCK TO  
SUBSTRATE ANCHORING  
XX**

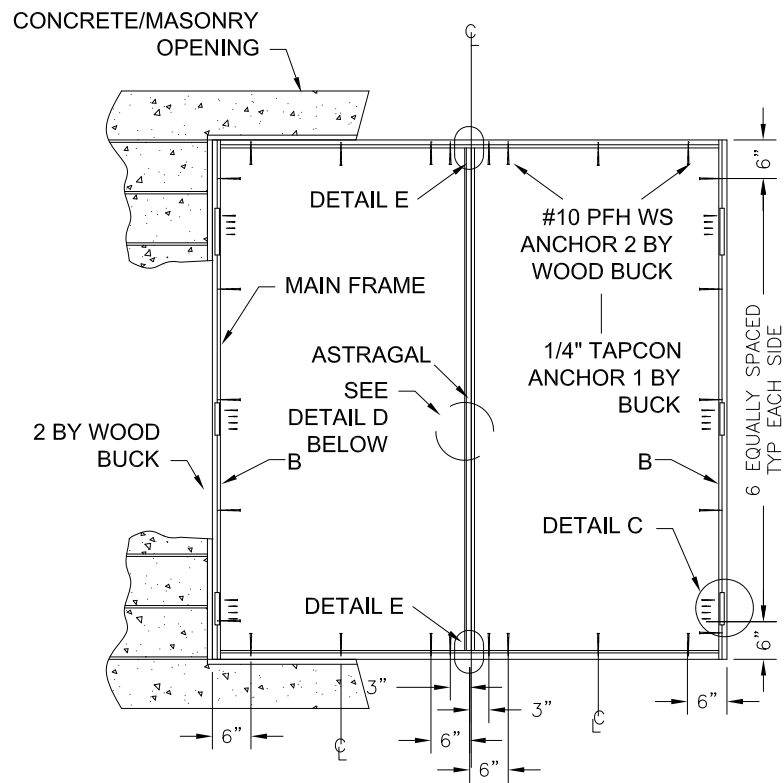

**MAIN FRAME TO  
BUCK ANCHORING  
XX**

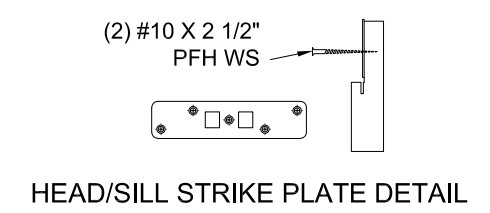
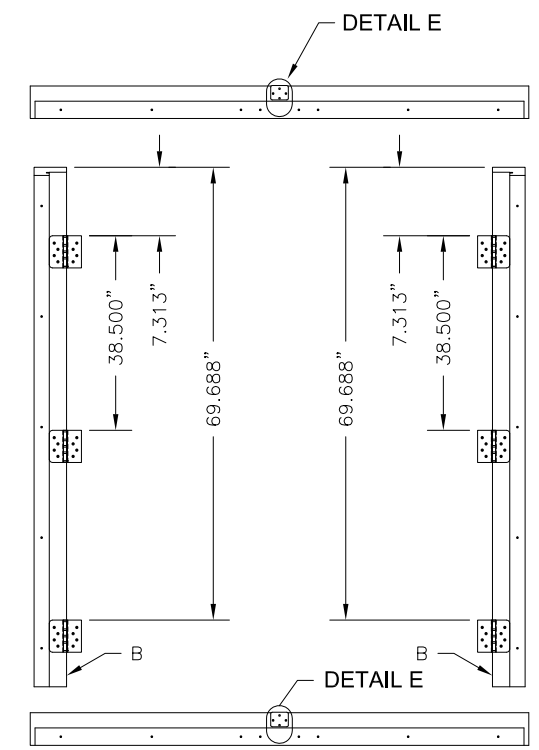

**HEAD/SILL STRIKE PLATE DETAIL**  
3500 / 3020 TRILEMMIUM  
ATTACH LOCK THROW BOLT  
STRIKE PLATE TO FRAME  
AS SHOWN.

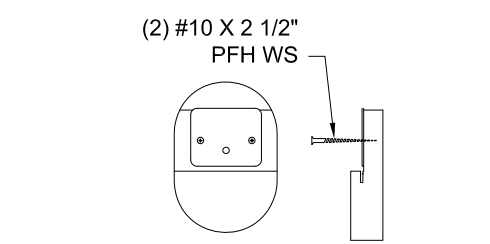

**HEAD STRIKE PLATE DETAIL**  
ULTIMATE MPA ASTRAGAL  
ATTACH ASTRAGAL THROW BOLT  
STRIKE PLATE TO FRAME  
AS SHOWN.

**INSTALLATION NOTES:**

- ONE (1) INSTALLATION ANCHOR IS REQUIRED AT EACH ANCHOR LOCATION SHOWN.
- NUMBER OF INSTALLATION ANCHORS DEPICTED IS THE MINIMUM NUMBER OF ANCHORS TO BE USED FOR PRODUCT INSTALLATION. ANCHORS MUST MATCH TYPE, SIZE, AND EMBEDMENT OF THOSE SHOWN HEREIN FOR RESPECTIVE SUBSTRATE.
- SHIM AS REQUIRED AT EACH INSTALLATION ANCHOR WITH LOAD BEARING SHIM(S). MAXIMUM ALLOWABLE SHIM SIZE IS 1/4 INCH. SHIM WHERE SPACE OF 1/8 INCH OR GREATER OCCURS. SHIM(S) SHALL BE CONSTRUCTED OF HIGH DENSITY PLASTIC OR BETTER.
- FOR INSTALLATION INTO WOOD FRAMING, USE #10 WOOD SCREWS OF SUFFICIENT LENGTH TO ACHIEVE 1 3/8" MINIMUM EMBEDMENT.
- FOR INSTALLATION THROUGH 1X BUCK TO CONCRETE / MASONRY, OR DIRECTLY INTO CONCRETE / MASONRY, USE 1/4" TAPCON OF SUFFICIENT LENGTH TO ACHIEVE 1-1/4" MINIMUM EMBEDMENT WITH A 2" MINIMUM EDGE DISTANCE.
- ALTERNATE CONCRETE / MASONRY INSTALLATION ANCHORS OF EQUIVALENT PERFORMANCE CHARACTERISTICS CAN BE USED UPON APPROVAL OF ARCHITECT OR ENGINEER OF RECORD.
- MINIMUM EMBEDMENT AND EDGE DISTANCE EXCLUDE WALL FINISHES (INCLUDING BUT NOT LIMITED TO STUCCO, FOAM, BRICK VENEER, AND SIDING).
- INSTALLATION ANCHOR CAPACITIES FOR PRODUCTS HEREIN ARE BASED ON SUBSTRATE MATERIALS WITH THE FOLLOWING PROPERTIES:
  - A. WOOD - MINIMUM SPECIFIC GRAVITY OF 0.42.
  - B. CONCRETE - MINIMUM COMPRESSIVE STRENGTH OF 3192 PSI.
  - C. MASONRY - STRENGTH CONFORMANCE TO ASTM C-90, GRADE N, TYPE 1 (OR GREATER).

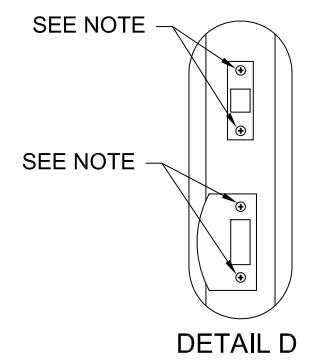

**DETAIL D**

**NOTE:**  
ATTACH STRIKE & DEADBOLT PLATES TO STRIKE & BUCK WITH #10 X 2" FH WOOD SCREW  
ATTACH STRIKE & DEAD BOLT PLATES TO ASTRAGAL WITH #8 X 2 1/2" FH WOOD SCREWS  
ATTACH STRIKE TO JAMB & SIDELITE JAMB WITH #10 X 1 3/4" FH WOOD SCREW.

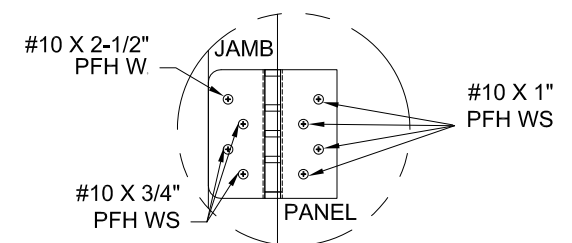

**HINGE DETAIL**

**SIGNED: 11/10/2021**

**ENDURA PRODUCTS, INC.**  
8817 WEST MARKET STREET  
COLFAX, NC 27235

MASONITE GLAZED  
FIBERGLASS DOORS  
ELEVATION AND ANCHOR LAYOUT

DRAWN: RM	DWG NO. NL-0017	REV C
SCALE NTS	DATE 09/04/13	SHEET 7 OF 9

L. ROBERTO LOMAS P.E.  
1432 WOODFORD RD LEWISVILLE, NC 27023  
434-688-0609 rllomas@rlomaspe.com



Luis R. Lomas P.E.  
TX No.: 101889

REVISIONS			
REV	DESCRIPTION	DATE	APPROVED
C	REVISED PER NEW CODE	11/10/2021	R.L.

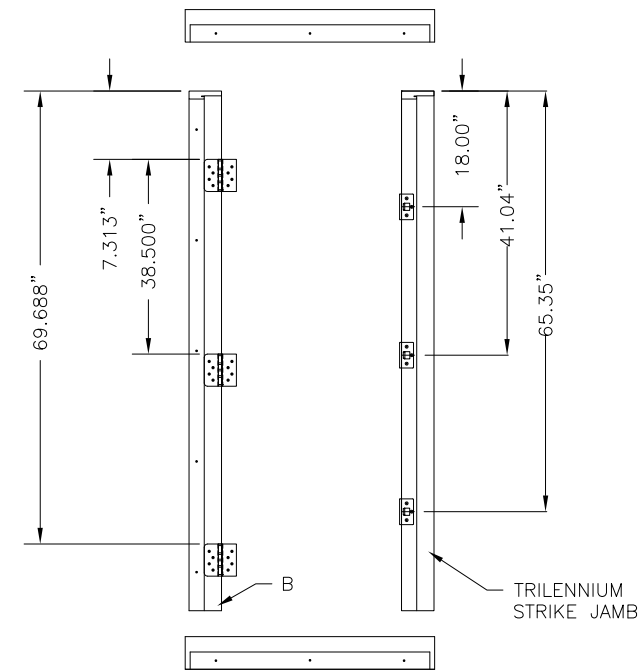
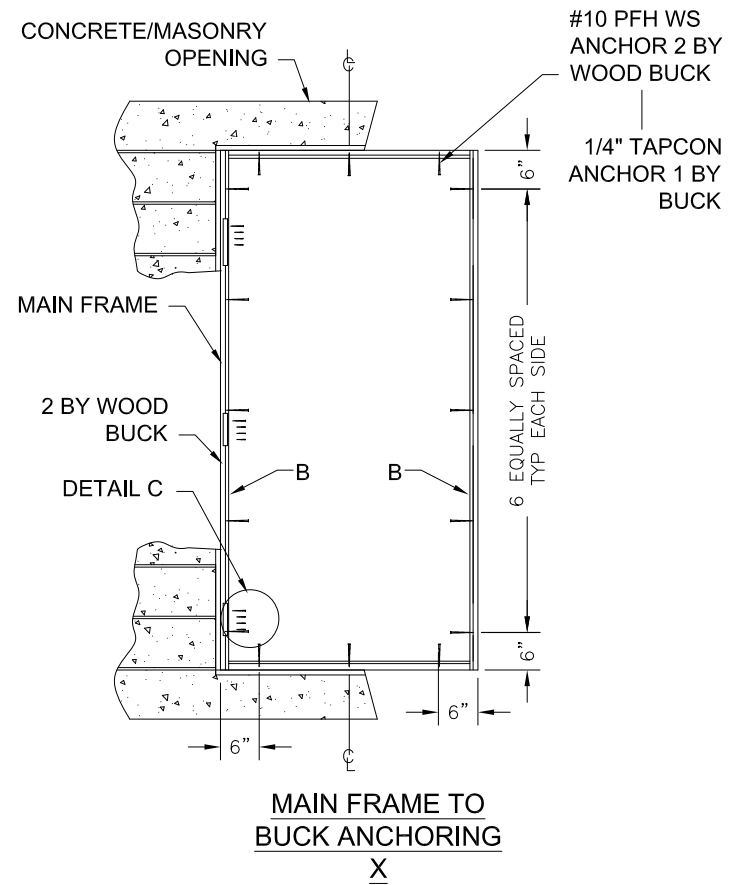
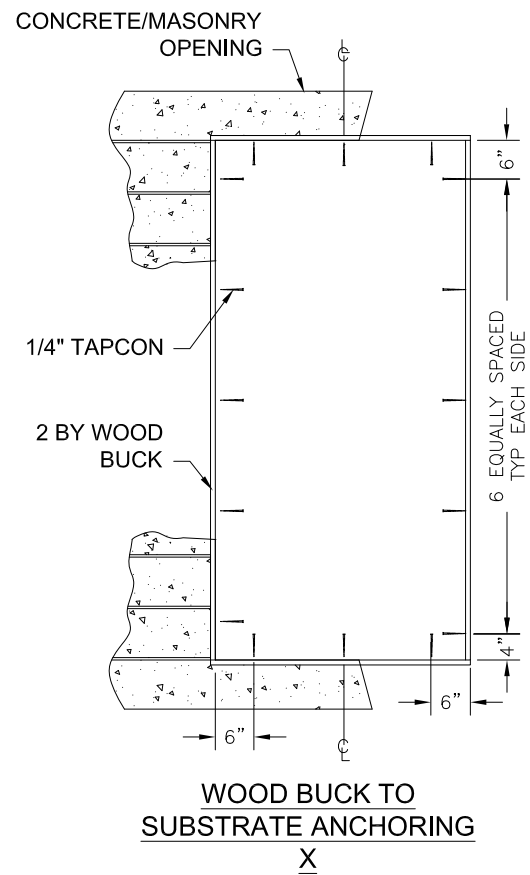

**INSTALLATION NOTES:**

- ONE (1) INSTALLATION ANCHOR IS REQUIRED AT EACH ANCHOR LOCATION SHOWN.
- NUMBER OF INSTALLATION ANCHORS DEPICTED IS THE MINIMUM NUMBER OF ANCHORS TO BE USED FOR PRODUCT INSTALLATION. ANCHORS MUST MATCH TYPE, SIZE, AND EMBEDMENT OF THOSE SHOWN HEREIN FOR RESPECTIVE SUBSTRATE.
- SHIM AS REQUIRED AT EACH INSTALLATION ANCHOR WITH LOAD BEARING SHIM(S). MAXIMUM ALLOWABLE SHIM SIZE IS 1/4 INCH. SHIM WHERE SPACE OF 1/8 INCH OR GREATER OCCURS. SHIM(S) SHALL BE CONSTRUCTED OF HIGH DENSITY PLASTIC OR BETTER.
- FOR INSTALLATION INTO WOOD FRAMING, USE #10 WOOD SCREWS OF SUFFICIENT LENGTH TO ACHIEVE 1 3/8" MINIMUM EMBEDMENT.
- FOR INSTALLATION THROUGH 1X BUCK TO CONCRETE / MASONRY, OR DIRECTLY INTO CONCRETE / MASONRY, USE 1/4" TAPCON OF SUFFICIENT LENGTH TO ACHIEVE 1-1/4" MINIMUM EMBEDMENT WITH A 2" MINIMUM EDGE DISTANCE.
- ALTERNATE CONCRETE / MASONRY INSTALLATION ANCHORS OF EQUIVALENT PERFORMANCE CHARACTERISTICS CAN BE USED UPON APPROVAL OF ARCHITECT OR ENGINEER OF RECORD.
- MINIMUM EMBEDMENT AND EDGE DISTANCE EXCLUDE WALL FINISHES (INCLUDING BUT NOT LIMITED TO STUCCO, FOAM, BRICK VENEER, AND SIDING).
- INSTALLATION ANCHOR CAPACITIES FOR PRODUCTS HEREIN ARE BASED ON SUBSTRATE MATERIALS WITH THE FOLLOWING PROPERTIES:

- A. WOOD - MINIMUM SPECIFIC GRAVITY OF 0.42.
- B. CONCRETE - MINIMUM COMPRESSIVE STRENGTH OF 3192 PSI.
- C. MASONRY - STRENGTH CONFORMANCE TO ASTM C-90, GRADE N, TYPE 1 (OR GREATER).

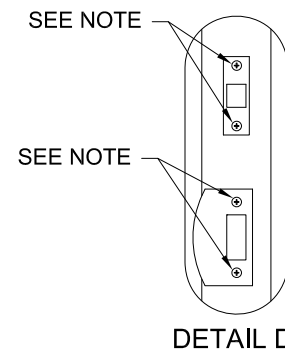

**NOTE:**  
 ATTACH STRIKE & DEADBOLT PLATES TO STRIKE & BUCK WITH #10 X 2" FH WOOD SCREW  
 ATTACH STRIKE & DEAD BOLT PLATES TO ASTRAGAL WITH #8 X 2 1/2" FH WOOD SCREWS  
 ATTACH STRIKE TO JAMB & SIDELITE JAMB WITH #10 X 1 3/4" FH WOOD SCREW.

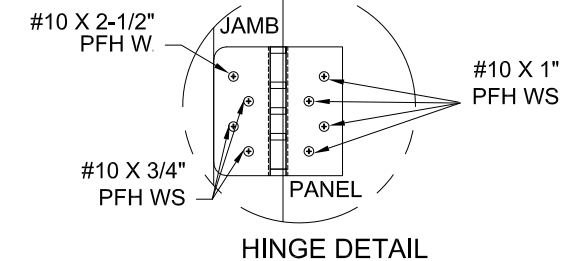

SIGNED: 11/10/2021

ENDURA PRODUCTS, INC.

8817 WEST MARKET STREET  
 COLFAX, NC 27235

MASONITE GLAZED  
 FIBERGLASS DOORS  
 ELEVATION AND ANCHOR LAYOUT

DRAWN: RM	DWG NO. NL-0017	REV C
SCALE NTS	DATE 09/04/13	SHEET 8 OF 9

L. ROBERTO LOMAS P.E.  
 1432 WOODFORD RD LEWISVILLE, NC 27023  
 434-688-0609 rllomas@rlomaspe.com



Luis R. Lomas P.E.  
 TX No.: 101889



BILL OF MATERIAL			
ITEM #	DESCRIPTION	QTY.	MATERIAL
1	HEAD / JAMB		
2	OUTSWING BUMP THRESHOLD ZOBL4565		
3	INSWING ADJUSTABLE THRESHOLD ZAACL4565		
4	DOOR STILE - CORE MATERIAL WOOD OR LVL		
5	DOOR TOP RAIL		
6	DOOR BOTTOM RAIL		
7	DOOR LOCK STILE - CORE MATERIAL WOOD OR LVL		
8	DOOR SKIN (MIN. 0.070" THICK)		
9	DOOR SKIN (MIN. 0.085" THICK)		
10	REINFORCEMENT WOOD FOR LOCKS		
11	COMPRESSION WEATHERSTRIP-PE-650 QLON		
12	VINYL DOOR BOTTOM SWEEP-DBKAC		
13	CORNER PAD		
14	4" X 4" HINGE BUTT		
15	CONTINUOUS LATCH AND HINGE STILE REINFORCEMENT		
16	POLYURETHANE FOAM BY MASONITE		
17	EXTRUDED ALUMINUM ASTRAGAL BY ENDURA-6063T-6		
18	WOOD ASTRAGAL BY ENDURA		
19	LATCH STRIKE PLATE		
20	DEAD BOLT STRIKE PLATE		
21	KWIKSET KNOB (SIGNATURE SERIES)		
22	KWIKSET DEADBOLT (SIGNATURE SERIES 980 / 985)		
23	LATCH STRIKE PLATE 3500 / 3020		
24	DEADBOLT PLATE		
25	ASTRAGAL STRIKE PLATE		
26	TRILENNIUM 3500 / 3020 LOCK		
27	TRILENNIUM 3070 MULTIPOINT LOCK		
28	#10 X 3/4" PFH WOOD SCREW (HINGE TO FRAME)		
29	#10 X 2 -1/2" PFH WOOD SCREW		
30	#10 X 1" PFH WOOD SCREW		
31	ODL GLAZING INSERT-ALUMINUM LIGHT FRAME		
32	RSL GLAZING INSERT-PVC FRAME		
33	ECLIPSE INTERIOR LOCK TRIM		
34	INSWING THRESHOLD ZAFLAA4565		
35	INSWING THRESHOLD ZAIL4565		
36	INSWING THRESHOLD ZAILAA4565		
37	TRILENNIUM 3000 MULTIPOINT LOCK		

REVISIONS			
REV	DESCRIPTION	DATE	APPROVED
C	REVISED PER NEW CODE	11/10/2021	R.L.

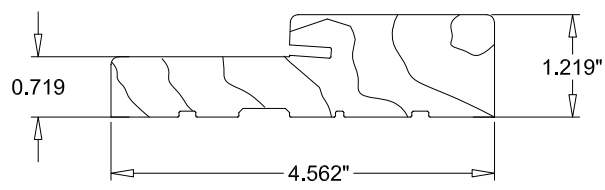

1 FRAME HEAD / JAMB BY ENDURA (PINE SG = 0.37)

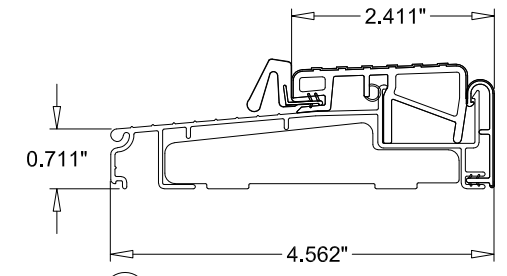

2 OUTSWING THRESHOLD ALUMINUM / WOOD BY ENDURA ZOBL4565

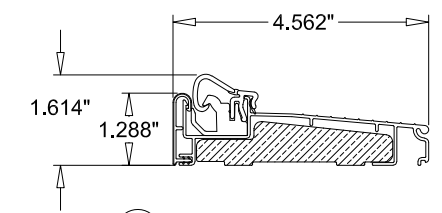

3 INSWING THRESHOLD ALUMINUM / WOOD BY ENDURA ZAACL4565

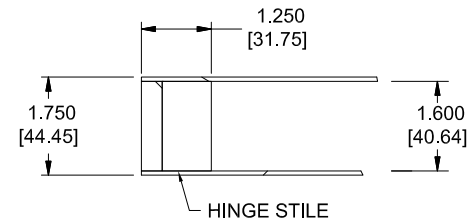

4 HINGE STILE (LVL)

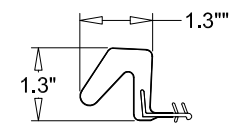

11 WEATHERSTRIPPING PE-650 FOAM

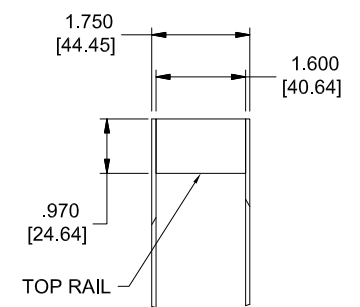

5 DOOR TOP RAIL (PINE SG = 0.42)

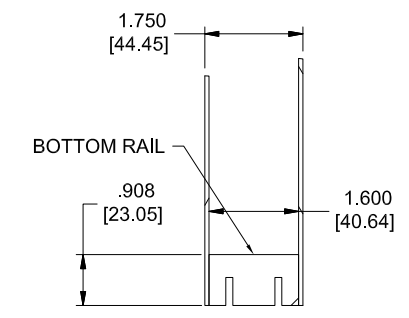

6 DOOR BOTTOM RAIL (PINE SG = 0.42)

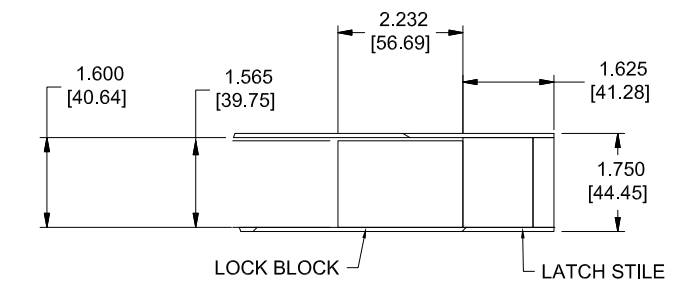

7 LOCK STILE (LVL)

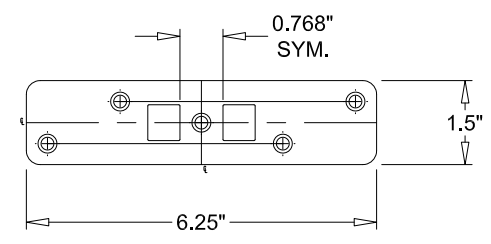

23 3500 / 3020 STRIKE PLATE STEEL

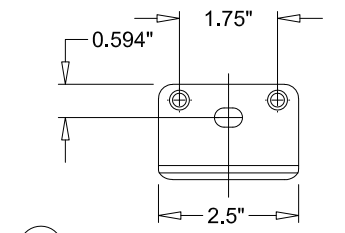

25 ASTRAGAL STRIKE PLATE STEEL

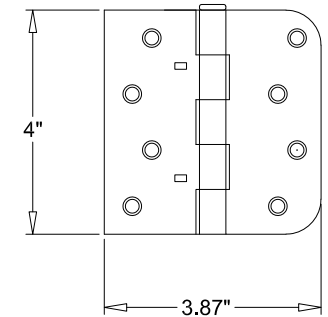

14 4" X 4" HINGE 0.097" THICK STEEL

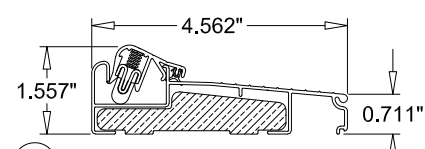

34 INSWING THRESHOLD ALUMINUM / WOOD BY ENDURA ZAFLAA4565

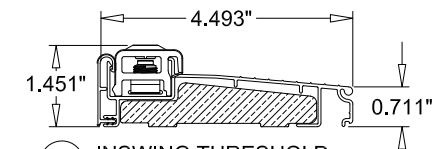

35 INSWING THRESHOLD ALUMINUM / WOOD BY ENDURA ZAIL4565

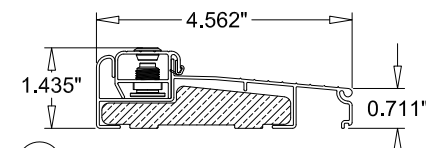

36 INSWING THRESHOLD ALUMINUM / WOOD BY ENDURA ZAILAA4565

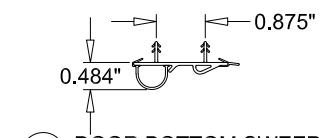

12 DOOR BOTTOM SWEEP (VINYL)

**GENERAL PLASTICS NOTES:**

- POLYURETHANE CORE FLAME SPREAD INDEX OF 50 AND SMOKE DEVELOPED INDEX OF 60 PER ASTM E84.
- PLASTICS TESTING OF FIBERLASS FACING:

Test Description	Test Method	Test Result
SELF IGNITION TEMP	ASTM D1929	Passed (>650 °F)
RATE OF BURNING	ASTM D635	Passed (C-1:<1.0 in/min)
SMOKE DENSITY	ASTM D2843	Passed (<75%)
TENSILE STRENGTH*	ASTM D638	Passed (<10%)

- PVC PLASTICS TESTING OF RSL LITE FRAME MATERIAL

Test Description	Test Method	Test Result
SELF IGNITION TEMP	ASTM D1929	Passed (>650 °F)
RATE OF BURNING	ASTM D635	Passed (C-1:<1.0 in/min)
SMOKE DENSITY	ASTM D2843	Passed (<75%)
FLEXURAL STRENGTH*	ASTM D790	BEFORE = 3366 PSI AFTER = *3058 PSI

\* STRENGTH TEST AFTER WEATHERING, PER SECTION 2612.2 OF THE FBC.

**ENDURA PRODUCTS, INC.**  
8817 WEST MARKET STREET  
COLFAX, NC 27235

MASONITE GLAZED  
FIBERGLASS DOORS  
BILL OF MATERIALS AND COMPONENTS

DRAWN: RM	DWG NO. NL-0017	REV C
SCALE NTS	DATE 09/04/13	SHEET 9 OF 9

L. ROBERTO LOMAS P.E.  
1432 WOODFORD RD LEWISVILLE, NC 27023  
434-688-0609 rllomas@rlomaspe.com

SIGNED: 11/10/2021



Luis R. Lomas P.E.  
TX No.: 101889