

THERMA TRU®

THERMA TRU DOORS

118 INDUSTRIAL DR., EDGERTON, OH 43517

"Smooth Star", "Fiber Classic" & "Classic Craft"

Opaque Fiberglass Single Door w/ or w/o Sidelites

IN SWING / OUT SWING
"Non-Impact"

EVALUATED FOR USE IN THE STATE OF TEXAS

The Fiberglass Door system described herein complies with the 2018 International Residential Code (IRC), Sections R301 & R609 and the 2018 International Building Code (IBC), Sections 1404.13, 1609, 1709.5, 2403 and 2404 subject to the following conditions:

1. Anchors shall be as listed and spaced as shown in the details. Anchor embedment to base material shall be beyond wall dressing or stucco.
2. When used in areas requiring wind-borne debris protection this product is required to be protected with an impact resistant covering that complies with Section R301.2.1.2 of the IRC and Section 1609.1.2 of the IBC.
3. Allowable design pressure requirements must be equal to or less than the design pressure rating shown in the design pressure chart, sheet 1 of this drawing.
4. Conditions not covered by this drawing are subject to further engineering analysis.
5. Fiber-Classic and Smooth-Star Door and Sidelite panels require the use of "J" part numbers. These door and sidelite panels must be stained or painted within six months of installation.

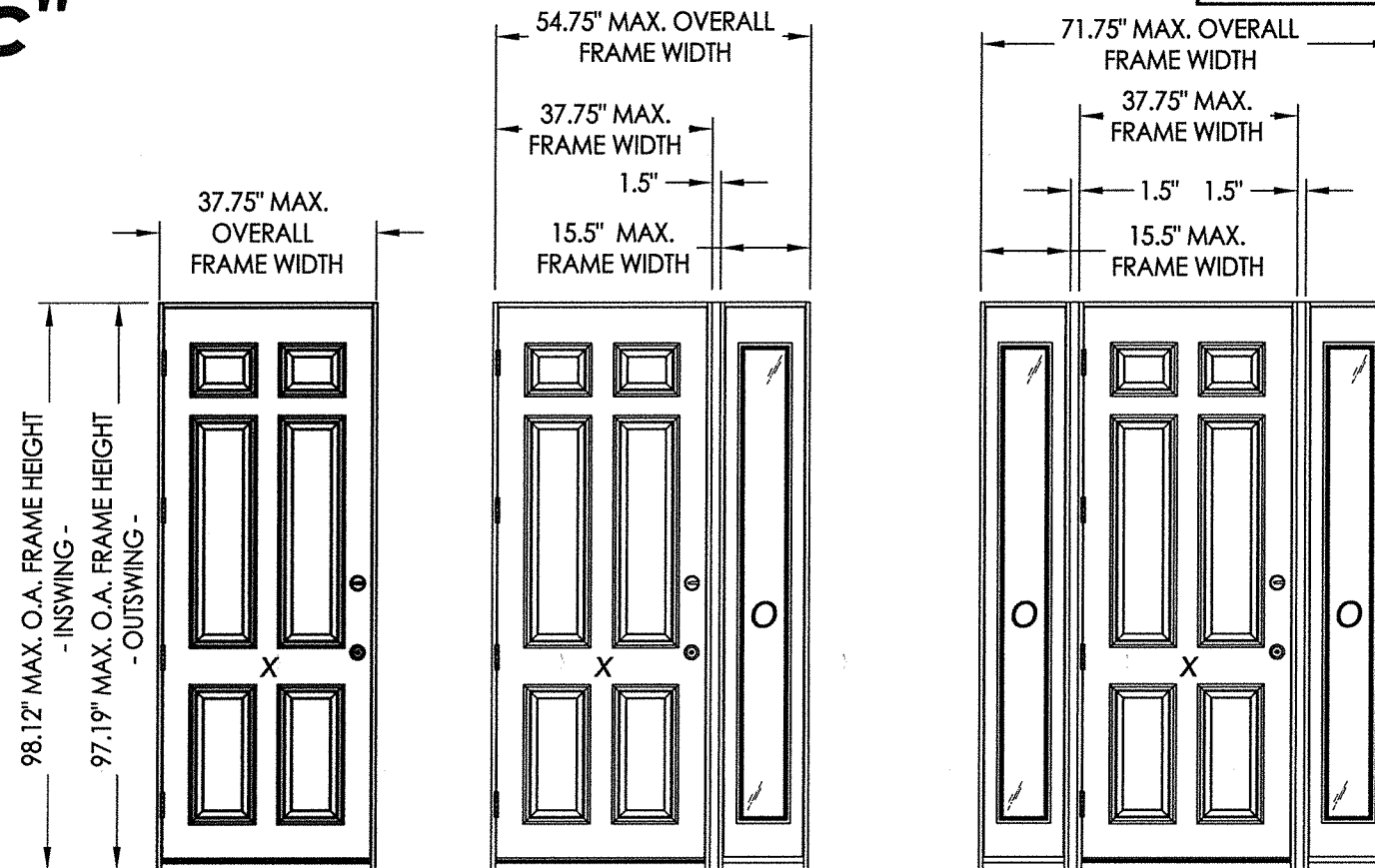

CONFIGURATION	MAX. FRAME DIMENSION	SWING	DESIGN PRESSURE (PSF) SMOOTH STAR / FIBER CLASSIC		DESIGN PRESSURE (PSF) CLASSIC CRAFT	
			POSITIVE	NEGATIVE	POSITIVE	NEGATIVE
X	37.75" x 98.12"	IN SWING	+80.0	-85.0	+80.0	-85.0
	37.75" x 97.19"	OUT SWING	+80.0	-80.0	+80.0	-80.0
OX or XO	54.75" x 98.12"	IN SWING	+55.0	-65.0	+55.0	-65.0
	54.75" x 97.19"	OUT SWING	+55.0	-55.0	+55.0	-55.0
OXO	71.75" x 98.12"	IN SWING	+55.0	-65.0	+55.0	-65.0
	71.75" x 97.19"	OUT SWING	+55.0	-55.0	+55.0	-55.0

TABLE OF CONTENTS	
SHEET #	DESCRIPTION
1	Typical elevations, design pressures & general notes
2	Door panel details (Smooth Star/Fiber Classic)
3	Door panel details (Classic Craft)
4	Sidelite panel & glazing detail (Smooth Star/Fiber Classic)
5	Sidelite panel & glazing detail (Classic Craft)
6	Elevations
7	Horizontal cross sections
8	Vertical cross sections
9	Vertical cross sections
10	Frame anchoring
11	Bill of materials and components

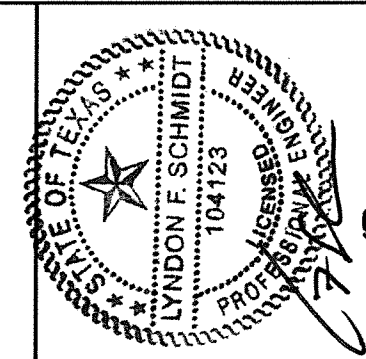

Documents Prepared By: Lyndon F. Schmidt, P.E.
TEXAS P.E. #104123

RW BUILDING CONSULTANTS, INC.
P.O. Box 230 Vairico FL 33595
Phone No.: 813.659.9197
TEXAS BOARD OF PROFESSIONAL ENGINEERS
CERTIFICATE OF REGISTRATION # F-11852

PRODUCT: THERMA-TRU FIBERGLASS DOOR
PART OR ASSEMBLY: TYPICAL ELEVATION, DESIGN PRESSURES & GENERAL NOTES

NO.	DATE	BY	REVISIONS
2	5/14/20	LFS	UPDATE TO 2018 IBC/IRC CODE
1	7/22/15	LFS	ADDED GENERAL NOTE 5.

DATE: 10/08/12
SCALE: N.T.S.
DWG. BY: JK
CHK. BY: LFS
DRAWING NO.: TX-4260
SHEET 1 OF 11

R:\Clients\Therma Tru PERMANENT\B - Texas Dept of Ins\TDI - DR 600 - 68 - 80 Opaque FG NonImp IS - OS Sgls Dbis w SL\C - Drawings\TX-4260-61.dwg, 2

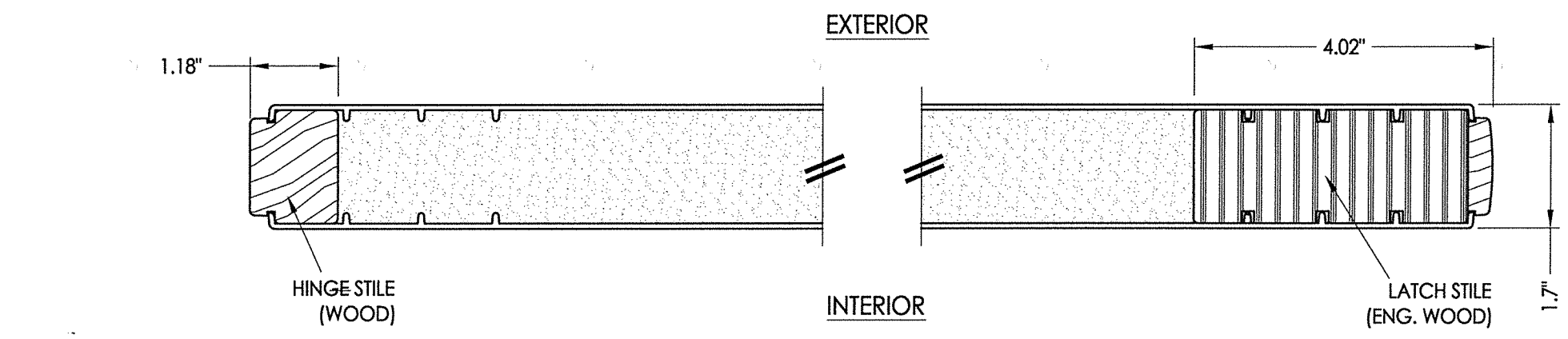

1 HORIZONTAL CROSS SECTION

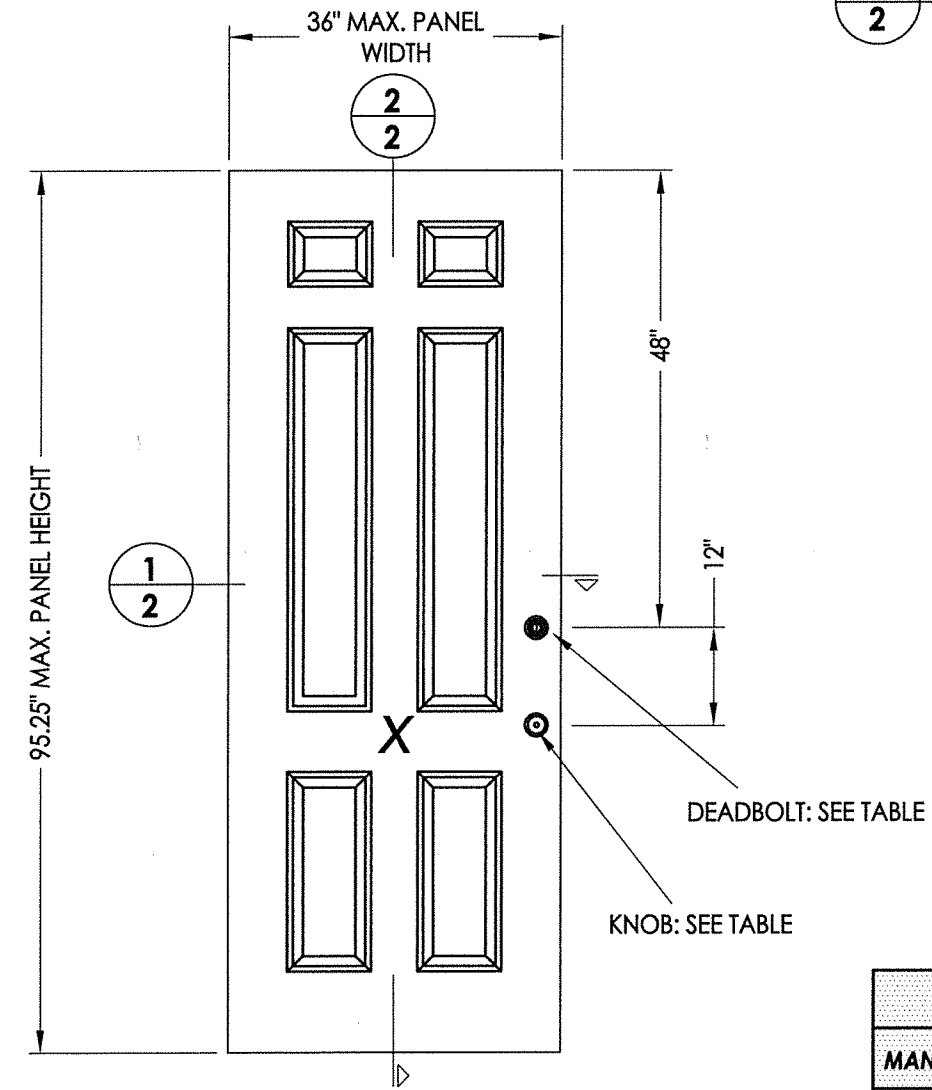

40 DOOR PANEL
Smooth Star/Fiber Classic

HARDWARE TABLE		
MANUFACTURER	MODEL	MAX. DESIGN PRESSURE
KWIKSET	KNOB: SIGNATURE SERIES	80 PSF
	DEADBOLT: SIGNATURE SERIES (980)	
SCHLAGE	KNOB: "F" SERIES	85 PSF
	DEADBOLT: "B" SERIES	

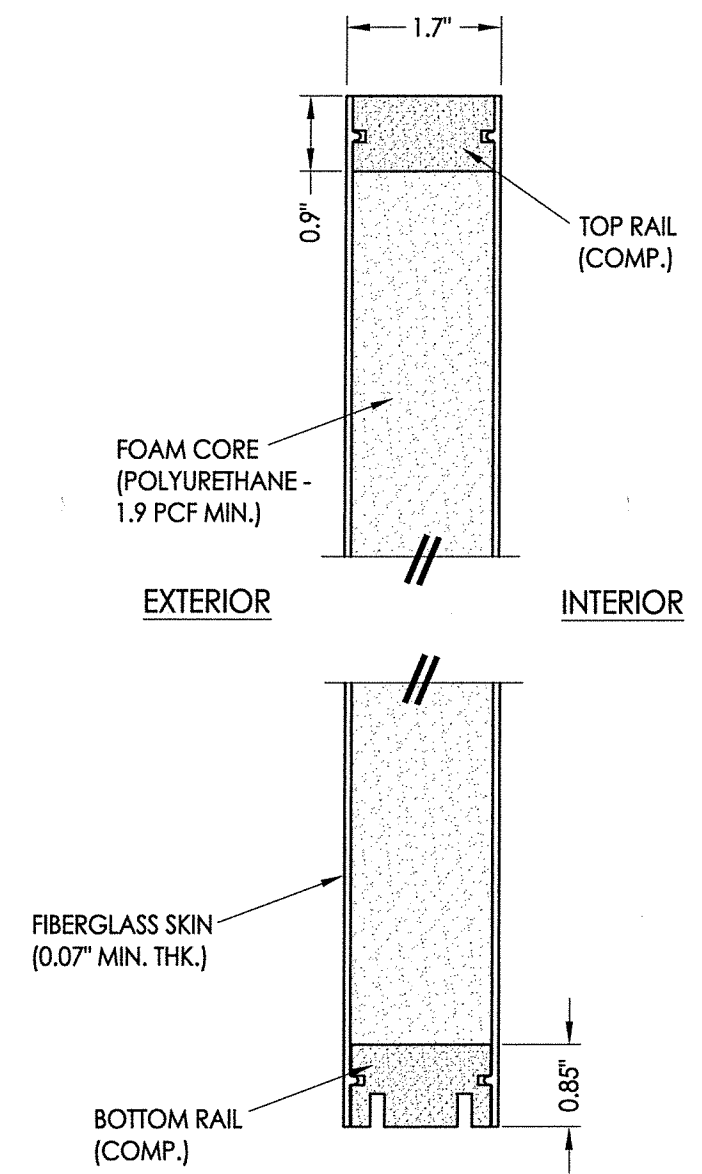

2 VERTICAL CROSS SECTION

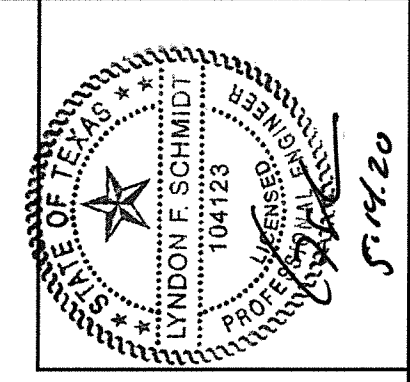

Documents Prepared By: Lyndon F. Schmidt, P.E.
TEXAS P.E. #104123

RW BUILDING CONSULTANTS, INC.
P.O. Box 230 Valrico FL, 33595
Phone No.: 813.659.9197

TEXAS BOARD OF PROFESSIONAL ENGINEERS
CERTIFICATE OF REGISTRATION # F-11852

PRODUCT: THERMA-TRU FIBERGLASS DOOR

PART OR ASSEMBLY: DOOR PANEL DETAILS

NO.	DATE	BY	REVISIONS
2	5/14/20	LFS	UPDATE TO 2018 IBC/IRC CODE
1	7/22/15	LFS	ADDED GENERAL NOTE 5.

DATE: 10/08/12

SCALE: N.T.S.

DWG. BY: JK

CHK. BY: LFS

DRAWING NO.: TX-4260

SHEET 2 OF 11

R:\Clients\Therma Tru PERMANENT\B - Texas Dept of Ins\TDI - DR 600 - 68 - 80 Opaque FG NonImp IS - OS Sgls Dbls w SL\C - Drawings\TX-4260-61.dwg, 3

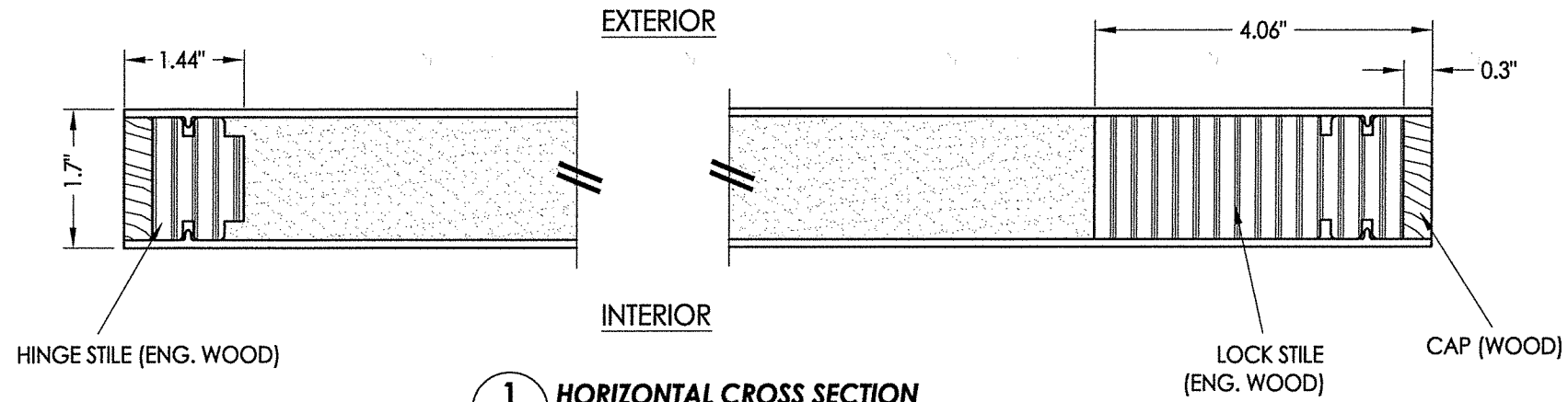

1
3 HORIZONTAL CROSS SECTION

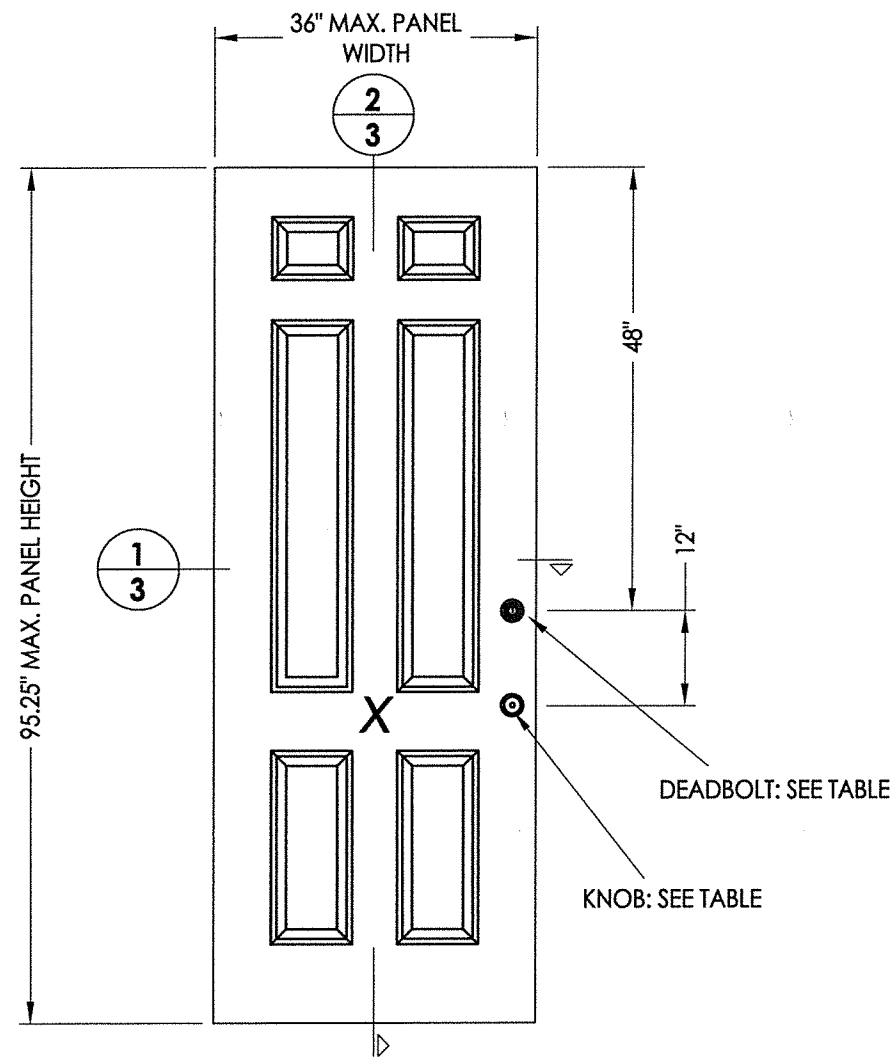

41 DOOR PANEL
Classic Craft

HARDWARE TABLE			MAX. DESIGN PRESSURE
MANUFACTURER	MODEL		
KWIKSET	KNOB:	SIGNATURE SERIES	80 PSF
	DEADBOLT:	SIGNATURE SERIES (980)	
SCHLAGE	KNOB:	"F" SERIES	85 PSF
	DEADBOLT:	"B" SERIES	

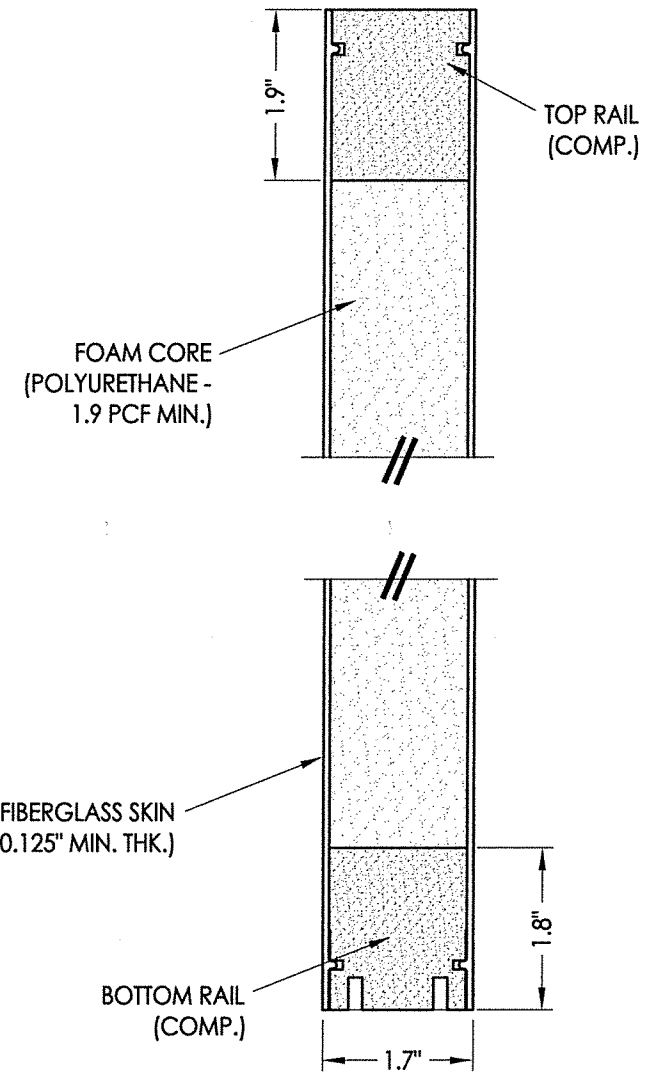

2
3 VERTICAL CROSS SECTION

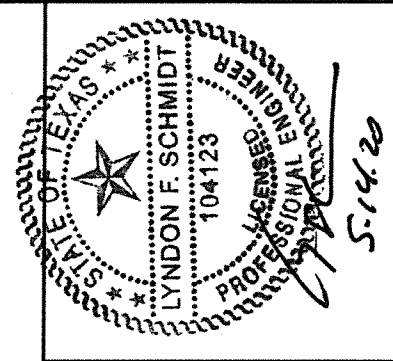

Documents Prepared By: Lyndon F. Schmidt, P.E.
TEXAS P.E. #104123

RW BUILDING CONSULTANTS, INC.
P.O. Box 230 Valrico FL 33595
Phone No.: 813.659.9197

TEXAS BOARD OF PROFESSIONAL ENGINEERS
CERTIFICATE OF REGISTRATION # F-11852

PRODUCT:	Therma-TRU FIBERGLASS DOOR	
PART OR ASSEMBLY:	DOOR PANEL DETAILS	
NO.	DATE	BY
2	5/14/20	LFS
1	7/22/15	LFS
REVISIONS		
DATE: 10/08/12		
SCALE: N.T.S.		
DWG. BY: JK		
CHK. BY: LFS		
DRAWING NO.: TX-4260		
SHEET 3 OF 11		

R:\Clients\Therma Tru PERMANENT\B - Texas Dept of Ins\TDI - DR 600 - 68 - 80 Opaque FG Nonimp IS - OS Sgls Dbils w SL\C - Drawings\TX-4260-61.dwg, 4

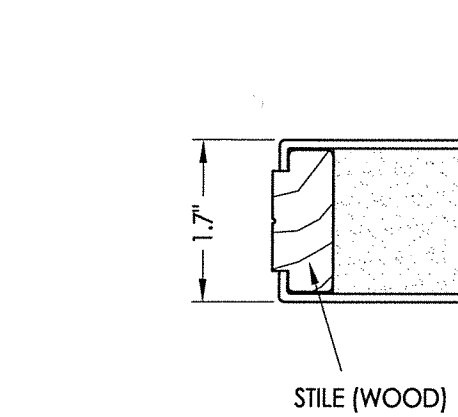

1
4 **HORIZONTAL CROSS SECTION**

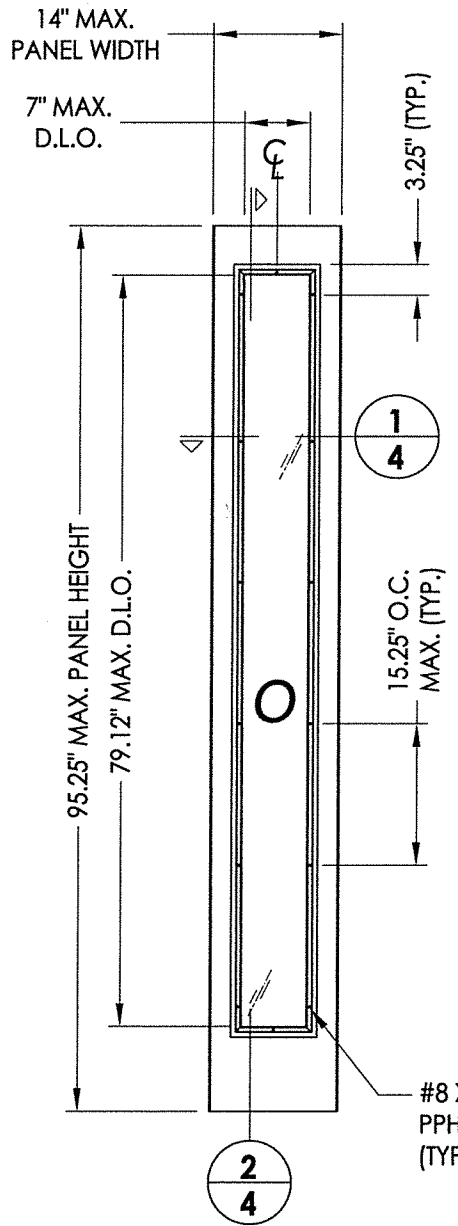

50 **SIDELITE PANEL**
Smooth Star/Fiber Classic

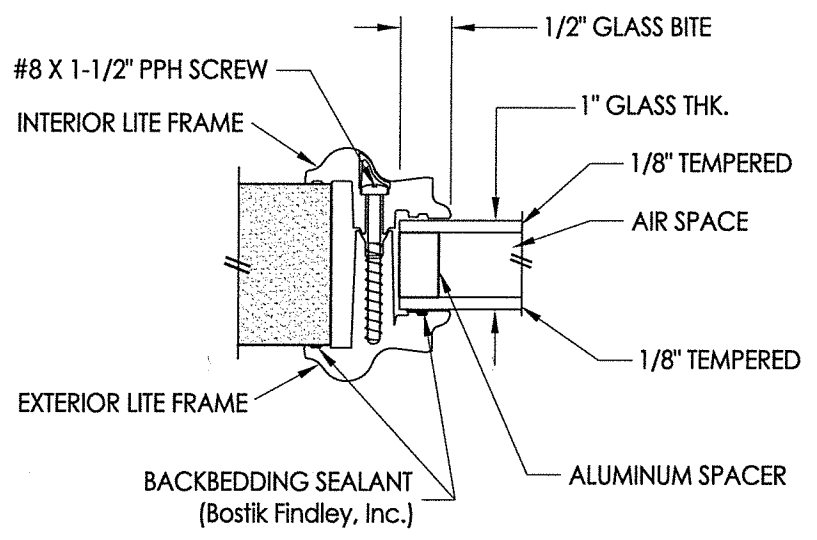

G1 **GLAZING DETAIL**
BTS Lip Lite Frame

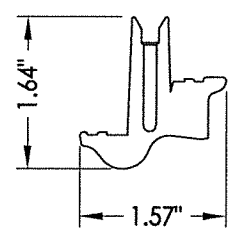

EXTERIOR LITE FRAME
BTS

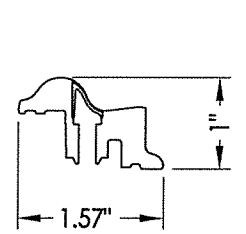

INTERIOR LITE FRAME
BTS

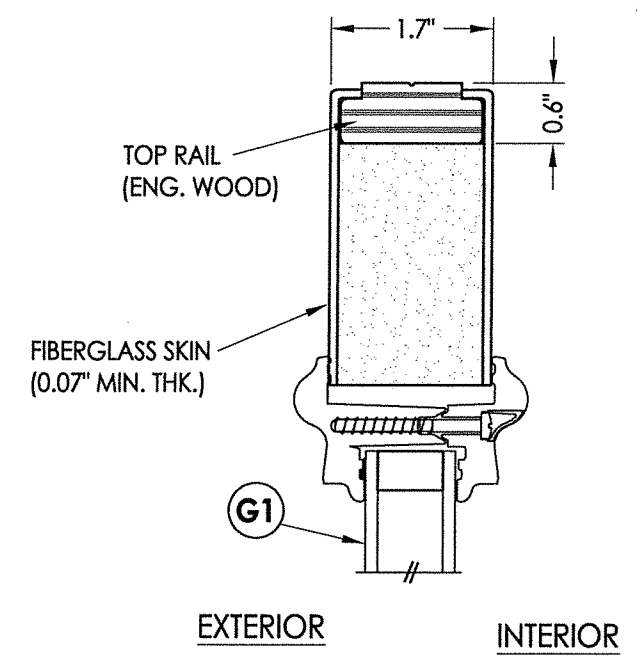

2
4 **VERTICAL CROSS SECTION**

FOAM CORE
(POLYURETHANE -
1.9 PCF MIN.)

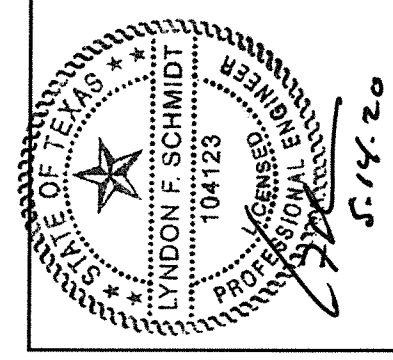

Documents Prepared By: Lyndon F. Schmidt, P.E.
TEXAS P.E. #104123

RW BUILDING CONSULTANTS, INC.
P.O. Box 230 Valrico FL 33595
Phone No.: 813.659.9197
TEXAS BOARD OF PROFESSIONAL ENGINEERS
CERTIFICATE OF REGISTRATION # F-11852

PRODUCT:	THERMA-TRU FIBERGLASS DOOR
PART OR ASSEMBLY:	SIDELITE PANEL & GLAZING DETAIL (SMOOTH STAR/FIBER CLASSIC)

NO.	DATE	BY	REVISIONS
2	5/14/20	LFS	UPDATE TO 2018 IBC/IRC CODE
1	7/22/15	LFS	ADDED GENERAL NOTE 5.

DATE:	10/08/12
SCALE:	N.T.S.
DWG. BY:	JK
CHK. BY:	LFS
DRAWING NO.:	TX-4260
SHEET	4 OF 11

© 2012 R.W. BUILDING CONSULTANTS INC.

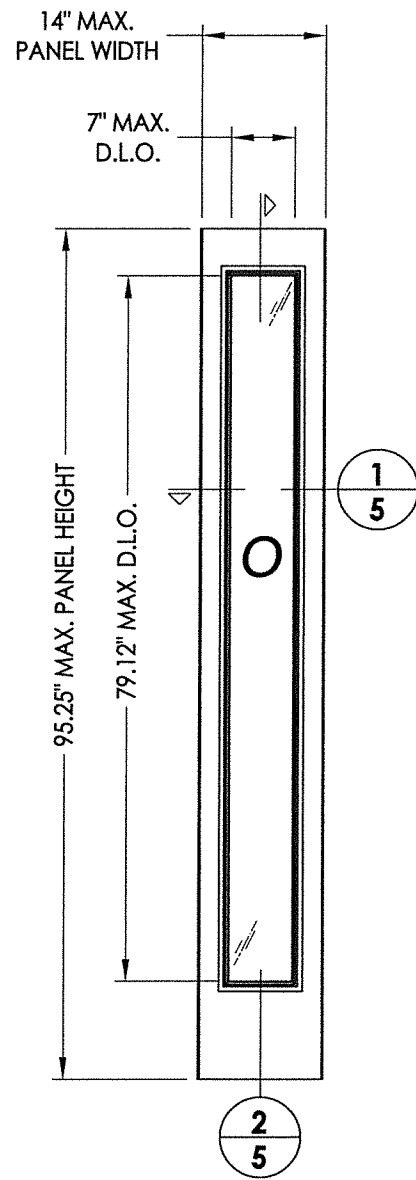

51 SIDELITE PANEL
Classic Craft

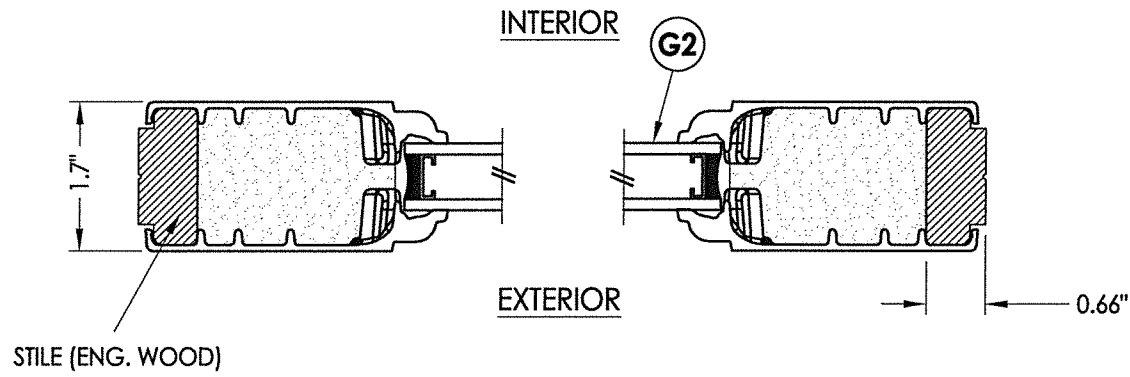

1/5 HORIZONTAL CROSS SECTION

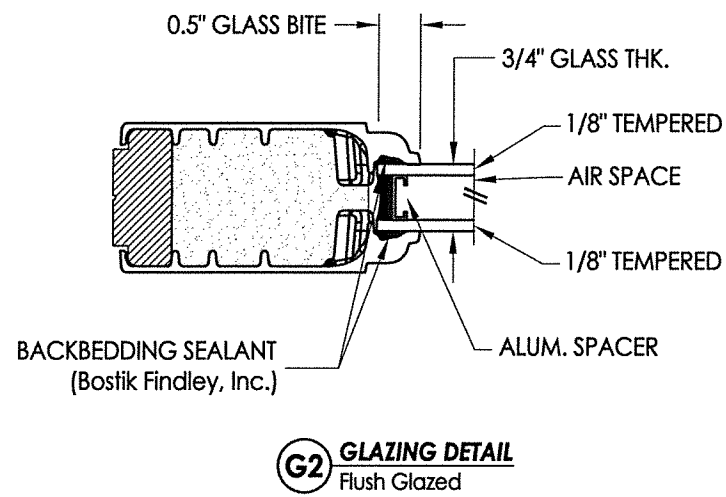

G2 GLAZING DETAIL
Flush Glazed

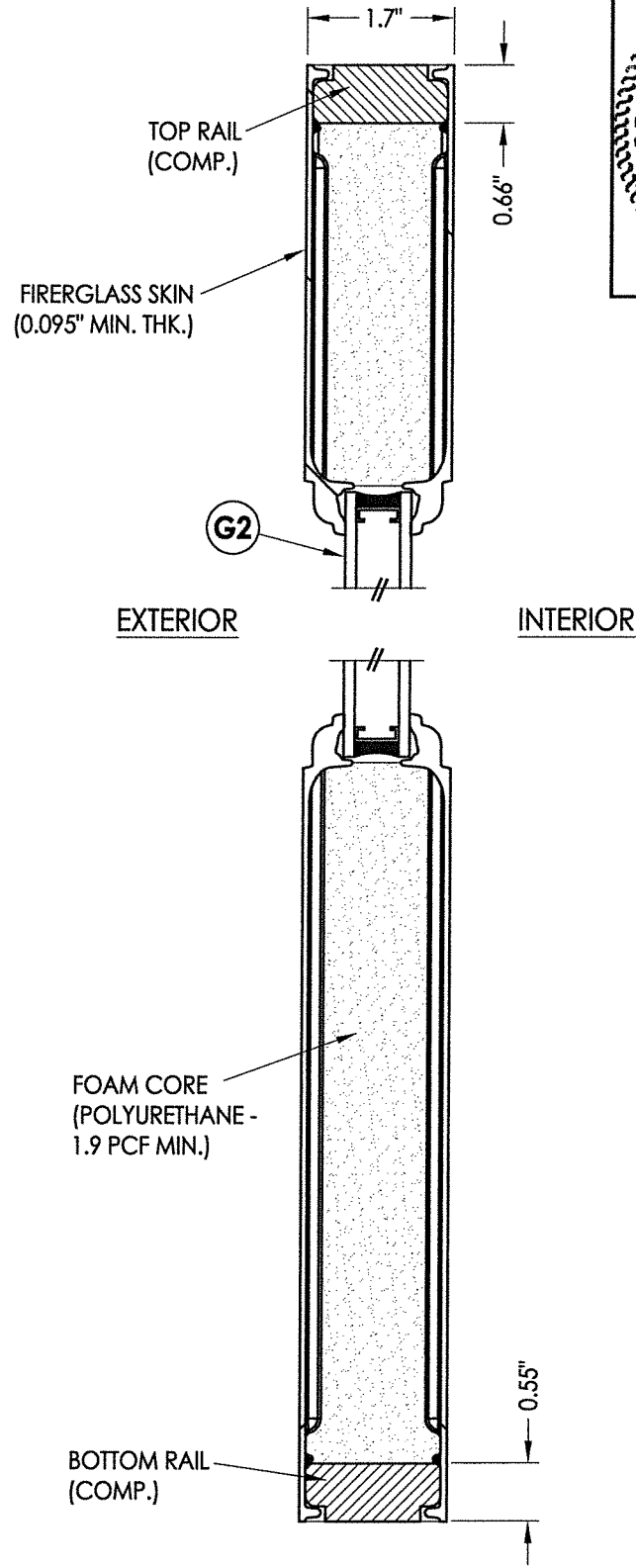

2/5 VERTICAL CROSS SECTION

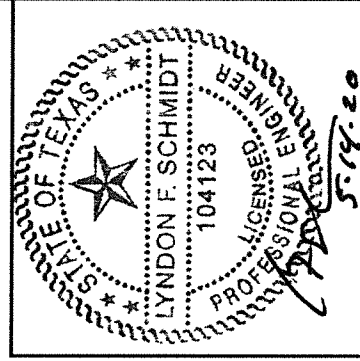

Documents Prepared By: Lyndon F. Schmidt, P.E.
TEXAS P.E. #104123

RW BUILDING CONSULTANTS, INC.
P.O. Box 230 Vairico FL. 33595
Phone No.: 813.659.9197

TEXAS BOARD OF PROFESSIONAL ENGINEERS
CERTIFICATE OF REGISTRATION # F-11852

PRODUCT: THERMA-TRU FIBERGLASS DOOR				
PART OR ASSEMBLY: SIDELITE PANEL & GLAZING DETAIL (CLASSIC CRAFT)				
2	5/14/20	UPDATE TO 2018 IBC/IRC CODE	LFS	BY
1	7/22/15	ADDED GENERAL NOTE 5.	LFS	BY
NO.	DATE	REVISIONS		
DATE: 10/08/12				
SCALE: N.T.S.				
DWG. BY: JK				
CHK. BY: LFS				
DRAWING NO.: TX-4260				
SHEET 5 OF 11				

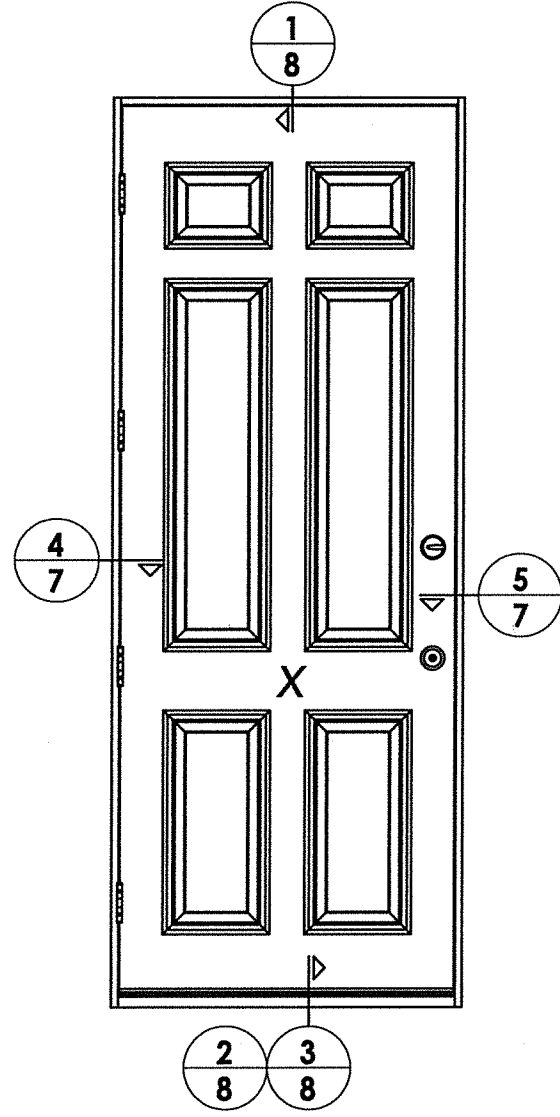

ELEVATION (X)

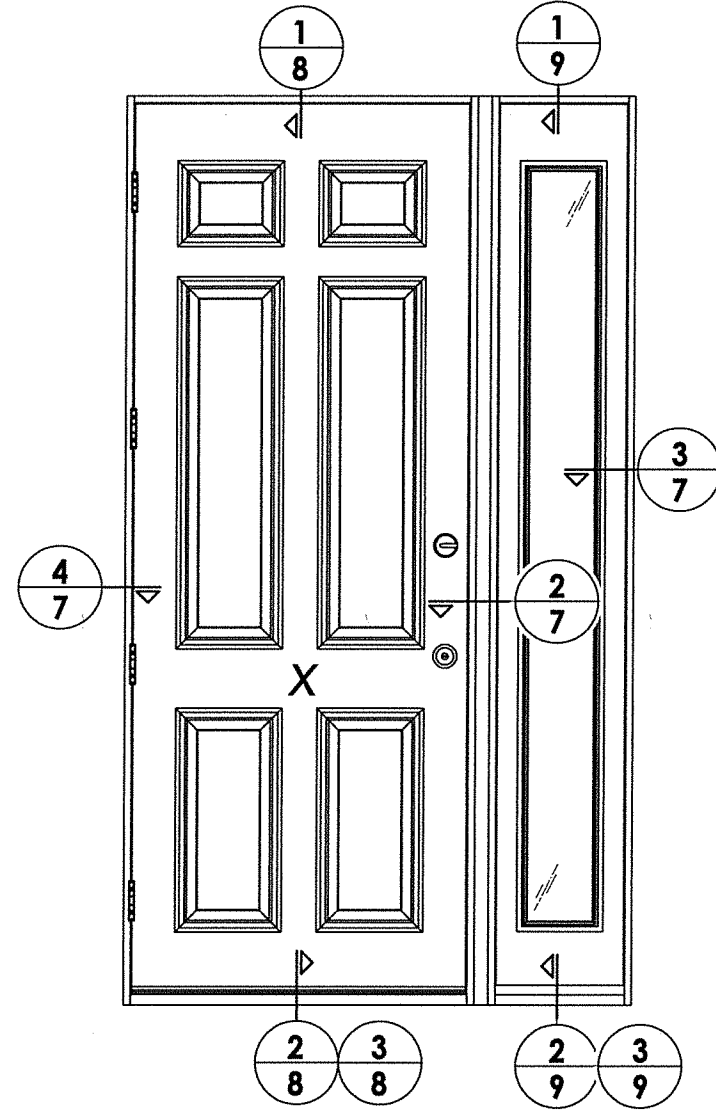

ELEVATION (OX / XO)

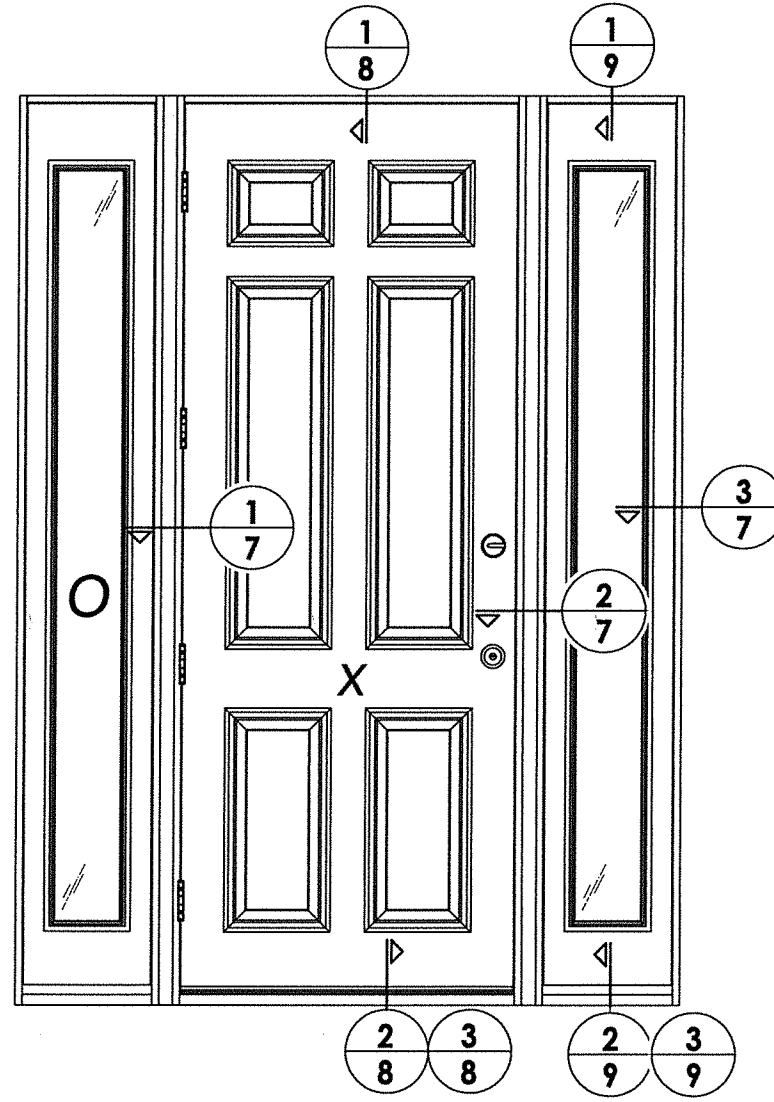

ELEVATION (OXO)

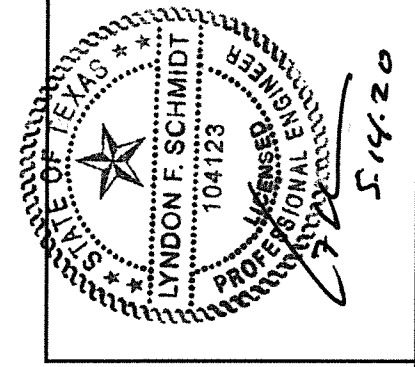

Documents Prepared By: Lyndon F. Schmidt, P.E.
TEXAS P.E. #104123

RW BUILDING CONSULTANTS, INC.
P.O. Box 230 Valrico FL 33595
Phone No.: 813.659.9197

TEXAS BOARD OF PROFESSIONAL ENGINEERS
CERTIFICATE OF REGISTRATION # F-11852

PRODUCT:		THERMA-TRU FIBERGLASS DOOR	
DATE:		10/08/12	
SCALE:		N.T.S.	
DWG. BY:		JK	
CHK. BY:		LFS	
DRAWING NO.:		TX-4260	
SHEET 6 OF 11			
REVISIONS			
NO.	DATE	DESCRIPTION	BY
2	5/14/20	UPDATE TO 2018 IBC/IRC CODE	LFS
1	7/22/15	ADDED GENERAL NOTE 5.	LFS

R:\Clients\Therma Tru PERMANENT\B - Texas Dept of Ins\TDI - DR 600 - 68 - 80 Opaque FG NonImp IS - OS Sgls Dbls w SL\C - Drawings\TX-4260-61.dwg, 7

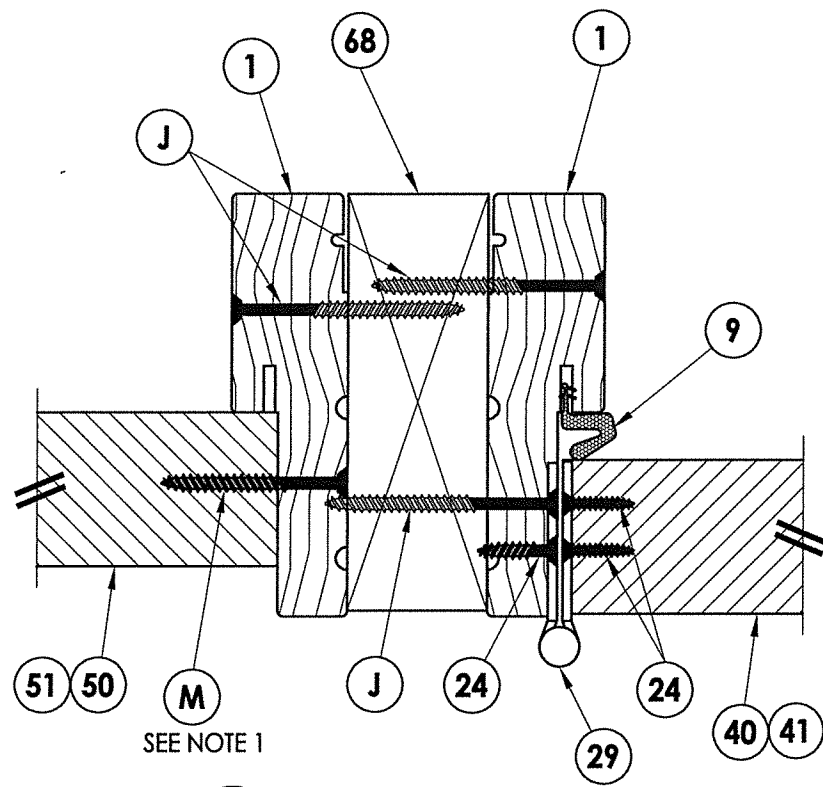

1
7 **HORIZONTAL CROSS SECTION**
Inswing shown - Outswing also approved

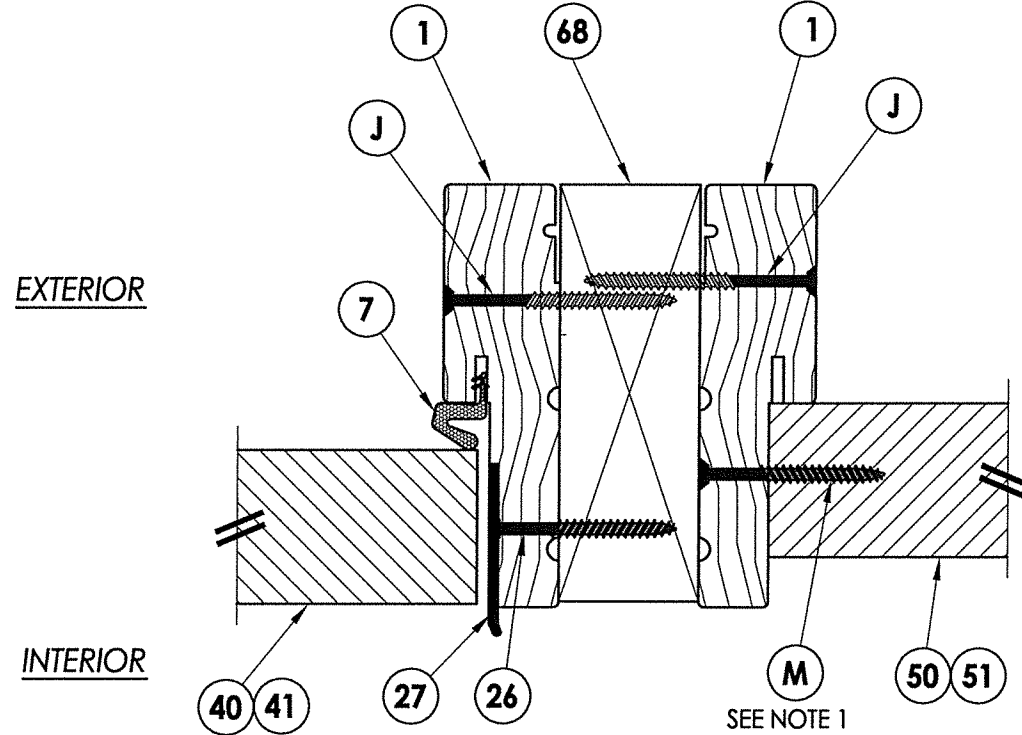

2
7 **HORIZONTAL CROSS SECTION**
Inswing shown - Outswing also approved

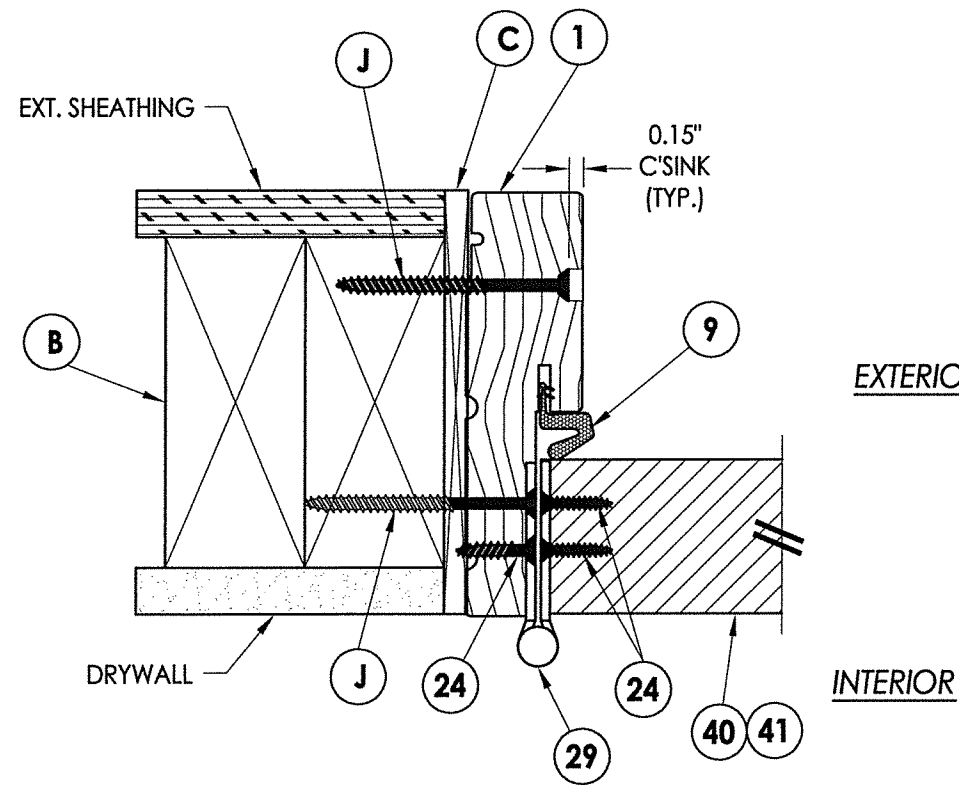

4
7 **HORIZONTAL CROSS SECTION**
Inswing shown - Outswing also approved

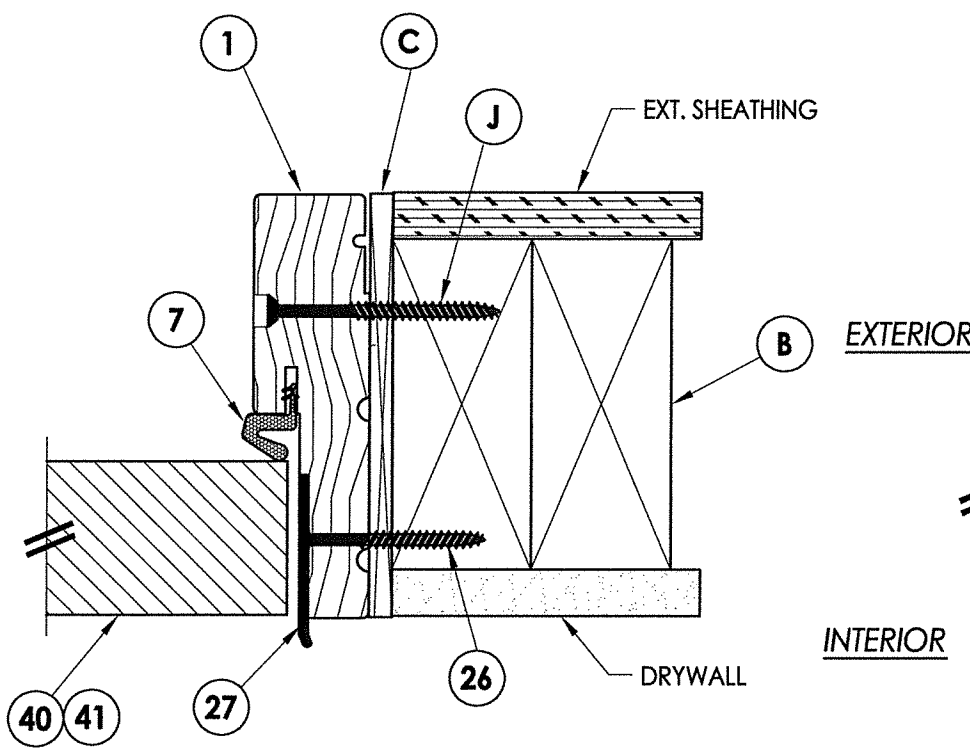

5
7 **HORIZONTAL CROSS SECTION**
Inswing shown - Outswing also approved

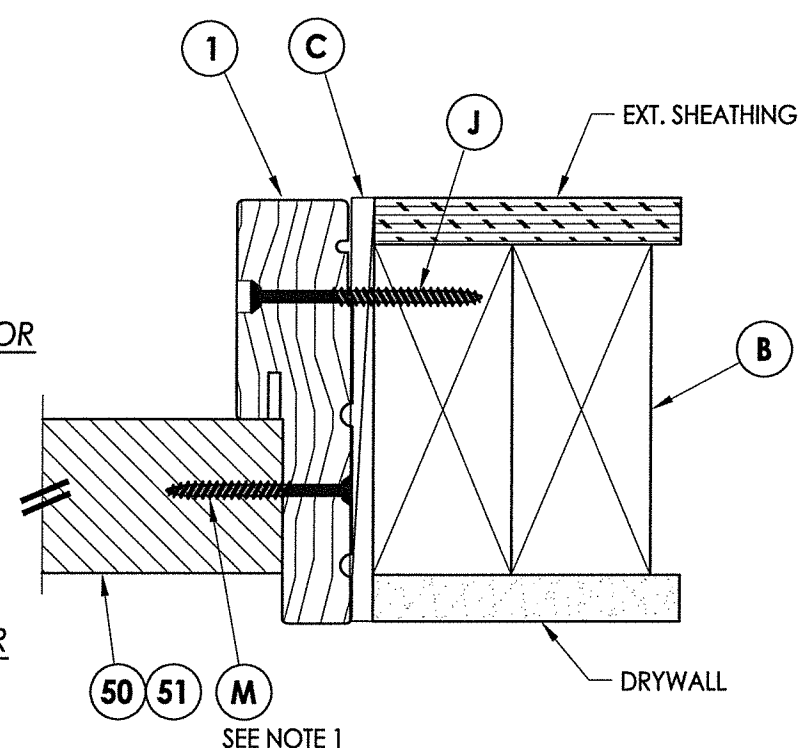

3
7 **HORIZONTAL CROSS SECTION**
Inswing shown - Outswing also approved

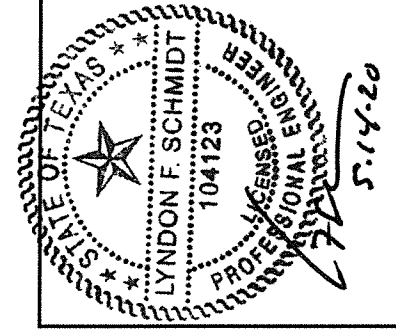

Note:
1. Sidelite assembly screws located 11-1/2" from each end plus 1 more at the center of jamb (3 total).

Documents Prepared By: Lyndon F. Schmidt, P.E.
TEXAS P.E. #104123

RW BUILDING CONSULTANTS, INC.
P.O. Box 230 Valrico FL 33595
Phone No.: 813.659.9197
TEXAS BOARD OF PROFESSIONAL ENGINEERS
CERTIFICATE OF REGISTRATION # F-11852

PRODUCT: THERMA-TRU FIBERGLASS DOOR
PART OR ASSEMBLY: HORIZONTAL CROSS SECTIONS

NO.	DATE	REVISIONS
2	5/14/20	UPDATE TO 2018 IBC/IRC CODE
1	7/22/15	ADDED GENERAL NOTE 5.
		LFS
		BY

DATE: 10/08/12

SCALE: N.T.S.

DWG. BY: JK

CHK. BY: LFS

DRAWING NO.: TX-4260

SHEET 7 OF 11

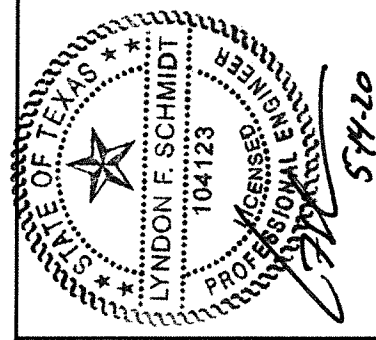

Documents Prepared By: Lyndon F. Schmidt, P.E.
TEXAS P.E. #104123

RW BUILDING CONSULTANTS, INC.
P.O. Box 230 Valrico FL, 33595
Phone No.: 813.659.9197

TEXAS BOARD OF PROFESSIONAL ENGINEERS
CERTIFICATE OF REGISTRATION # F-11852

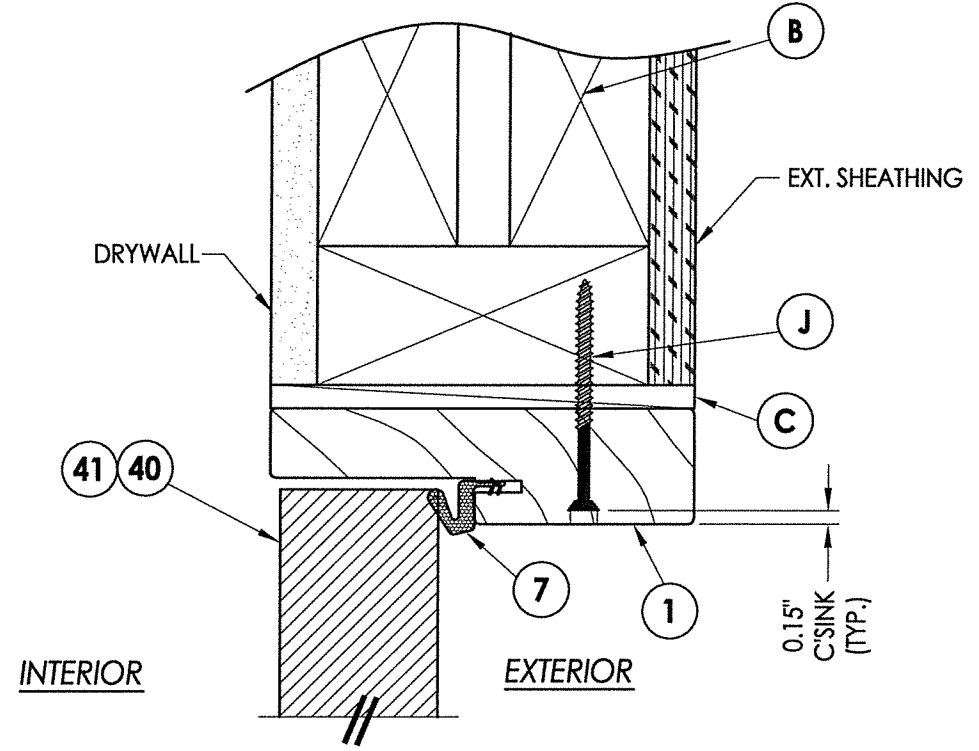

1 VERTICAL CROSS SECTION
8 Inswing shown - Outswing also approved

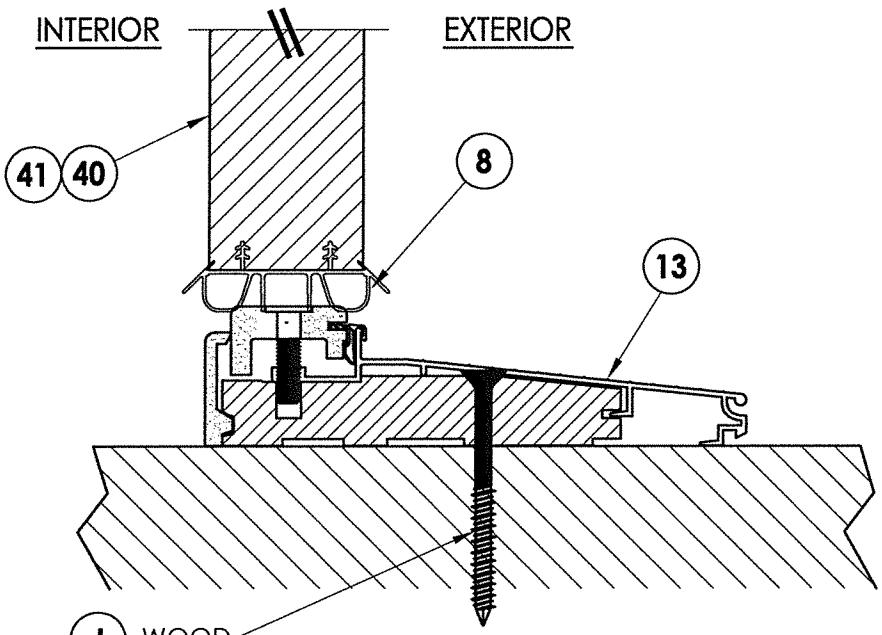

2 VERTICAL CROSS SECTION
8 Inswing configuration

J WOOD
P CONCRETE

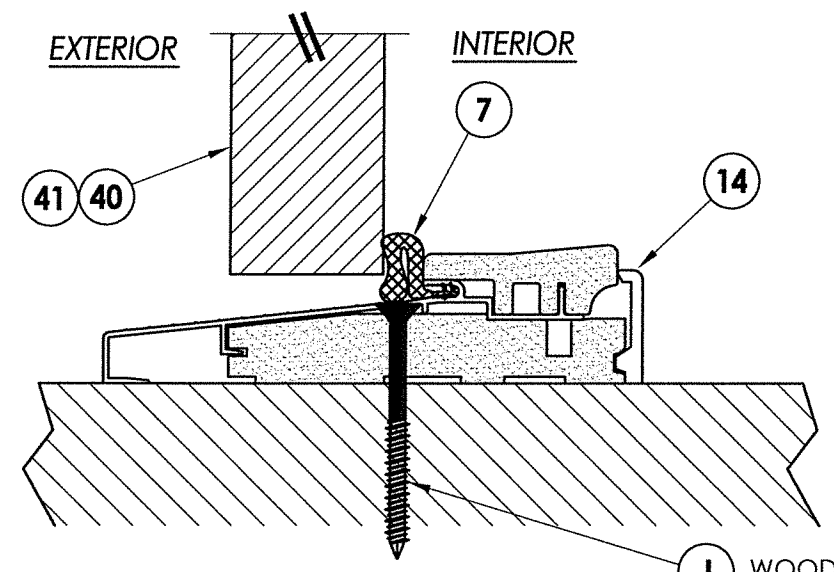

3 VERTICAL CROSS SECTION
8 Outswing configuration

J WOOD
P CONCRETE

PRODUCT: THERMA-TRU FIBERGLASS DOOR	
PART OR ASSEMBLY: VERTICAL CROSS SECTIONS	
NO.	DATE
2	5/14/20
1	7/22/15
REVISIONS	
DATE: 10/08/12	
SCALE: N.T.S.	
DWG. BY: JK	
CHK. BY: LFS	
DRAWING NO.: TX-4260	
SHEET 8 OF 11	

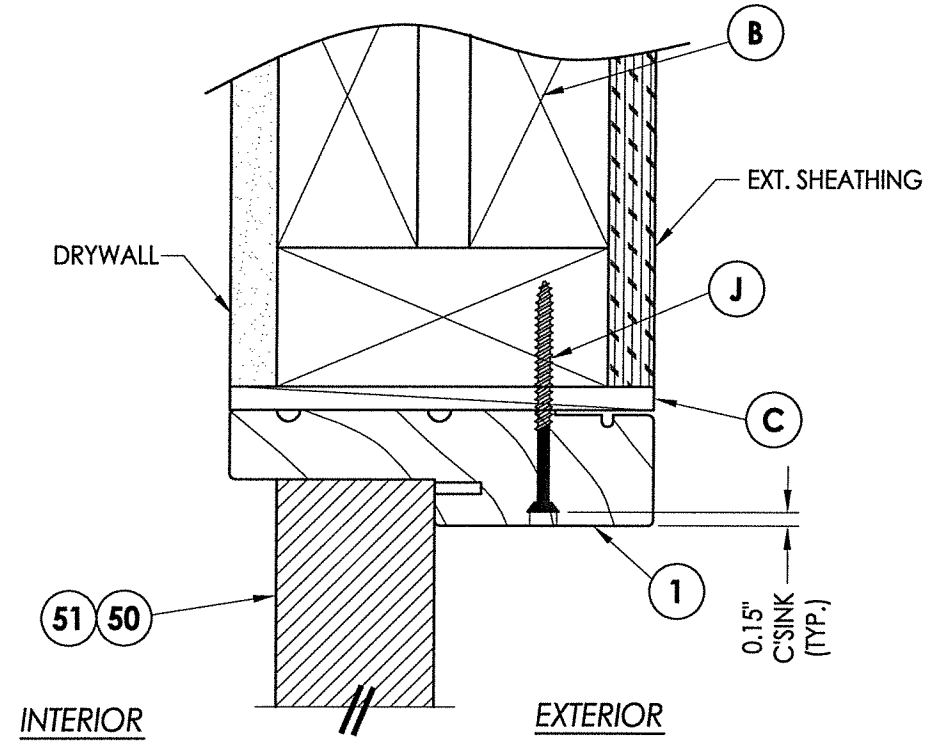

1 VERTICAL CROSS SECTION
9 Inswing shown - Outswing also approved

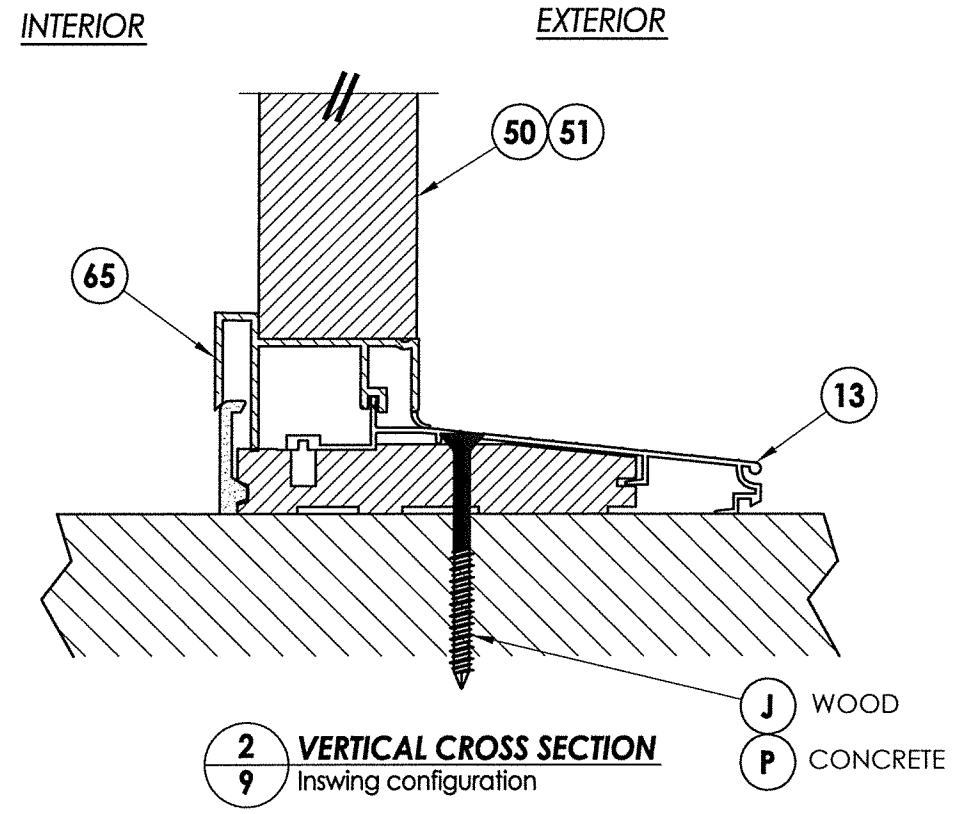

2 VERTICAL CROSS SECTION
9 Inswing configuration

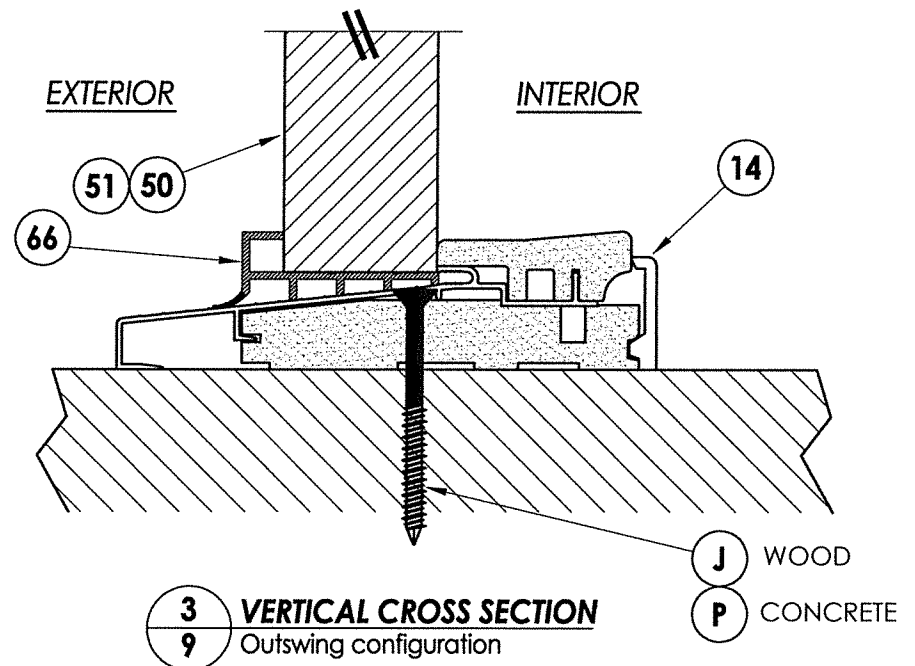

3 VERTICAL CROSS SECTION
9 Outswing configuration

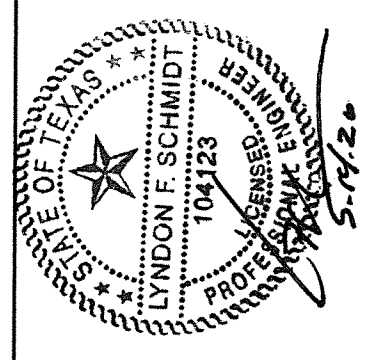

Documents Prepared By: Lyndon F. Schmidt, P.E.
 TEXAS P.E. #104123

RW BUILDING CONSULTANTS, INC.
 P.O. Box 230 Valrico FL 33595
 Phone No.: 813.659.9197

TEXAS BOARD OF PROFESSIONAL ENGINEERS
 CERTIFICATE OF REGISTRATION # F-11852

PRODUCT: THERMA-TRU FIBERGLASS DOOR
 PART OR ASSEMBLY: VERTICAL CROSS SECTIONS

NO.	DATE	REVISIONS
2	5/14/20	UPDATE TO 2018 IBC/IRC CODE
1	7/22/15	ADDED GENERAL NOTE 5.
		LFS BY

DATE: 10/08/12
 SCALE: N.T.S.
 DWG. BY: JK
 CHK. BY: LFS
 DRAWING NO.: TX-4260
 SHEET 9 OF 11

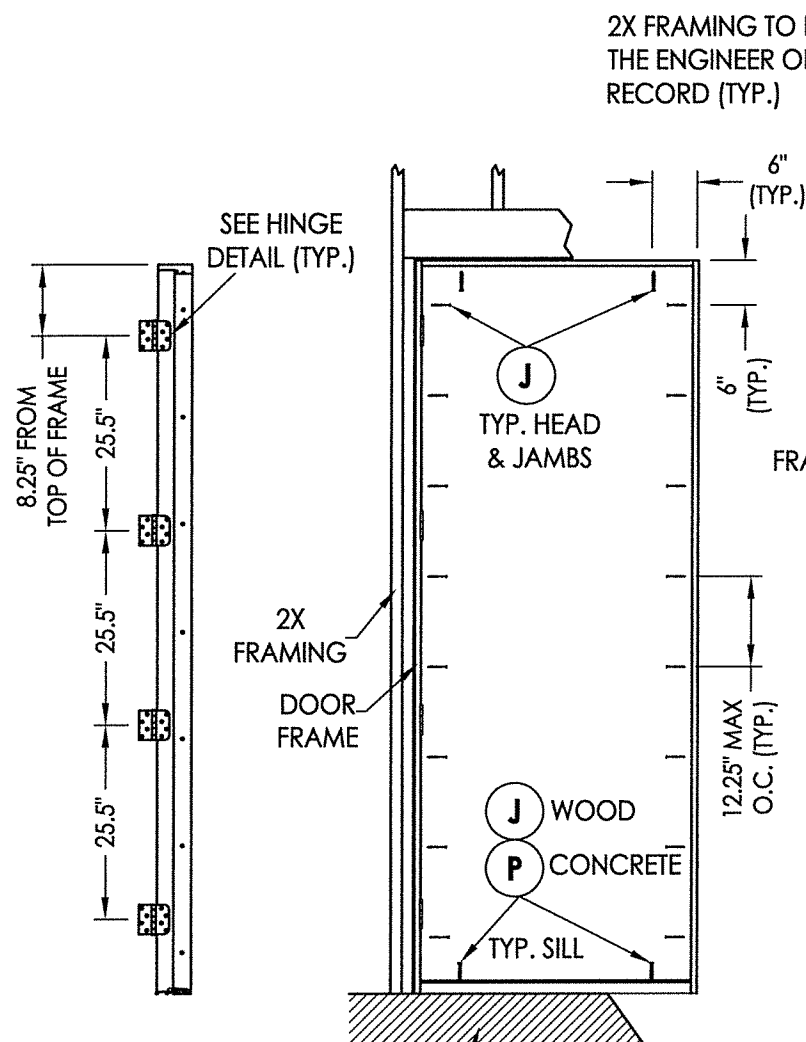

HINGE JAMB

FLOOR SUBSTRATE MATERIAL (TYP.)
 CONCRETE (MIN. 3000 PSI)
 WOOD (S.G. >= 0.42)

FRAME ANCHORING
 X

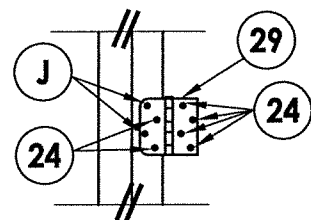

HINGE DETAIL
 Inswing

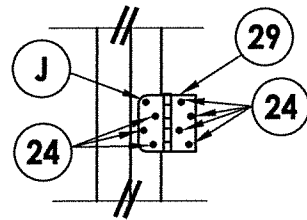

HINGE DETAIL
 Outswing

2X FRAMING TO BE DESIGNED BY THE ENGINEER OR ARCHITECT OF RECORD (TYP.)

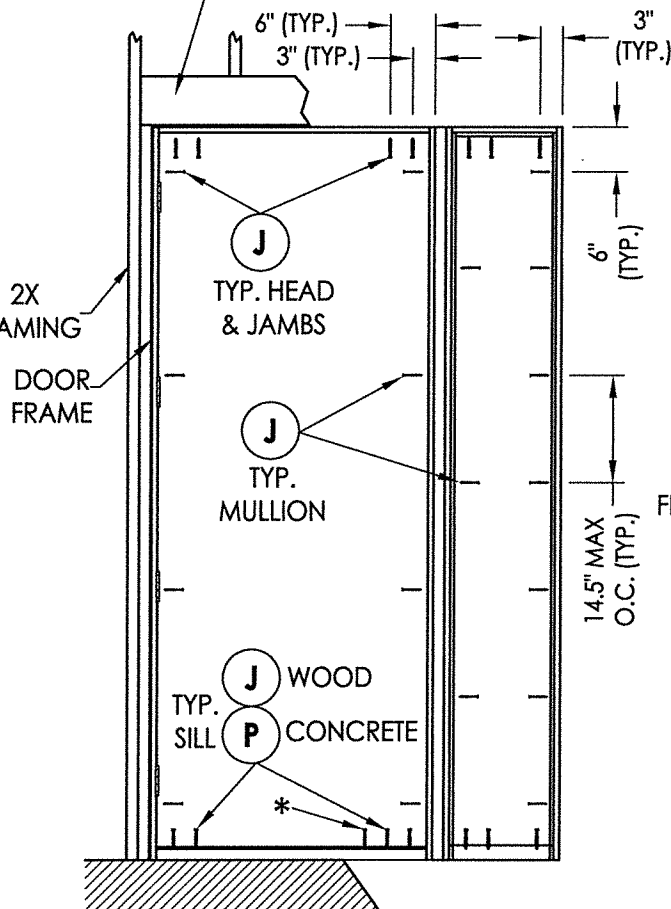

FRAME ANCHORING
 XO / OX

*This anchor required for D.P > 60 psf.

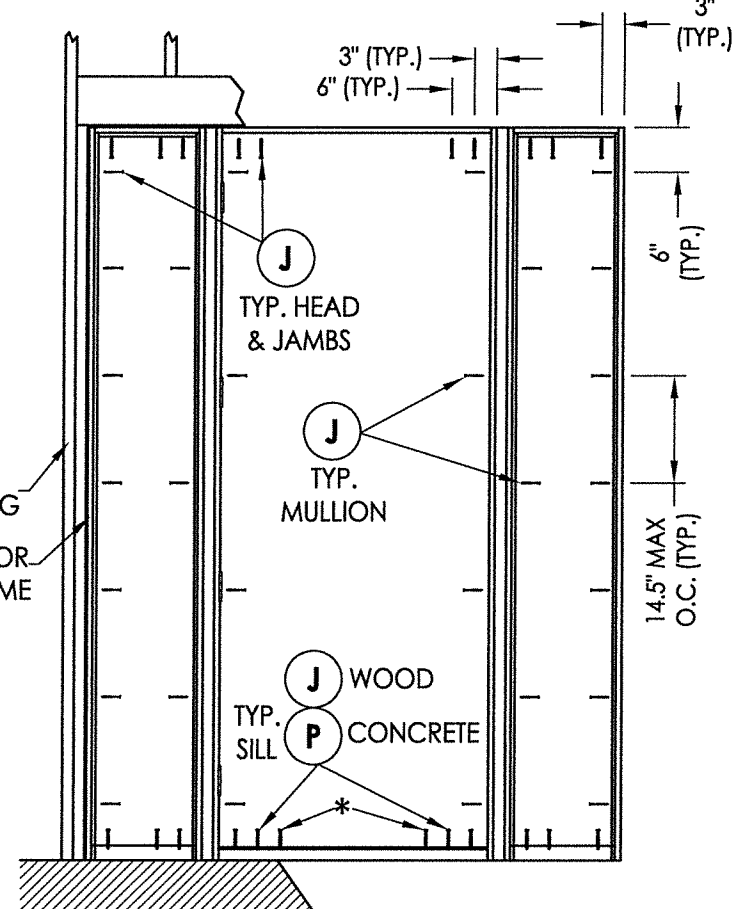

FRAME ANCHORING
 OXO

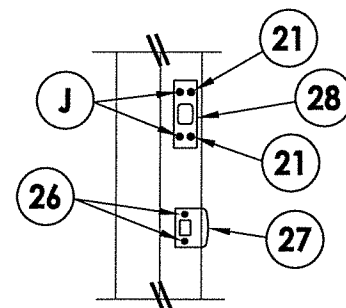

LATCH & DEADBOLT STRIKE DETAIL
 Kwikset Hardware - Standard Strike

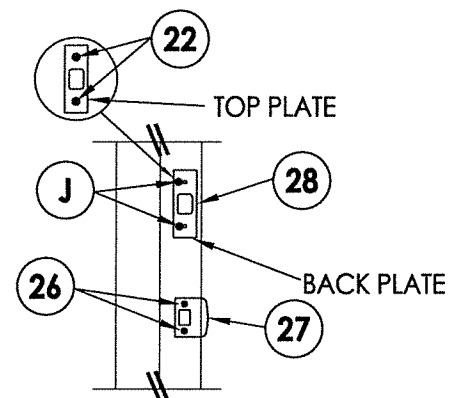

LATCH & DEADBOLT STRIKE DETAIL
 Schlage Hardware - Standard Strike

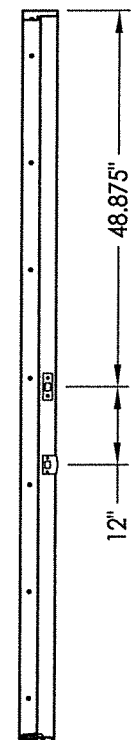

STRIKE JAMB

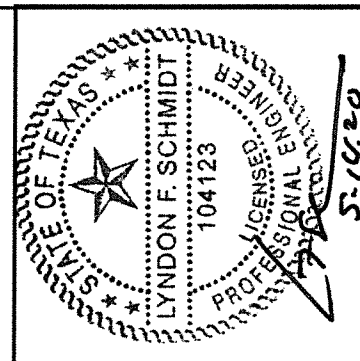

Documents Prepared By: Lyndon F. Schmidt, P.E.
 TEXAS P.E. #104123

RW BUILDING CONSULTANTS, INC.
 P.O. Box 230 Valrico FL, 33595
 Phone No.: 813.659.9197

TEXAS BOARD OF PROFESSIONAL ENGINEERS
 CERTIFICATE OF REGISTRATION # F-11852

PRODUCT:	THERMA-TRU FIBERGLASS DOOR		
PART OR ASSEMBLY:	FRAME ANCHORING		
NO.	DATE	BY	REVISIONS
2	5/14/20	LFS	UPDATE TO 2018 IBC/IRC CODE
1	7/22/15	LFS	ADDED GENERAL NOTE 5.
DATE: 10/08/12			
SCALE: N.T.S.			
DWG. BY: JK			
CHK. BY: LFS			
DRAWING NO.: TX-4260			
SHEET 10 of 11			

