

MORTISE LOCKSET WITH OR WITHOUT DEADBOLT

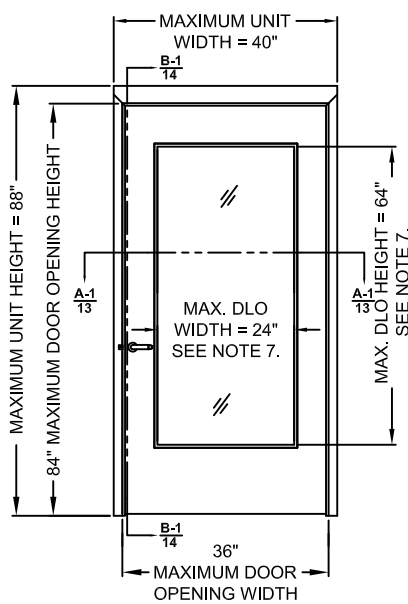

| CONFIG. | DESIGN PRESSURE RATING, PSF | |
|---------|--|--|
| | WHERE WATER INFILTRATION REQUIREMENT IS NEEDED SEE SHEET 5 | WHERE WATER INFILTRATION REQUIREMENT IS NOT NEEDED SEE SHEET 6 |
| 1 | ±75 | ±75 |

CYLINDRICAL LOCKSET 1/2" MIN. THROW LATCH

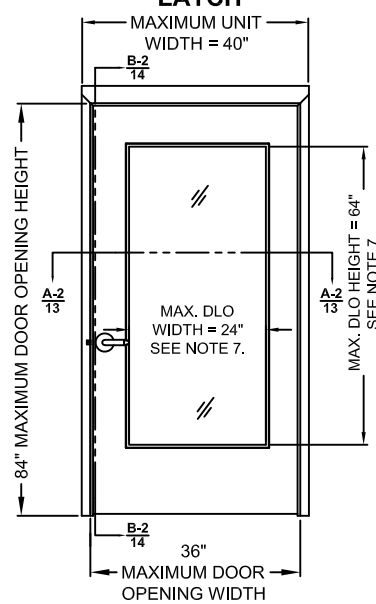

| CONFIG. | DESIGN PRESSURE RATING, PSF | |
|---------|--|--|
| | WHERE WATER INFILTRATION REQUIREMENT IS NEEDED SEE SHEET 5 | WHERE WATER INFILTRATION REQUIREMENT IS NOT NEEDED SEE SHEET 6 |
| 2 | ±75 | ±75 |

SURFACE VERTICAL ROD EXIT DEVICE

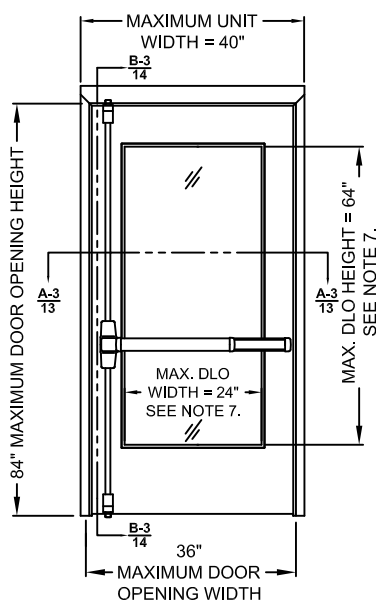

| CONFIG. | DESIGN PRESSURE RATING, PSF | |
|---------|--|--|
| | WHERE WATER INFILTRATION REQUIREMENT IS NEEDED SEE SHEET 5 | WHERE WATER INFILTRATION REQUIREMENT IS NOT NEEDED SEE SHEET 6 |
| 3 | ±60 | ±60 |

CONCEALED VERTICAL ROD EXIT DEVICE

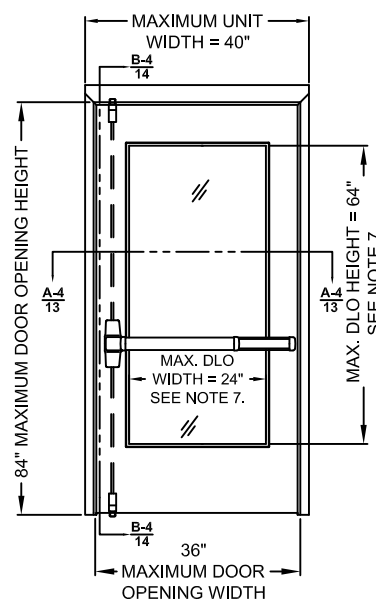

| CONFIG. | DESIGN PRESSURE RATING, PSF | |
|---------|--|--|
| | WHERE WATER INFILTRATION REQUIREMENT IS NEEDED SEE SHEET 5 | WHERE WATER INFILTRATION REQUIREMENT IS NOT NEEDED SEE SHEET 6 |
| 4 | ±60 | ±60 |

THREE-POINT LATCHING EXIT DEVICE

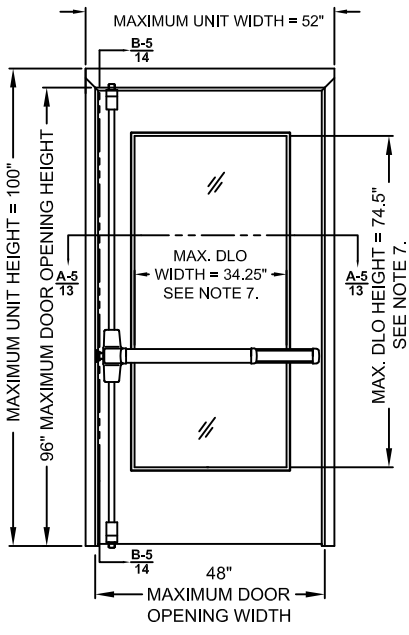

| CONFIG. | DESIGN PRESSURE RATING, PSF | |
|---------|--|--|
| | WHERE WATER INFILTRATION REQUIREMENT IS NEEDED SEE SHEET 5 | WHERE WATER INFILTRATION REQUIREMENT IS NOT NEEDED SEE SHEET 6 |
| 5 | ±50 | ±50 |

THREE-POINT LATCHING EXIT DEVICE

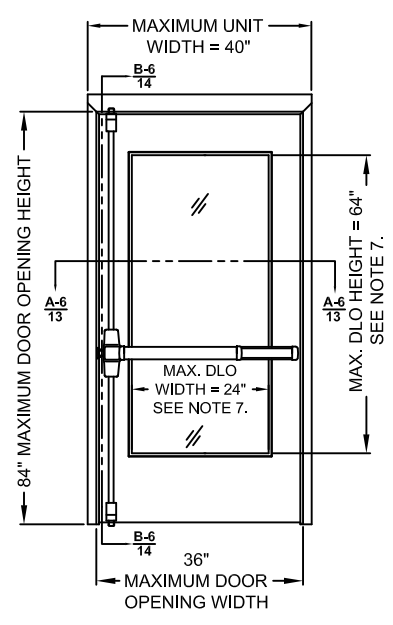

| CONFIG. | DESIGN PRESSURE RATING, PSF | |
|---------|--|--|
| | WHERE WATER INFILTRATION REQUIREMENT IS NEEDED SEE SHEET 5 | WHERE WATER INFILTRATION REQUIREMENT IS NOT NEEDED SEE SHEET 6 |
| 6 | ±60 | ±60 |

CYLINDRICAL LOCKSET 1/2" MIN. THROW LATCH

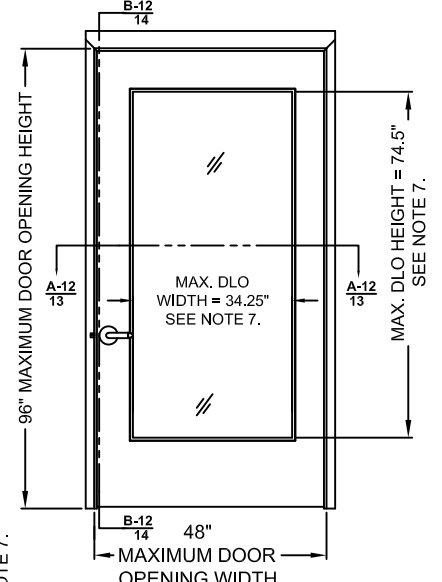

| CONFIG. | DESIGN PRESSURE RATING, PSF | |
|---------|--|--|
| | WHERE WATER INFILTRATION REQUIREMENT IS NEEDED SEE SHEET 5 | WHERE WATER INFILTRATION REQUIREMENT IS NOT NEEDED SEE SHEET 6 |
| 12 | ±50 | ±50 |

RIM EXIT DEVICE

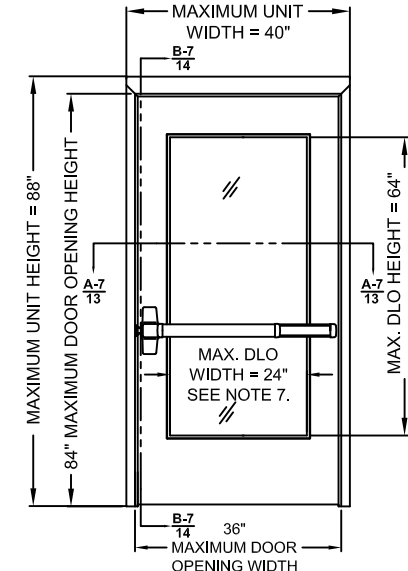

| CONFIG. | DESIGN PRESSURE RATING, PSF | |
|---------|--|--|
| | WHERE WATER INFILTRATION REQUIREMENT IS NEEDED SEE SHEET 5 | WHERE WATER INFILTRATION REQUIREMENT IS NOT NEEDED SEE SHEET 6 |
| 7 | ±60 | ±60 |

RIM EXIT DEVICE

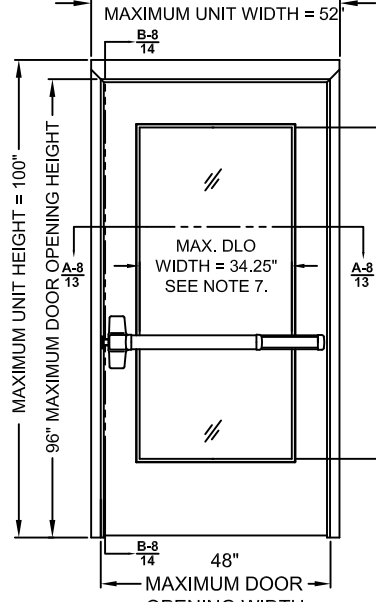

| CONFIG. | DESIGN PRESSURE RATING, PSF | |
|---------|--|--|
| | WHERE WATER INFILTRATION REQUIREMENT IS NEEDED SEE SHEET 5 | WHERE WATER INFILTRATION REQUIREMENT IS NOT NEEDED SEE SHEET 6 |
| 8 | ±50 | ±50 |

RIM EXIT DEVICE

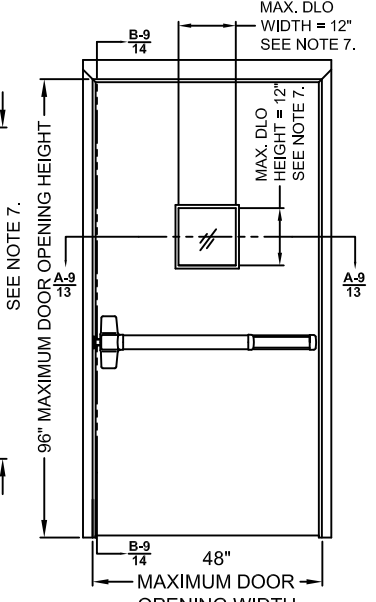

| CONFIG. | DESIGN PRESSURE RATING, PSF | |
|---------|--|--|
| | WHERE WATER INFILTRATION REQUIREMENT IS NEEDED SEE SHEET 5 | WHERE WATER INFILTRATION REQUIREMENT IS NOT NEEDED SEE SHEET 6 |
| 9 | ±75 | ±100 |

RIM EXIT DEVICE

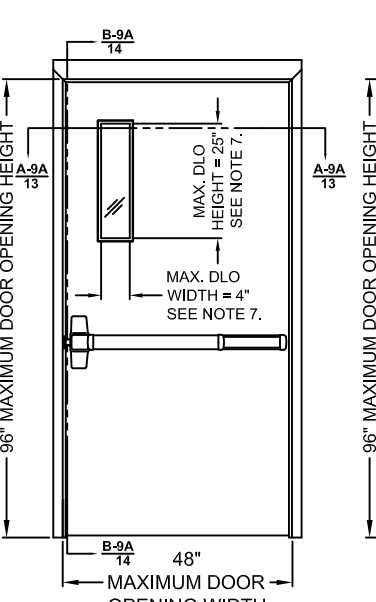

| CONFIG. | DESIGN PRESSURE RATING, PSF | |
|---------|--|--|
| | WHERE WATER INFILTRATION REQUIREMENT IS NEEDED SEE SHEET 5 | WHERE WATER INFILTRATION REQUIREMENT IS NOT NEEDED SEE SHEET 6 |
| 9A | ±75 | ±100 |

EXIT ALARM LOCK

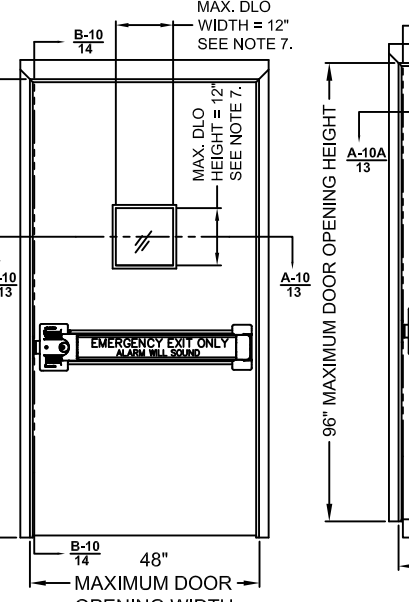

| CONFIG. | DESIGN PRESSURE RATING, PSF | |
|---------|--|--|
| | WHERE WATER INFILTRATION REQUIREMENT IS NEEDED SEE SHEET 5 | WHERE WATER INFILTRATION REQUIREMENT IS NOT NEEDED SEE SHEET 6 |
| 10 | ±55 | ±55 |

EXIT ALARM LOCK

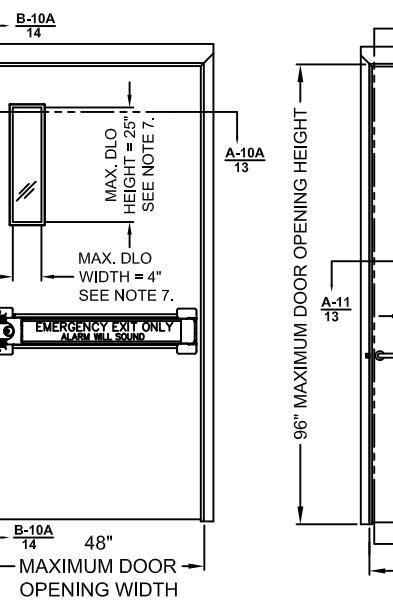

| CONFIG. | DESIGN PRESSURE RATING, PSF | |
|---------|--|--|
| | WHERE WATER INFILTRATION REQUIREMENT IS NEEDED SEE SHEET 5 | WHERE WATER INFILTRATION REQUIREMENT IS NOT NEEDED SEE SHEET 6 |
| 10A | ±55 | ±55 |

MORTISE LOCKSET WITH OR WITHOUT DEADBOLT

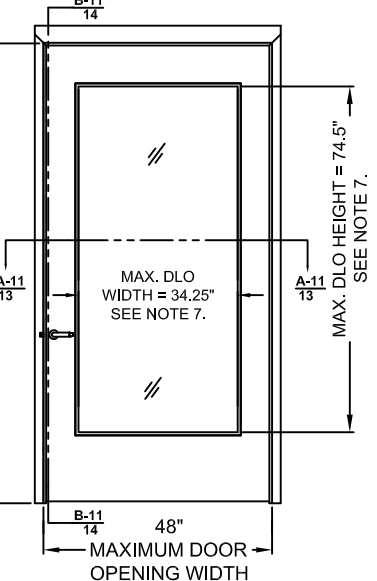

| CONFIG. | DESIGN PRESSURE RATING, PSF | |
|---------|--|--|
| | WHERE WATER INFILTRATION REQUIREMENT IS NEEDED SEE SHEET 5 | WHERE WATER INFILTRATION REQUIREMENT IS NOT NEEDED SEE SHEET 6 |
| 11 | ±50 | ±50 |

COMPLIANCE STATEMENT:

1. THESE PRODUCTS HAVE BEEN TESTED TO PROTOCOLS TAS 201, 202 & 203-94, ASTM PROTOCOLS E283-04(12), E330-14 AND E331-00(09), AND COMPLY WITH 2018 IBC & IRC.

NOTES:

- INTERIOR VIEWS ARE SHOWN FOR ALL ELEVATIONS OF OUTSWING DOOR
- SEE TABLE 1 ON SHEET 2 FOR GLAZING SIZE, HARDWARE APPLICATIONS AND LIMITATIONS
- SEE SHEET 3 AND 16 FOR HINGE REQUIREMENTS
- SEE SHEET 4 FOR ANCHORING TYPES AND LIMITATIONS AND SHEET 5 & 6 FOR SILL WEATHERING INSTALLATION
- SEE SHEET 5 TABLES 3.1 AND 3.2 FOR WATER RATED THRESHOLD AND WEATHERSTRIPPING INSTALLATION AND LIMITATIONS
- SEE SHEET 6 TABLES 4.1 AND 4.2 FOR NON WATER RATED THRESHOLD AND WEATHERSTRIPPING INSTALLATION AND LIMITATIONS
- SEE SHEET 9 FOR GLAZING OPTIONS AND DETAILS
- DLO - DAYLIGHT OPENING SIZE, SAME AS EXPOSED GLASS. SEE SHEETS 1, 2, 8 AND 9 FOR LIMITATIONS
- ALL CONFIGURATIONS MEET LARGE AND SMALL MISSILE IMPACT REQUIREMENTS- LARGE MISSILE IMPACT (50 F/S)

| | | | |
|------------------------|------------------|--|---------------------|
| BEND RADIUS | | SCHLAGE LOCK COMPANY, LLC 11819 N. PENNSYLVANIA STREET CARMEL, IN 46032 | |
| THIRD ANGLE PROJECTION | | TITLE: STEELCRAFT H SERIES SINGLE OUTSWING GLAZED COMMERCIAL STEEL DOORS WITH AND WITHOUT PANIC EXIT DEVICES | |
| DRAWN YMF | DATE 05/20/07 | GLASS OUTSWING DOORS AND HARDWARE CONFIGURATIONS COMMERCIAL DOOR OPENING SINGLE GLASS DOORS. | |
| CHECKED | | SIZE FLAT | DWG NO. IRGS07-T |
| APPROVED | | SCALE: NTS | REV B 1-9-20 |
| ENG. APPVL JPD | 11/15/07 | AUTOCAD | SHEET 1 of 16 |

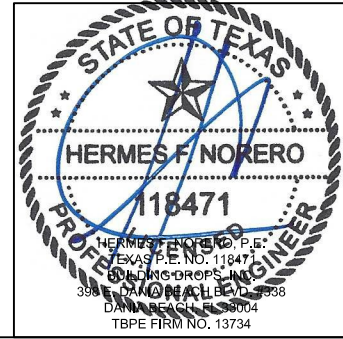

| Door Configuration | Maximum Design Pressure, PSF | | Maximum Door Opening Size, in. | | Maximum DLO Size, in. (NOTE 3) | | Locking Hardware Description | | | | Comments | | |
|--------------------|------------------------------|-----------------------|--------------------------------|--------|--------------------------------|--------|------------------------------------|---|---|------------|---|--------|---|
| | Positive | Negative | Width | Height | Width | Height | Hardware Family | Model/Series | Strike Models | Brand | | | |
| 1 | 75 | 75 | 36 | 84 | 24 | 64 | Mortise Lock | L/LV9400, AD-MD, CO-MD | 10-072 | Schlage | Function with deadbolt, 3/4" min. throw latch & 1" min. throw bolt | | |
| | | | | | | | | L/LV9000, AD-MD, CO-MD | | | Function w/o deadbolt, 3/4" min. throw latch | | |
| | | | | | | | | LE-MS, LEB-MS, LE-MB, LEB-MS, LE-MD, LEB-MD | | | Function with or w/o deadbolt, 3/4" min. throw latch & 1" min. throw bolt (if applicable) | | |
| | | | | | | | | M/MA | | | ANSI | Falcon | Function with or w/o deadbolt, 3/4" min. throw latch & 1" min. throw bolt (if applicable) |
| 2 | 75 | 75 | 36 | 84 | 24 | 64 | Cylindrical Lock | D, ND, NDE, NDEB, AD-CY, CO-CY | 10-025 | Schlage | 1/2" min throw latch | | |
| | | | | | | | | T | ANSI | Falcon | 1/2" min throw latch | | |
| 3 | 60 | 60 | 36 | 84 | 24 | 64 | Surface Vertical Rod Exit Device | 98/9927 & 98/9927-F | 299-F,499-F Top, 304L Bottom | Von Duprin | | | |
| | | | | | | | | F-25-V & 25-V | 3788 Top, 2130 Bottom | Falcon | | | |
| 4 | 60 | 60 | 36 | 84 | 24 | 64 | Concealed Vertical Rod Exit Device | 98/9947-F & HH98/9947 | 338 Top, 304L or 385A Bottom | Von Duprin | HH98/9947 devices have a 2-3/4" backset | | |
| | | | | | | | | 33/3547A -F & HH33/3547A | 338 Top, 304L or 385A Bottom | Von Duprin | HH33/3547A devices have a 2-3/4" backset | | |
| | | | | | | | | F-25-C | 4188 Top, 2130 Bottom | Falcon | | | |
| 5 | 50 | 50 | 48 | 96 | 34.25 | 74.5 | Three-Point Latching Device | 98/9957 & 98/9957-F | 299-F,499-F Top/Middle, 304L Bottom | Von Duprin | | | |
| 6 | 60 | 60 | 36 | 84 | 24 | 64 | Three-Point Latching Device | 98/9957 & 98/9957-F | 299-F,499-F Top/Middle, 304L,248L4 Bottom | Von Duprin | | | |
| 7 | 60 | 60 | 36 | 84 | 24 | 64 | Rim Exit Device | 98/99 & 98/99-F | 299-F,499-F | Von Duprin | | | |
| | | | | | | | | 88-F | 268/468 | Von Duprin | | | |
| 8 | 50 | 50 | 48 | 96 | 34.25 | 74.5 | Rim Exit Device | 98/99 & 98/99-F | 299-F,499-F | Von Duprin | | | |
| | | | | | | | | 88-F | 268/468 | Von Duprin | | | |
| 9 | 75/100 SEE NOTE 2. | 75/100 SEE NOTE 2. | 48 | 96 | 12 | 12 | Rim Exit Device | XP98/99 & XP98/99-F | 909/954 | Von Duprin | | | |
| 9A | | | | | | | | | | | | 3 | 33 |
| 4 | | | | | | | | | | | | 25 | |
| 10 | 55 | 55 | 48 | 96 | 12 | 12 | Exit Alarm Lock | 2670 Guard-X | 267 | Von Duprin | | | |
| 10A | | | | | | | | | | | | 3 | 33 |
| 4 | | | | | | | | | | | | 25 | |
| 11 | 50 | 50 | 48 | 96 | 34.25 | 74.5 | Mortise Lock | L/LV9400, AD-MD, CO-MD | 10-072 | Schlage | Function with deadbolt, 3/4" min. throw latch & 1" min. throw bolt | | |
| | | | | | | | | L/LV9000, AD-MS, CO-MS | | | Function w/o deadbolt, 3/4" min. throw latch | | |
| | | | | | | | | LE-MS, LEB-BS, LE-MB, LEB-MB, LE-MD, LEB-MD | | | Function with or w/o deadbolt, 3/4" min. throw latch & 1" min. throw bolt (if applicable) | | |
| | | | | | | | | M/MA | | | ANSI | Falcon | Function with or w/o deadbolt, 3/4" min. throw latch & 1" min. throw bolt (if applicable) |
| 12 | 50 | 50 | 48 | 96 | 34.25 | 74.5 | Cylindrical Lock | D, ND, NDE, NDEB, AD-CY, CO-CY | 10-025 | Schlage | 1/2" min throw latch | | |
| | | | | | | | | ALX | ANSI | | | | |
| | | | | | | | | T | ANSI | Falcon | 1/2" min throw latch | | |

TABLE 1.

- NOTES:
- SEE SHEETS 10, 11 & 12 FOR LOCKING HARDWARE.
 - DOOR CONFIGURATIONS 9 AND 9A ARE RATED FOR MAXIMUM DESIGN PRESSURE UP TO ±75 PSF WITH ZERO INT'L THRESHOLD 12A OR FOR DOOR OPENINGS UP TO 3'-0" X 7'-0" WITH NGP THRESHOLD 12B AND ±50 PSF FOR DOOR OPENINGS UP TO 4'-0" X 8'-0" WITH NGP THRESHOLD 12B WHEN WATER INFILTRATION REQUIREMENT IS NEEDED. SEE SHEET 5
 - 2.1 DOOR CONFIGURATIONS 9 AND 9A ARE RATED FOR A MAXIMUM DESIGN PRESSURE UP TO ±75PSF WITH ZERO INT'L THRESHOLD OPTIONS AND UP TO ±100 PSF WITH NGP THRESHOLD OPTIONS WHEN WATER INFILTRATION REQUIREMENT IS NOT NEEDED. SEE SHEET 6
 - DLO - DAYLIGHT OPENING, SAME AS EXPOSED GLASS. SEE SHEETS 1, 2, 8 & 9 FOR GLAZING TYPES, DETAILS AND LIMITATIONS.

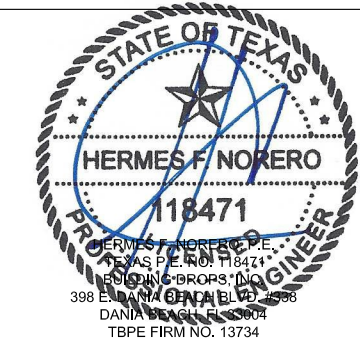

| | | | | | |
|-------------------|------------------|--|------|---------------------|------------------|
| BEND RADIUS | | SCHLAGE LOCK COMPANY, LLC 11819 N. PENNSYLVANIA STREET CARMEL, IN 46032 | | | |
| | | TITLE: STEELCRAFT H SERIES SINGLE OUTSWING GLAZED COMMERCIAL STEEL DOORS WITH AND WITHOUT PANIC EXIT DEVICES | | | |
| DRAWN YMF | DATE 05/20/07 | GLASS OUTSWING DOORS AND HARDWARE CONFIGURATIONS COMMERCIAL DOOR OPENING SINGLE GLASS DOORS. | | | |
| CHECKED | | SIZE | FLAT | DWG NO. IRGS07-T | REV B 1-9-20 |
| APPROVED | | SCALE: | NTS | AUTOCAD | SHEET 2 of 16 |
| ENG. APPVL JPD | 11/15/07 | | | | |

NOTES:

- ANCHOR REQUIREMENTS:
SEE SHEET 4 FOR APPROVED ANCHORS AND INSTALLATION.
- HINGE REQUIREMENTS: 4.5" STD WT. MIN.
FOR DOOR OPENING UP TO 90" HIGH - MIN (3) HINGES
FOR DOOR OPENING OVER 90" - 96" HIGH - MIN (4) HINGES
STD LOCATIONS: 9.75" FROM RABBET IN HEAD TO CL OF TOP HINGE
10.38" FROM FLOOR TO CL OF BOTTOM HINGE, EQUALLY SPACED
IN BETWEEN. HINGE LOCATIONS MAY VARY, MAX SPACING DO NOT EXCEED 35.5" FOR 3 HINGES.
SEE SHEET 16 FOR APPROVED CONTINUOUS HINGE MODELS.
- SEE SHEETS 1, 2, 3 & 7 FOR AVAILABLE STANDARD OPENING SIZES AND SPECIFICATIONS.
- HARDWARE INSTALLATION AS PER MANUFACTURER'S INSTRUCTIONS.
- 4" FACE FRAME HEAD IS AVAILABLE. SEE SHEET 4.
- APPLY CAULK TO FULL LENGTH OF SILL AND ENTIRE PERIMETER OF FRAME. SEE SHEETS 5 & 6
- WEATHERSTRIPPING:
- WHEN WATER INFILTRATION IS REQUIRED INSTALL PER SHEET 5. (ZERO INTL 566 VS NGP 950)
- WHEN WATER INFILTRATION IS NOT REQUIRED - INSTALL PER SHEET 6. (ZERO INTL 566, 65 & 568 VS NGP 950)
- SEE SHEET 13 FOR HORIZONTAL CROSS-SECTIONS, SEE SHEET 14 FOR VERTICAL CROSS-SECTIONS.
- INSTALL REINFORCEMENT CHANNELS AROUND EACH LITE-CUTOUT.
- ELECTRICAL INSTALLATION AND FIRE RATINGS ARE UNDER SEPARATE APPROVAL AND MUST BE REVIEWED BY CORRESPONDING AUTHORITY.
- OPTIONAL POWER TRANSFERS, AND/OR "SIGNAL SWITCH" MAY BE USED AS ALLOWED BY CODE AND IT DOES NOT EFFECT THE MECHANICAL PROPERTIES OF EXIT DEVICE AND/OR INHIBIT EGRESS. TO BE REVIEWED BY BUILDING OFFICIAL.
- TYPICAL SILL INSTALLATION SHALL BE ANCHORED PER OVERHEAD AND SIDEVIEW VIEW TH DETAILS ON THIS SHEET.
- DAYLIGHT OPENING (DLO) IS THE SAME AS EXPOSED GLASS. SEE SHEETS 1, 2, 8 AND 9 FOR LIMITATIONS & GLAZING TYPES.
- WHEN USING CONTINUOUS HINGE THE MINIMUM DISTANCE FROM DOOR EDGE TO EXPOSED GLASS IS 6-1/4" AT STILES AND 7-1/2" AT MIDRAILS.

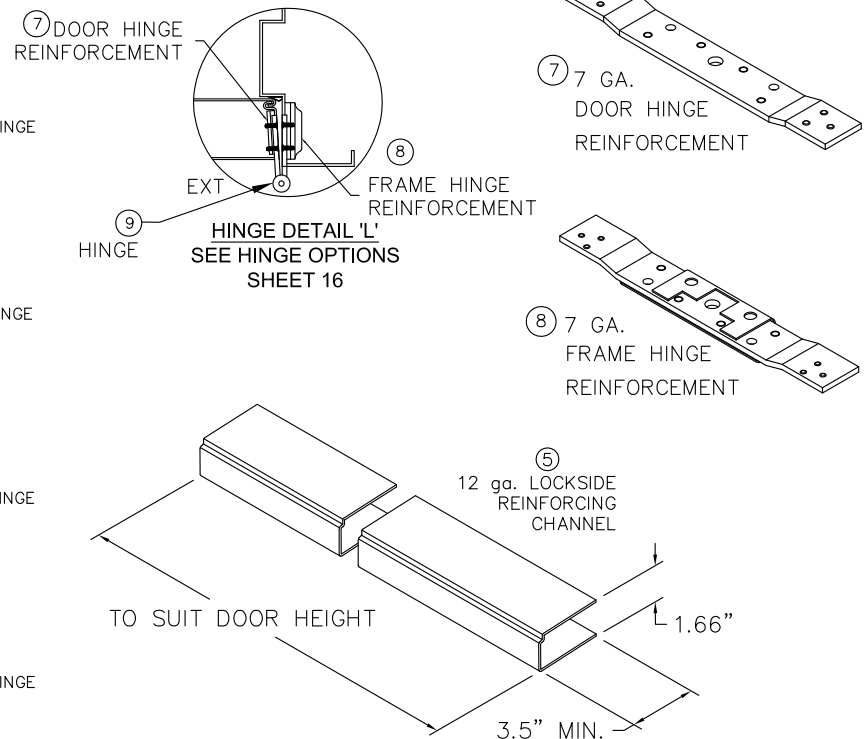
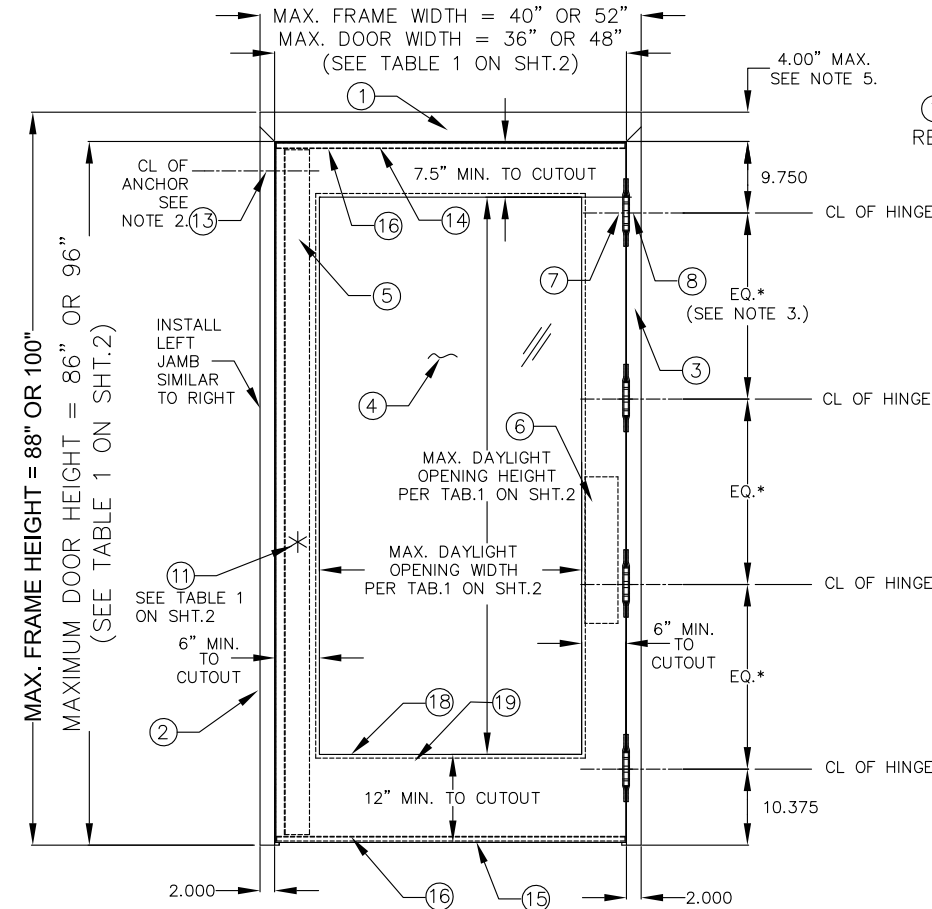
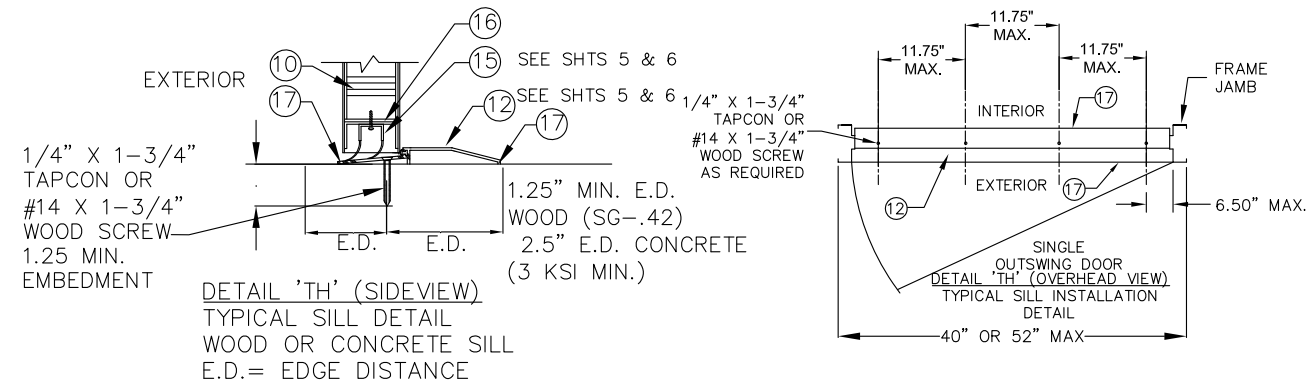
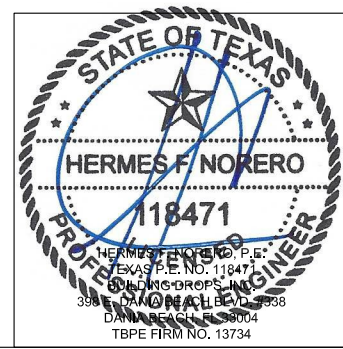

TABLE 2.

| ITEM | QUANTITY | DESCRIPTION | MATERIAL | SIZE, MAX. |
|--|---------------------|--|---|--|
| 1 | 1 | HEAD SEE SHT 7 ASTM A366 | .053" MIN. STL | MAX. 52" |
| 2 | 1 | STRIKE JAMB SEE SHT. 7 ASTM A366 | .053" MIN. STL | MAX. 100" |
| 3 | 1 | HINGE JAMB SEE SHT 7 ASTM A366 | .053" MIN. STL | MAX. 100" |
| 4 | 1 | LEXAN BY SABIC INNOVATIVE PLASTICS | .25" OR .50" | 35.406" X 75.656" MAX |
| | | LAMINATED GLASS WITH SENTRYGLAS INTERLAYER | .562" TYP. | |
| 5 | 1 | LOCK SIDE REINFORCEMENT CHANNEL | .093" MIN. STL | 3.5 X 93.44 MAX, |
| | | SUPERLITE II-XL BY SAFTI WITH SENTRYGLAS INTERLAYER | 1.06" TYP. | |
| 6 | 1 | HINGE SIDE PANIC REINFORCEMENT | .067" MIN. STL | MAX. 20" |
| 7 | NOTE 2. | HINGE REINFORCEMENT DOOR ASTM A621 | .167" MIN. STL. | 1.23" X 9.19" MIN. |
| 8 | NOTE 2. | HINGE REINFORCEMENT FRAME ASTM A621 | .167" MIN. STL. | 1.5" X 9.19" MIN. |
| 9 | NOTE 2. | 4.5" X 4.5" BUTT HINGES (SEE SHT 16) | .134 MIN. | (8) #12-24 MS PER HINGE |
| 10 | 1 | OPTIONAL CONTINUOUS HINGE (SEE SHT 16) | .075" MIN. STL/.12 ALUM | MAX. 95" |
| | | CORE MATERIAL (SHEET 15): | D) HONEYCOMB C) STEEL STIFFENED A & F) POLYSTYRENE B & F) POLYURETHANE/POLYISOCYANURATE E) MINERAL BOARD TEMPERATURE RISE CORE | |
| 11 | 1 | LOCKING HARDWARE - SEE SHEET 2 TABLE 1. | | |
| 12 | 1 | THRESHOLD SILL W/BUMPER GASKET | | |
| | | 12A) 566 ZERO SEE SHT. 5 WATER RATED & 6 NON-WATER | .125" ALUM. 6063 T5 | 5.0"X0.5"X48"MAX. |
| | | 12B) 950 NGP SEE SHT. 5 WATER RATED & 6 NON-WATER | .078" ALUM. 6063 T5 | |
| | | 12C) 65 ZERO SEE SHT. 6 NON WATER RATED | .125" ALUM. 6063 T5 | |
| | | 12D) 568 ZERO SEE SHT. 6 NON WATER RATED | .125" ALUM. 6063 T5 | |
| 12E) 568 ZERO SEE SHT. 6 NON WATER RATED | .125" ALUM. 6063 T5 | | | |
| 13 | NOTE 1. | JAMB ANCHOR ASTM A924 | SEE SHEET 4 | |
| 14 | SEE SHEET 6 | 14A)PSO74 DOOR SEAL STEELCRAFT 14B)188S 14C)117S 14D)8144S 14E)8150S DOOR SEAL ZERO | TPE SILICONE | MAX. 20' |
| 15 | 1 | FAS-SEAL DOOR SWEEP SEE SHEETS 5 & 6 | TPE | MAX. 48" |
| 16 | 2 | END CHANNEL ASTM A924 (14 GA - INVERTED) | .067" MIN. STL | .69" X 1.66" X 48" MAX. |
| 17 | AS NEEDED | CAULK - BUTYL RUBBER OR SILICONE | SEE SHEETS 5 & 6 | |
| 18 | AS NEEDED | GLAZING HOLDING DOOR TRIM | | 34.25" X 74.5" EXPOSED GLASS MAX. |
| | | 1) DEZIGNER TRIM | | |
| | | 2) STEEL OVERLAPPING TRIM | .032" MIN. STL | |
| | | 3) STEEL OVERLAPPING TRIM | | |
| 19 | NOTE 9. | CUTOUT REINFORCEMENT CHANNEL (18 GA) | .047" MIN. STL | 0.5"X1.56"X35.5"X 75.5" MAX. |
| | | DOOR SLAB (16 OR 14 GA) | SEE SHEET 7 | 4' X 8' MAX. |
| 21 | 1 | 21A) 188S DOOR SEAL BY ZERO INT'L | SILICONE SEE SHEET 5 | MAX. 20' |
| | | 21B) PSO74 DOOR SEAL BY STEELCRAFT | TPE SEE SHEET 5 | |
| 22 | 2 | 202N DOOR SEAL BY NGP | TPE SEE SHEET 5 | MAX. 84" OR 96" |
| 23 | 1 | 23A) 139 DOOR SWEEP BY ZERO INT'L | SEE SHEET 5 | MAX. 36" OR 48" |
| | | 23B) 328 DOOR SWEEP BY ZERO INT'L | | |
| | | 23C) 200N DOOR SWEEP BY ZERO INT'L | | |
| 24 | 3 | 24A) 475 ADJUSTABLE SEAL BY ZERO INT'L | TPE SEE SHEET 5 | MAX. 84" OR 96" FOR JAMB MAX. 36" OR 48" FOR HEAD |
| | | 24B) 170N ADJUSTABLE SEAL BY NGP | | |
| 25 | 1 | 25A) 142 RAIN DRIP BY ZERO INT'L | SEE SHEET 5 | MAX. 40" OR 52" FOR HEAD MAX. 36" OR 48" FOR DOOR |
| | | 25B) 11 RAIN DRIP BY ZERO INT'L | | |
| | | 25C) 16A RAIN DRIP BY NGP | | |
| 26 | 1 | TOP CAP GALV. A60 ASTM A924 | .020" MIN. STL | 0.5" X 1.76" X 36" OR 48" |

| | | | |
|------------------------|--|--|------------------|
| BEND RADIUS | SCHLAGE LOCK COMPANY, LLC 11819 N. PENNSYLVANIA STREET CARMEL, IN 46032 | | |
| THIRD ANGLE PROJECTION | TITLE: STEELCRAFT H SERIES SINGLE OUTSWING GLAZED COMMERCIAL STEEL DOORS WITH AND WITHOUT PANIC EXIT DEVICES | | |
| DRAWN YMF | DATE 05/20/07 | H-SERIES SINGLE GLASS DOORS (OUTSWING) | |
| CHECKED | | | |
| APPROVED | SIZE FLAT | DWG NO. IRGS07-T | REV B 1-9-20 |
| ENG. APPVL JPD | 11/15/07 | SCALE: NTS AUTOCAD | SHEET 3 of 16 |



A WIRE OR T MASONRY ANCHOR INTO GROUT FILLED FRAME AND BLOCK WALL

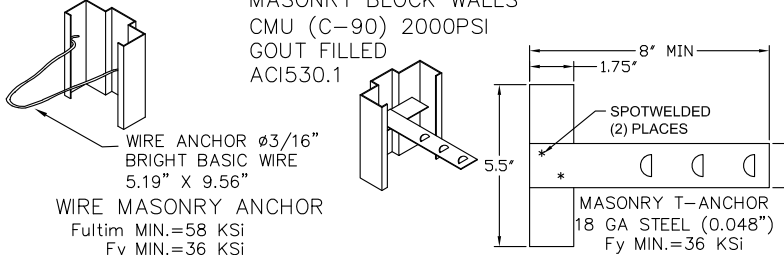
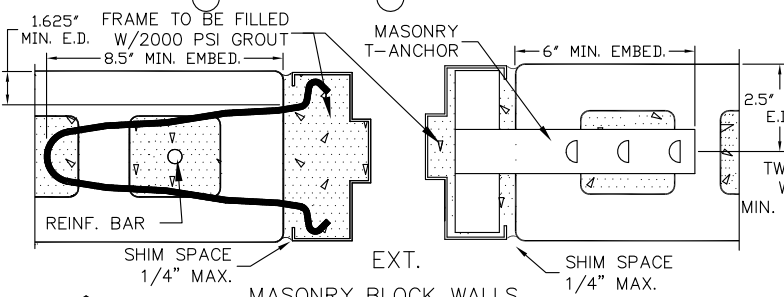
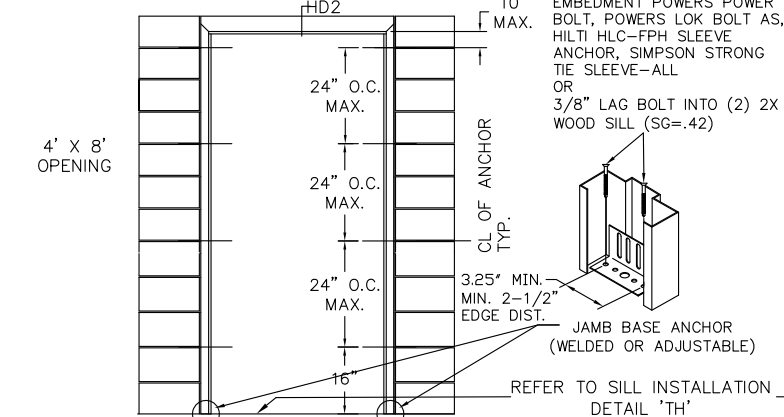

JAMB BASE ANCHOR INTO CONCRETE (3 KSI MIN.): #0.375\"/>

B WOOD STUD ANCHOR

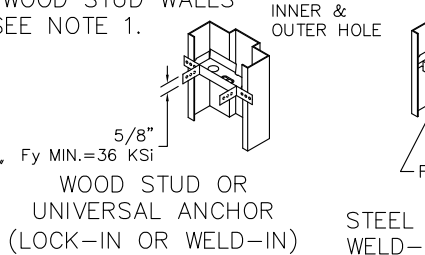
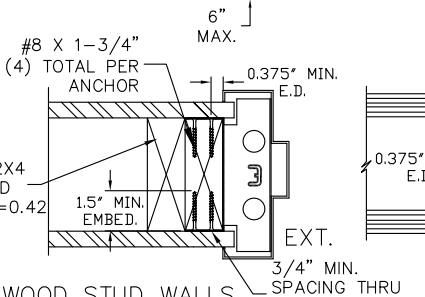
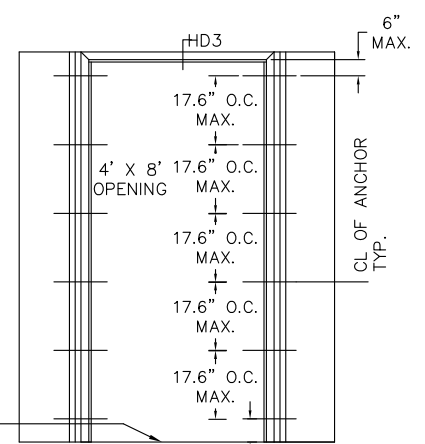

C STEEL STUD ANCHOR

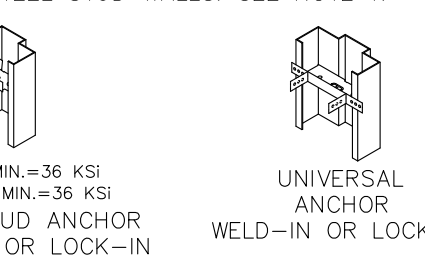
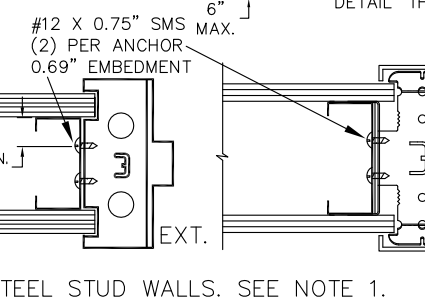
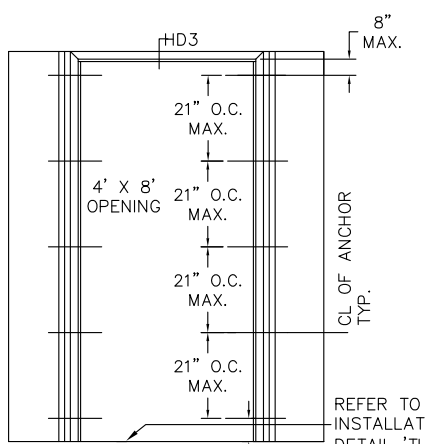

D EXISTING MASONRY ANCHOR (EMA) INTO CONCRETE WALL OR CMU

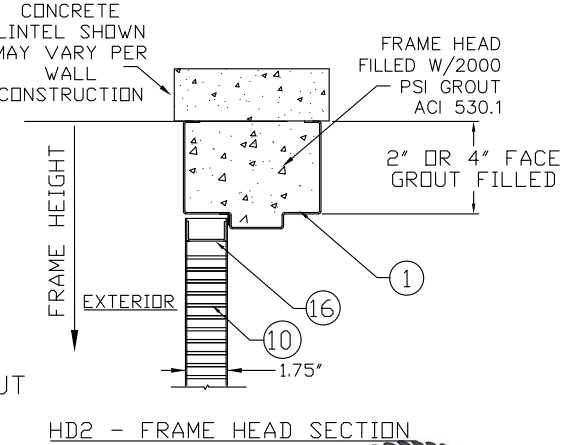
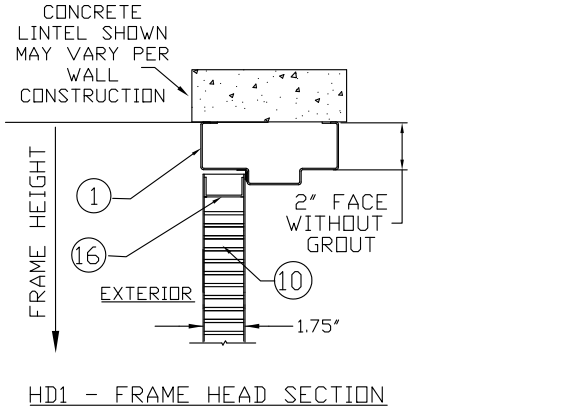
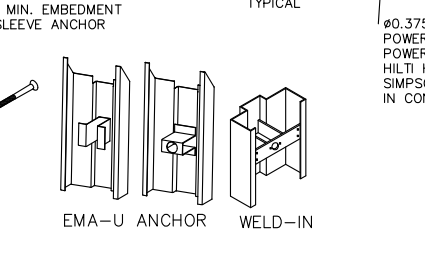
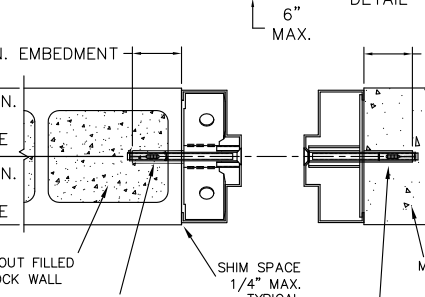
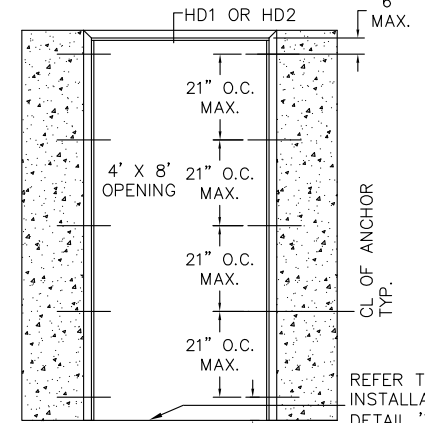

E EXISTING MASONRY ANCHOR (EMA) WITH LAG BOLT INTO WOOD STUD WALL

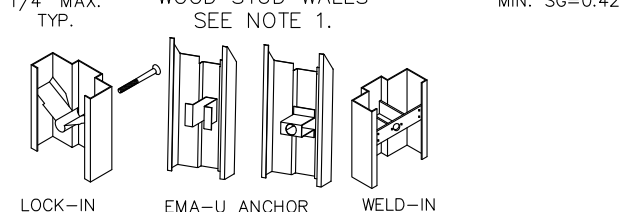
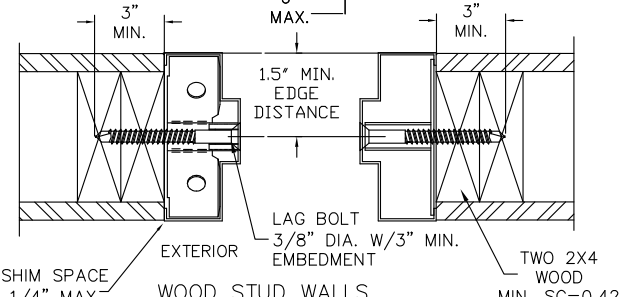
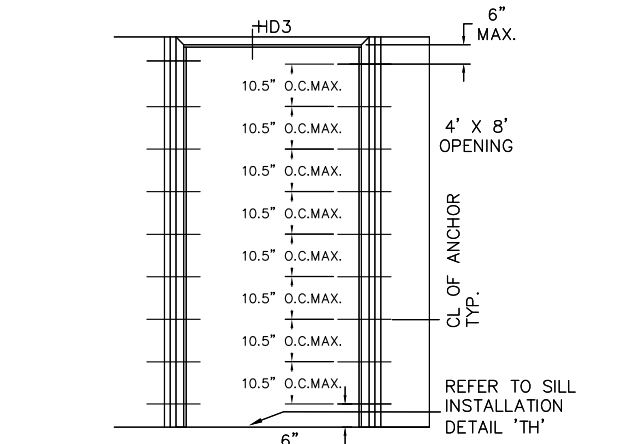

F POURED CONCRETE TILT UP WALL

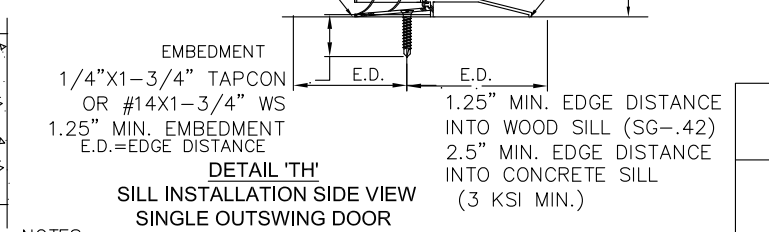
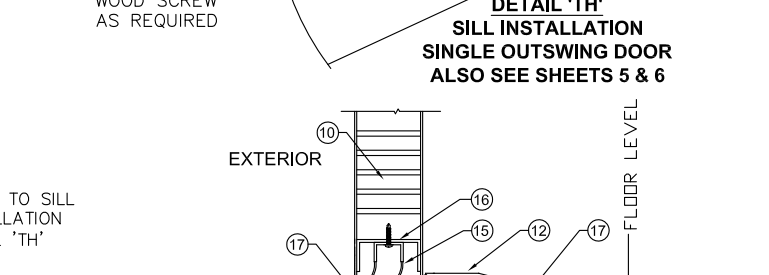
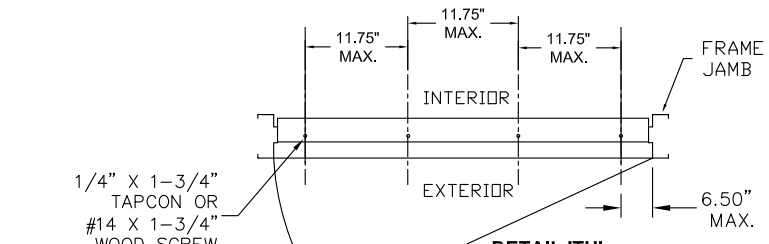
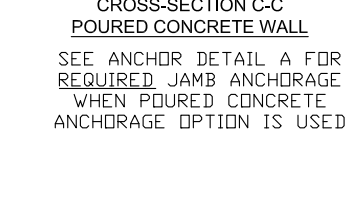
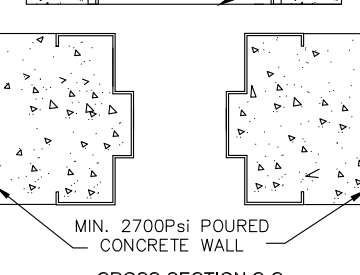
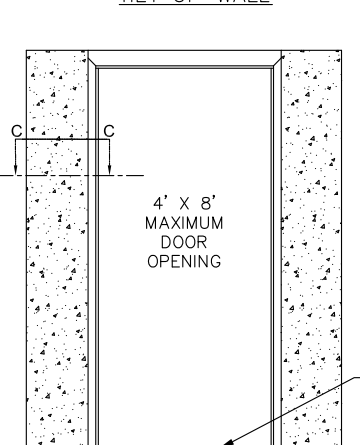

NOTES:
 1.(*)WOOD OR (*)STEEL STRUCTURAL MEMBERS OF WOOD AND STEEL-STUD WALLS MUST BE DESIGNED TO CARRY AT LEAST 312 #/FT. LOAD FOR ASSEMBLIES RATED @75 PSF, AND 416#/FT. FOR ASSEMBLIES RATED @100 PSF, WHICH SHOULD BE VERIFIED BY THE APPROPRIATE OFFICIAL.
 2.NUMBER OF ANCHORS FOR VARIOUS OPENING HEIGHTS IS LIMITED BY MAXIMUM DISTANCE BETWEEN ANCHORS, SHOWN ON THIS SHEET.
 3.SEAL ALL JOINTS WHERE FRAME MEETS WALL WITH BUTYL RUBBER OR SILICONE CAULK
 4.INSTALL THRESHOLD INTO BEAD OF BUTYL RUBBER OR SILICONE CAULK FULL LENGTH OF SILL

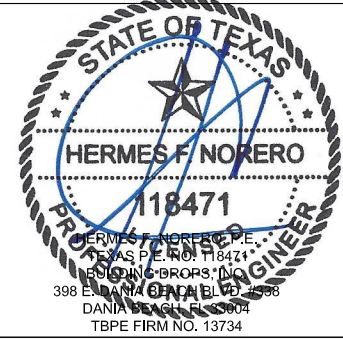
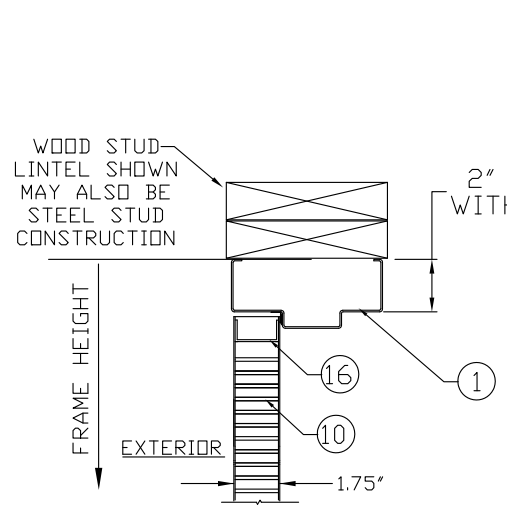

| | | | |
|------------------------|----------|--|------------------|
| BEND RADIUS | | SCHLAGE LOCK COMPANY, LLC 11819 N. PENNSYLVANIA STREET CARMEL, IN 46032 | |
| THIRD ANGLE PROJECTION | DATE | TITLE: STEELCRAFT H SERIES SINGLE OUTSWING GLAZED COMMERCIAL STEEL DOORS WITH AND WITHOUT PANIC EXIT DEVICES | |
| DRAWN YMF | 05/20/07 | FRAME ANCHOR DETAILS & INSTALLATION CONDITIONS. | |
| CHECKED | | SIZE | REV |
| APPROVED | | FLAT | B 1-9-20 |
| ENG. APPVL JPD | 10/11/07 | DWG NO. IRGS07-T | SHEET 4 of 16 |
| SCALE: NTS | | AUTOCAD | |

TABLE 3.1 WATER RATED PERIMETER SEAL HARDWARE - ZERO INT'L THRESHOLD 566

| ITEM NUMBER | MODEL No./ DESCRIPTION | MFG. |
|-------------|------------------------|------------|
| 12A | 566 THRESHOLD | ZERO INT'L |
| 15 | FAS-SEAL SWEEP | STEELCRAFT |
| 16 | END CHANNEL | STEELCRAFT |
| 21A | 188S DOOR SEAL | ZERO INT'L |
| 23A | 139 DOOR SWEEP | ZERO INT'L |
| 23B | 328 DOOR SWEEP | ZERO INT'L |
| 24A | 475 ADJUSTABLE SEAL | ZERO INT'L |
| 25A | 142 RAIN DRIP | ZERO INT'L |
| 25B | 11 RAIN DRIP | ZERO INT'L |
| 26 | DOOR TOP CAP | STEELCRAFT |

ZERO INT'L 566 THRESHOLD GASKETING SYSTEM REQUIREMENTS FOR WATER INFILTRATION - MAXIMUM DESIGN PRESSURE RATING 75PSF - MAXIMUM DOOR SIZE 4'-0" X 8'-0" (SEE ELEVATIONS, SHEET 1)

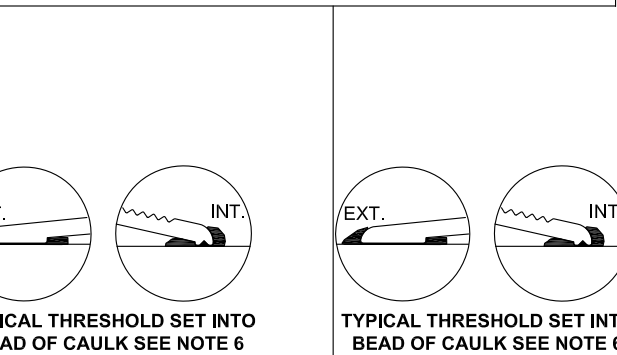
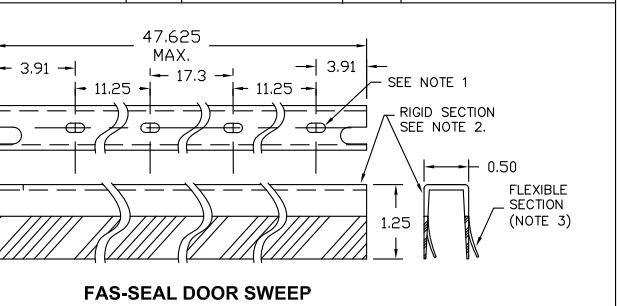
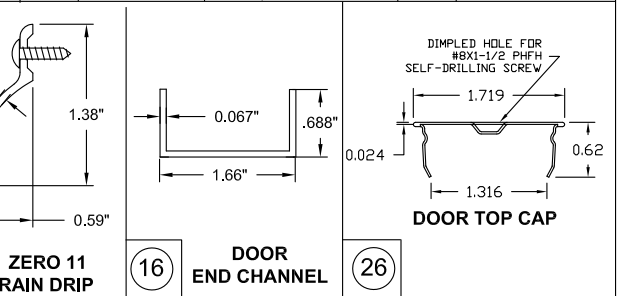
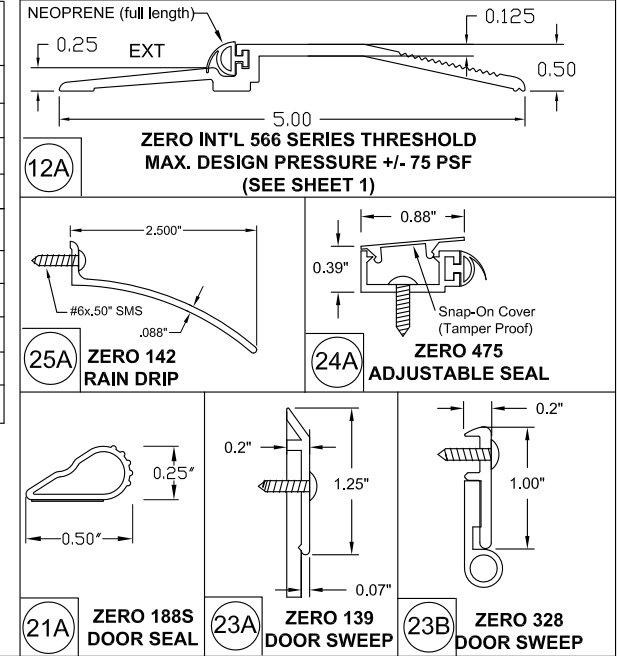
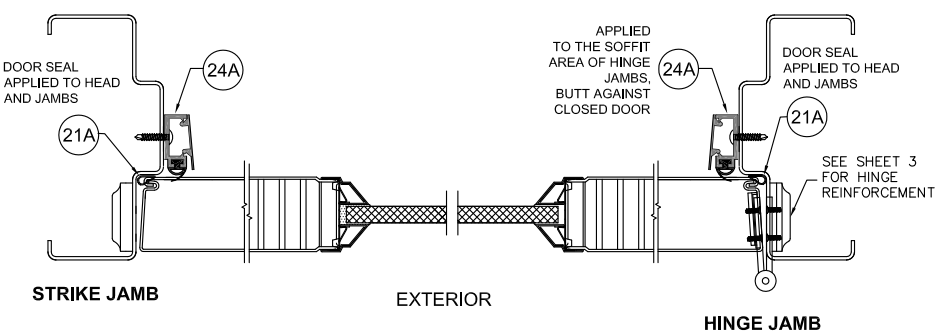
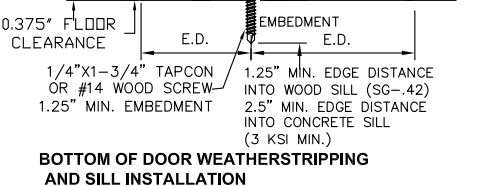
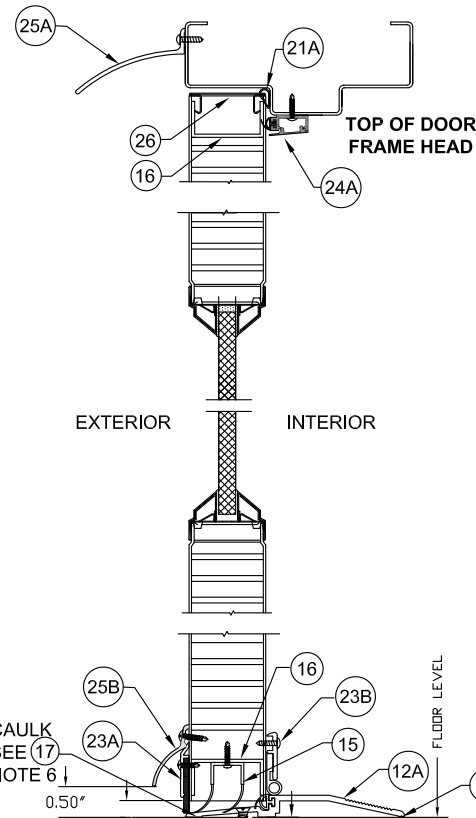
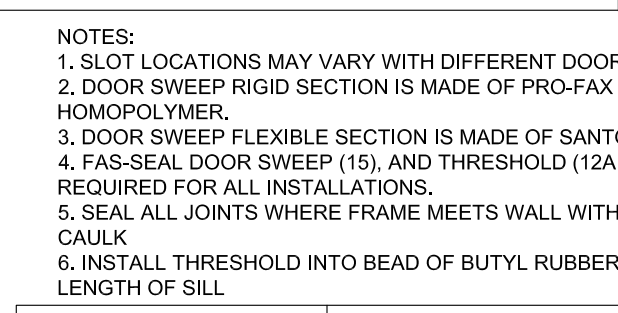
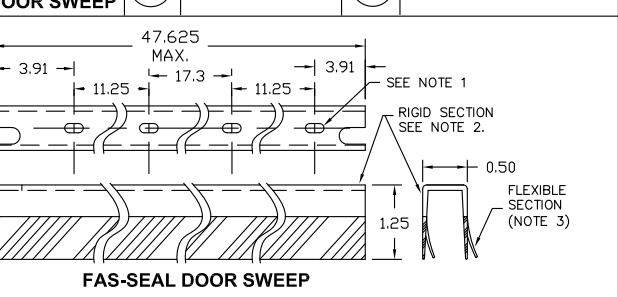
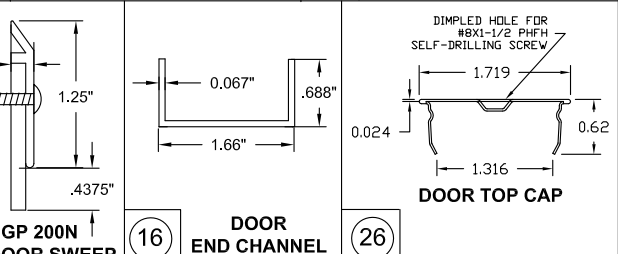
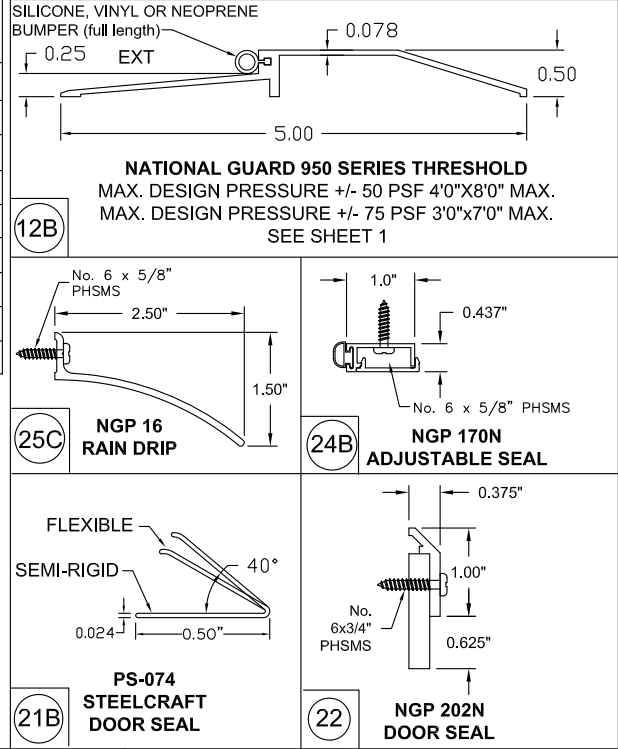
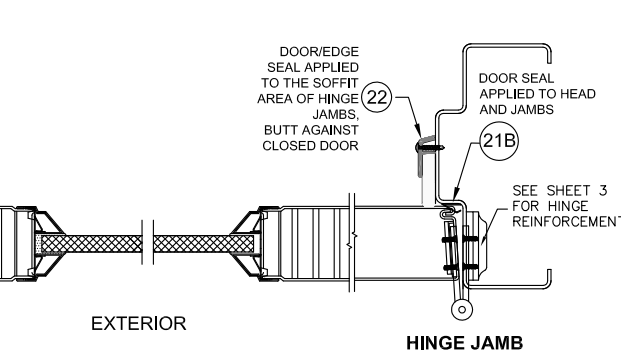
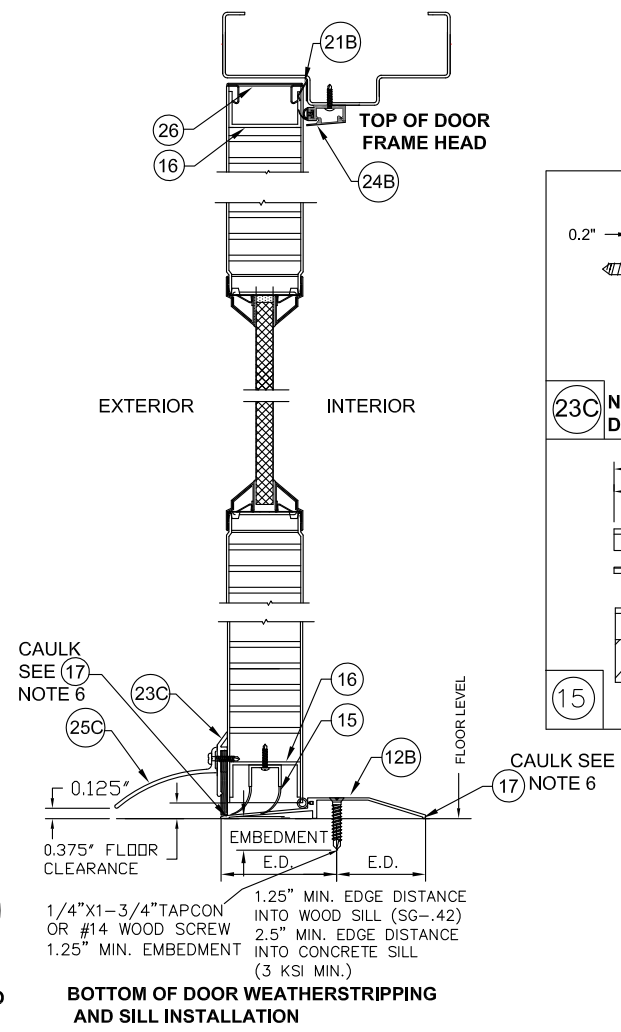

TABLE 3.2 WATER RATED PERIMETER SEAL HARDWARE - NGP THRESHOLD 950

| ITEM NUMBER | MODEL No./ DESCRIPTION | MFG. |
|-------------|------------------------|------------|
| 12B | 950 THRESHOLD | NGP |
| 15 | FAS-SEAL SWEEP | STEELCRAFT |
| 16 | END CHANNEL | STEELCRAFT |
| 21B | PS074 DOOR SEAL | STEELCRAFT |
| 22 | 202N DOOR SEAL | NGP |
| 23C | 200N DOOR SWEEP | NGP |
| 24B | 170N ADJUSTABLE SEAL | NGP |
| 25C | 16A RAIN DRIP | NGP |
| 26 | DOOR TOP CAP | STEELCRAFT |

NGP 950 THRESHOLD GASKETING SYSTEM REQUIREMENTS FOR WATER INFILTRATION - MAXIMUM DESIGN PRESSURE RATING 75PSF FOR MAXIMUM DOOR SIZE OF 3'-0" X 7'-0" MAXIMUM DESIGN PRESSURE 50 PSF FOR MAXIMUM DOOR SIZE OF 4'-0" X 8'-0" (SEE ELEVATIONS, SHEET 1)



- NOTES:**
1. SLOT LOCATIONS MAY VARY WITH DIFFERENT DOOR WIDTH.
 2. DOOR SWEEP RIGID SECTION IS MADE OF PRO-FAX #PD-199 POLYPROPYLENE HOMOPOLYMER.
 3. DOOR SWEEP FLEXIBLE SECTION IS MADE OF SANTOPRENE #101-73
 4. FAS-SEAL DOOR SWEEP (15), AND THRESHOLD (12A OR 12B AS REQUIRED) ARE REQUIRED FOR ALL INSTALLATIONS.
 5. SEAL ALL JOINTS WHERE FRAME MEETS WALL WITH BUTYL RUBBER OR SILICONE CAULK
 6. INSTALL THRESHOLD INTO BEAD OF BUTYL RUBBER OR SILICONE CAULK FULL LENGTH OF SILL

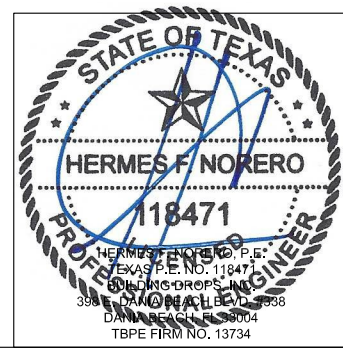

| | | | |
|------------------------|----------|--|----------|
| BEND RADIUS | | SCHLAGE LOCK COMPANY, LLC 11819 N. PENNSYLVANIA STREET CARMEL, IN 46032 | |
| THIRD ANGLE PROJECTION | DATE | TITLE: STEELCRAFT H SERIES SINGLE OUTSWING GLAZED COMMERCIAL STEEL DOORS WITH AND WITHOUT PANIC EXIT DEVICES | |
| DRAWN YMF | 05/20/07 | SINGLE GLAZED DOOR PERIMETER SEAL HARDWARE APPROVED WHERE WATER INFILTRATION IS REQUIRED | |
| CHECKED | | SIZE | REV |
| APPROVED | | FLAT | B 1-9-20 |
| ENG. APPVL JPD | 10/11/07 | DWG NO. IRGS07-T | SHEET |
| | | SCALE: NTS | 5 of 16 |
| | | AUTOCAD | |

TABLE 4.1 NON WATER RATED PERIMETER SEAL HARDWARE - ZERO INT'L THRESHOLDS

| ITEM NUMBER | MODEL No./ DESCRIPTION | MFG. |
|---------------------|------------------------|------------|
| 12 | 12A 566 THRESHOLD | ZERO INT'L |
| | 12C 65 THRESHOLD | ZERO INT'L |
| | 12D 568 THRESHOLD | ZERO INT'L |
| 14 | 14A PS074 DOOR SEAL | STEELCRAFT |
| | 14B 188S DOOR SEAL | ZERO INT'L |
| | 14C 117S DOOR SEAL | ZERO INT'L |
| | 14D 8144S DOOR SEAL | ZERO INT'L |
| 14E 8150S DOOR SEAL | ZERO INT'L | |
| 15 | FAS-SEAL SWEEP | STEELCRAFT |
| 16 | END CHANNEL | STEELCRAFT |

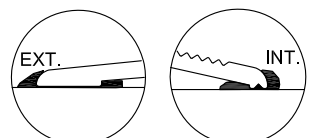
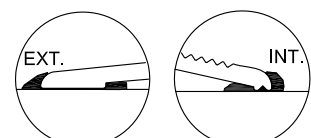
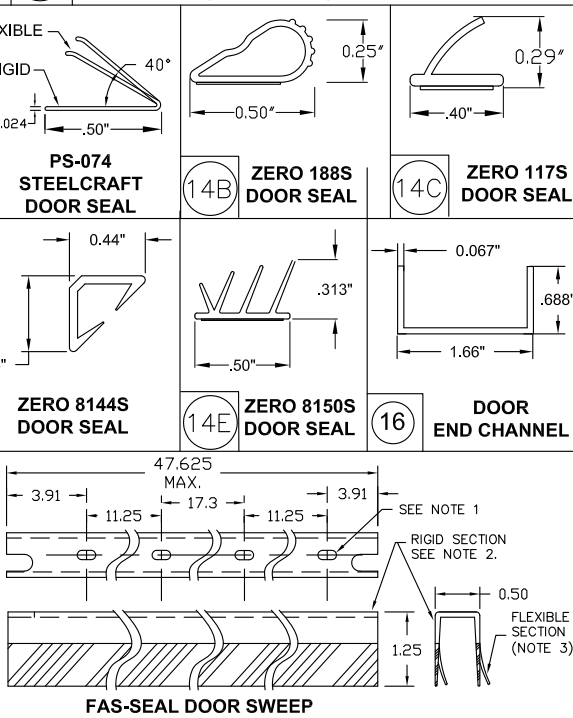
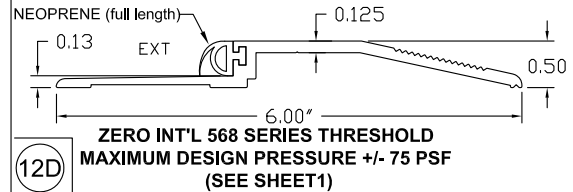
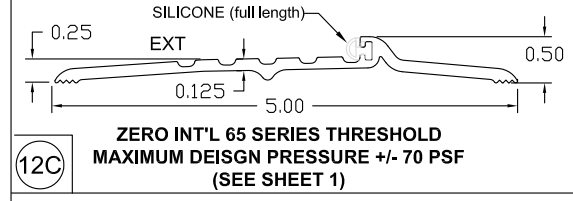
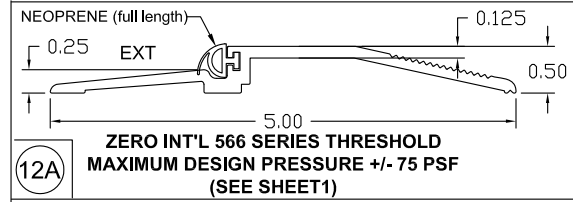

ZERO INT'L 566, 65 AND 568 THRESHOLD GASKETING SYSTEM REQUIREMENTS WHEN WATER INFILTRATION IS NOT REQUIRED
MAXIMUM DESIGN PRESSURE RATING 75 PSF -
MAXIMUM DOOR SIZE 4'-0" X 8'-0"
(SEE ELEVATIONS, SHEET 1)

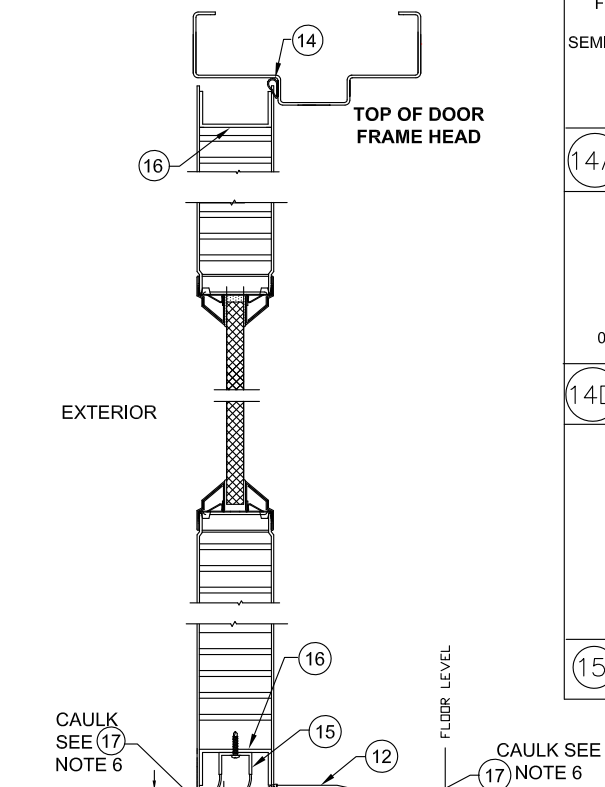

BOTTOM OF DOOR WEATHERSTRIPPING AND SILL INSTALLATION
 0.375" FLOOR CLEARANCE
 1.25" MIN. E.D.
 1.25" MIN. EMBEDMENT INTO CONCRETE SILL (3 KSI MIN.)
 1/4"x1-3/4" TAPCON OR #14 WOOD SCREW INTO WOOD SILL (SG-.42)
 2.5" MIN. EDGE DISTANCE INTO CONCRETE SILL (3 KSI MIN.)
 CAULK SEE NOTE 6
 FLOOR LEVEL

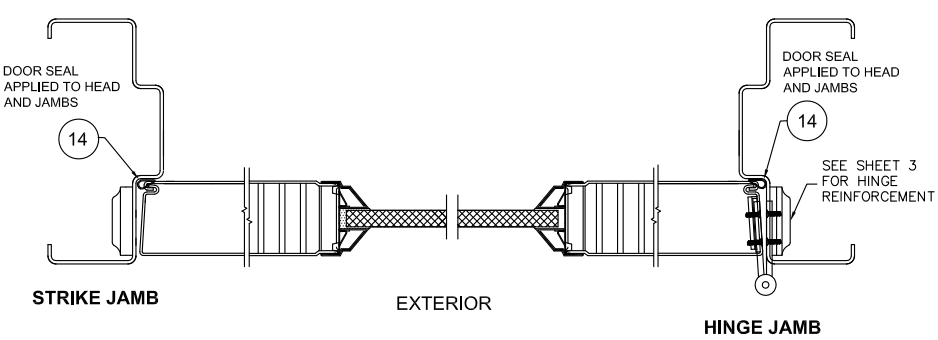
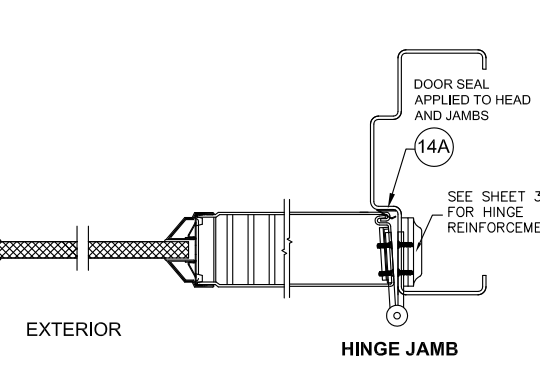
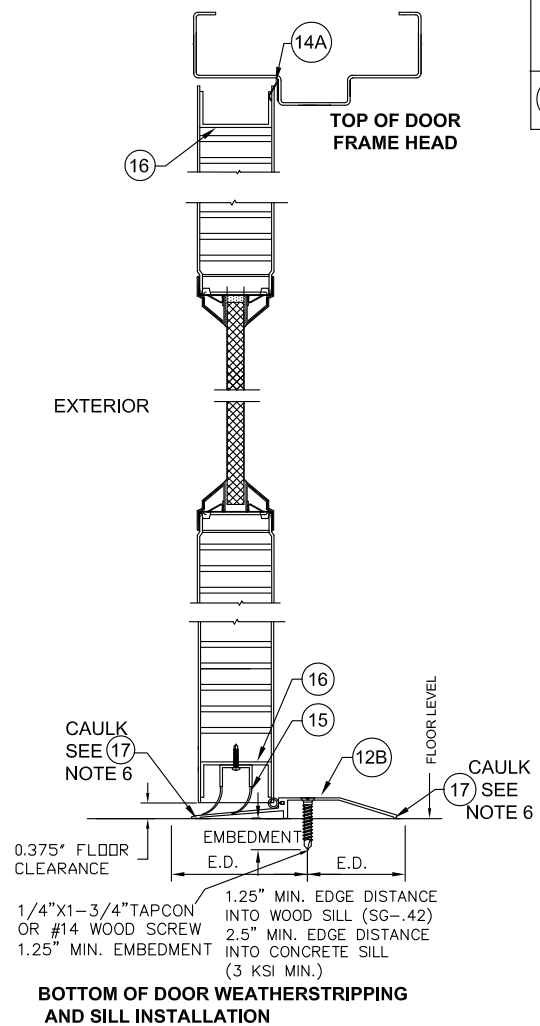
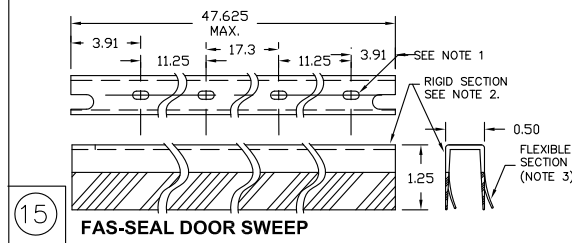
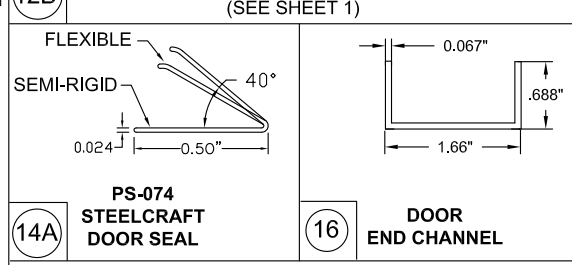
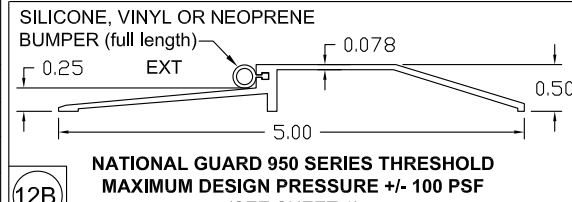

TABLE 4.2 NON WATER RATED PERIMETER SEAL HARDWARE - NGP THRESHOLD 950

| ITEM NUMBER | MODEL No./ DESCRIPTION | MFG. |
|-------------|------------------------|------------|
| 12B | 950 THRESHOLD | NGP |
| 14A | PS074 DOOR SEAL | STEELCRAFT |
| 15 | FAS-SEAL SWEEP | STEELCRAFT |
| 16 | END CHANNEL | STEELCRAFT |

NGP 950 THRESHOLD GASKETING SYSTEM REQUIREMENTS WHEN WATER INFILTRATION IS NOT REQUIRED -
MAXIMUM DESIGN PRESSURE 100 PSF FOR
MAXIMUM DOOR SIZE OF 4'-0" X 8'-0"
(SEE ELEVATIONS, SHEET 1)



- NOTES:**
1. SLOT LOCATIONS MAY VARY WITH DIFFERENT DOOR WIDTH.
 2. DOOR SWEEP RIGID SECTION IS MADE OF PRO-FAX #PD-199 POLYPROPYLENE HOMOPOLYMER.
 3. DOOR SWEEP FLEXIBLE SECTION IS MADE OF SANTOPRENE #101-73
 4. FAS-SEAL DOOR SWEEP (15), DOOR SEAL (14A, 14B, 14C, 14D, 14E) AND THRESHOLD (12A, 12B, 12C, 12D) AS APPLICABLE, ARE REQUIRED FOR ALL INSTALLATIONS.
 5. SEAL ALL JOINTS WHERE FRAME MEETS WALL WITH BUTYL RUBBER OR SILICONE CAULK
 6. INSTALL THRESHOLD INTO BEAD OF BUTYL RUBBER OR SILICONE CAULK FULL LENGTH OF SILL

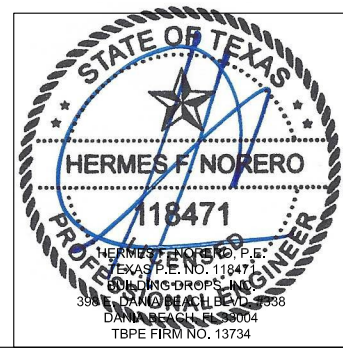

| | | | |
|------------------------|----------|--|------------------|
| BEND RADIUS | | SCHLAGE LOCK COMPANY, LLC 11819 N. PENNSYLVANIA STREET CARMEL, IN 46032 | |
| THIRD ANGLE PROJECTION | DATE | TITLE: STEELCRAFT H SERIES SINGLE OUTSWING GLAZED COMMERCIAL STEEL DOORS WITH AND WITHOUT PANIC EXIT DEVICES | |
| DRAWN YMF | 05/20/07 | SINGLE GLAZED DOOR PERIMETER SEAL HARDWARE APPROVED WHERE WATER INFILTRATION IS NOT REQUIRED | |
| CHECKED | | SIZE | REV |
| APPROVED | | FLAT | B 1-9-20 |
| ENG. APPVL JPD | 10/11/07 | DWG NO. IRGS07-T | SHEET 6 of 16 |
| | | SCALE: NTS | AUTOCAD |

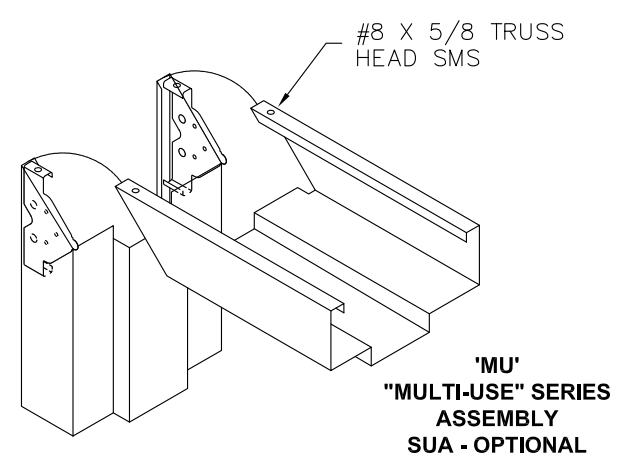
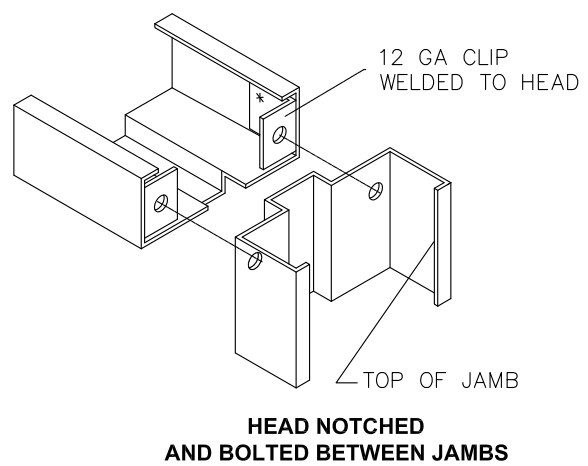
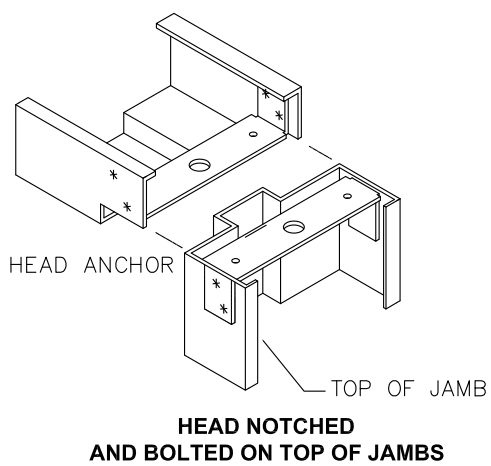
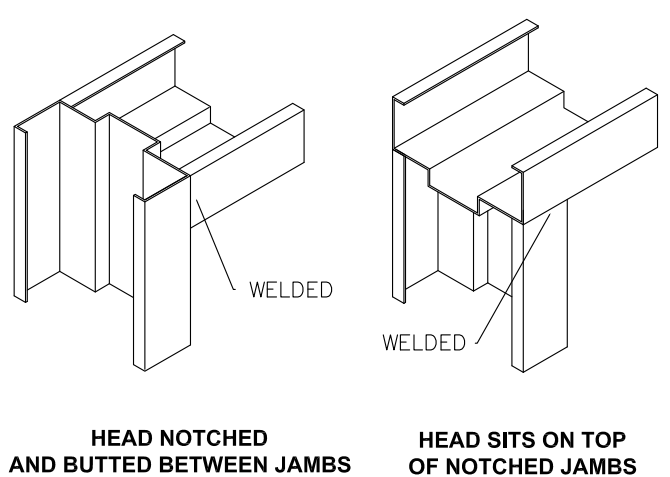
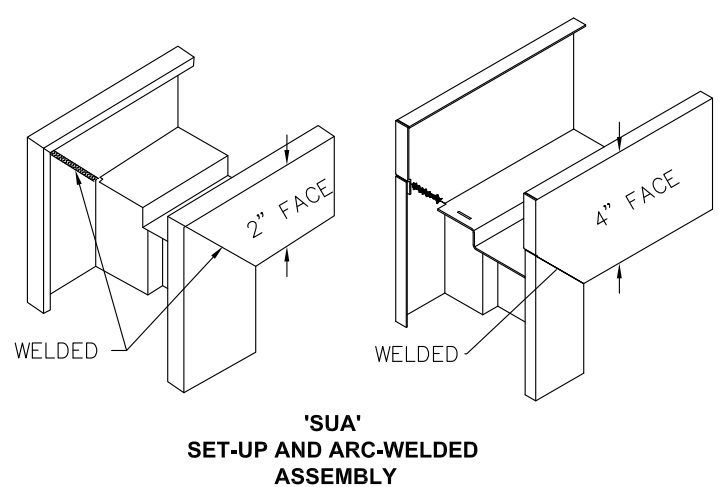
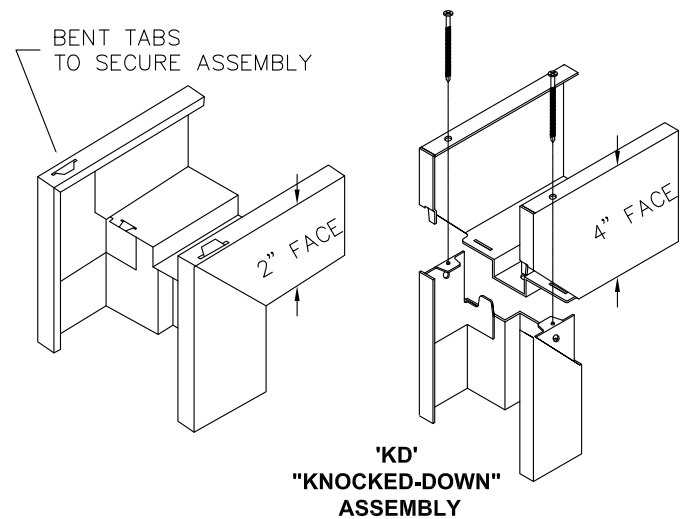

TABLE 5. AVAILABLE STEELCRAFT DOOR CONFIGURATIONS

| CORE MATERIAL PER SHT.15 | MAXIMUM OPENING SIZE | | SKIN MATERIAL | |
|--|--------------------------|--------|-----------------|----------------------|
| | WIDTH | HEIGHT | DESCR. | GA./MIN. THK |
| HONEYCOMB POLYSTYRENE POLYURETHANE (POLYISOCYANURATE) TEMPERATURE RISE STEEL STIFFENED | VARIES SEE SHT 2 TABLE 1 | | CRS GALV | 16/.053" 14/.067" |
| HONEYCOMB POLYSTYRENE POLYURETHANE | VARIES SEE SHT 2 TABLE 1 | | STAINLESS STEEL | 16/.053" |

TABLE 6. AVAILABLE STEELCRAFT FRAME CONFIGURATIONS

| FRAME SERIES | JAMB DEPTH | MAXIMUM OPENING SIZE | | MATERIAL | |
|--------------|------------|--------------------------|--------|-----------------|----------------------------------|
| | | WIDTH | HEIGHT | DESCR. | GA./MIN. THK |
| F | 5.75" MIN. | VARIES SEE SHT 2 TABLE 1 | | CRS/HRS GALV | 16/.053" 14/.067" 12/.099" |
| | | | | STAINLESS STEEL | 16/.053" |
| MU | 5.75" MIN. | VARIES SEE SHT 2 TABLE 1 | | CRS/HRS GALV | 16/.053" 14/.067" |

TYPICAL FRAME PROFILE DOUBLE RABBET

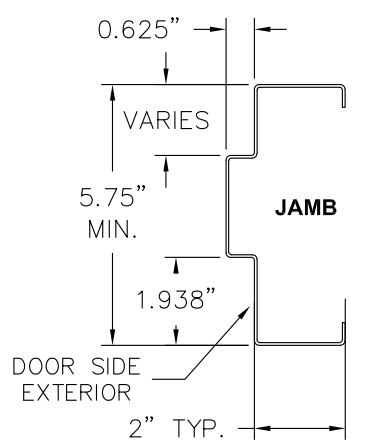
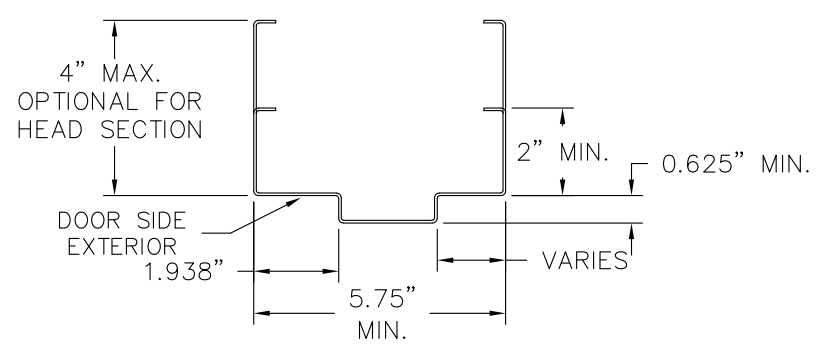

TYPICAL FRAME PROFILE DOUBLE RABBET

NOTES:

- DOOR CONSTRUCTION
 - MINIMUM DOOR THICKNESS - 1 3/4"
 - DOOR SIZE MAY VARY, SUBJECTED TO COMPLIANCE WITH FLORIDA BUILDING CODE AND PRODUCT AVAILABILITY FROM MANUFACTURER (SEE SHEET 2 FOR AVAILABLE HARDWARE)
- FRAME CONSTRUCTION
 - MINIMUM JAMB DEPTH - 5 3/4", STOP HEIGHT - 5/8"
 - FRAMES AVAILABLE AS FLUSH (F-SERIES) AND MULT-USE (MU-SERIES) (SEE TABLE 6)
- FOR DOOR AND FRAME MATERIAL SPECIFICATIONS REFERENCE SEE TABLE 7.

TABLE 7. STEEL MECHANICAL PROPERTIES

| MATERIAL | ASTM REF. | YIELD KSI | TENSILE KSI |
|-------------|-----------|-----------|-------------|
| CRS | A366 | MIN. 41.5 | MIN. 52.4 |
| HRS | A1011 | | |
| GALV: A60 | A924 | MIN. 41.5 | MIN. 73.2 |
| SS: 304,316 | A240 | | |

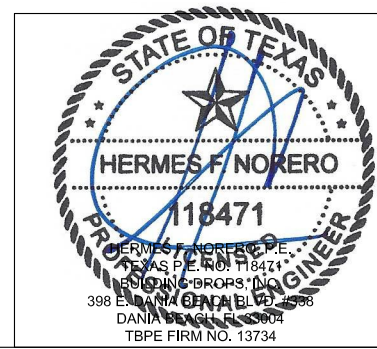

| | | | | | |
|------------------------|------------------|--|------|---------------------|-----------------|
| BEND RADIUS | | SCHLAGE LOCK COMPANY, LLC 11819 N. PENNSYLVANIA STREET CARMEL, IN 46032 | | | |
| THIRD ANGLE PROJECTION | | TITLE: STEELCRAFT H SERIES SINGLE OUTSWING GLAZED COMMERCIAL STEEL DOORS WITH AND WITHOUT PANIC EXIT DEVICES | | | |
| DRAWN YMF | DATE 05/20/07 | FRAME PROFILE, CORNER DETAILS AND DOOR FRAME MATERIAL, AND SIZE OPTIONS. | | | |
| CHECKED | | SIZE | FLAT | DWG NO. IRGS07-T | REV B 1-9-20 |
| APPROVED | | SCALE: NTS AUTOCAD | | SHEET 7 of 16 | |
| ENG. APPVL JPD | 11/15/07 | | | | |

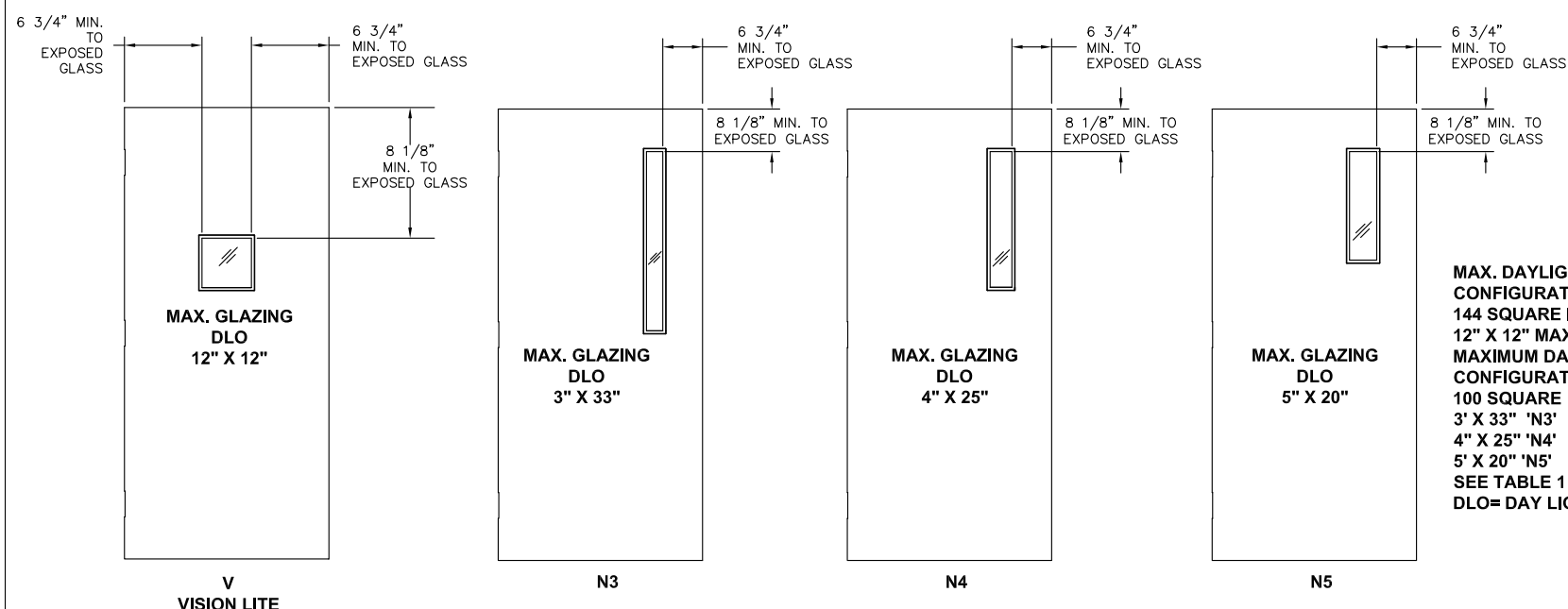
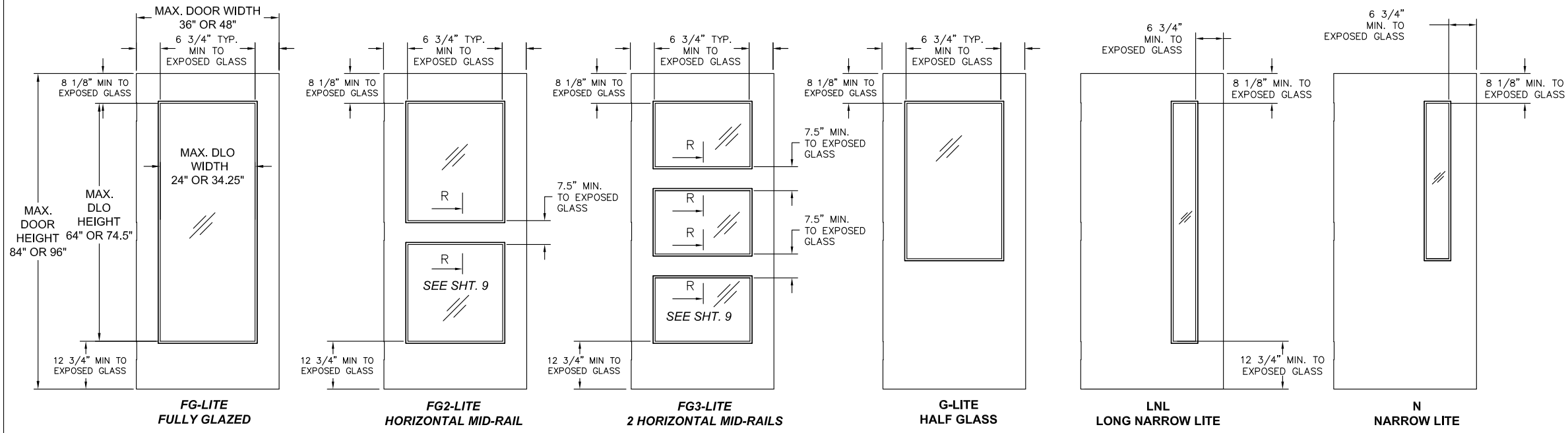

MAX. DAYLIGHT OPENING FOR CONFIGURATION 9 AND 10 IS 144 SQUARE INCHES
12\"/>

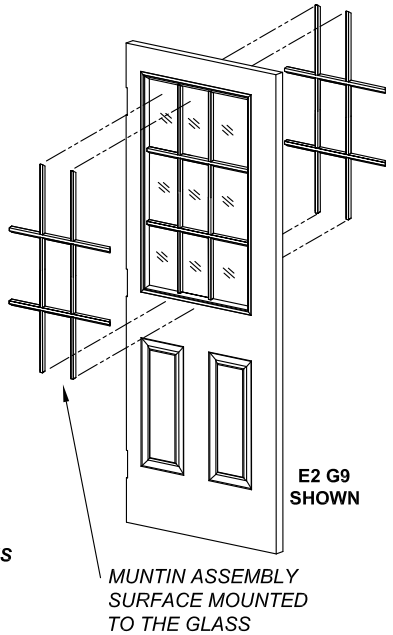
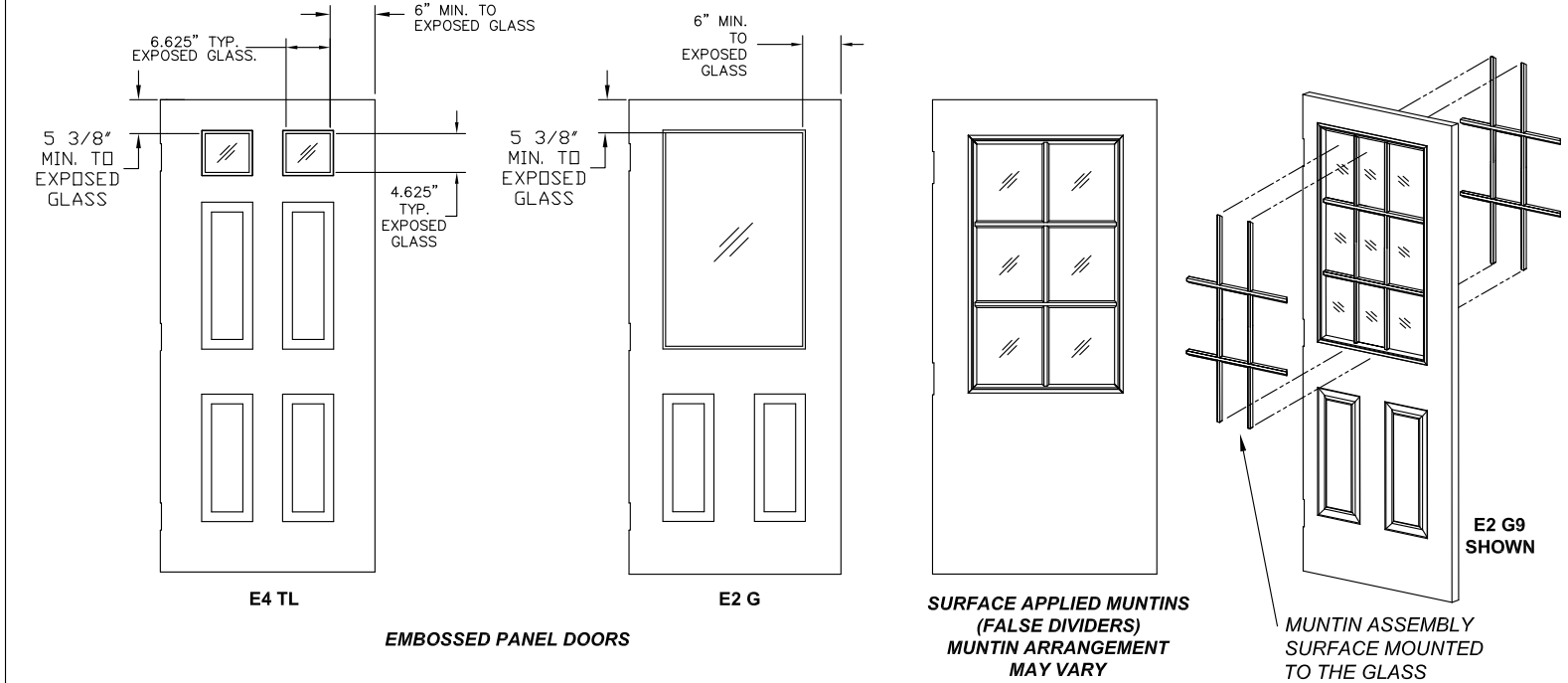

NOTES:

1. DOOR CONSTRUCTION
2. MINIMUM DOOR THICKNESS - 1 3/4"
3. ALL GLASS LITE TYPES SHOWN ON THIS SHEET ARE AVAILABLE FOR ALL DOOR CONFIGURATIONS SHOWN ON SHEET 1 AND TABLE 1 SHEET 2 EXCEPT FOR CONFIGURATIONS 9, 9A, 10 AND 10A. SEE NOTE 4.
4. DOOR CONFIGURATIONS 9 AND 10 AVAILABLE WITH 'V' VISION LITE AND 9A AND 10A IS AVAILABLE WITH N3, N4 AND N5 TYPE LITE. (SEE TABLE 1 SHEET 2)
5. MAXIMUM GLAZING DLO HEIGHT AND WIDTH AS PER SHEETS 1, 2, AND 8.
6. GLAZING OPENING DLO SIZE WILL CHANGE IN PROPORTION WITH DOOR SIZE.(SEE TABLE 1 SHEET 2 FOR LIMITATIONS)
7. DOOR SIZE MAY VARY, SUBJECTED TO COMPLIANCE WITH FLORIDA BUILDING CODE AND PRODUCT AVAILABILITY FROM MANUFACTURER.
8. GLASS LITES NOT LIMITED TO THOSE SHOWN, PROVIDED DIMENSIONS SHOWN ARE MAINTAINED. (SEE TABLE 1 SHEET 2)
9. DOORS WITH MULTIPLE GLASS LITES ARE NOT LIMITED TO THE DESIGNS SHOWN, PROVIDED THE DIMENSIONS SHOWN ARE MAINTAINED.(SEE TABLE 1 SHEET 2 FOR LIMITATIONS)
10. WHEN USING A CONTINUOUS HINGE THE MINIMUM DISTANCE FROM THE EDGE OF THE DOOR TO EXPOSED GLASS IS 6-1/4" AT STILES AND 7-1/2" AT MID RAILS.
11. DLO = DAYLIGHT OPENING (SEE TABLE 1 SHEET 2 FOR LIMITATIONS)
12. VERIFY GLAZING OPTION ON SHEET 9 IS AVAILABLE FOR GLASS LITE TYPE AND SIZE.

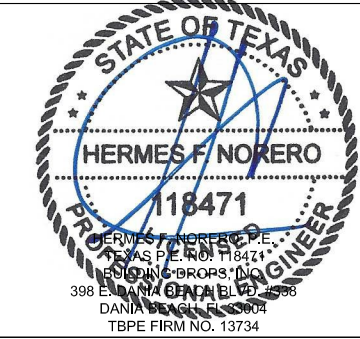

| | | | | | |
|------------------------|------------------|--|---------------------|-----------------|--|
| BEND RADIUS | | SCHLAGE LOCK COMPANY, LLC 11819 N. PENNSYLVANIA STREET CARMEL, IN 46032 | | | |
| THIRD ANGLE PROJECTION | | TITLE: STEELCRAFT H SERIES SINGLE OUTSWING GLAZED COMMERCIAL STEEL DOORS WITH AND WITHOUT PANIC EXIT DEVICES | | | |
| DRAWN YMF | DATE 05/20/07 | GLASS DOOR CONFIGURATIONS. | | | |
| CHECKED | | SIZE FLAT | DWG NO. IRGS07-T | REV B 1-9-20 | |
| APPROVED | | SCALE: NTS | AUTOCAD | SHEET 8 of 16 | |
| ENG. APPVL JPD | 11/15/07 | | | | |

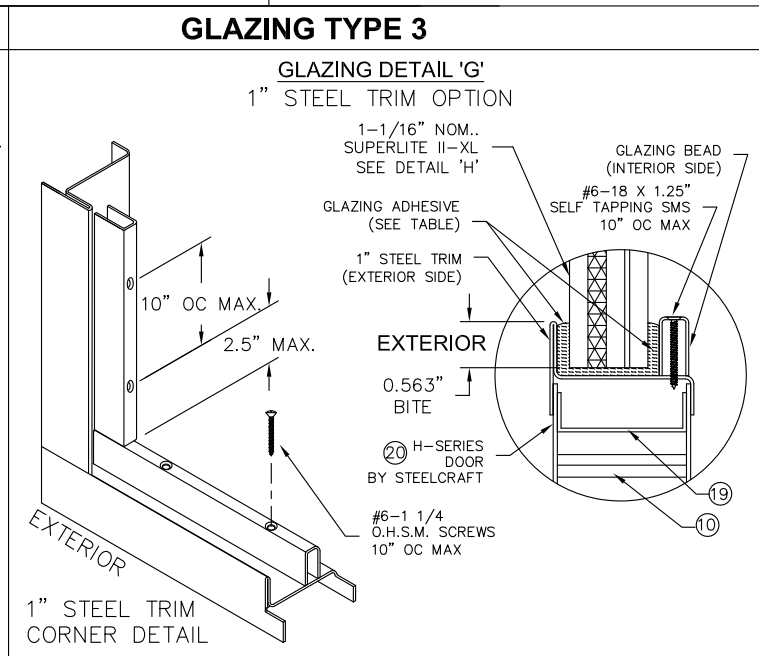
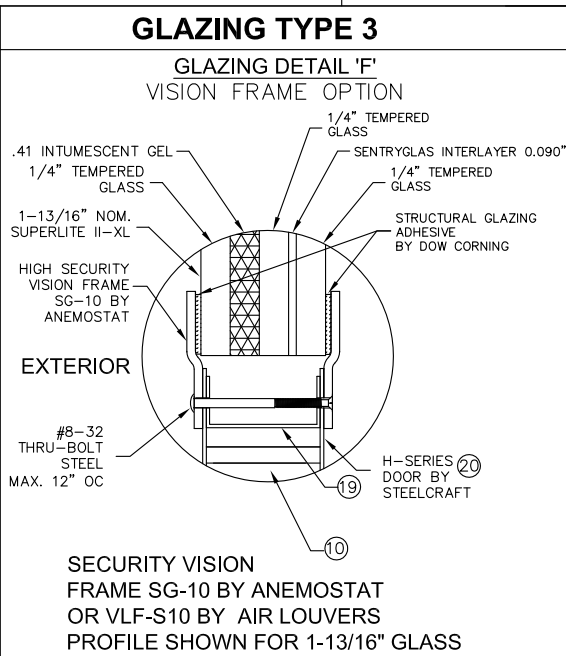
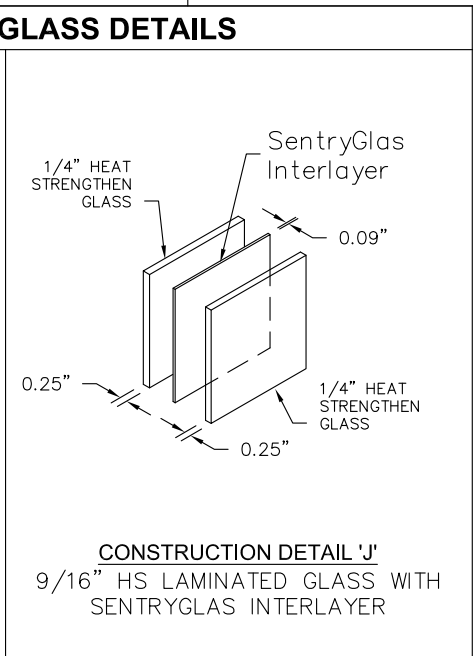
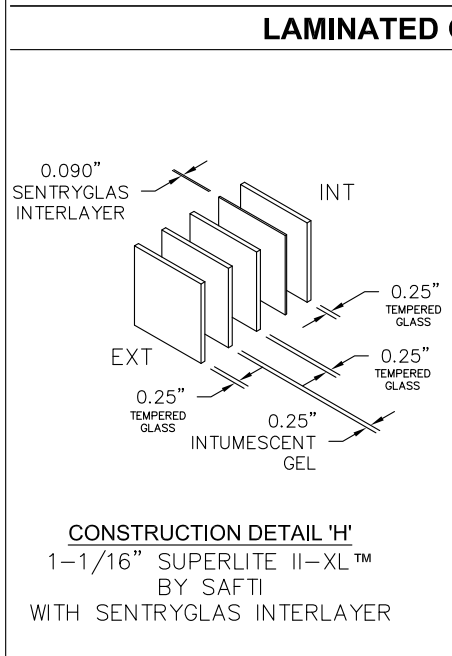
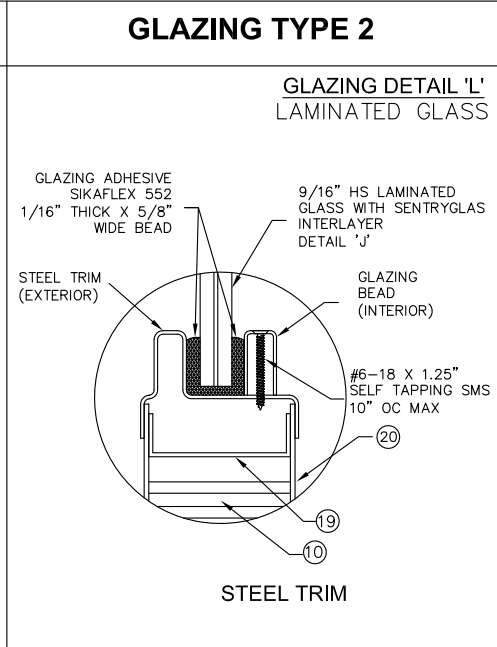
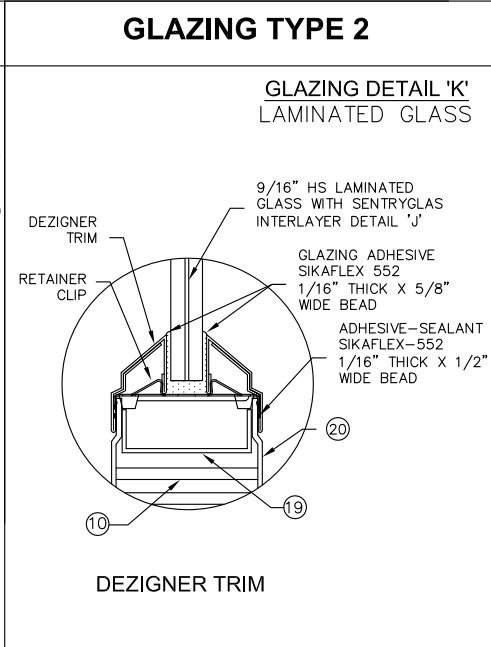
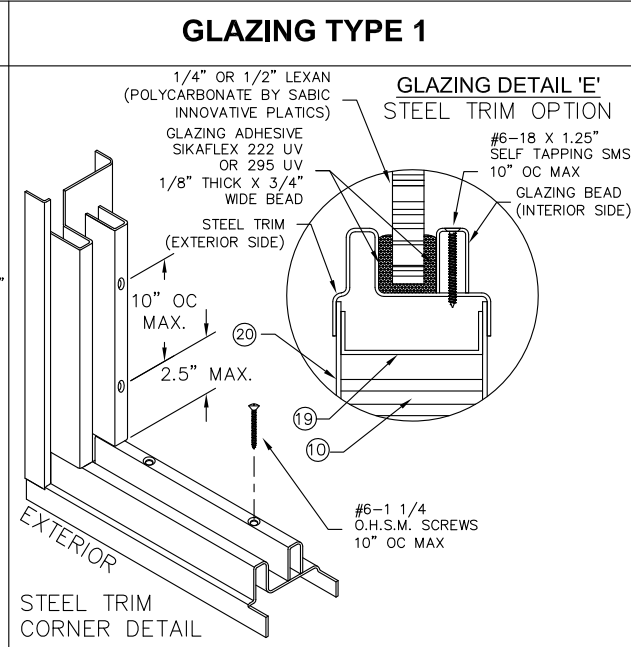
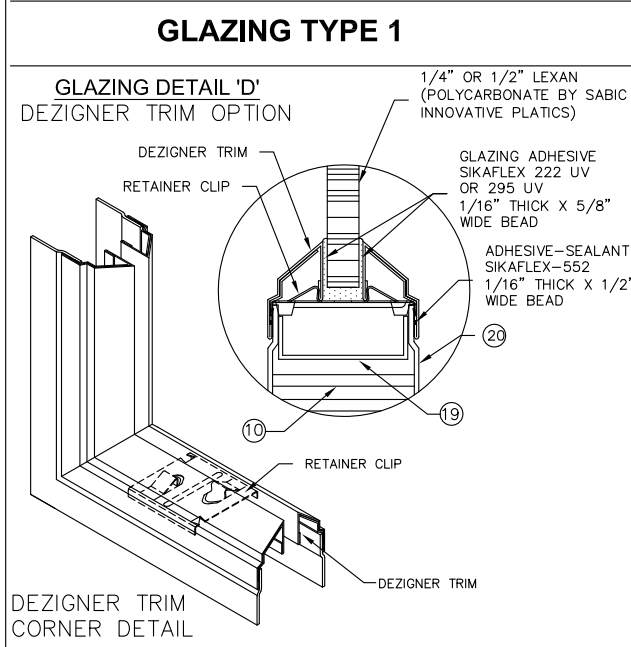
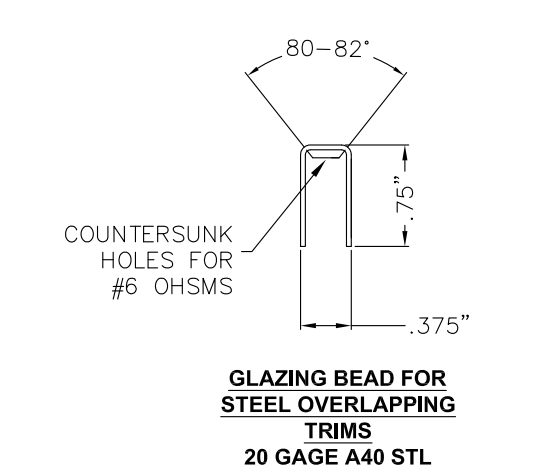
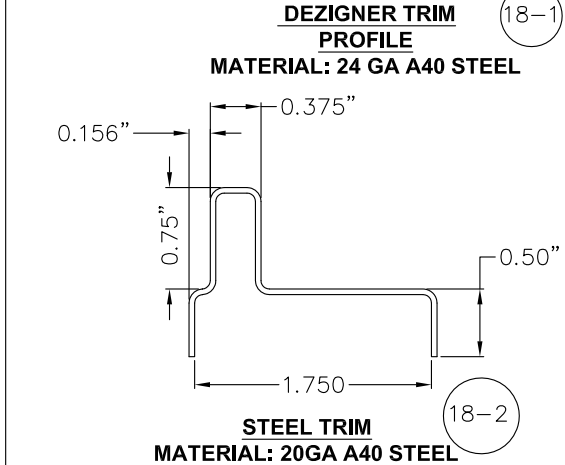
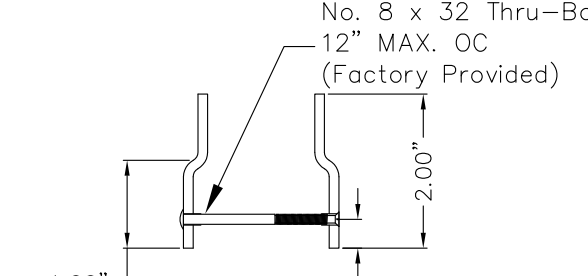
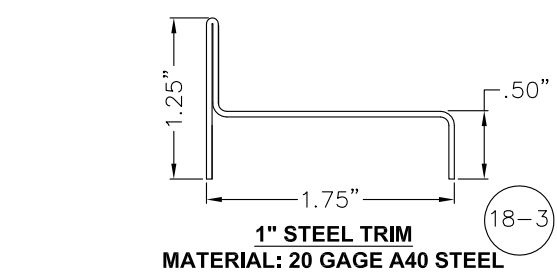
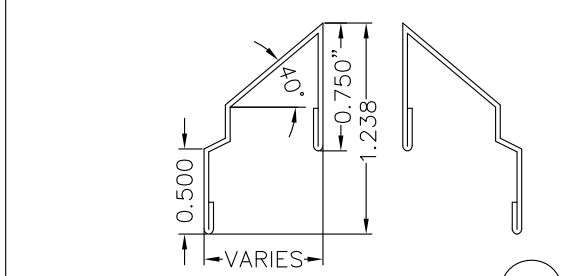

TABLE 8.

| GLAZING TYPES AND METHODS | | | | |
|---------------------------|---|---|-----------------------|---|
| TYPE | GLAZING MATERIAL | TRIM TYPE | SEALANT -ADHESIVE | GLAZING ADHESIVE |
| | 1 | LEXAN BY SABIC INNOVATIVE PLASTICS 1/4" OR 1/2" DETAILS 'D' & 'E' | DEZIGNER 1/2" OR 1/4" | SIKAFLEX 552 |
| STEEL TRIM | | | | |
| 1" STEEL TRIM | | | | |
| 2 | 9/16" HS LAMINATED GLASS WITH SENTRYGLAS INTERLAYER DETAILS 'J', 'K' & 'L' | DEZIGNER 1/2" | SIKAFLEX 552 | SIKAFLEX 552 OR DOW CORNING 995/975/983 1/16" X 5/8" BEAD |
| | | STEEL TRIM | | |
| | | 1" STEEL TRIM | | |
| 3 | SUPERLITE II-XL™ BY SAFTI WITH SENTRYGLAS INTERLAYER DETAILS 'H', 'F' & 'G' | 1" STEEL TRIM (DETAIL 'G') | NONE | SIKAFLEX 552 OR DOW CORNING 995/975/983 1/16" X 5/8" BEAD |
| | | SECURITY VISION FRAME SG-10 BY ANEMOSTAT OR VLF-S10 BY AIR LOUVERS (DETAIL 'F') | NONE | |



NOTES:

- SEE SHT.1 FOR ELEVATIONS, SHT.2 FOR SIZES AND SHT.7 FOR DOOR & FRAME MATERIAL SPECIFICATIONS.
- SEE SHT. 4 FOR ANCHOR REQUIREMENTS, WALL CONSTRUCTION AND ANCHORING SYSTEM
- SEE SHT. 7 FOR AVAILABLE OPENING SIZES, JAMB DEPTHS AND SPECIFICATIONS
- APPROVED HARDWARE TO BE INSTALLED PER MANUFACTURER'S INSTALLATION INSTRUCTIONS.
- VERIFY GLAZING MATERIAL IS AVAILABLE IN SIZE REQUIRED.

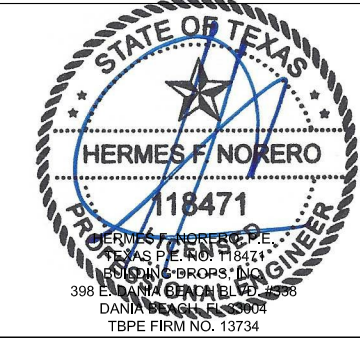

| | | | | |
|------------------------|------------------|---|---------------------|------------------|
| BEND RADIUS | | SCHLAGE LOCK COMPANY, LLC 11819 N. PENNSYLVANIA STREET CARMEL, IN 46032 | | |
| THIRD ANGLE PROJECTION | | TITLE: STEELCRAFT H SERIES SINGLE OUTSWING GLAZED COMMERCIAL STEEL DOOR WITH AND WITHOUT PANIC EXIT DEVICES | | |
| DRAWN YMF | DATE 05/20/07 | GLASS TRIM OPTIONS. | | |
| CHECKED | | SIZE FLAT | DWG NO. IRGS07-T | REV B 1-9-20 |
| APPROVED | | SCALE: NTS | AUTOCAD | SHEET 9 of 16 |
| ENG. APPVL JPD | 11/15/07 | | | |

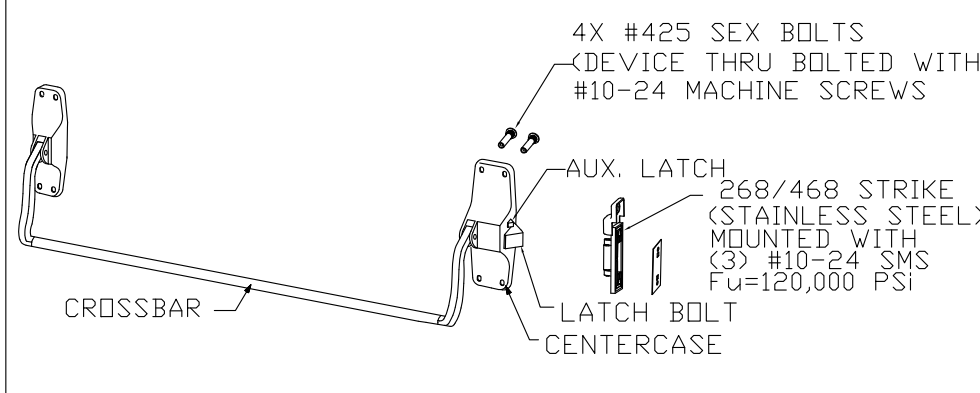

VON DUPRIN 88-F RIM DEVICE, USED IN CONFIGURATIONS: 7 & 8

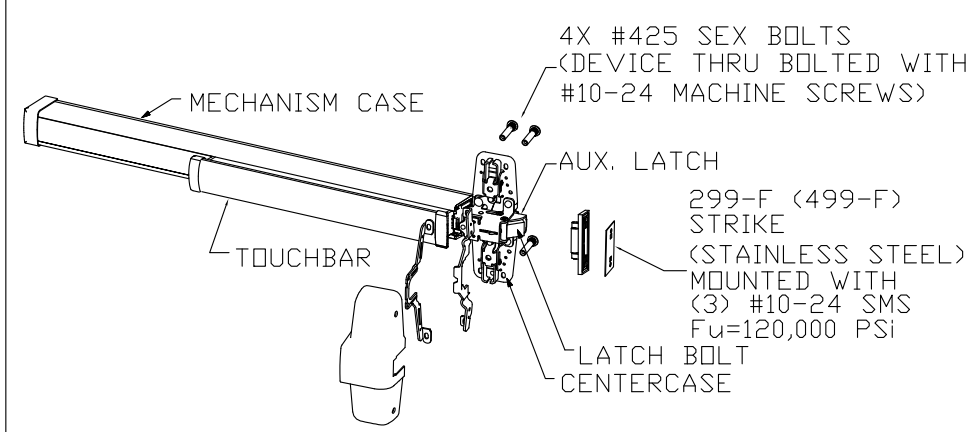

VON DUPRIN 98/99 & 98/99-F RIM DEVICE USED IN CONFIGURATIONS: 7 & 8

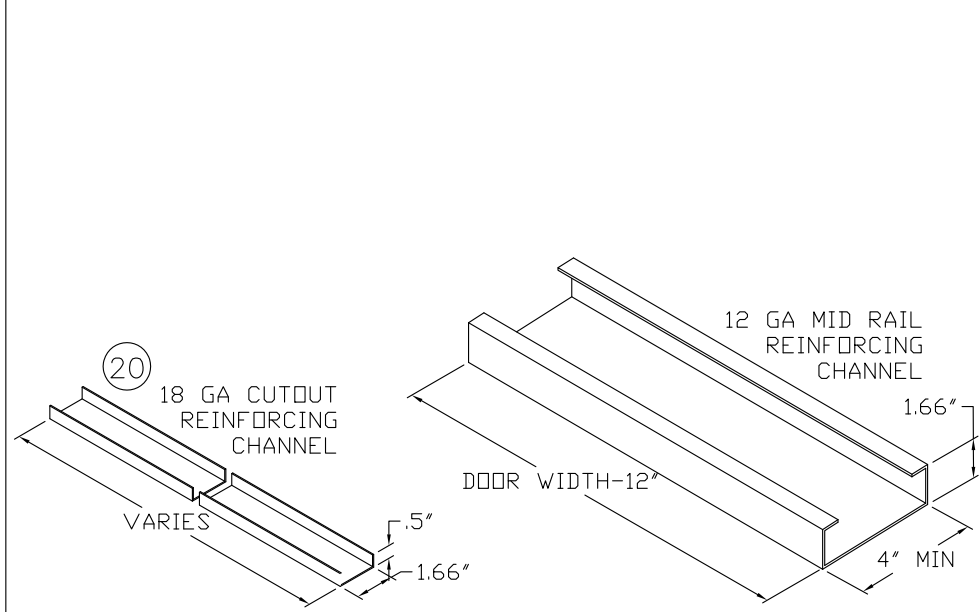

NOTES:
 1. ELECTRICAL FUNCTIONS/INSTALLATION AND FIRE RATINGS ARE NOT PART OF THIS APPROVAL, TO BE REVIEWED AND APPROVED BY BUILDING OFFICIAL
 2. EXIT HARDWARE OPTIONS:
 FOR 98/99 & XP98/99 SERIES - OPTIONS E, RX, LX, SS, EL, QEL, CX, F, ALK, CD, PN;
 (OPTIONS MAY VARY PER SERIES)
 TRIM: ALL APPLICABLE TRIMS AVAILABLE.
 FOR 88-F SERIES - FUNCTION E; TRIM: ALL APPLICABLE TRIMS AVAILABLE. PN MODEL OFFERED.

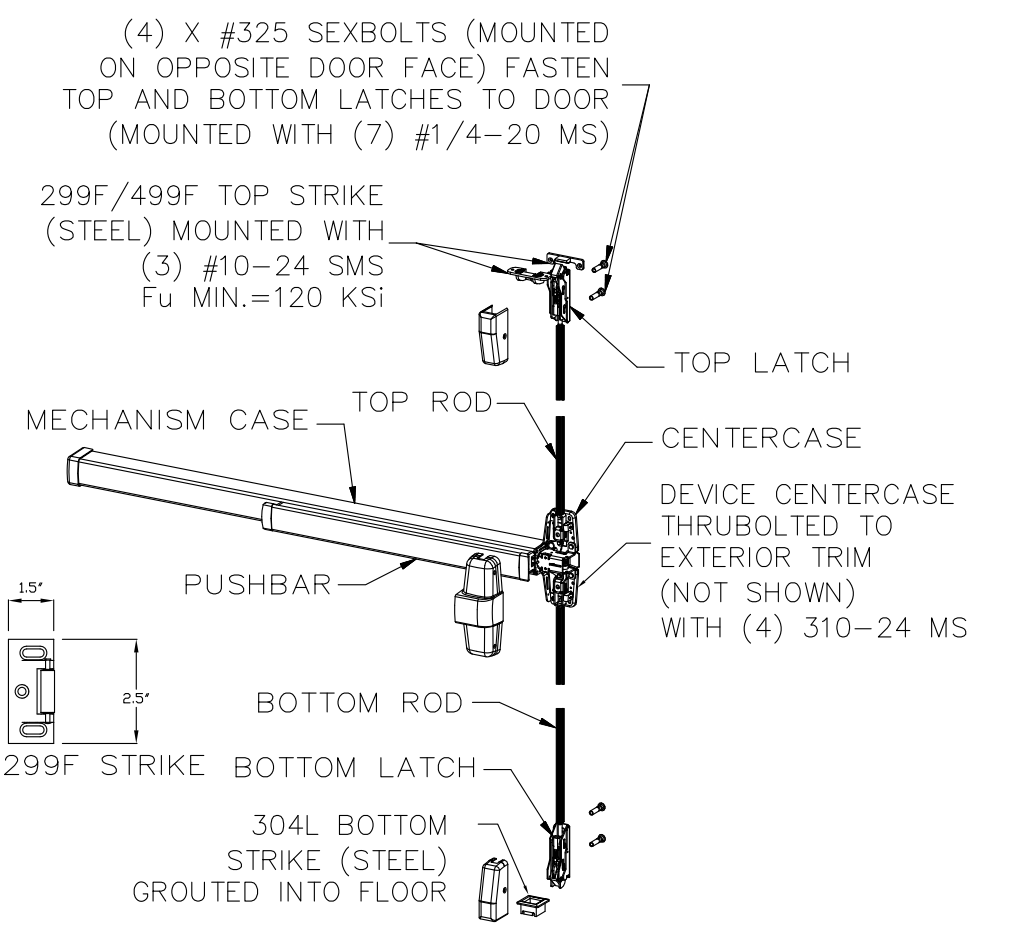

VON DUPRIN 98/9927 & 98/9927-F SURFACE VERTICAL ROD EXIT DEVICE USED IN DOOR CONFIGURATION 3 (SEE SHT.1)

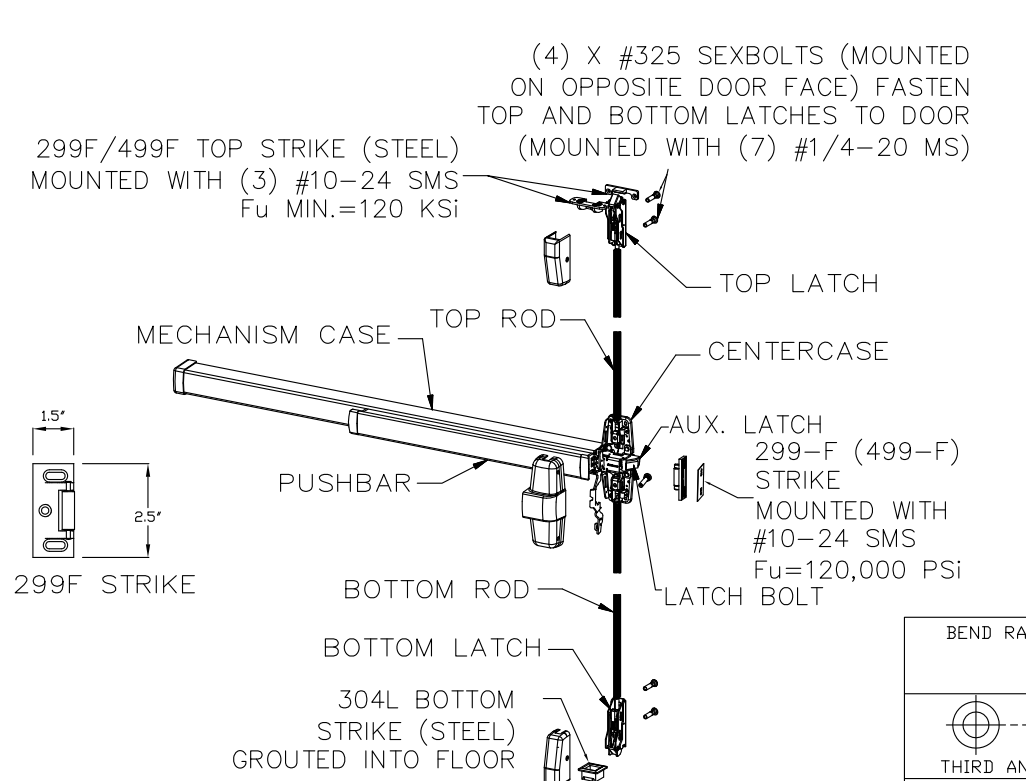

VON DUPRIN 98/9957 & 98/9957-F THREE POINT EXIT DEVICE USED IN DOOR CONFIGURATIONS 5 & 6 (SEE SHT.1)

GLAZING MATERIAL SEE TABLE 8 ON SHEET 9. SEE SHEETS 1, 2, 3 AND 8 FOR INFORMATION ON DAYLIGHT OPENING, GLASS TYPES AND SIZE LIMITATIONS

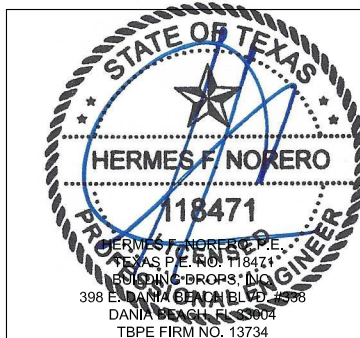
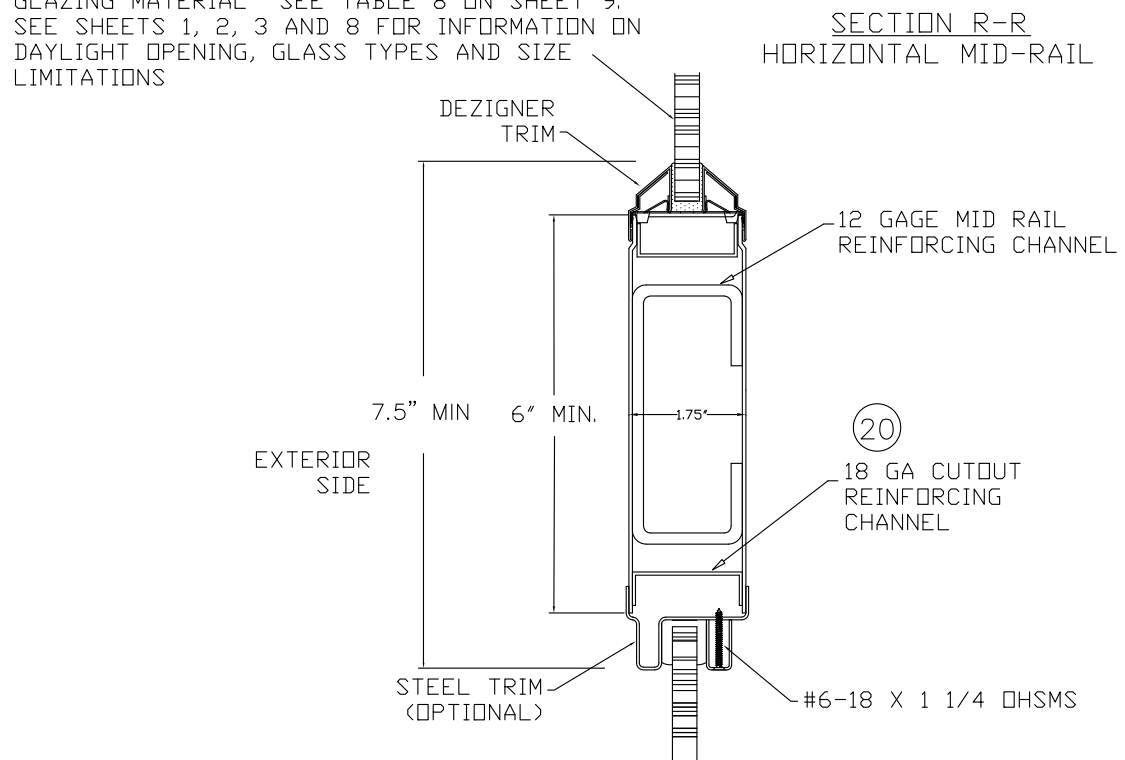

| | | | |
|------------------------|-------------------|--|---------------------|
| BEND RADIUS | | SCHLAGE LOCK COMPANY, LLC 11819 N. PENNSYLVANIA STREET CARMEL, IN 46032 | |
| THIRD ANGLE PROJECTION | | TITLE: STEELCRAFT H SERIES SINGLE OUTSWING GLAZED COMMERCIAL STEEL DOORS WITH AND WITHOUT PANIC EXIT DEVICES | |
| DRAWN YMF | DATE 05/20/07 | EXIT HARDWARE FOR GLASS SINGLE DOORS. | |
| CHECKED | CDATE | SIZE FLAT | DWG NO. IRGS07-T |
| APPROVED | ADATE | REV B | 1-9-20 |
| ENG. APPVL JPD | EDATE 11/15/07 | SCALE: NTS | AUTOCAD |
| | | SHEET 10 of 16 | |

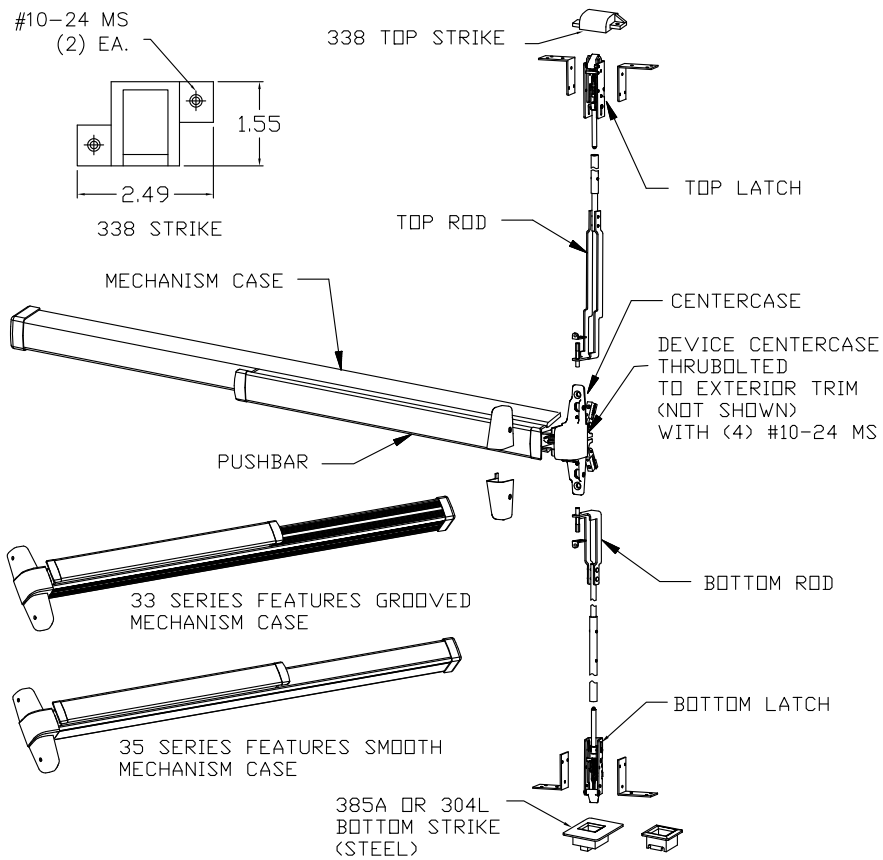

VON DUPRIN SERIES 33/3547A-F & HH33/3547 CONCEALED VERTICAL ROD EXIT DEVICE WITH 2-3/4" BACKSET USED IN COMFIGURATION 4

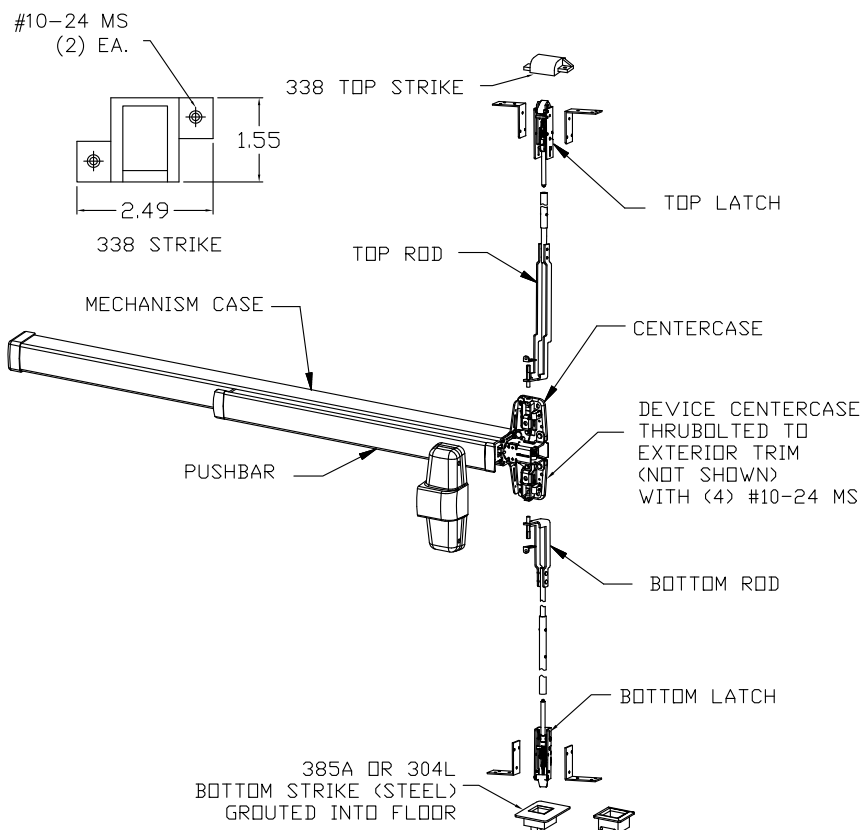

VON DUPRIN 98/9947-F & HH98/9947 CONCEALED VERTICAL ROD EXIT DEVICE WITH 2-3/4" BACKSET USED IN CONFIGURATION 4

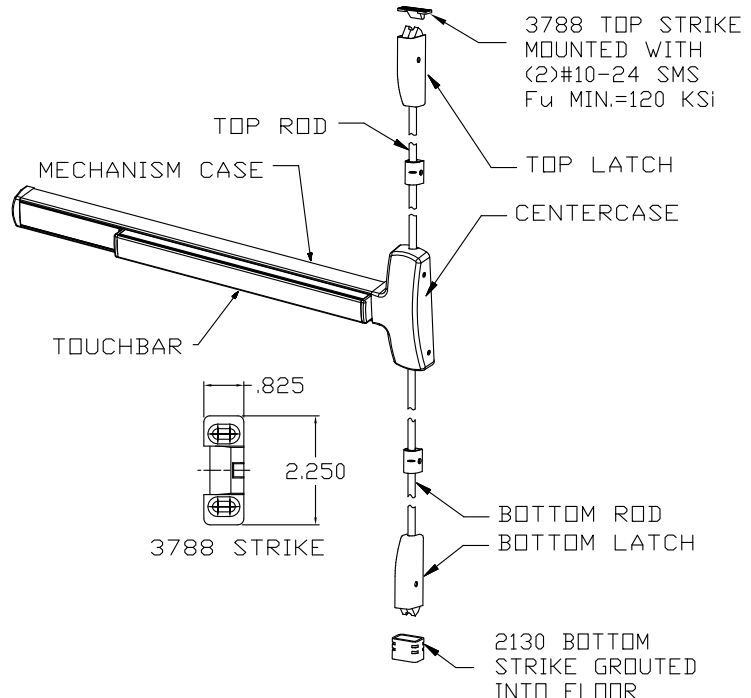

FALCON F-25-V & 25-V, SURFACE VERTICAL ROD EXIT DEVICE USED IN DOOR CONFIGURATION 3 (SEE SHT.1)

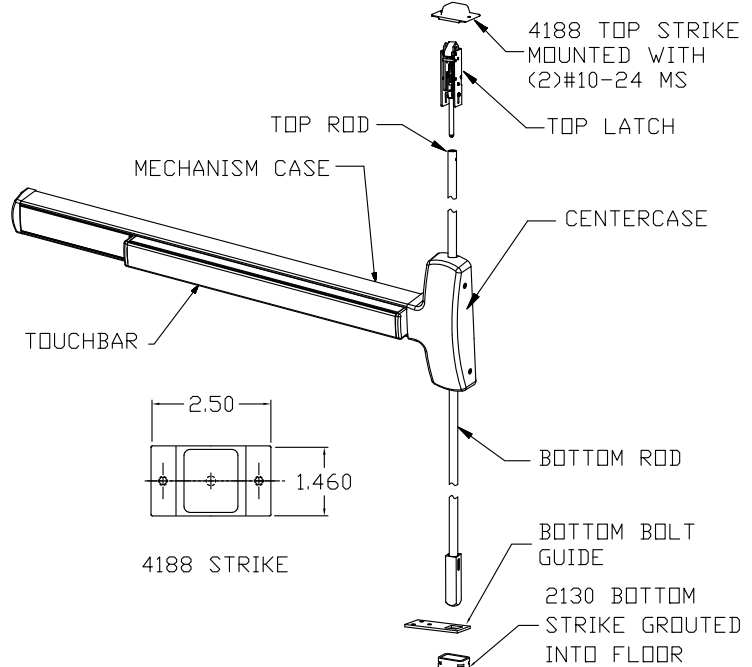

FALCON F-25-C, CONCEALED VERTICAL ROD EXIT DEVICE USED IN DOOR CONFIGURATION 4 (SEE SHT.1)

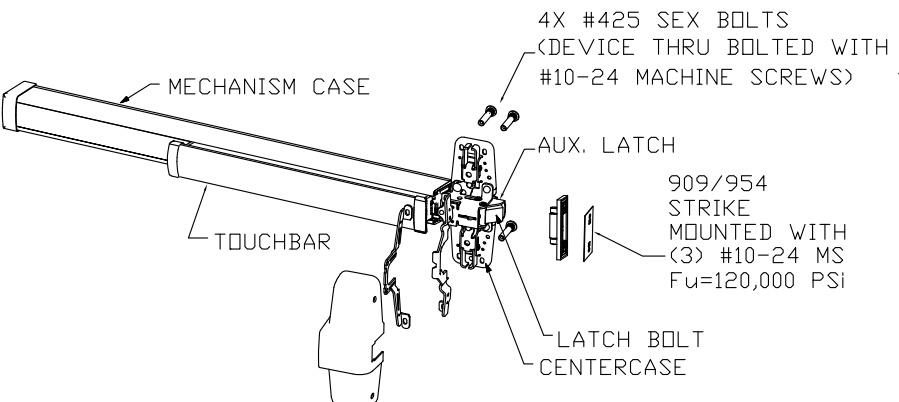

VON DUPRIN XP98/99 & XP98/99-F USED IN CONFIGURATIONS 9 & 9A

NOTES:
 1. INSTALLATION AND FIRE RATINGS ARE NOT PART OF THIS APPROVAL, TO BE REVIEWED AND APPROVED BY BUILDING OFFICIAL
 2. EXIT HARDWARE OPTIONS:
 FOR 98/99 & XP98/99 SERIES - FUNCTIONS E, RX, LX, SS, EL, QEL, CX, F (OPTIONS MAY VARY PER SERIES)
 TRIMS: ALL APPLICABLE TRIMS AVAILABLE..
 PN MODEL OFFERED.
 FOR 33/35-F SERIES - FUNCTIONS RX, LX, EL, QEL, SS
 TRIM: ALL APPLICABLE TRIMS AVAILABLE.
 FOR 2670 GUARD-X
 TRIM: ALL APPLICABLE TRIMS AVAILABLE.
 F-25-C & (F)25V SERIES - FUNCTIONS AE, DM, LM, LK, KOR, ED, EL, EA, FSA, FSE, HWEA
 TRIMS: ALL APPLICABLE TRIM AVAILABLE

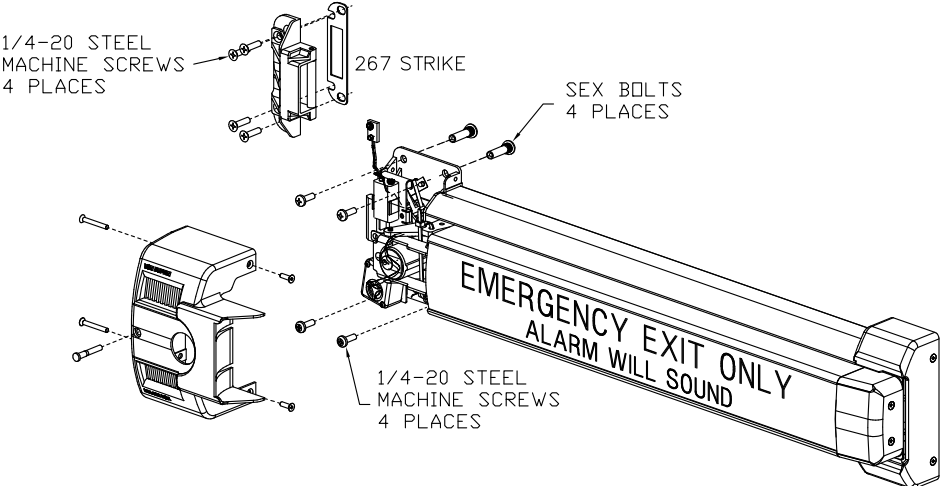

VON DUPRIN SERIES 2670 GAURD-X USED IN CONFIGURATIONS: 10 & 10A

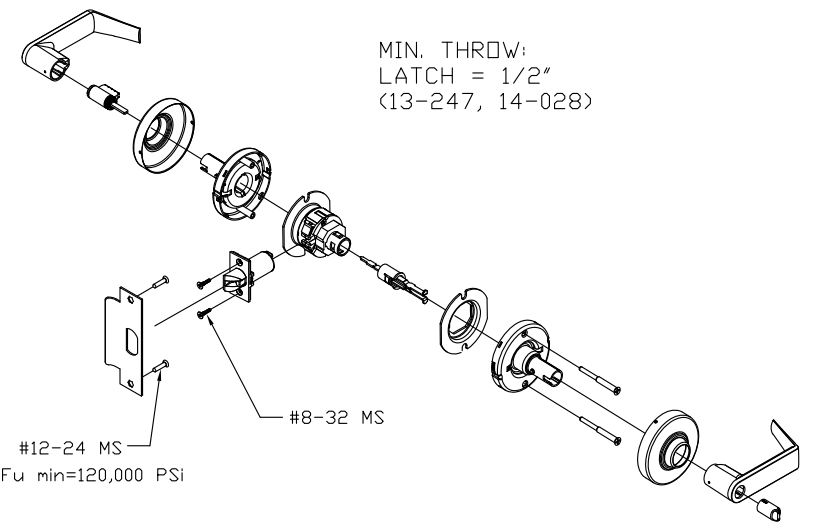

SCHLAGE ALX-SERIES CYLINDRICAL LOCKSET USED IN DOOR CONFIGURATIONS 2 & 12 (SEE SHT.1)

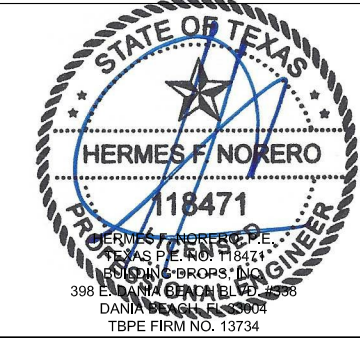

| | | | |
|------------------------|------------------|--|---------------------|
| BEND RADIUS | | SCHLAGE LOCK COMPANY, LLC 11819 N. PENNSYLVANIA STREET CARMEL, IN 46032 | |
| THIRD ANGLE PROJECTION | | TITLE: STEELCRAFT H SERIES SINGLE OUTSWING GLAZED COMMERCIAL STEEL DOORS WITH AND WITHOUT PANIC EXIT DEVICES | |
| DRAWN YMF | DATE 05/20/07 | HARDWARE OPTIONS FOR GLASS SINGLE DOORS. | |
| CHECKED | | SIZE FLAT | DWG NO. IRGS07-T |
| APPROVED | | SCALE: NTS | REV B 1-9-20 |
| ENG. APPVL JPD | 11/15/07 | AUTOCAD | SHEET 11 of 16 |

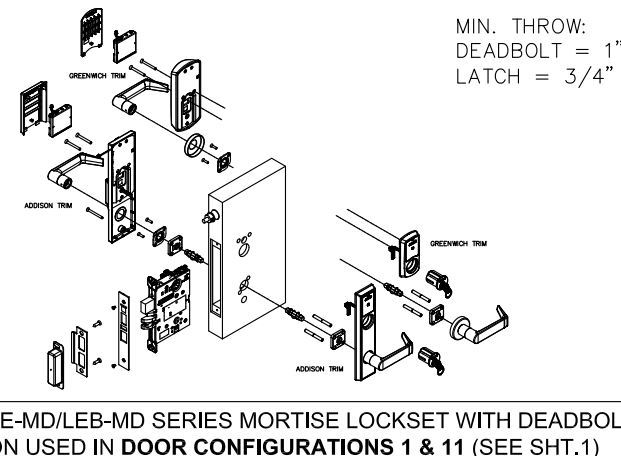
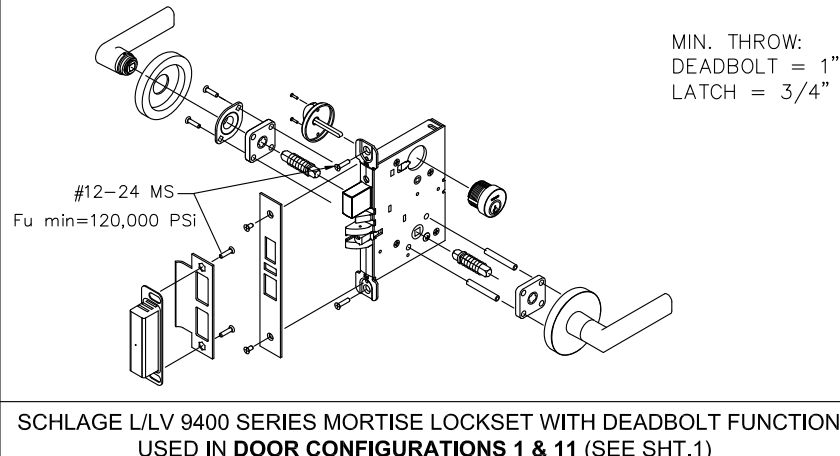
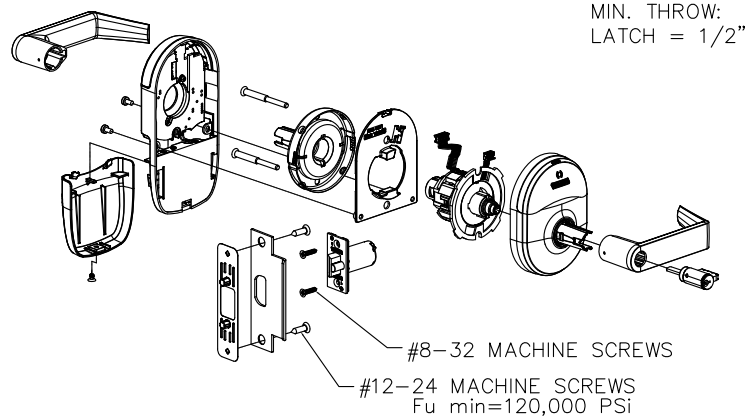

SCHLAGE NDE AND NDEB-SERIES CYLINDRICAL LOCKSET WITH 1/2\"/>

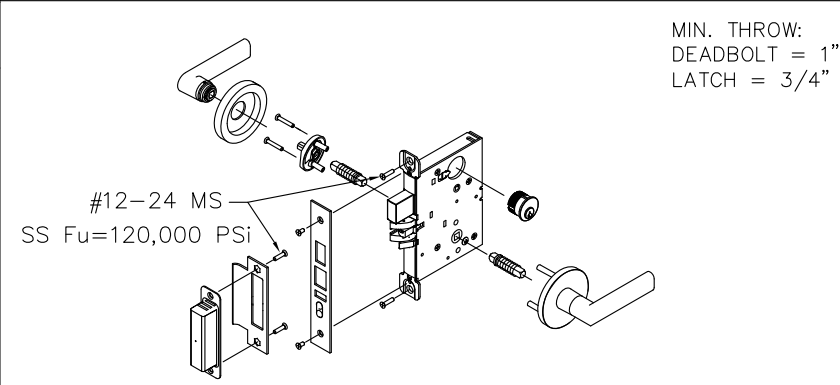

FALCON M/MA-SERIES MORTISE LOCKSET WITH DEADBOLT FUNCTION USED IN DOOR CONFIGURATIONS 1 & 11 (SEE SHT.1)

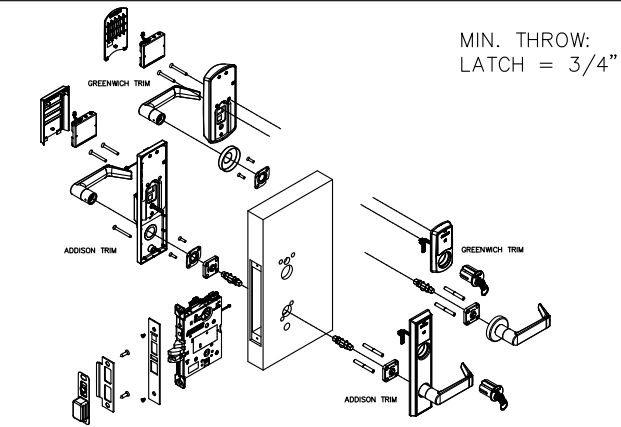

SCHLAGE LE-MS, LEB-MS, LE-MB, LEB-MB SERIES MORTISE LOCKSET WITHOUT DEADBOLT USED IN DOOR CONFIGURATIONS 1 & 11 (SHT.1)

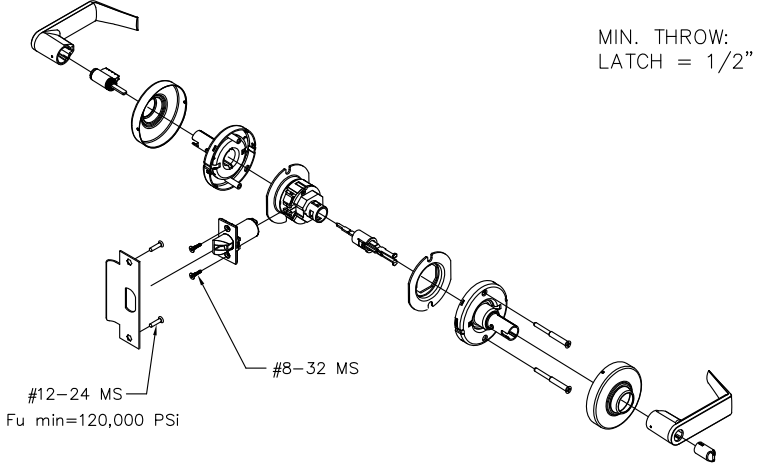

SCHLAGE D/ND-SERIES CYLINDRICAL LOCKSET USED IN DOOR CONFIGURATIONS 2 & 12 (SEE SHT.1)

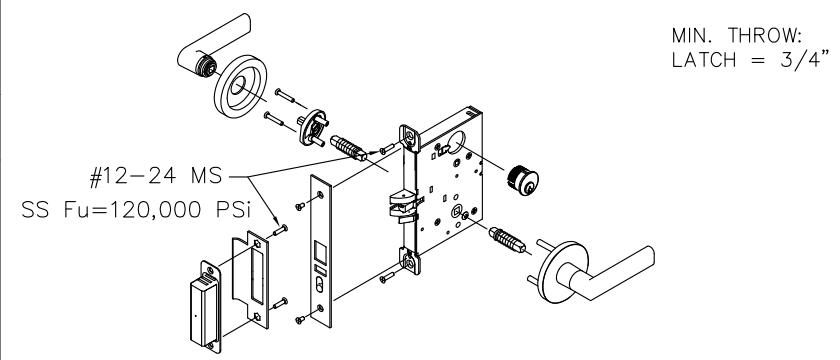

FALCON M/MA-SERIES MORTISE LOCKSET W/O DEADBOLT FUNCTION USED IN DOOR CONFIGURATIONS 1 & 11 (SEE SHT.1)

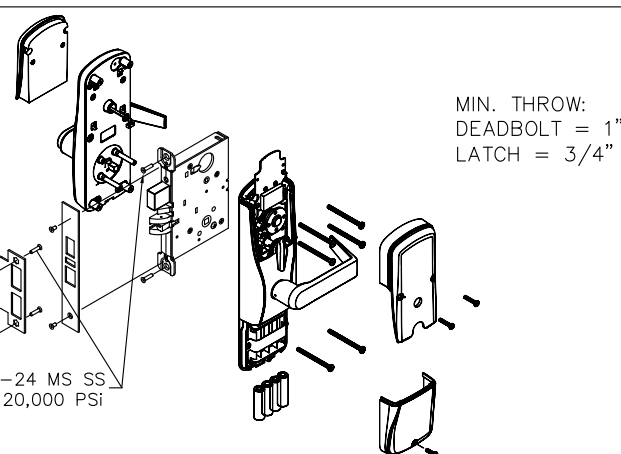

SCHLAGE AD-MD & CO-MD SERIES MORTISE LOCKSET W/ DEADBOLT USED IN DOOR CONFIGURATIONS 1 & 11 (SEE SHT.1)

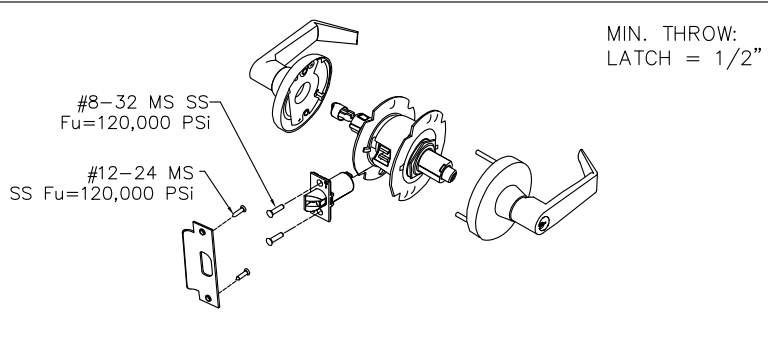

FALCON T-SERIES CYLINDRICAL LOCKSET USED IN DOOR CONFIGURATIONS 2 & 12 (SEE SHT.1)

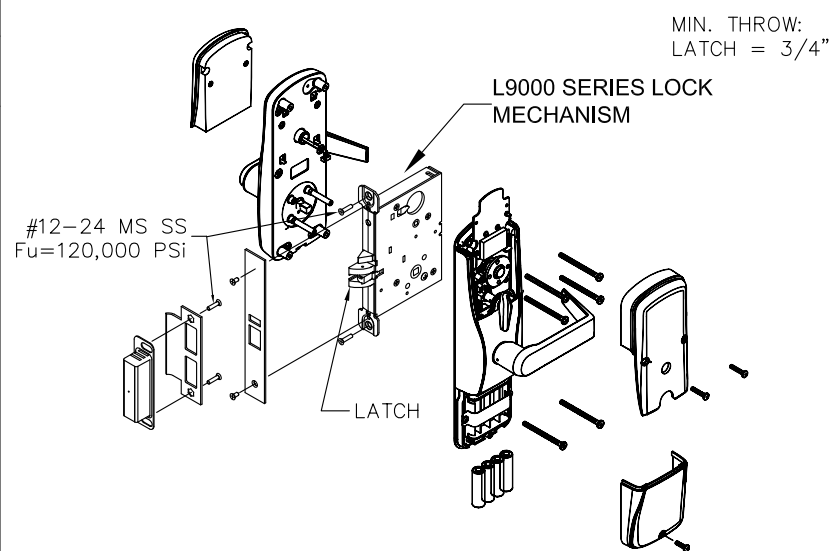

SCHLAGE AD-MS & CO-MS SERIES MORTISE LOCKSET WITHOUT DEADBOLT USED IN DOOR CONFIGURATIONS 1 & 11 (SEE SHT.1)

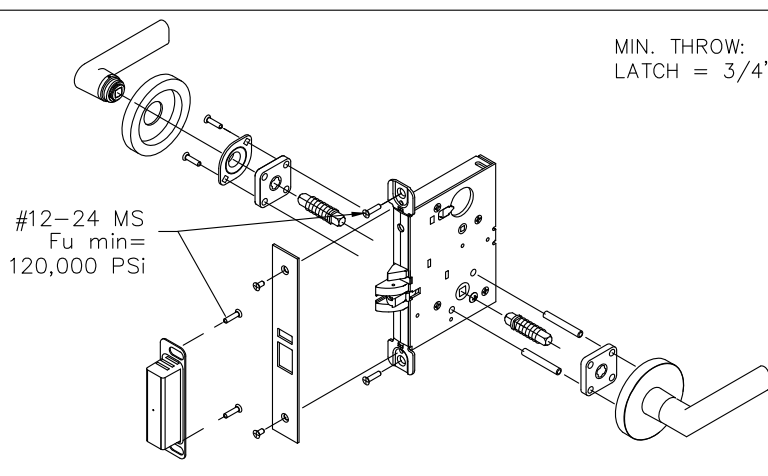

SCHLAGE L/LV 9000 SERIES MORTISE LOCKSET WITHOUT DEADBOLT USED IN DOOR CONFIGURATIONS 1 & 11 (SEE SHT.1)

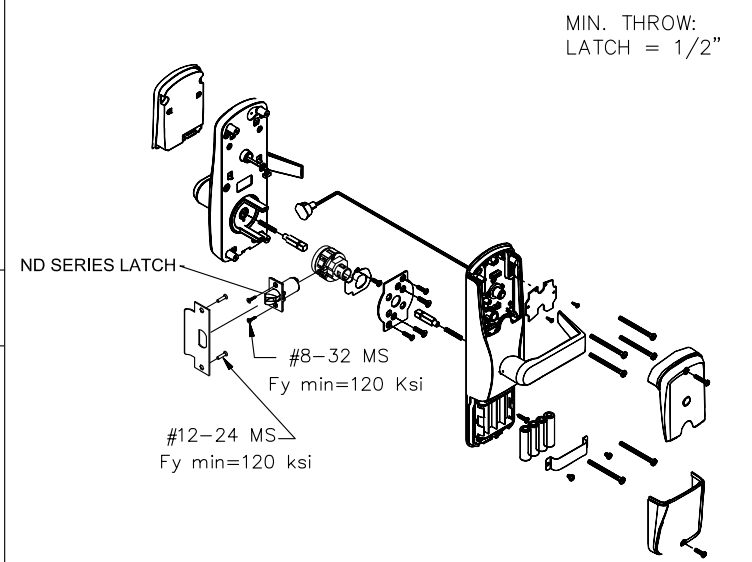

SCHLAGE AD-CY & CO-CY SERIES CYLINDRICAL LOCKSET USED IN DOOR CONFIGURATIONS 1 & 12 (SEE SHT.1)

- NOTE:
1. FIRE RATINGS ARE NOT PART OF THIS APPROVAL AND ARE TO BE REVIEWED BY THE BUILDING OFFICIAL.
 2. ELECTRIFIED FUNCTIONS APPROVED, BUT NOT SHOWN ABOVE.

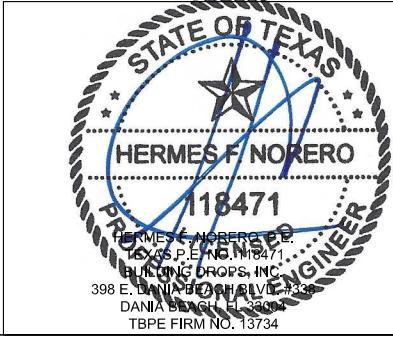

| | | | | | |
|------------------------|------------------|--|---------|---------------------|-----------------|
| BEND RADIUS | | SCHLAGE LOCK COMPANY, LLC 11819 N. PENNSYLVANIA STREET CARMEL, IN 46032 | | | |
| THIRD ANGLE PROJECTION | | TITLE: STEELCRAFT H SERIES SINGLE OUTSWING GLAZED COMMERCIAL STEEL DOORS WITH AND WITHOUT PANIC EXIT DEVICES | | | |
| DRAWN YMF | DATE 05/20/07 | HARDWARE OPTIONS FOR GLAZED SINGLE DOORS. | | | |
| CHECKED | | SIZE | FLAT | DWG NO. IRGS07-T | REV B 1-9-20 |
| APPROVED | | SCALE: NTS | AUTOCAD | | SHEET 12 of 16 |
| ENG. APPVL JPD | 10/11/07 | | | | |

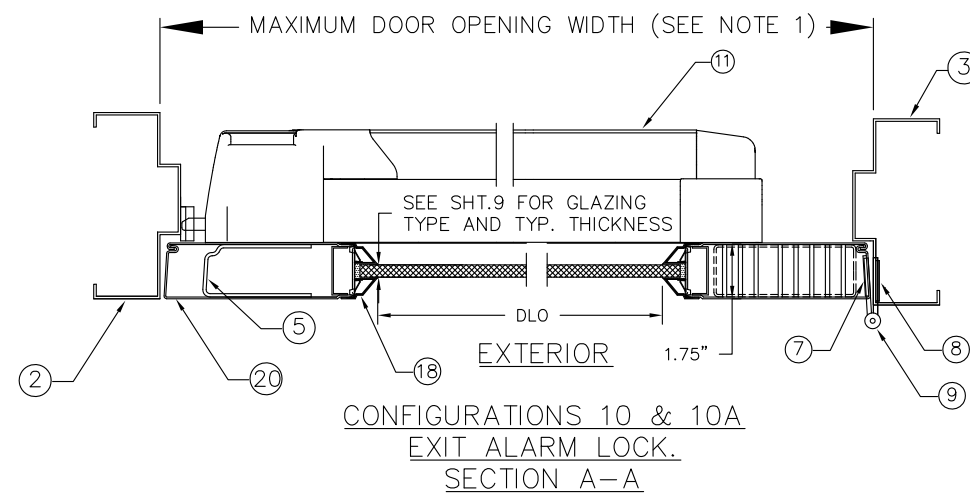
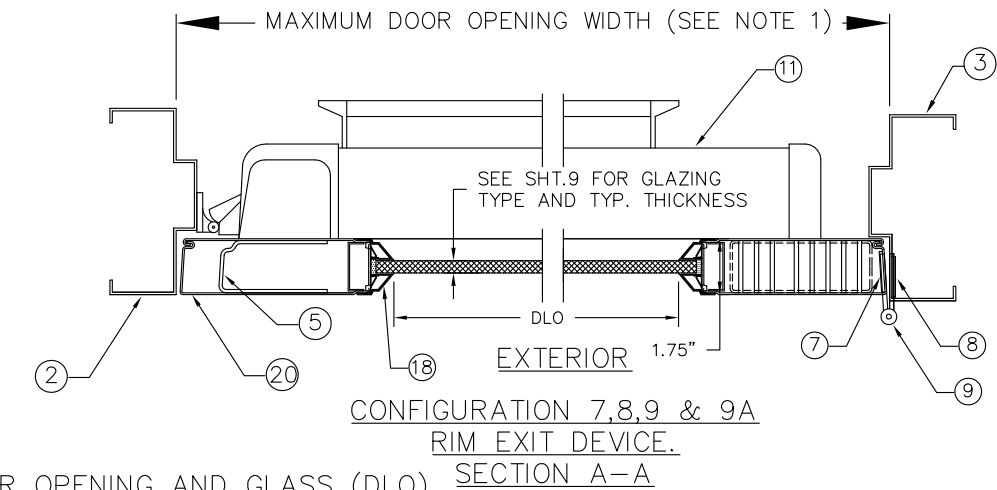
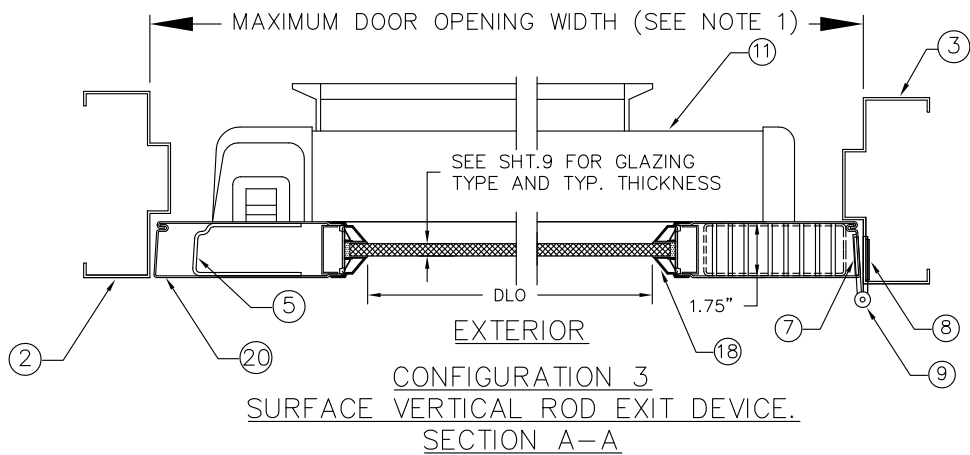
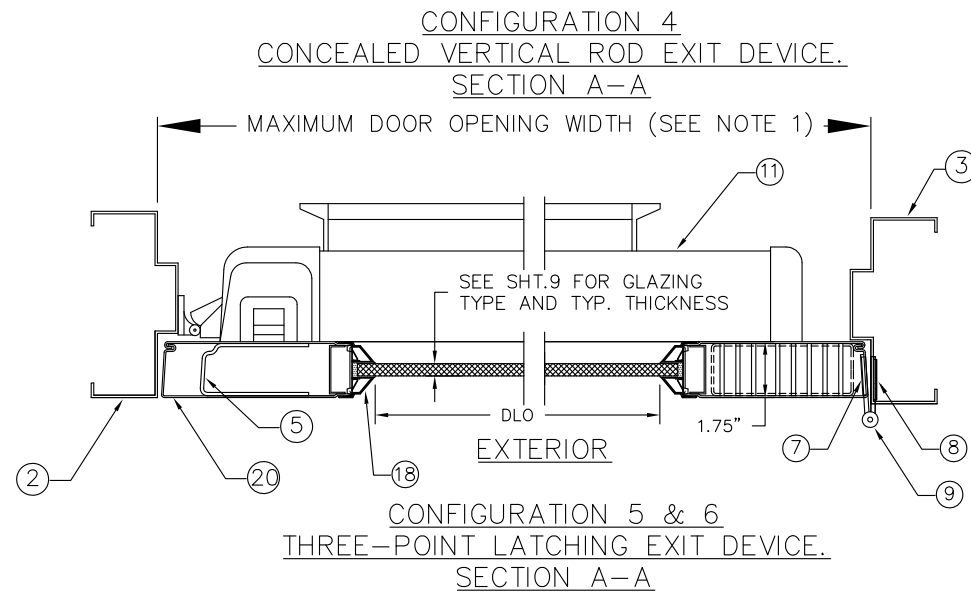
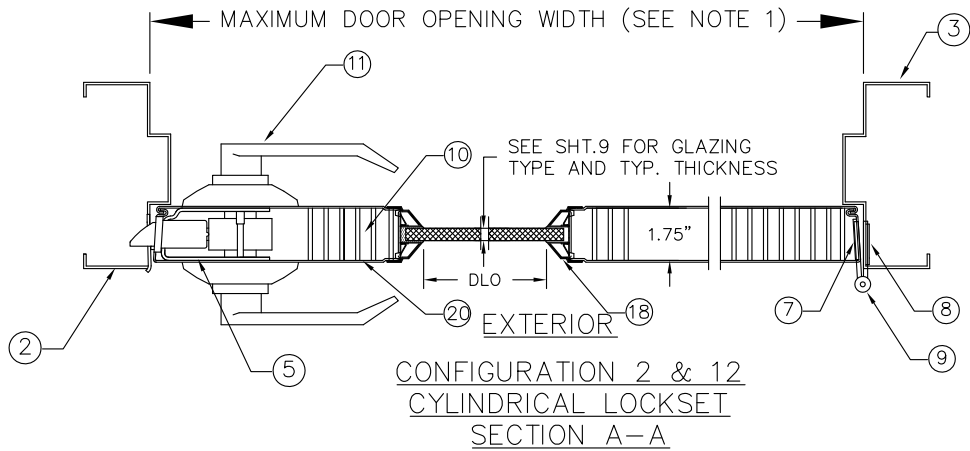
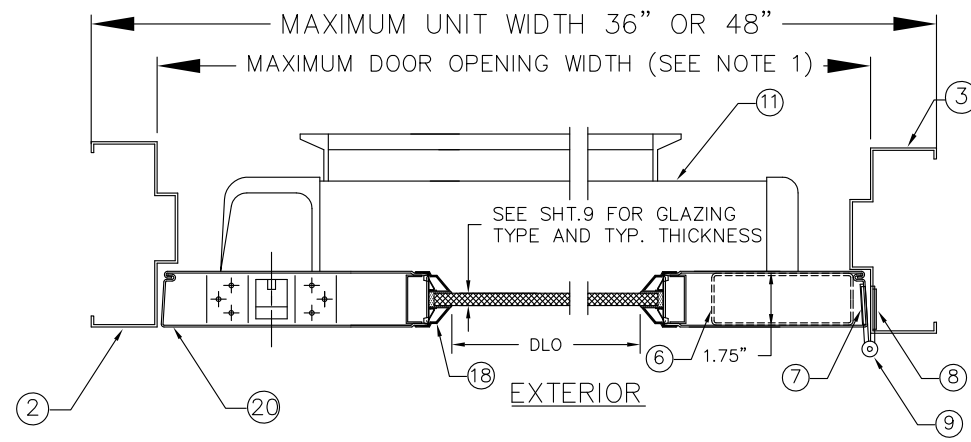
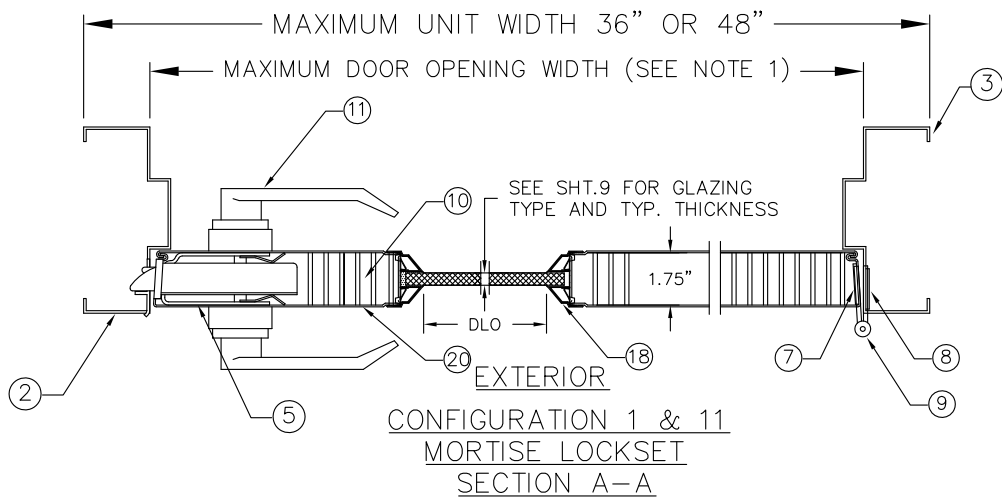

NOTES:
 1. FOR MAXIMUM DOOR OPENING AND GLASS (DLO) SIZE, SEE TABLE 1 ON SHEET 2 AND SHEETS 8 & 9 FOR LIMITATIONS.
 2. SEE SHEET 4 FOR ANCHOR INSTALLATION AND SILL INSTALLATION DETAILS

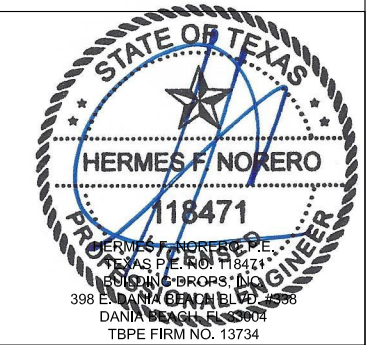

| | | | | | |
|------------------------|------------------|--|---------------------|----------|----------|
| BEND RADIUS | | SCHLAGE LOCK COMPANY, LLC 11819 N. PENNSYLVANIA STREET CARMEL, IN 46032 | | | |
| THIRD ANGLE PROJECTION | | TITLE: STEELCRAFT H SERIES SINGLE OUTSWING GLAZED COMMERCIAL STEEL DOORS WITH AND WITHOUT PANIC EXIT DEVICES | | | |
| DRAWN YMF | DATE 05/20/07 | HORIZONTAL CROSS SECTIONS FOR GLASS SINGLE DOORS. | | | |
| CHECKED | | SIZE FLAT | DWG NO. IRGS07-T | REV B | 1-9-20 |
| APPROVED | | SCALE: NTS | AUTOCAD | SHEET | 13 of 16 |
| ENG. APPVL JPD | 11/15/07 | | | | |

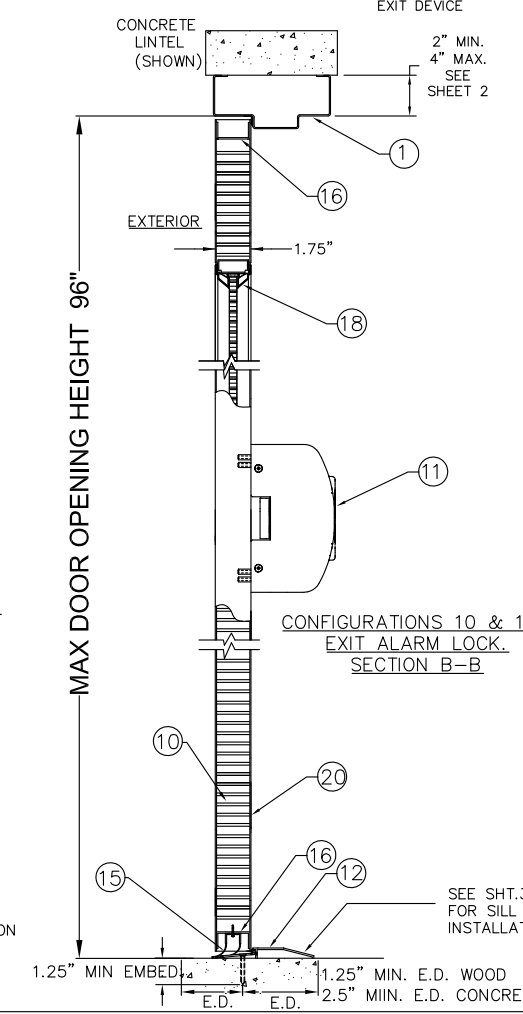
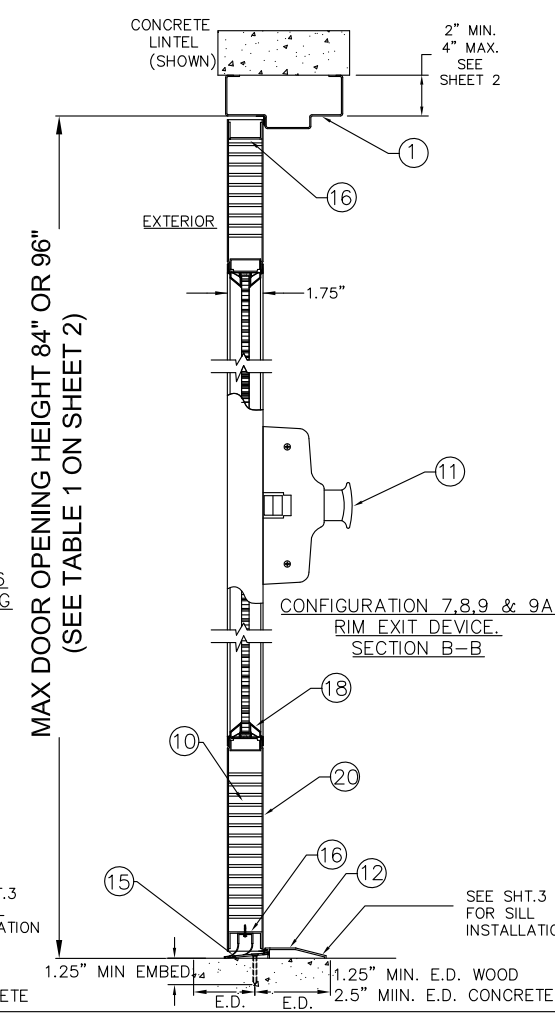
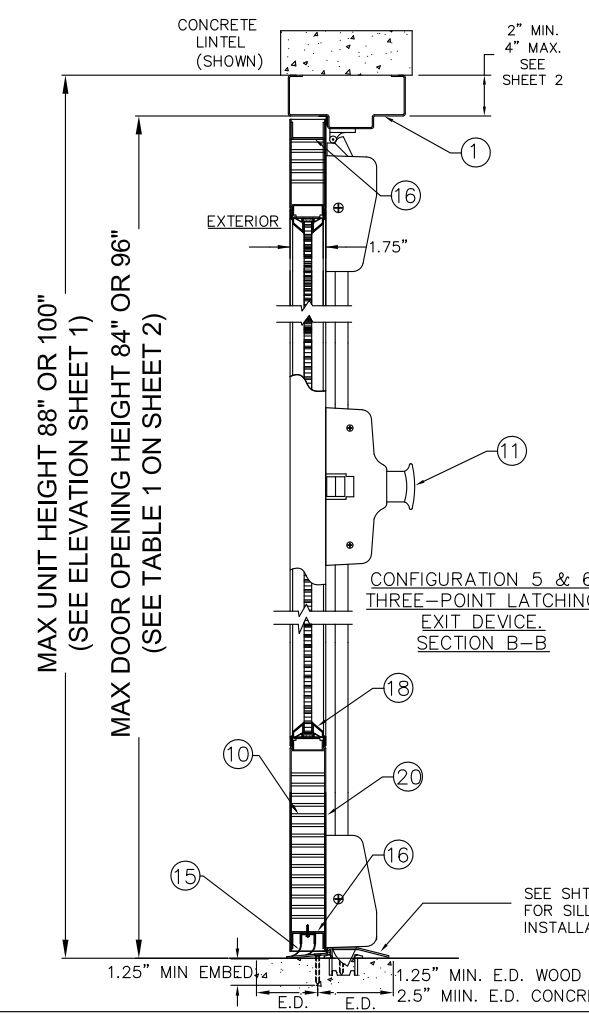
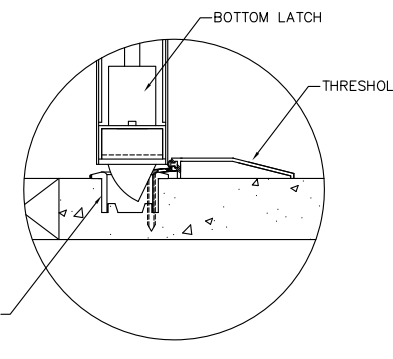
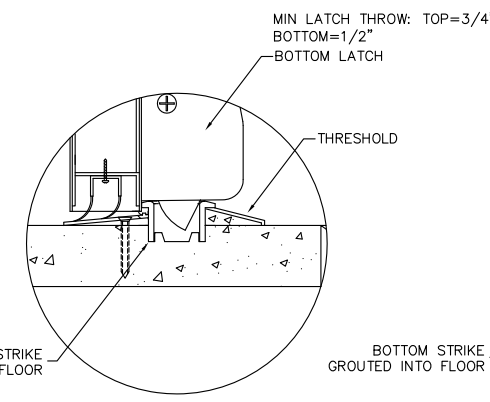
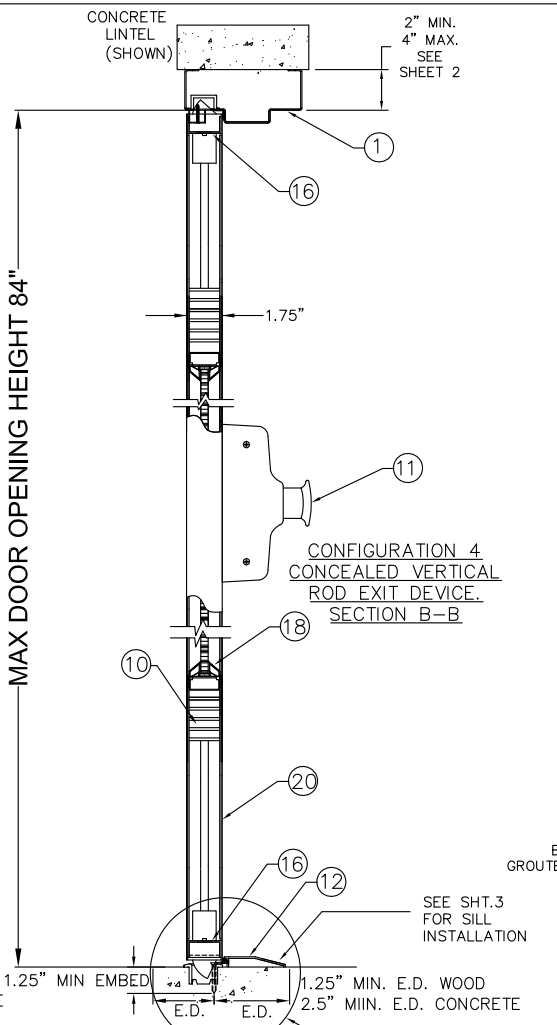
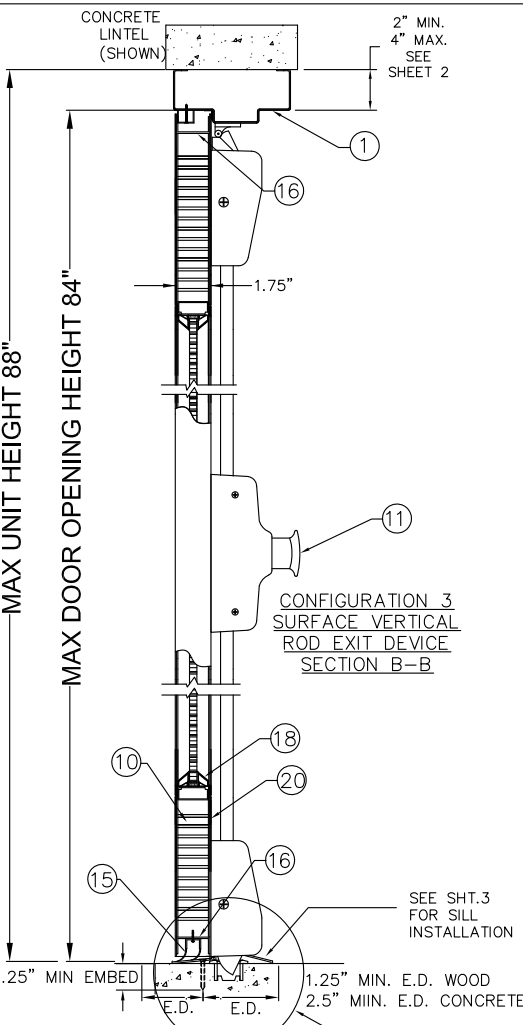
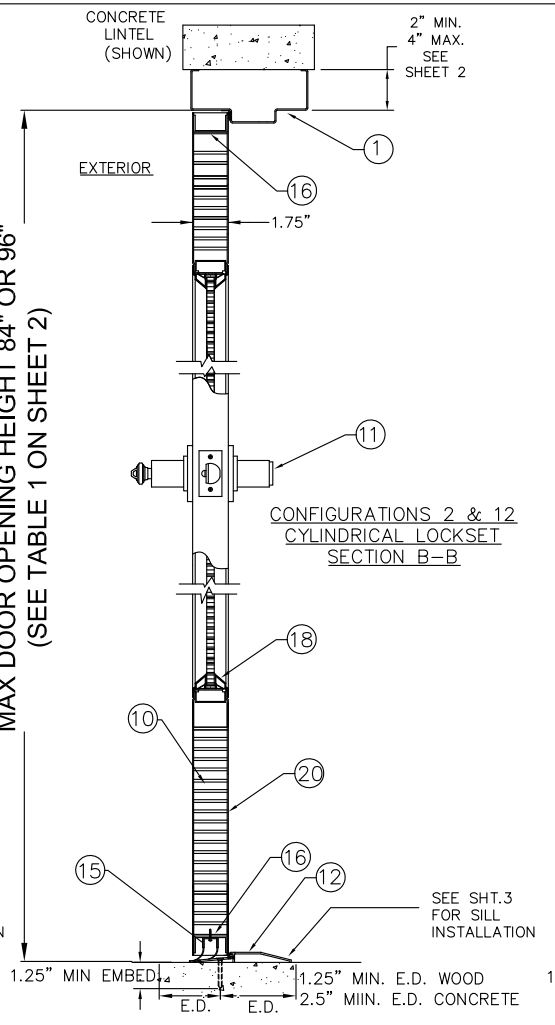
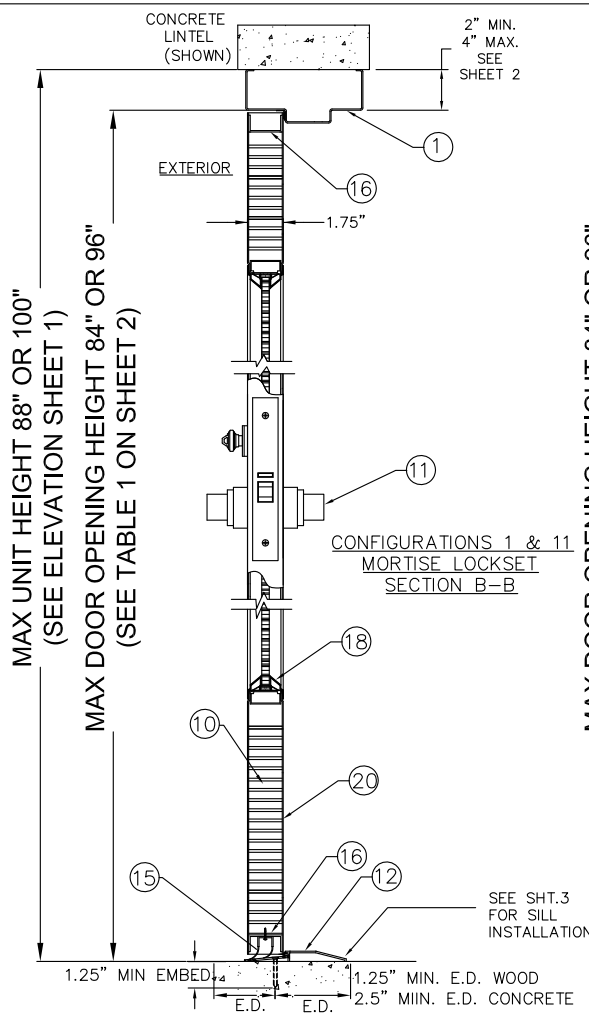

- NOTES:
1. FOR MAXIMUM DOOR OPENING SIZE AND GLASS (DLO) SIZE, SEE TABLE 1 ON SHEET 2 AND SHEETS 8 & 9 FOR LIMITATIONS.
 2. SEE SHEET 4 FOR ANCHORS INSTALLATION AND SILL INSTALLATION DETAILS.

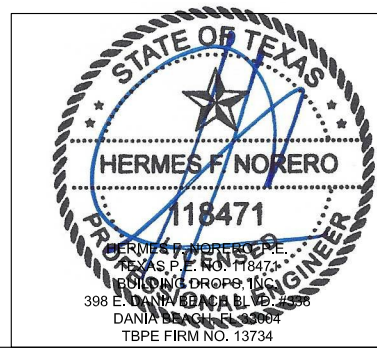

| | | | | | |
|------------------------|------------------|--|---------------------|----------|----------|
| BEND RADIUS | | SCHLAGE LOCK COMPANY, LLC 11819 N. PENNSYLVANIA STREET CARMEL, IN 46032 | | | |
| THIRD ANGLE PROJECTION | | TITLE: STELLCRAFT H SERIES SINGLE OUTSWING GLAZED COMMERCIAL STEEL DOORS WITH AND WITHOUT PANIC EXIT DEVICES | | | |
| DRAWN YMF | DATE 05/20/07 | VERTICAL CROSS SECTIONS FOR GLASS SINGLE DOORS. | | | |
| CHECKED | | SIZE FLAT | DWG NO. IRGS07-T | REV B | 1-9-20 |
| APPROVED | | SCALE: NTS | AUTOCAD | SHEET | 14 of 16 |
| ENG. APPVL JPD | 11/15/07 | | | | |

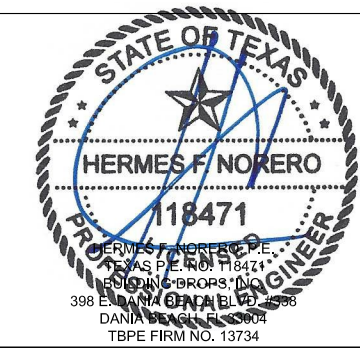
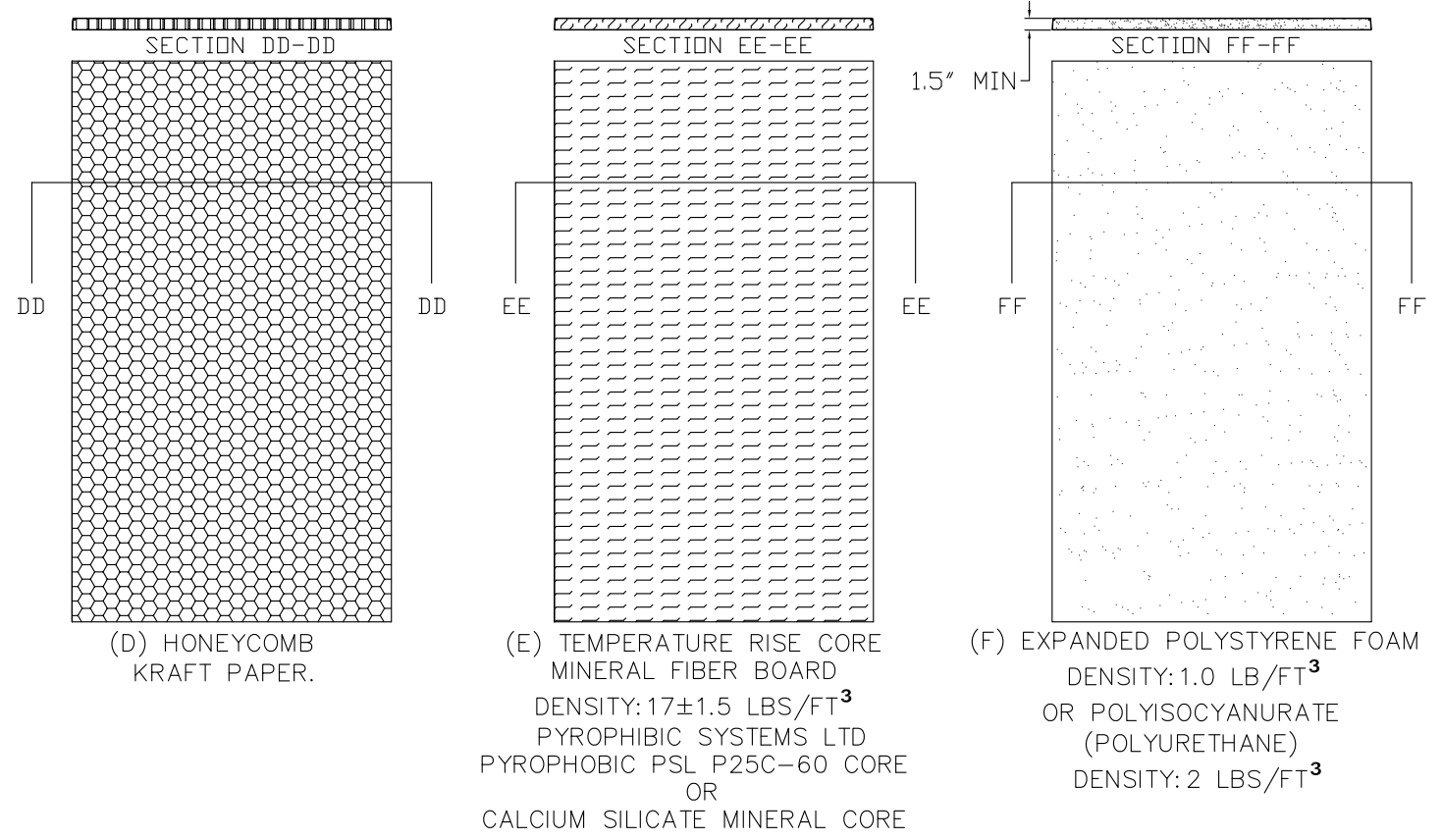
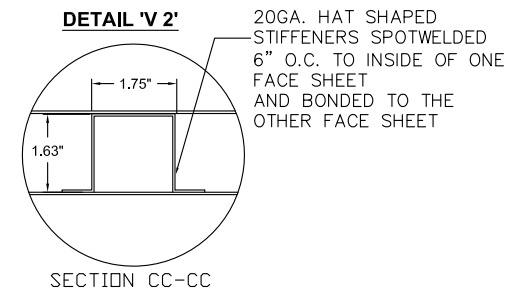
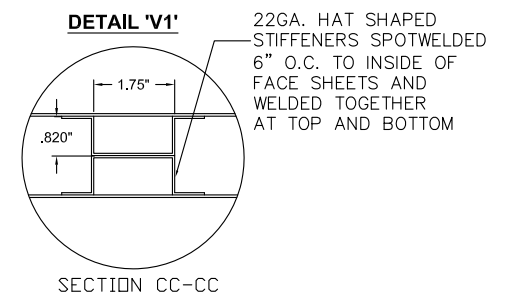
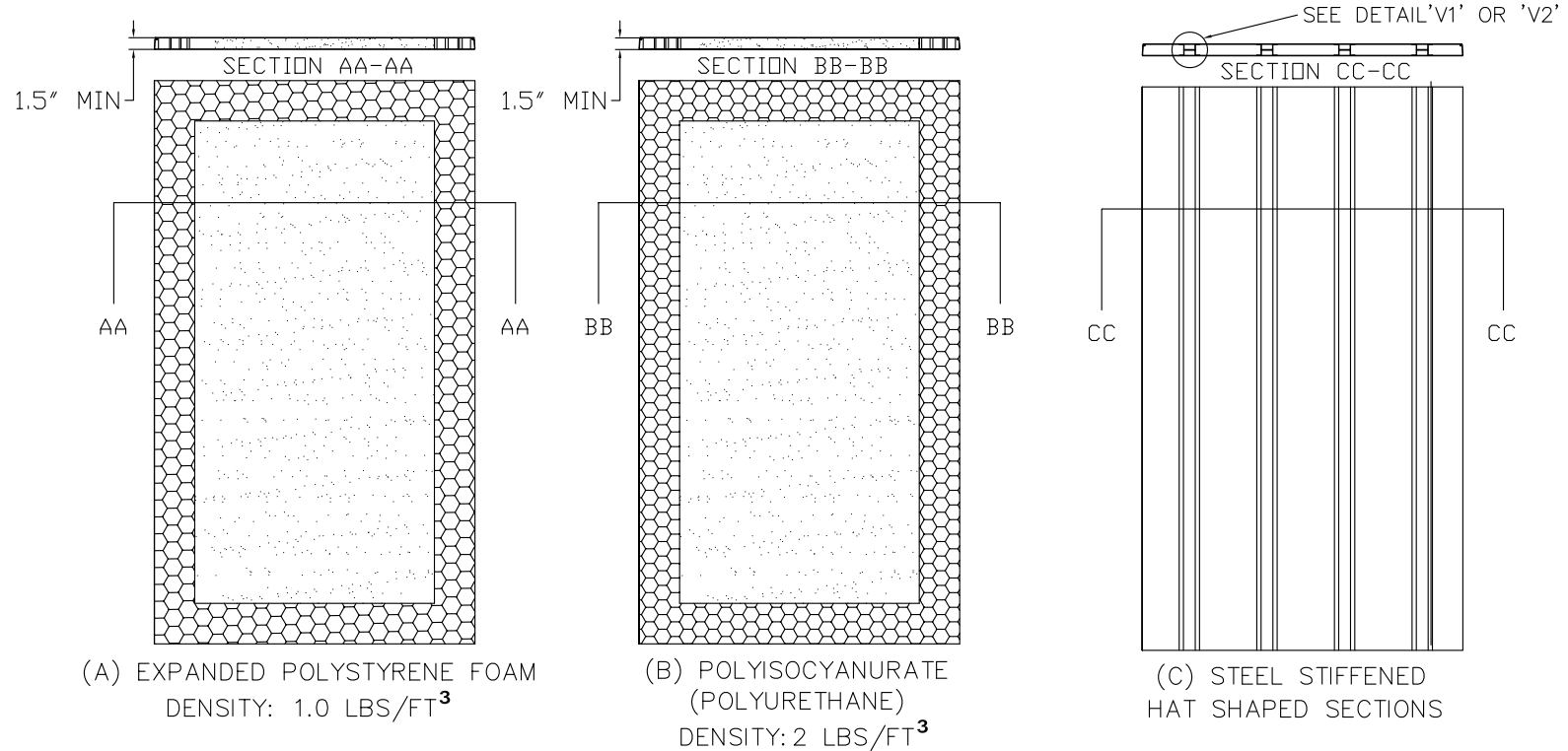

NOTES:
1. CORE MATERIAL SHOWN WITHOUT CUTOUTS FOR REINFORCEMENTS

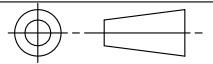
| | | | | | |
|---|--|---|------|--|-----------------|
| BEND RADIUS | | SCHLAGE LOCK COMPANY, LLC 11819 N. PENNSYLVANIA STREET CARMEL, IN 46032 | | | |
|  THIRD ANGLE PROJECTION | | | | | |
| DRAWN JPD | | DATE 02/03/14 | | TITLE: STEELCRAFT H SERIES SINGLE OUTSWING GLAZED COMMERCIAL STEEL DOORS WITH AND WITHOUT PANIC EXIT DEVICES | |
| CHECKED | | | | DOOR CORE OPTIONS | |
| APPROVED | | SIZE | FLAT | DWG NO. IRGS07-T | REV B 1-9-20 |
| ENG. APPVL | | SCALE: NTS | | AUTOCAD | SHEET 15 of 16 |

BUTT HINGE
 4.5" X 4.5" STD. WT. MIN.
 IVES 5BB1/3CB1
 STANLEY FBB179/1900
 HAGER BB1279
 .134" MIN. THICKNESS
 Fy MIN. = 36ksi

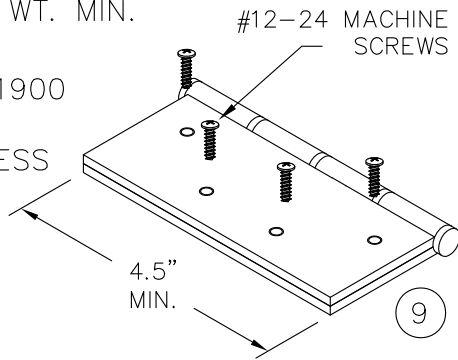

CONTINUOUS HINGE
 IVES 112HD, 112XY,
 224HD & 224XY
 STANLEY 661HD
 SELECT SL11HD
 PEMKO FM_HD SERIES
 HAGER 780-224HD
 ABH A240HD
 ALUMINUM 6036-T6 MIN
 .110" MIN. THICKNESS

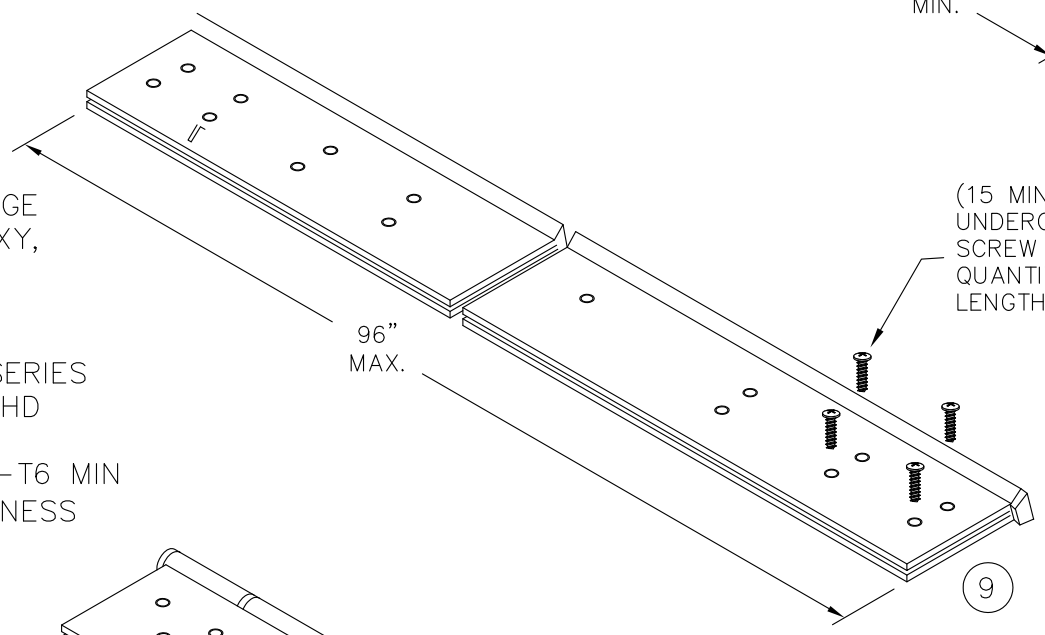

(15 MIN.) 12-24x3/4" FLAT HEAD
 UNDERCUT SELF DRILLING
 SCREW DOOR AND FRAME LEAF
 QUANTITY VARIES PER HINGE
 LENGTH

STEEL CONTINUOUS HINGE
 IVES 600
 .075 (14GA) MIN. THCKNESS
 1012 COLD ROLLED STEEL
 Fy MIN. 45ksi
 STAINLESS STEEL CONTINUOUS HINGE
 IVES 700, 700CS
 HAGER 790-900
 MARKAR FM-300 & HG305
 ABH A500
 .075" (14GA) MIN. THICKNESS
 304 STAINLESS STEEL
 Fy MIN. 31ksi

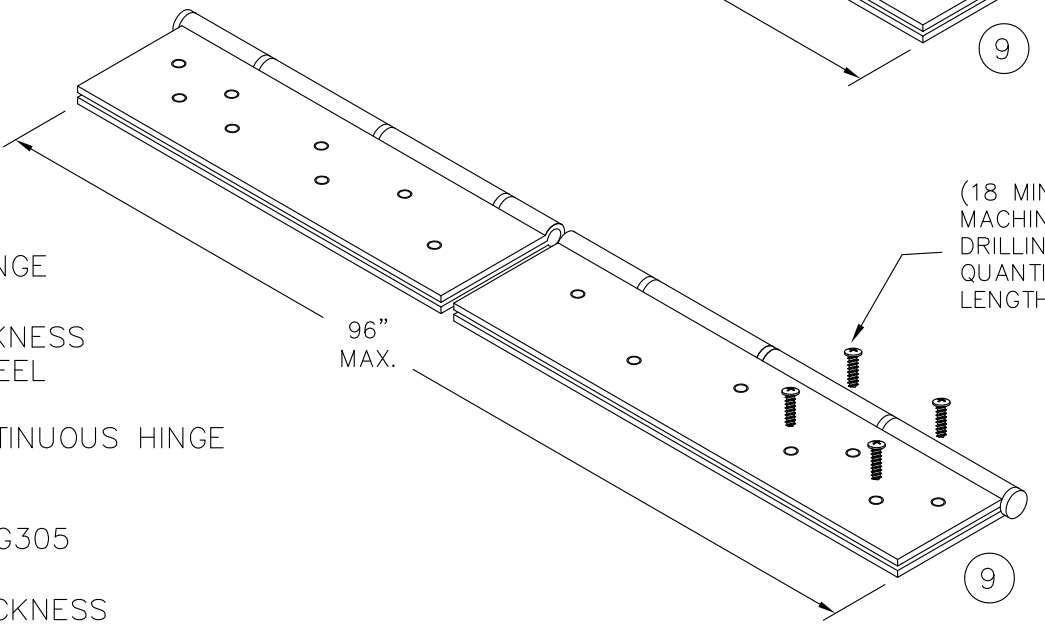

(18 MIN.) #10-24X 1/2" MIN.
 MACHINE SCREW OR SELF
 DRILLING EACH HINGE LEAF
 QUANTITY VARIES PER HINGE
 LENGTH

CONTINUOUS HINGE NOTES:
 1. QUANTITY OF SCREWS VARIES PER HINGE LENGTH,
 MANUFACTURER AND MODEL NUMBER
 2. SCREW SPACING VARIES PER HINGE LENGTH,
 MANUFACTURER AND MODEL NUMBER
 3. INSTALL HINGES PER THE MANUFACTURERS INSTALLATION
 INSTRUCTIONS

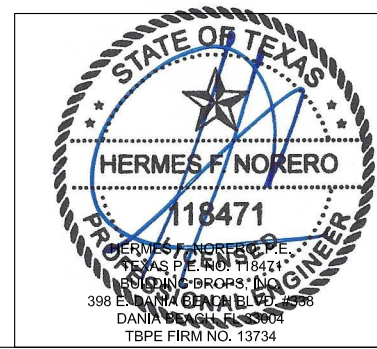

| | | | | | |
|----------------------------|------------------|--|------|---------------------|-----------------|
| BEND RADIUS | | SCHLAGE LOCK COMPANY, LLC 11819 N. PENNSYLVANIA STREET CARMEL, IN 46032 | | | |
| THIRD ANGLE PROJECTION | | TITLE: STEELCRAFT H SERIES SINGLE OUTSWING GLAZED COMMERCIAL STEEL DOORS WITH AND WITHOUT PANIC EXIT DEVICES | | | |
| DRAWN JPD | DATE 02/03/14 | HINGE OPTIONS | | | |
| CHECKED | | SIZE | FLAT | DWG NO. IRGS07-T | REV B 1-9-20 |
| APPROVED | | SCALE: | NTS | AUTOCAD | SHT 16 OF 16 |
| ENG. APPVL | | | | | |