

STEVE'S & SONS

203 Humble Ave.
San Antonio, TX 78225

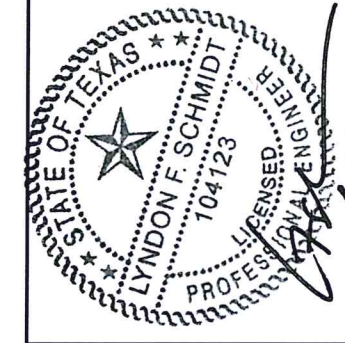

Documents Prepared By: Lyndon F. Schmidt, P.E.
TEXAS P.E. #104123

RW BUILDING CONSULTANTS, INC.
P.O. Box 230 Valrico FL 33595
Phone No.: 813.659.9197

CERTIFICATE OF REGISTRATION # F-11852

GLAZED FIBERGLASS DOUBLE DOOR "NON-IMPACT" INSWING / OUTSWING

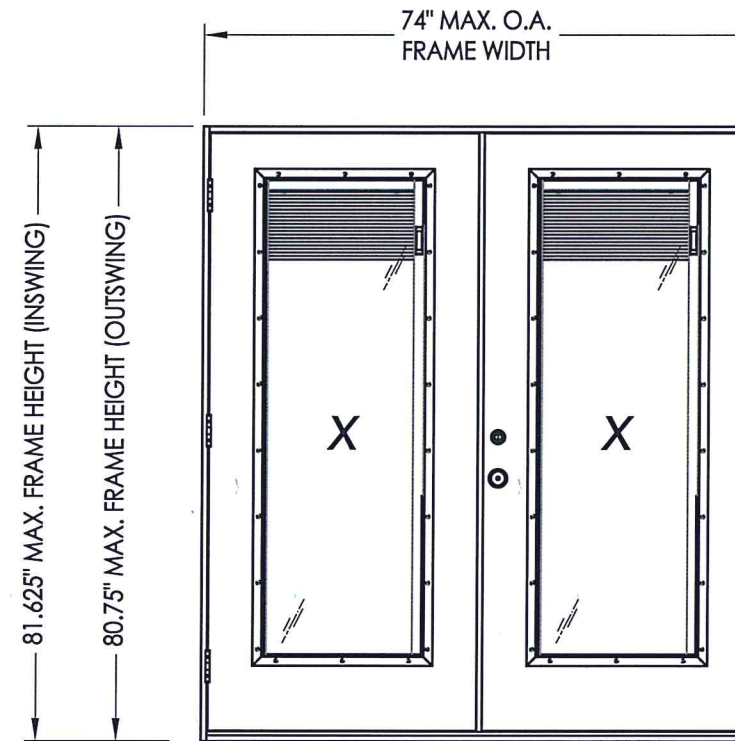

EVALUATED FOR USE IN THE STATE OF TEXAS

The Fiberglass Door system described herein complies with the 2018 International Residential Code (IRC), Sections R301 & R609 and the 2018 International Building Code (IBC), Sections 1404.13, 1609, 1709.5, 2403 and 2404 subject to the following conditions:

1. Anchors shall be as listed and spaced as shown in the details. Anchor embedment to base material shall be beyond wall dressing or stucco.
2. When used in areas requiring wind-borne debris protection this product is required to be protected with an impact resistant covering that complies with Section R301.2.1.2 of the IRC and Section 1609.1.2 of the IBC.
3. Allowable design pressure requirements must be equal to or less than the design pressure rating shown in the design pressure chart, sheet 1 of this drawing.
4. Conditions not covered by this drawing are subject to further engineering analysis.

TABLE OF CONTENTS

SHEET #	DESCRIPTION
1	Typical elevations, design pressures & general notes
2	Door panel details
3	Lite frame details
4	Elevations & horizontal cross section
5	Vertical cross sections
6	Frame anchoring
7	Bill of materials & components

CONFIGURATION	MAX. FRAME DIMENSION	ASTRAGAL	DESIGN PRESSURE (PSF) INSWING		DESIGN PRESSURE (PSF) OUTSWING	
			POSITIVE	NEGATIVE	POSITIVE	NEGATIVE
XX	74.0" x 81.625"	COLUMBIA	+40.0	-45.0	+40.0	-40.0
		WORLDWIDE	+45.0	-47.0	+45.0	-45.0

PRODUCT:	STEVE'S & SONS
PART OR ASSEMBLY:	TYPICAL ELEVATION, DESIGN PRESSURES & GENERAL NOTES
DATE	4/25/18
SCALE	N.T.S.
DWG. BY	JK
CHK. BY	LFS
DRAWING NO.	TX-4814
SHEET	1 OF 7

R:\Clients\Steves and Sons - Permanent\B - Texas Dept of Ins\Hinged Doors-Fiberglass\DR 426 Glazed Fiberglass Doors\C - Drawings\TX-4814.dwg, 2.2

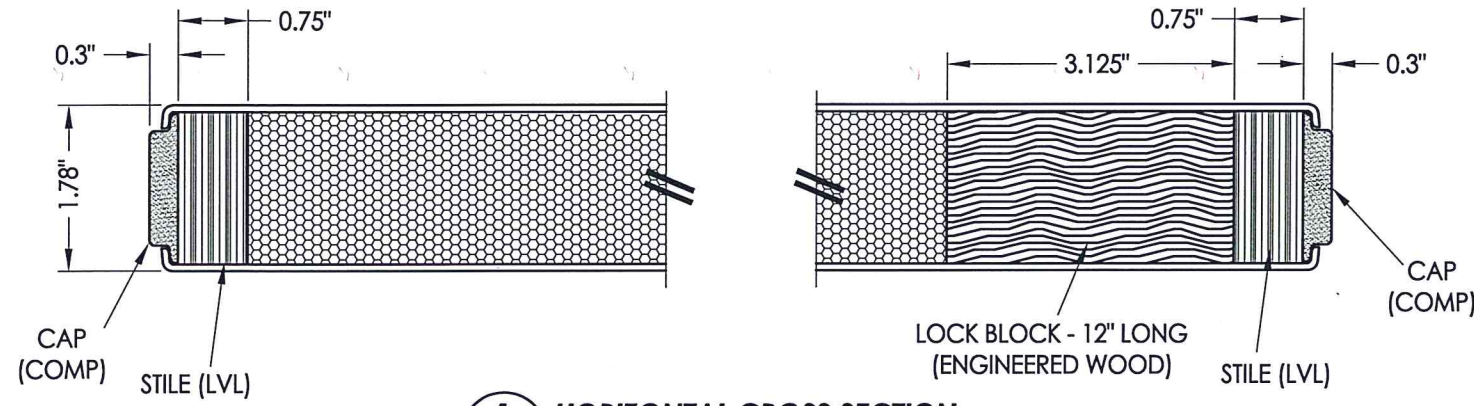

1
2 HORIZONTAL CROSS SECTION

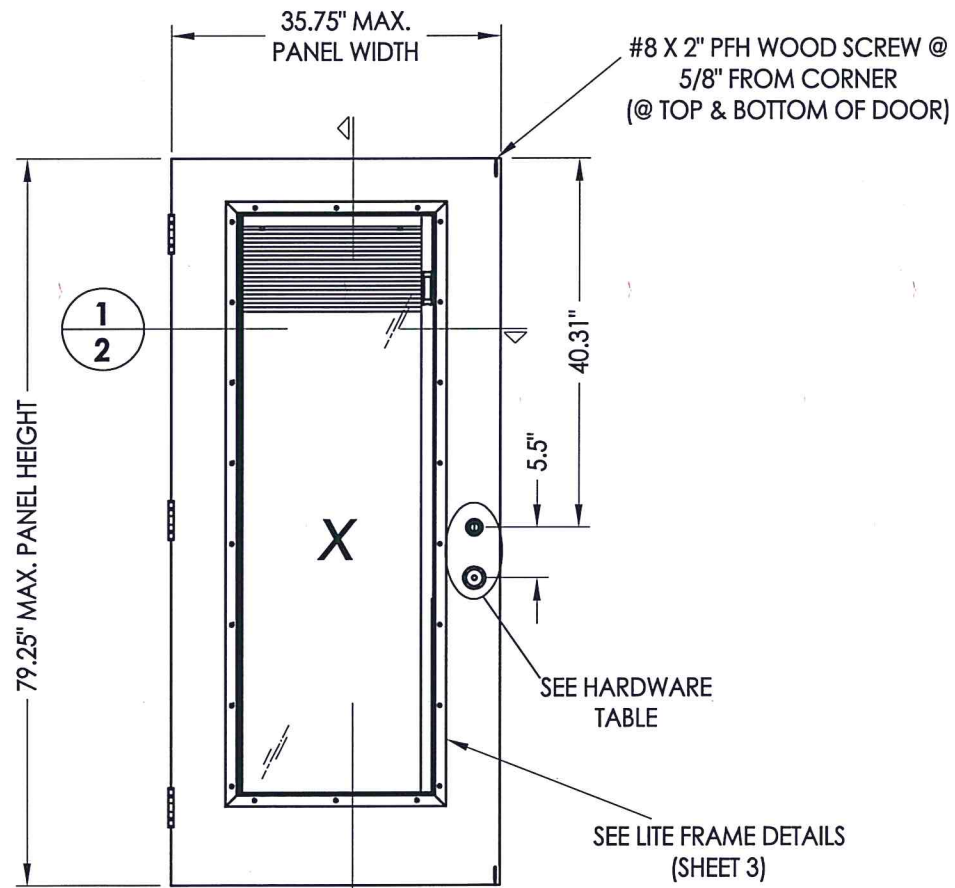

40 DOOR PANEL
Fiberglass

HARDWARE TABLE	
MANUFACTURER	MODEL
KWIKSET	KNOB: KWIKSET (GR. 2) DEADBOLT: 660 SERIES (GR. 3)

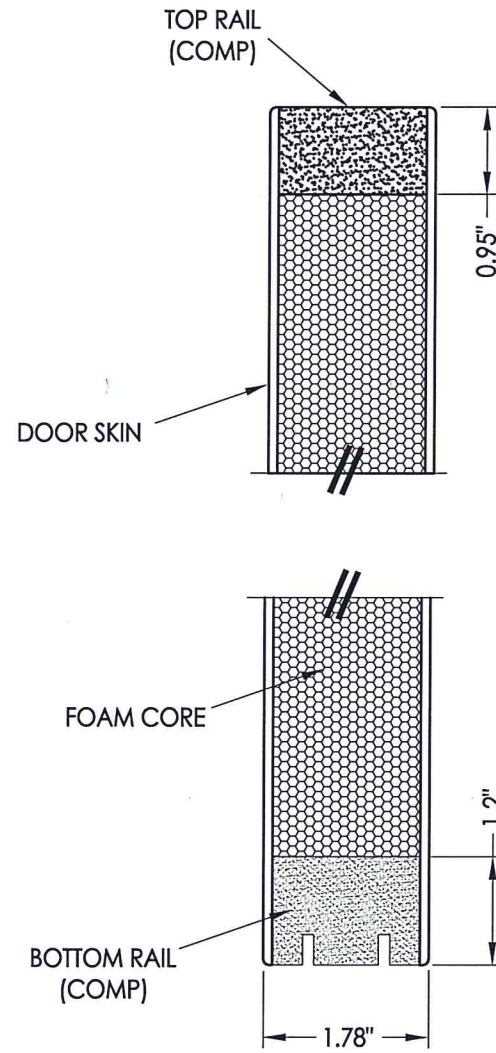

2
2 VERTICAL CROSS SECTION



Documents Prepared By: Lyndon F. Schmidt, P.E.
TEXAS P.E. #104123

RW BUILDING CONSULTANTS, INC.
P.O. Box 230 Valrico FL 33595
Phone No.: 813.659.9197

CERTIFICATE OF REGISTRATION # F-11852

PRODUCT: STEVES & SONS

PART OR ASSEMBLY:

DOOR
PANEL DETAILS

REVISIONS	
NO.	DATE
2	6/02/20
1	6/06/18

DATE: 4/25/18

SCALE: N.T.S.

DWG. BY: JK

CHK. BY: LFS

DRAWING NO.:

TX-4814

SHEET 2 OF 7

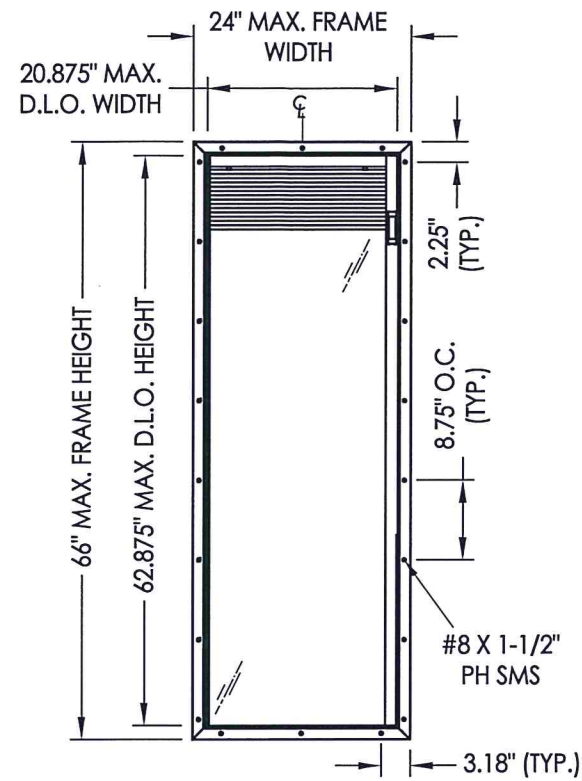

EVOLVE LITE FRAME (ODL)
(w/ BLINDS BETWEEN GLASS)

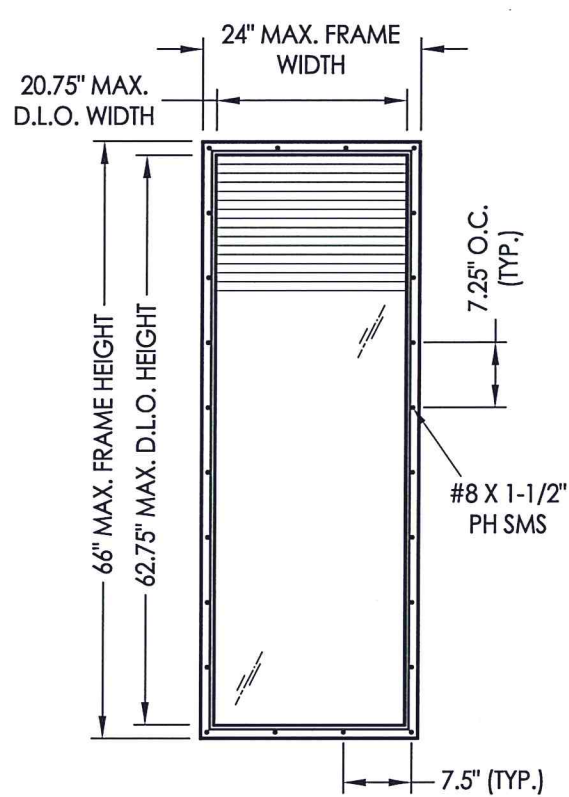

TRIMLITE FRAME
(w/ BLINDS BETWEEN GLASS)

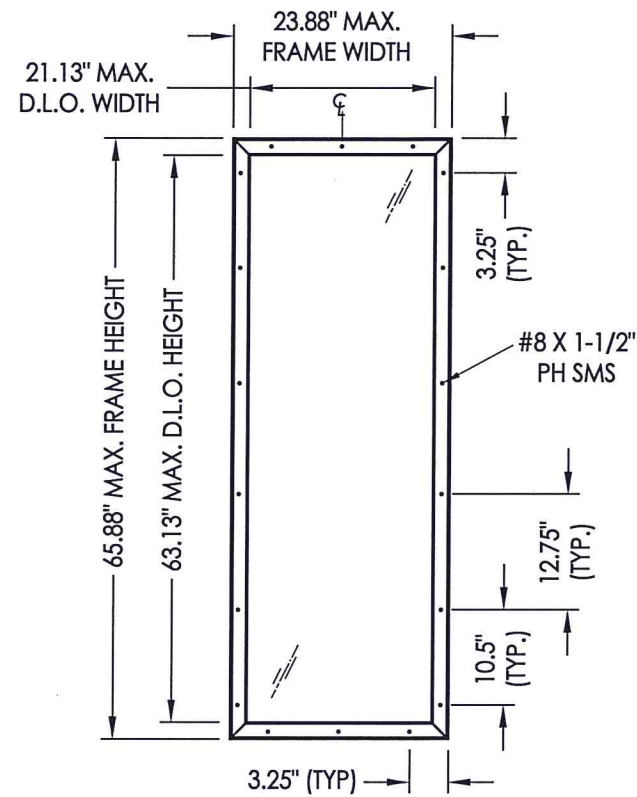

ODL LITE FRAME

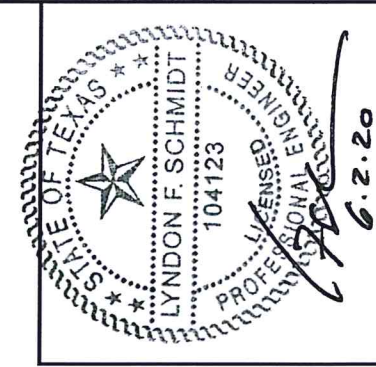

Documents Prepared By: Lyndon F. Schmidt, P.E.
TEXAS P.E. #104123

RW BUILDING CONSULTANTS, INC.
P.O. Box 230 Vairico FL, 33595
Phone No.: 813.659.9197

CERTIFICATE OF REGISTRATION # F-11852

PRODUCT: STEVES & SONS

PART OR ASSEMBLY: LITE FRAME DETAILS

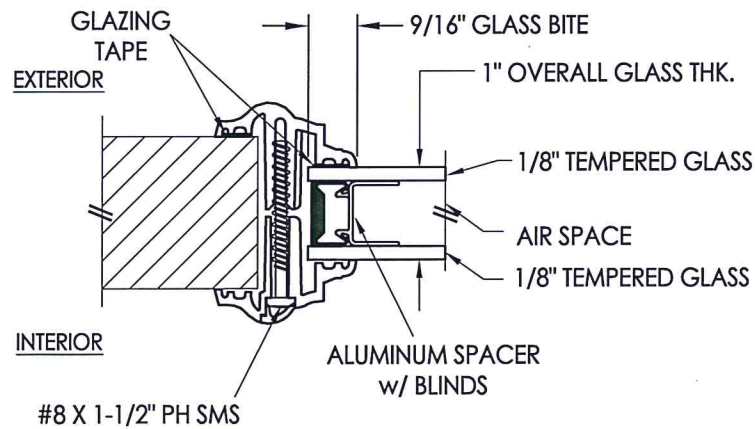

G1 GLAZING DETAIL
EVOLVE LITE FRAME

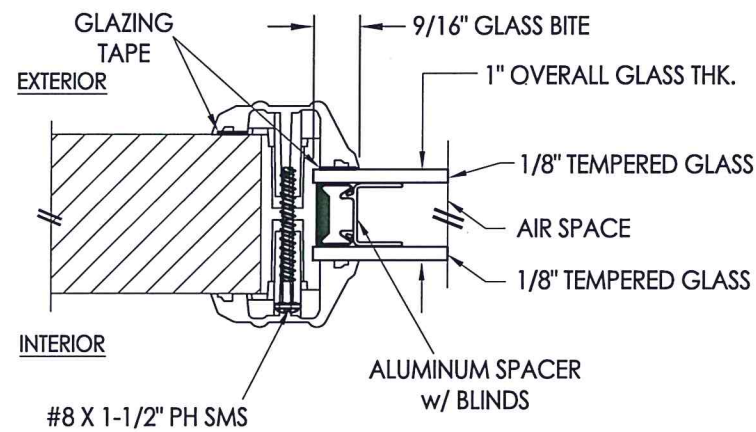

G2 GLAZING DETAIL
TRIMLITE FRAME

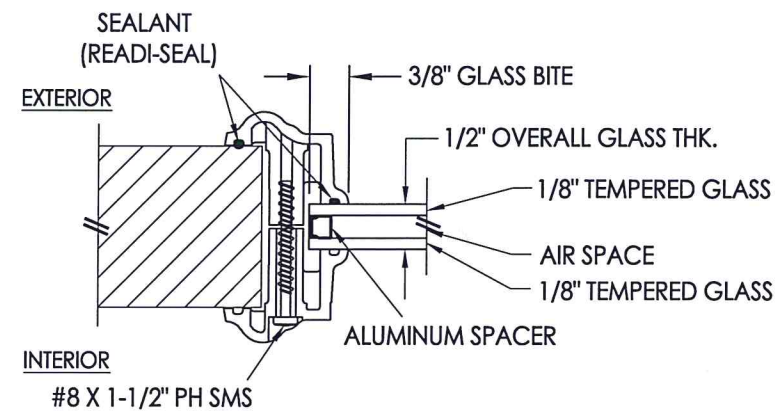

G3 GLAZING DETAIL
ODL LITE FRAME

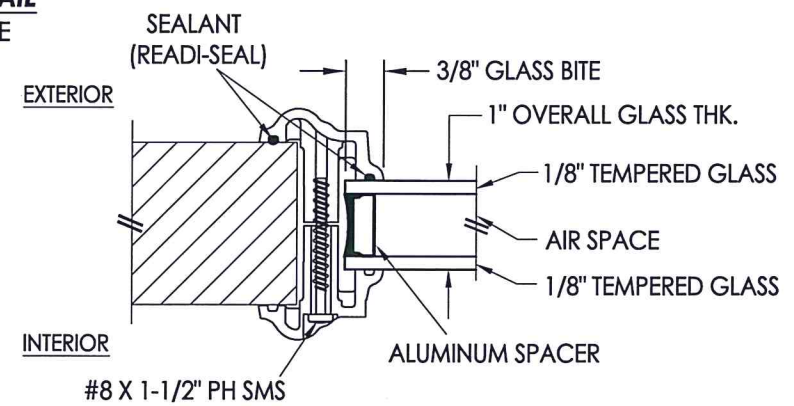

G4 GLAZING DETAIL
ODL LITE FRAME

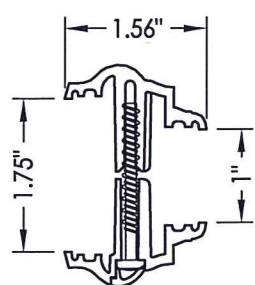

EVOLVE LITE FRAME (1\"/>

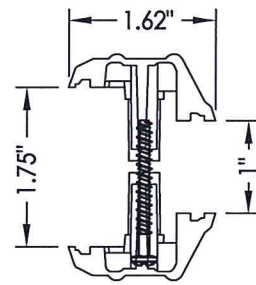

TRIMLITE FRAME (1\"/>

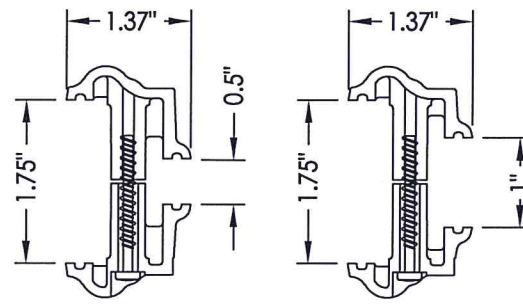

ODL LITE FRAME (1/2\"/>

REVISIONS	
NO.	DATE
2	6/02/20 UPDATE TO 2018 IBC/IRC CODE
1	6/06/18 CLARIFIED LOCK HARDWARE
	LFS
	BY

DATE: 4/25/18
SCALE: N.T.S.
DWG. BY: JK
CHK. BY: LFS
DRAWING NO.: TX-4814
SHEET 3 OF 7

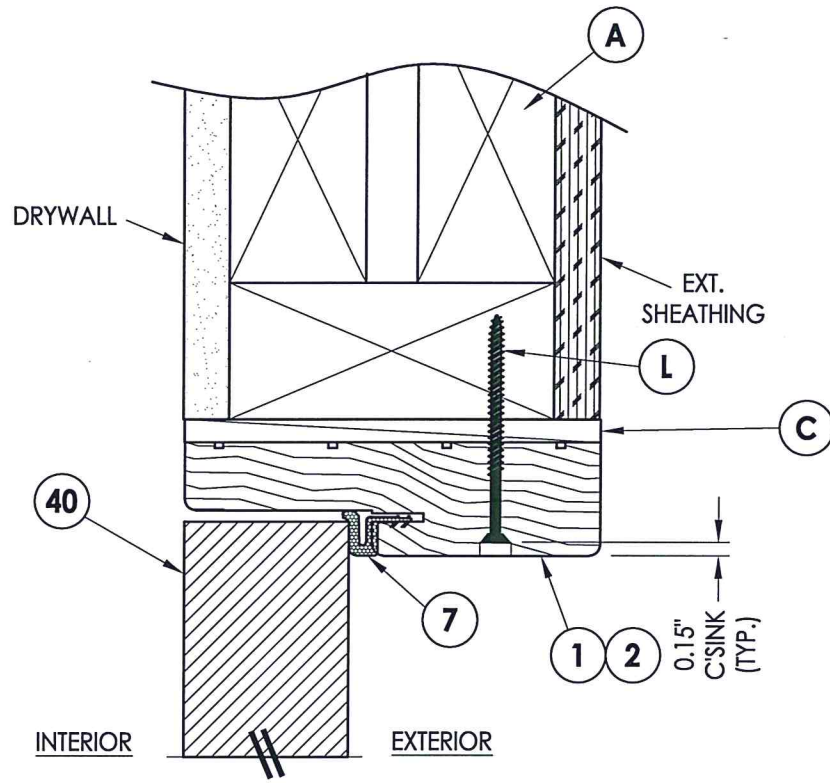

1 VERTICAL CROSS SECTION
5 Inswing shown (Outswing similar)

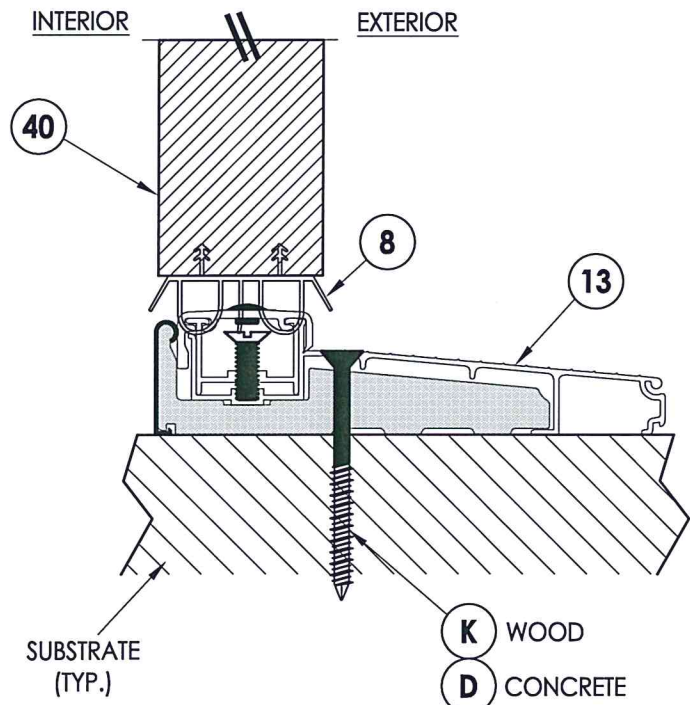

2 VERTICAL CROSS SECTION
5 Inswing sill

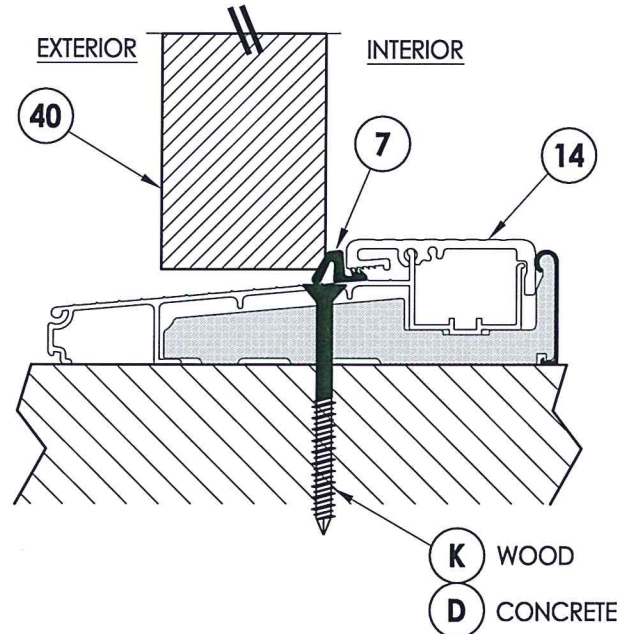

3 VERTICAL CROSS SECTION
5 Outswing Sill

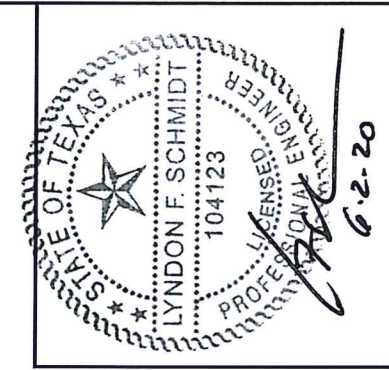

Documents Prepared By: Lyndon F. Schmidt, P.E.
 TEXAS P.E. #104123

RW BUILDING CONSULTANTS, INC.
 P.O. Box 230 Valrico FL 33595
 Phone No.: 813.659.9197

CERTIFICATE OF REGISTRATION # F-11852

PRODUCT: STEVES & SONS

PART OR ASSEMBLY:
 VERTICAL CROSS SECTIONS

NO.	DATE	REVISIONS	BY
2	6/02/20	UPDATE TO 2018 IBC/IRC CODE	LFS
1	6/05/18	CLARIFIED LOCK HARDWARE	LFS

DATE: 4/25/18

SCALE: N.T.S.

DWG. BY: JK

CHK. BY: LFS

DRAWING NO.:
 TX-4814

SHEET 5 OF 7

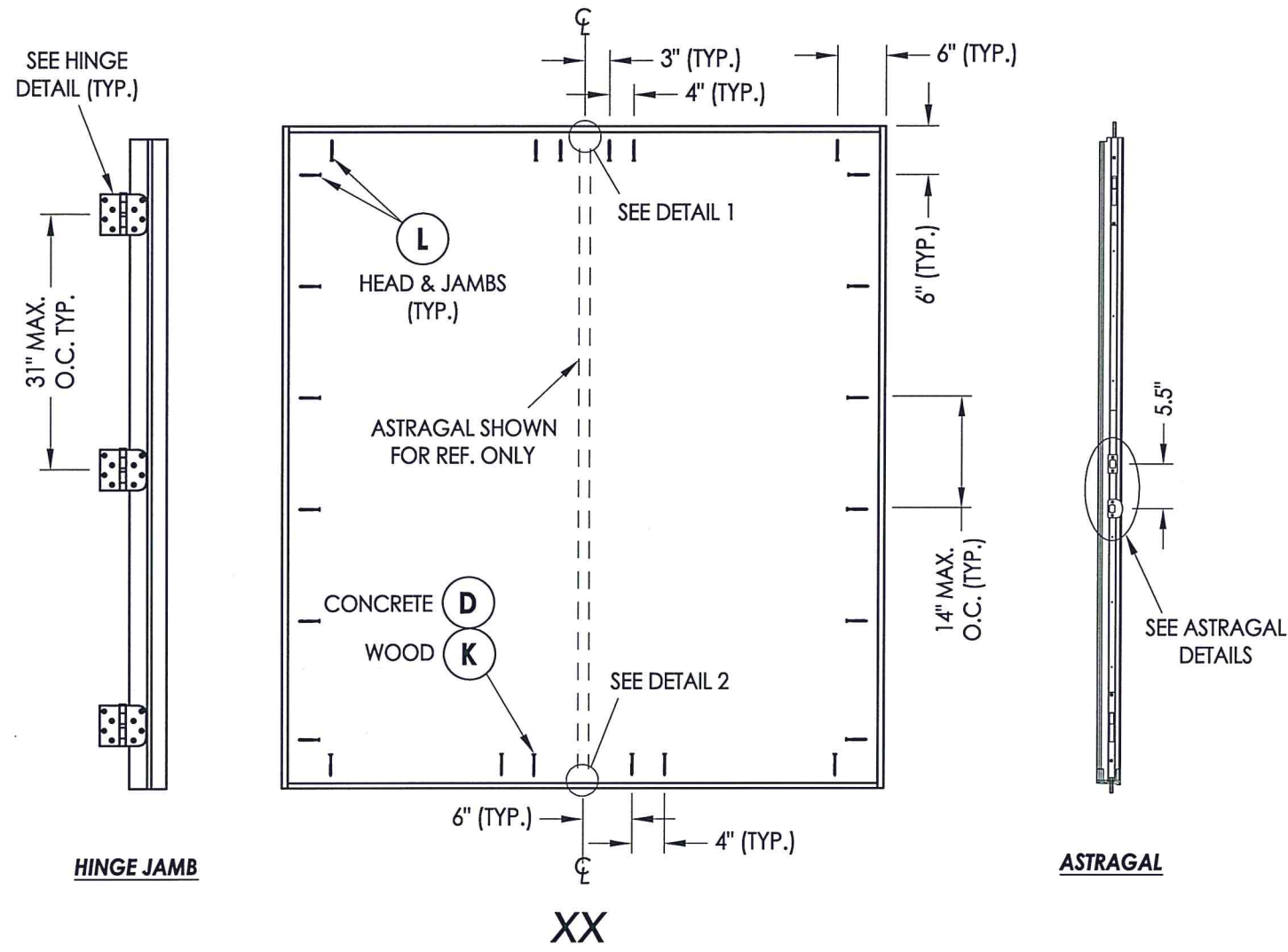

FRAME ANCHORING

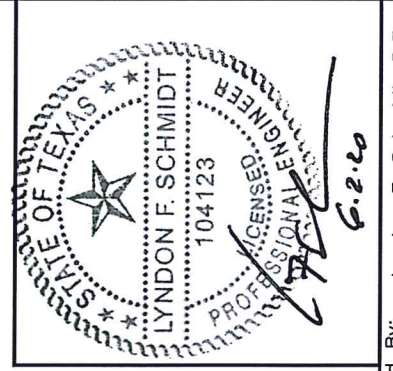
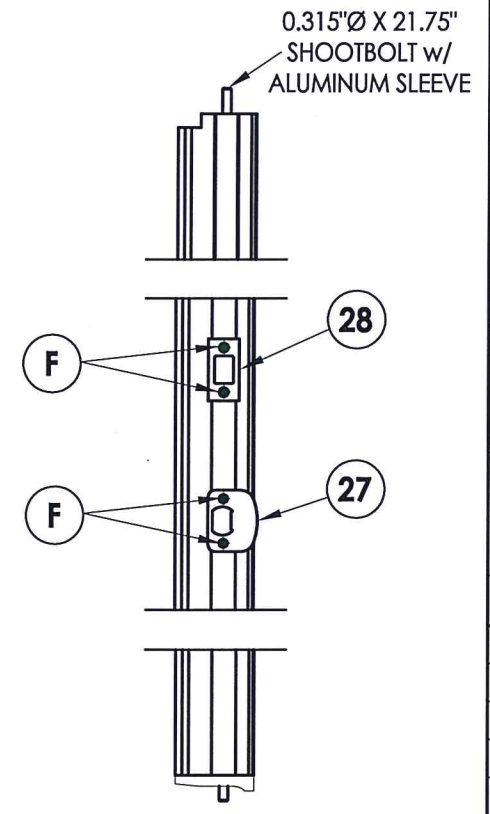
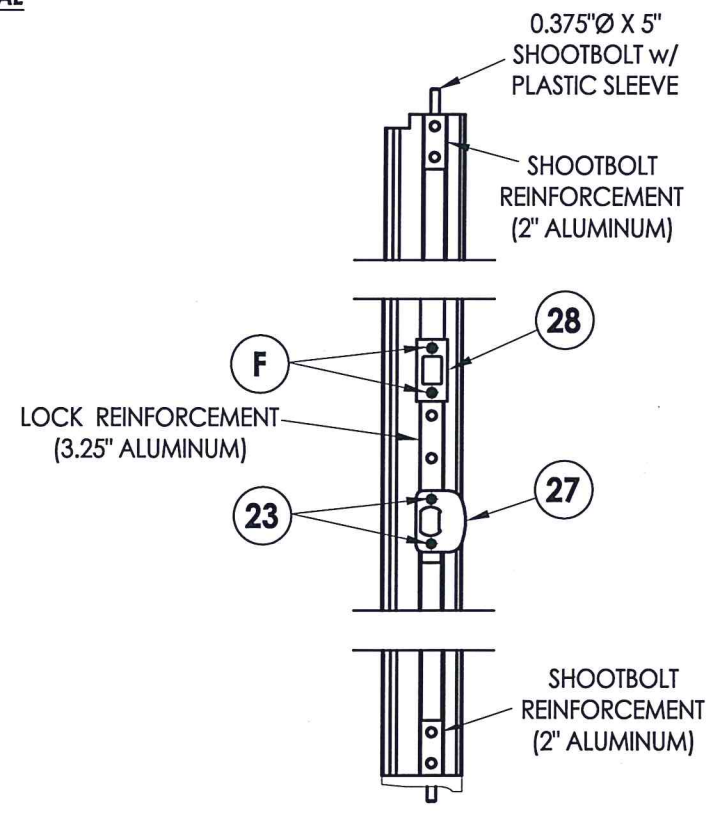
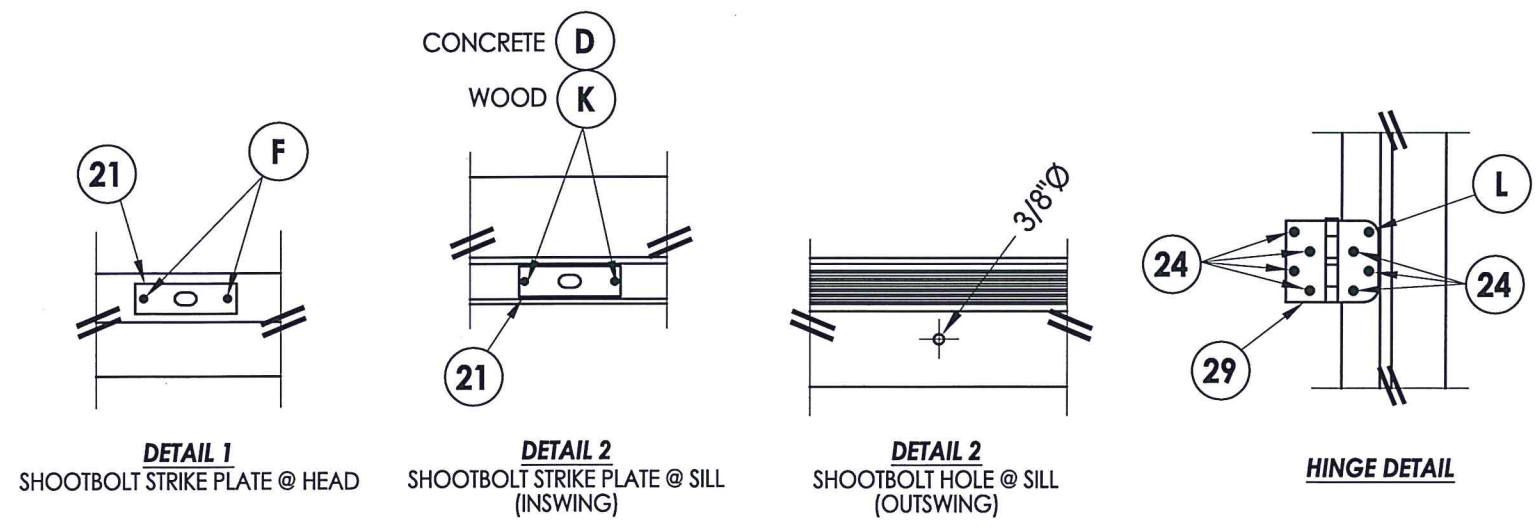

Documents Prepared By: Lyndon F. Schmidt, P.E.
TEXAS P.E. #104123

RW BUILDING CONSULTANTS, INC.
P.O. Box 230 Valrico FL 33595
Phone No.: 813.659.9197

CERTIFICATE OF REGISTRATION # F-11852

PRODUCT:	STEVES & SONS
PART OR ASSEMBLY:	FRAME ANCHORING

NO.	DATE	BY	REVISIONS
2	6/02/20	LFS	UPDATE TO 2018 IBC/IRC CODE
1	6/06/18	LFS	CLARIFIED LOCK HARDWARE

DATE:	4/25/18
SCALE:	N.T.S.
DWG. BY:	JK
CHK. BY:	LFS
DRAWING NO.:	TX-4814
SHEET	6 OF 7

BILL OF MATERIALS		
ITEM #	DESCRIPTION	MATERIAL
A	2X FRAMING (SG >= 0.42)	WOOD
C	1/4" MAX. SHIM SPACE	-
D	1/4" Ø PFH ELCO OR ITW CONCRETE SCREW (1-3/4" MIN. EMBEDMENT)	STEEL
F	#8 X 2-1/2" PFH WS	STEEL
K	#10 PFH WS (1-3/4" MIN. EMBEDMENT)	STEEL
L	#10 X 2-1/2" PFH WS (1.15" MIN. EMBEDMENT)	STEEL
1	WOOD JAMB (FINGER-JOINT PINE - SG >= 0.42)	WOOD
2	COMPOSITE JAMB (WORLDWIDE 4EVER JAMB)	COMP
7	WEATHERSTRIP (Q-LON)	FOAM
8	DOOR BOTTOM SWEEP	PVC
11	#8 X 1" PH SMS	STEEL
13	INSWING ADJUSTABLE THRESHOLD	ALUM/ COMP
14	OUTSWING BUMP THRESHOLD	ALUM/ COMP
19	ASTRAGAL (COLUMBIA)	ALUM
20	ASTRAGAL (WORLDWIDE)	ALUM
21	SHOOTBOLT STRIKE PLATE	STEEL
23	10-24 X 3/8" FH MACHINE SCREW	STEEL
24	#10 X 1" PFH WS	STEEL
27	LATCH STRIKE PLATE	STEEL
28	DEADBOLT STRIKE PLATE	STEEL
29	4" X 4" HINGE	STEEL
40	DOOR PANEL	-

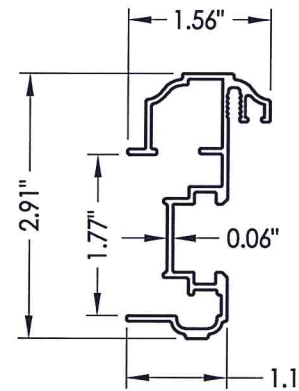
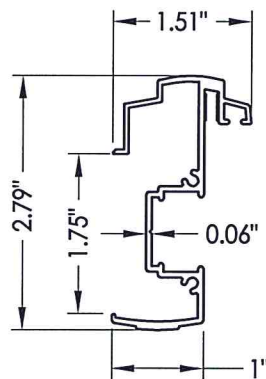
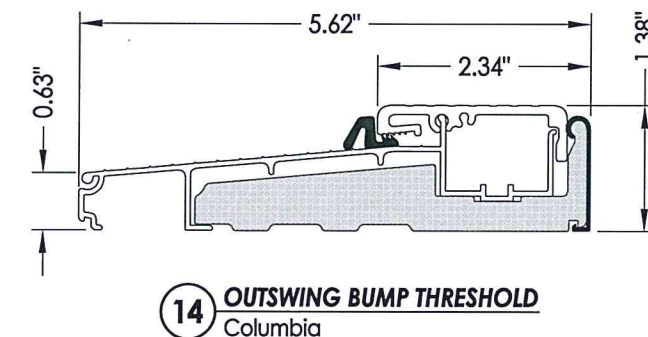
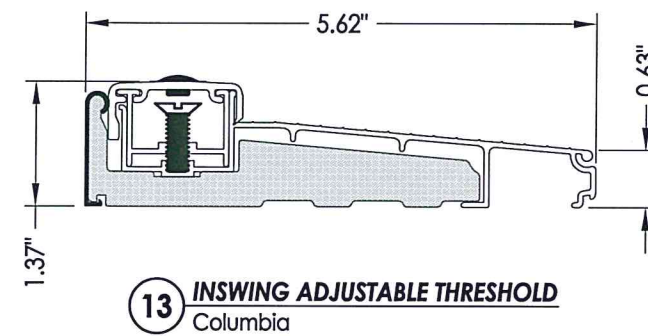
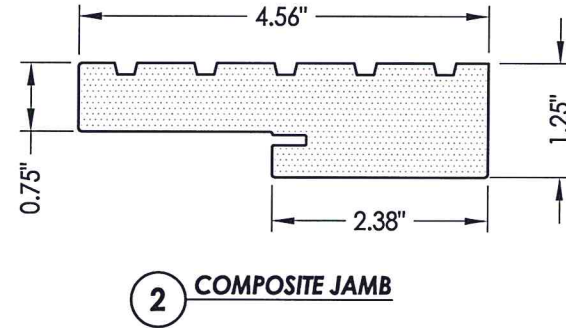
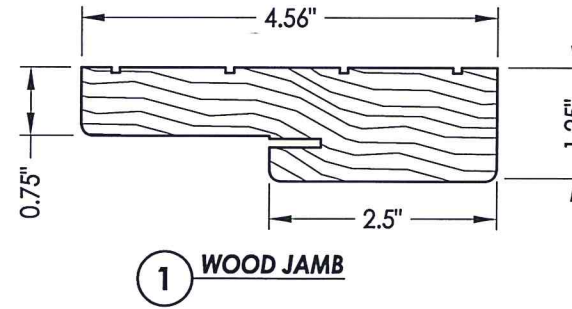

CONCRETE ANCHOR NOTES:

- Concrete anchor locations at the corners may be adjusted to maintain the min. edge distance to mortar joints.
- Concrete anchor locations noted as "MAX. ON CENTER" must be adjusted to maintain the min. edge distance to mortar joints, additional concrete anchors may be required to ensure the "MAX. ON CENTER" dimension are not exceeded.
- Concrete anchor table:

ANCHOR TYPE	ANCHOR SIZE	MIN. EMBEDMENT	MIN. CLEARANCE TO MASONRY EDGE	MIN. CLEARANCE TO ADJACENT ANCHOR
ITW TAPCON®	1/4"	1-3/4"	2"	4"
ELCO ULTRACON®	1/4"	1-3/4"	1"	4"

WOOD SCREW INSTALLATION NOTES:

- Maintain a minimum 5/8" edge distance, 1" end distance, & 1" o.c. spacing of wood screws to prevent the splitting of wood.

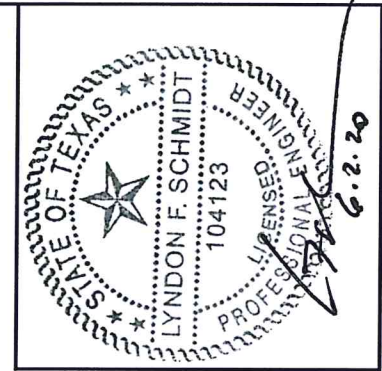

Documents Prepared By: Lyndon F. Schmidt, P.E.
TEXAS P.E. #104123

RW BUILDING CONSULTANTS, INC.
P.O. Box 230 Valrico FL, 33595
Phone No.: 813.659.9197

CERTIFICATE OF REGISTRATION # F-11852

PRODUCT: STEVES & SONS

PART OR ASSEMBLY:
BILL OF MATERIALS & COMPONENTS

NO.	DATE	REVISIONS
1	6/06/18	CLARIFIED LOCK HARDWARE
2	6/02/20	UPDATE TO 2018 IBC/IRC CODE
LFS		
LFS		
BY		

DATE: 4/25/18

SCALE: N.T.S.

DWG. BY: JK

CHK. BY: LFS

DRAWING NO.: TX-4814

SHEET 7 OF 7