

5400/5400S/7700/9900 SGD (OXXXXO)  
 Maximum Size: 205" x 96"  
 Design Pressure: +35/-45 psf

**FIN INSTALLATIONS**

**NOTES:**

1. Installations depicted satisfy the requirements of the 2018 International Building Code for design wind pressures and overall sizes noted.
2. Wood bucks, wood framing, steel stud framing, concrete and concrete masonry are by others and shall be designed by the architect or engineer of record to resist the loads imparted to them.
3. Wood buck strips and wood frames are assumed S-P-F (G=0.42) or denser. Buck width shall be greater than the frame width. Tapered or partial width buck strips are not allowed.
4. Concrete masonry installations are assumed at least ASTM C90 normal weight hollow masonry units with a 1-1/4" wall thickness or normal weight concrete with a minimum compressive strength of  $f'c = 3,000$  psi.
5. Metal stud frames are assumed to be a minimum 18 gauge 33 KSI steel.
6. Wood screws shall be corrosion resistant and meet the requirements of ANSI/ASME B18.6.1
7. Tapcon masonry anchors shall have a minimum embedment of 1-1/2" or full penetration of concrete masonry unit shell. They shall also have a minimum of 2" edge distance. Install concrete masonry anchors per manufacturer's installation instructions.
8. TEKS screws shall be corrosion resistant and shall be ASTM A510 Grade 1018 or equivalent.
9. Maximum permitted shim thickness is 1/4". Shims shall be non-compressible and load bearing type. Every through-frame fastener shall have a shim.
10. Products are not impact resistant and require approved protection devices if used in wind-borne debris regions.

**CONTENTS:**

Sheets 1-3	Elevations and Notes
Sheet 4	Fin Install to Wood
Sheet 5	Fin Install to Steel Stud
Sheet 6	Frame Install to Wood
Sheet 7	Frame Install to Steel Stud
Sheets 8-9	Frame Install to Concrete or CMU
Sheet 10	Strap Install to Wood
Sheet 11	Strap Install to Steel Stud
Sheets 12-13	Strap Install to Concrete or CMU
Sheet 14	Glazing Detail
Sheet 15	Accessories
Sheets 16-17	Sections and BOM
Sheet 18	Components

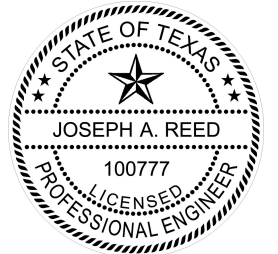

Joseph A. Reed, PE  
 TX PE 100777  
 5 Leigh Dr.  
 York, PA 17406  
 717-846-1200  
 Project 23550-1

*Joseph A. Reed*

2020.10.12 07:30:54 -04'00'

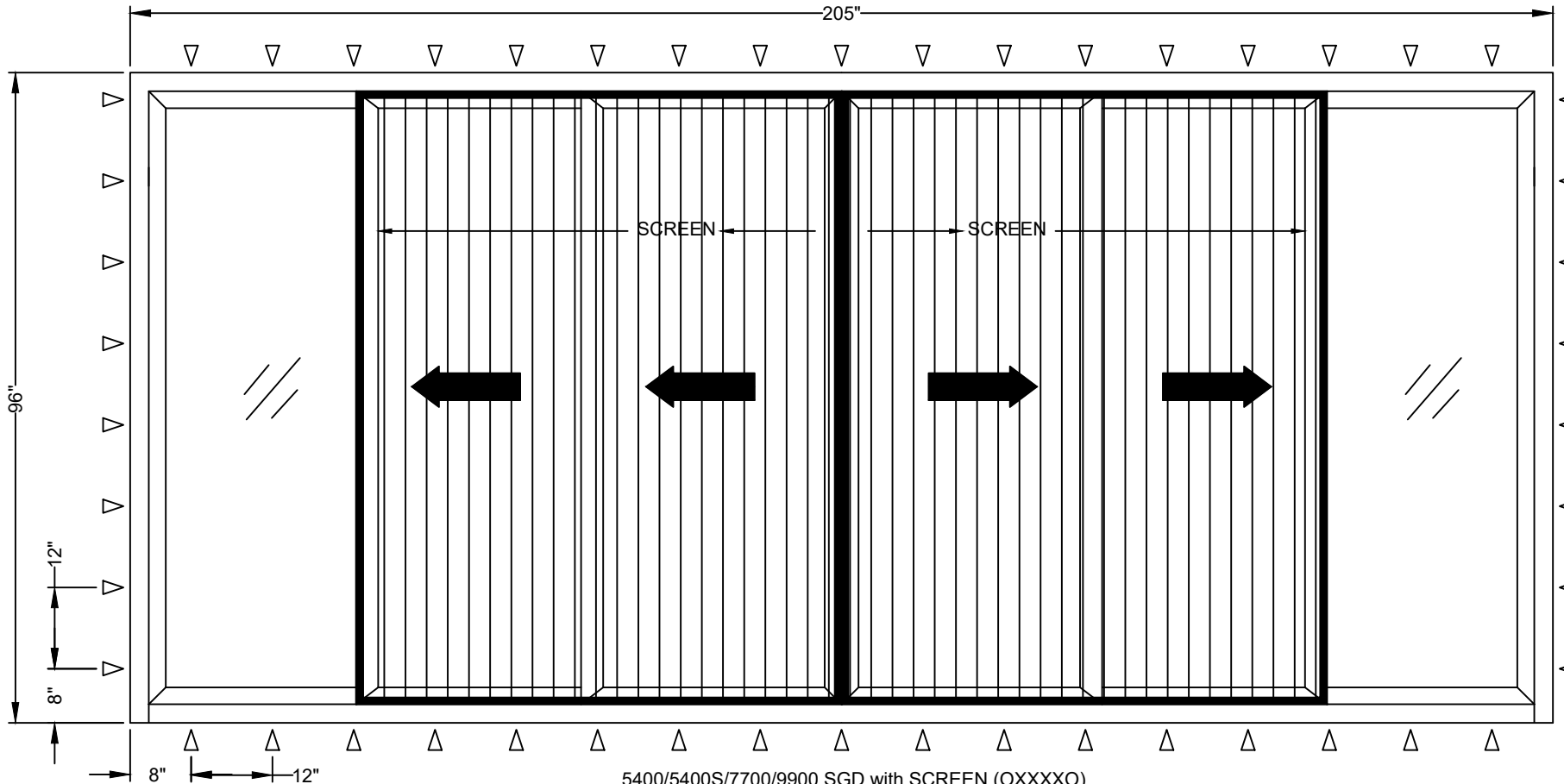

5400/5400S/7700/9900 SGD with SCREEN (OXXXXO)  
 Maximum Size: 205" x 96"  
 Design Pressure: +25/-45 psf

△ FIN ANCHOR - SEE SHEET 4 TO SHEET 5

FOR 205" X 96" DOORS  
 PANEL SIZE: 35-7/8" X 91-1/8"  
 DLO: 29" X 84-5/8"  
 GLAZING: INS. GLASS; TWO (2) 1/8" TEMPERED GLASS  
 OR  
 INS GLASS; 1/8" TEMPERED GLASS (EXTERIOR)  
 (2) 1/8" ANNEALED GLASS 0.030"  
 PVB (INTERIOR)

<b>5400/5400S/7700/9900 SGD</b>	
<b>Non-Impact</b>	
<b>Elevations and Notes</b>	
<b>Wincore Windows &amp; Doors</b>	
250 Staunton Turnpike Parkersburg, WV 26104	
Drawing No.: 23550-9-1001	
Project No.: 23550-9	
Drawn By: JAR	Rev: - Date: 10/10/20
Scale: NTS	Sheet 1 of 18

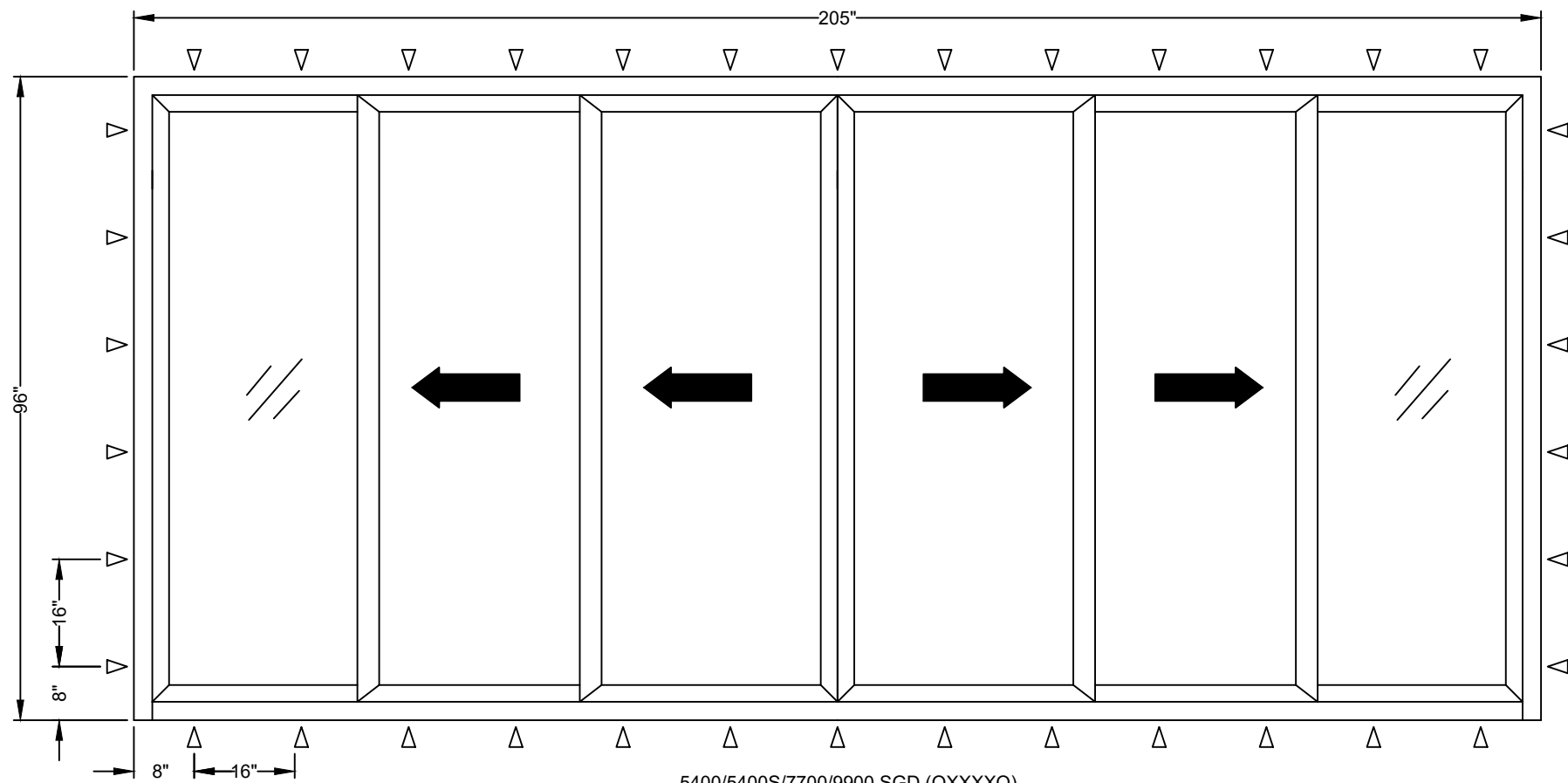

FOR 205" X 96" DOORS  
 PANEL SIZE: 35-7/8" X 91-1/8"  
 DLO: 29" X 84-5/8"  
 GLAZING: INSULATING GLASS; TWO (2) 1/8" TEMPERED GLASS  
 OR  
 INSULATING GLASS; 1/8" TEMPERED GLASS (EXTERIOR)  
 (2) 1/8" ANNEALED GLASS 0.030"  
 PVB (INTERIOR)

5400/5400S/7700/9900 SGD (OXXXXO)  
 Maximum Size: 205" x 96"  
 Design Pressure: +35/-45 psf

**FRAME OR STRAP INSTALLATIONS**

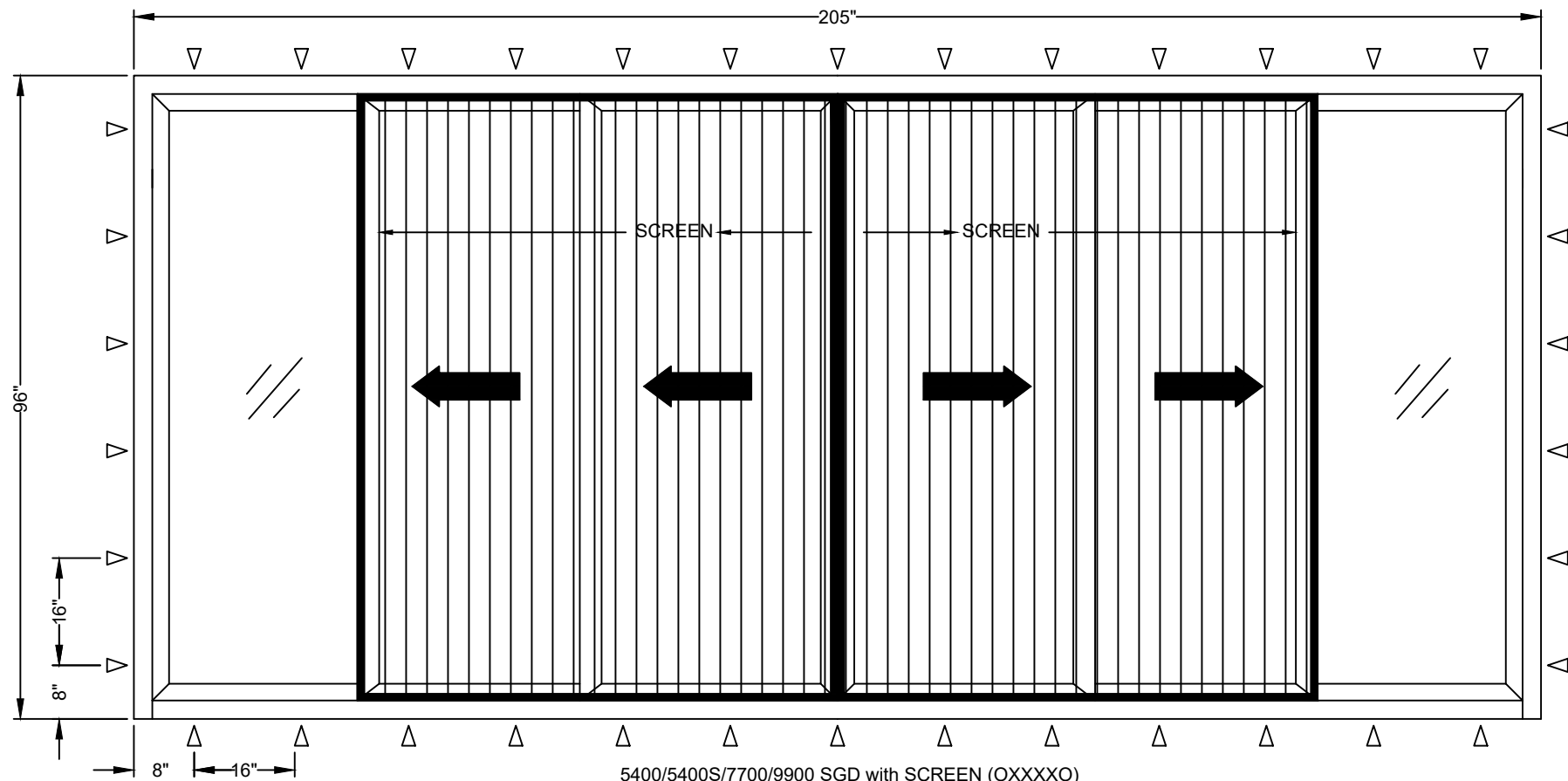

5400/5400S/7700/9900 SGD with SCREEN (OXXXXO)  
 Maximum Size: 205" x 96"  
 Design Pressure: +25/-45 psf

△ FRAME OR STRAP ANCHOR - SEE SHEET 6 TO SHEET 13

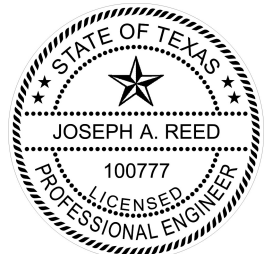

Joseph A. Reed, PE  
 TX PE 100777  
 5 Leigh Dr.  
 York, PA 17406  
 717-846-1200  
 Project 23550-1

*Joseph A. Reed*

2020.10.12 07:30:54 -04'00'

<b>5400/5400S/7700/9900 SGD</b>	
<b>Non-Impact</b>	
Elevations and Notes	
<b>Wincore Windows &amp; Doors</b>	
250 Staunton Turnpike Parkersburg, WV 26104	
Drawing No.: 23550-9-1001	
Project No.: 23550-9	
Drawn By: JAR	Rev: - Date: 10/10/20
Scale: NTS	Sheet 2 of 18

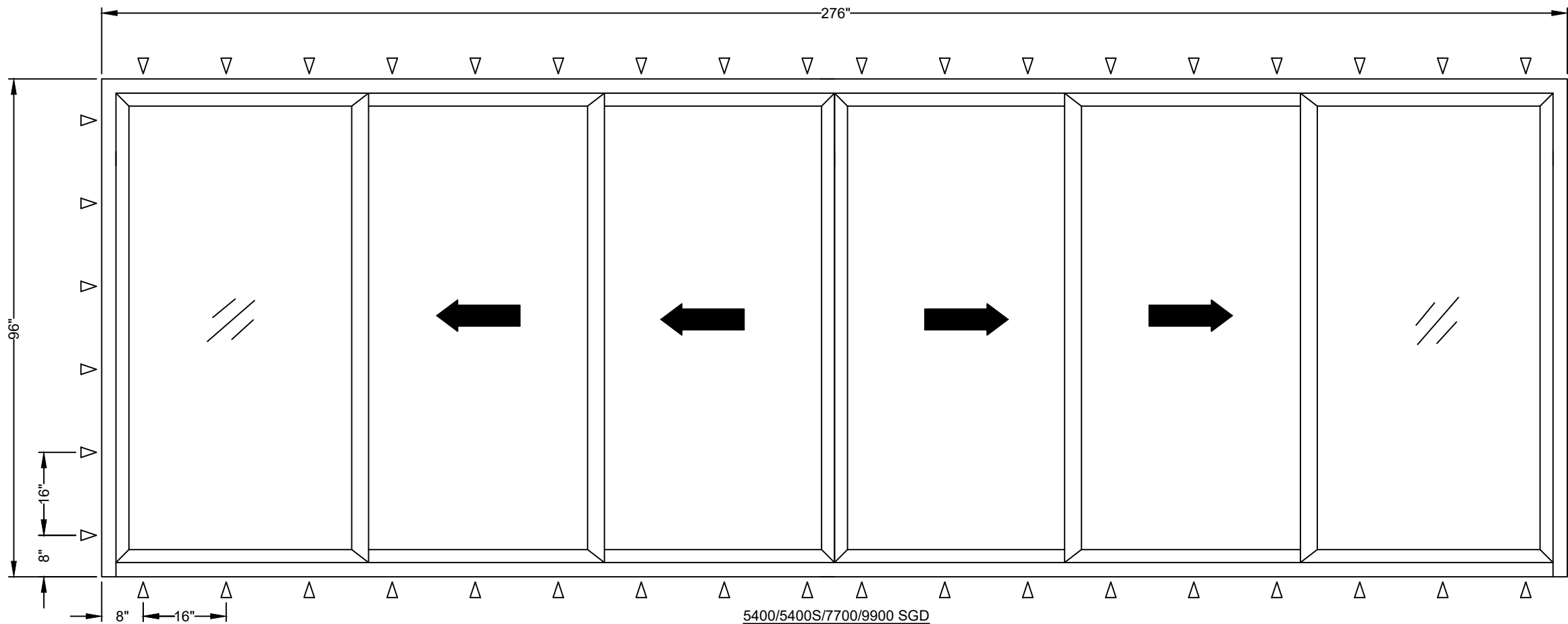

5400/5400S/7700/9900 SGD  
(OXXXXO)  
Maximum Size: 276" x 96"  
Design Pressure: +30/-30 psf

**ALL INSTALLATIONS**

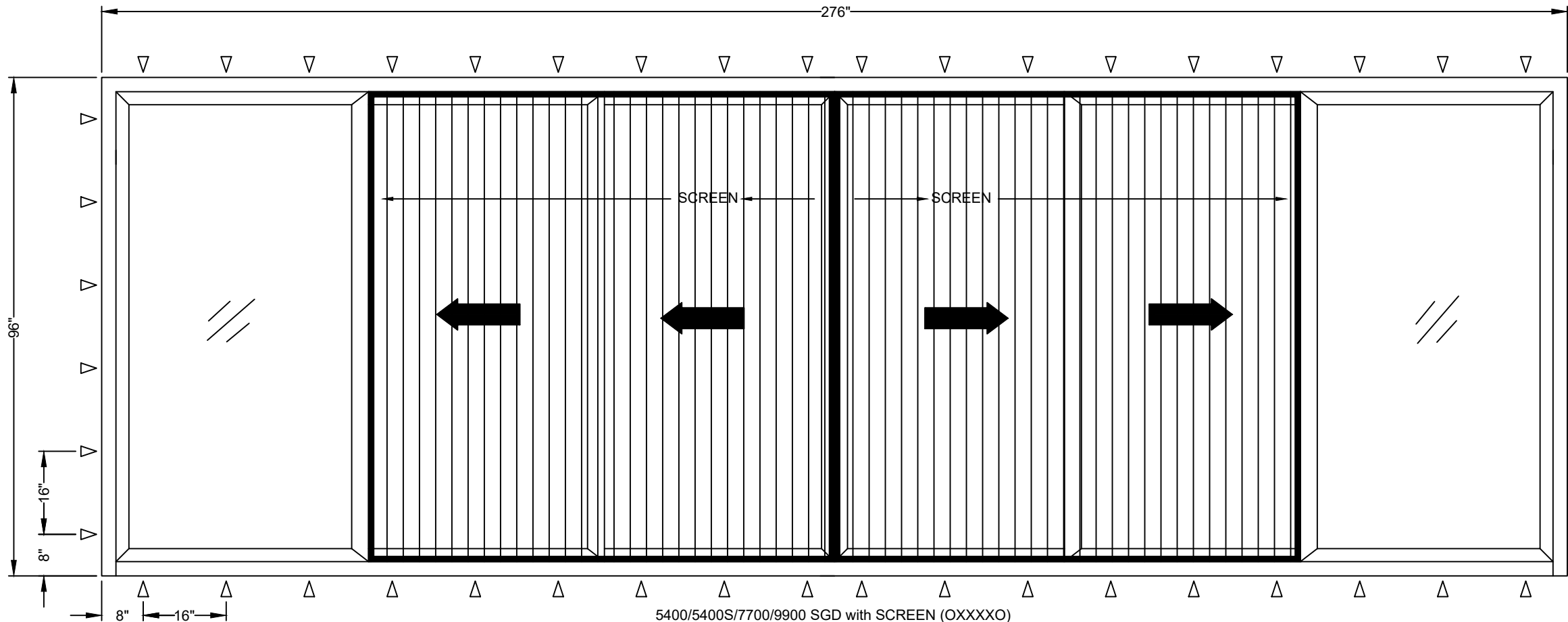

5400/5400S/7700/9900 SGD with SCREEN (OXXXXO)  
Maximum Size: 276" x 96"  
Design Pressure: +15/-30 psf

△ ANCHOR - SEE SHEET 4 TO SHEET 13

FOR 276" X 96" DOORS  
 PANEL SIZE: 47-1/2" X 91-1/8"  
 DLO: 41" X 84-5/8"  
 GLAZING: INSULATING GLASS; TWO (2) 1/8" TEMPERED GLASS  
 OR  
 INSULATING GLASS; 1/8" TEMPERED GLASS (EXTERIOR)  
 (2) 1/8" ANNEALED GLASS 0.030"  
 PVB (INTERIOR)

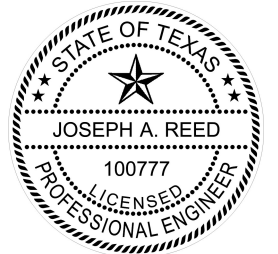

Joseph A. Reed, PE  
 TX PE 100777  
 5 Leigh Dr.  
 York, PA 17406  
 717-846-1200  
 Project 23550-1

*Joseph A. Reed*

2020.10.12 07:30:54 -04'00'

<b>5400/5400S/7700/9900 SGD</b>	
<b>Non-Impact</b>	
Elevations and Notes	
<b>Wincore Windows &amp; Doors</b>	
250 Staunton Turnpike Parkersburg, WV 26104	
Drawing No.: 23550-9-1001	
Project No.: 23550-9	
Drawn By: JAR	Rev: - Date: 10/10/20
Scale: NTS	Sheet 3 of 18

# HEAD

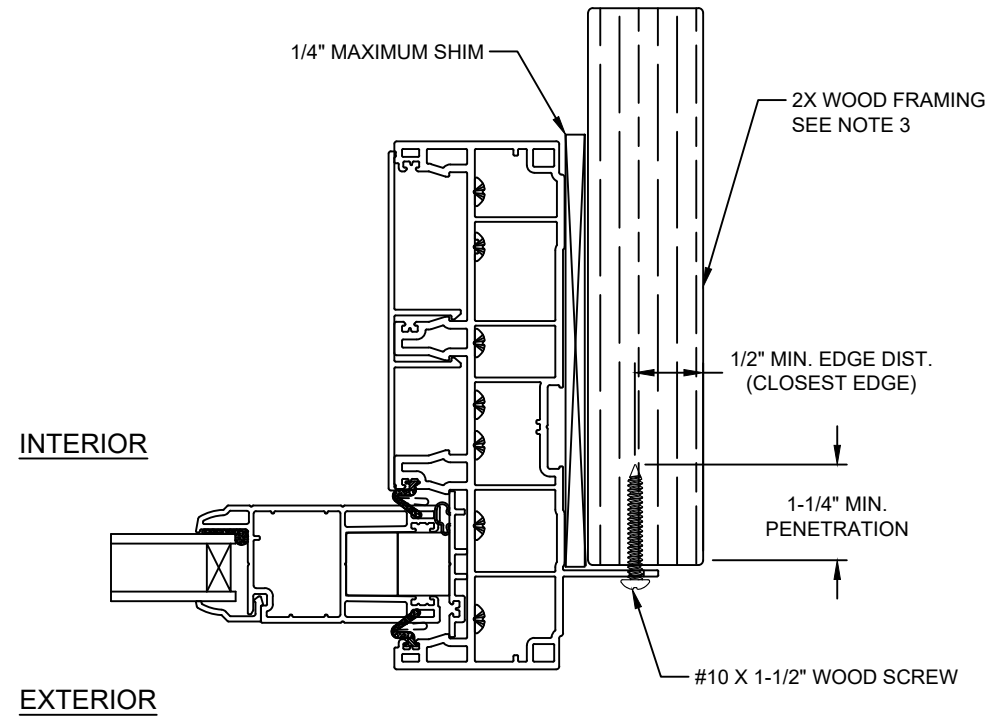
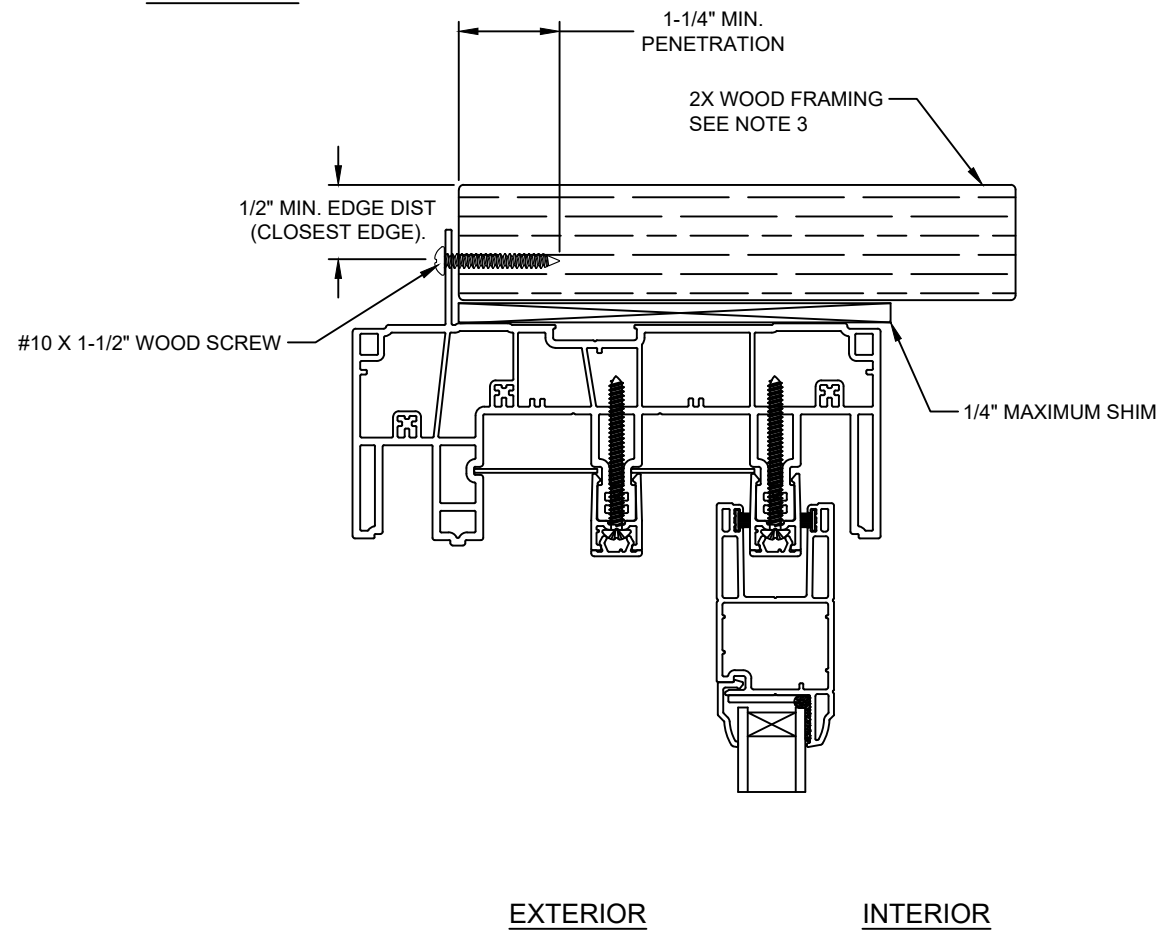

# JAMB

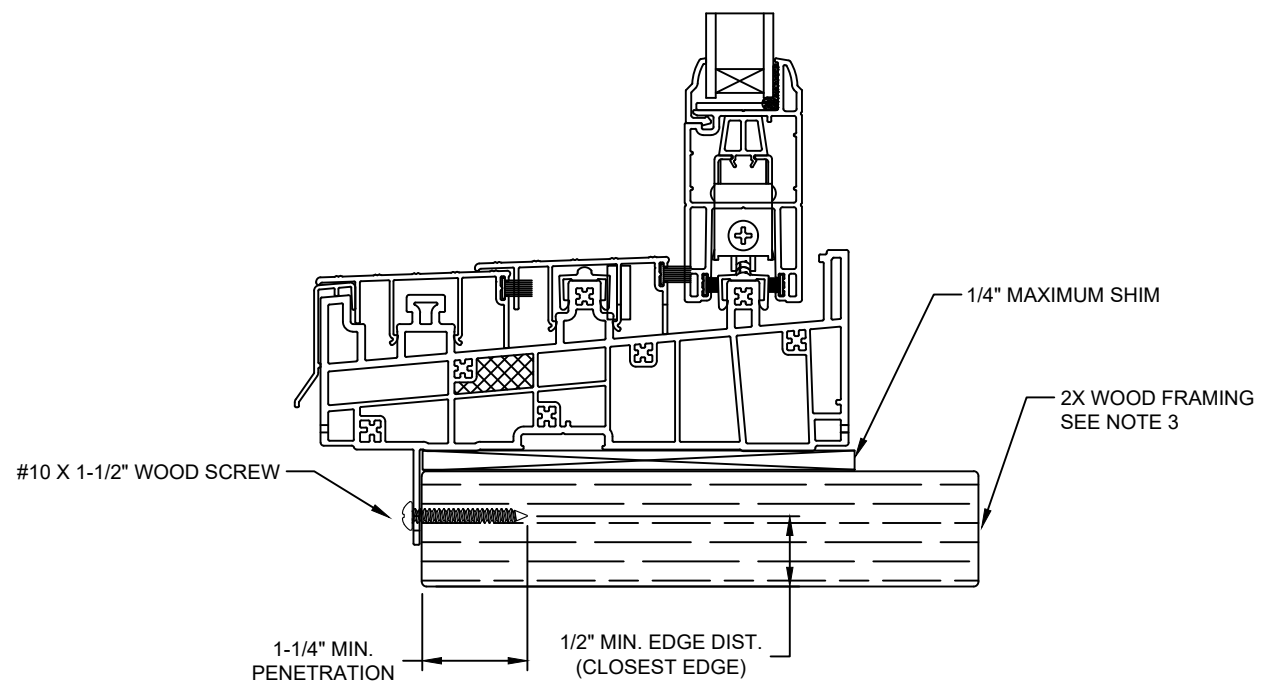

# SILL

NOTE:  
 IF SILL INSTALLED FINLESS TO WOOD, SEE SHEETS 6 AND 10  
 IF SILL INSTALLED FINLESS TO STEEL STUD, SEE SHEETS 7 AND 11  
 IF SILL INSTALLED FINLESS TO CONCRETE, SEE SHEETS 8, 9, 12 AND 13

Note:  
 Waterproofing and interior finishes by others. Not shown for clarity.

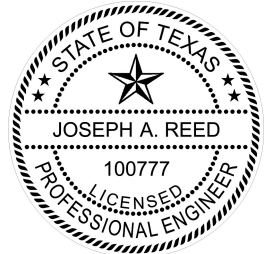

Joseph A. Reed, PE  
 TX PE 100777  
 5 Leigh Dr.  
 York, PA 17406  
 717-846-1200  
 Project 23550-1

*Joseph A. Reed*

2020.10.12 07:30:54 -04'00'

<b>5400/5400S/7700/9900 SGD</b> <b>Non-Impact</b> Fin Install to Wood	
<b>Wincore Windows &amp; Doors</b> 250 Staunton Turnpike Parkersburg, WV 26104	
Drawing No.: 23550-9-1001 Project No.: 23550-9 Drawn By: JAR    Rev: -    Date: 10/10/20	
Scale: NTS	Sheet 4 of 18

# HEAD

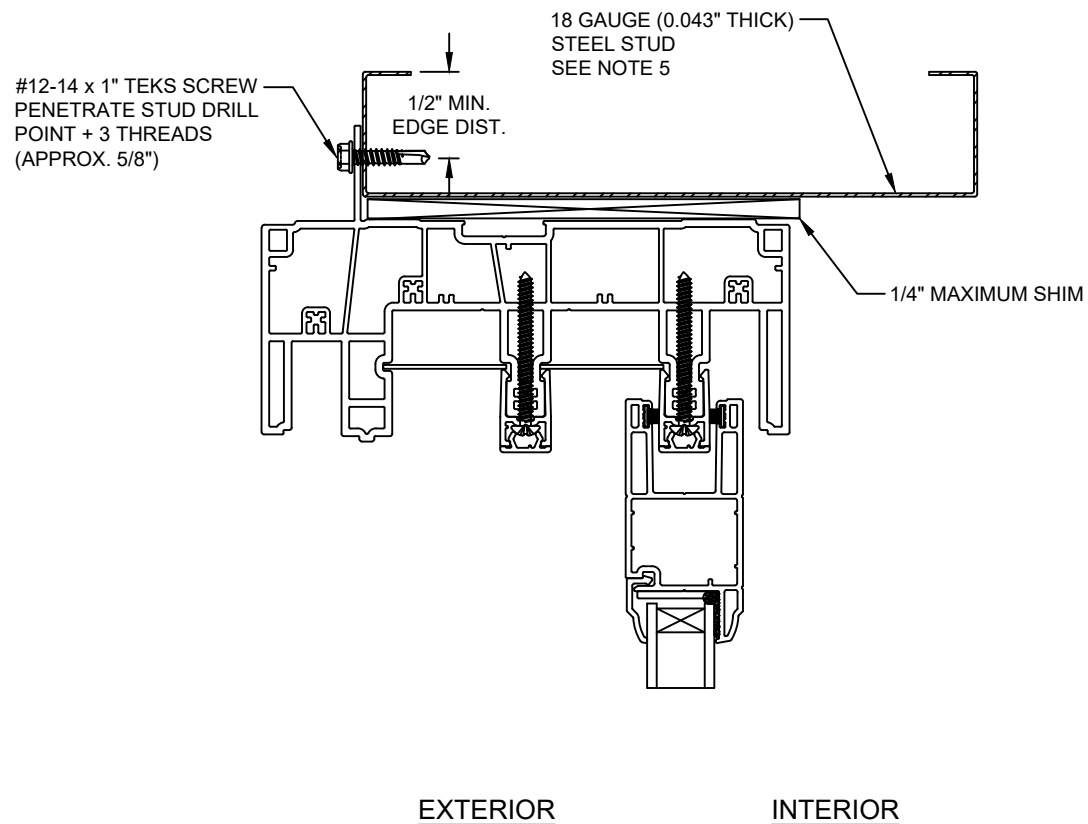

Note:  
Waterproofing and interior finishes by others. Not shown for clarity.

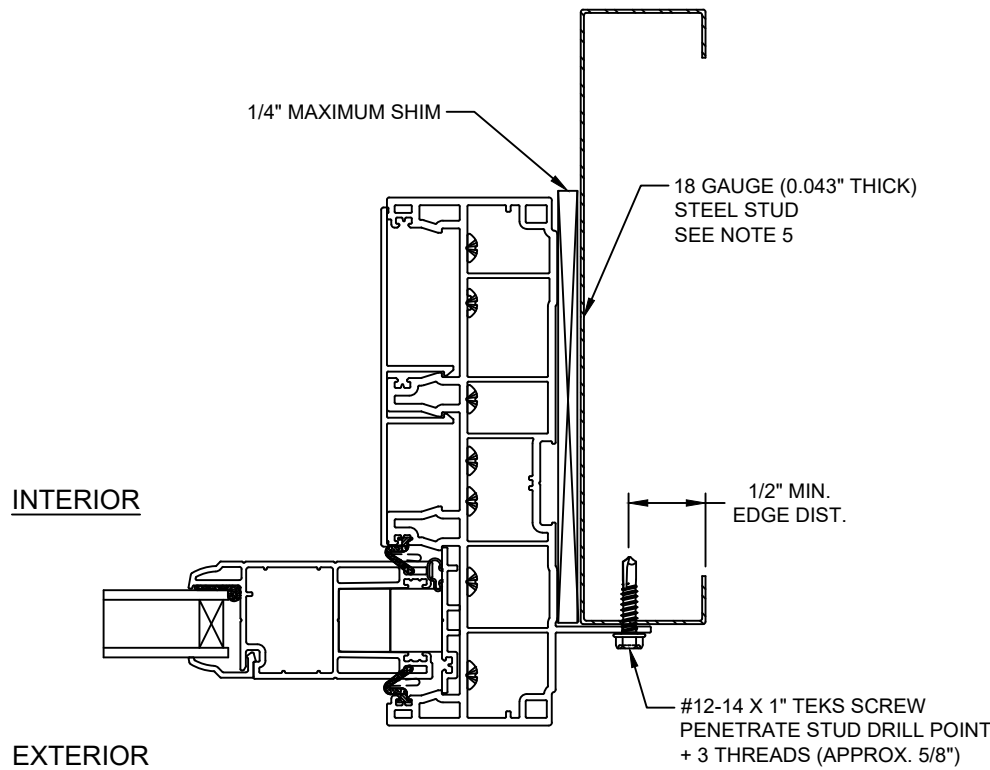

# JAMB

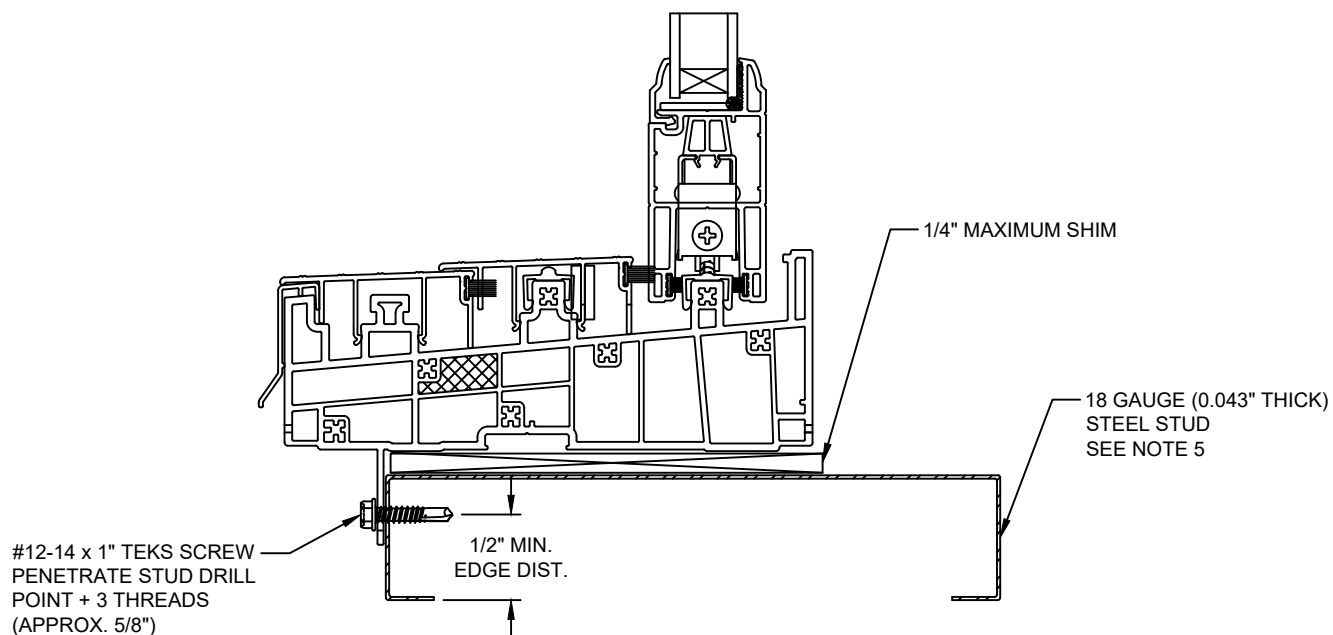

# SILL

NOTE:  
IF SILL INSTALLED FINLESS TO WOOD, SEE SHEETS 6 AND 10  
IF SILL INSTALLED FINLESS TO STEEL STUD, SEE SHEETS 7 AND 11  
IF SILL INSTALLED FINLESS TO CONCRETE, SEE SHEETS 8, 9, 12 AND 13

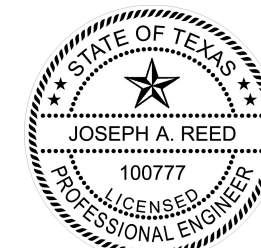

Joseph A. Reed, PE  
TX PE 100777  
5 Leigh Dr.  
York, PA 17406  
717-846-1200  
Project 23550-1

*Joseph A. Reed*

2020.10.12 07:30:54 -04'00'

<b>5400/5400S/7700/9900 SGD</b> <b>Non-Impact</b> Fin Install to Steel Stud	
<b>Wincore Windows &amp; Doors</b> 250 Staunton Turnpike Parkersburg, WV 26104	
Drawing No.: 23550-9-1001 Project No.: 23550-9 Drawn By: JAR    Rev: -    Date: 10/10/20	
Scale: NTS	Sheet 5 of 18

# HEAD

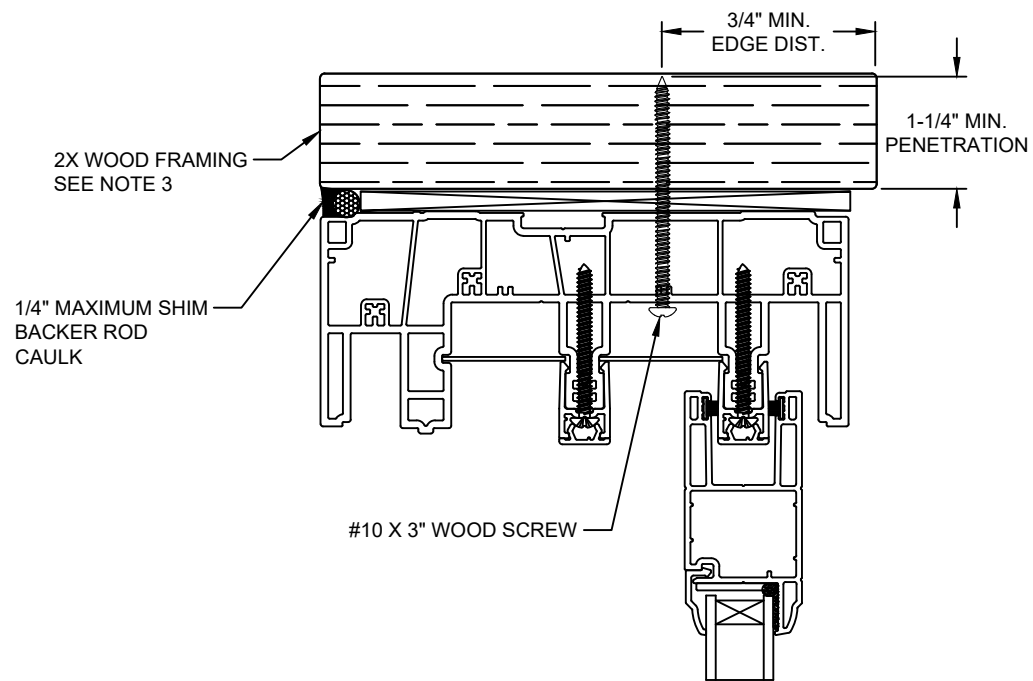

EXTERIOR

INTERIOR

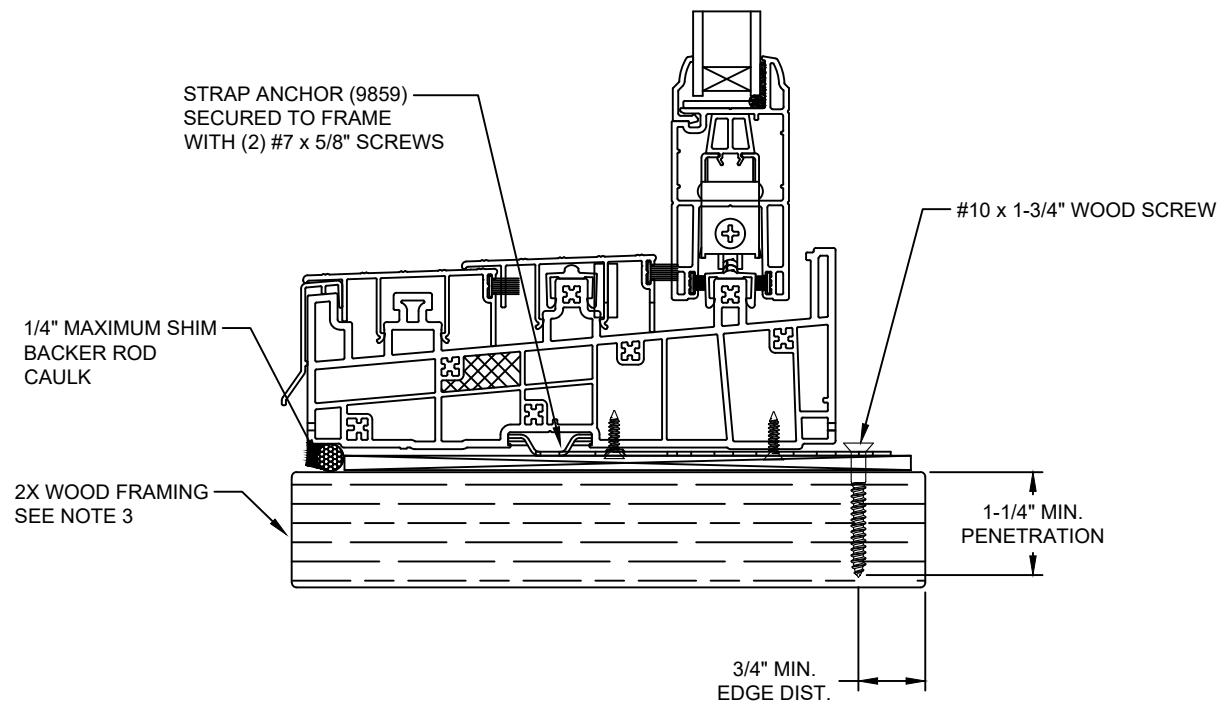

# SILL

NOTE:  
IF SILL INSTALLED TO STEEL STUD, SEE SHEETS 7 AND 11  
IF SILL INSTALLED TO CONCRETE, SEE SHEETS 8, 9, 12 AND 13

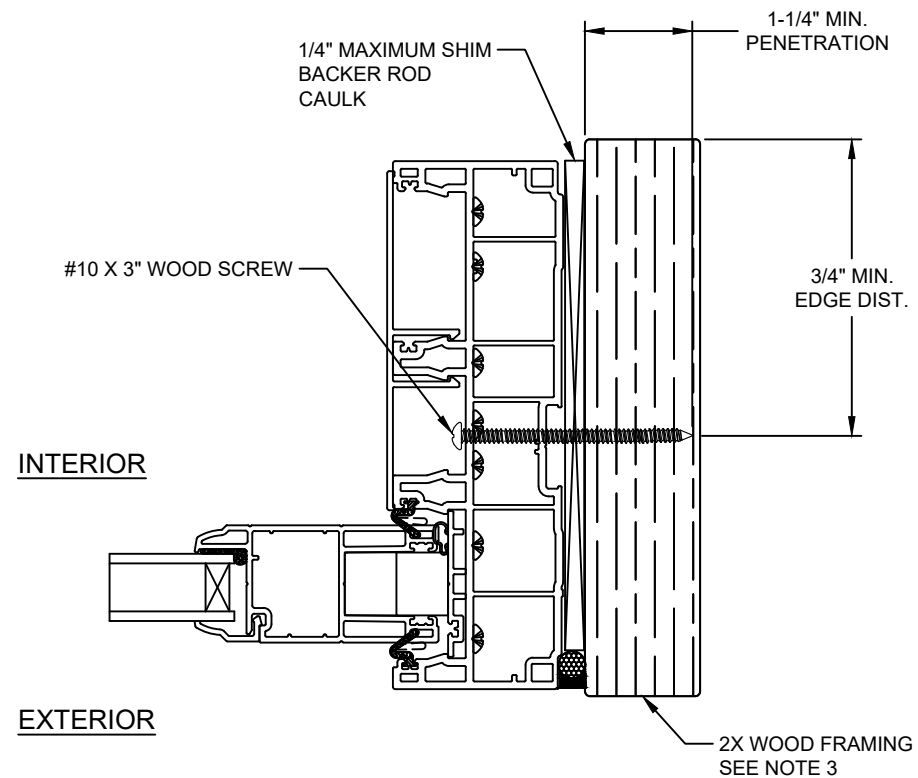

# JAMB

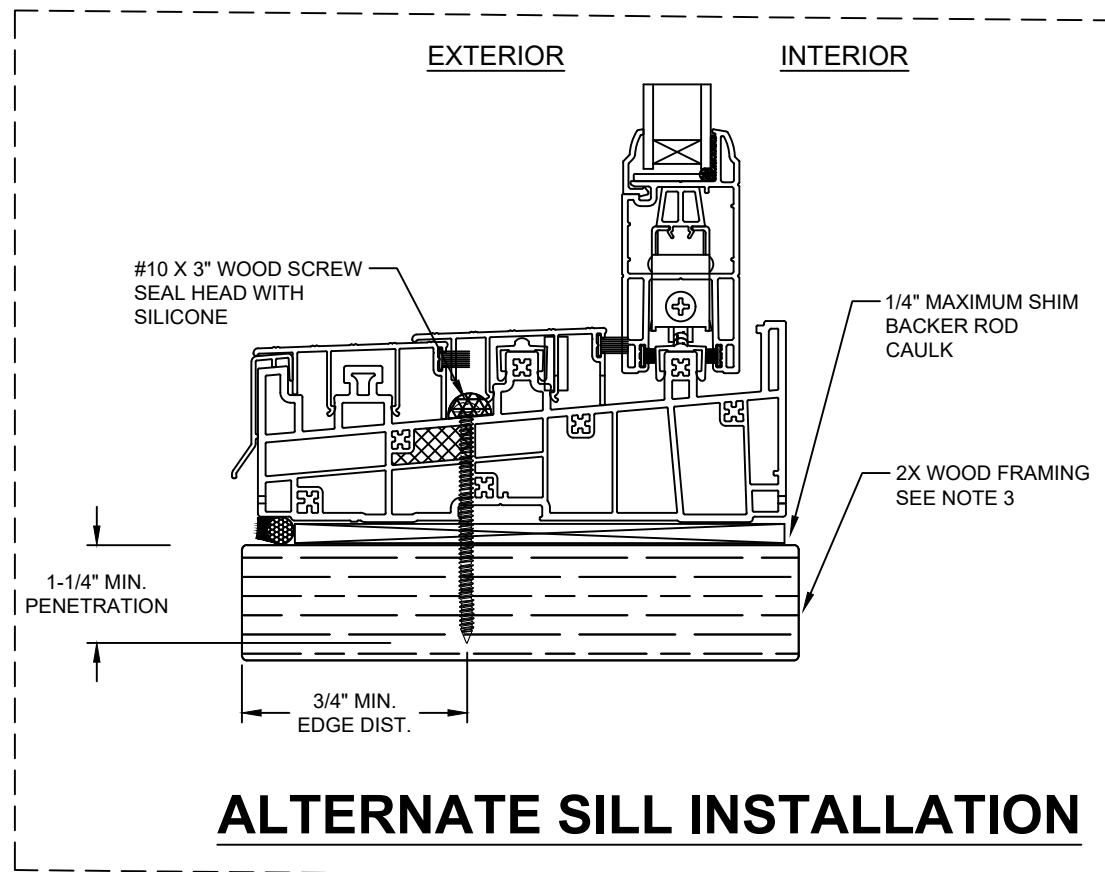

# ALTERNATE SILL INSTALLATION

Note:  
Waterproofing and interior finishes by others. Not shown for clarity.

Joseph A. Reed, PE  
TX PE 100777  
5 Leigh Dr.  
York, PA 17406  
717-846-1200  
Project 23550-1

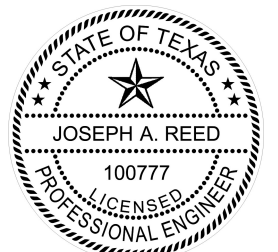

*Joseph A. Reed*

2020.10.12 07:30:54 -04'00'

**5400/5400S/7700/9900 SGD**  
**Non-Impact**  
Frame Install to Wood  
**Wincore Windows & Doors**  
250 Staunton Turnpike  
Parkersburg, WV 26104

Drawing No.: 23550-9-1001  
Project No.: 23550-9  
Drawn By: JAR Rev: - Date: 10/10/20

Scale: NTS

Sheet 6 of 18

# HEAD

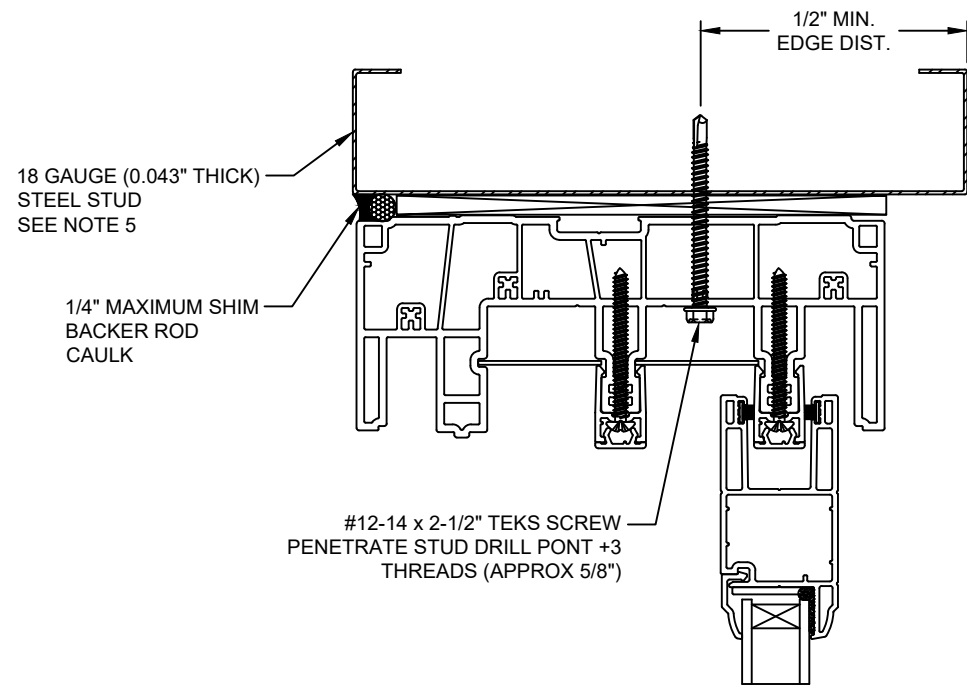

EXTERIOR

INTERIOR

Note:  
Waterproofing and interior finishes by others. Not shown for clarity.

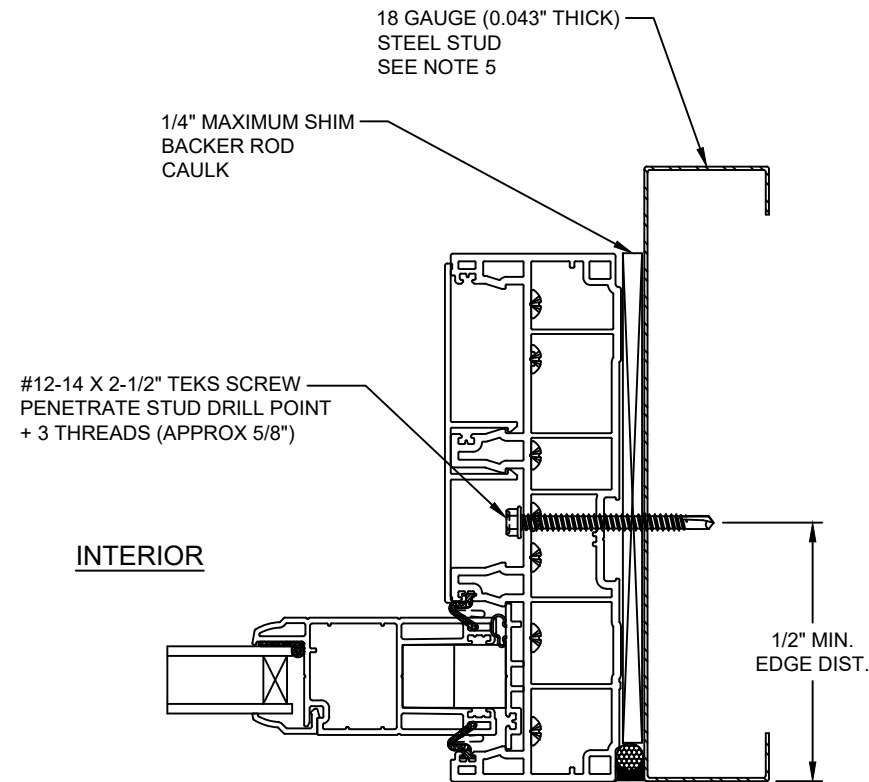

INTERIOR

EXTERIOR

# JAMB

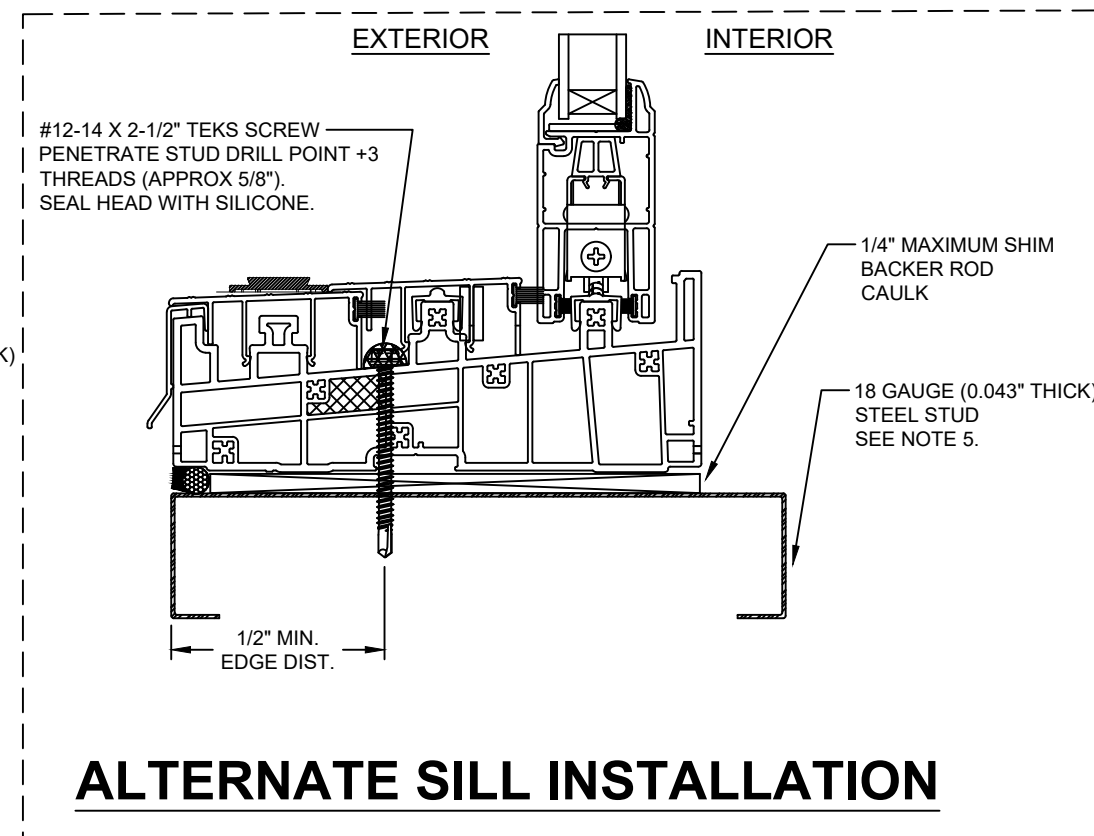
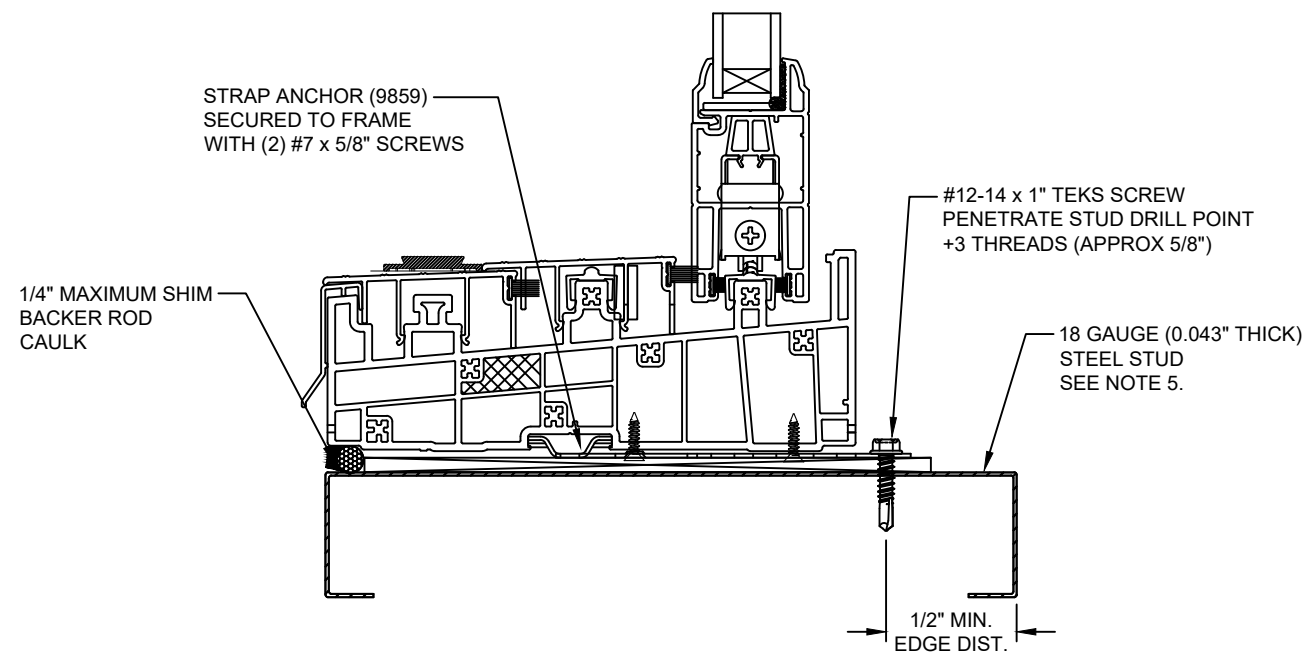

# ALTERNATE SILL INSTALLATION

# SILL

NOTE:  
IF SILL INSTALLED TO WOOD, SEE SHEETS 6 AND 10  
IF SILL INSTALLED TO CONCRETE, SEE SHEETS 8, 9, 12 AND 13

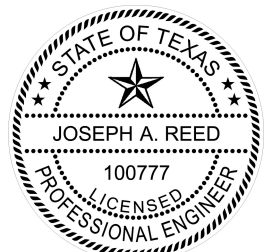

Joseph A. Reed, PE  
TX PE 100777  
5 Leigh Dr.  
York, PA 17406  
717-846-1200  
Project 23550-1

*Joseph A. Reed*

2020.10.12 07:30:54 -04'00'

<b>5400/5400S/7700/9900 SGD</b> <b>Non-Impact</b> <b>Frame Install to Steel Stud</b>	
<b>Wincore Windows &amp; Doors</b> 250 Staunton Turnpike Parkersburg, WV 26104	
Drawing No.: 23550-9-1001 Project No.: 23550-9 Drawn By: JAR    Rev: -    Date: 10/10/20	

Scale: NTS	Sheet 7 of 18
------------	---------------

# HEAD

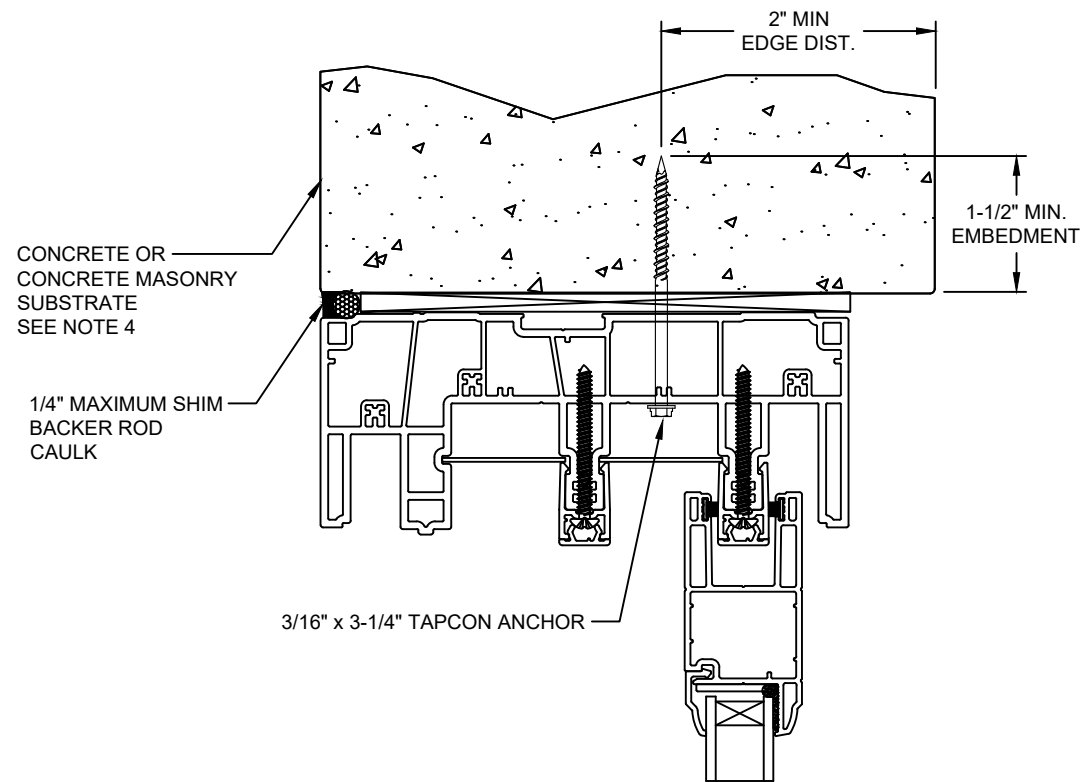

EXTERIOR

INTERIOR

Note:  
Waterproofing and interior finishes by others. Not shown for clarity.

# JAMB

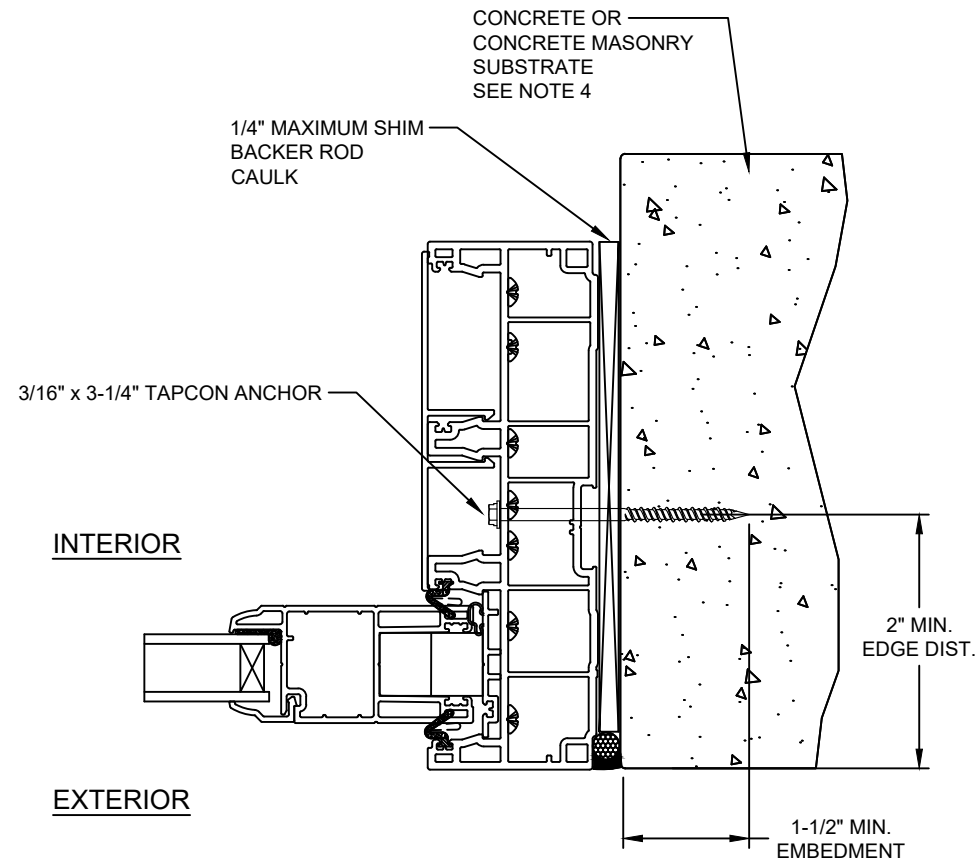

INTERIOR

EXTERIOR

EXTERIOR

INTERIOR

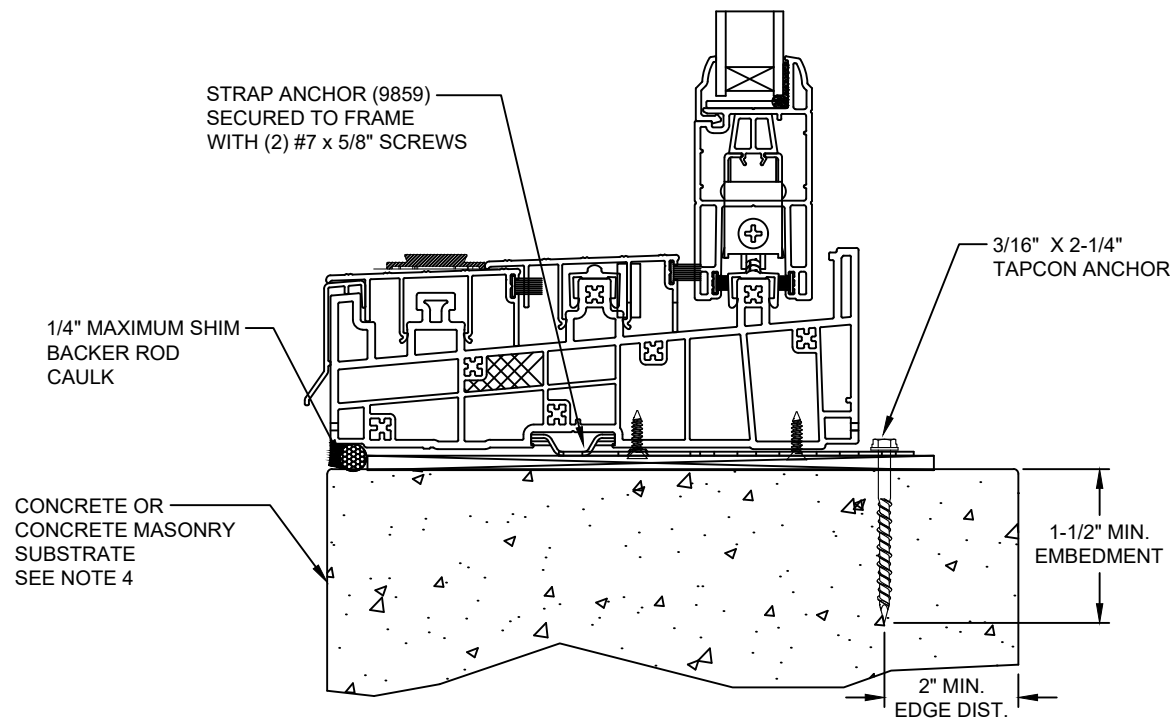

# SILL

NOTE:  
IF SILL INSTALLED TO WOOD, SEE SHEETS 6 AND 10  
IF SILL INSTALLED TO STEEL STUD, SEE SHEETS 7 AND 11

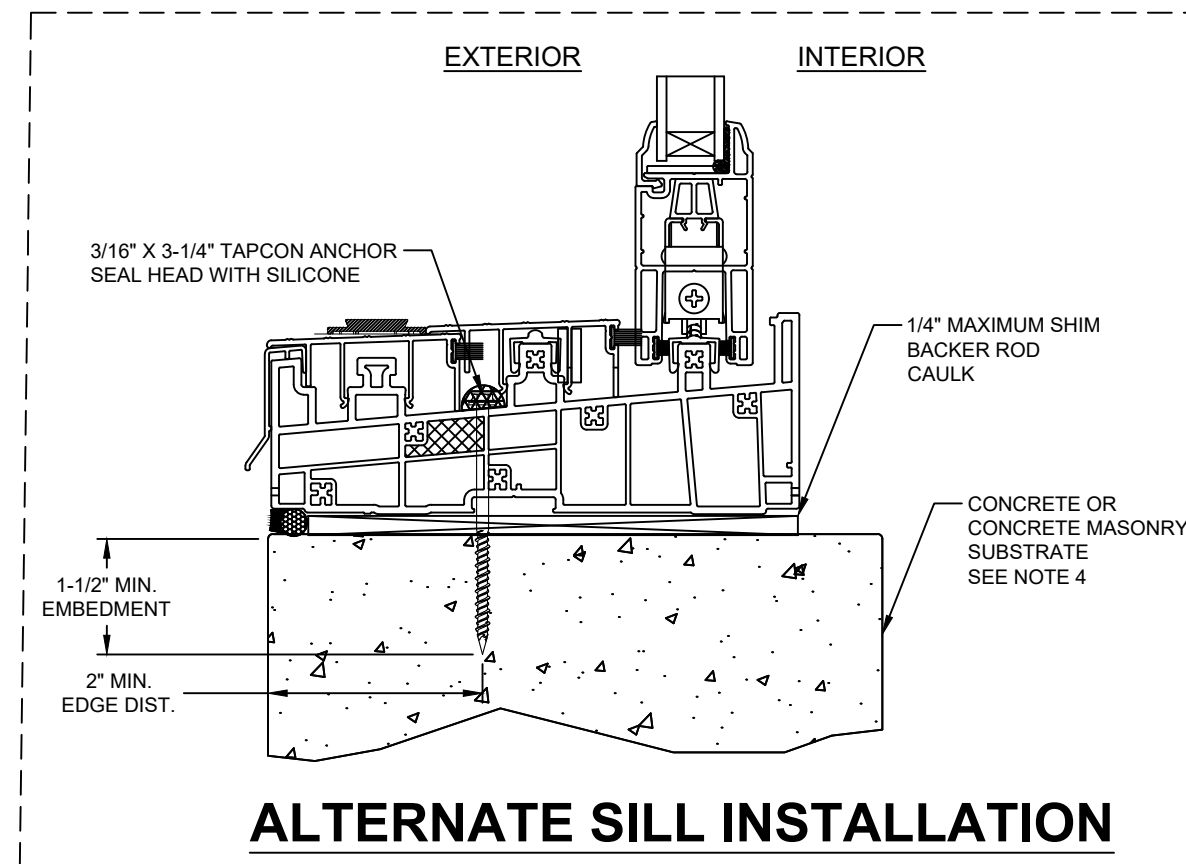

# ALTERNATE SILL INSTALLATION

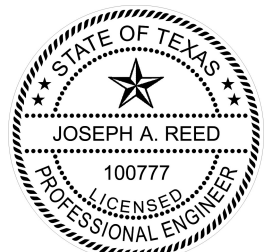

Joseph A. Reed, PE  
TX PE 100777  
5 Leigh Dr.  
York, PA 17406  
717-846-1200  
Project 23550-1

*Joseph A. Reed*

2020.10.12 07:30:54 -04'00'

<b>5400/5400S/7700/9900 SGD</b>	
<b>Non-Impact</b>	
Frame Install to Concrete or CMU	
<b>Wincore Windows &amp; Doors</b>	
250 Staunton Turnpike Parkersburg, WV 26104	
Drawing No.: 23550-9-1001	
Project No.: 23550-9	
Drawn By: JAR	Rev: - Date: 10/10/20

Scale: NTS	Sheet 8 of 18
------------	---------------



# HEAD

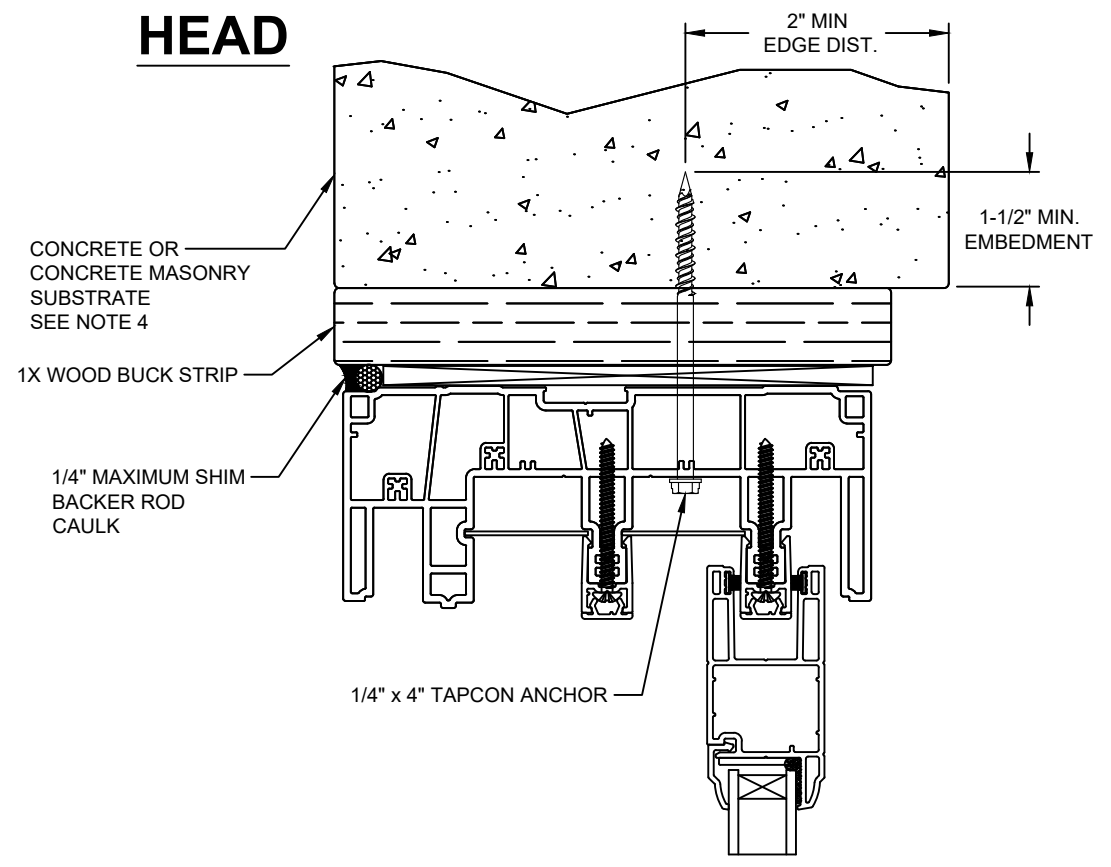

EXTERIOR

INTERIOR

# JAMB

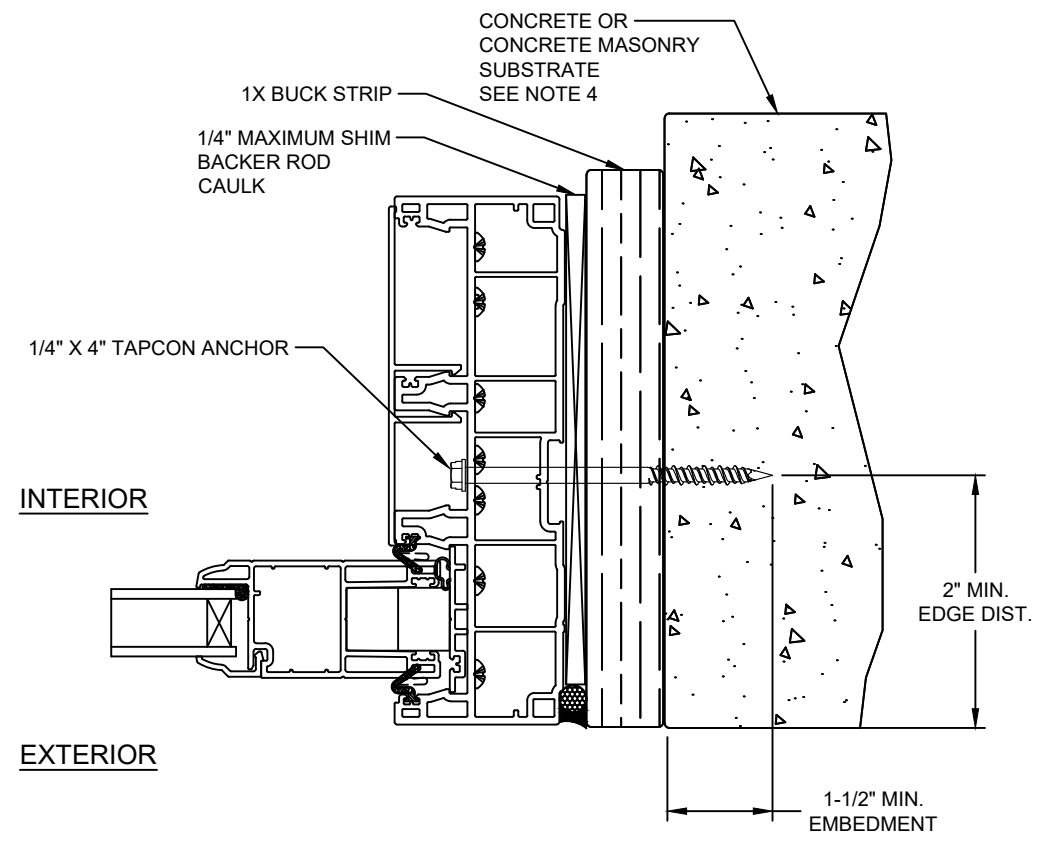

**Note:**  
Waterproofing and interior finishes by others. Not shown for clarity.

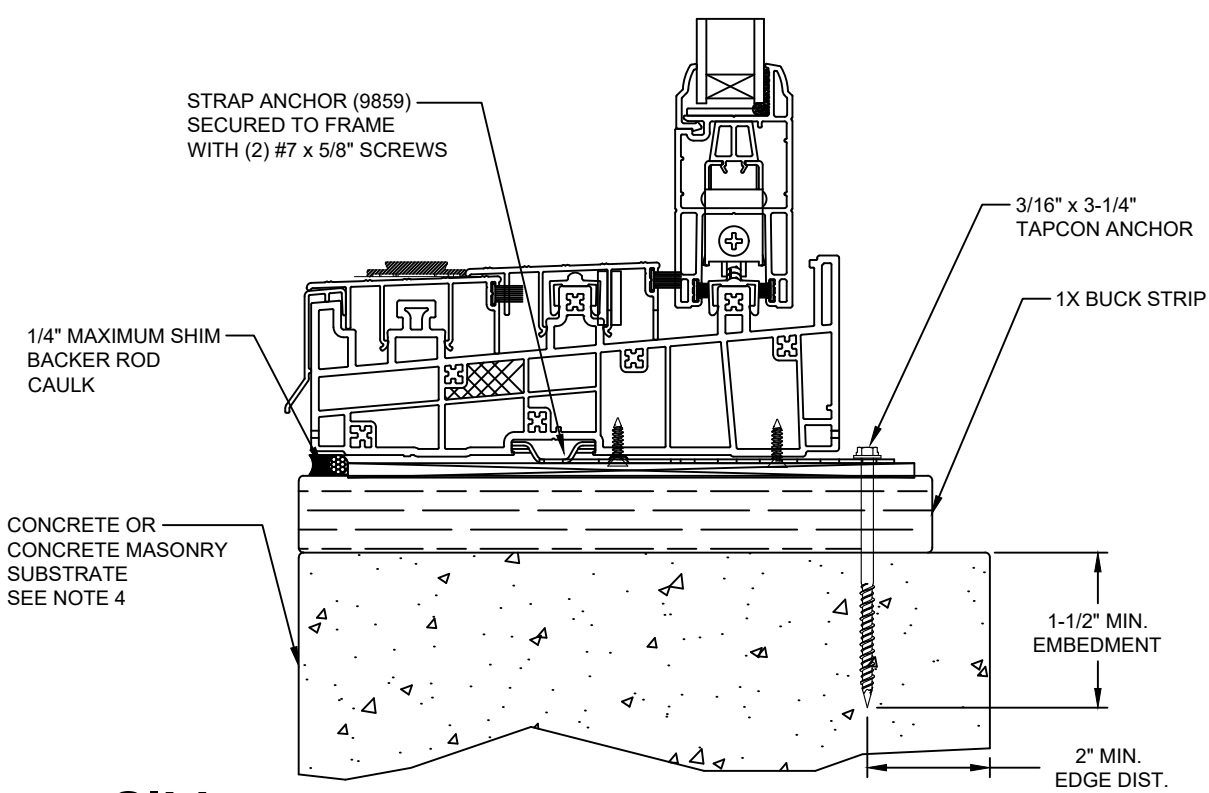

# SILL

**NOTE:**  
IF SILL INSTALLED TO WOOD, SEE SHEETS 6 AND 10  
IF SILL INSTALLED TO STEEL STUD, SEE SHEETS 7 AND 11

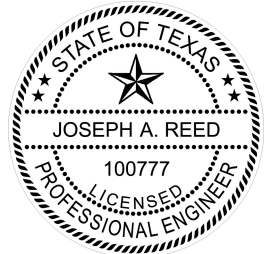
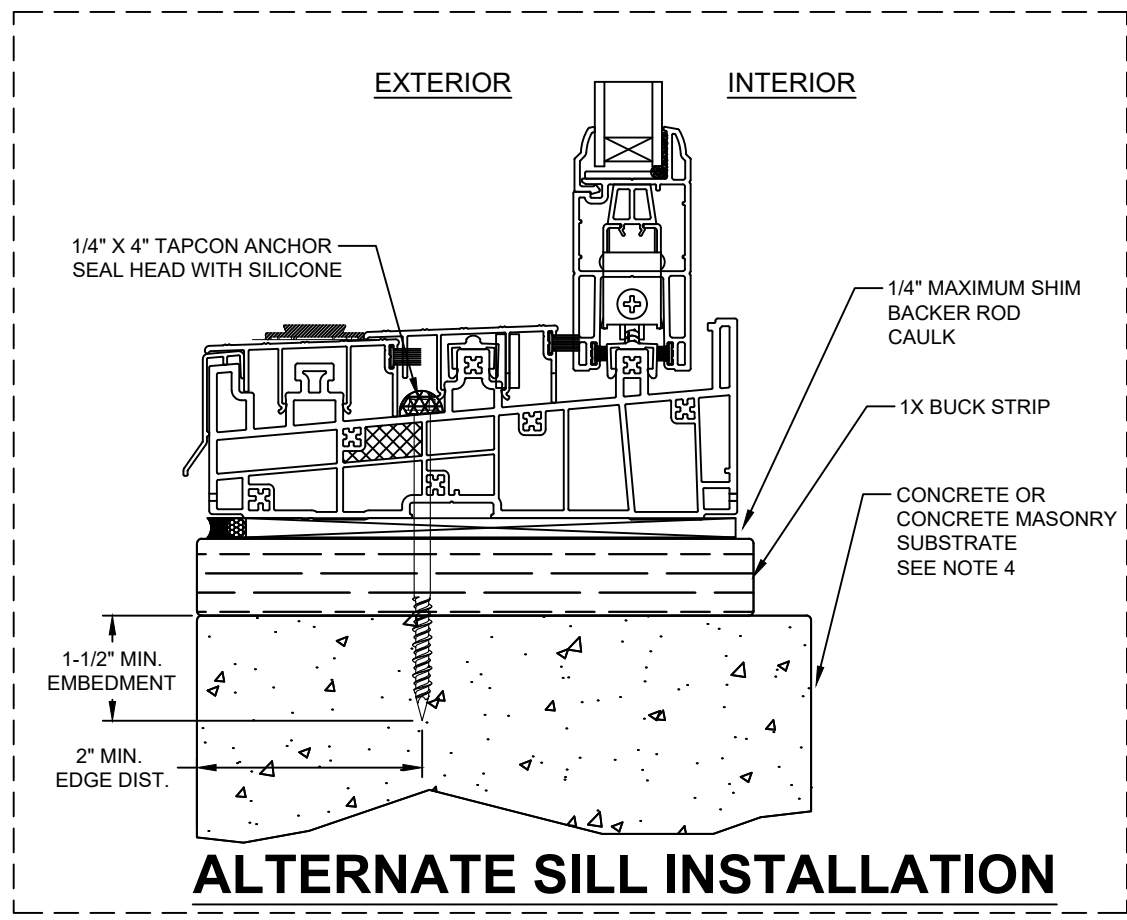

Joseph A. Reed, PE  
TX PE 100777  
5 Leigh Dr.  
York, PA 17406  
717-846-1200  
Project 23550-1

*Joseph A. Reed*

2020.10.12 07:30:54 -04'00'

**5400/5400S/7700/9900 SGD**  
**Non-Impact**  
Frame Install to Concrete or CMU  
**Wincore Windows & Doors**  
250 Staunton Turnpike  
Parkersburg, WV 26104

Drawing No.: 23550-9-1001  
Project No.: 23550-9  
Drawn By: JAR Rev: - Date: 10/10/20

Scale: NTS Sheet 9 of 18

# HEAD

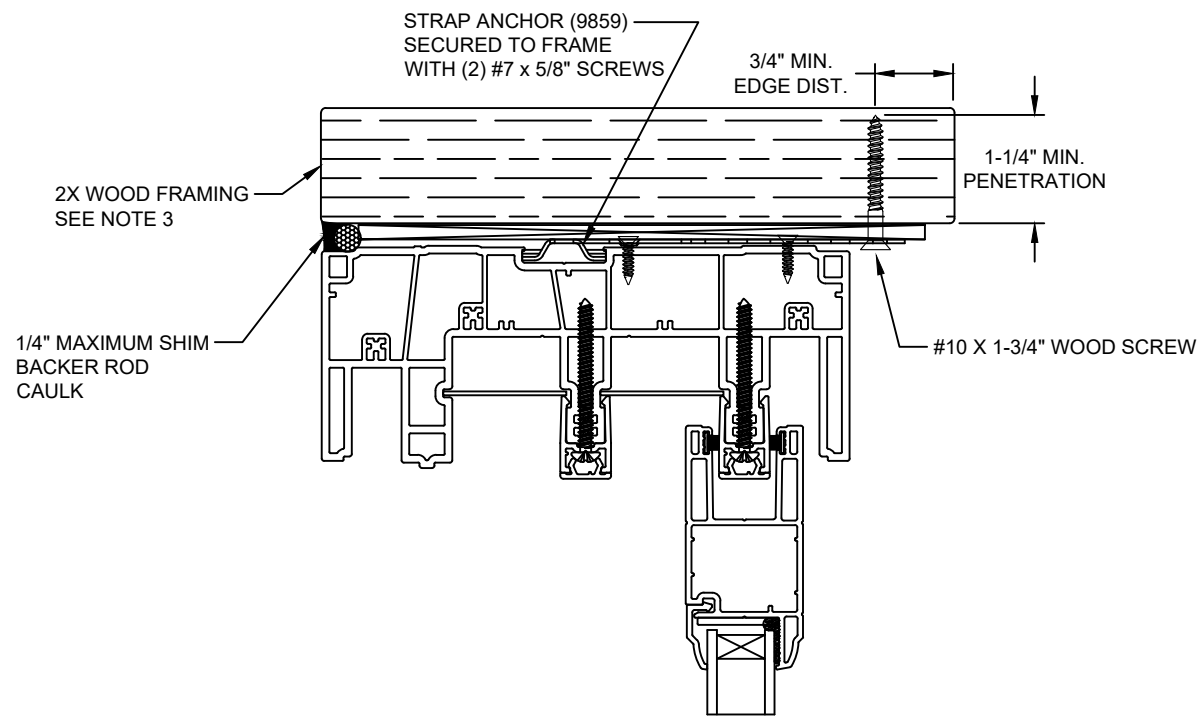

EXTERIOR

INTERIOR

# JAMB

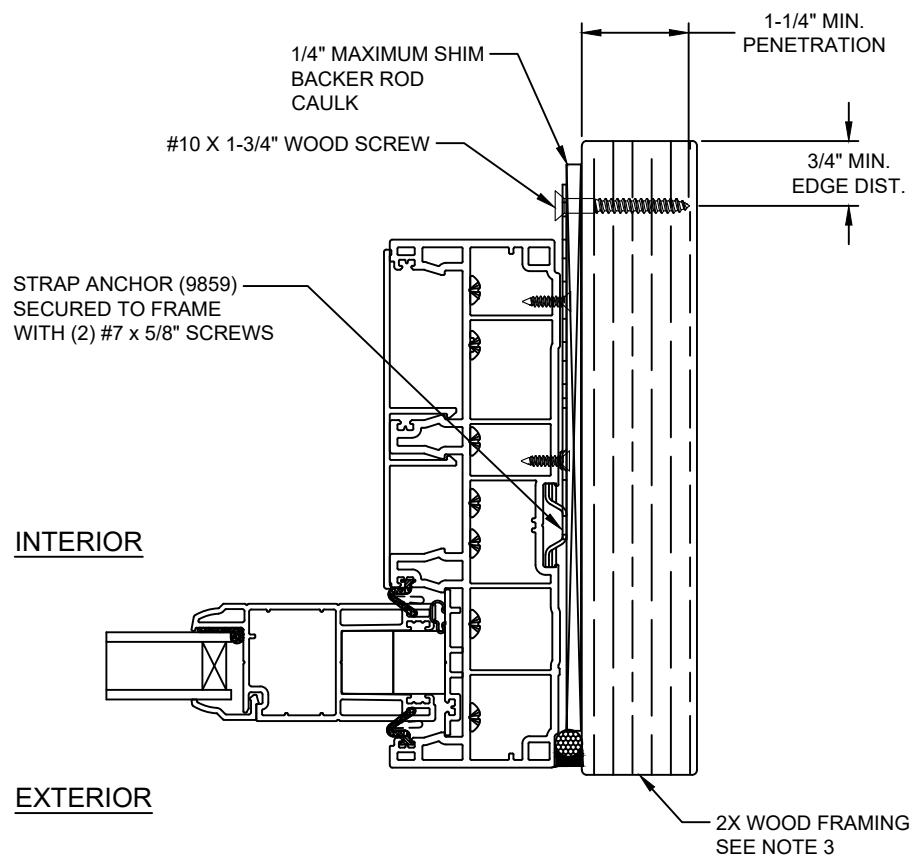

INTERIOR

EXTERIOR

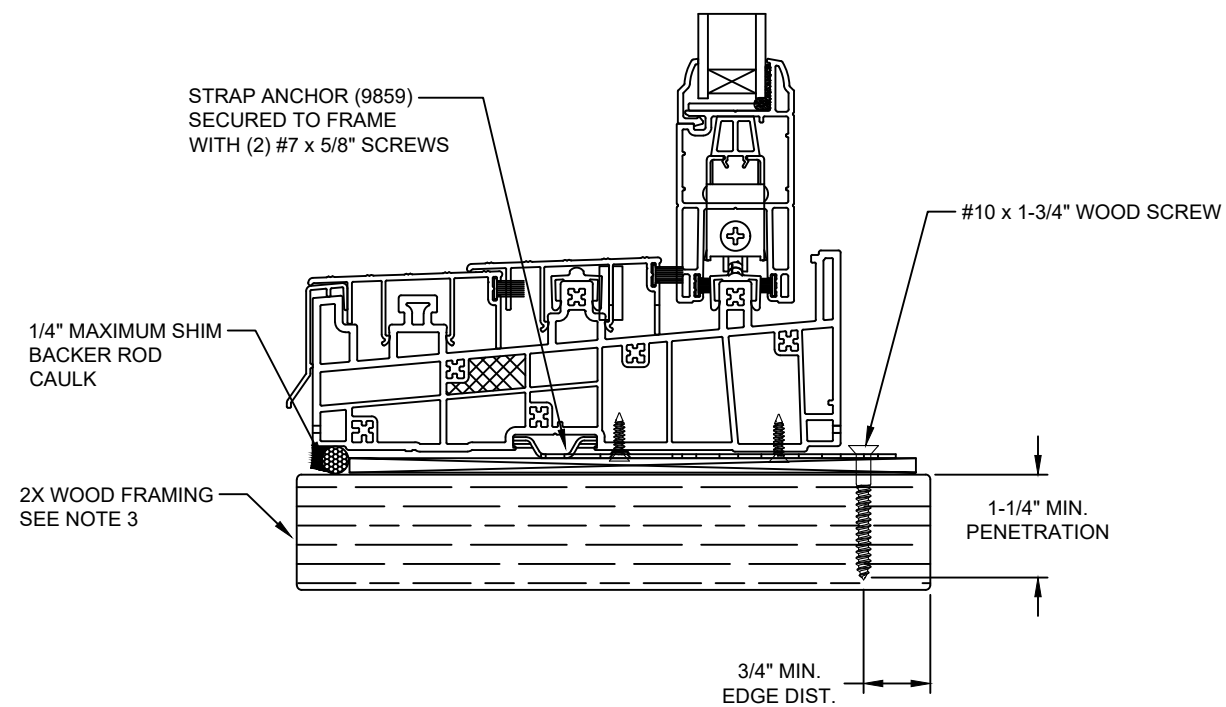

# SILL

NOTE:  
IF SILL INSTALLED TO STEEL STUD, SEE SHEET 11  
IF SILL INSTALLED TO CONCRETE, SEE SHEETS 12 AND 13

Note:  
Waterproofing and interior finishes by others. Not shown for clarity.

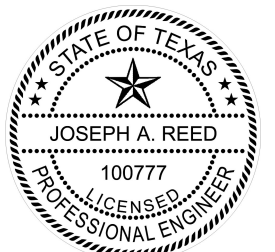

Joseph A. Reed, PE  
TX PE 100777  
5 Leigh Dr.  
York, PA 17406  
717-846-1200  
Project 23550-1

*Joseph A. Reed*

2020.10.12 07:30:54 -04'00'

**5400/5400S/7700/9900 SGD**

**Non-Impact**

**Strap Install to Wood**

**Wincore Windows & Doors**

250 Staunton Turnpike

Parkersburg, WV 26104

Drawing No.: 23550-9-1001

Project No.: 23550-9

Drawn By: JAR Rev: - Date: 10/10/20

Scale: NTS

Sheet 10 of 18

Note:  
Waterproofing and interior finishes by others. Not shown for clarity.

# HEAD

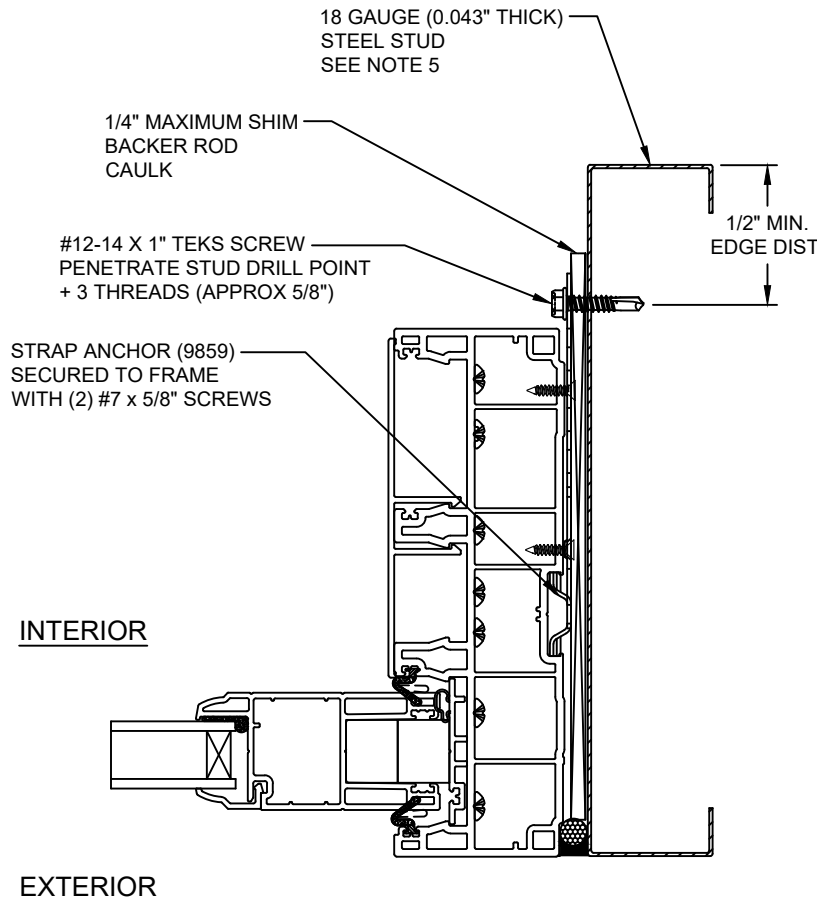
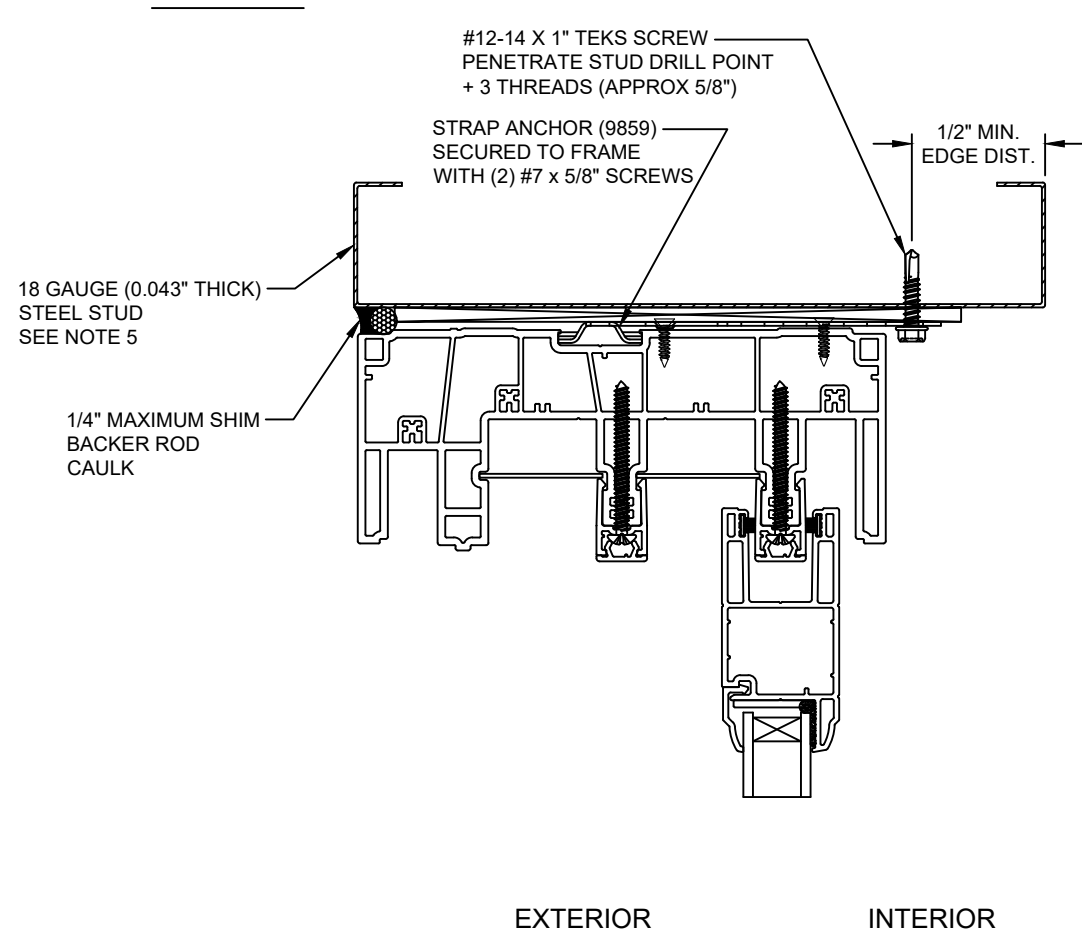

# JAMB

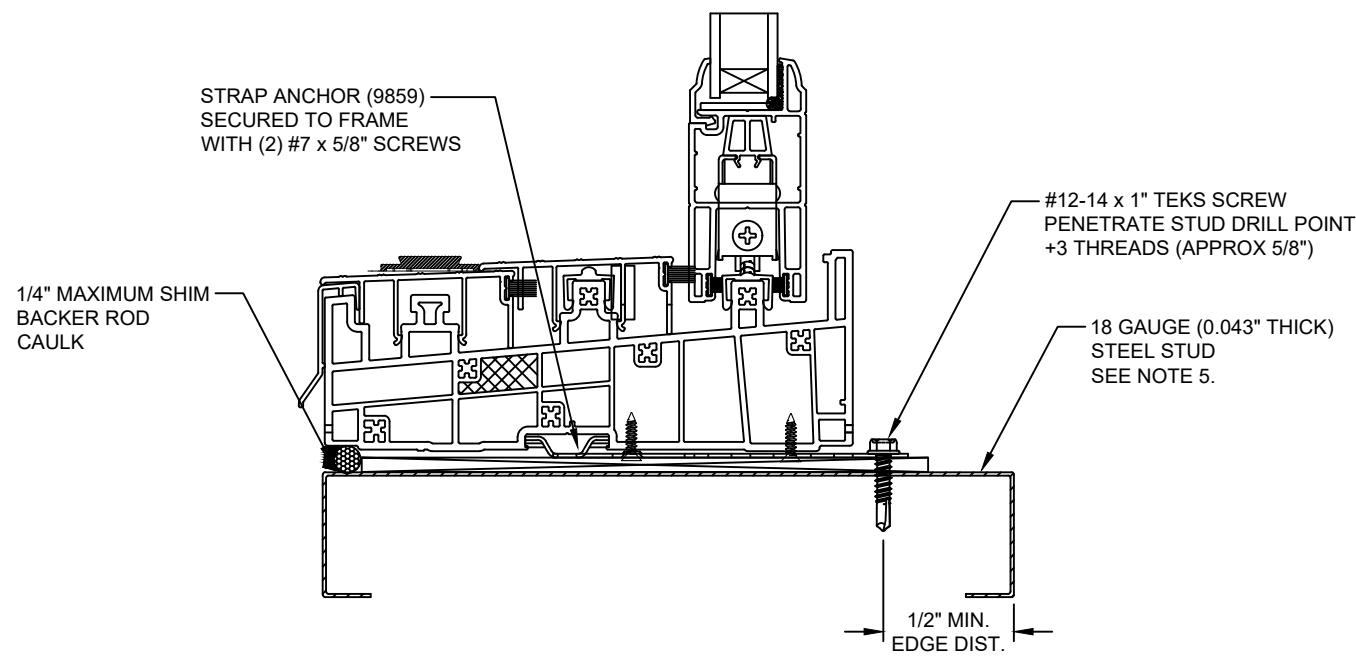

# SILL

NOTE:  
IF SILL INSTALLED TO WOOD, SEE SHEET 10  
IF SILL INSTALLED TO CONCRETE, SEE SHEETS 12 AND 13



Joseph A. Reed, PE  
TX PE 100777  
5 Leigh Dr.  
York, PA 17406  
717-846-1200  
Project 23550-1

*Joseph A. Reed*  
2020.10.12 07:30:54 -04'00'

<b>5400/5400S/7700/9900 SGD</b>	
<b>Non-Impact</b>	
Strap Install to Steel Stud	
<b>Wincore Windows &amp; Doors</b>	
250 Staunton Turnpike Parkersburg, WV 26104	
Drawing No.: 23550-9-1001	
Project No.: 23550-9	
Drawn By: JAR	Rev: - Date: 10/10/20
Scale: NTS	Sheet 11 of 18

# HEAD

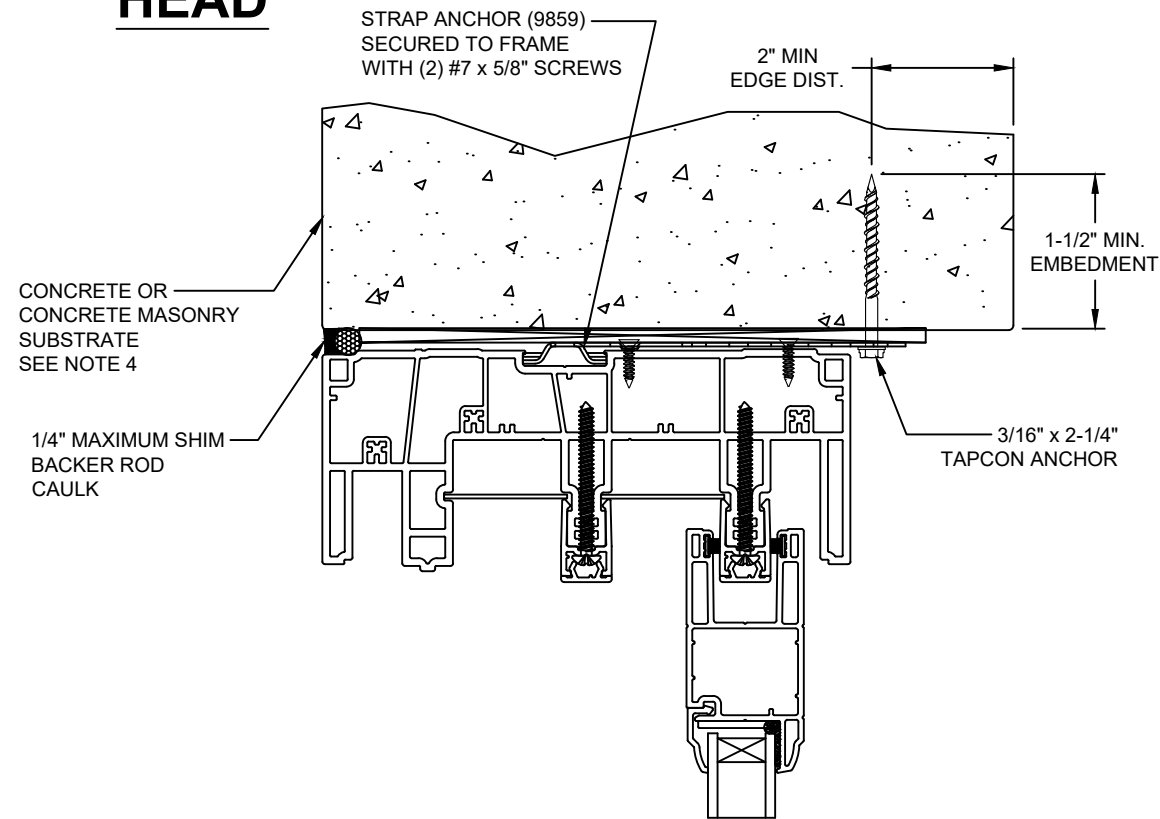

EXTERIOR

INTERIOR

CONCRETE OR  
CONCRETE MASONRY  
SUBSTRATE  
SEE NOTE 4

1/4" MAXIMUM SHIM  
BACKER ROD  
CAULK

3/16" x 2-1/4" TAPCON ANCHOR

STRAP ANCHOR (9859)  
SECURED TO FRAME  
WITH (2) #7 x 5/8" SCREWS

1-1/2" MIN.  
EMBEDMENT

INTERIOR

EXTERIOR

# JAMB

Note:  
Waterproofing and interior finishes by  
others. Not shown for clarity.

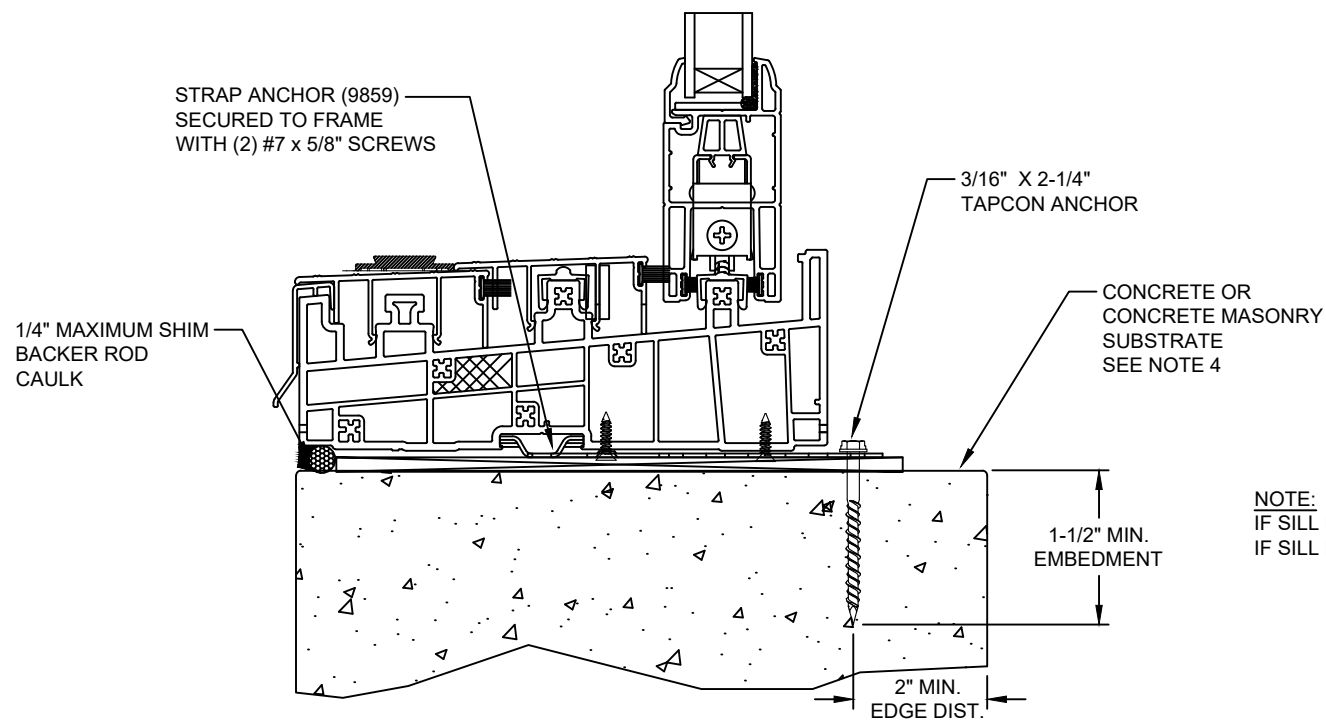

# SILL

NOTE:  
IF SILL INSTALLED TO WOOD, SEE SHEET 10  
IF SILL INSTALLED TO STEEL STUD, SEE SHEET 11

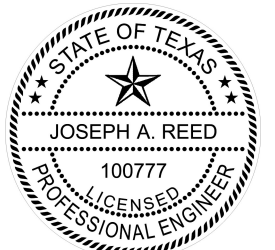

Joseph A. Reed, PE  
TX PE 100777  
5 Leigh Dr.  
York, PA 17406  
717-846-1200  
Project 23550-1

*Joseph A. Reed*

2020.10.12 07:30:54 -04'00'

<b>5400/5400S/7700/9900 SGD</b> <b>Non-Impact</b> Strap Install to Concrete or CMU	
<b>Wincore Windows &amp; Doors</b> 250 Staunton Turnpike Parkersburg, WV 26104	
Drawing No.: 23550-9-1001 Project No.: 23550-9 Drawn By: JAR    Rev: -    Date: 10/10/20	
Scale: NTS	Sheet 12 of 18

**Note:**  
Waterproofing and interior finishes by others. Not shown for clarity.

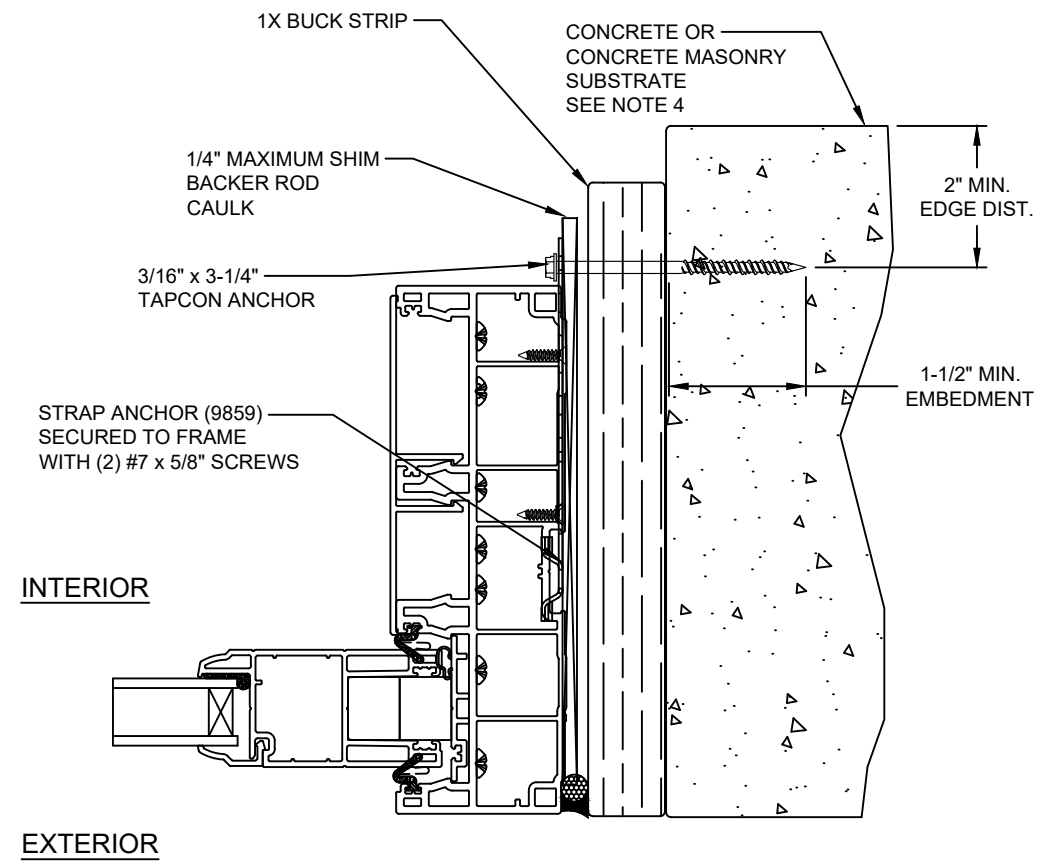
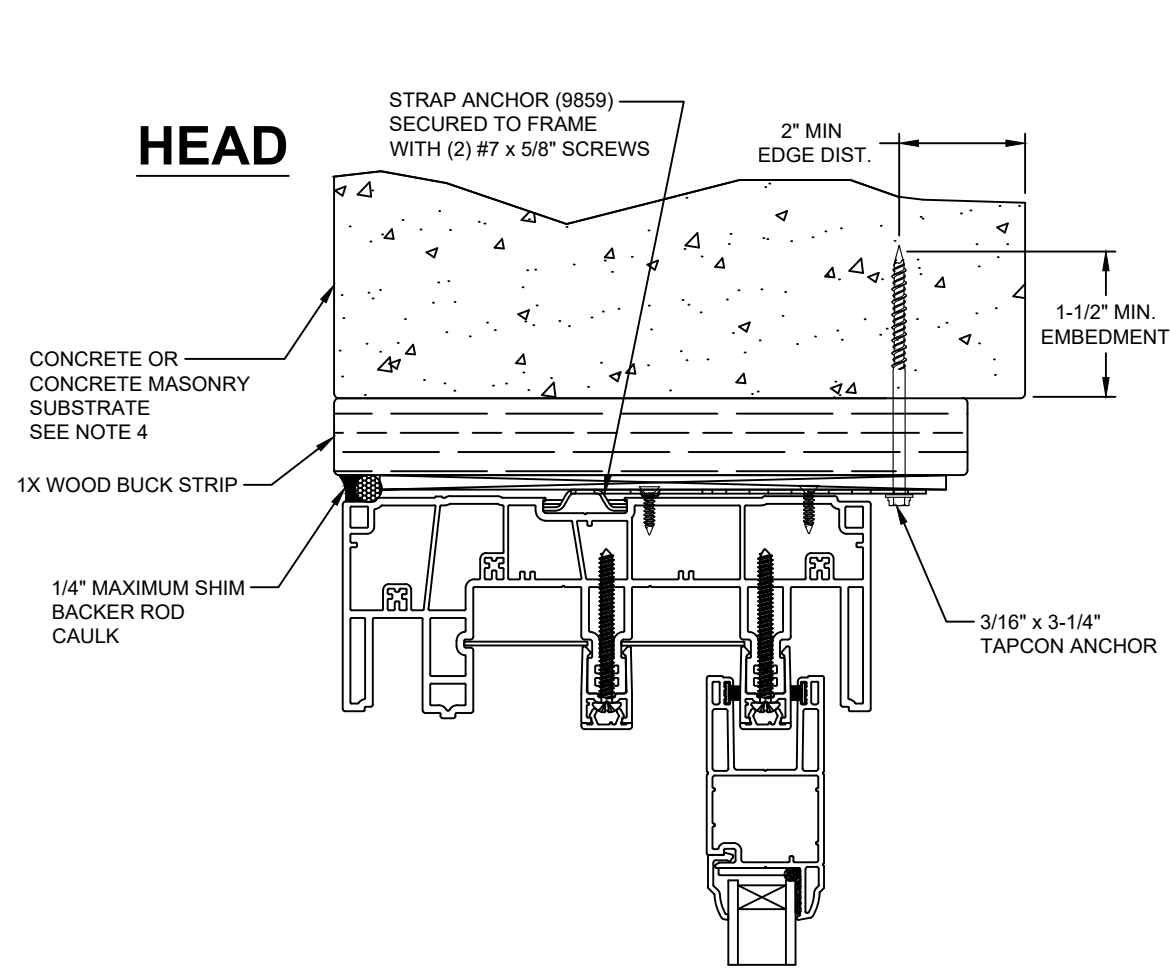

EXTERIOR      INTERIOR

**JAMB**

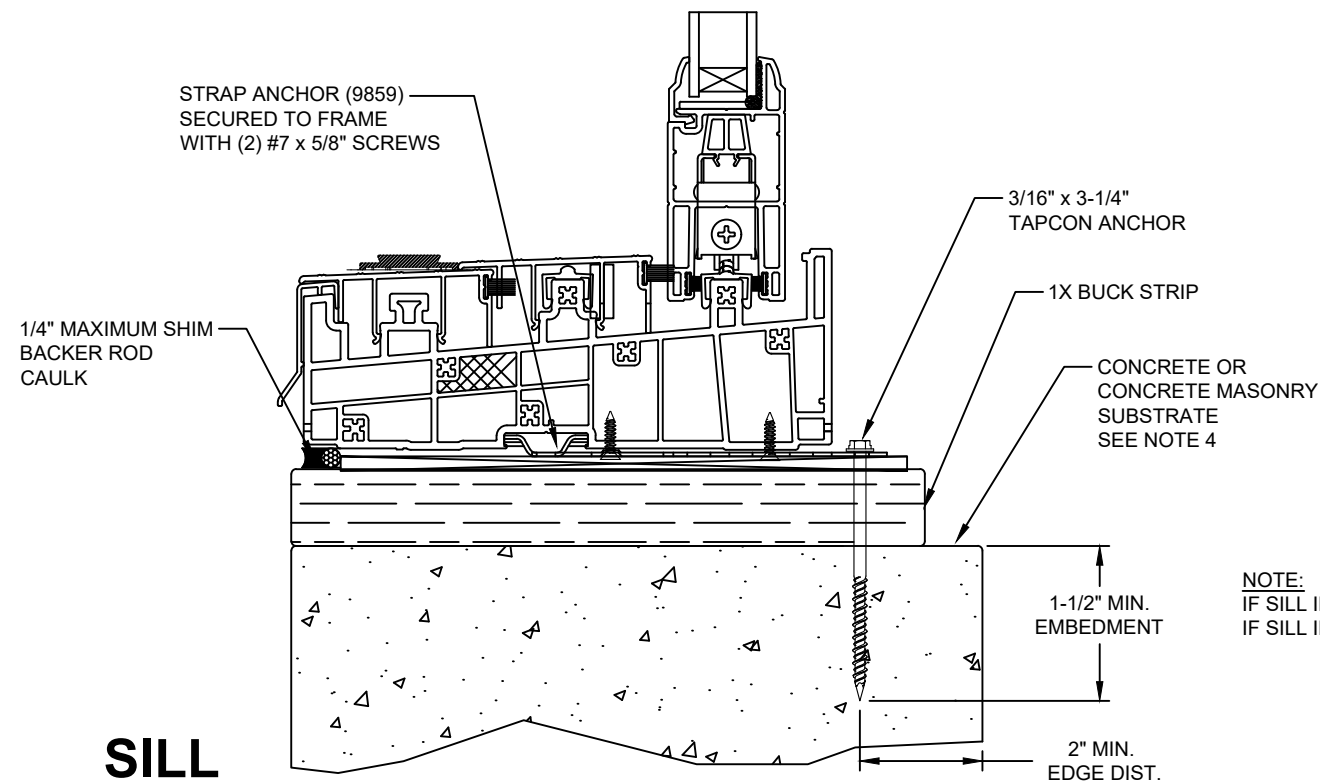

**NOTE:**  
IF SILL INSTALLED TO WOOD, SEE SHEET 10  
IF SILL INSTALLED TO STEEL STUD, SEE SHEET 11

**SILL**

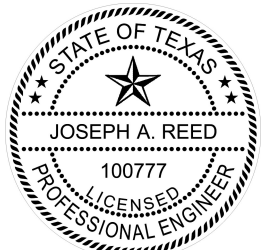

Joseph A. Reed, PE  
TX PE 100777  
5 Leigh Dr.  
York, PA 17406  
717-846-1200  
Project 23550-1

*Joseph A. Reed*

2020.10.12 07:30:54 -04'00'

**5400/5400S/7700/9900 SGD**  
**Non-Impact**  
Strap Install to Concrete or CMU  
**Wincore Windows & Doors**  
250 Staunton Turnpike  
Parkersburg, WV 26104

Drawing No.: 23550-9-1001  
Project No.: 23550-9  
Drawn By: JAR      Rev: -      Date: 10/10/20

Scale: NTS

Sheet 13 of 18

EXTERIOR

INTERIOR

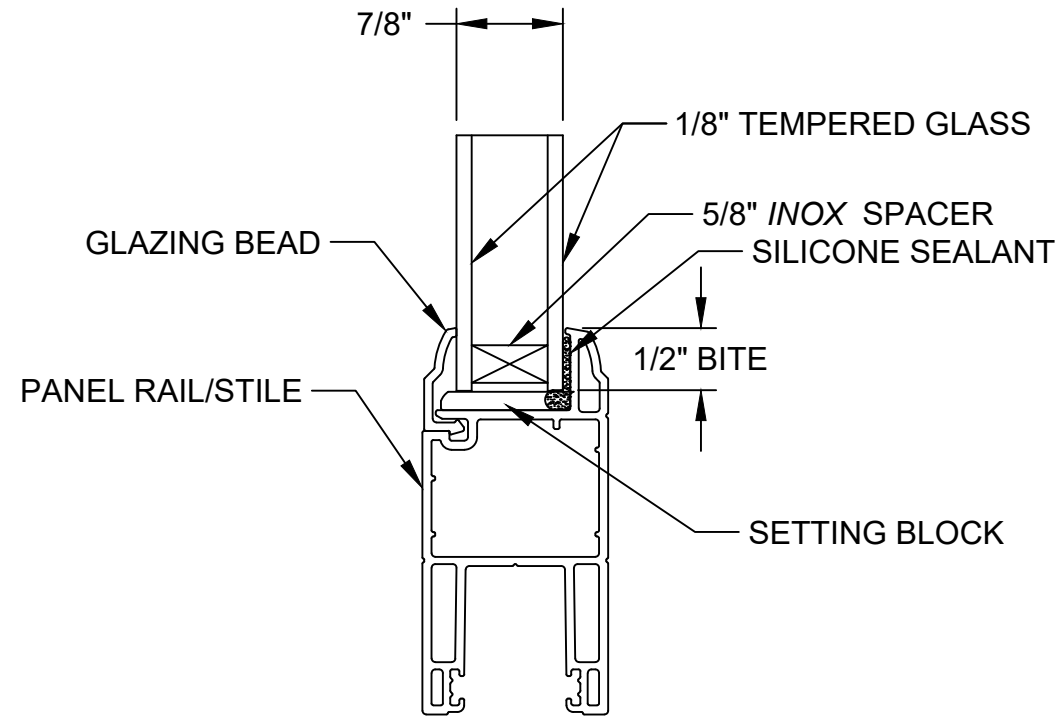

EXTERIOR

INTERIOR

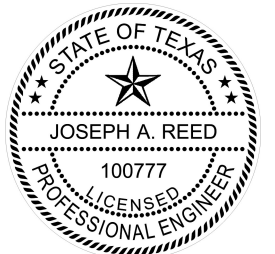
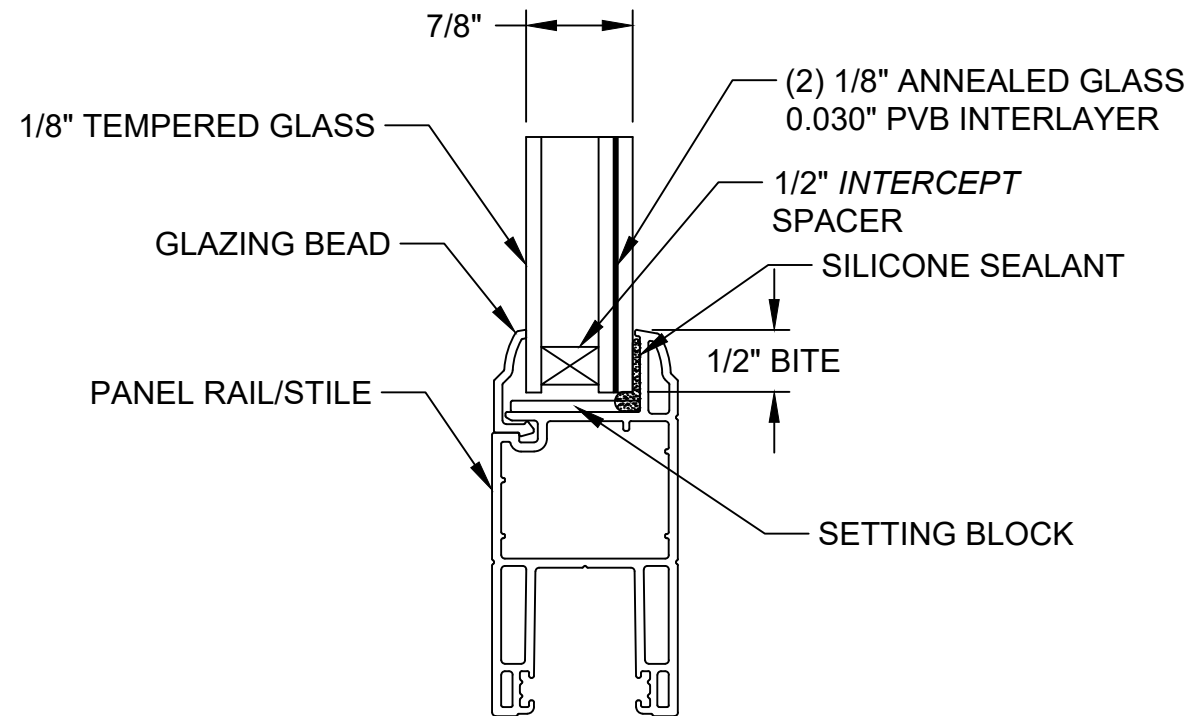

Joseph A. Reed, PE  
 TX PE 100777  
 5 Leigh Dr.  
 York, PA 17406  
 717-846-1200  
 Project 23550-1

*Joseph A. Reed*

2020.10.12 07:30:54 -04'00'

**5400/5400S/7700/9900 SGD**  
**Non-Impact**  
**Glazing Detail**

**Wincore Windows & Doors**  
 250 Staunton Turnpike  
 Parkersburg, WV 26104

Drawing No.: 23550-9-1001  
 Project No.: 23550-9  
 Drawn By: JAR Rev: - Date: 10/10/20

Scale: NTS

Sheet 14 of 18

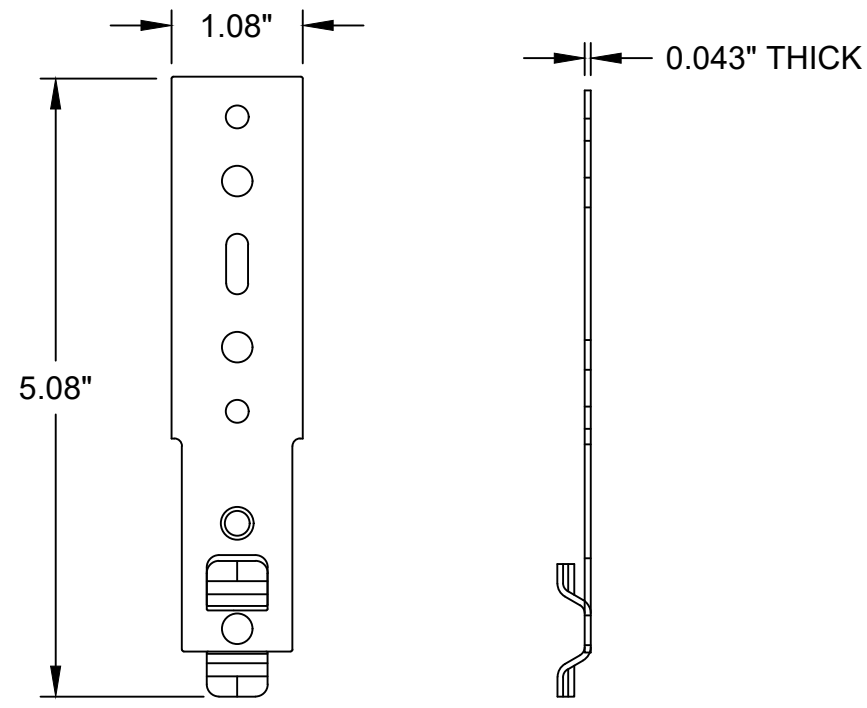

STRAP ANCHOR  
 PART NO. 9859  
 18 GAUGE STEEL

Joseph A. Reed, PE  
 TX PE 100777  
 5 Leigh Dr.  
 York, PA 17406  
 717-846-1200  
 Project 23550-1

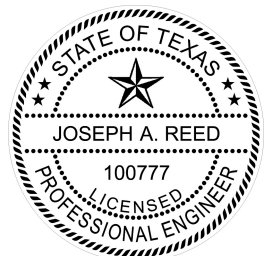

*Joseph A. Reed*

2020.10.12 07:30:54 -04'00'

<b>5400/5400S/7700/9900 SGD</b>	
<b>Non-Impact</b>	
Accessories	
<b>Wincore Windows &amp; Doors</b>	
250 Staunton Turnpike Parkersburg, WV 26104	
Drawing No.: 23550-9-1001 Project No.: 23550-9 Drawn By: JAR    Rev: -    Date: 10/10/20	
Scale: NTS	Sheet 15 of 18

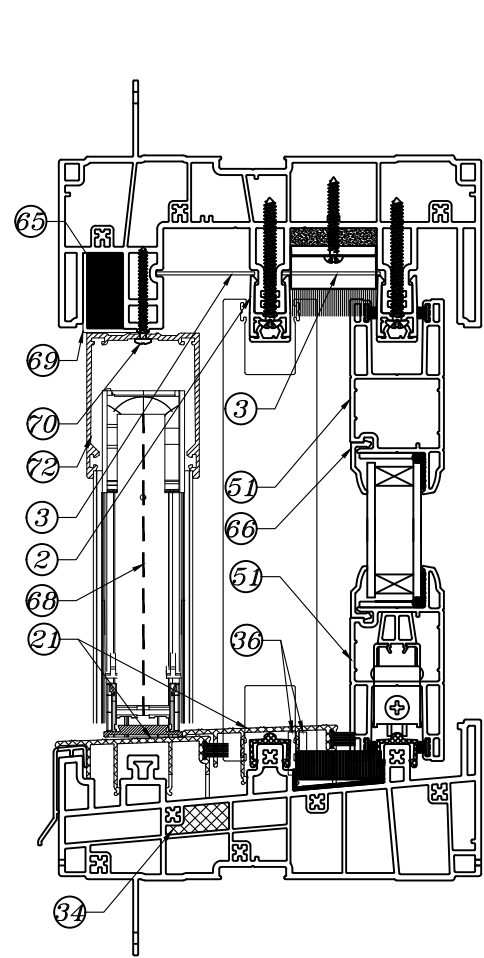

Section A-A

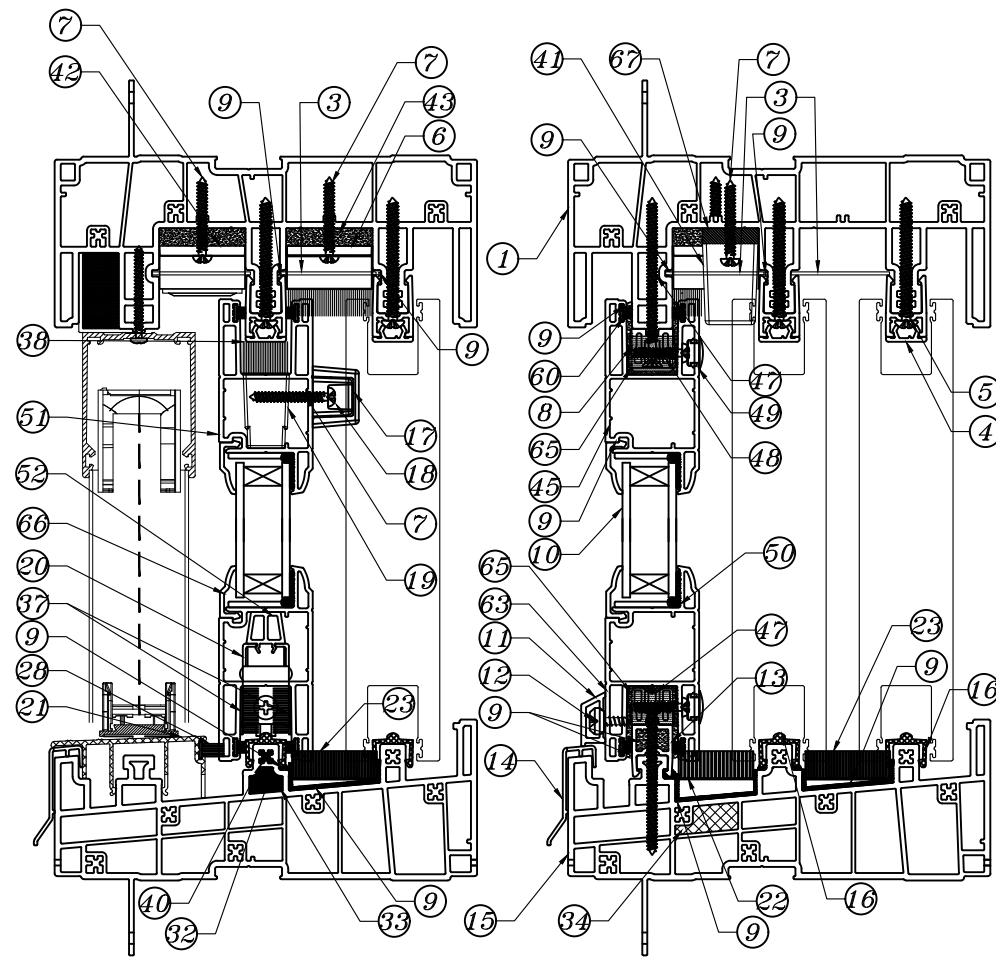

Section B-B

Section C-C

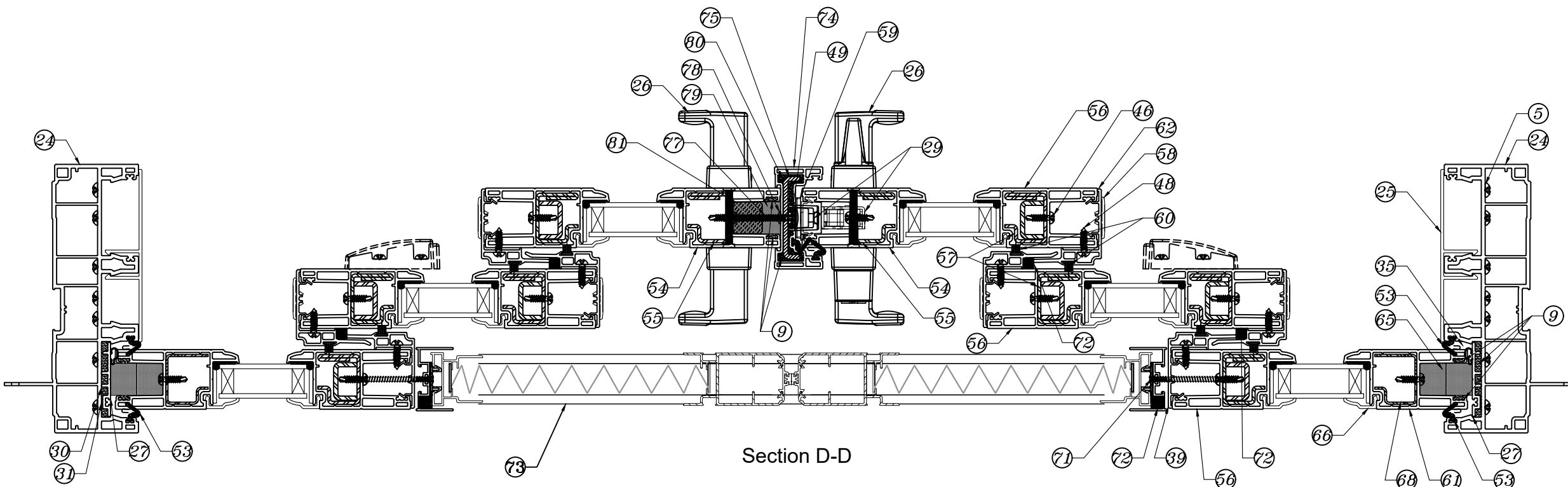
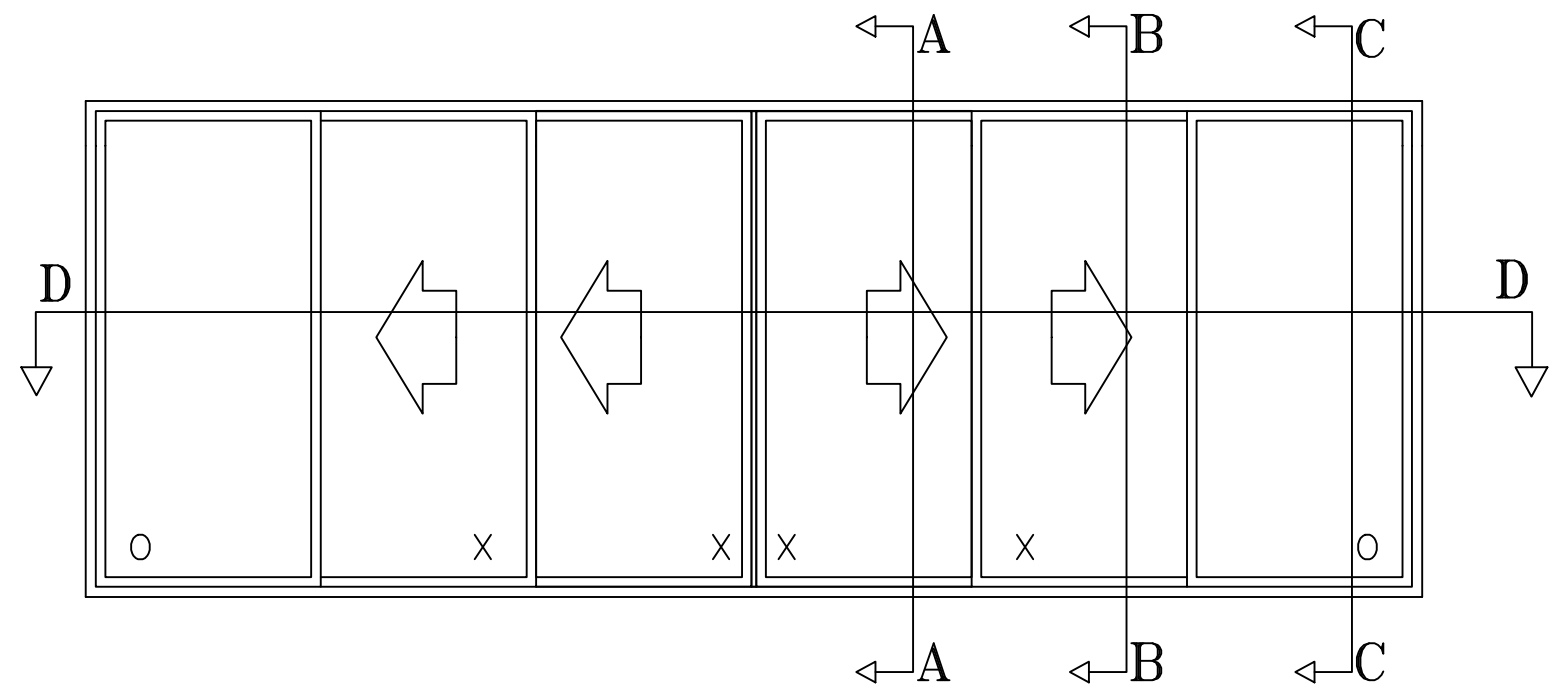

Section D-D

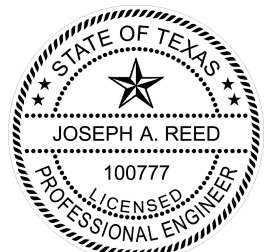

Joseph A. Reed, PE  
 TX PE 100777  
 5 Leigh Dr.  
 York, PA 17406  
 717-846-1200  
 Project 23550-1

*Joseph A. Reed*

2020.10.12 07:30:54 -04'00'

<b>5400/5400S/7700/9900 SGD</b> <b>Non-Impact</b> Sections and BOM	
<b>Wincore Windows &amp; Doors</b> 250 Staunton Turnpike Parkersburg, WV 26104	
Drawing No.: 23550-9-1001 Project No.: 23550-9 Drawn By: JAR    Rev: -    Date: 10/10/20	
Scale: NTS	Sheet 16 of 18



Item	PART No.	Item Description	Source
1	8352, 8302, 8312, 8322, 8332, 8362, 8372, 8382	Head track profile	P.H. Tech
2	8321	Head track	P.H. Tech
3	8323	Head Cover (Option)	P.H. Tech
4	8331	Head Cover Rail	P.H. Tech
5	8942.VIS10	No 10 x 2", Pan head, Phillips, SS Screw	P.H. Tech
6	703	Head Weatherseal block	P.H. Tech
7	8941	No. 8-18 x 1 1/4", Pan head, Quadrex screw	P.H. Tech
8	7003	Fixed sash anchor block	P.H. Tech
9		Sealant	Various
10		Glass	Various
11	6352	Drip Cap	P.H. Tech
12	8813.VIS10	No. 10-12 x 5/8", special mushroom head, Quadrex	P.H. Tech
13	8301	Fixed Rail Support	P.H. Tech
14	9730	Sill cladding	P.H. Tech
15	8350, 8300, 8310, 8320, 8330, 8360, 8370, 8380	Sill track profile	P.H. Tech
16	9708	Sliding rail	P.H. Tech
17	8389.58.CAPEV	Cap (bumper of the central mobile sash)	P.H. Tech
18	8389.04.ARREV	Bumper (central mobile sash)	P.H. Tech
19	8397	Mobile sash anchor block (welded)	P.H. Tech
20	9732	Tandem Wheel	P.H. Tech (Truth)
21	9718	Sill protector	P.H. Tech
22	8371	Sill weatherseal block (33mm)	P.H. Tech
23	8381	Sill Weatherseal block (37mm)	P.H. Tech
24	8354, 8304 8314, 8324, 8334, 8364, 8374, 8384	Jamb track profile	P.H. Tech
25	8313	Jamb cover	P.H. Tech
26	9748	Handle Kit	P.H. Tech (Roto Fasco)
27	8303	Bulb weatherstrip adaptor	P.H. Tech
28	9581 9575	Weatherstrip	Ultrafab #1-GB-42027045-GY Schlegel #HF-7532-270
29	9250	Mortise Lock / Keeper kit	P.H. Tech (Roto Fasco)
30	8378	Frame Corner Gasket (Sill)	P.H. Tech
31	8379	Frame Corner Gasket (Head)	P.H. Tech
32	8781	Rail foam plug	P.H. Tech
33	8782	Anti bug foam (rail)	P.H. Tech
34	8783	Anti bug foam (sill)	P.H. Tech
35	8784	Fixed sash foam bloc	P.H. Tech
36	8387	Sill protector foam gasket (mobile)	P.H. Tech
37	8786	Bottom weatherstrip (center sash)	P.H. Tech
38	8787	Top weatherstrip (center sash)	P.H. Tech
39	8377	Sill protector foam gasket	P.H. Tech
40	8788	Rail foam plug	P.H. Tech
41	8940	Bumper	P.H. Tech
42	8703	Head block	P.H. Tech

Item	PART No.	Item Description	Source
43	8373	Spacer for blocks 703/8703	P.H. Tech
44			
45	7508.F	Fixed horizontal rail	P.H. Tech
46	9867.VIS08	No. 8-10 x 5/8", pan head, quadrex self-drilling screw	P.H. Tech
47	9619.VIS08	No. 8-15 x 2 3/4", flat head, Quadrex, Wood screw	P.H. Tech
48	9796.VIS08	No. 8-10 x 5/8", pan head, quadrex screw	P.H. Tech
49	9667	Screw Cap	P.H. Tech
50	8933	Setting block (glass)	P.H. Tech
51	7508.M	Mobile horizontal rail	P.H. Tech
52	7541	Tandem Wheel setting block	P.H. Tech
53	9584	Weatherstrip	Amesbury/Truth Foamtile #32343
54	7507-M	Mobile side stile (>2080)	P.H. Tech
55	9597	Mobile side stile steel reinforcement (6sashes)	P.H. Tech
56	7526	Meeting stile (>2080)	P.H. Tech
57	9528	Meeting stile steel reinforcement (>2080)	P.H. Tech
58	8842	Sliding cap	P.H. Tech
59	7523	Groove cover	P.H. Tech
60	9550	Weatherstrip	Schlegel #HF-7522-270 Nap #RPHF027023
61	7587-F	Fixed side stile (>2080)	P.H. Tech
62	7026	Interlock	P.H. Tech
63	8395-L/R	Drip Cap Cover (Left/Right)	P.H. Tech
64			
65	9853	Foam plug	P.H. Tech
66	5770, 5771, 5772, 5775, 5792, 5793, 5796	Glazing bead	P.H. Tech
67	8789	Spacer for bumper	P.H. Tech
68	9598-F	Fixed side stile steel reinforcement (>2080)	P.H. Tech
69	1489	Head Moulding for MultiPD with Screen	P.H. Tech
70		No 6 x 1-1/2" Pan Quadrex	Interlock USA
71	9785.VIS08	No. 8-15 x 2", truss head, Quadrex, Wood screw	P.H. Tech
72	8989	Compression Joint Foam Block	P.H. Tech
73	8335	Retractable screen (AIRE Slim or AIRE Grand)	Interlock USA
74	8326	Astragal	P.H. Tech
75	8760	Astragal steel reinforcement	P.H. Tech
76	9655	Astragal sealant	P.H. Tech
77	8772	No. 8 x 2", flat head, Quadrex screw, self drilling	P.H. Tech
78	8709	5/32 pop-rivet	P.H. Tech
79	9873	Corner block	P.H. Tech
80	8771	Astragal foam block	P.H. Tech
81	9135	Mullion block (2X)	P.H. Tech
* 82	Opti884	Weatherstrip	Amesbury/Truth Foamtile #32343

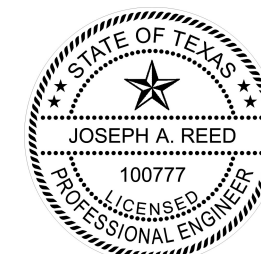

Joseph A. Reed, PE  
TX PE 100777  
5 Leigh Dr.  
York, PA 17406  
717-846-1200  
Project 23550-1

*Joseph A. Reed*

2020.10.12 07:30:54 -04'00'

**5400/5400S/7700/9900 SGD**  
**Non-Impact**  
**Sections and BOM**  
**Wincore Windows & Doors**  
250 Staunton Turnpike  
Parkersburg, WV 26104

Drawing No.: 23550-9-1001  
Project No.: 23550-9  
Drawn By: JAR Rev: - Date: 10/10/20

Scale: NTS

Sheet 17 of 18

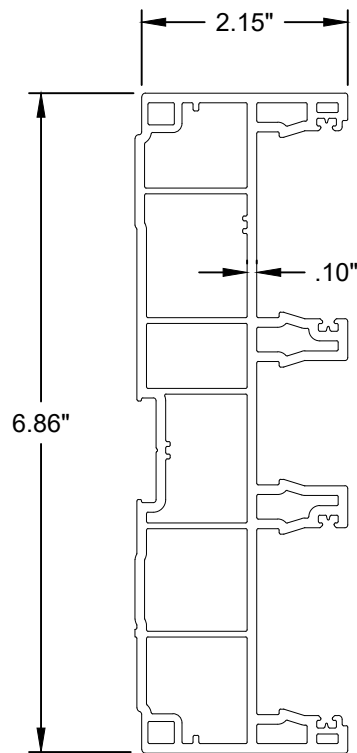

JAMB TRACK  
PVC

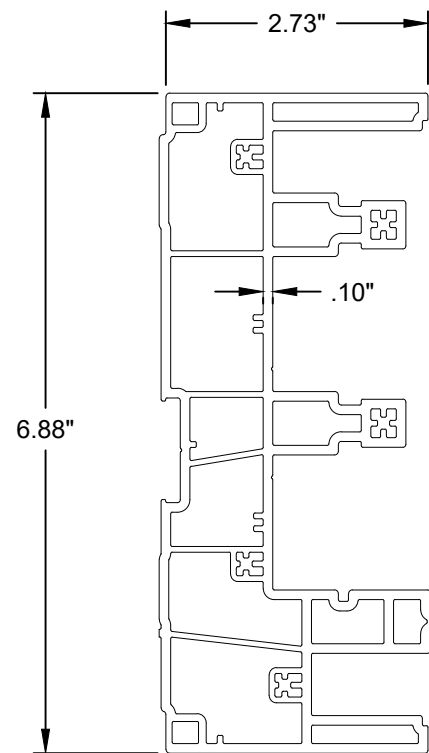

HEAD TRACK  
PVC

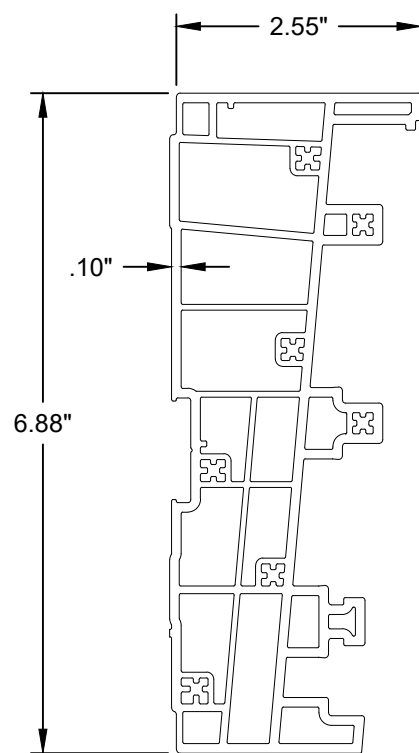

SILL TRACK  
PVC

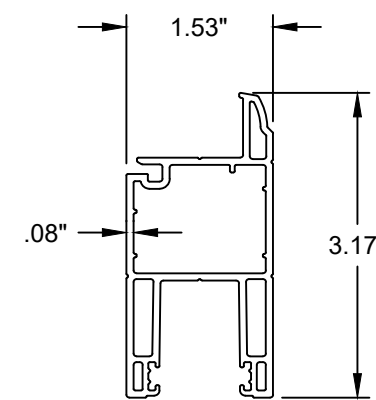

STILE/RAIL  
PVC

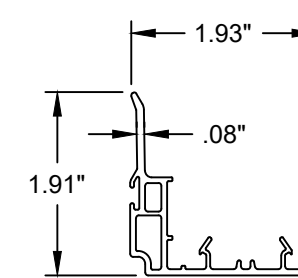

INTERLOCK  
PVC

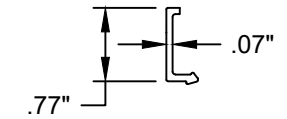

GLAZING BEAD  
PVC

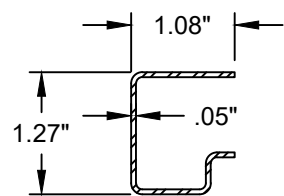

STILE REINFORCEMENT  
STEEL

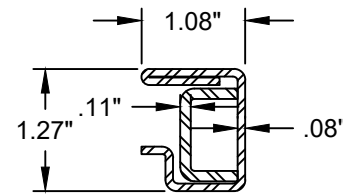

MEETING STILE REINFORCEMENT  
STEEL

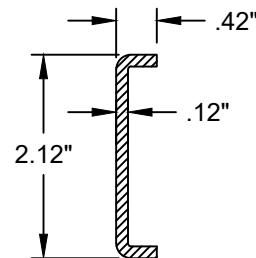

ASTRAGAL REINFORCEMENT  
STEEL

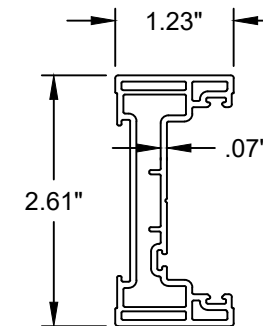

ASTRAGAL  
PVC

Joseph A. Reed, PE  
TX PE 100777  
5 Leigh Dr.  
York, PA 17406  
717-846-1200  
Project 23550-1

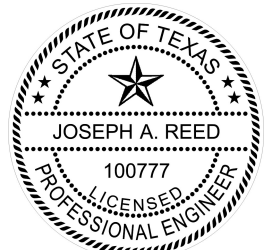

*Joseph A. Reed*

2020.10.12 07:30:54 -04'00'

**5400/5400S/7700/9900 SGD**  
**Non-Impact**  
**Components**

**Wincore Windows & Doors**  
250 Staunton Turnpike  
Parkersburg, WV 26104

Drawing No.: 23550-9-1001  
Project No.: 23550-9  
Drawn By: JAR Rev: - Date: 10/10/20

Scale: NTS

Sheet 18 of 18

HARDWARE	
ITEM	LOCATION
HANDLE KIT (ROTO) WITH 2-POINT LOCK	LOCK STILES
MORTISE LOCK AND METAL KEEPER	LOCK STILES
NYLON ROLLER WITH METAL HOUSING	EACH END OF BOTTOM RAIL
ALUMINUM ROLLER GUIDE	SILL TRACK