



868 MURRAY ROAD, DOTHAN, AL 36303

# "REDIFRAME PD" HOLLOW METAL FRAME IN SWING/OUT SWING "IMPACT"

**EVALUATED FOR USE IN THE STATE OF TEXAS**

The Steel Door Frame system described herein complies with the 2018 International Residential Code (IRC), Sections R301 & R609 and the 2018 International Building Code (IBC), Sections 1404.13, 1609, 1709.5, 2403 and 2404 subject to the following conditions:

1. Anchors shall be as listed and spaced as shown in the details. Anchor embedment to base material shall be beyond wall dressing or stucco.
2. When used in areas requiring wind-borne debris protection, this system is required to be protected with an impact resistant covering that complies with Section R301.2.1.2 of the IRC and Section 1609.2 of the IBC.
3. Allowable design pressure requirements must be equal to or less than the design pressure rating shown in the design pressure chart, sheet 1 of this drawing.
4. Conditions not covered by this drawing are subject to further engineering analysis.

TABLE OF CONTENTS	
SHEET #	DESCRIPTION
1	Typical elevations, design pressures, & general notes
2	Door panel details
3	Door panel details
4	Elevations & vertical cross sections
5	Horizontal cross sections
6	Frame anchoring
7	Bill of materials & components

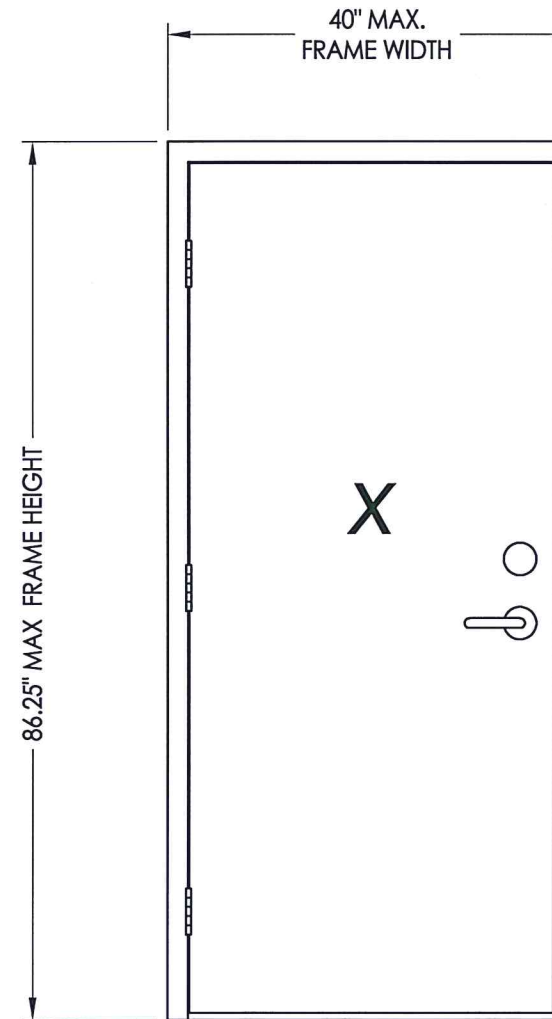

MAX. OVERALL DIMENSION	DESIGN PRESSURE (PSF) INSWING		DESIGN PRESSURE (PSF) OUTSWING	
	POSITIVE	NEGATIVE	POSITIVE	NEGATIVE
40.0" X 86.25"	+65.0	-65.0	+65.0	-65.0

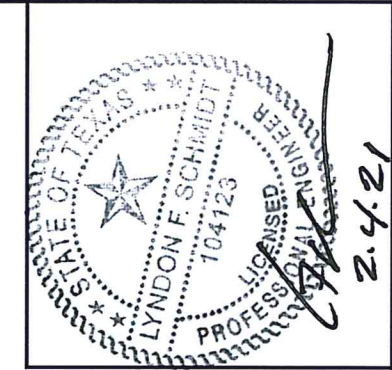

Documents Prepared By: Lyndon F. Schmidt, P.E.  
TEXAS P.E. #104123

RW BUILDING CONSULTANTS, INC.  
P.O. Box 230 Valrico FL 33595  
Phone No.: 813.659.9197

TEXAS BOARD OF PROFESSIONAL ENGINEERS  
CERTIFICATE OF REGISTRATION # F-11852

PRODUCT: DUNBARTON  
PART OR ASSEMBLY:  
TYPICAL ELEVATIONS, DESIGN PRESSURES & GENERAL NOTES

NO.	DATE	BY	REVISIONS

DATE: 2/01/21  
SCALE: N.T.S.  
DWG. BY: RW  
CHK. BY: LFS  
DRAWING NO.: TX-5150  
SHEET 1 OF 7

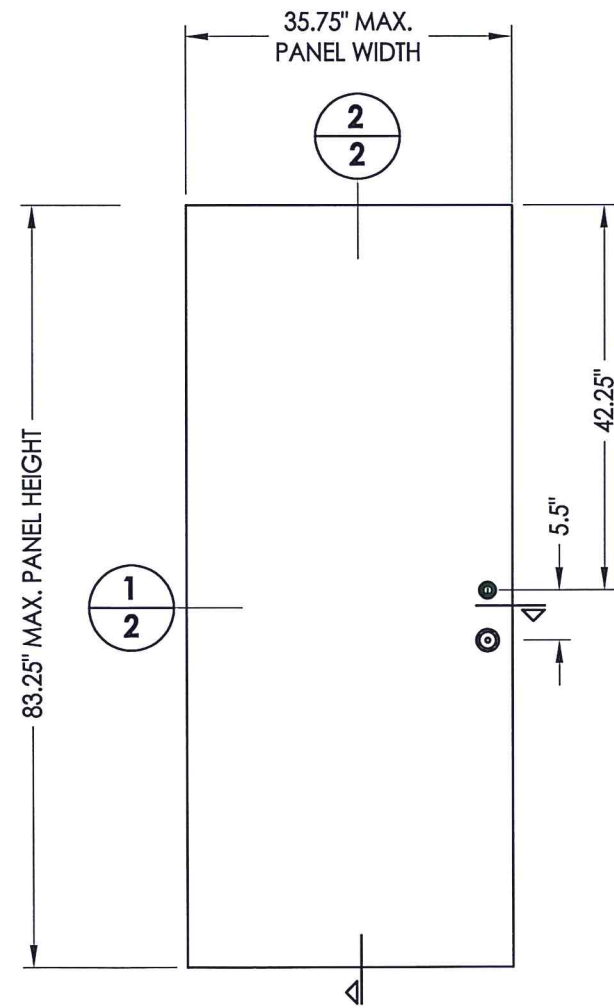
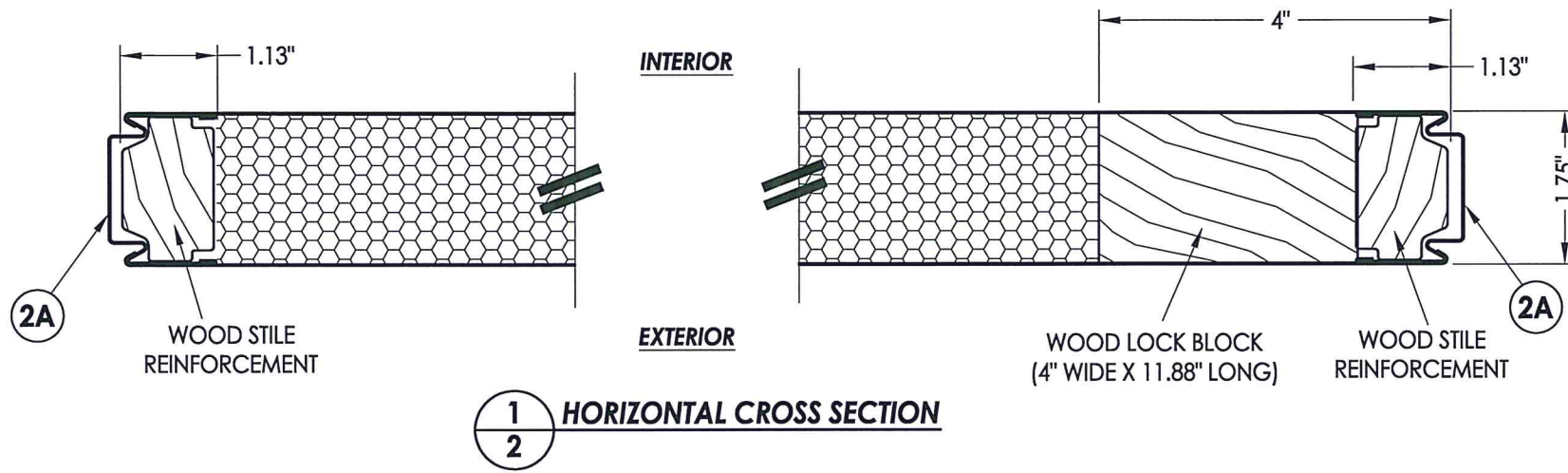

**40** 7'-0" STEEL DOOR PANEL  
JELD-WEN

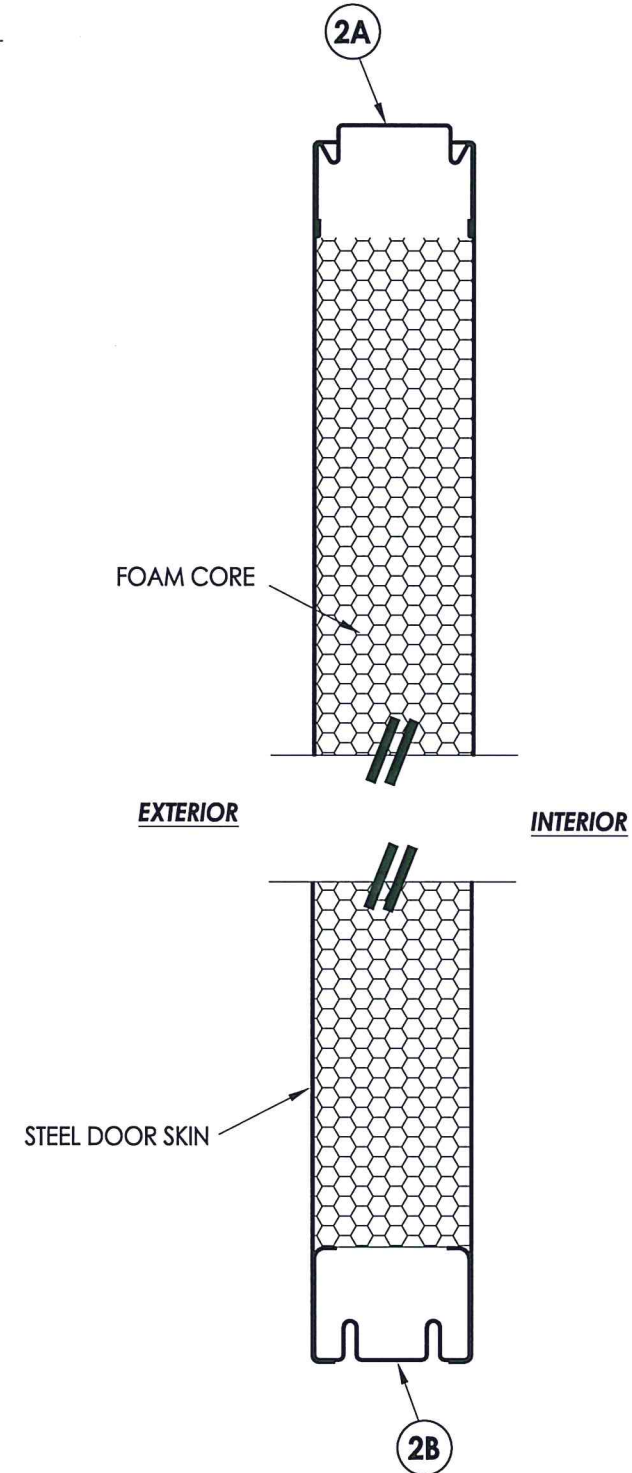
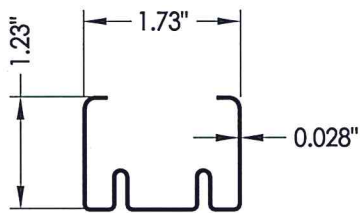
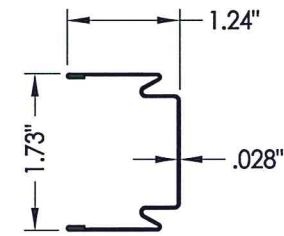

DOOR SKIN: 0.022" MIN. THK. GALV. STEEL  
FOAM CORE: POLYSTYRENE



Documents Prepared By: Lyndon F. Schmidt, P.E.  
TEXAS P.E. #104123

**RW** BUILDING CONSULTANTS, INC.  
P.O. Box 230 Valrico FL 33595  
Phone No.: 813.659.9197

TEXAS BOARD OF PROFESSIONAL ENGINEERS  
CERTIFICATE OF REGISTRATION # F-11852

PRODUCT:	DUNBARTON
PART OR ASSEMBLY:	DOOR PANEL DETAILS

NO.	DATE	BY

DATE:	2/01/21
SCALE:	N.T.S.
DWG. BY:	RW
CHK. BY:	LFS
DRAWING NO.:	TX-5150
SHEET	2 OF 7



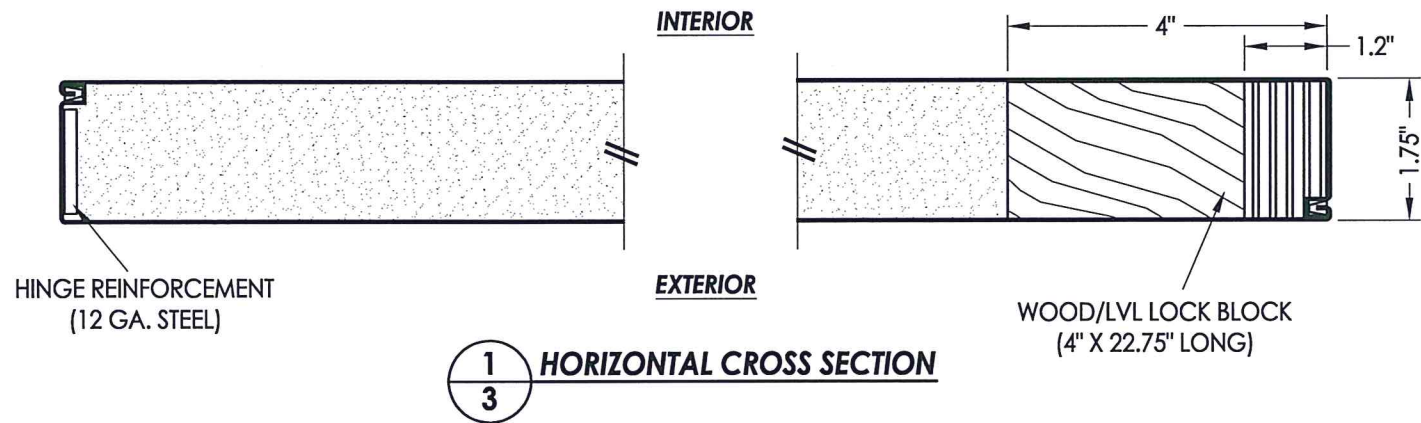

**1**  
**3** **HORIZONTAL CROSS SECTION**

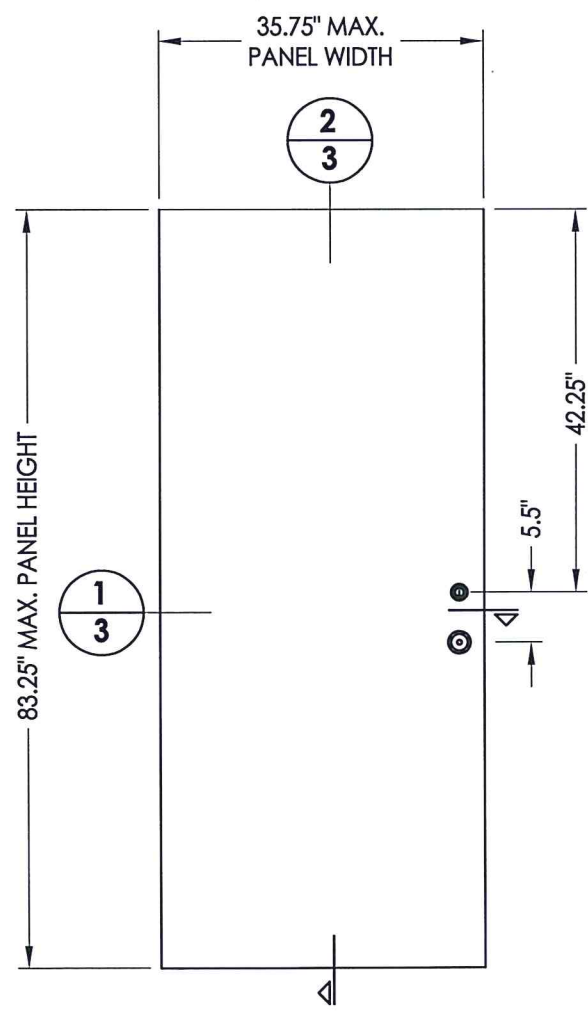

**41** **7'-0\"/>**

DOOR SKIN: 0.022\"/>

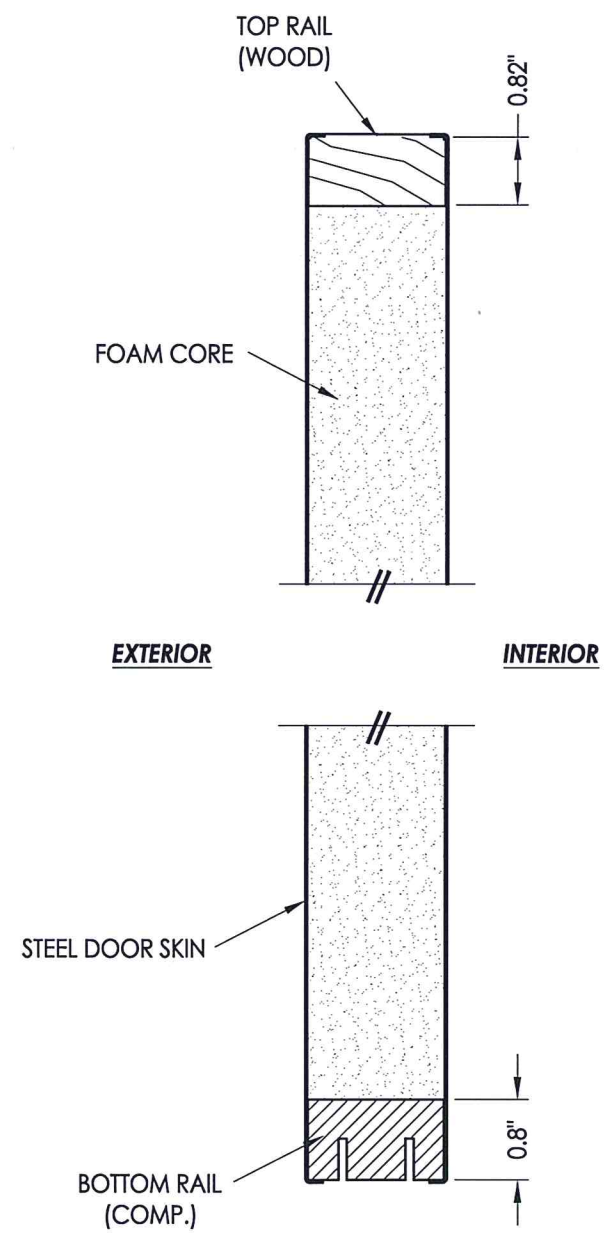

**2**  
**3** **VERTICAL CROSS SECTION**



Documents Prepared By: Lyndon F. Schmidt, P.E.  
TEXAS P.E. #104123

**RW** BUILDING CONSULTANTS, INC.  
P.O. Box 230 Valrico FL, 33595  
Phone No.: 813.659.9197

TEXAS BOARD OF PROFESSIONAL ENGINEERS  
CERTIFICATE OF REGISTRATION # F-11852

PRODUCT:	DUNBARTON
PART OR ASSEMBLY:	DOOR PANEL DETAILS

NO.	DATE	BY	REVISIONS

DATE:	2/01/21
SCALE:	N.T.S.
DWG. BY:	RW
CHK. BY:	LFS
DRAWING NO.:	TX-5150
SHEET	3 OF 7

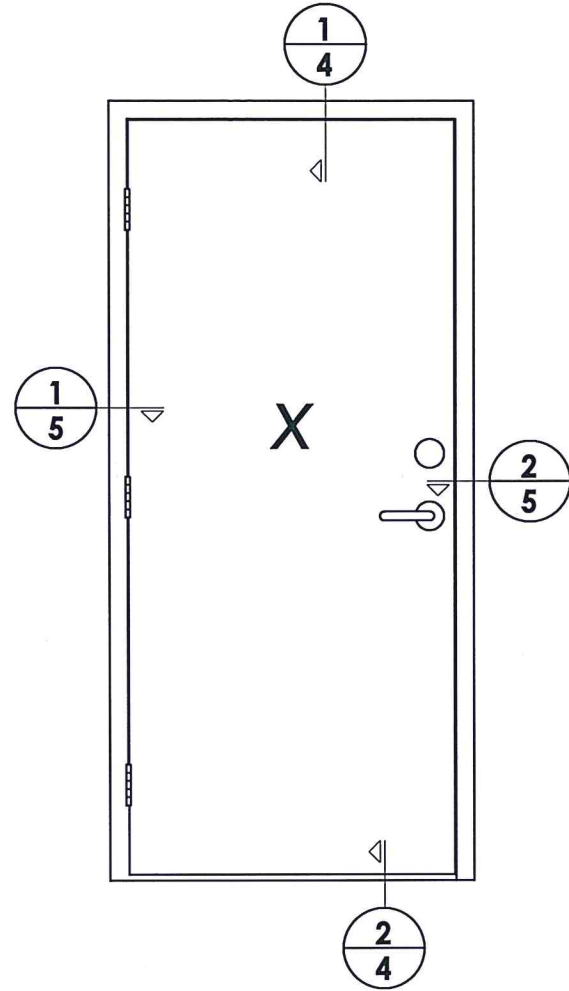

LOCK HARDWARE	
LATCH:	SCHLAGE (J10SOL)
DEADBOLT:	KWIKSET SIGNATURE SERIES (780)

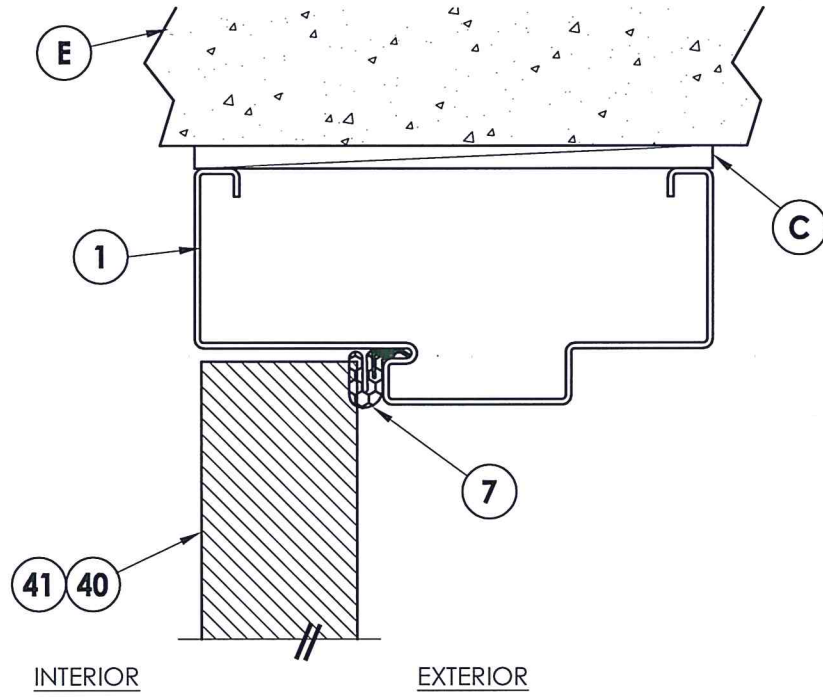

**1**  
**4** **VERTICAL CROSS SECTION**  
Inswing Shown (Outswing Similar)

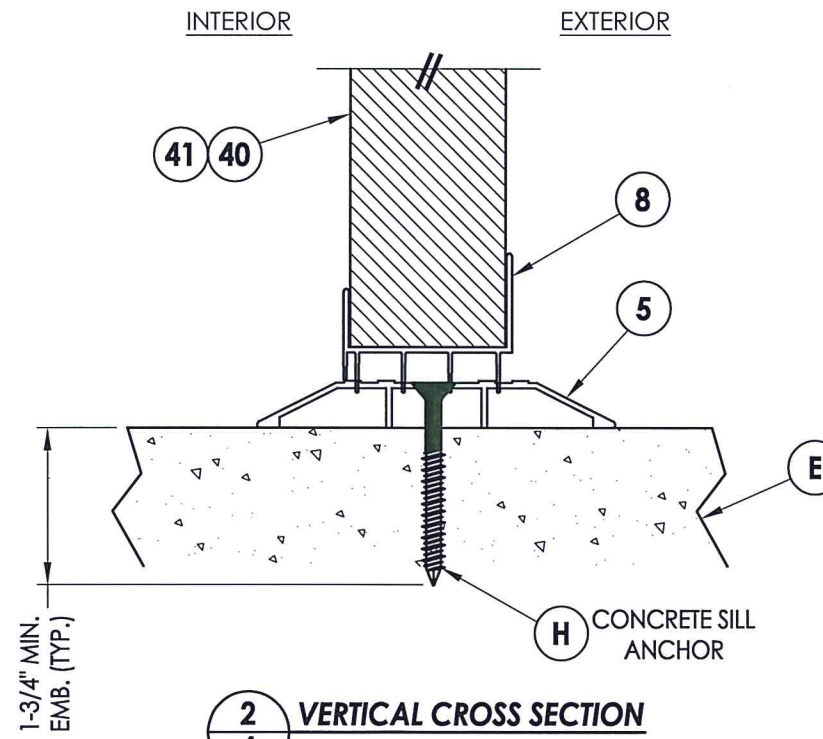

**2**  
**4** **VERTICAL CROSS SECTION**

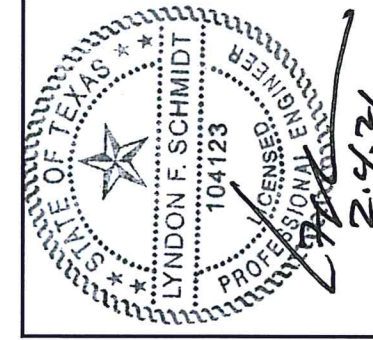

Documents Prepared By: Lyndon F. Schmidt, P.E.  
TEXAS P.E. #104123

**RW** BUILDING CONSULTANTS, INC.  
P.O. Box 230 Valrico FL 33595  
Phone No.: 813.659.9197

TEXAS BOARD OF PROFESSIONAL ENGINEERS  
CERTIFICATE OF REGISTRATION # F-11852

PRODUCT: DUNBARTON	
PART OR ASSEMBLY: ELEVATION & VERTICAL CROSS SECTIONS	
NO.	DATE
BY	REVISIONS
DATE: 2/01/21	
SCALE: N.T.S.	
DWG. BY: RW	
CHK. BY: LFS	
DRAWING NO.: TX-5150	
SHEET 4 OF 7	





FRAME CORNER:  
KNOCK DOWN TABS  
OR FACE WELDED

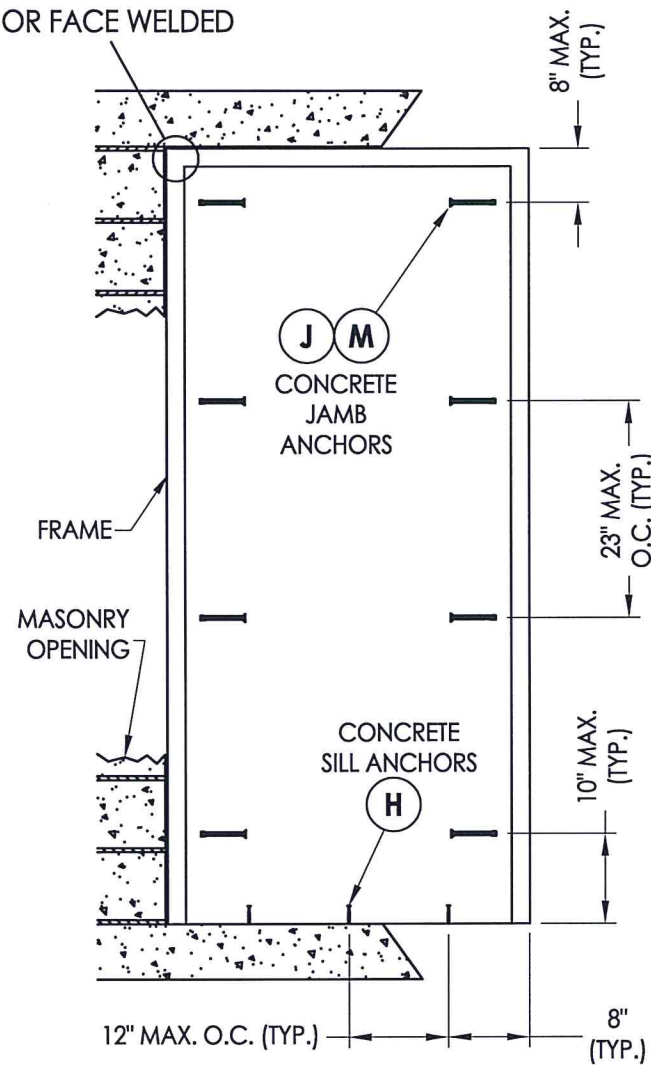

**FRAME ANCHORING**  
Masonry Construction  
Concrete Anchors

WOOD STUD FRAMING  
(BY OTHERS)

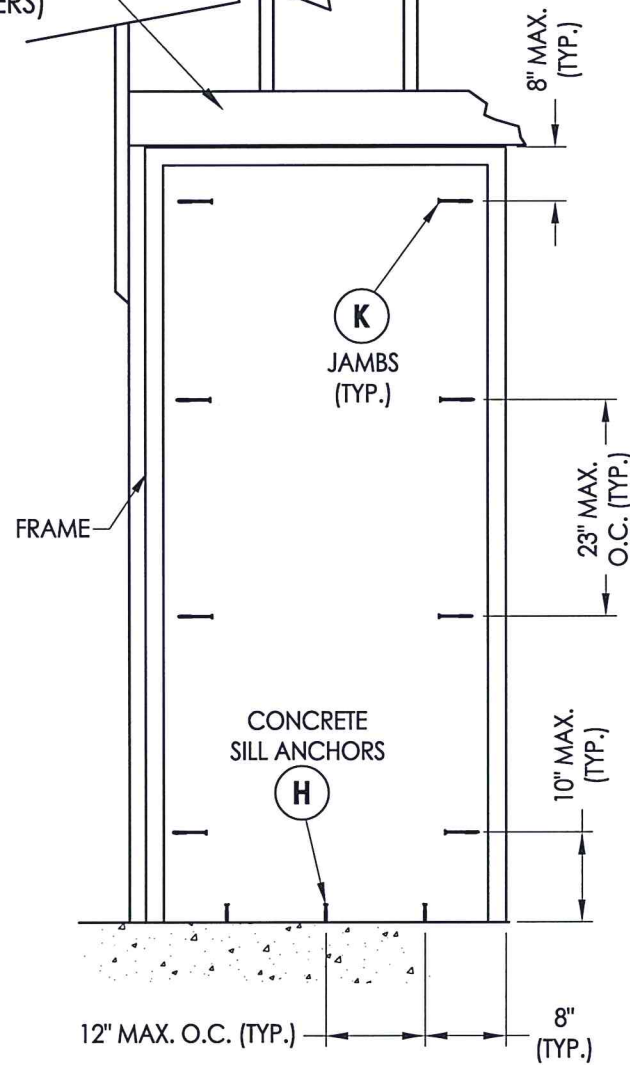

**FRAME ANCHORING**  
Wood Stud

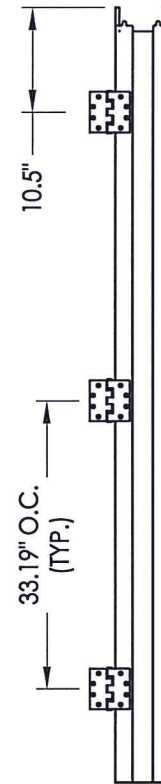

**HINGE JAMB**

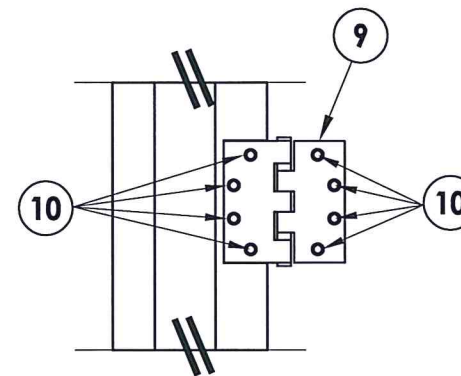

**HINGE DETAIL**

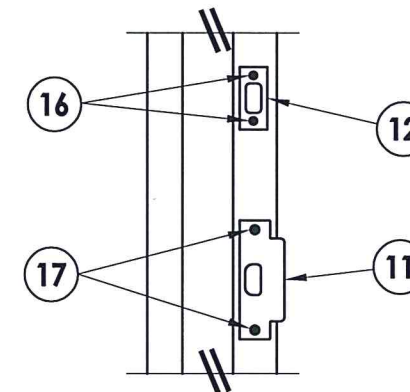

**STRIKE DETAIL**  
Latch & Deadbolt

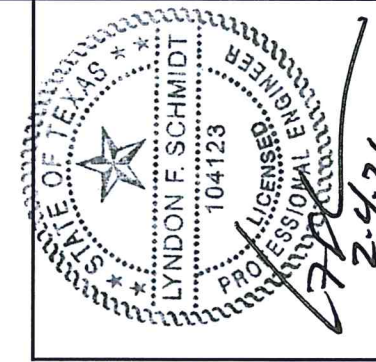

Documents Prepared By: Lyndon F. Schmidt, P.E.  
TEXAS P.E. #104123

**RW** BUILDING CONSULTANTS, INC.  
P.O. Box 230 Valrico FL 33595  
Phone No.: 813.659.9197

TEXAS BOARD OF PROFESSIONAL ENGINEERS  
CERTIFICATE OF REGISTRATION # F-11852

PRODUCT: DUNBARTON

PART OR ASSEMBLY: FRAME ANCHORING

NO.	DATE	BY	REVISIONS

DATE: 2/01/21  
SCALE: N.T.S.  
DWG. BY: RW  
CHK. BY: LFS  
DRAWING NO.: TX-5150  
SHEET 6 OF 7

**CONCRETE ANCHOR NOTES:**

- Concrete screw locations at the corners may be adjusted to maintain a minimum 1" edge distance to mortar joints. If concrete screw locations noted as "MAX. O.C." must be adjusted to maintain the minimum edge distance to mortar joints, additional concrete screws may be required to ensure the maximum on center dimension is not exceeded.
- Concrete anchor table:

ANCHOR TYPE	ANCHOR LOCATION	ANCHOR SIZE	MANUFACTURER	MIN. EDGE DISTANCE	MIN. EMBEDMENT
CONCRETE ANCHOR SCREW	JAMBS	3/8"	LDT TAPCON® (ITW BUILDEX)	3"	1-1/2"
	SILL	1/4"	TAPCON® (ITW BUILDEX) ULTRACON+® (DeWALT)	2-1/2"	1-3/4"
CONCRETE SLEEVE ANCHOR	JAMBS	3/8"	DYNABOLT SLEEVE ANCHOR® (ITW REDHEAD)	2-1/4"	1-1/2"



**BILL OF MATERIALS**

ITEM #	DESCRIPTION	MATERIAL
B	2X STUD FRAMING (G>= 0.55)	WOOD
C	1/4" MAX. SHIM SPACE	-
E	MASONRY - 3,000 PSI MIN. CONCRETE CONFORMING TO ACI 301 OR HOLLOW BLOCK (GROUT FILLED) CONFORMING TO ASTM C90	CONCRETE
H	1/4" X 2-1/4" PFH CONCRETE SCREW (SEE CONCRETE ANCHOR TABLE)	STEEL
J	3/8" X 5" PFH DYNABOLT SLEEVE ANCHOR (SEE CONCRETE ANCHOR TABLE)	STEEL
K	3/8" X 5" FH LAG SCREW (2-1/8" MIN. EMBEDMENT)	STEEL
M	3/8" X 5" LDT TAPCON CONCRETE SCREW (SEE CONCRETE ANCHOR TABLE)	STEEL
1	HOLLOW METAL FRAME	STEEL
5	ADA THRESHOLD	ALUM
7	WEATHERSTRIP	-
8	DOOR SWEEP	-
9	HINGE 4" X 4"	STEEL
10	#12-24 X 1/2" FH MACHINE SCREW	STEEL
11	LATCH STRIKE PLATE	STEEL
12	DEADBOLT STRIKE PLATE	STEEL
16	#8 X 3/4" FH SCREWS	STEEL
17	#12 X 1" FH SCREWS	STEEL
20	HINGE REINFORCEMENT (12 GA.)	STEEL
30	EXPANSION ANCHOR BRACKET(18 GA)	STEEL
40	STEEL DOOR PANEL (7'-0" DOOR JELD-WEN)	STEEL
41	STEEL DOOR PANEL (7'-0" DOOR MASONITE)	STEEL

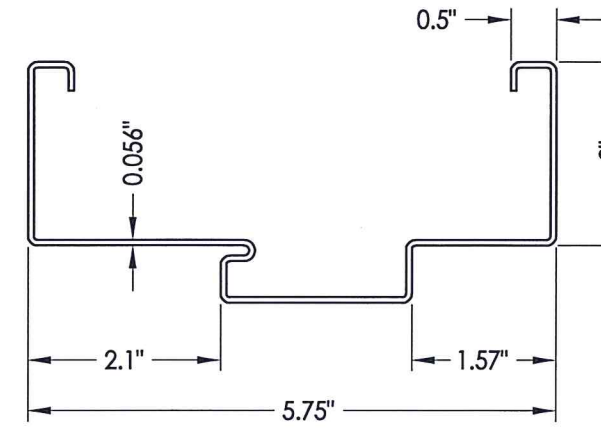

**1 HOLLOW METAL FRAME**  
16 GA. GALV. STEEL

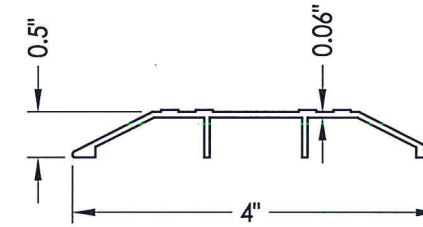

**5 ADA THRESHOLD**  
DLP ISHC

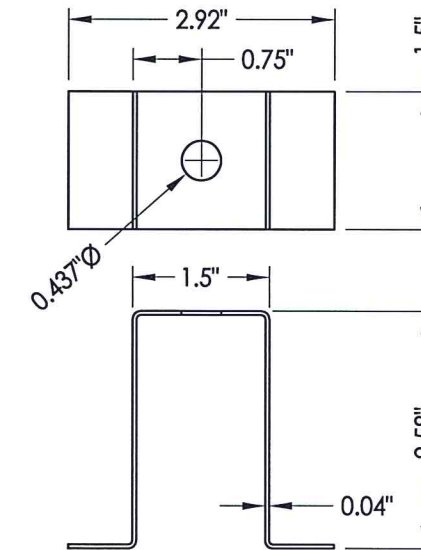

**30 EXPANSION ANCHOR**  
Bracket

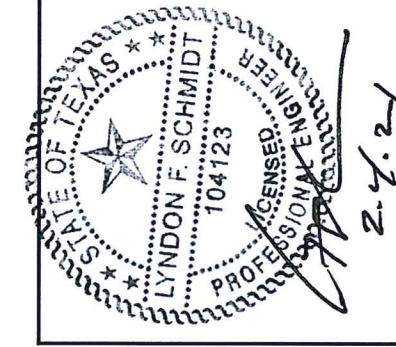

Documents Prepared By: Lyndon F. Schmidt, P.E.  
TEXAS P.E. #104123

**RW** BUILDING CONSULTANTS, INC.  
P.O. Box 230 Vairico FL 33595  
Phone No.: 813.659.9197

TEXAS BOARD OF PROFESSIONAL ENGINEERS  
CERTIFICATE OF REGISTRATION # F-11852

PRODUCT: DUNBARTON  
PART OR ASSEMBLY: BILL OF MATERIALS & COMPONENTS

NO.	DATE	BY	REVISIONS

DATE: 2/01/21  
SCALE: N.T.S.  
DWG. BY: RW  
CHK. BY: LFS  
DRAWING NO.: TX-5150  
SHEET 7 OF 7