

Z:\Clients\Endura PERMANENT\B - Texas Dept of Ins\TDI - DR-1021 Flush GLZ Plastpro FG door (4910-4915)\C - Drawings\TX-4911,12,14,15.dwg

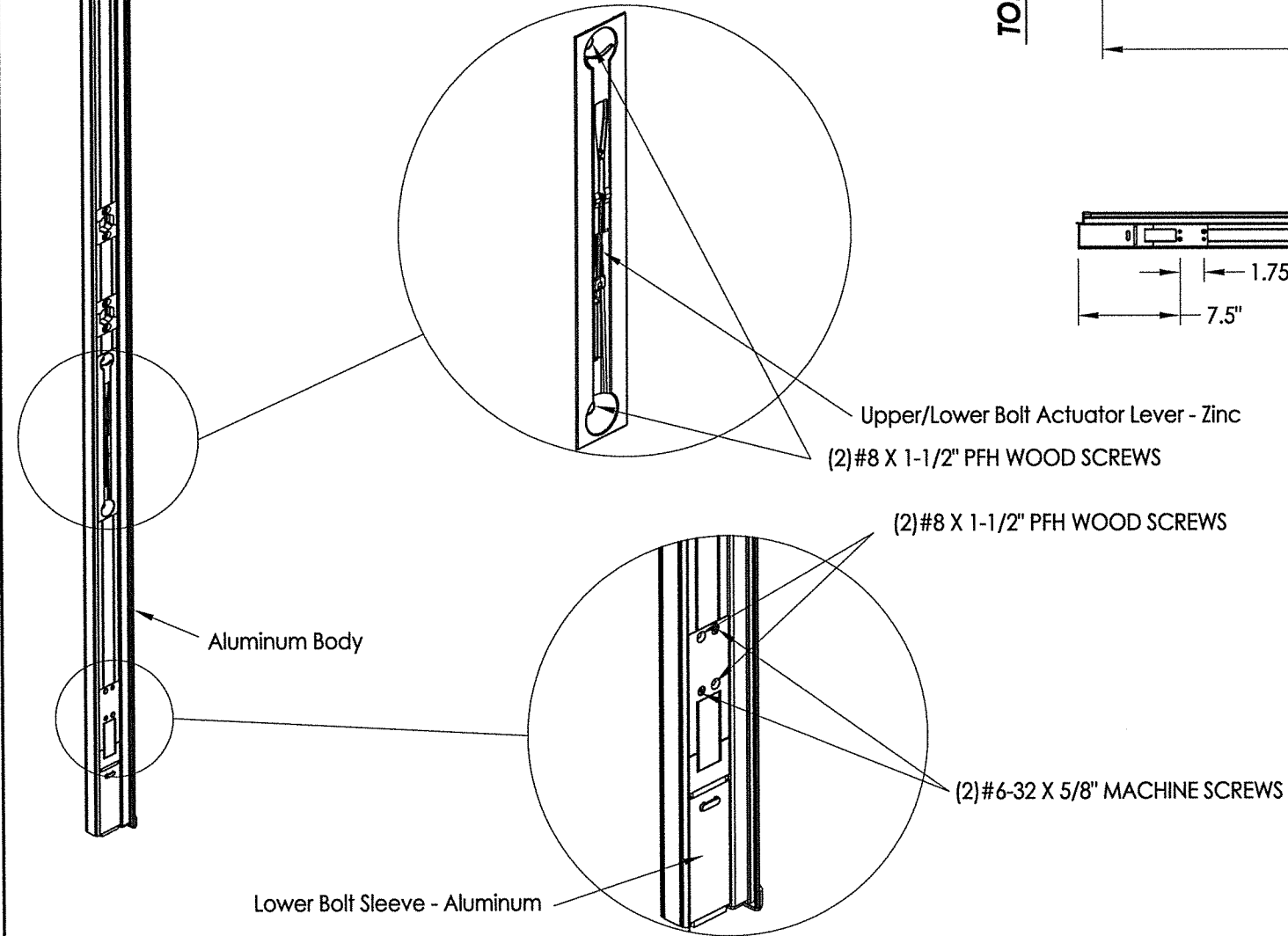

ULTIMATE FLIP LEVER ASTRAGAL

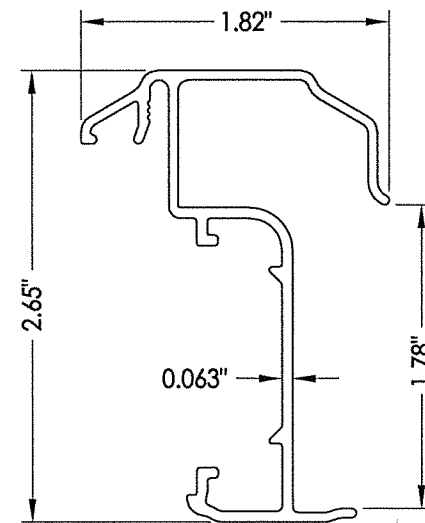
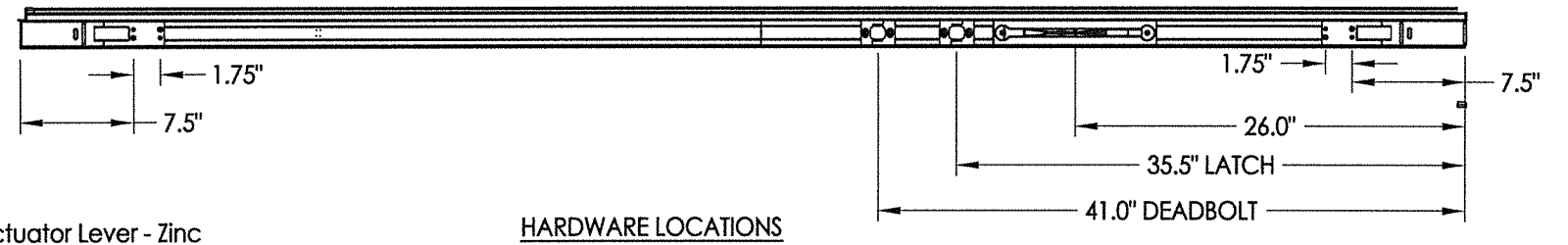
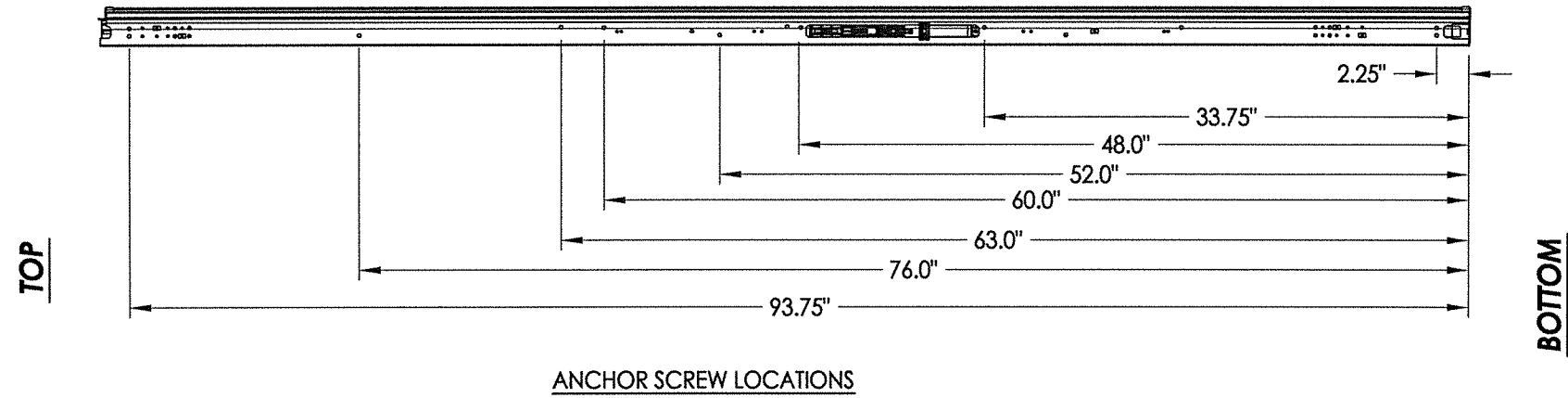
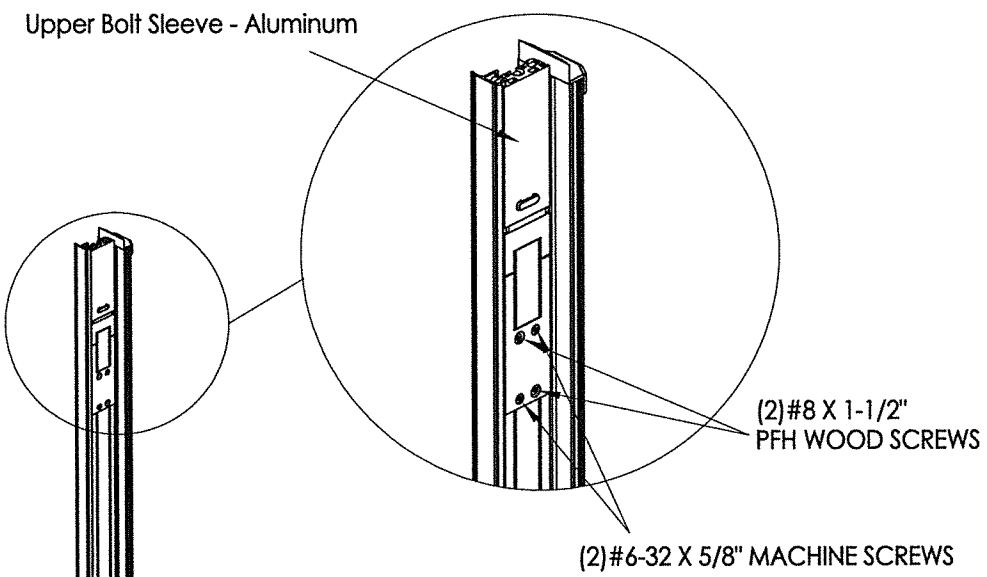
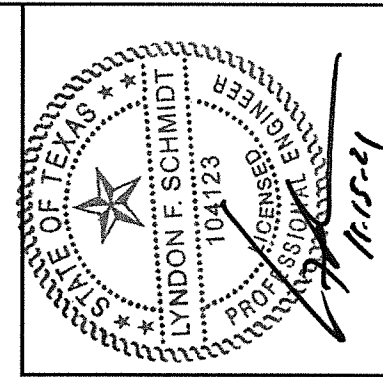

Documents Prepared By: Lyndon F. Schmidt, P.E.
TEXAS P.E. #104123

RW BUILDING CONSULTANTS, INC.
P.O. Box 230 Vairico FL 33595
Phone No.: 813.659.9197
TEXAS BOARD OF PROFESSIONAL ENGINEERS
CERTIFICATE OF REGISTRATION # F-11852

PRODUCT: ENDURA

PART OR ASSEMBLY: ASTRAGAL DETAILS (ULTIMATE FLIP LEVER)

| NO. | DATE | REVISIONS |
|-----|----------|-----------------------------|
| 1 | 11/10/21 | UPDATE TO 2018 IBC/IRC CODE |
| | | LFS |
| | | BY |

DATE: 11/8/18

SCALE: N.T.S.

DWG. BY: MT

CHK. BY: LFS

DRAWING NO.: TX-4915

SHEET 2 OF 8

Z:\Clients\Endura PERMANENT\B - Texas Dept of Ins\TDI - DR-1021 Flush GLZ Plastpro FG door (4910-4915)\C - Drawings\TX-4911,12,14,15.dwg

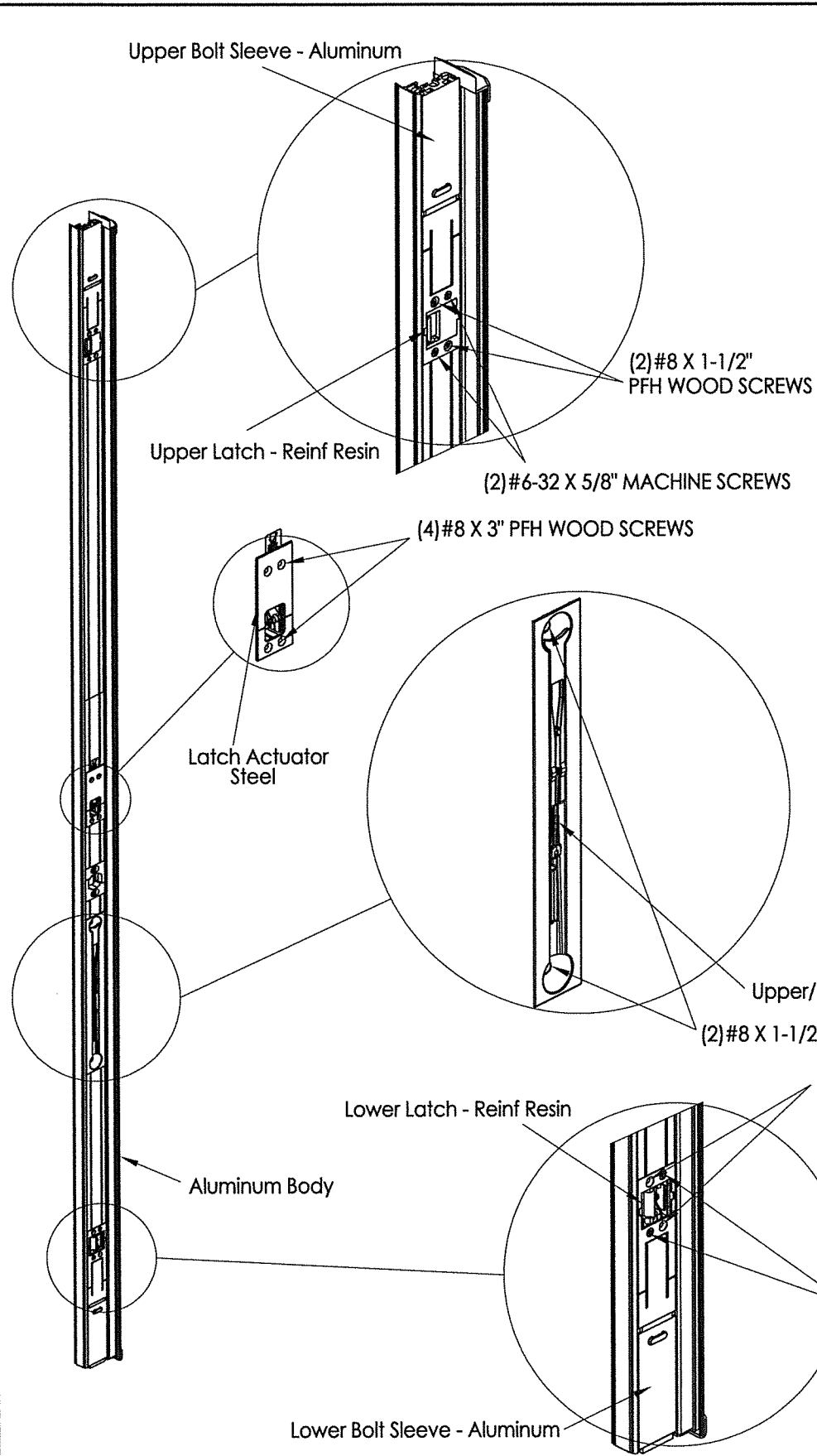

ULTIMATE MULTI-POINT ASTRAGAL

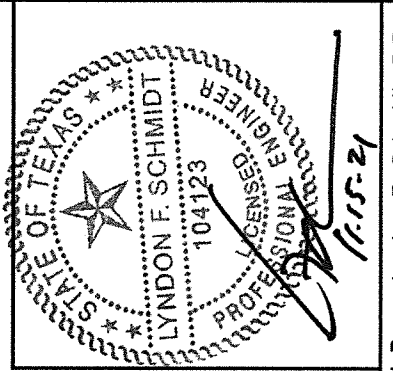
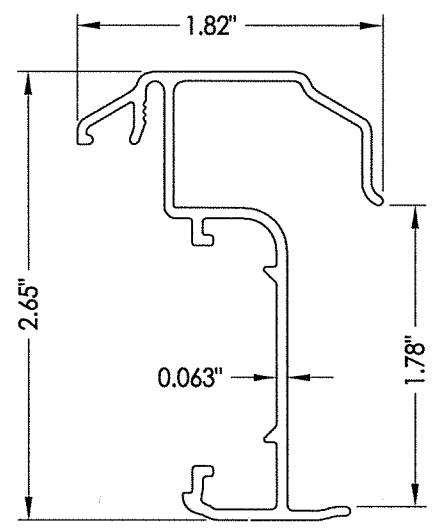
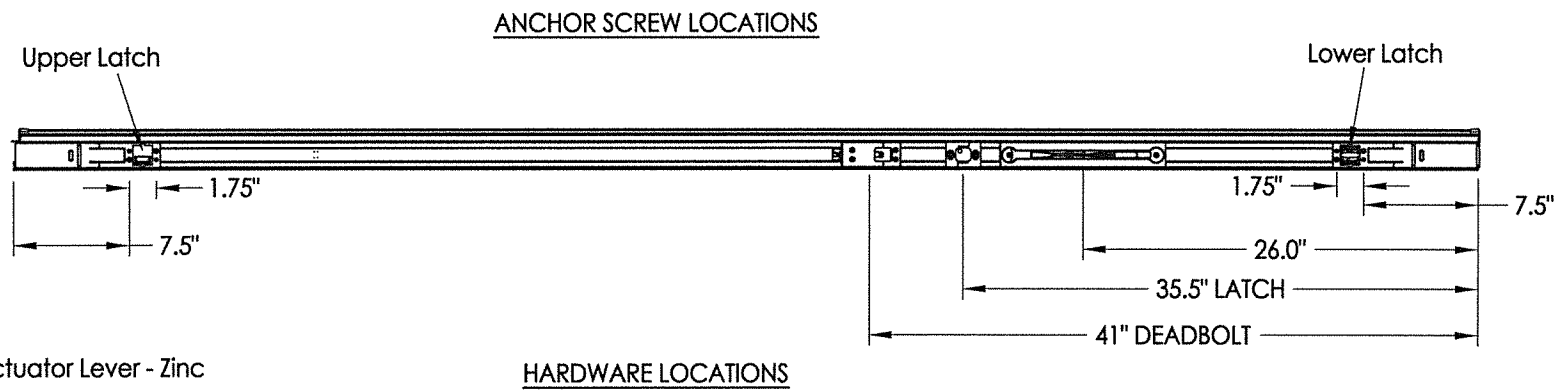
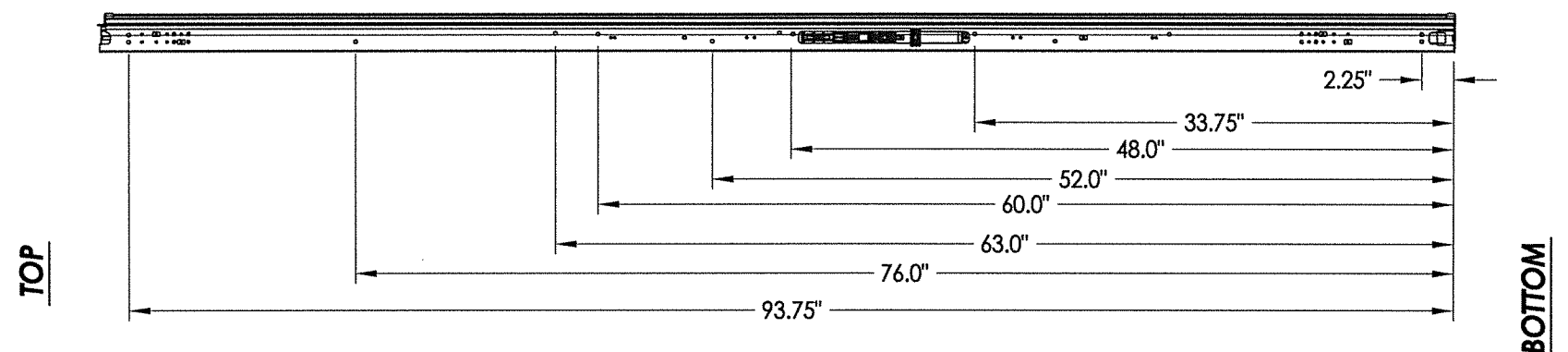

Documents Prepared By: Lyndon F. Schmidt, P.E.
 TEXAS P.E. #104123

R.W. BUILDING CONSULTANTS, INC.
 P.O. Box 230 Vairico FL, 33595
 Phone No.: 813.659.9197

TEXAS BOARD OF PROFESSIONAL ENGINEERS
 CERTIFICATE OF REGISTRATION # F-11852

| | |
|-------------------|--|
| PRODUCT: | ENDURA |
| PART OR ASSEMBLY: | ASTRAGAL DETAILS (ULTIMATE MULTI-POINT) |

| NO. | DATE | REVISIONS | BY |
|-----|----------|-----------------------------|-----|
| 1 | 11/10/21 | UPDATE TO 2018 IBC/IRC CODE | LFS |

| | |
|--------------|---------|
| DATE: | 11/8/18 |
| SCALE: | N.T.S. |
| DWG. BY: | MT |
| CHK. BY: | LFS |
| DRAWING NO.: | TX-4915 |
| SHEET | 3 OF 8 |

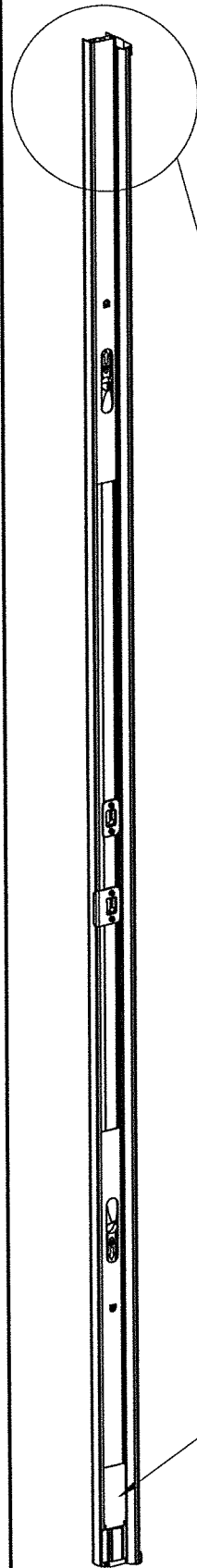

ULTIMATE HURRICANE ASTRAGAL

(2) #8 X 1-5/8" PFH WOOD SCREWS
UPPER BOLT SLEEVE (REINF. POLYMER)

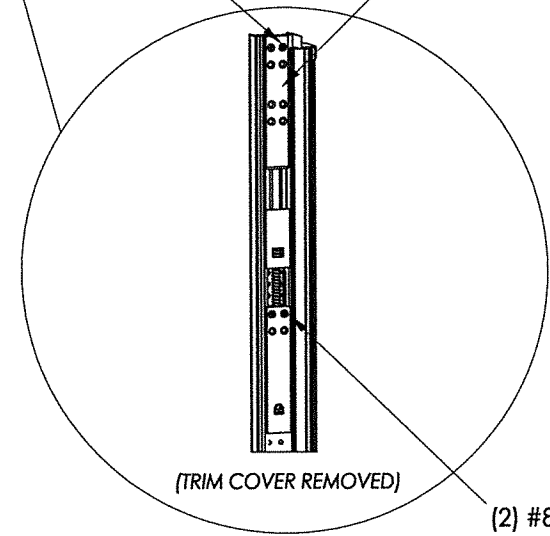

(2) #8 X 1-5/8" PFH WOOD SCREWS

LOWER BOLT SLEEVE (REINF. POLYMER)

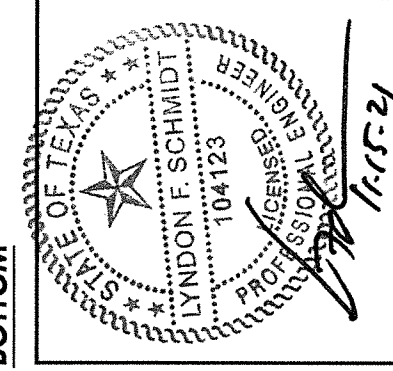
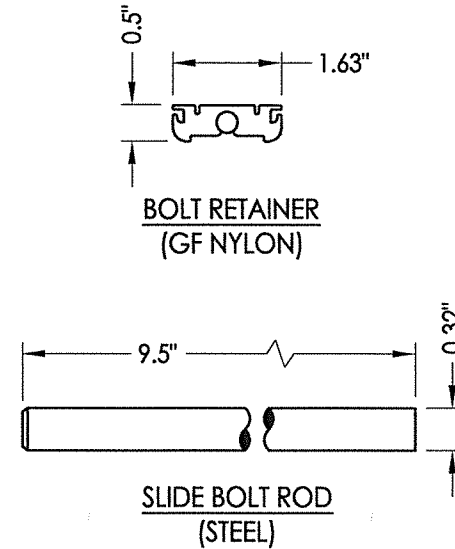
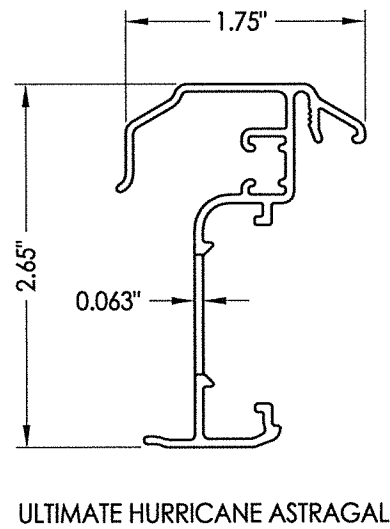
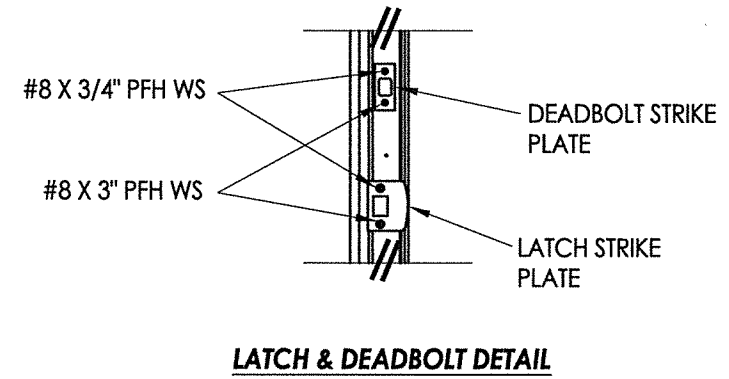
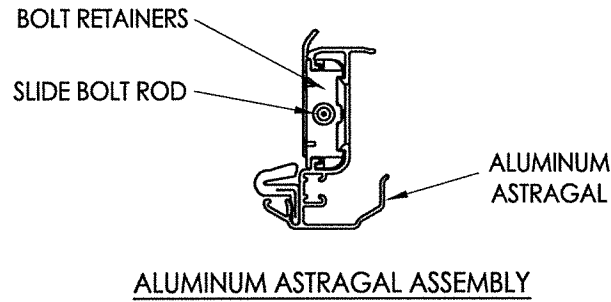
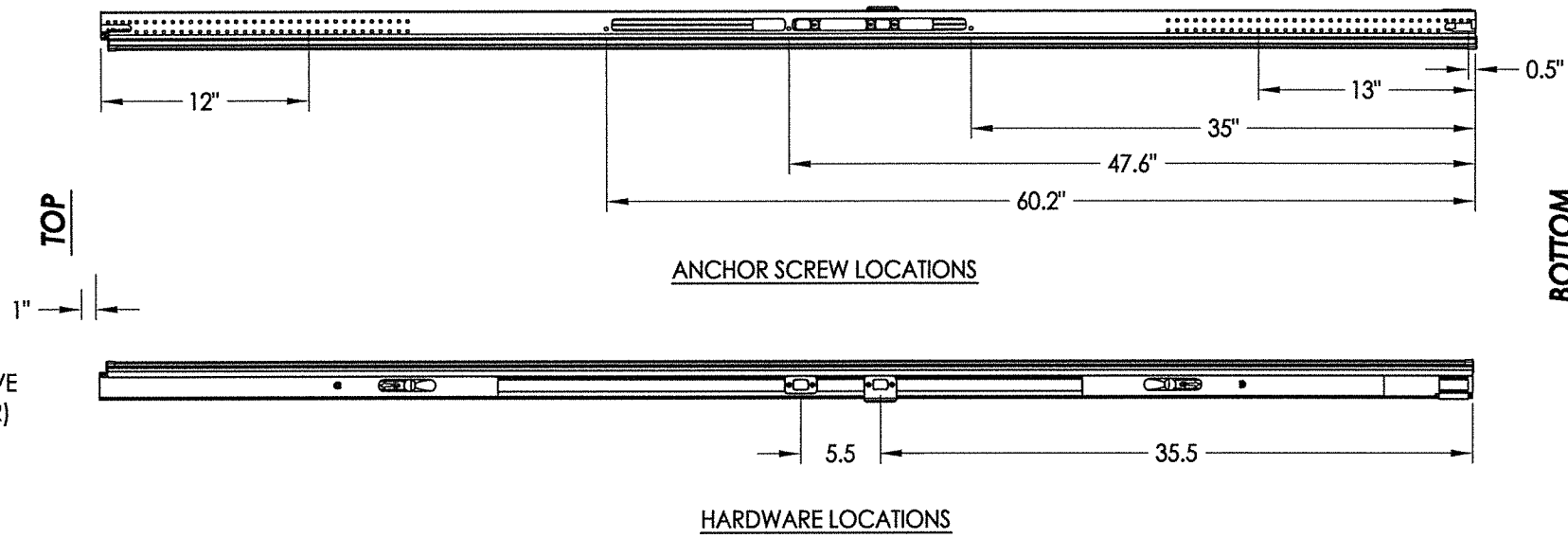

Documents Prepared By: Lyndon F. Schmidt, P.E.
TEXAS P.E. #104123

RW BUILDING CONSULTANTS, INC.
P.O. Box 230 Valrico FL 33595
Phone No.: 813.659.9197

TEXAS BOARD OF PROFESSIONAL ENGINEERS
CERTIFICATE OF REGISTRATION # F-11852

PRODUCT: ENDURA

PART OR ASSEMBLY: ASTRAGAL DETAILS (ULTIMATE HURRICANE)

| NO. | DATE | REVISIONS |
|-----|----------|-----------------------------|
| 1 | 11/10/21 | UPDATE TO 2018 IBC/IRC CODE |
| | | LFS |
| | | BY |

DATE: 11/8/18
SCALE: N.T.S.
DWG. BY: MT
CHK. BY: LFS
DRAWING NO.: TX-4915
SHEET 4 OF 8

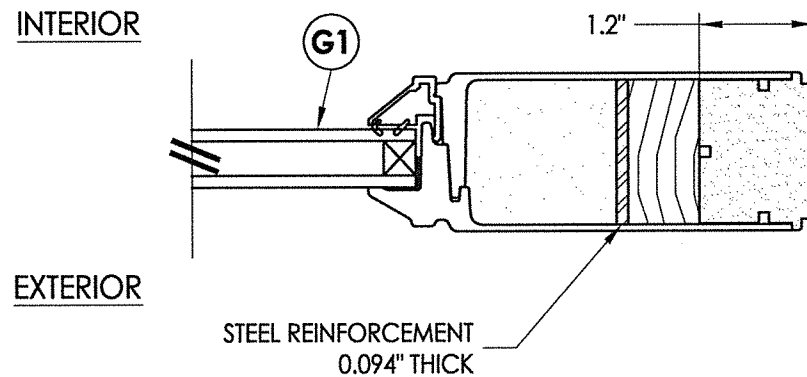
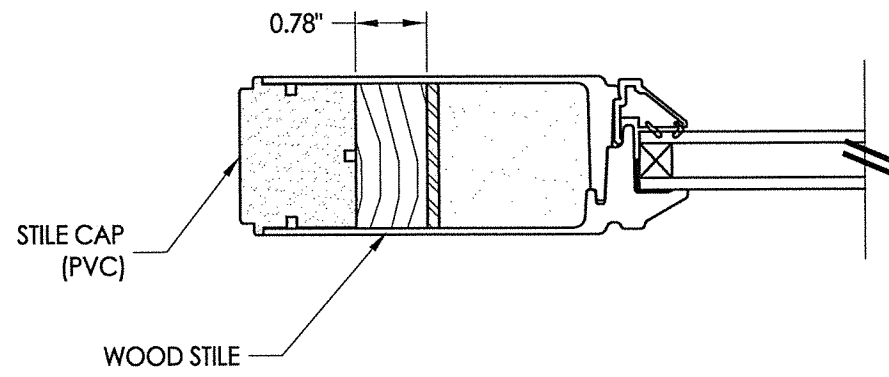

1
5 HORIZONTAL CROSS SECTION

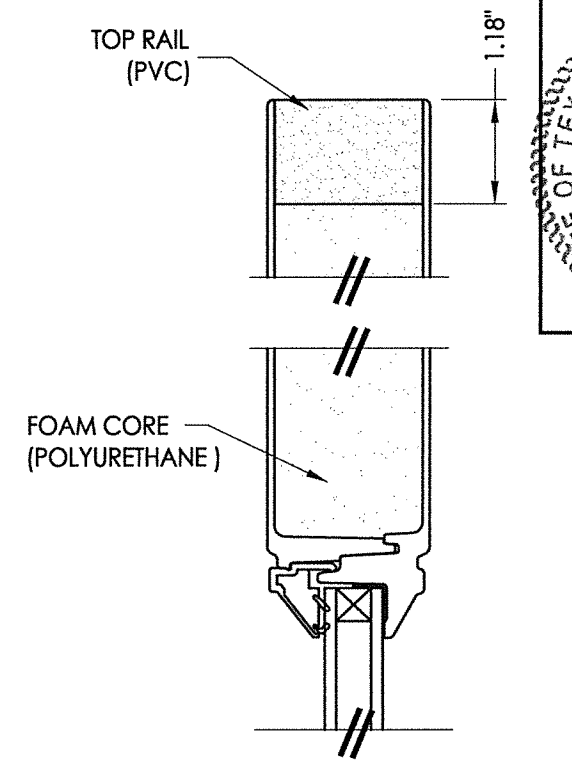

INTERIOR EXTERIOR

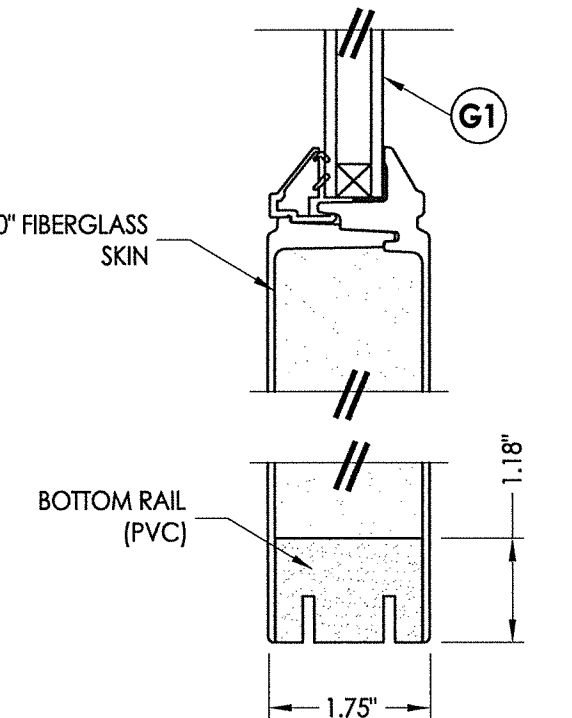

2
5 VERTICAL CROSS SECTION

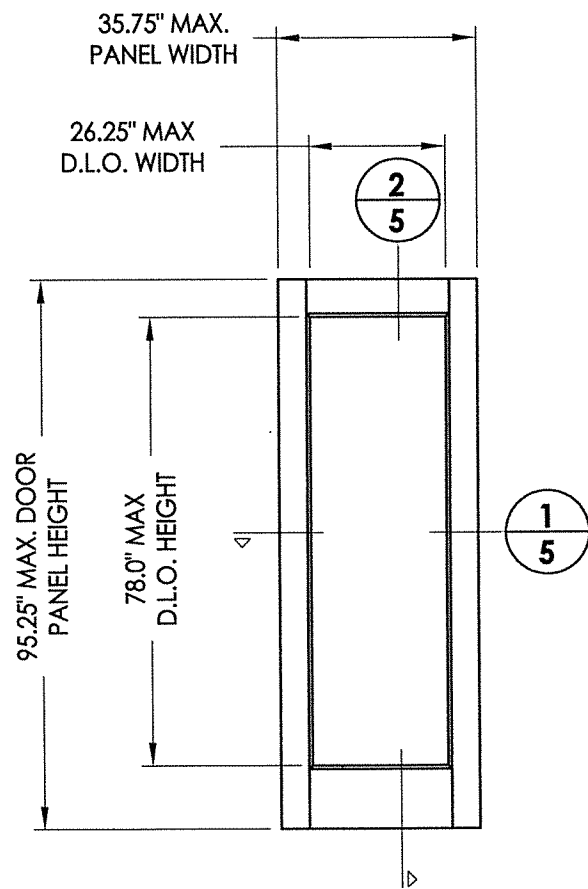

PLASTPRO
Flushglazed
(Fiberglass)

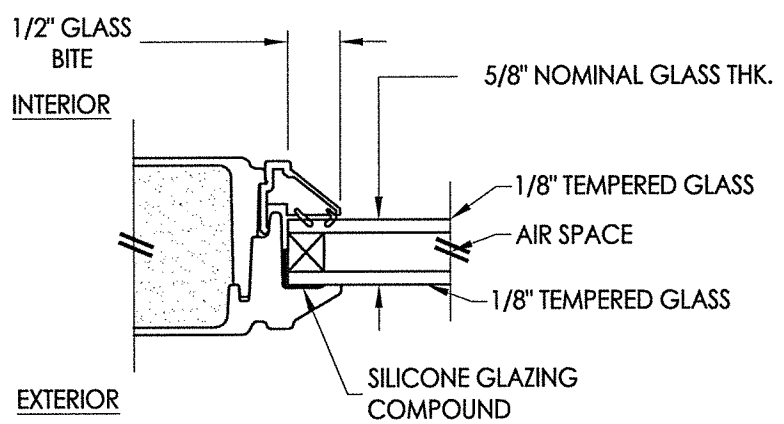

G1 GLAZING DETAIL
Flush Glazing

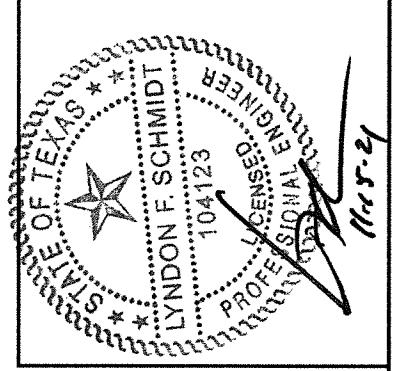

Documents Prepared By: Lyndon F. Schmidt, P.E.
TEXAS P.E. #104123

RW BUILDING CONSULTANTS, INC.
P.O. Box 230 Vairico FL 33595
Phone No.: 813.659.9197
TEXAS BOARD OF PROFESSIONAL ENGINEERS
CERTIFICATE OF REGISTRATION # F-11852

| | |
|-------------------|---------------------------------------|
| PRODUCT: | ENDURA |
| PART OR ASSEMBLY: | DOOR PANEL DETAILS (FLUSH GLAZING) |

| NO. | DATE | REVISIONS |
|-----|----------|-----------------------------|
| 1 | 11/10/21 | UPDATE TO 2018 IBC/IRC CODE |
| | | LFS |
| | | BY |

| | |
|--------------|---------|
| DATE: | 11/8/18 |
| SCALE: | N.T.S. |
| DWG. BY: | MT |
| CHK. BY: | LFS |
| DRAWING NO.: | TX-4915 |
| SHEET | 5 OF 8 |

Z:\Clients\Endura PERMANENT.B - Texas Dept of Ins\TDI - DR-1021 Flush GLZ Plastpro FG door (4910-4915)\C - Drawings\TX-4911,12,14,15.dwg

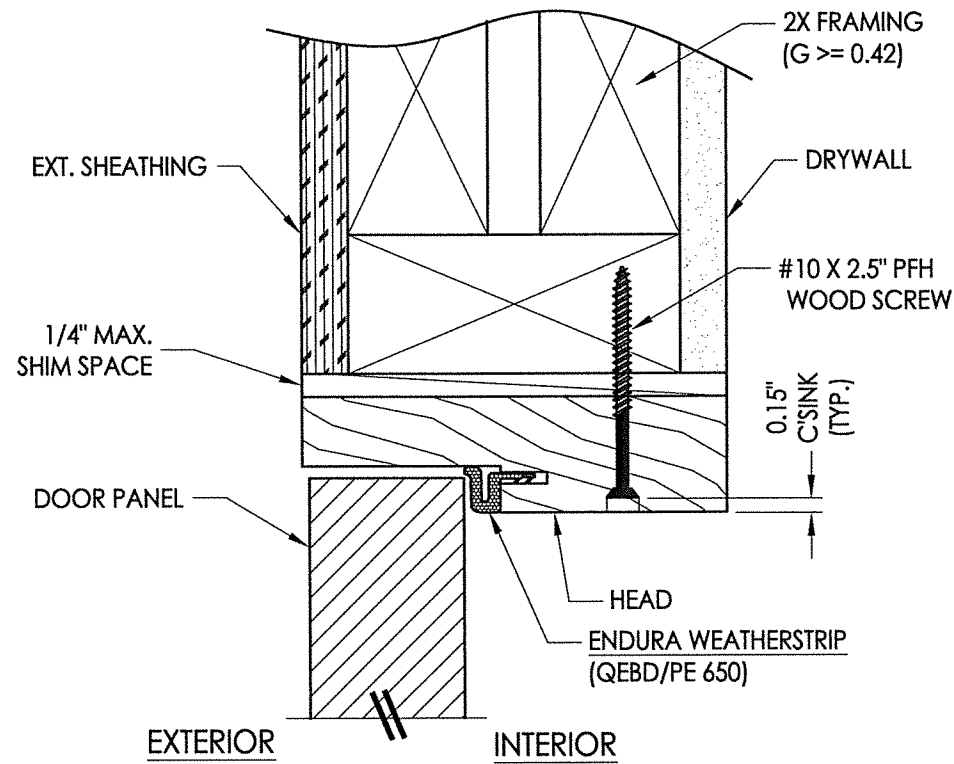

3 **VERTICAL CROSS SECTION**
6 Outswing shown - inswing also approved

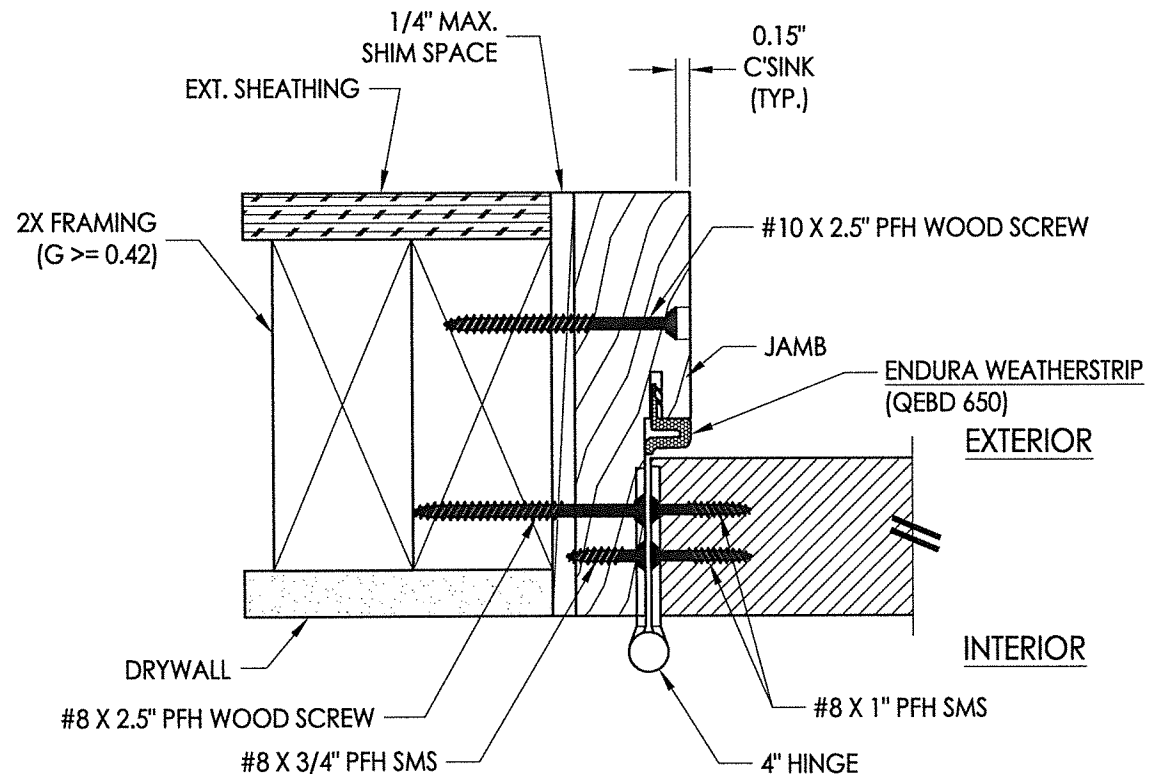

1 **HORIZONTAL CROSS SECTION**
6 Inswing shown - Outswing also approved

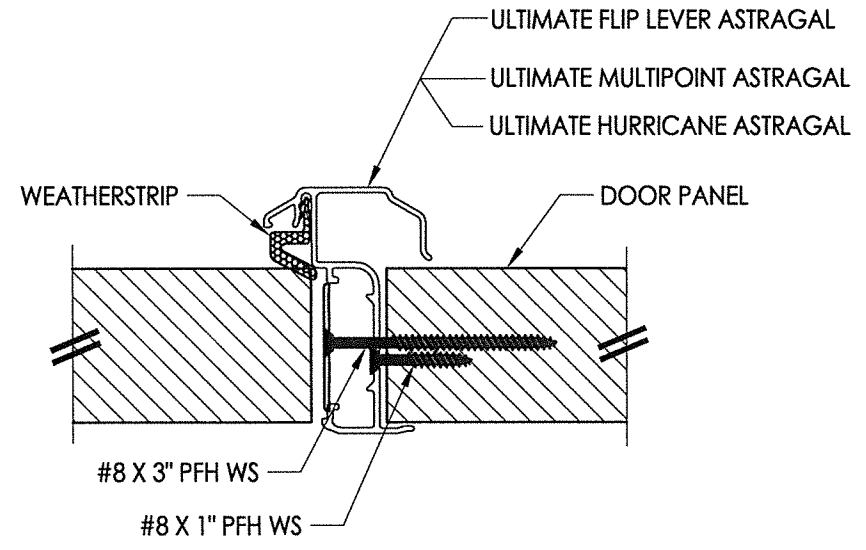
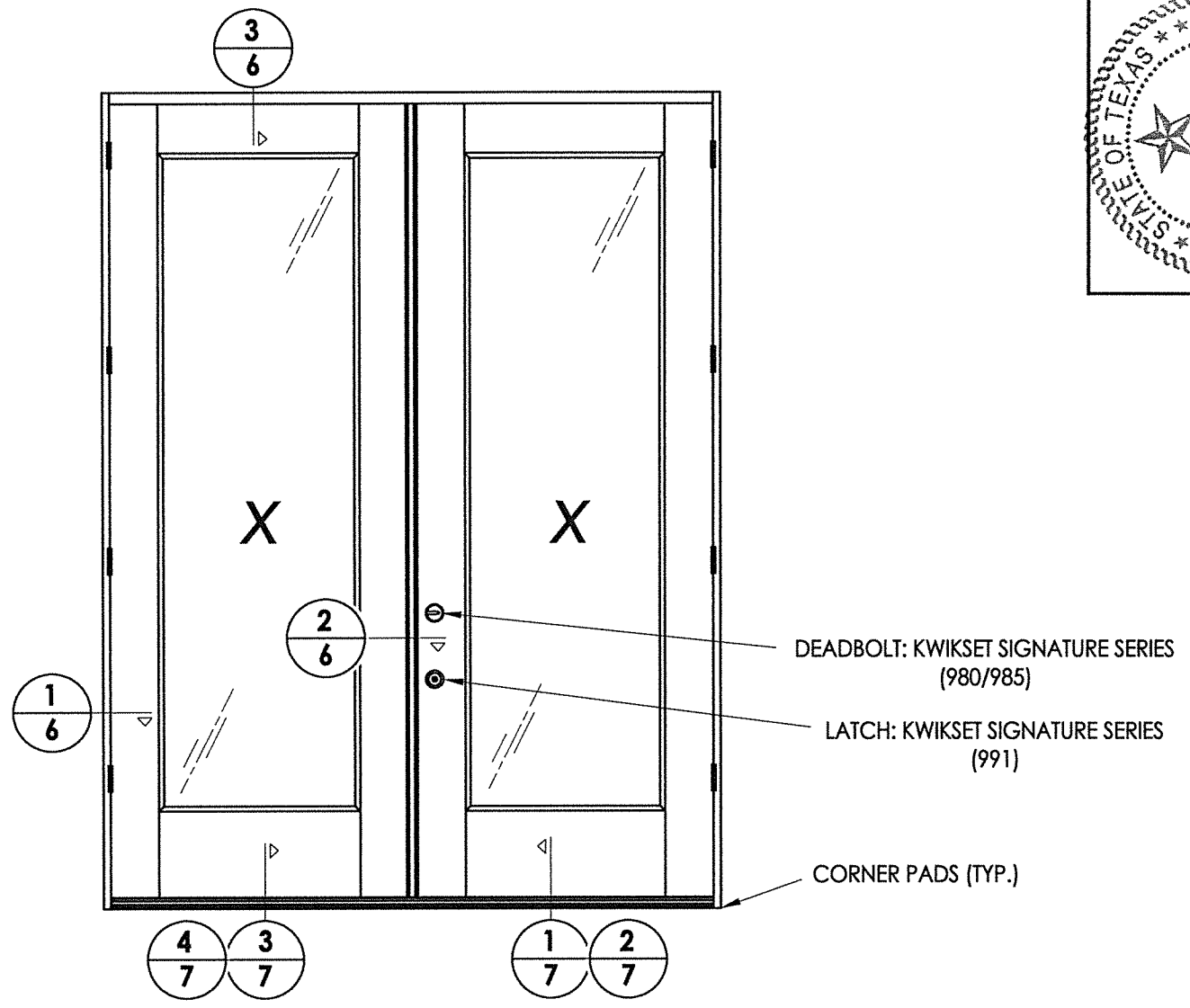

2 **HORIZONTAL CROSS SECTION**
6

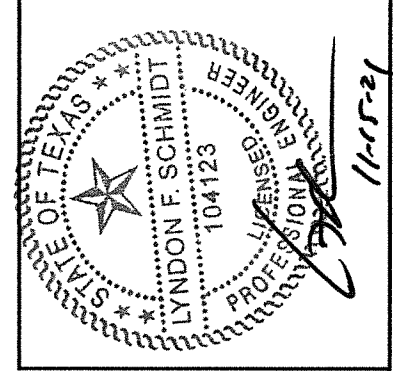

Documents Prepared By: Lyndon F. Schmidt, P.E.
TEXAS P.E. #104123

RW BUILDING CONSULTANTS, INC.
P.O. Box 230 Valrico FL 33595
Phone No.: 813.659.9197
TEXAS BOARD OF PROFESSIONAL ENGINEERS
CERTIFICATE OF REGISTRATION # F-11852

PRODUCT: ENDURA
PART OR ASSEMBLY: HORIZONTAL CROSS SECTIONS

| NO. | DATE | REVISIONS |
|-----|----------|-----------------------------|
| 1 | 11/10/21 | UPDATE TO 2018 IBC/IRC CODE |
| | | LFS |
| | | BY |

DATE: 11/8/18
SCALE: N.T.S.
DWG. BY: MT
CHK. BY: LFS
DRAWING NO.: TX-4915
SHEET 6 OF 8

Z:\Clients\Endura PERMANENT.B - Texas Dept of Ins\TDI - DR-1021 Flush GLZ Plastpro FG door (4910-4915)\C - Drawings\TX-4911,12,14,15.dwg

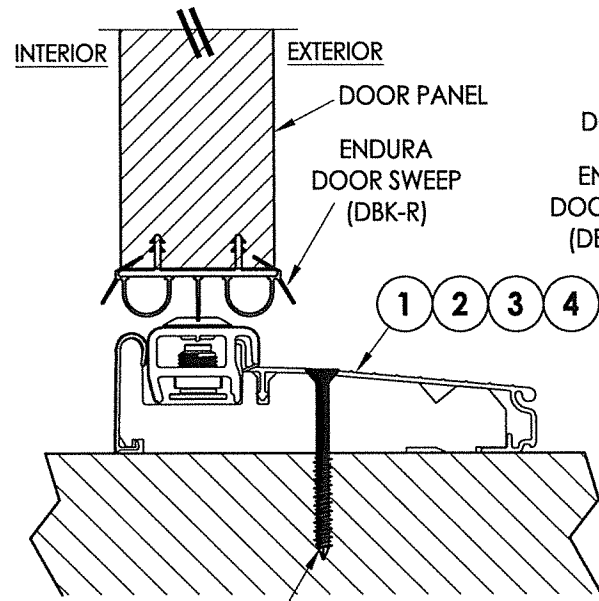

#10 X 2.5" PFH WOOD SCREW OR
1/4" X 2-3/4" DeWALT OR ITW CONCRETE SCREW

1 VERTICAL CROSS SECTION
7 Inswing Adjustable Threshold

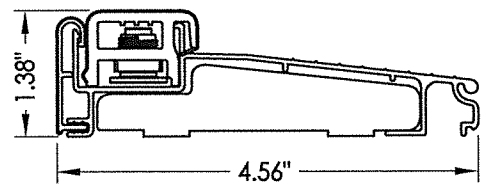

1 INSWING ADJUSTABLE THRESHOLD
ZAIL4565
MAX. DESIGN PRESSURE = +40/-45 PSF

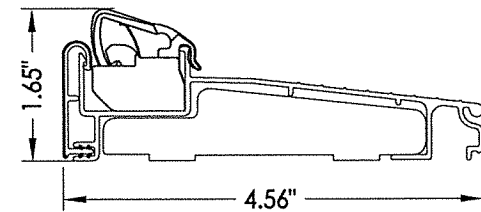

6 INSWING ARTICULATING THRESHOLD
ZACL4565

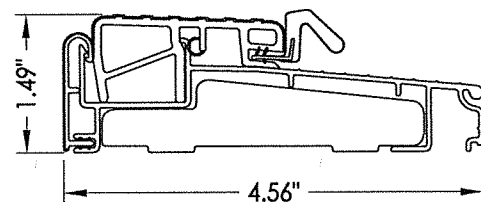

11 OUTSWING THRESHOLD
ZOBL4565

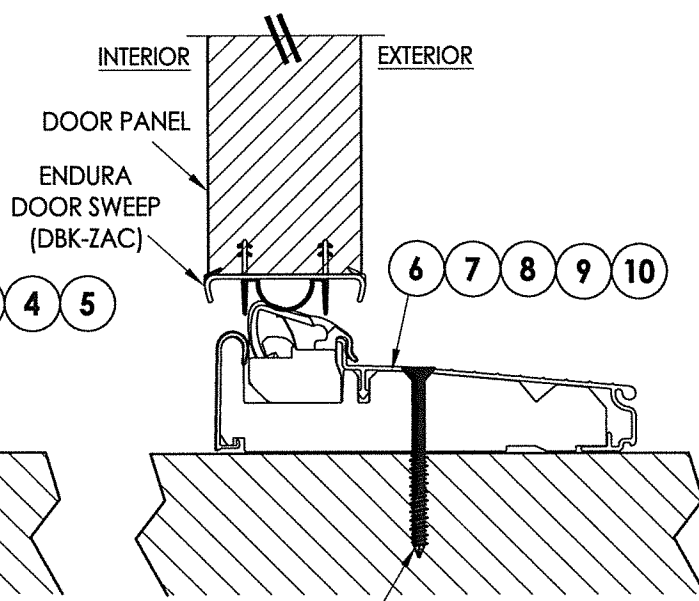

#10 X 2.5" PFH WOOD SCREW OR
1/4" X 2-3/4" DeWALT OR ITW CONCRETE SCREW

2 VERTICAL CROSS SECTION
7 Inswing Articulating Threshold
w/ Pin Capture

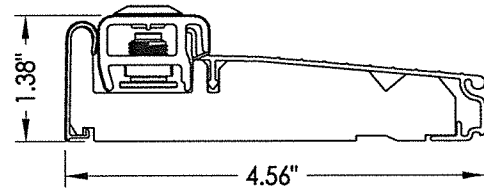

2 INSWING ADJUSTABLE THRESHOLD
ZAI4565FN
MAX. DESIGN PRESSURE = +40/-45 PSF

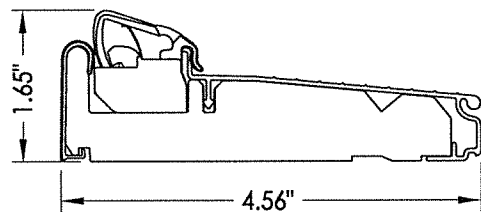

7 INSWING ARTICULATING THRESHOLD
ZAC4565FN
MAX. DESIGN PRESSURE = +40/-45 PSF

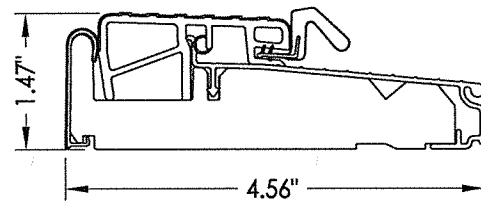

12 OUTSWING THRESHOLD
ZOB4565FN

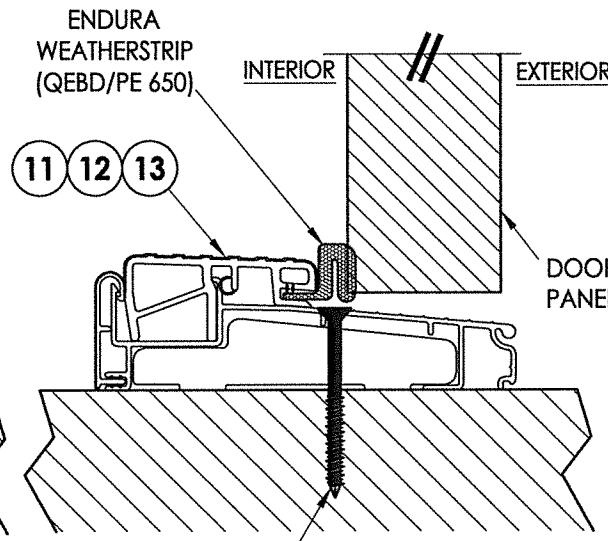

#10 X 2.5" PFH WOOD SCREW OR
1/4" X 2-3/4" DeWALT OR ITW CONCRETE SCREW

3 VERTICAL CROSS SECTION
7 Outswing Bump Threshold

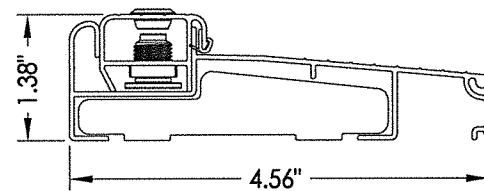

3 INSWING ADJUSTABLE THRESHOLD
ZAILAA4565
MAX. DESIGN PRESSURE = +40/-45 PSF

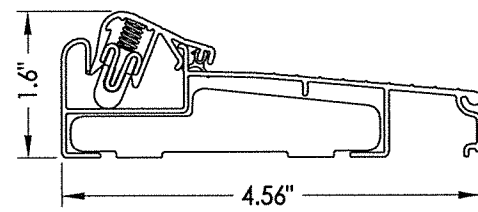

8 INSWING ARTICULATING THRESHOLD
ZACAA4565

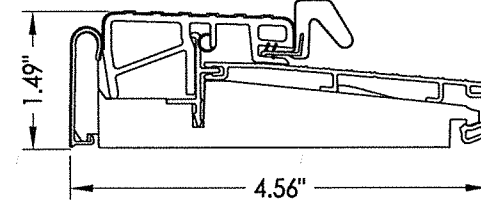

13 OUTSWING THRESHOLD
ZOB4565RDS

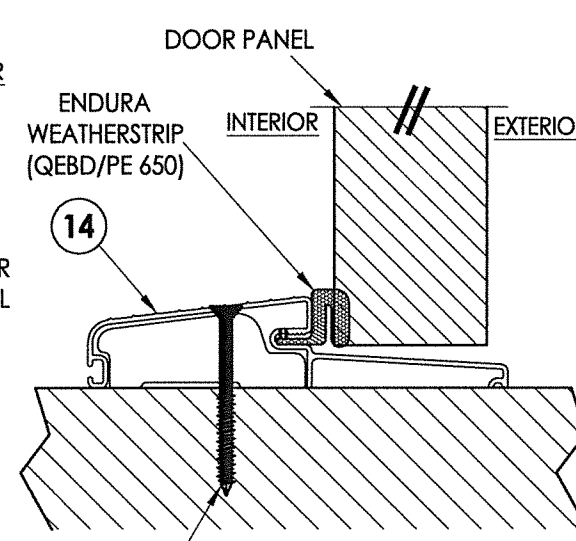

#10 X 2.5" PFH WOOD SCREW OR
1/4" X 2-3/4" DeWALT OR ITW CONCRETE SCREW

4 VERTICAL CROSS SECTION
7 Outswing Bump Threshold

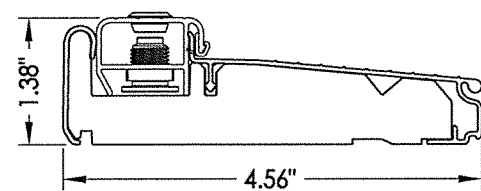

4 INSWING ADJUSTABLE THRESHOLD
ZAI4565RDS
MAX. DESIGN PRESSURE = +40/-45 PSF

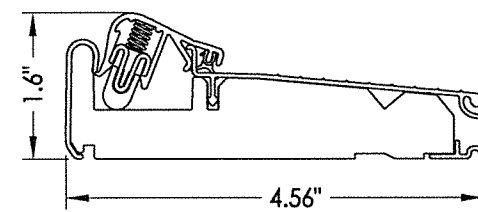

9 INSWING ARTICULATING THRESHOLD
ZACAA4565FN
MAX. DESIGN PRESSURE = +40/-45 PSF

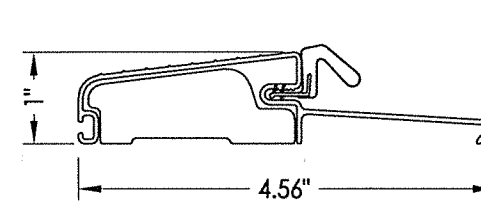

14 OUTSWING THRESHOLD
FOB4566

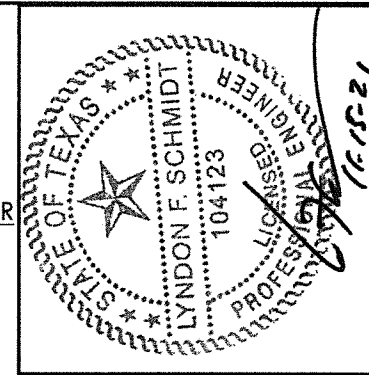

Documents Prepared By: Lyndon F. Schmidt, P.E.
TEXAS P.E. #104123

RW BUILDING CONSULTANTS, INC.
P.O. Box 230 Valrico FL 33595
Phone No.: 813.659.9197
TEXAS BOARD OF PROFESSIONAL ENGINEERS
CERTIFICATE OF REGISTRATION # F-11852

PRODUCT: ENDURA
PART OR ASSEMBLY: VERTICAL CROSS SECTIONS

| NO. | DATE | BY | REVISIONS |
|-----|----------|-----|-----------------------------|
| 1 | 11/10/21 | LFS | UPDATE TO 2018 IBC/IRC CODE |

DATE: 11/8/18
SCALE: N.T.S.
DWG. BY: MT
CHK. BY: LFS
DRAWING NO.: TX-4915
SHEET 7 OF 8

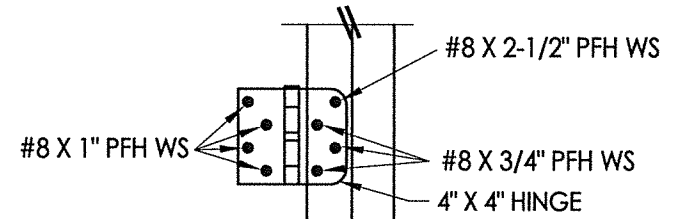
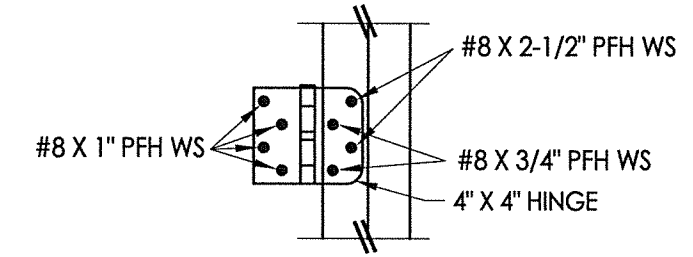
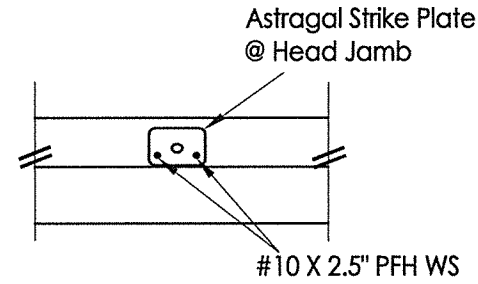
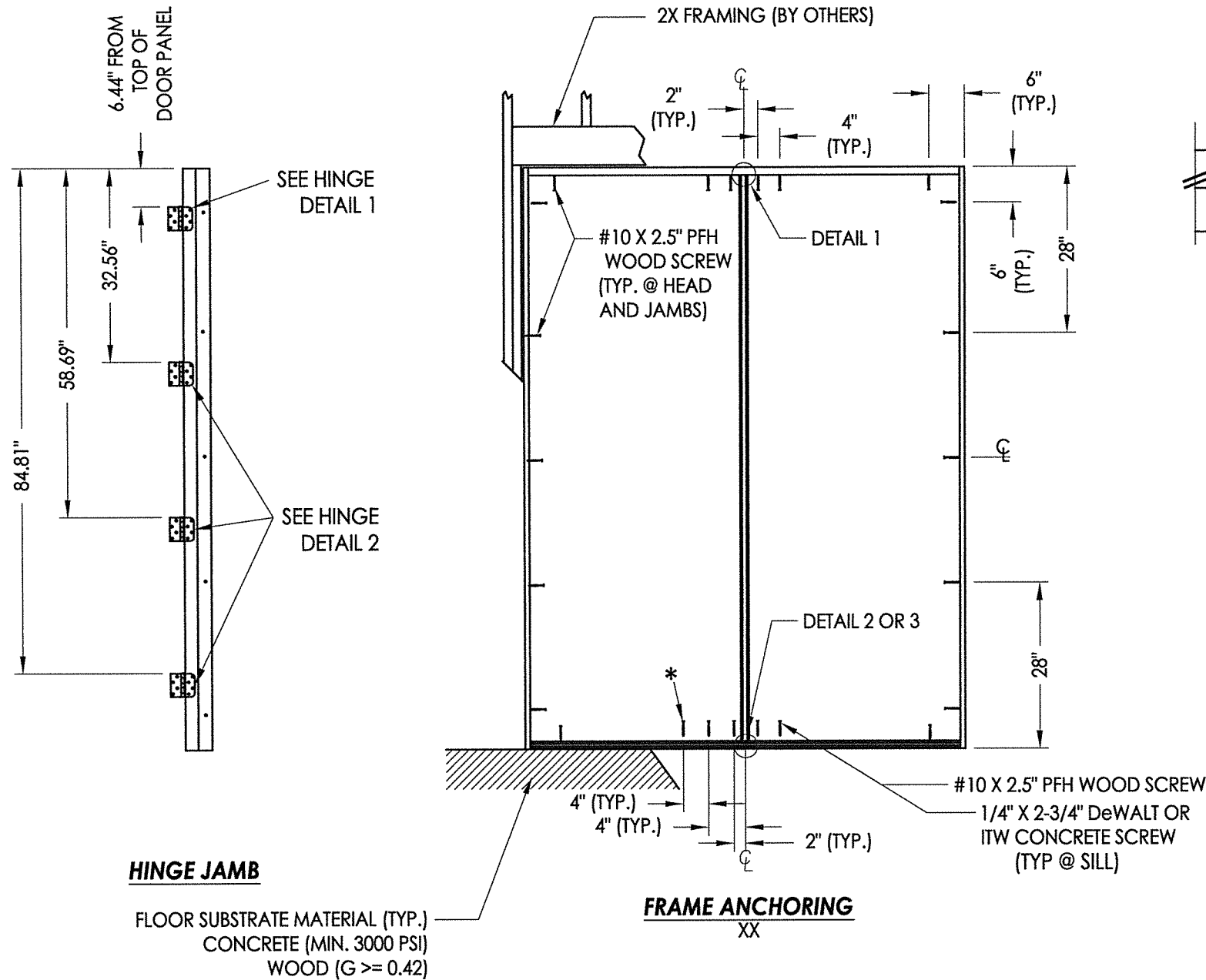

*NOTE: This anchor required for D.P. > 40 PSF.

CONCRETE ANCHOR NOTES:

- Concrete anchor locations at the corners may be adjusted to maintain the min. edge distance to mortar joints.
- Concrete anchor locations noted as "MAX. ON CENTER" must be adjusted to maintain the min. edge distance to mortar joints, additional concrete anchors may be required to ensure the "MAX. ON CENTER" dimension are not exceeded.
- Concrete anchor table:

| ANCHOR TYPE | ANCHOR SIZE | MIN. EMBEDMENT | MIN. CLEARANCE TO MASONRY EDGE | MIN. CLEARANCE TO ADJACENT ANCHOR |
|------------------|-------------|----------------|--------------------------------|-----------------------------------|
| ITW TAPCON® | 3/16" | 1-3/4" | 3" | 1-1/2" |
| | 1/4" | 1-3/4" | 1-1/2" | 4" |
| DeWALT ULTRACON® | 1/4" | 1-3/4" | 1" | 4" |

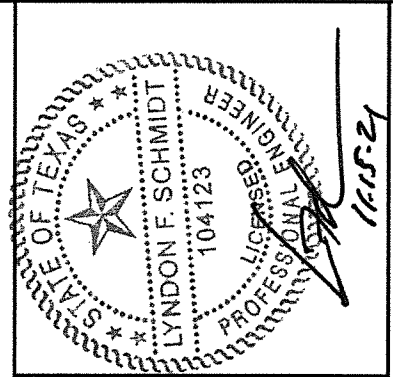
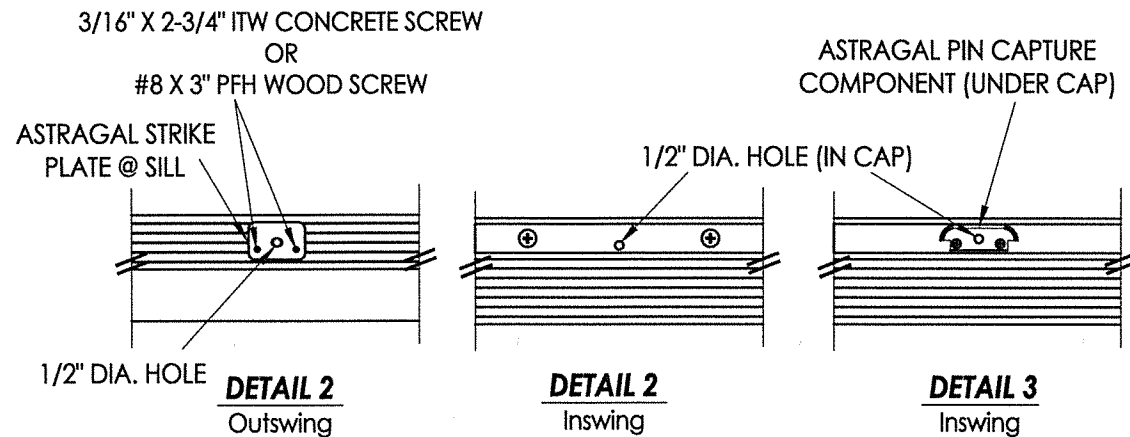

Documents Prepared By: Lyndon F. Schmidt, P.E.
TEXAS P.E. #104123

RW BUILDING CONSULTANTS, INC.
P.O. Box 230 Valrico FL, 33595
Phone No.: 813.659.9197
TEXAS BOARD OF PROFESSIONAL ENGINEERS
CERTIFICATE OF REGISTRATION # F-11852

PRODUCT: ENDURA
PART OR ASSEMBLY: FRAME ANCHORING

| NO. | DATE | DESCRIPTION | BY |
|-----|----------|-----------------------------|-----|
| 1 | 11/10/21 | UPDATE TO 2018 IBC/IRC CODE | LFS |

DATE: 11/8/18
SCALE: N.T.S.
DWG. BY: MT
CHK. BY: LFS
DRAWING NO.: TX-4915
SHEET 8 OF 8