

ARCADIA INC.

IPWS 512 HD SERIES ENTRANCE DOOR (IMPACT)

INSTALLATION NOTES:

- ONE (1) INSTALLATION ANCHOR IS REQUIRED AT EACH ANCHOR LOCATION SHOWN.
- THE NUMBER OF INSTALLATION ANCHORS DEPICTED IS THE MINIMUM NUMBER OF ANCHORS TO BE USED FOR PRODUCT INSTALLATION.
- INSTALL INDIVIDUAL INSTALLATION ANCHORS WITHIN A TOLERANCE OF ±1/2 INCH OF THE DEPICTED LOCATION IN THE ANCHOR LAYOUT DETAIL (I.E., WITHOUT CONSIDERATION OF TOLERANCES). TOLERANCES ARE NOT CUMULATIVE FROM ONE INSTALLATION ANCHOR TO THE NEXT.
- SHIM AS REQUIRED AT EACH INSTALLATION ANCHOR WITH LOAD BEARING SHIM(S). MAXIMUM ALLOWABLE SHIM STACK TO BE 1/4 INCH. SHIM WHERE SPACE OF 1/16 INCH OR GREATER OCCURS. SHIM(S) SHALL BE CONSTRUCTED OF HIGH DENSITY PLASTIC OR BETTER.
- FOR INSTALLATION INTO WOOD FRAMING USE 1/4 INCH WOOD SCREWS OF SUFFICIENT LENGTH TO ACHIEVE 1 1/2 INCH MINIMUM EMBEDMENT INTO WOOD SUBSTRATE.
- FOR INSTALLATION THROUGH 1X BUCK TO CONCRETE/MASONRY, OR DIRECTLY INTO CONCRETE/MASONRY, USE 1/4 INCH DIAMETER ITW TAPCONS OF SUFFICIENT LENGTH TO ACHIEVE 1 1/2 INCH MINIMUM EMBEDMENT.
- FOR INSTALLATION THROUGH METAL FRAME USE 1/4"-20 SELF-DRILLING SCREWS OF SUFFICIENT LENGTH TO ACHIEVE 3 THREADS MINIMUM PENETRATION BEYOND METAL FRAME SUBSTRATE.
- FOR INSTALLATION THROUGH ALUMINUM MULLION USE 1/4"-20 SELF-DRILLING SCREWS OF SUFFICIENT LENGTH TO ACHIEVE 3 THREADS MINIMUM PENETRATION BEYOND ALUMINUM FRAME SUBSTRATE.
- MINIMUM EMBEDMENT AND EDGE DISTANCE EXCLUDE WALL FINISHES, INCLUDING BUT NOT LIMITED TO STUCCO, FOAM, BRICK VENEER, AND SIDING.
- INSTALLATION ANCHORS AND ASSOCIATED HARDWARE MUST BE MADE OF CORROSION RESISTANT MATERIAL OR HAVE A CORROSION RESISTANT COATING.
- FOR HOLLOW BLOCK AND GROUT FILLED BLOCK, DO NOT INSTALL INSTALLATION ANCHORS INTO MORTAR JOINTS. EDGE DISTANCE IS MEASURED FROM FREE EDGE OF BLOCK OR EDGE OF MORTAR JOINT INTO FACE SHELL OF BLOCK.
- INSTALLATION ANCHORS SHALL BE INSTALLED IN ACCORDANCE WITH ANCHOR MANUFACTURER'S INSTALLATION INSTRUCTIONS, AND ANCHORS SHALL NOT BE USED IN SUBSTRATES WITH STRENGTHS LESS THAN THE MINIMUM STRENGTH SPECIFIED BY THE ANCHOR MANUFACTURER.
- INSTALLATION ANCHOR CAPACITIES FOR PRODUCTS HEREIN ARE BASED ON SUBSTRATE MATERIALS WITH THE FOLLOWING PROPERTIES:
 - WOOD - MINIMUM SPECIFIC GRAVITY OF 0.42.
 - CONCRETE - MINIMUM COMPRESSIVE STRENGTH OF 3000 PSI.
 - MASONRY - STRENGTH CONFORMANCE TO ASTM C-90.
 - STEEL - MINIMUM YIELD STRENGTH OF 33 KSI. MINIMUM 18 GA. WALL THICKNESS.
 - ALUMINUM - MINIMUM 1/16 INCH THICK 6063-T5 ALUMINUM.

GENERAL NOTES:

- THE PRODUCT SHOWN HEREIN IS DESIGNED AND MANUFACTURED TO COMPLY WITH THE 2018 INTERNATIONAL BUILDING CODE (IBC) AND 2018 INTERNATIONAL RESIDENTIAL CODE (IRC), AND HAS BEEN EVALUATED ACCORDING TO THE FOLLOWING:
 - ASTM E1886-13a
 - ASTM E1996-17
 - ASTM E330-14
- ADEQUACY OF THE EXISTING STRUCTURAL CONCRETE/MASONRY, 2X FRAMING AND METAL STUD FRAMING AS A MAIN WIND FORCE RESISTING SYSTEM CAPABLE OF WITHSTANDING AND TRANSFERRING APPLIED PRODUCT LOADS TO THE FOUNDATION IS THE RESPONSIBILITY OF THE ENGINEER OR ARCHITECT OF RECORD FOR THE PROJECT OF INSTALLATION.
- 1X AND 2X BUCKS (WHEN USED) SHALL BE DESIGNED AND ANCHORED TO PROPERLY TRANSFER ALL LOADS TO THE STRUCTURE. BUCK DESIGN AND INSTALLATION IS THE RESPONSIBILITY OF THE ENGINEER OR ARCHITECT OF RECORD FOR THE PROJECT OF INSTALLATION.
- THE INSTALLATION DETAILS DESCRIBED HEREIN ARE GENERIC AND MAY NOT REFLECT ACTUAL CONDITIONS FOR A SPECIFIC SITE. IF SITE CONDITIONS CAUSE INSTALLATION TO DEVIATE FROM THE REQUIREMENTS DETAILED HEREIN, A LICENSED ENGINEER OR ARCHITECT SHALL PREPARE SITE SPECIFIC DOCUMENTS FOR USE WITH THIS DOCUMENT.
- APPROVED IMPACT PROTECTIVE SYSTEM **IS NOT REQUIRED** ON THIS PRODUCT IN AREAS REQUIRING IMPACT RESISTANCE.
- DOOR FRAME MATERIAL: ALUMINUM 6063-T5
- ALL STRUCTURAL MATERIALS & DISSIMILIAR METALS SHALL BE PROTECTED, TREATED, PAINTED, COATED, AND/OR ISOLATED AS REQUIRED IN THE APPLICABLE SECTIONS OF THE CURRENT FLORIDA BUILDING CODE AND REFERENCED DESIGN SPECIFICATIONS.
- GLASS SHALL MEET THE REQUIREMENTS OF ASTM E 1300 GLASS CHARTS. SEE SHEET 3 FOR GLAZING DETAIL.

TABLE OF CONTENTS	
SHEET	SHEET DESCRIPTION
1	INSTALLATION & GENERAL NOTES
2	ELEVATION, ANCHOR LAYOUT, & ANCHOR TYPES
3	GLAZING DETAIL
4	VERTICAL SECTIONS
5	HORIZONTAL SECTIONS
6	BILL OF MATERIALS & COMPONENTS

DESIGN PRESSURE TABLE		
MAX. FRAME SIZE	MAX. DP	IMPACT RATING
41 13/16" X 83 3/16"	+96/-50 PSF	LMI & SMI

NOTES:

- DOOR NOT RATED FOR WATER INFILTRATION. DOOR ASSEMBLIES INSTALLED WHERE THE OVERHANG (OH) RATIO IS EQUAL TO OR MORE THAN 1 NEED NOT TO BE TESTED FOR WATER INFILTRATION.
- OH RATIO= OH LENGTH/OH HEIGHT



ARCADIA, INC.
2301 EAST VERNON AVE.
VERNON, CA 90058
PH: (323)771-9819

TITLE: IPWS 512 HD SERIES
ENTRANCE DOOR
(IMPACT)
INSTALLATION &
GENERAL NOTES

PREPARED BY:
BUILDING DROPS, INC.
398 E. DANIA BEACH BLVD., STE. 338
DANIA BEACH, FL 33004
PH: (954)399-8478
FAX: (954)744-4738
WEB: www.buildingdrops.com



REMARKS	BY	DATE

THE INSTALLATION DETAILS DESCRIBED HEREIN ARE GENERIC AND MAY NOT REFLECT ACTUAL CONDITIONS FOR A SPECIFIC SITE. IF SITE CONDITIONS CAUSE INSTALLATION TO DEVIATE FROM THE REQUIREMENTS DETAILED HEREIN, A LICENSED ENGINEER OR ARCHITECT SHALL PREPARE SITE SPECIFIC DOCUMENTS FOR USE WITH THIS DOCUMENT



HERMES F. NORERO, P.E.
TEXAS P.E. No. 118471
BUILDING DROPS, INC
398 E. DANIA BEACH BLVD. # 338
DANIA BEACH, FL 33004
TBPE FIRM No. 13734

DATE: **02.16.23**

DWG. BY: **SH** CHK. BY: **HFN**

SCALE: **NTS**

DWG. #: **ARC012**

SHEET:
1



ARCADIA, INC.
2301 EAST VERNON AVE.
VERNON, CA 90058
PH: (323)771-9819

TITLE: **IPWS 512 HD SERIES ENTRANCE DOOR (IMPACT)**
ELEVATION, ANCHOR LAYOUT, & ANCHOR TYPES

PREPARED BY: **BUILDING DROPS, INC.**
398 E. DANIA BEACH BLVD., STE. 338
DANIA BEACH, FL 33004
PH: (954)399-8478
FAX: (954)744-4738
WEB: www.buildingdrops.com



REMARKS	BY	DATE

THE INSTALLATION DETAILS DESCRIBED HEREIN ARE GENERIC AND MAY NOT REFLECT ACTUAL CONDITIONS FOR A SPECIFIC SITE. IF SITE CONDITIONS CAUSE INSTALLATION TO DEVIATE FROM THE REQUIREMENTS DETAILED HEREIN, A LICENSED ENGINEER OR ARCHITECT SHALL PREPARE SITE SPECIFIC DOCUMENTS FOR USE WITH THIS DOCUMENT



HERMES F. NORERO, P.E.
TEXAS P.E. No. 118471
BUILDING DROPS, INC
398 E. DANIA BEACH BLVD. # 338
DANIA BEACH, FL 33004
TBPE FIRM No. 13734

DATE: **02.16.23**
DWG. BY: **SH** | CHK. BY: **HFN**
SCALE: **NTS**
DWG. #: **ARC012**
SHEET:

2

DESIGN PRESSURE (PSF)			
NOMINAL DIMS.		"X" CONFIGURATION	
FRAME WIDTH 'in.'	FRAME HEIGHT 'in.'	EXT. (+)	INT. (-)
28.0	66.0	96.0	50.0
34.0		96.0	50.0
40.0		96.0	50.0
46.0		83.7	43.6
50.0	72.0	77.0	40.1
28.0		96.0	50.0
34.0		96.0	50.0
40.0		96.0	50.0
46.0	78.0	83.7	43.6
28.0		96.0	50.0
34.0		96.0	50.0
40.0		96.0	50.0
42.0	84.0	91.7	47.8
28.0		96.0	50.0
34.0		96.0	50.0
40.0		96.0	50.0
40.0	90.0	96.0	50.0
36.0		96.0	50.0
28.0		96.0	50.0
34.0		96.0	50.0
28.0	96.0	96.0	50.0
34.0		96.0	50.0
28.0		96.0	50.0
32.0		96.0	50.0

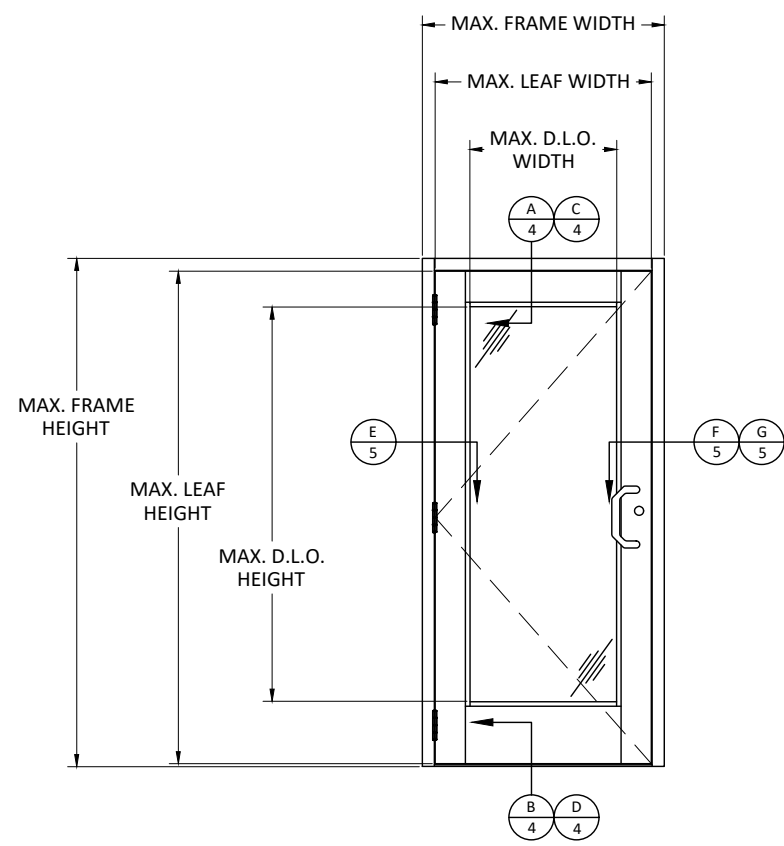

ELEVATION

D.L.O. WIDTH = FRAME WIDTH - 15.8125"
D.L.O. HEIGHT = FRAME HEIGHT - 18.875"
LEAF WIDTH = FRAME WIDTH - 4.3125"
LEAF HEIGHT = FRAME HEIGHT - 2.5625"

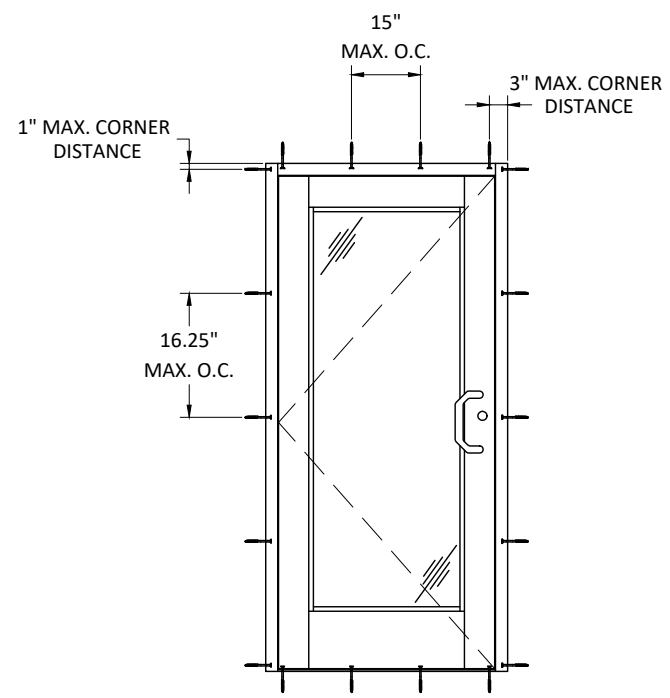

ANCHOR LAYOUT

IPWS 512 HD SERIES ENTRANCE DOOR ANCHOR SCHEDULE				
ANCHOR TYPE	ANCHOR DISCRIPTION	SUBSTRATE REQUIREMENTS	MIN. EDGE DISTANCE	MIN. EMBEDMENT
A	1/4" WOOD SCREW	WOOD MIN S.G. = 0.42	3/4"	1-1/2"
B	1/4" ITW TAPCON	CONCRETE MIN. 3000 PSI MASONRY CONFORMS TO ASTM C-90	2-1/2"	1-1/2"
C	1/4"-20 SELF DRILLING SCREW	STEEL MIN. YIELD STRENGTH 33 KSI, 18 GAUGE ALUMINUM MIN. 1/16" THICK 6063-T5	1/2"	3 THREADS PENETRATION

s:\projects\arcadia_incl\tdr-23-0123 - tdi_submittal.ms-362 entrance door_v5-512 entrance door\dwgs\ipws-512 hd entrance door\arc012.dwg 2/20/2023 9:07 AM



ARCADIA, INC.
2301 EAST VERNON AVE.
VERNON, CA 90058
PH: (323)771-9819

TITLE: IPWS 512 HD SERIES
ENTRANCE DOOR
(IMPACT)
GLAZING DETAIL

PREPARED BY:
BUILDING DROPS, INC.
398 E. DANIA BEACH BLVD., STE. 338
DANIA BEACH, FL 33004
PH: (954)399-8478
FAX: (954)744-4738
WEB: www.buildingdrops.com

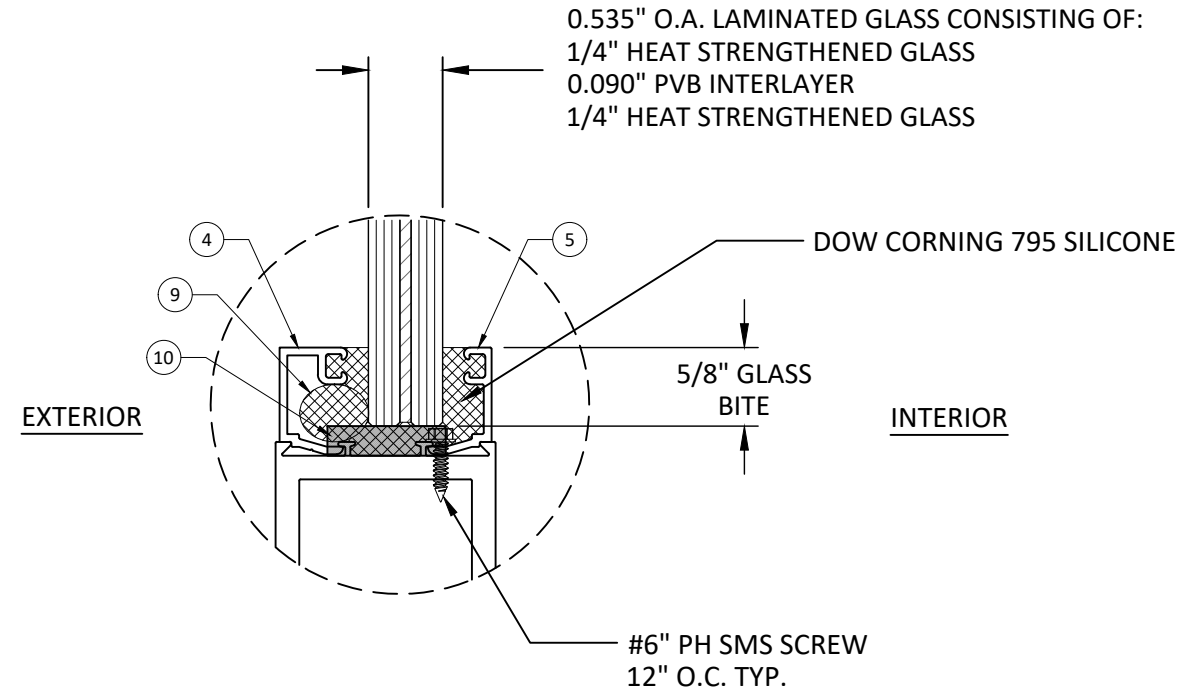
**GLAZING DETAIL
WET GLAZED**

- NOTES:
1. GLASS THICKNESS AND TYPE COMPLIES WITH ASTM E 1300 GLASS CHART REQUIREMENTS.
 2. ALL GLAZING CONFIGURATIONS SHALL COMPLY WITH SAFETY GLAZING REQUIREMENTS OUTLINED IN THE 2018 IBC.
 3. ALL LITES GREATER THAN 36" IN WIDTH SHALL UTILIZE SETTING BLOCKS IN ACCORDANCE WITH CH. 24 OF THE 2018 IBC.
 4. SETTING BLOCK DUROMETER HARDNESS OF 70-90 (SHORE A) AS REFERENCED IN CHAPTER 24.

REMARKS	BY	DATE

THE INSTALLATION DETAILS DESCRIBED HEREIN ARE GENERIC AND MAY NOT REFLECT ACTUAL CONDITIONS FOR A SPECIFIC SITE. IF SITE CONDITIONS CAUSE INSTALLATION TO DEVIATE FROM THE REQUIREMENTS DETAILED HEREIN, A LICENSED ENGINEER OR ARCHITECT SHALL PREPARE SITE SPECIFIC DOCUMENTS FOR USE WITH THIS DOCUMENT



HERMES F. NORERO, P.E.
TEXAS P.E. No. 118471
BUILDING DROPS, INC
398 E. DANIA BEACH BLVD. # 338
DANIA BEACH, FL 33004
TBPE FIRM No. 13734

DATE: **02.16.23**

DWG. BY: **SH** CHK. BY: **HFN**

SCALE: **NTS**

DWG. #: **ARC012**

SHEET:
3
OF 6

s:\projects\arcadia_incl\tdi-23-0123_tdi_submittal.ms-362-entrance door_vse-512-entrance door\dwgs\ipws-512-hd-entrance door\arc012.dwg 2/20/2023 9:07 AM

TITLE: IPWS 512 HD SERIES
ENTRANCE DOOR
(IMPACT)
VERTICAL SECTIONS

PREPARED BY:
BUILDING DROPS, INC.
398 E. DANIA BEACH BLVD., STE. 338
DANIA BEACH, FL 33004
PH: (954)399-8478
FAX: (954)744-4738
WEB: www.buildingdrops.com



REMARKS	BY	DATE

THE INSTALLATION DETAILS DESCRIBED HEREIN ARE GENERIC AND MAY NOT REFLECT ACTUAL CONDITIONS FOR A SPECIFIC SITE. IF SITE CONDITIONS CAUSE INSTALLATION TO DEVIATE FROM THE REQUIREMENTS DETAILED HEREIN, A LICENSED ENGINEER OR ARCHITECT SHALL PREPARE SITE SPECIFIC DOCUMENTS FOR USE WITH THIS DOCUMENT



HERMES F. NORERO, P.E.
TEXAS P.E. No. 118471
BUILDING DROPS, INC
398 E. DANIA BEACH BLVD. # 338
DANIA BEACH, FL 33004
TBPE FIRM No. 13734

DATE: 02.16.23

DWG. BY:
SH

CHK. BY:
HFN

SCALE: NTS

DWG. #: ARC012

SHEET:

4

OF 6

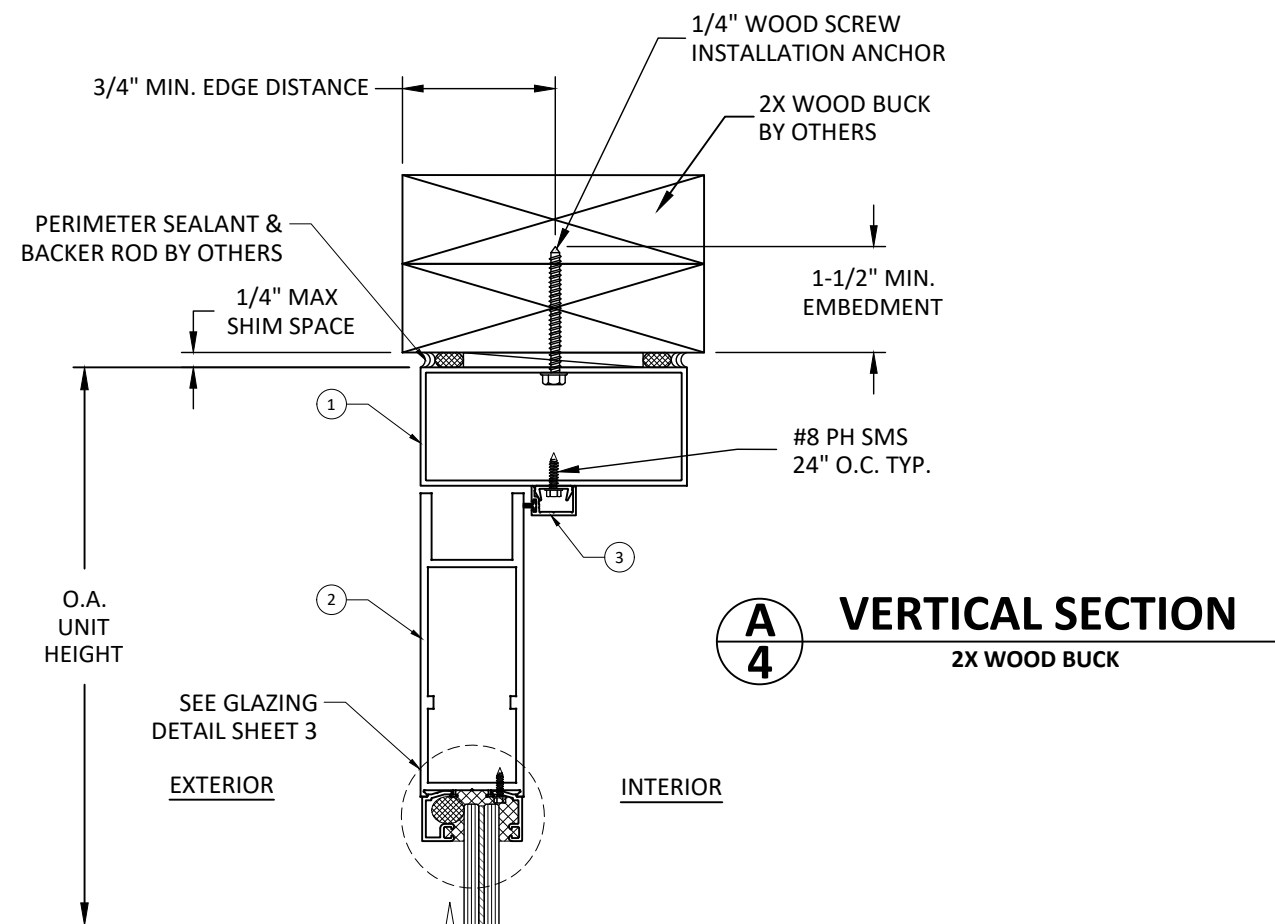

A
4 VERTICAL SECTION
2X WOOD BUCK

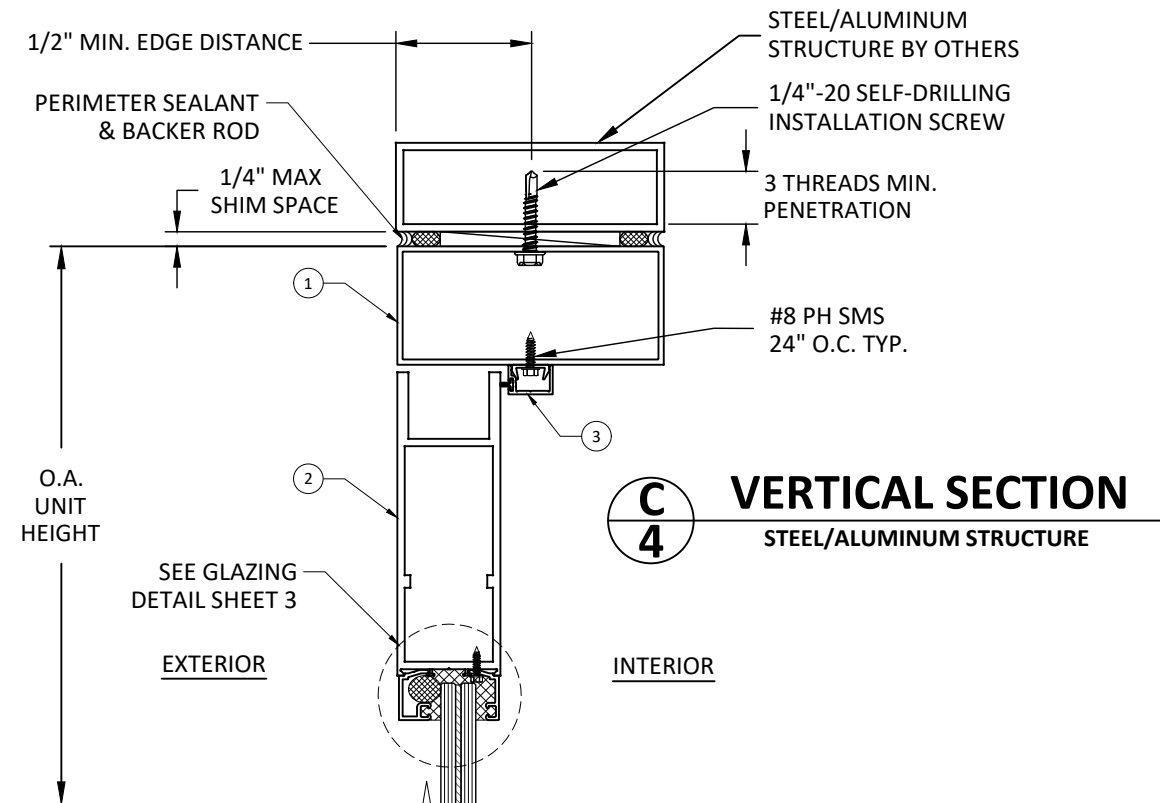

C
4 VERTICAL SECTION
STEEL/ALUMINUM STRUCTURE

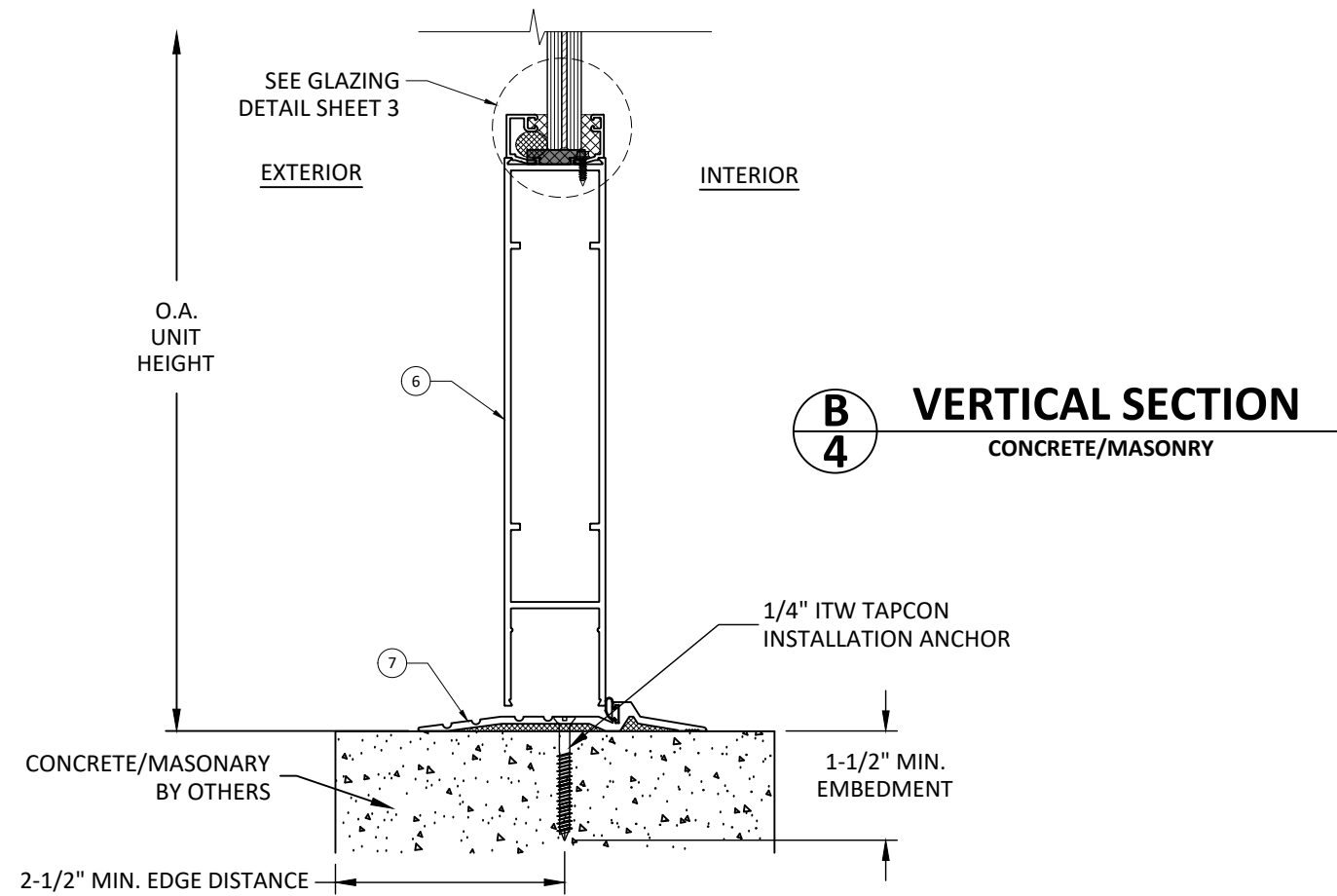

B
4 VERTICAL SECTION
CONCRETE/MASONRY

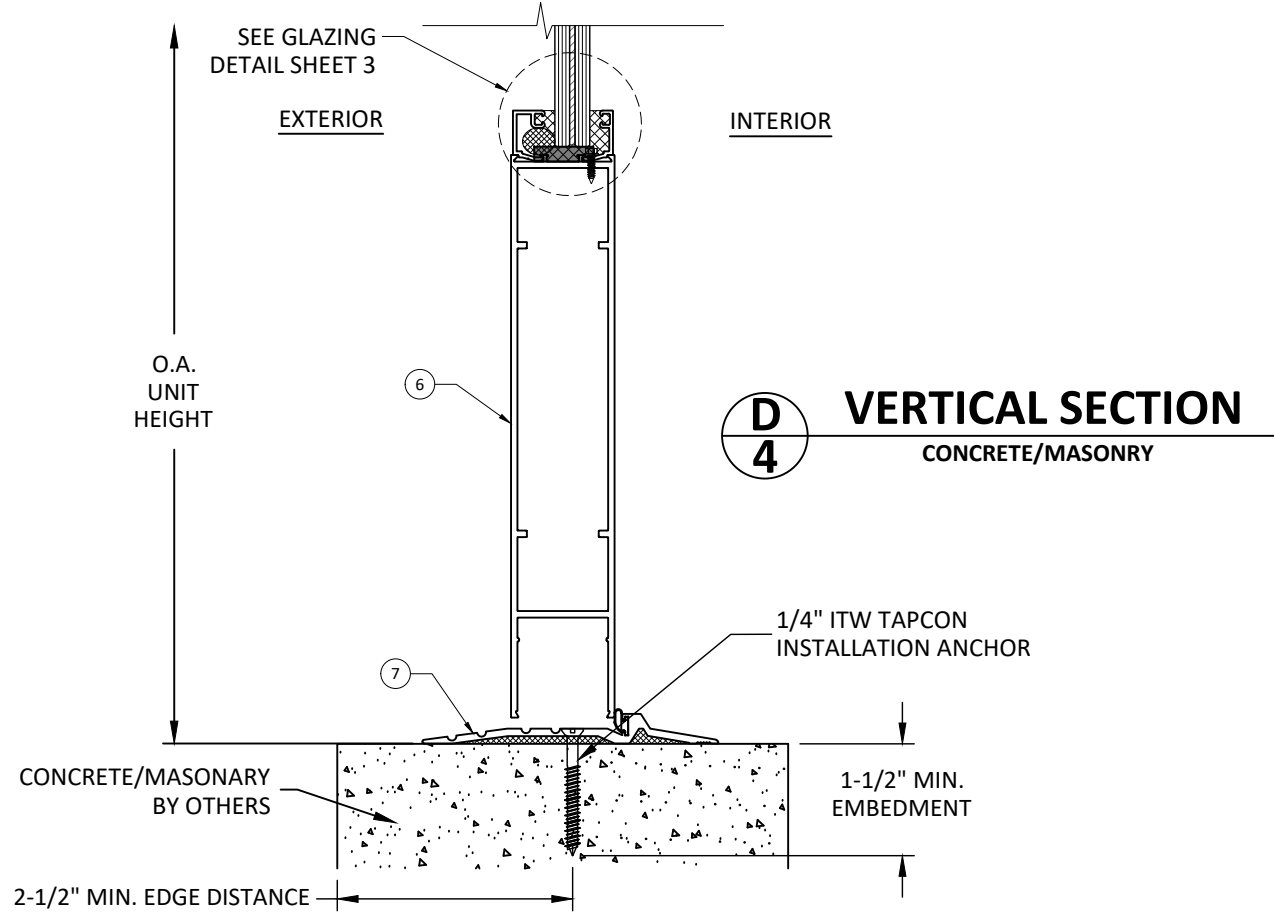

D
4 VERTICAL SECTION
CONCRETE/MASONRY

s:\projects\arcadia_incl\tdi-23-0123_tdi_submittal.ms-362_entrance_door\dwgs\ipws-512_hd_entrance_door\arc012.dwg 2/20/2023 9:07 AM

TITLE: IPWS 512 HD SERIES
ENTRANCE DOOR
(IMPACT)

HORIZONTAL SECTIONS

PREPARED BY:
BUILDING DROPS, INC.
398 E. DANIA BEACH BLVD., STE. 338
DANIA BEACH, FL 33004
PH: (954)399-8478
FAX: (954)744-4738
WEB: www.buildingdrops.com



REMARKS	BY	DATE

THE INSTALLATION DETAILS DESCRIBED HEREIN ARE GENERIC AND MAY NOT REFLECT ACTUAL CONDITIONS FOR A SPECIFIC SITE. IF SITE CONDITIONS CAUSE INSTALLATION TO DEVIATE FROM THE REQUIREMENTS DETAILED HEREIN, A LICENSED ENGINEER OR ARCHITECT SHALL PREPARE SITE SPECIFIC DOCUMENTS FOR USE WITH THIS DOCUMENT



HERMES F. NORERO, P.E.
TEXAS P.E. No. 118471
BUILDING DROPS, INC
398 E. DANIA BEACH BLVD. # 338
DANIA BEACH, FL 33004
TBPE FIRM No. 13734

DATE: 02.16.23

DWG. BY: SH

CHK. BY: HFN

SCALE: NTS

DWG. #: ARC012

SHEET:

5

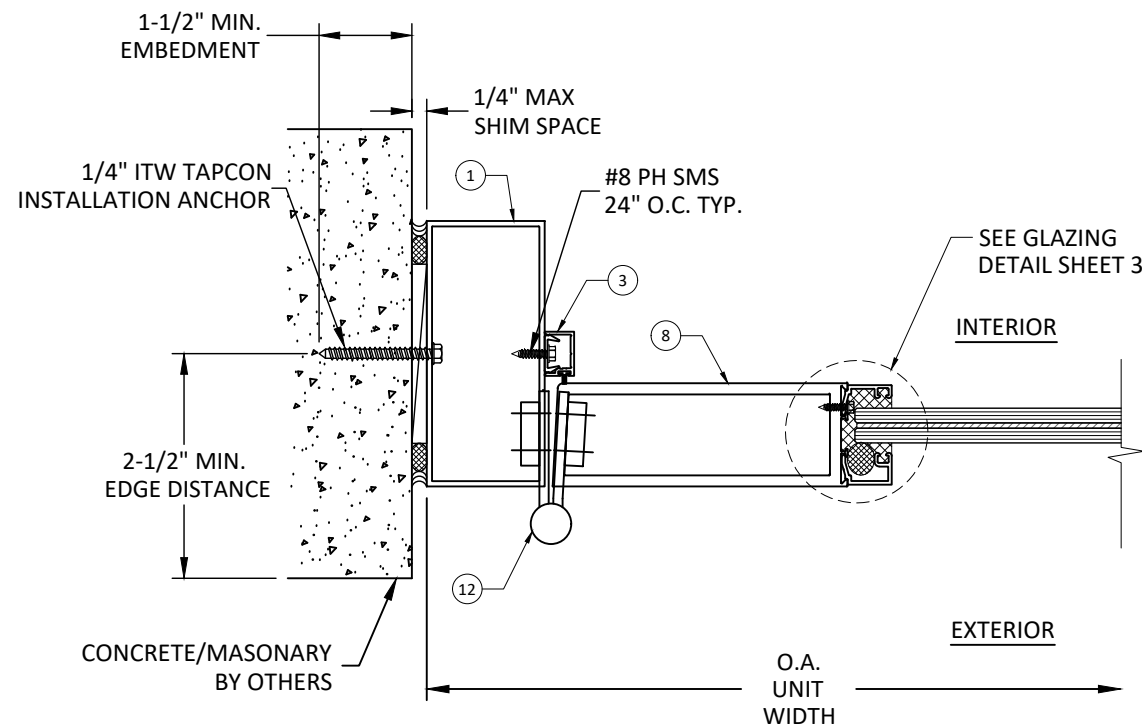

E
5 HORIZONTAL SECTION
HINGE JAMB
CONCRETE/MASONRY

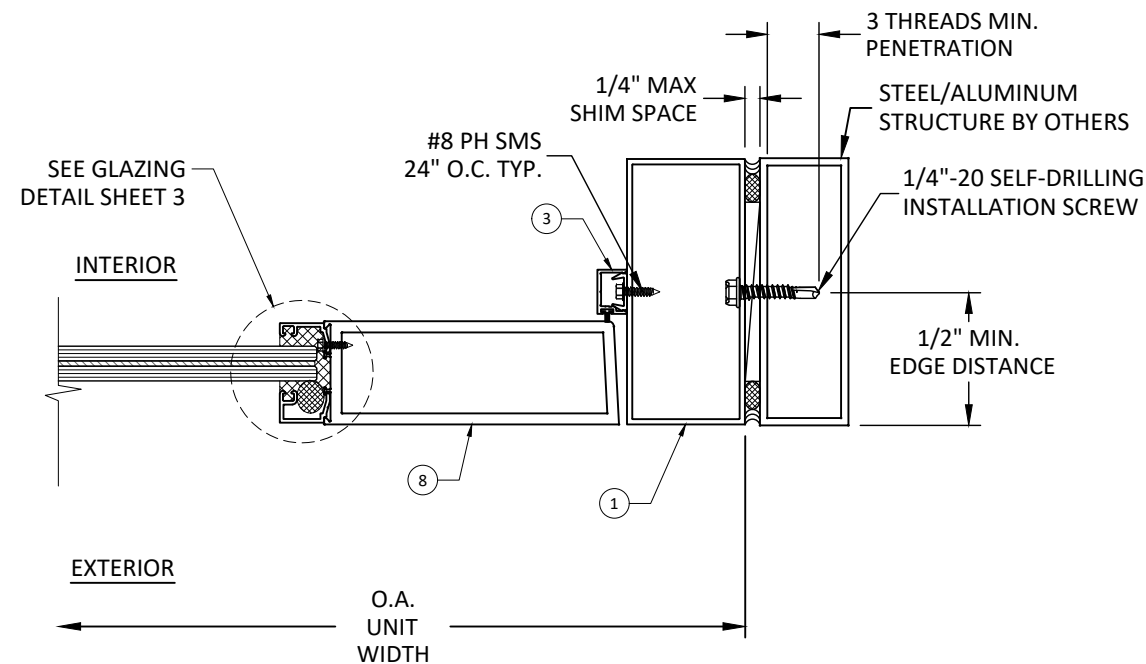

F
5 HORIZONTAL SECTION
LOCK JAMB
STEEL/ALUMINUM STRUCTURE

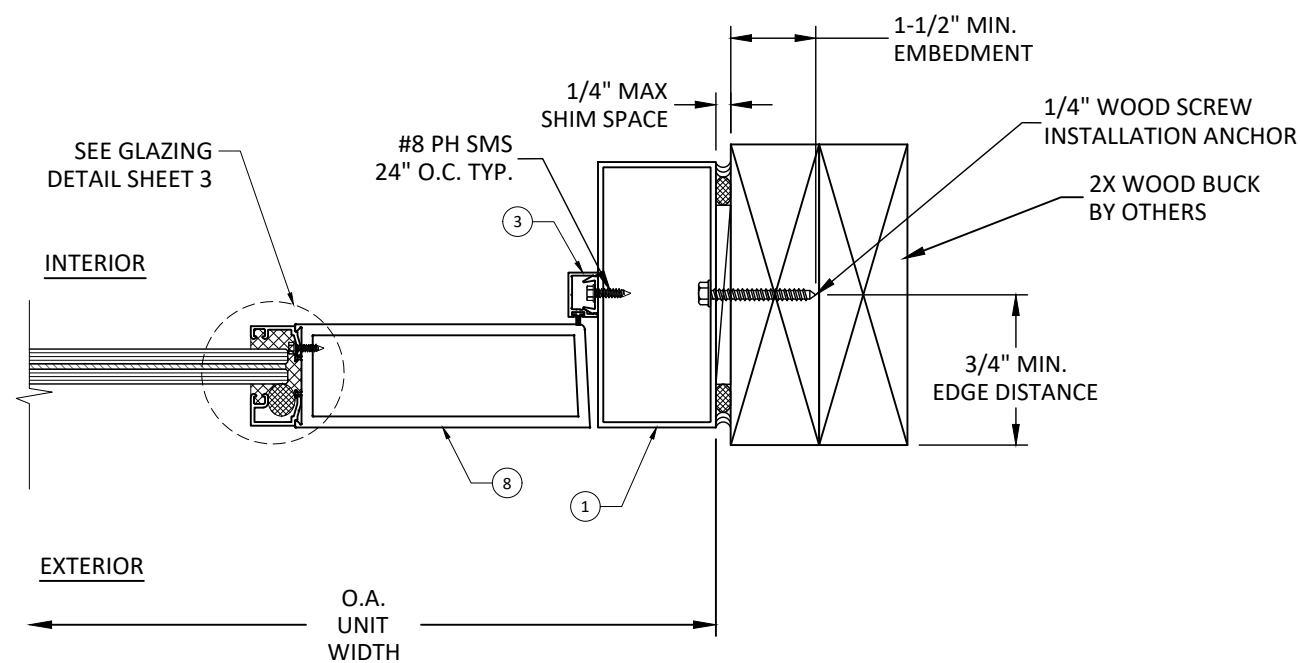

G
5 HORIZONTAL SECTION
LOCK JAMB
2X WOOD BUCK

s:\projects\arcadia_incl\tdi-23-0123_tdi_submittal_ms-362_entrance_door_v5-512_entrance_door\dwgs\ipws-512_hd_entrance_door\arc012.dwg 2/20/2023 9:07 AM

2/20/2023 9:07 AM

WS 512 HD ENTRANCE DOOR BILL OF MATERIALS

ITEM #	PART #	DESCRIPTION	MATERIAL	MANUFACTURER
1	245	HEAD/JAMB	6063-T5	ARCADIA
2	31-430H	TOP RAIL	6063-T5	ARCADIA
3	S-155	CAP	6063-T5	ARCADIA
4	DS-004	GLAZING BEAD	6063-T6	ARCADIA
5	DS-001	GLAZING BEAD	6063-T6	ARCADIA
6	DRB-950	BOTTOM RAIL	6063-T5	ARCADIA
7	TH-500	THRESHOLD	6063-T5	ARCADIA
8	DSO-401H	STILE	6063-T5	ARCADIA
9		BACKER ROD		
10		SETTING BLOCK		
11	1850S	DEAD BOLT	STAINLESS STEEL	
12	NRP-630	BUTT HINGES	STAINLESS STEEL	

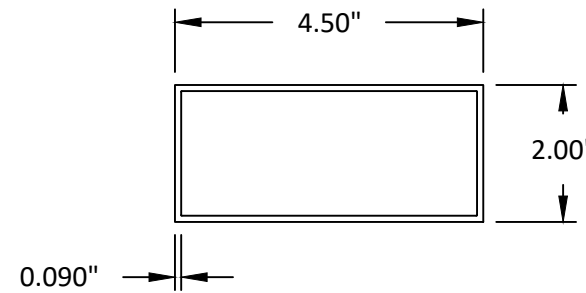

1 HEAD & JAMB

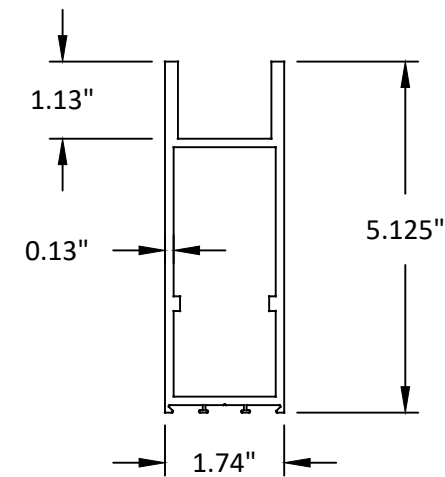

2 TOP RAIL

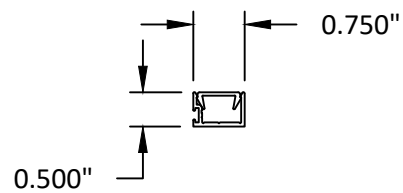

3 CAP

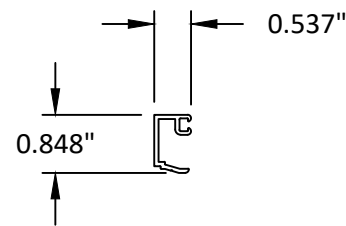

4 GLAZING BEAD

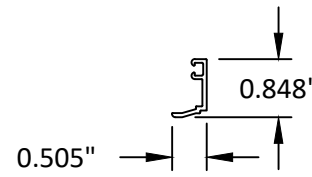

5 GLAZING BEAD

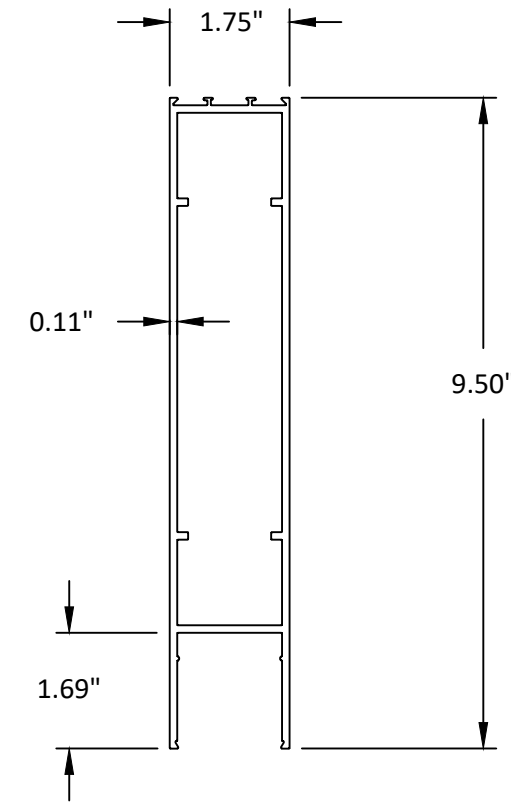

6 BOTTOM RAIL

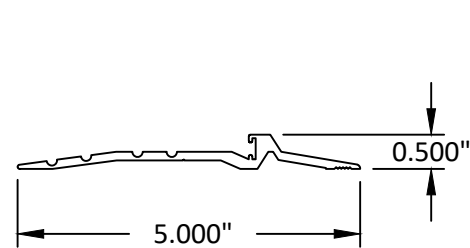

7 TRESHOLD

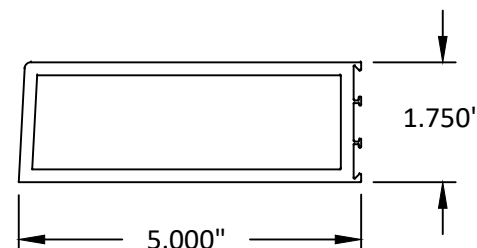

8 STILE



ARCADIA, INC.
2301 EAST VERNON AVE.
VERNON, CA 90058
PH: (323)771-9819

TITLE: IPWS 512 HD SERIES
ENTRANCE DOOR
(IMPACT)
BILL OF MATERIALS
& COMPONENTS

PREPARED BY:
BUILDING DROPS, INC.
398 E. DANIA BEACH BLVD., STE. 338
DANIA BEACH, FL 33004
PH: (954)399-8478
FAX: (954)744-4738
WEB: www.buildingdrops.com



REMARKS	BY	DATE

THE INSTALLATION DETAILS DESCRIBED HEREIN ARE GENERIC AND MAY NOT REFLECT ACTUAL CONDITIONS FOR A SPECIFIC SITE. IF SITE CONDITIONS CAUSE INSTALLATION TO DEVIATE FROM THE REQUIREMENTS DETAILED HEREIN, A LICENSED ENGINEER OR ARCHITECT SHALL PREPARE SITE SPECIFIC DOCUMENTS FOR USE WITH THIS DOCUMENT



HERMES F. NORERO, P.E.
TEXAS P.E. No. 118471
BUILDING DROPS, INC
398 E. DANIA BEACH BLVD. # 338
DANIA BEACH, FL 33004
TBPE FIRM No. 13734

DATE:	02.16.23	
DWG. BY:	SH	CHK. BY: HFN
SCALE:	NTS	
DWG. #:	ARC012	

SHEET:
6
OF 6

s:\projects\arcadia_incl\tdi-23-0123 -tdi_submittal_ms-362_entrance_door\dwgs\ipws-512_hd_entrance_door\arc012.dwg