

4 3 2 1

MODEL 902 AND C2AL
MAX 16'-2" WIDE X 18'-0" HIGH

REVISIONS					
REV. NO.	ZONE:	DATE:	ECN NO.	APPVD:	DESCRIPTION
03	-	08/2012	-	-	UPDATED FOR TDI
04	-	06/2013	-	-	REMOVED PLEXIGLASS OPTION. SPECIFIED ALL GLAZING DIMEN.
05	-	08/2016	-	-	REMOVED WIND SPEED TABLE.

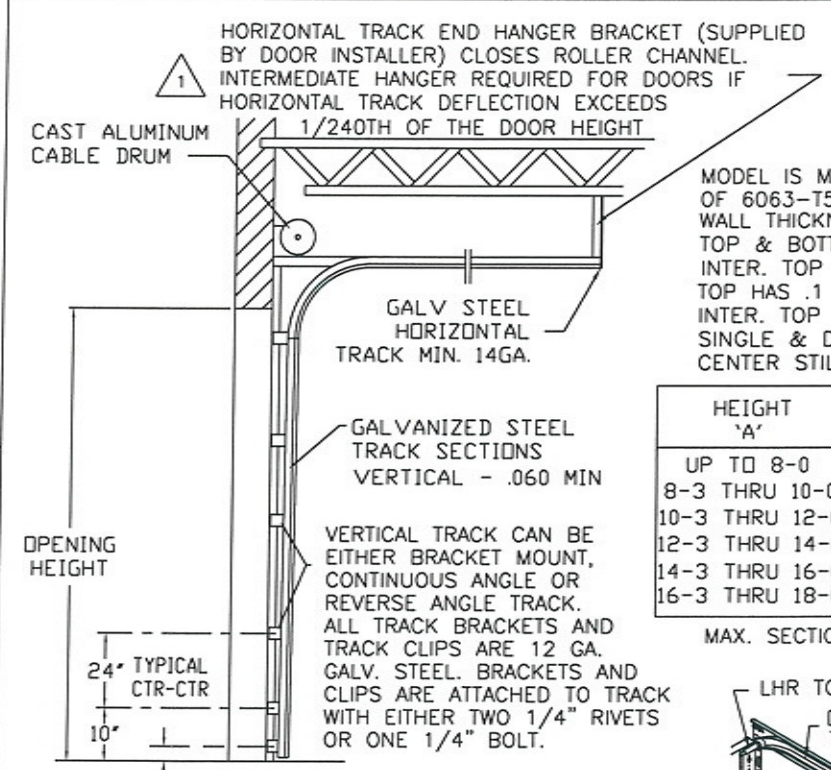

MODEL IS MADE OF 6063-T5 ALUMINUM EXTRUSIONS. WALL THICKNESS:
TOP & BOTTOM RAILS .075
INTER. TOP & BOTTOM RAILS .075
TOP HAS .1 x 1.875" FIN
INTER. TOP RAIL CAP .040
SINGLE & DOUBLE END STILES .075
CENTER STILES .062

HEIGHT 'A'	NUMBER OF SECTIONS	NUMBER OF 4" 16 GAGE C-CHANNEL
UP TO 8-0	4	4
8-3 THRU 10-0	5	5
10-3 THRU 12-0	6	6
12-3 THRU 14-0	7	7
14-3 THRU 16-0	8	8
16-3 THRU 18-0	9	9

MAX. SECTION HEIGHT: 24"

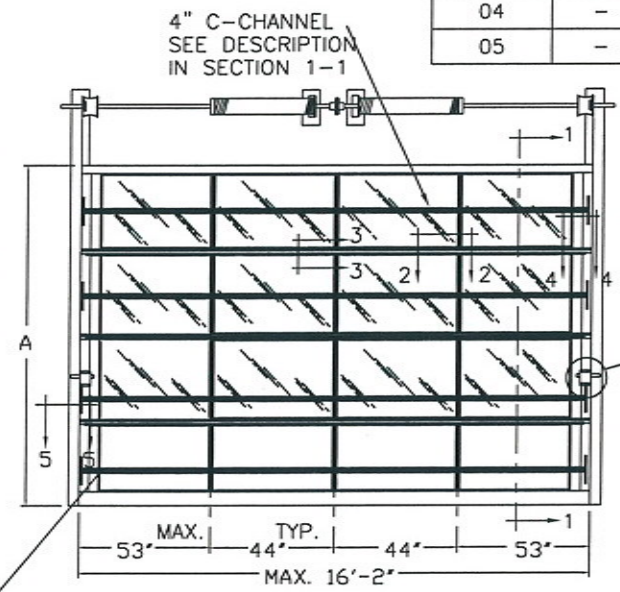

SIDE ELEVATION STANDARD-LIFT TRACK DETAILS**
**HI-LIFT, VERTICAL LIFT, LOW HEADROOM TRACK AVAILABLE.

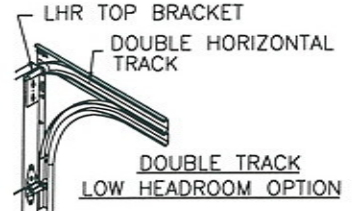

NOTE: DOUBLE TRACK LOW HEADROOM, HI-LIFT TRACK, FOLLOW-THE-ROOF TRACK, AND VERTICAL LIFT TRACK ARE AVAILABLE OPTIONS. 3" TRACK ALSO AVAILABLE.

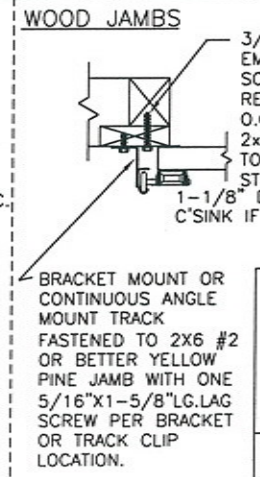
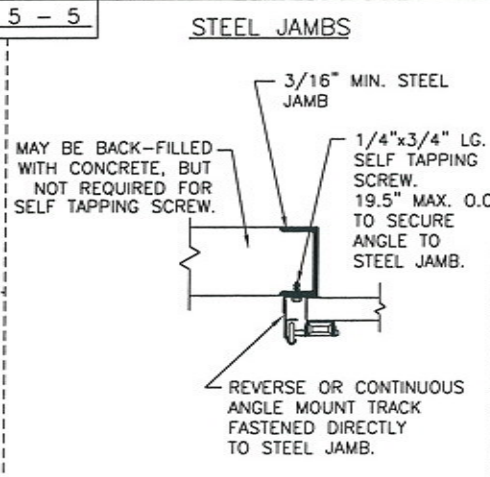
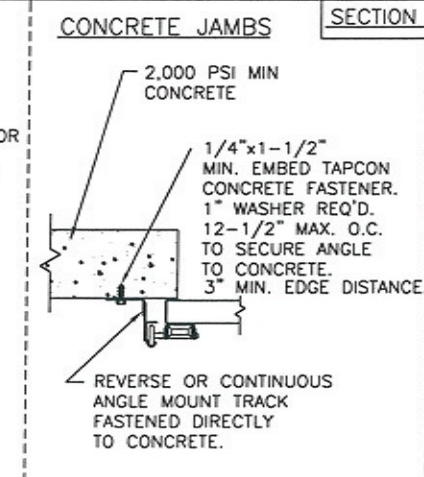
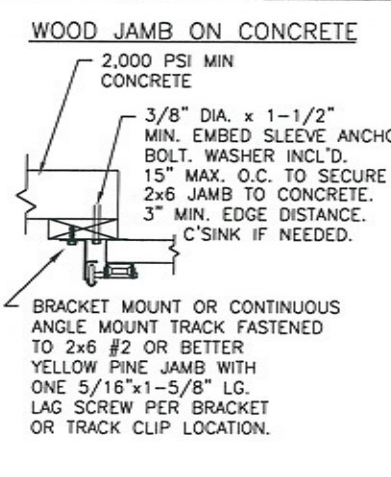
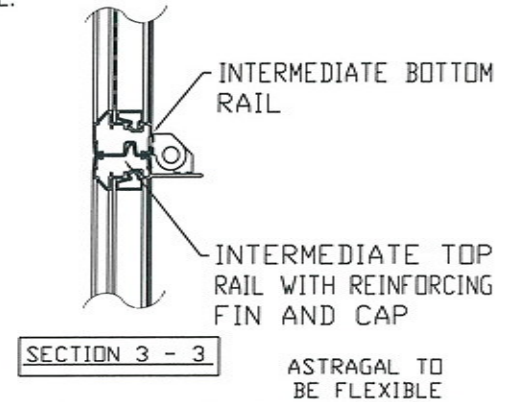
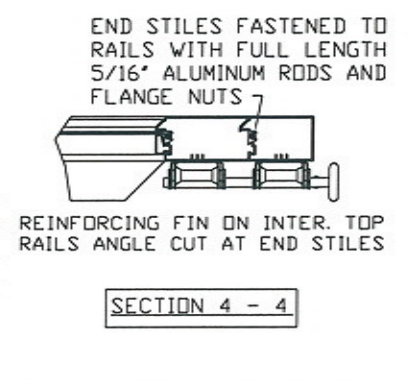
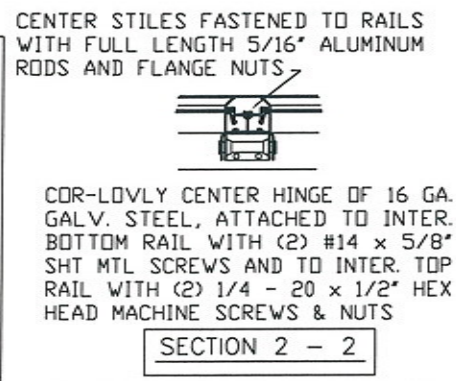
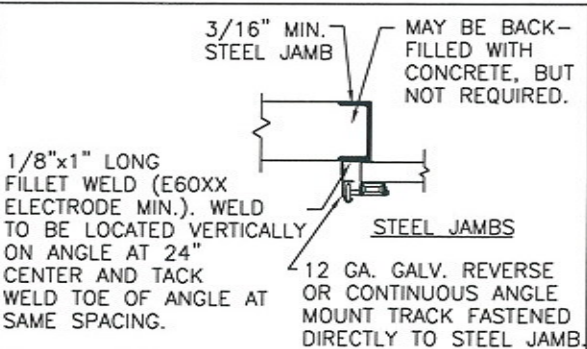

CLOPAY CORP. ALL RIGHTS RESERVED.

Third Angle Projection

Unless Stated Otherwise TOLERANCES are

.0	± .031
.00	± .015
.000	± .005
.0000	± .001
Degrees	± 1/2°

Unless Stated Otherwise DIMENSIONS ARE IN INCHES.

Clopay Building Products Company
8585 Duke Boulevard
Mason, OH 45040 USA
Tel. No. 513-770-4800
Fax No. 513-770-4853

DESIGN ENGINEER: MARK WESTERFIELD, P.E. FLORIDA P.E. #48495, NC P.E. #23832, TEXAS P.E. #91513 DESIGN LOADS: +32 & -32 P.S.F. TEST LOADS +48 & -48 P.S.F.	MPC: C-AL-1F499
WINDLOAD RATING W5	
DESCRIPTION: M/N 902 / C2AL +32PSF DES LOAD	
DRAWN BY: R.J.K.	DATE: 12/8/99
CHECKED BY: -	DATE: -
DWG. NO.: 103294	SHEET 1 OF 1
SCALE: N/A	DWG. SIZE: B

THE OPTIONAL GLAZING SHOWN ON THIS DRAWING MEETS THE WIND LOAD REQUIREMENTS OF THE FLORIDA BUILDING CODE OR INTERNATIONAL BUILDING CODE BUT DOES NOT MEET THE IMPACT RESISTANT REQUIREMENT FOR WINDBORNE DEBRIS REGIONS (FBC SECT. 1606.1.4; IBC SECT. 1609.1.4).

ADJUSTABLE TOP ROLLER BRKT. OF 12 GA. GALV. STEEL, FASTENED WITH (4) #14x5/8" SHT. METAL SCREWS

ONE 4" TALL C-CHANNEL PER DOOR SECTION. ONE 1/4" x 3/4" SELF TAPPING SCREW PER STILE.

5 STRAPS ON EACH SECTION. EACH STRAP ATTACHED WITH (3) 1/4" x 3/4" SELF TAPPING SCREWS (TWO SCREWS TO DOOR, ONE SCREW TO C-CHANNEL).

SECTION 1 - 1

2" ROLLERS FEATURE (10) 1/4" DIA STEEL BALL BRNGS., FULL FLOATING IN CASE HARDENED STEEL RACES

INTERMEDIATE ROLLER HINGES OF 14 GA MIN GALV STEEL, FASTENED WITH (4) #14 x 5/8" SHEET MTL SCREWS & (2) 1/4"x3/4" SELF TAPPING SCREWS.

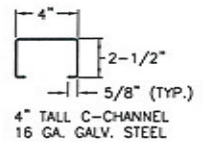
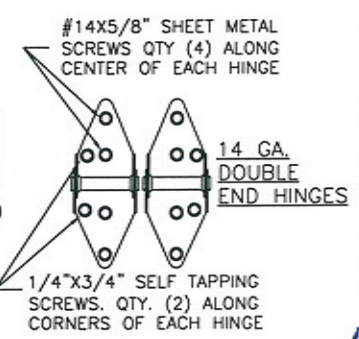

ASTRAGAL TO BE FLEXIBLE VINYL.

BOTTOM ROLLER BRACKET OF 12 GA. GALV. STEEL, FASTENED WITH (4) #14 x 5/8" SHT MTL SCREWS

BOTTOM SECTION REINFORCED W/ A TEMPERED ALUMINUM EXTRUSION WITH INTEGRAL RETAINER FOR FLEXIBLE VINYL ASTRAGAL

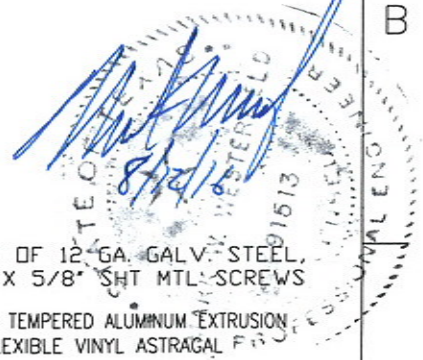

4 3 2 1